

INSTRUCTION

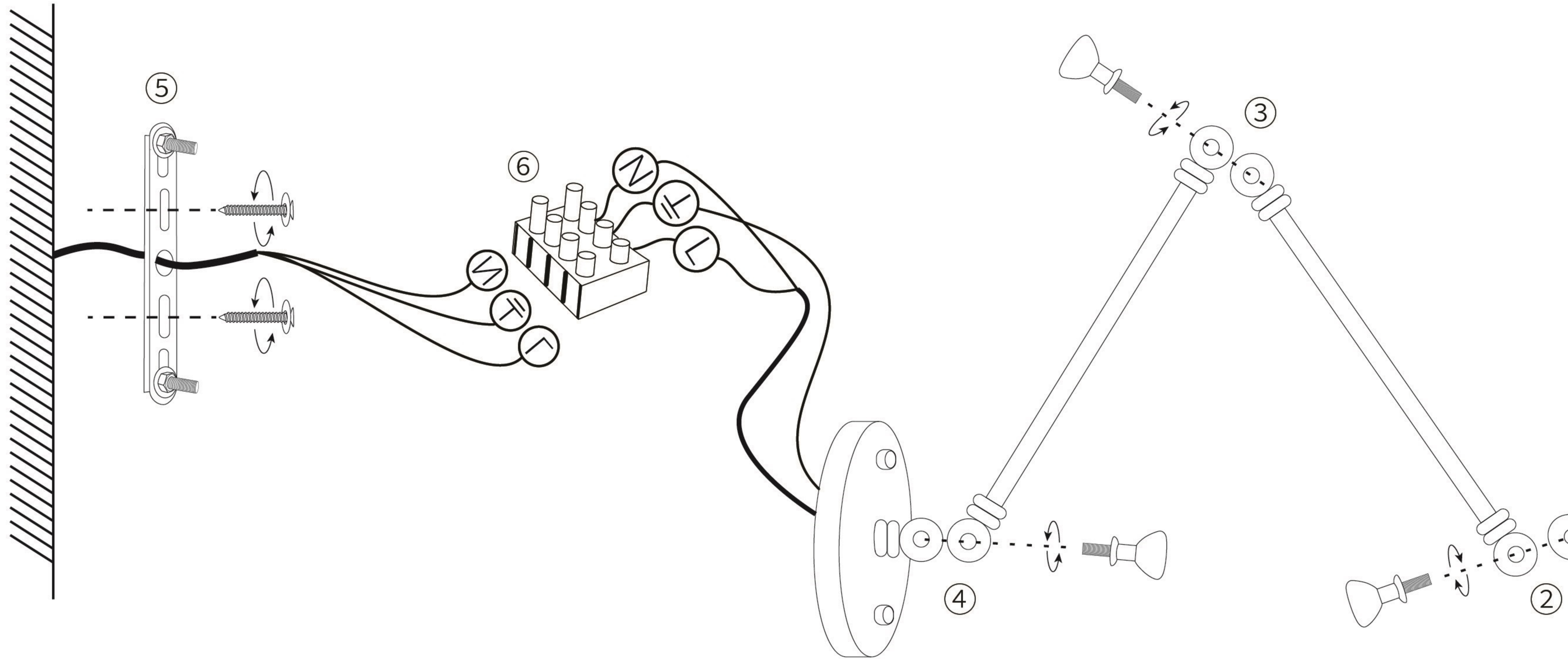

1. Please strictly follow the instructions while installation to avoid any Hazard or damages.

2. Please don't reform the light and change the part of light by yourself.

- ◆ Power do not exceed the prescribed scope.
- ◆ Please do not in high temperature, wet places or outdoor use.
- ◆ Maintenance; Installation shall ensure that the power supply has been cut off and the entrusted electrical professionals responsible for.
- ◆ When the abnormal situation of lamps and lanterns, please quickly cut off power supply, and contact the supplier.

Attention: Before installation, cut off power to prevent electric shock.

When installed, please followed the steps by number.

When finished, please check the light's installment to be whether reliable.

When adjust the angle, please loosen the screw at first, then fix the angle.

installation

Follow steps (②→③→④→⑤→⑥→①) :

- Light Installation. e.g.②③④: Screw the lamp shades as the number of picture, then fix the joint part.
- Wall Plate Installation. e.g.⑤: Ensure the hole distance of wall plate, then began drilling, fix and tighten the above-mentioned parts with expansion bolts.
- Fix the Lamp-stand. e.g.⑤: Ensure the hole of lamp-stand and wall plate, then tighten bolts.
- Connect Wires. e.g.⑥: Joint the reserved wire on the wall and the light.
Attn.: Please shut off the electric before joint the wire.
- Bulbs Insallation.