

ASSEMBLY INSTRUCTIONS

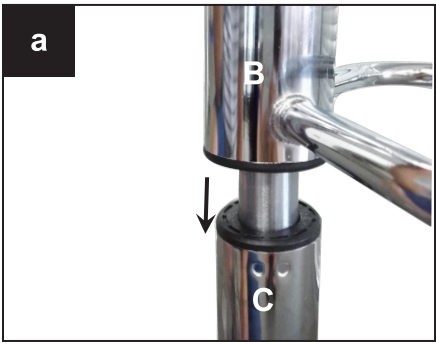

STEP # 3



3. Attach the barstool top to the base by inserting the upper of the gas lift mechanism (C) into the bottom of the steel seat plate (B) as instruction (a).
4. The Barstool is now ready for use. To raise and lower the seat, grasp the Handle and pull upward without applying any weight on the seat. To lower, raise the handle upward by sitting on the seat.

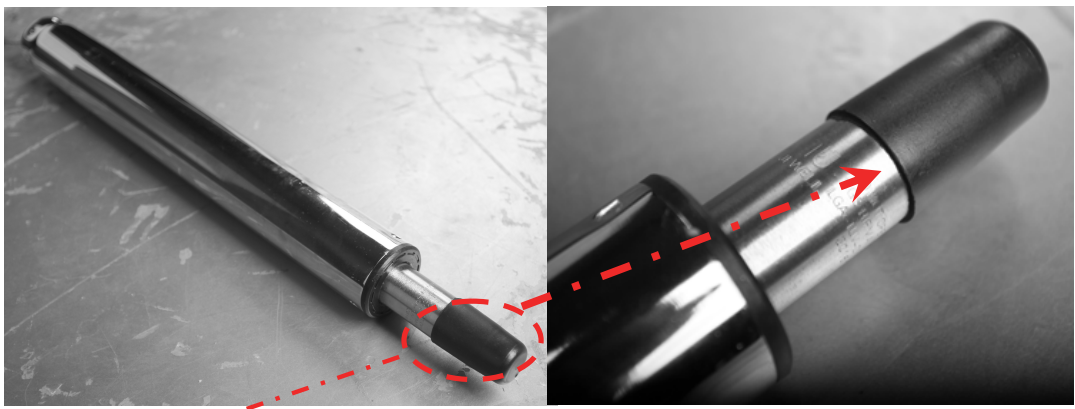

Please remove cap on the gas lift mechanism (C) before assembly.

ASSEMBLY INSTRUCTIONS

Adjustable Bar Stool



MAXIMUM RECOMMENDED WEIGHT CAPACITY

1. Maximum weight capacity per stool is 250 pounds.

GENERAL INFORMATION & TIPS

1. Please read the assembly instructions prior to assembling the chair.
2. To avoid damage, assemble the chair on a non-abrasive surface such as carpet.
3. Make sure all bolts are tightly fastened before the chair is used.
4. This chair is not for commercial use.

Please make sure you have all parts before beginning assembly. Please wait until all steps are completed before tightening bolts.

PARTS AND HARDWARE LIST

A. Seat Cushion	B. Steel Seat Plate	C. Gas Lift Mechanism
		
QTY: 1 pc	QTY: 1 pc	QTY: 1 pc
D. Barstool Base	E. Roundhead Allen Bolt	F. Allen Wrench
		
QTY: 1 pc	QTY: 4 pcs	QTY: 1 pc
G. Base Top Cover		
		
QTY: 1 pc		

ASSEMBLY INSTRUCTIONS

Please make sure you have all parts before beginning assembly. please wait until all steps are completed before tightening bolts.

1. Use the long end of the allen wrench to fasten allen bolts loosely and quickly.
2. Use the short end of the allen wrench for final tightening.

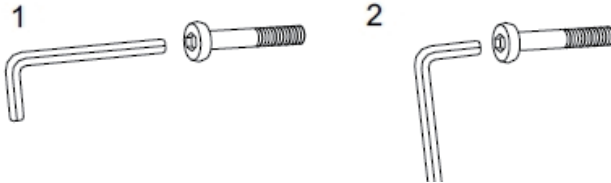

STEP # 1

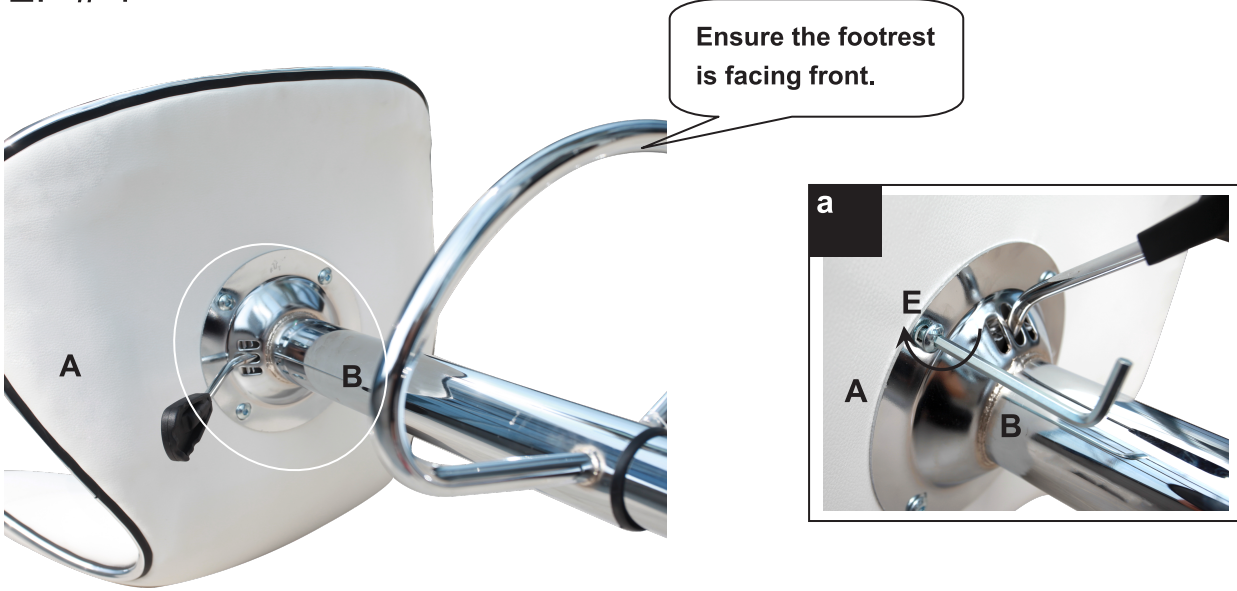

1. Attach steel seat plate (B) to the seat cushion (A) using four bolts (E) as instruction (a). Tighten the bolts with allen wrench

**Note: Ensure the footrest of the steel seat plate (B) is facing front.**

STEP # 2

2. Insert Gas Lift mechanism(C) into Base Top Cover(G) and into the hole on the barstool base(D) as shown.

