

## Fitting instructions

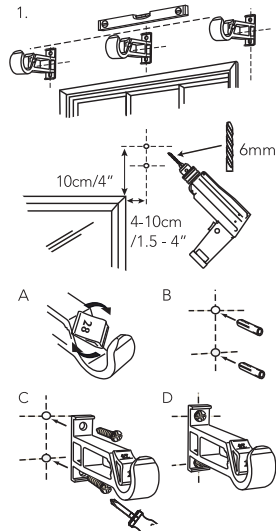

Position the brackets 4-10cm (1.5 - 4") from the edge of the window, and 10cm (4") above the window. Mark and drill the bracket positions, making sure they are level. Rotate the clear insert on the bracket having the larger number (28) upward for the 16mm pole width and the lower number (25) for the 13mm pole. Using suitable fixings mount the brackets in place.

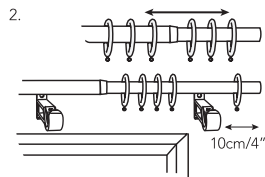

Extend the pole to required length. We recommend that the pole extends 10cm (4") beyond the end brackets to allow maximum light to enter the room when the curtains are open.

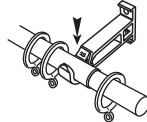

If using the pole with rings, slide the rings onto the pole. Place the pole onto the brackets positioning one ring either end between the finial and the bracket.

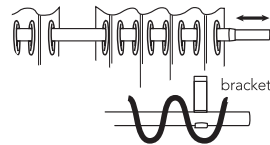

If you are hanging eyelet curtains onto the pole, place the last eyelet at each end between the finial and bracket to act as an end stop. When opening or closing eyelet curtains allow them to glide past the pole joint. Do not pull the curtains downwards when doing so.

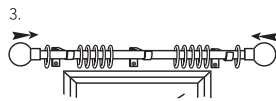

Place the finials over the pole ends.

Note: Separate diameter finials are supplied to fit either 13 or 16mm pole end.

Finial and other components may vary in style.