

# ASSEMBLY INSTRUCTION

## LIFT TOP TABLE WITH SHELF

### PART LIST:

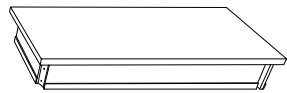

Cocktail table top  
1 pc

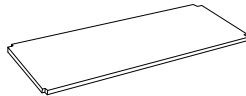

Bottom shelf  
1 pc

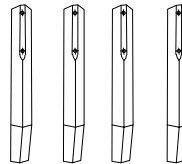

Cocktail Table leg  
4 pcs



Supporting leg  
1 pc

### HARDWARE LIST

A		L-ALLEN KEY	5mm	1 PC
B		Bolt	Ø5/16"x2"	8 PCS
C		Spring Washer	Ø5/16"	12 PCS
D		Flat Washer	Ø5/16"xØ19mm	12 PCS
E		Bolt	Ø5/16"x3/4"	4 PCS
F		Connector	24"x19"x18m/m	4 PCS
G		Screw	Ø8*5/8"	4 PCS

### STEP 1

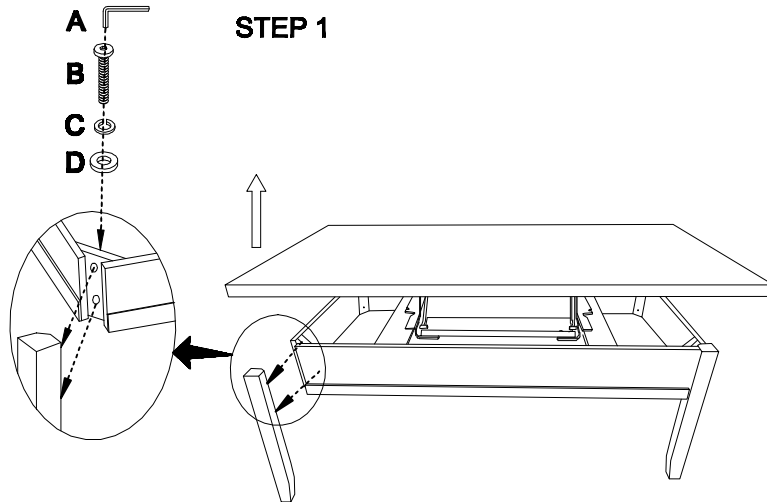

### STEP 2

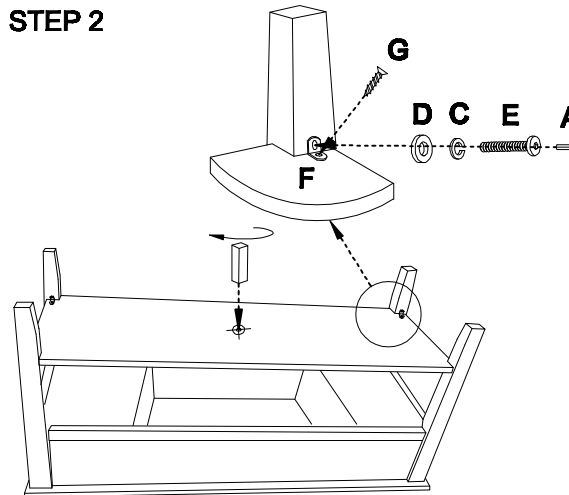

### COMPLETED

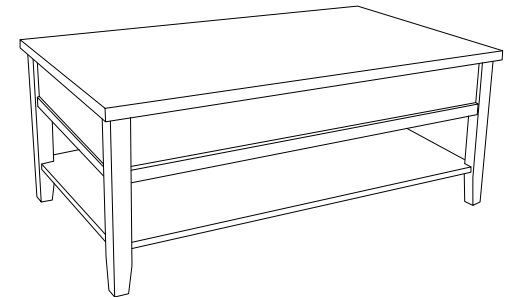

### CAUTION!

Do not allow children to play on the mechanized furniture or operate the mechanism. Top surfaces fold down on closing, so that a child could possibly be injured. Always leave furniture in the closed position when unattended. To prevent the table from tipping over, do not place more than 30 pounds on the top when in the open position. KEEP HANDS CLEAR OF MECHANISM.