

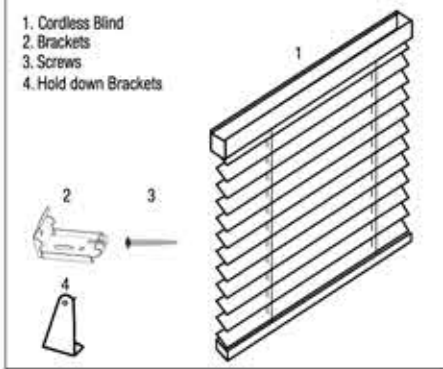

**Instructions for Installation, Operation and Cleaning**

Congratulations on your cordless blind purchase! You can take pride and comfort in knowing that your new blind will be easy to install, will add to your home's beauty, and will perform to your expectations. Before beginning installation, please take a moment to review the following instructions and safety warnings.



**IMPORTANT SAFETY INFORMATION**

Read all instructions, warning tags, and labels provided with your product to avoid injury. Keep this manual.

Please contact our Customer Service Center at the phone number, email or address below for additional support.

4. Mark screw locations. Align edge of bracket with inside or outside of marks made in step 3, ensuring to avoid the "X."

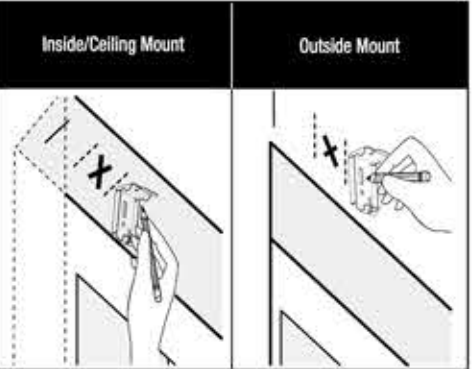

5. Drill holes.

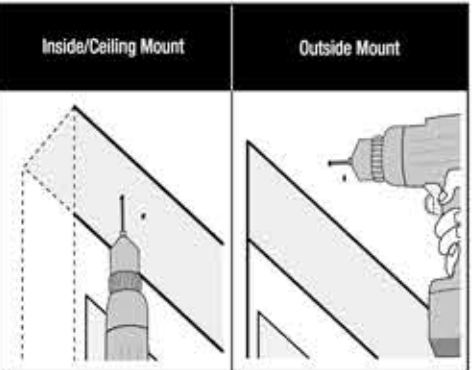

6. Screw brackets into place.

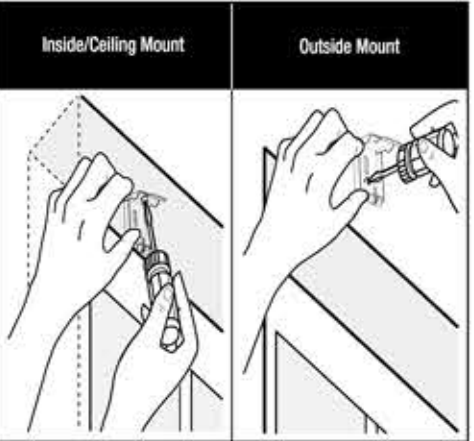

## Installation Instructions

1. Determine inside/ceiling or outside mount

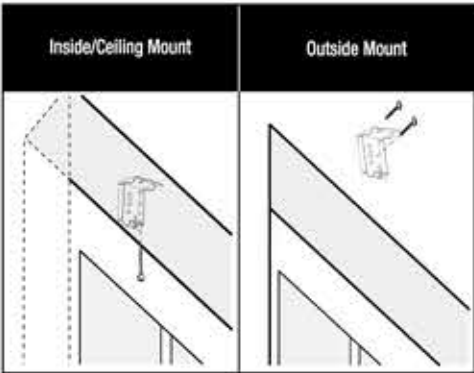

2. Place blind in desired location and mark corners.

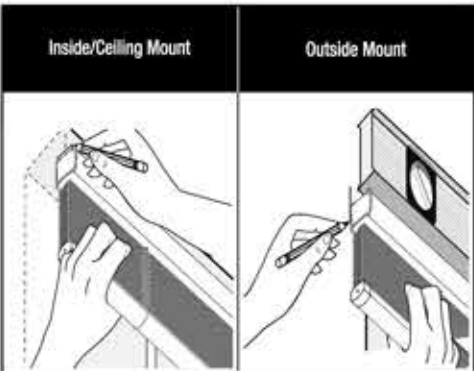

3. Tilt blind forward and mark location of internal components. For proper operation of the blind, brackets must be outside of this area.

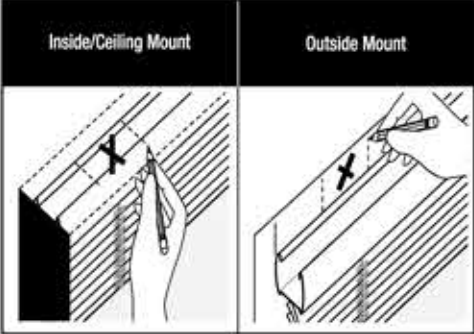

7. Mount blind in brackets.

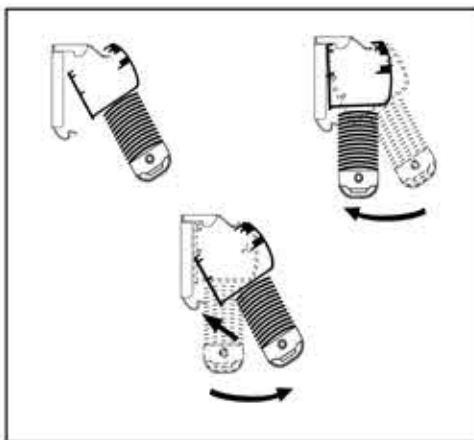

## Operation Instructions

**TO BRING BLIND DOWN TO WINDOW SILL:**  
Pull blind down to the window sill using the center of the bottom rail.

*Tip: You may pull blind all the way down to the window sill or stop at any desired height.*



**TO FULLY OPEN BLIND:**  
Push blind up using the center of the bottom rail.  
*Tip: You may fully open blind to top of window or stop at any desired height.*



**TO TILT SLATS:**  
Open or close the blind slats by turning the wand until the slats are opened or closed to the desired position.



## TROUBLESHOOTING GUIDE

**Problem: Bottomrail is uneven**

**Solution #1:**  
Correct by lifting bottom rail from the side hanging down the furthest.

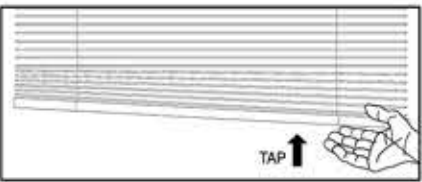

**Solution #2:**

- Lower bottom rail approximately 3ft from the headrail.
- Hold low side of the bottom rail with one hand.
- Using your other hand grab onto the high side of the bottom rail as far out as you can and pull down on that side to level.
- Raise and lower twice to check consistency and repeat as necessary to achieve a level bottomrail.



**Problem: Having difficulty attaching headrail to mounting brackets**

**Solution:** Tilt head rail to place head rail lip on top of mounting bracket hook. Level head rail and push back to lock head rail into mounting brackets.



**To Secure Blinds at Bottom of Window (OPTIONAL)**  
Hold down brackets have been included with your blind. If necessary, they can be used to prevent the blind from swaying in the wind. Otherwise, they can be discarded. Secure the hold down brackets to the window sill or door with screws. The pins protruding from the hold down brackets fit the holes in the end caps of the bottom rail.

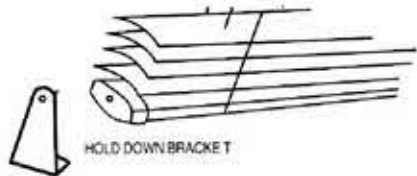

**TIP:**  
You can always move blind up and down and adjust slat tilt at any time.

**TO CLEAN BLIND:**  
Dust gently with clean, damp non-abrasive cloth.

**NOTE:**  
This blind cannot be shortened. Blind intentionally made longer to allow for slat tilt operation. Altering the length of this blind will compromise the function.