

ELECTRIC PALLET TRUCK WITH SCALE- EPT-2748-45-SCL

APPROX. WEIGHT: 1056 LBS.

*** ANY ADDITIONS, DELETIONS, OR OMISSIONS MUST BE CORRECTED ON THIS DRAWING AS THIS DRAWING WILL BE CONSIDERED ALL INCLUSIVE ***
ALL GRAPHICS PROVIDED ARE FOR REFERENCE ONLY. IF CERTAIN DIMENSIONS ARE CRITICAL PLEASE VERIFY THOSE DIMENSIONS WITH YOUR SALESPERSON

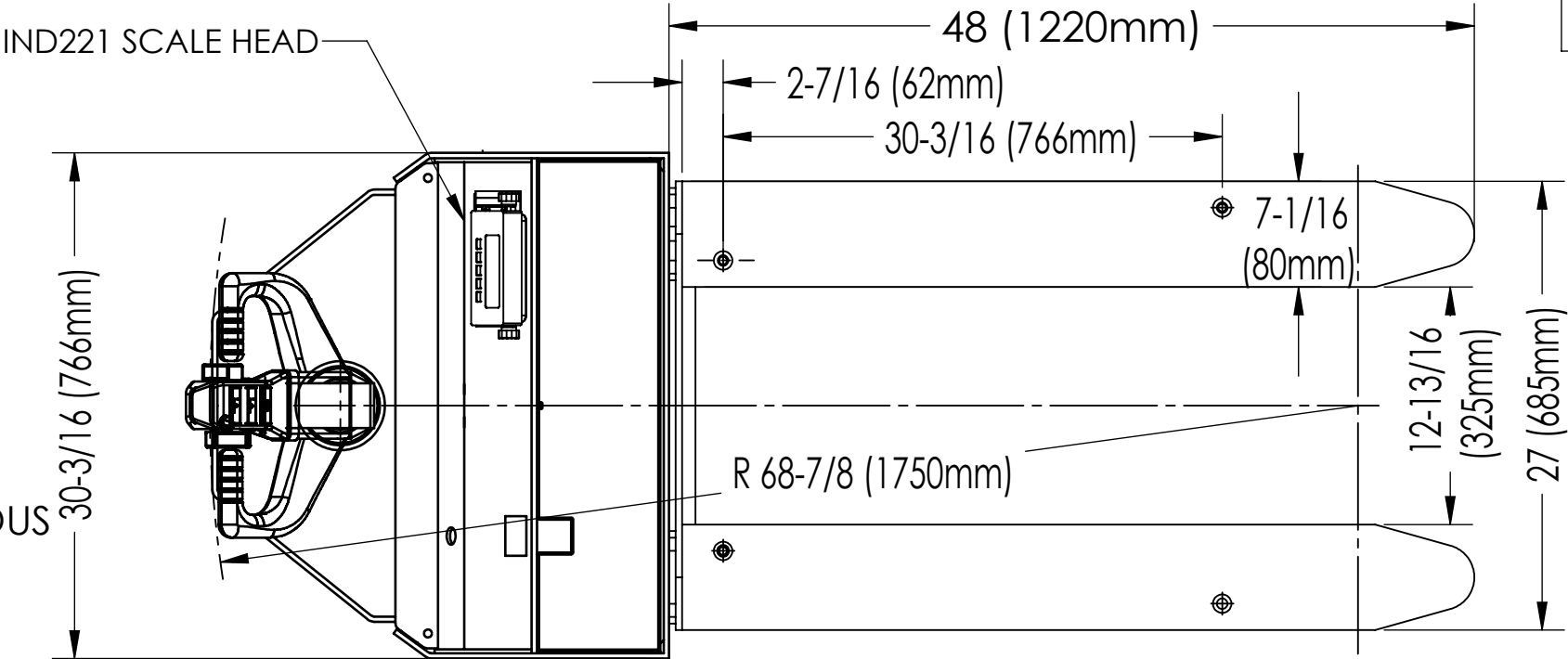
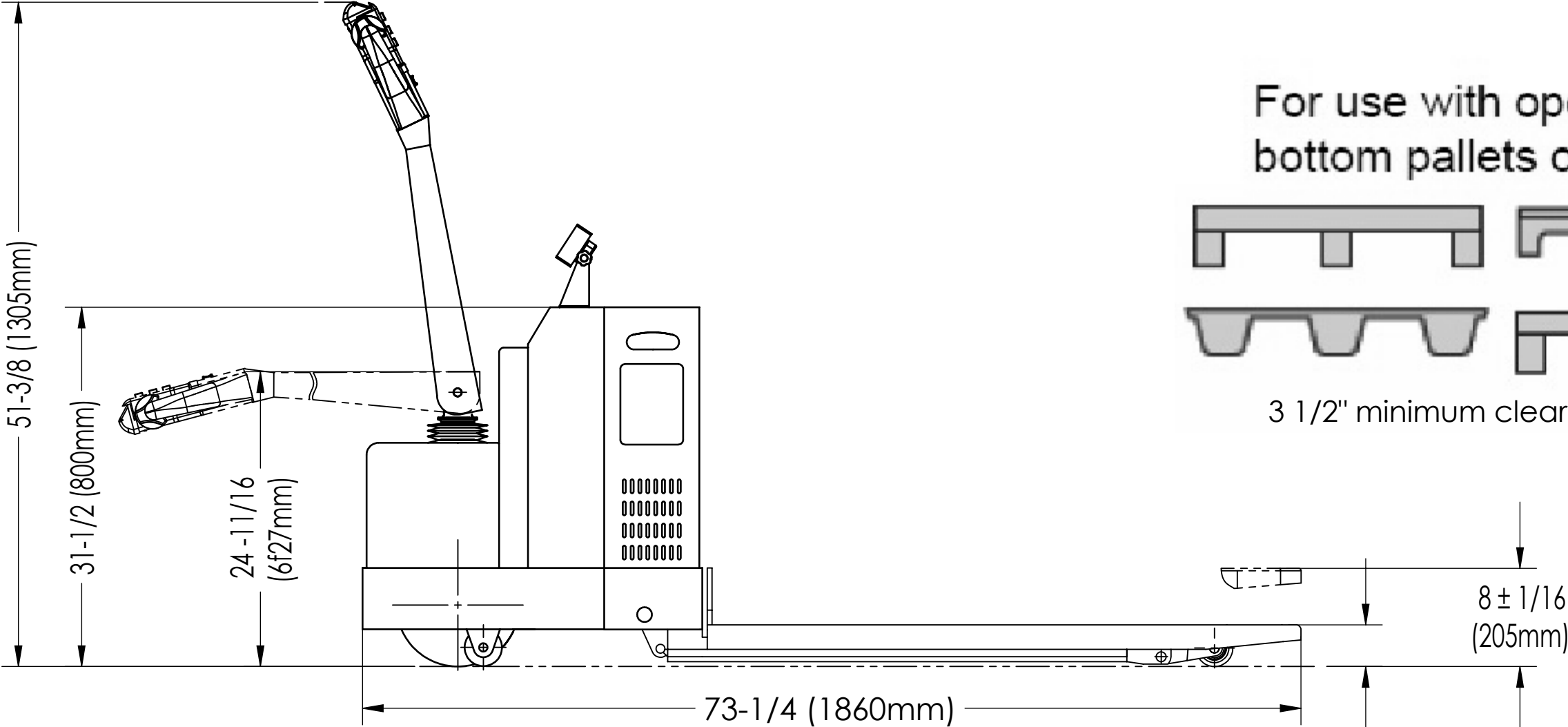

FOR INTERNAL USE ONLY PROJECT SIGN OFF	
SALES	
ENG.	
FAB.	
POWER	

APPROVAL	I, THE UNDERSIGNED, AGREE THAT THE PRODUCT AS REPRESENTED SATISFIES DESIGN AND DIMENSION REQUIREMENTS. I ALSO ACKNOWLEDGE MY DUTY TO CONFIRM PRODUCT AND INSTALLATION COMPLIANCE WITH ALL APPLICABLE FEDERAL, STATE AND LOCAL REGULATIONS AND STANDARDS.	
	UNITS REQUIRING APPROVAL DRAWINGS OR MODIFIED ARE NON-RETURNABLE	
	[] As drawn [] As marked	
	Signed: _____ Date: _____	
	Printed Name: _____ LEAD TIME WILL START UPON RECEIPT OF SIGNED APPROVAL DRAWING	

DISTRIBUTOR'S NAME:		P.O.#
VESTIL MANUFACTURING		X
DRAWN BY: RLH		W.O.#
DATE: 1/3/2019		X
REFERENCE: X	SCALE: NA	SALES: X
QUOTED LEAD TIME: X	QUOTE # X	FILE NAME: EPT-2748-45-SCL

STANDARD FEATURES
MODEL # EPT-2748-45-SCL
CAPACITY: 4,500 LBS. CONTINUOUS
LIFT HEIGHT: 8 ± 1/16"
LOWERED HEIGHT: 3 3/8 ± 1/16"
DRIVE WHEEL: Ø10 X 3 1/8"
LOAD ROLLER: Ø2¾ X 2.9"
TOUGH BAKED IN POWDER COATED
BLACK & YELLOW FINISH