

5 Drawer Office Cabinet

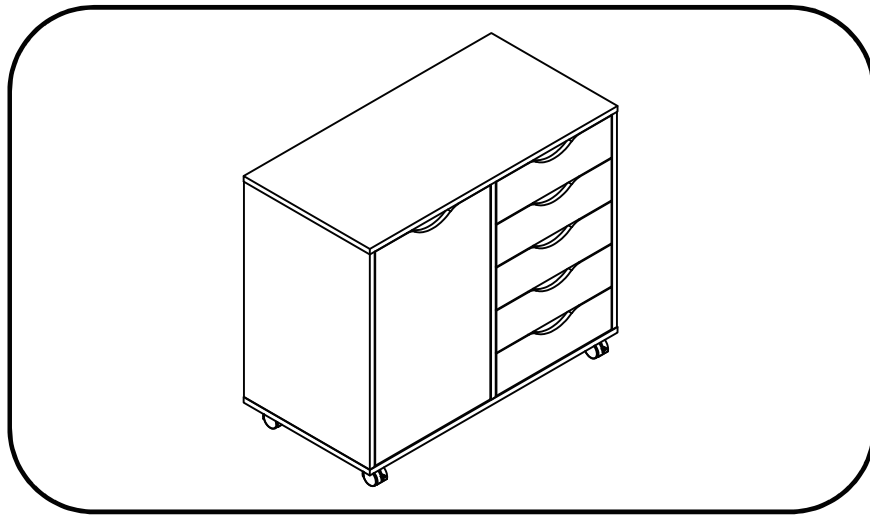

Assembly Instructions

Product Dimensions:
30.79"L×15.63"D×26.42"H

Please take a moment to read through the entire instruction booklet before assembly to familiarize yourself with this product. Once you feel ready to start, follow the instructions step by step and this should make this process as easy as we could make it for you.

If you need help or have damaged or missing parts, contact customer service at

WARNING CAUTION

ADULT ASSEMBLY REQUIRED

CHOKING HAZARD

- This product includes small parts, sharp points and sharp edges in its unassembled state. Keep unassembled parts away from children under 3 years of age, and animals.

SAFETY WARNINGS

- Follow the information on the warnings appearing on cabinet and on the carton. Do not remove warning label from cabinet.
- Do not allow children under 3 years of age to use the cabinet.
- Do not use substitute parts. Contact the manufacturer or dealer for replacement parts.

FURNITURE TIP-OVER HAZARD

Children have died from furniture tip-over

To reduce the risk of furniture tip-over:

- ALWAYS install tip-over restraint especially if used by a wall or in the open.
- NEVER put a TV on this product
- NEVER allow children to stand, climb or hang on drawers, doors, or shelves.
- NEVER open more than one drawer at a time.
- ALWAYS place heaviest items in lowest cabinet.

PARENTAL SUPERVISION IS REQUIRED

- Parents or Guardians should supervise use under the intended age specifically regarding children that may have access to it and climb on the unit.
- Do not allow horseplay on, under, or behind the unit and prohibit jumping on the cabinet.
- If used improperly, your table may be pulled over or fall, creating risk of injury or damage. Children should not be permitted to climb or pull on the cabinet.

USE, MAINTENANCE & ASSEMBLY

- Periodically check and ensure that the components are in their proper position, free from damage, and that all connectors are tight.
- Use on level surfaces only. Assemble on a soft level surface to avoid damage to unit or floor.
- Do not use this item if any components are missing or damaged.
- Do not use substitute parts. Contact the manufacturer or dealer for replacement parts.
- Only clean using damp cloth and mild detergent, do not use bleach or abrasive cleaners.
- Check you have all components and tools listed on page 4
- Do not stand or put weight on this product during assembly, this could cause damage.
- Remove all hardware from the plastic bags and separate them into groups.
- Assemble the item as close to its final position (in the same room) as possible.
- Certain assembly steps may be easier with 2 people.
- Dispose of all packaging carefully and responsibly.
- We do not recommend power screwdrivers. Only use hand screwdrivers to prevent damage to unit.
- Keep these instructions for future reference.

Enfants morts suite au basculement d'un meuble.

Afin de limiter le risque de basculement de meuble:

- TOUJOURS utiliser les fixations anti-basculement.
- NE JAMAIS installer de TV sur ce produit.
- NE JAMAIS laisser d'enfants se tenir debout sur les tiroirs, portes ou étagères, y grimper ou s'y suspendre.
- NE JAMAIS ouvrir plus d'un tiroir à la fois.
- TOUJOURS placer les choses les plus lourdes dans les tiroirs du bas.

Han muerto niños por el vuelco de muebles.

Para limitar el riesgo de vuelco de los muebles:

- Utilizar SIEMPRE las fijaciones antivuelco que suministran.
- NUNCA instalar un TV sobre este producto.
- NUNCA permitir que los niños se pongan de pie, trepen o se cuelguen de los cajones, puertas o baldas.
- NUNCA abrir más de un cajón a la vez.
- Colocar los objetos más pesados en los cajones inferiores.

ASSEMBLY INSTRUCTION

Please take a moment to read through the whole instruction booklet before assembly to familiarize yourself with this product. Once you feel ready to start, follow the instructions step by step and this should make this process as easy as we could make it for you.

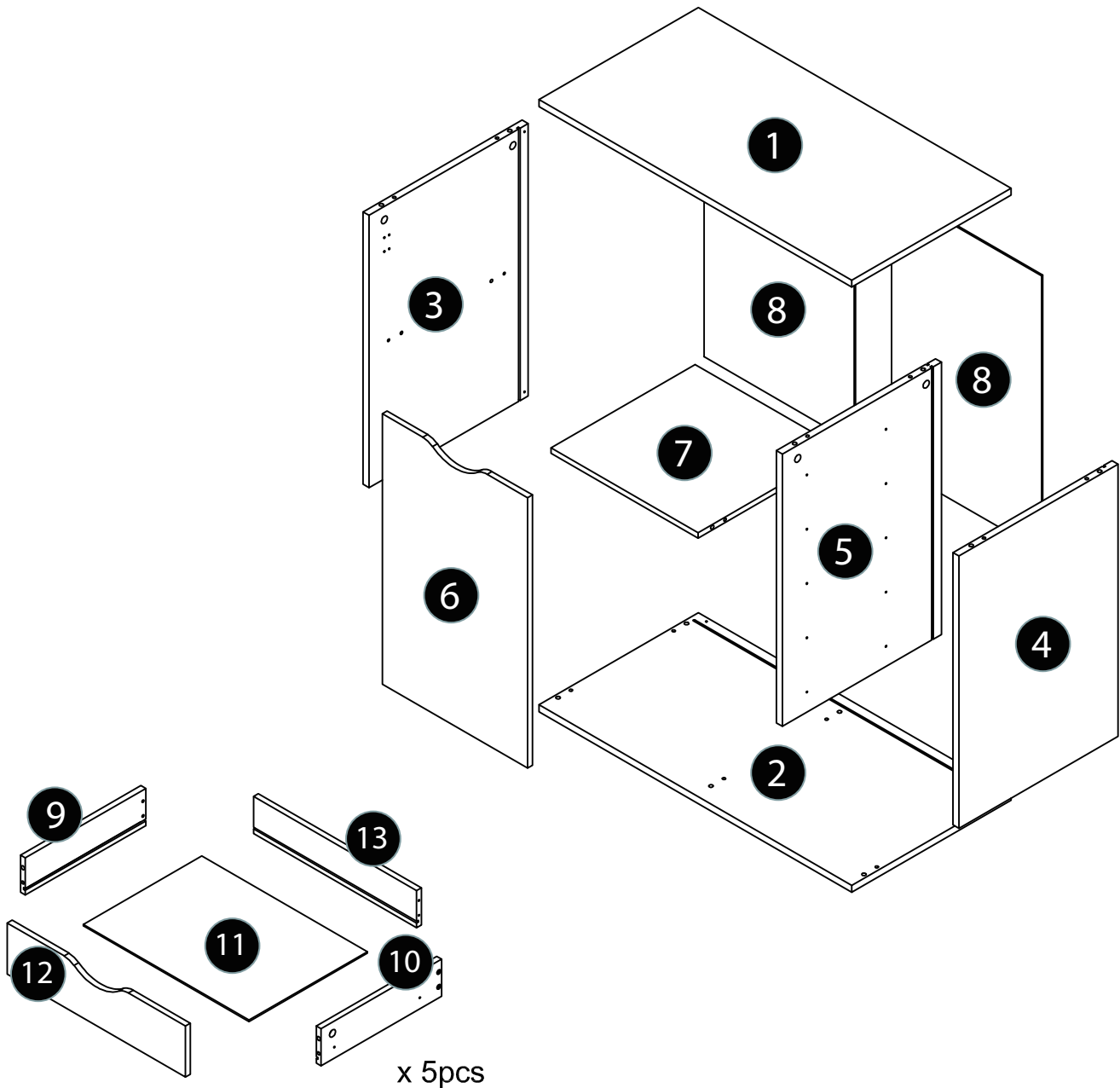

This drawing is to give you an overall idea only of how this assembly will go together and does not replace the assembly instructions.

COMPONENT PARTS

Please check that you have all the parts listed below

1. Top Panel ×1
2. Bottom Panel×1
3. Left Side Panel ×1
4. Right Side Panel ×1
5. Neutral Plate ×1
6. Cabinet Front Door ×1
7. Cabinet Middle Panel ×1
8. Back Panel×2
9. Drawer Left Panel×5
10. Drawer Right Panel×5
11. Drawer Bottom Panel ×5
12. Drawer Front Panel ×5
13. Drawer Back Panel×5

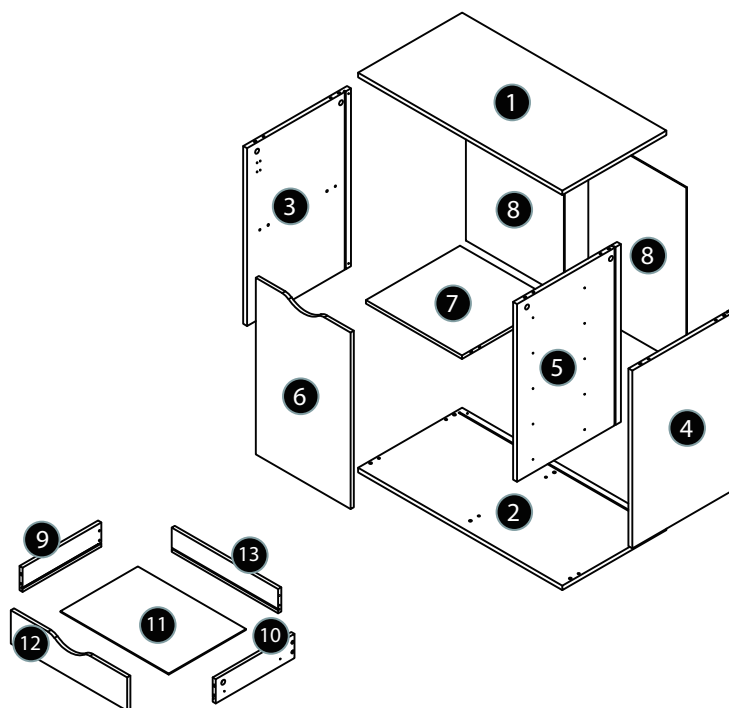

ASSEMBLY HARDWARE

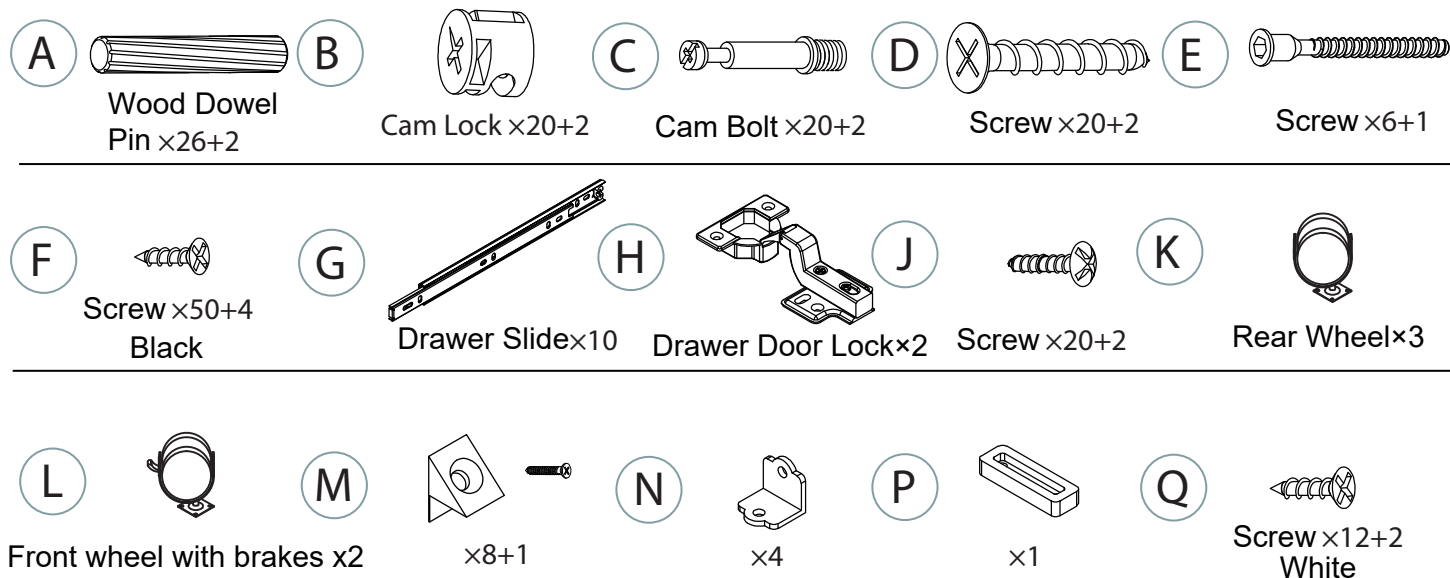

Tools Required

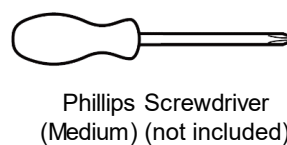
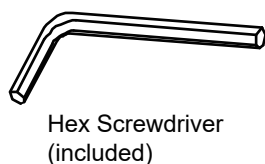

***Do Not Use Power
Screwdriver or Drill.**

ASSEMBLY INSTRUCTIONS

1

Select G (×10) .Divide G(×10) into Drawer Slide Inner(×10) and Drawer Slide Outer(×10).

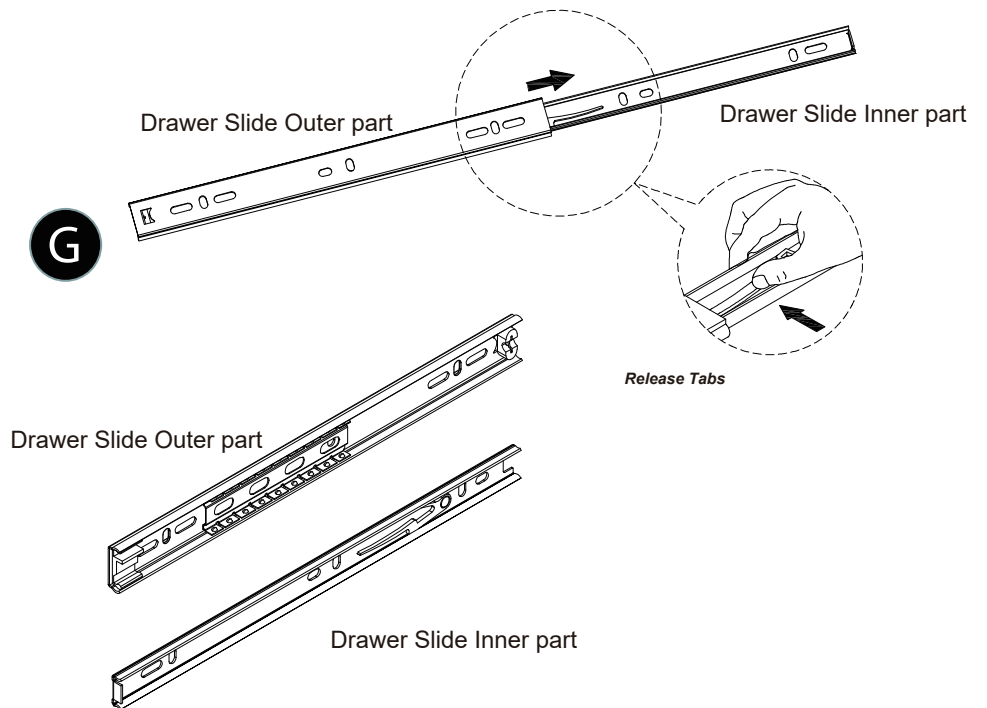

2

Select 3(×1) and C(×2).Insert C(×2) into 3.

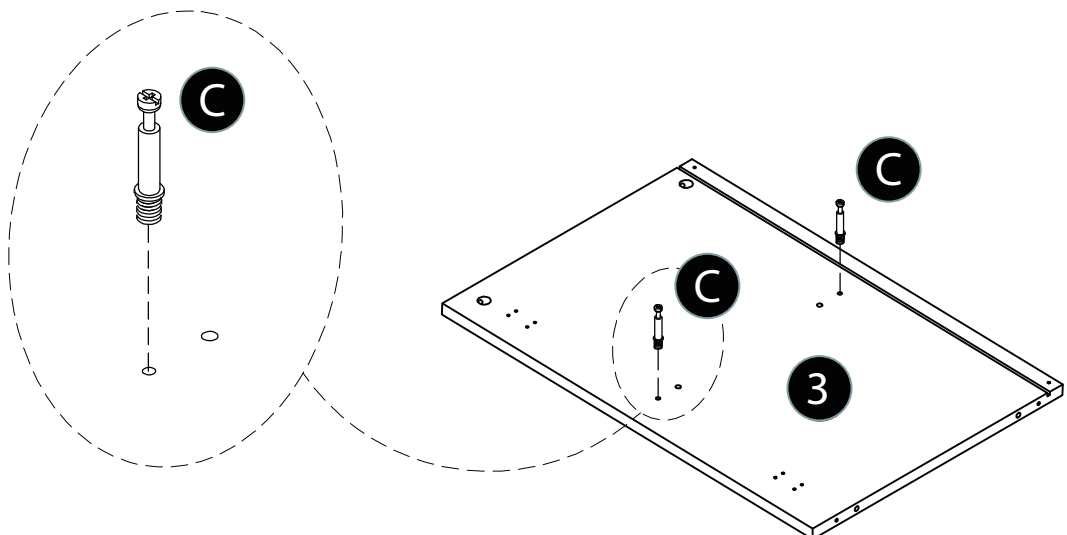

ASSEMBLY INSTRUCTIONS

3

Select 7(×1), A(×2) and B(×2). Insert 7 into 3 with A(×2) and C(×2). Insert B(×2) into 7.

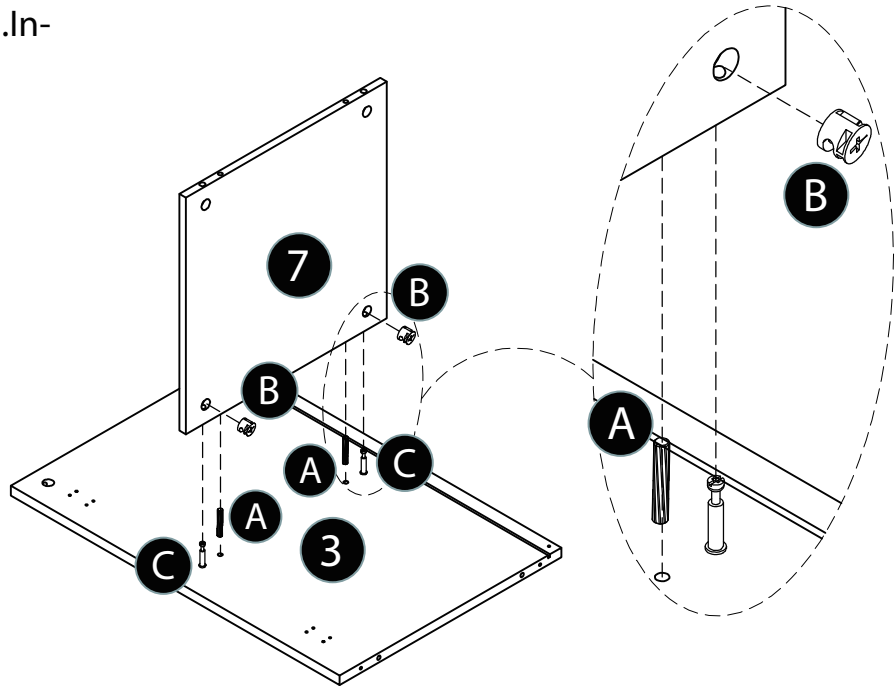
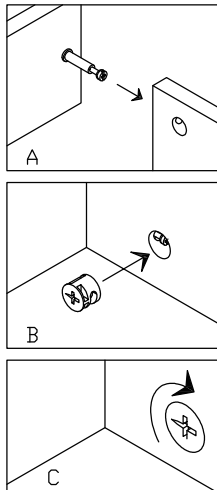

4

Select 5(×1), F(×10) and Drawer Slide Outer part (×5). Attach Drawer Slide Outer part(×5) to 5 with F(×10).

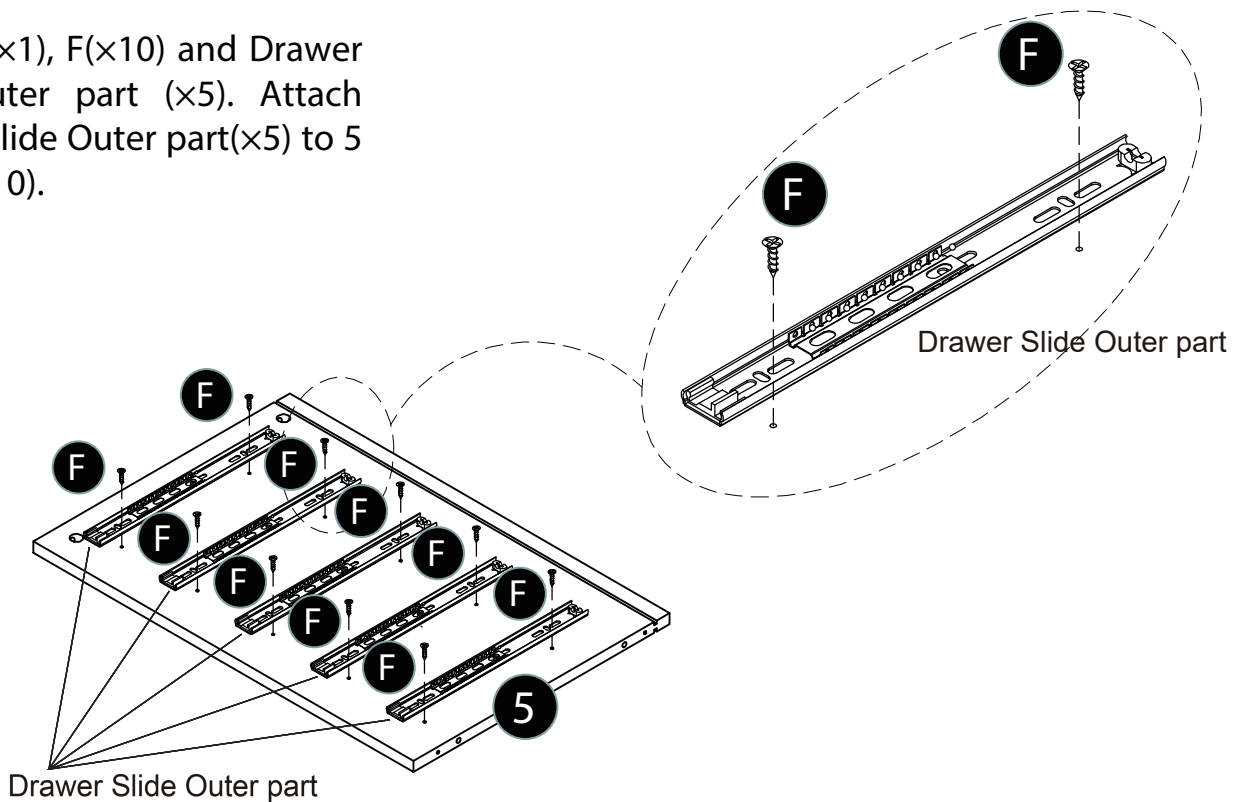

ASSEMBLY INSTRUCTIONS

5

Select 5(×1) and C(×2). Insert C(×2) into 5.

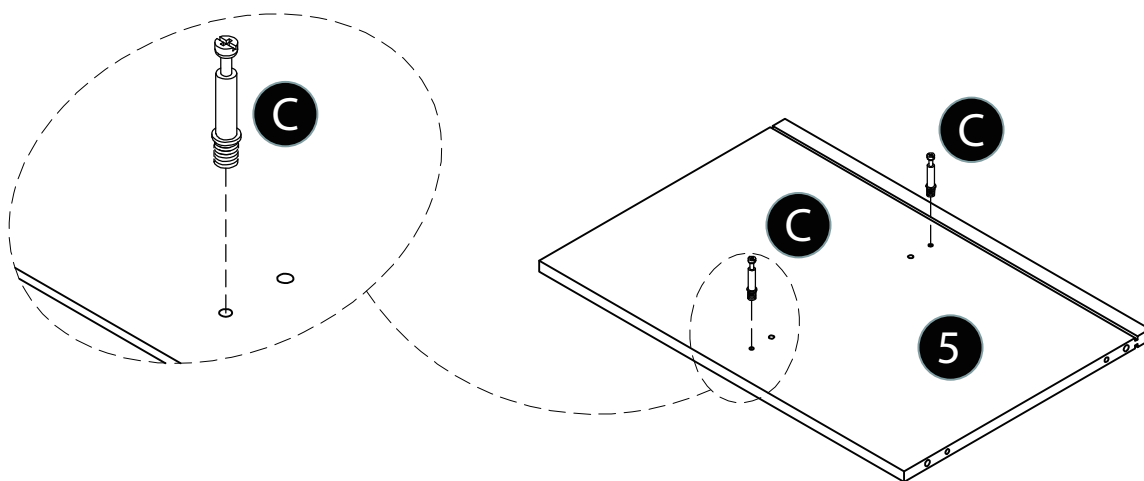

6

Insert 7 into 5 with A(×2) and C(×2).
Insert B(×2) into 7.

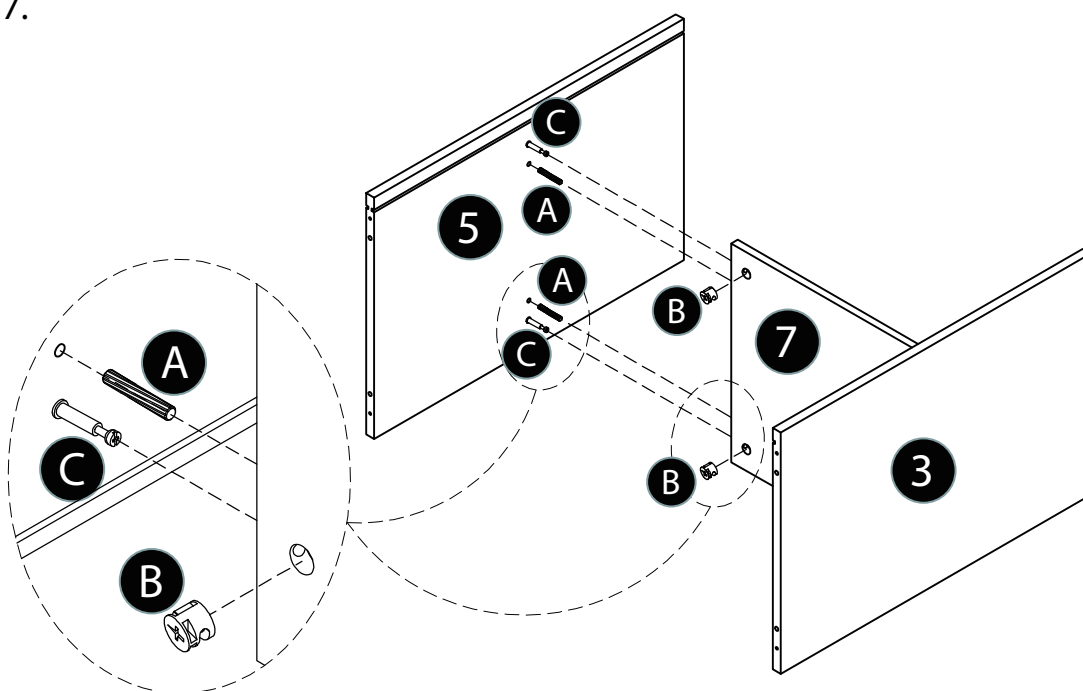

ASSEMBLY INSTRUCTIONS

7

Select 4(×1), F(×10) and Drawer Slide Outer part (×5). Attach Drawer Slide Outer part(×5) to 4 with F(×10).

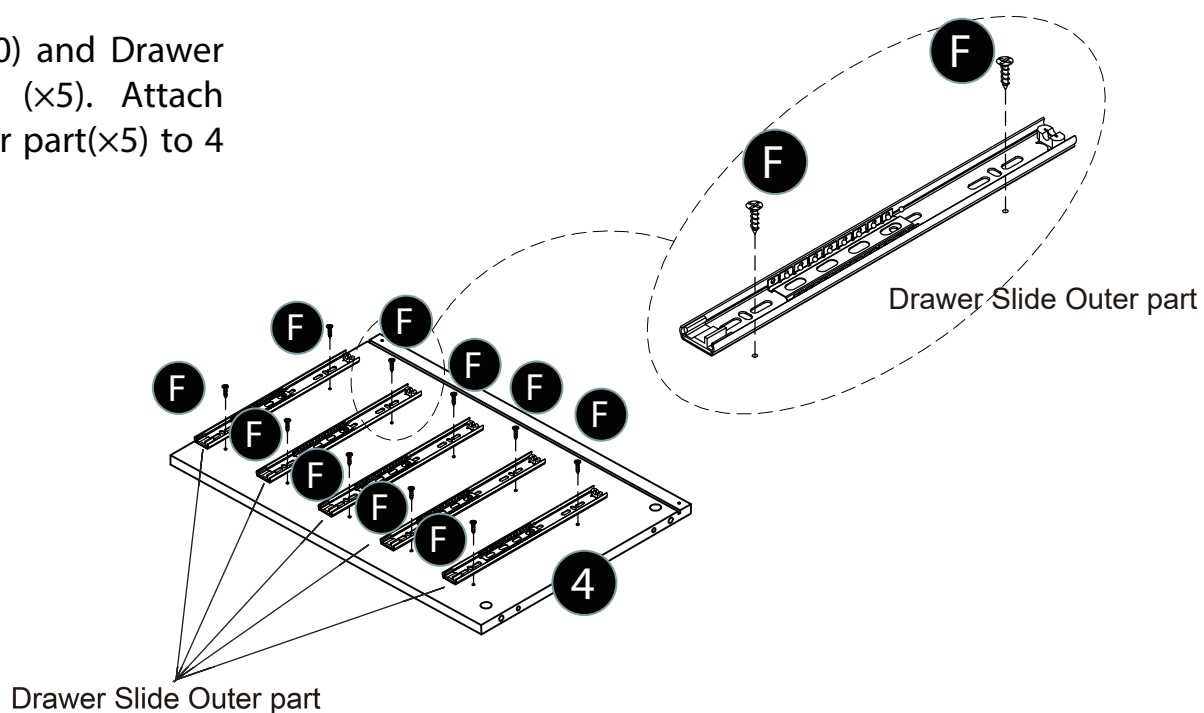

8

Install C(×6) into 1. Insert F(×2) into P(×1) into 1.

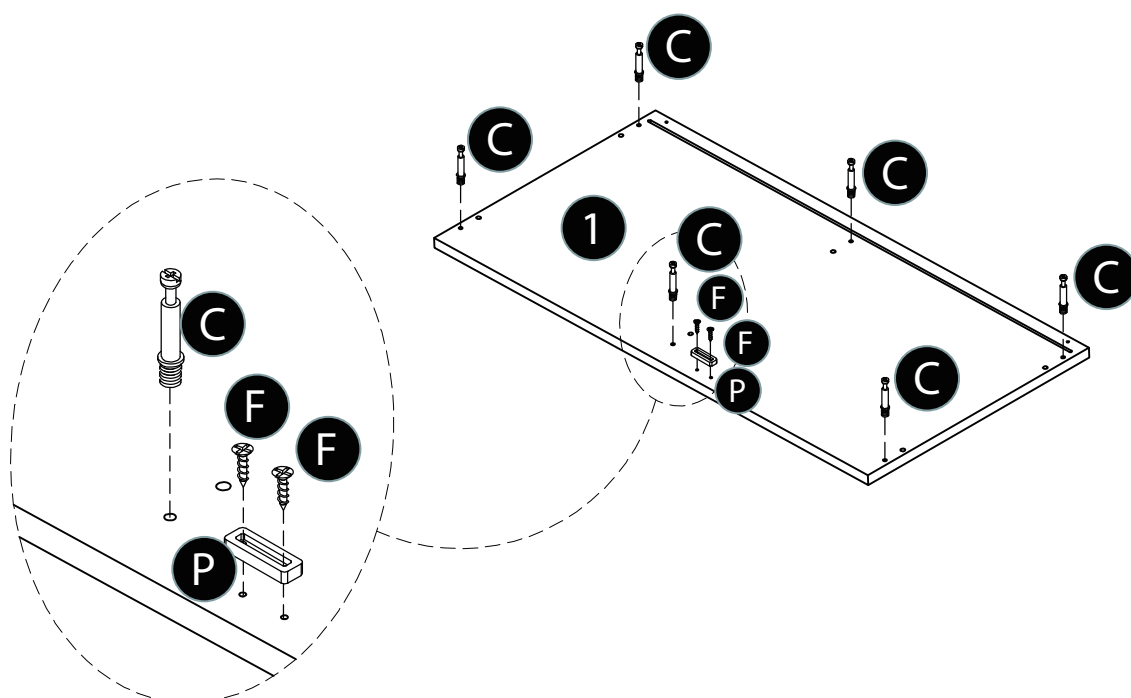

ASSEMBLY INSTRUCTIONS

9

Insert 4 into 1 with A($\times 2$) and C($\times 2$).
Insert B($\times 2$) into 4.

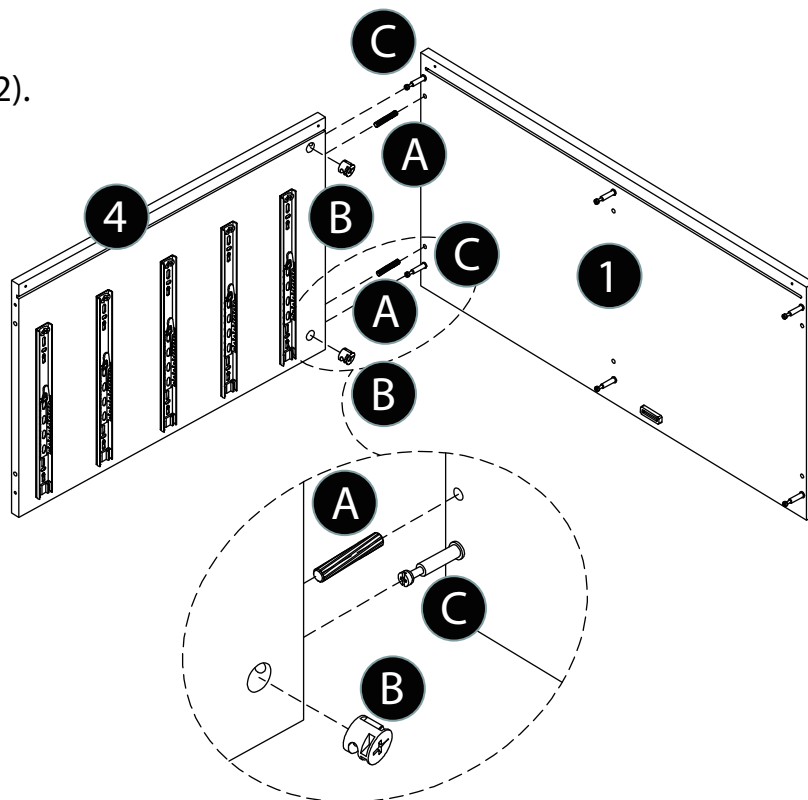

10

Insert 3 into 1 with A($\times 2$) and C($\times 2$).
Insert 5 into the middle hole of 1 with
A($\times 2$) and C($\times 2$).
Insert B($\times 2$) into 5.
Repeat for 3.

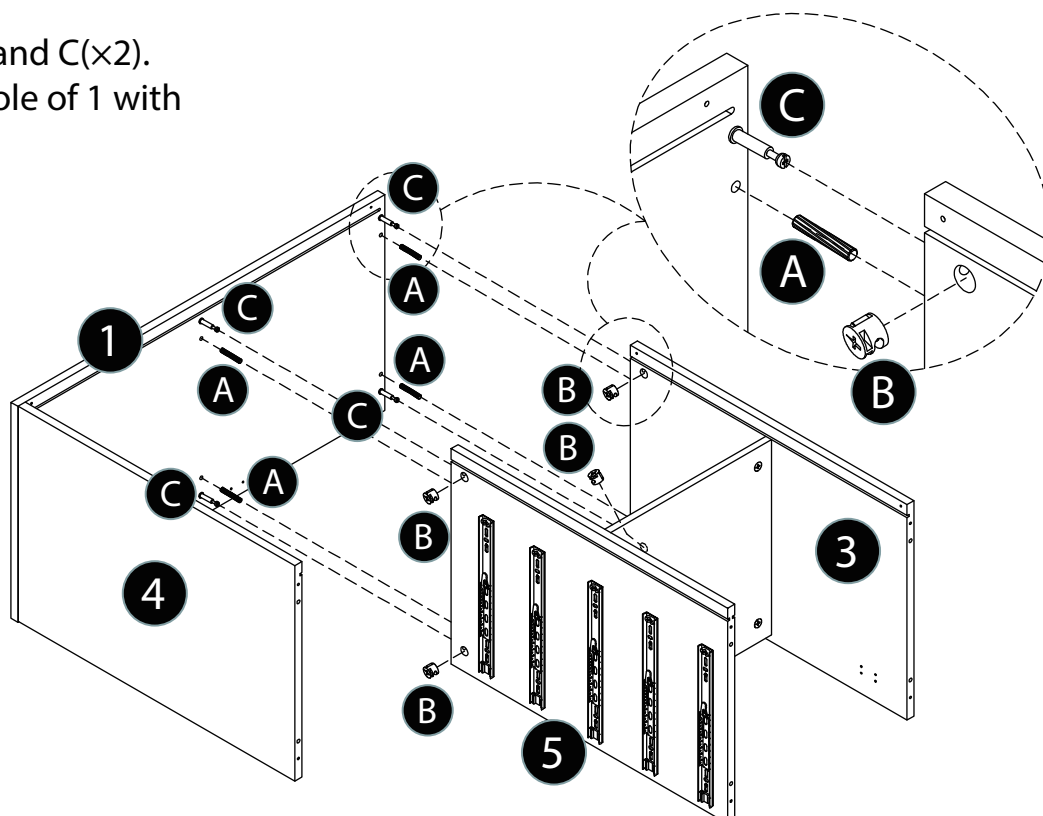

ASSEMBLY INSTRUCTIONS

11

Select 8(x2). Install 8(x1) along the grooves of 3 and 5. Repeat for the other 8.

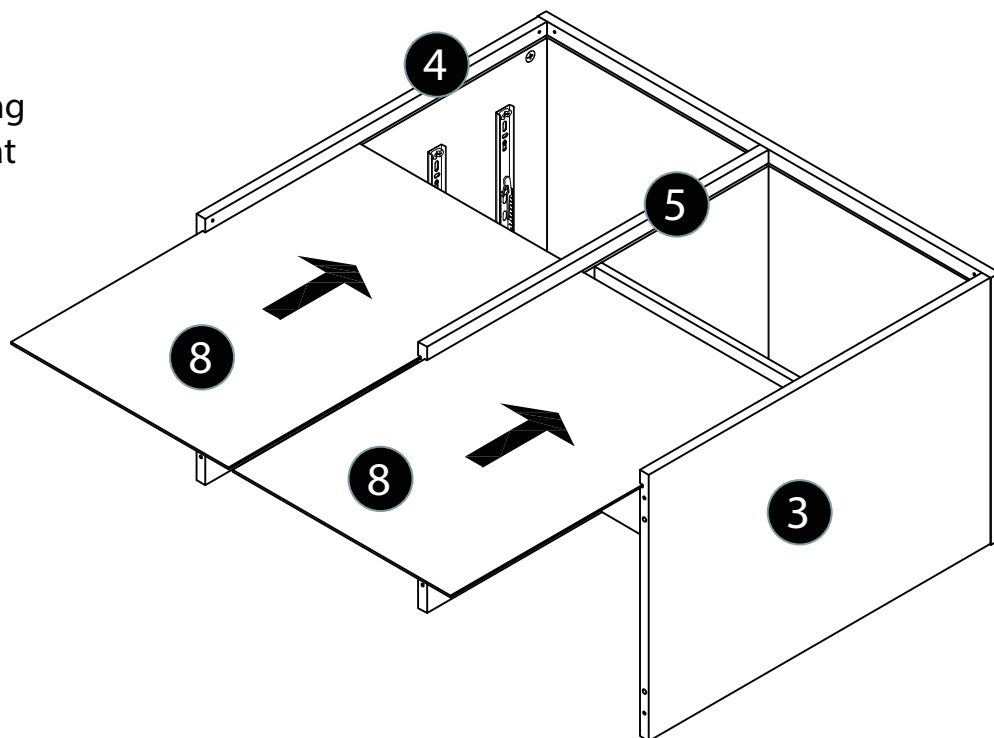

12

Select A(x6) and E(x6).
Insert 2 into 4,5 and 6 with
A(x6) and E(x6).

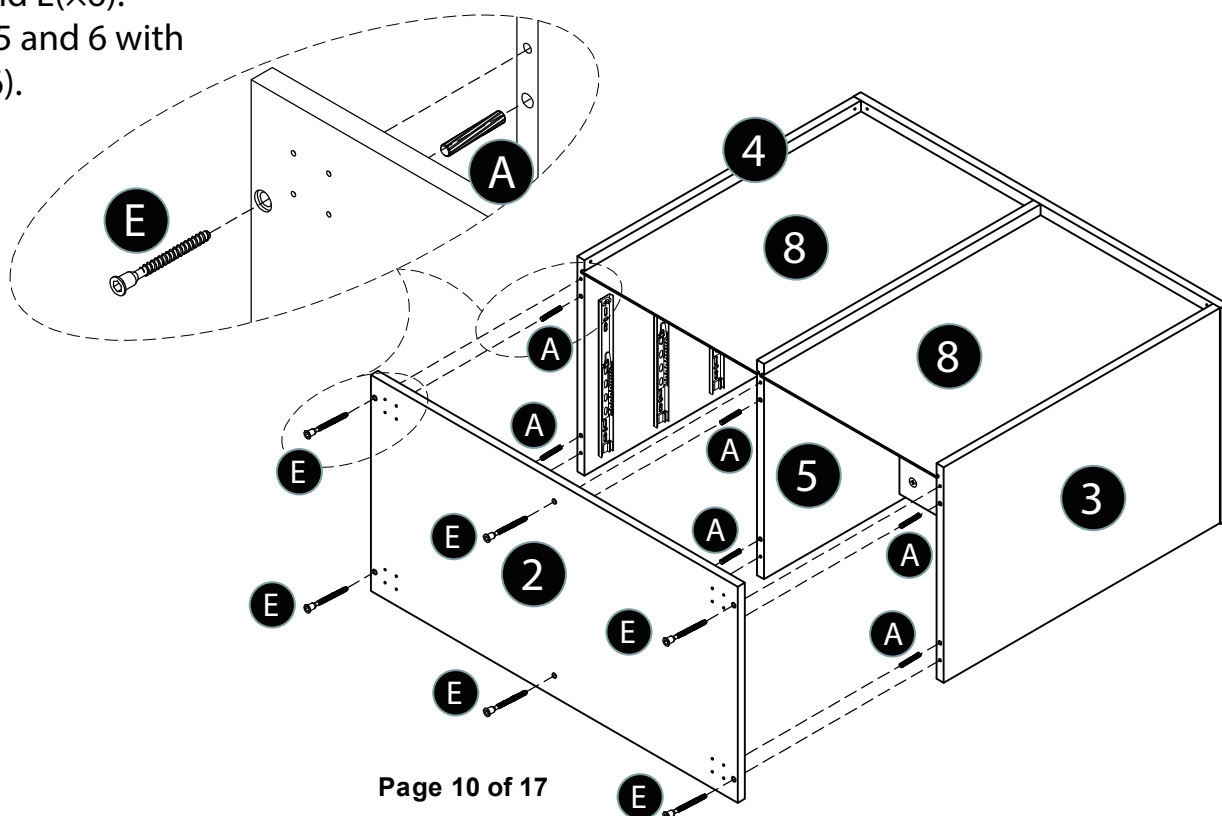

ASSEMBLY INSTRUCTIONS

13

Select K($\times 3$), L($\times 2$) and J($\times 20$).
Insert K($\times 2$) into 2 with J($\times 8$).
Repeat for L($\times 2$).

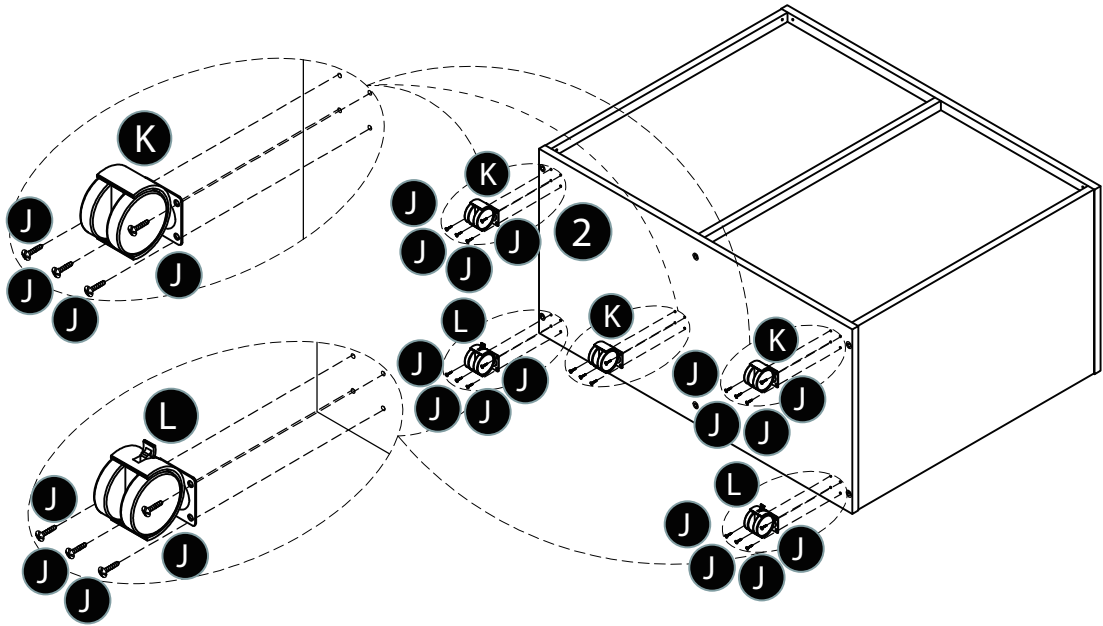

14

Select F($\times 8$), M($\times 12$) and N($\times 4$).
Insert N($\times 4$) into F($\times 8$) into corners of 8($\times 2$).
Insert M($\times 4$) into 8($\times 1$). Repeat for the other 8.

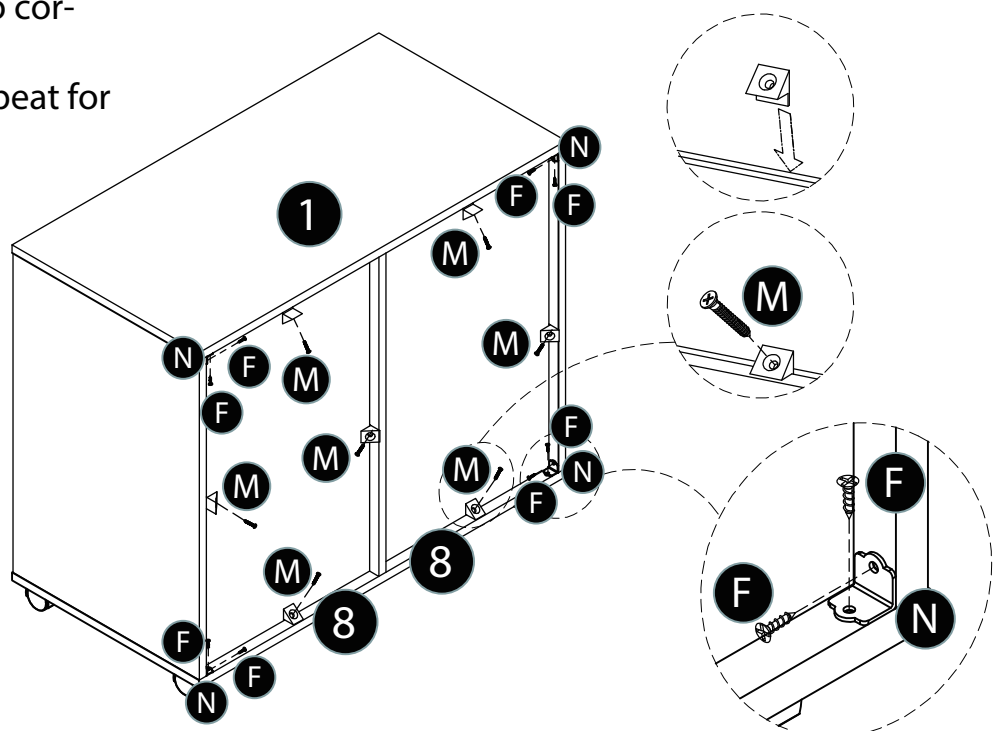

ASSEMBLY INSTRUCTIONS

15

Select D(×20), 9(×5), 10(×5) and 13(×5).

Insert D(×2) into 9(×1) into one side of 13.

Repeat for another 9(×4) and 13(×4).

Insert D(×2) into 10(×1) into the other side of 13. Repeat for another 10(×4) and 13(×4).

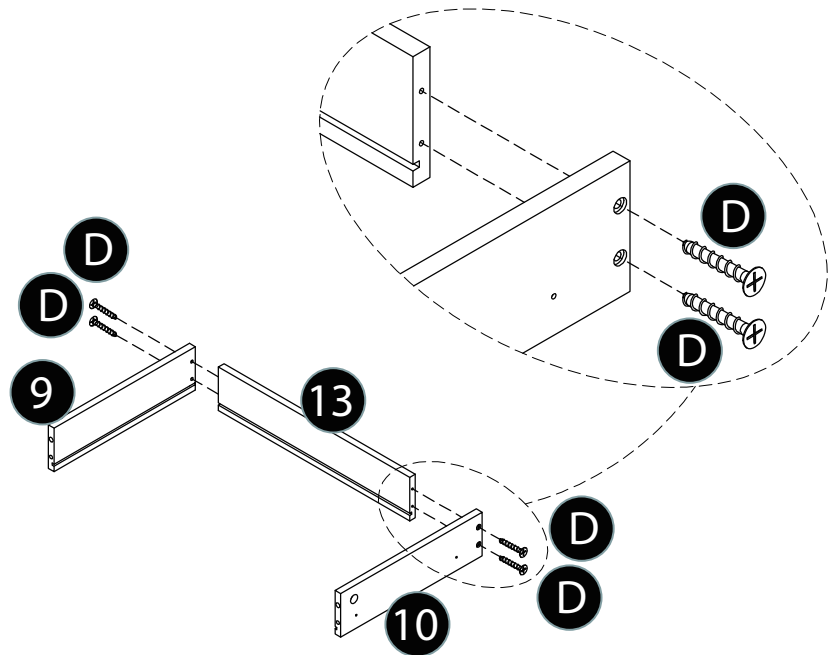

16

Install 11(×5) along the grooves of 9(×5) and 10(×5).

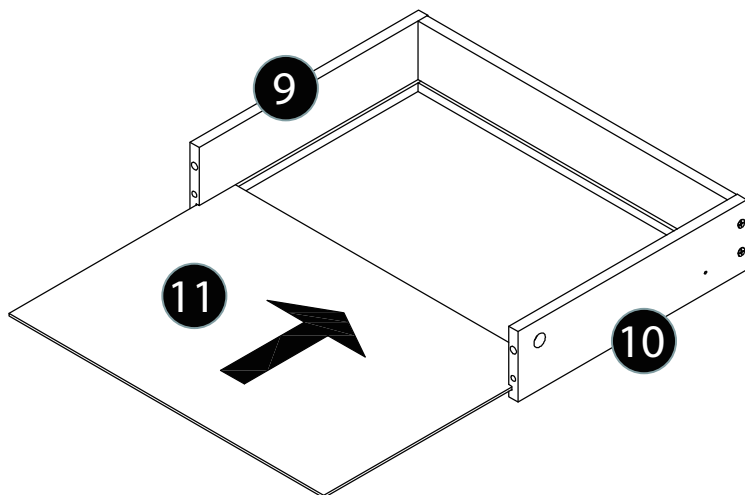

ASSEMBLY INSTRUCTIONS

17

Select 12(×5) and C(×10).
Insert C(×2) into 12(×1).
Repeat for another 12(×4).

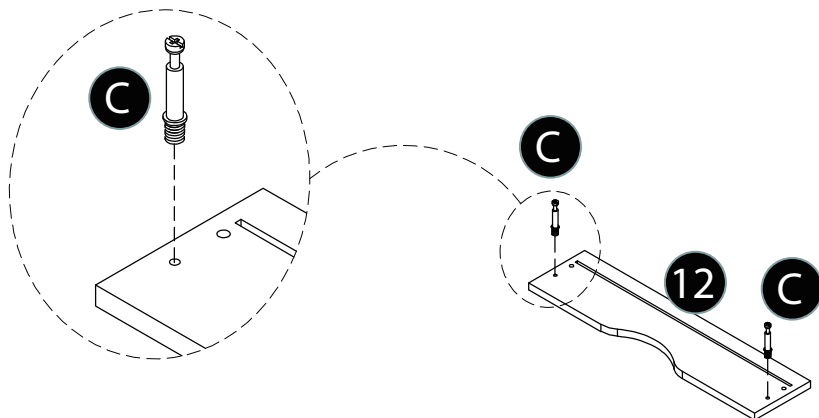

18

Select A(×10), B(×10) and 12(×5).
Insert 12 into 9 and 10 with A(×2),
B(×2) and C(×2). Repeat for another
12(×4).

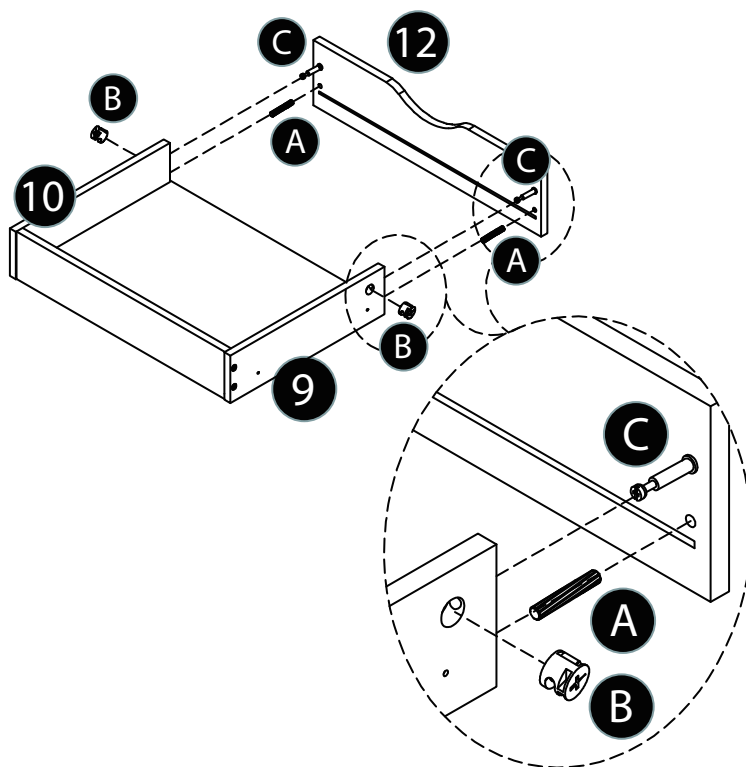

ASSEMBLY INSTRUCTIONS

19

Select F(×20) and Drawer Slide Inner (×10). Attach Drawer Slide Inner(×5) to 9(×5) with F(×10). Repeat for 10(×5).

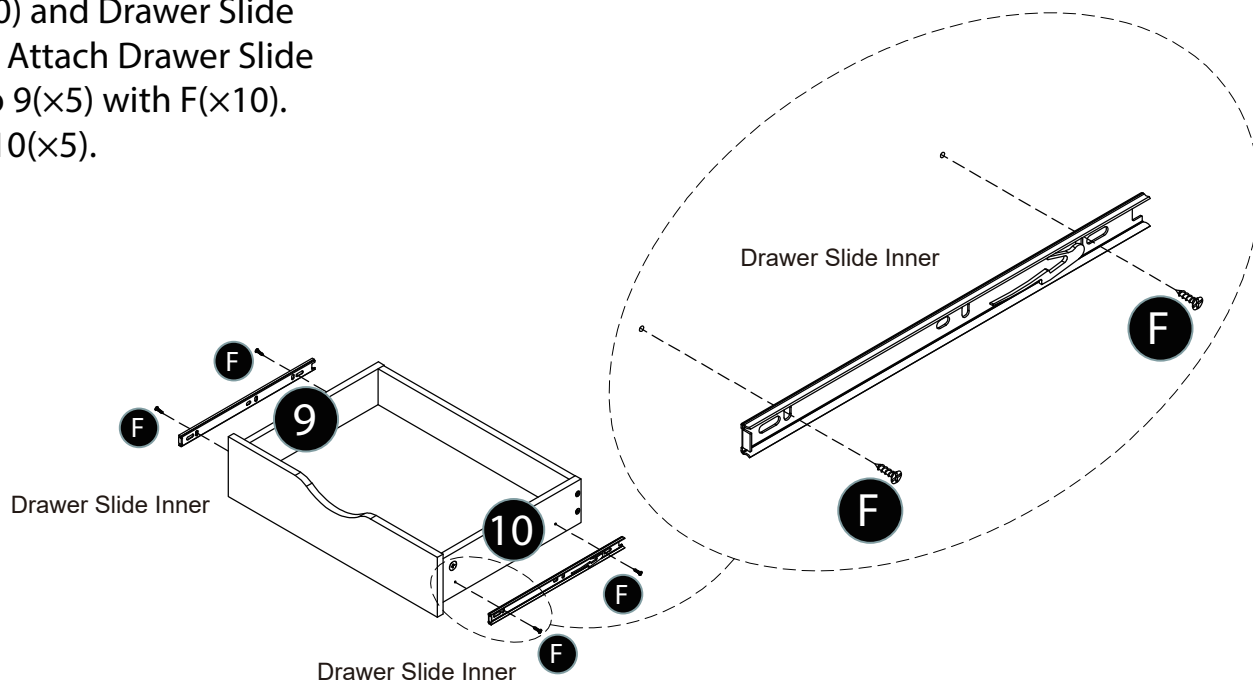

20

Carefully insert drawer box by aligning inner and outer slides and pushing drawer into place until clicks on both sides. Repeat for other drawer boxes. Note: it may be easier to insert inner to outer by fully extending drawer slide out.

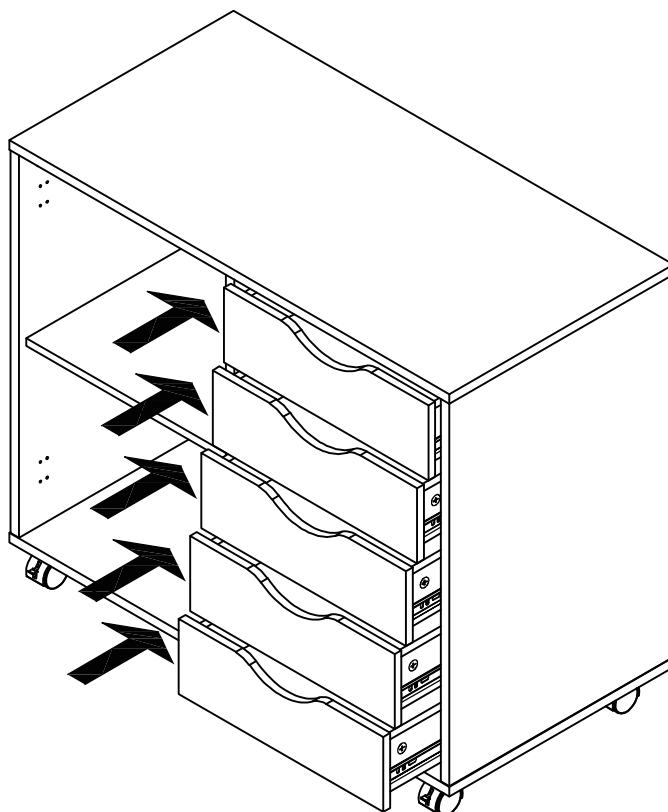

ASSEMBLY INSTRUCTIONS

21

Select 6(×1),H(×2) and Q(×4).
Insert H(×2) and Q(×4) into 6.

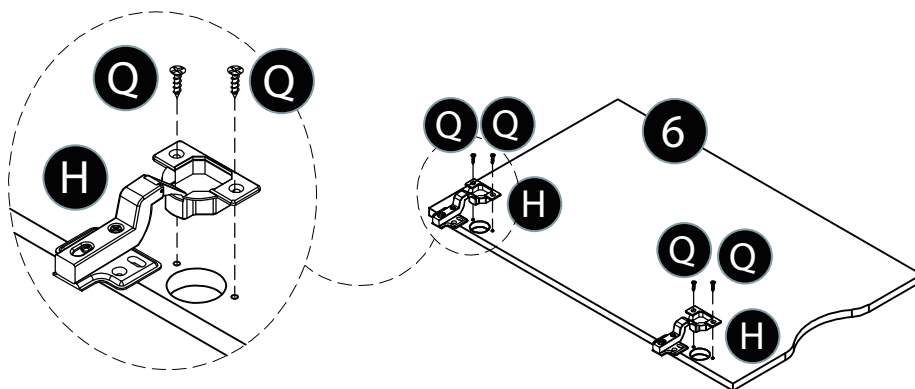

22

Insert H(×1) into Cabinet with
Q(×4).
Repeat for the other H(×1).

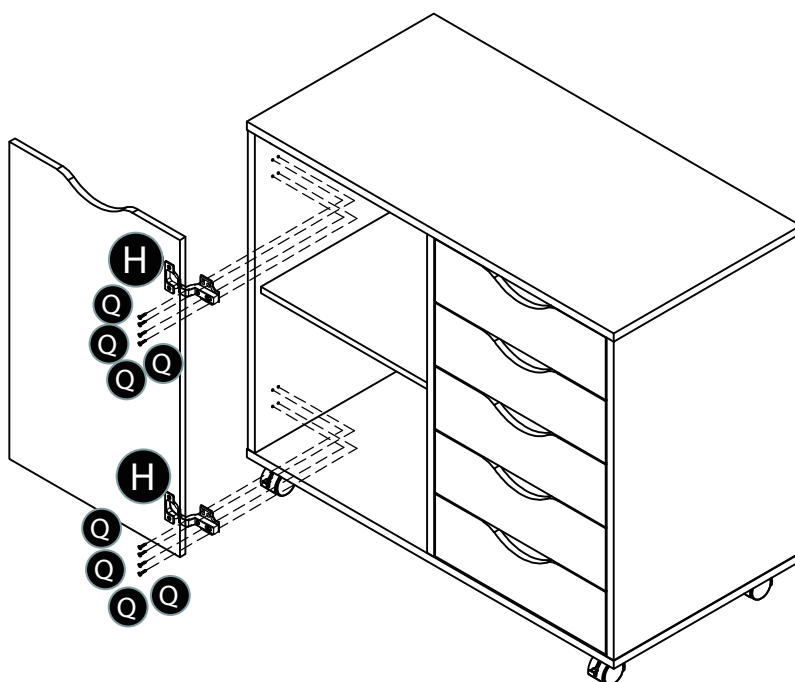
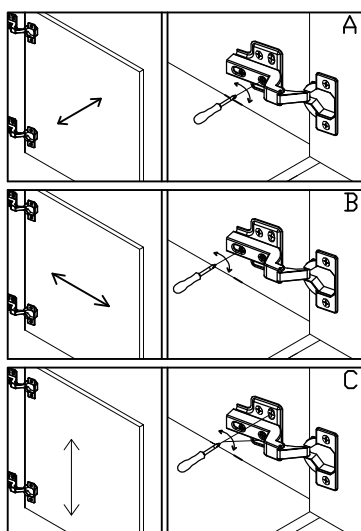

HOW TO REMOVE A DRAWER

If the drawer is installed in a cabinet and the position is incorrect or affects the assembly of other drawers, it needs to be removed and reassembled, as follows

23

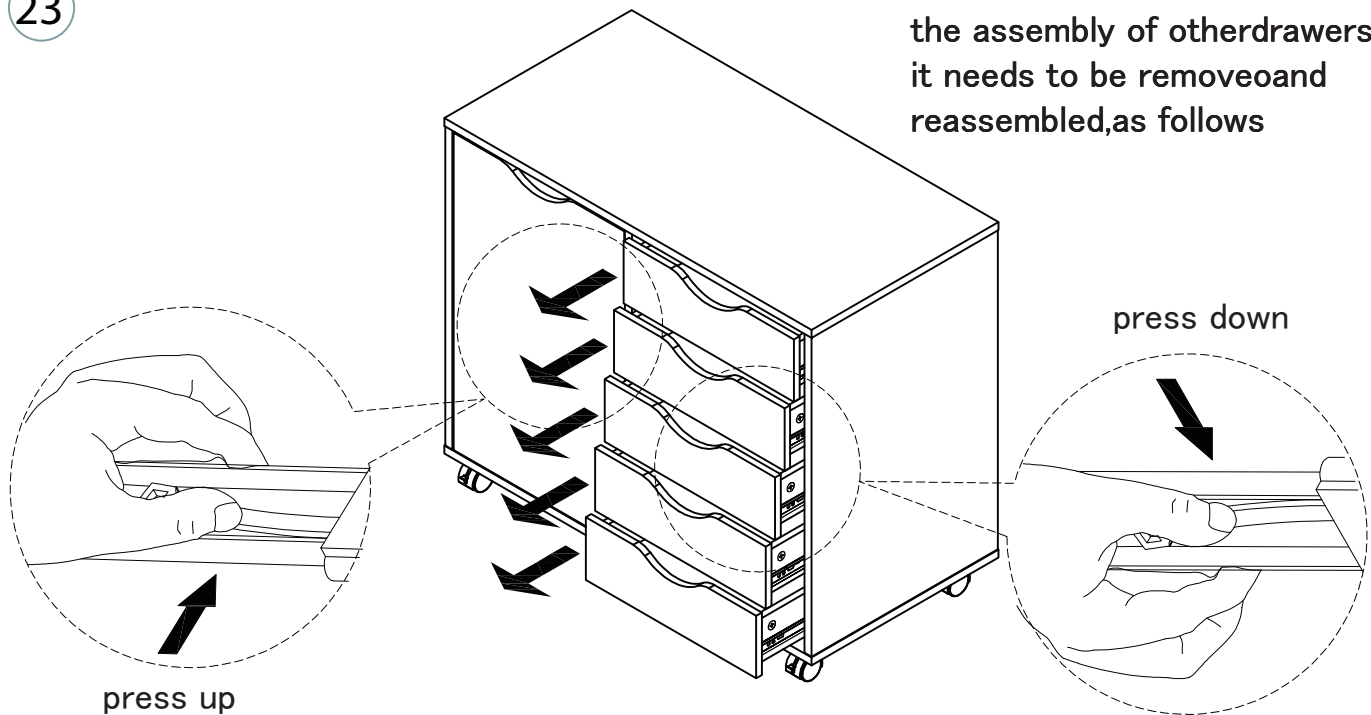

24

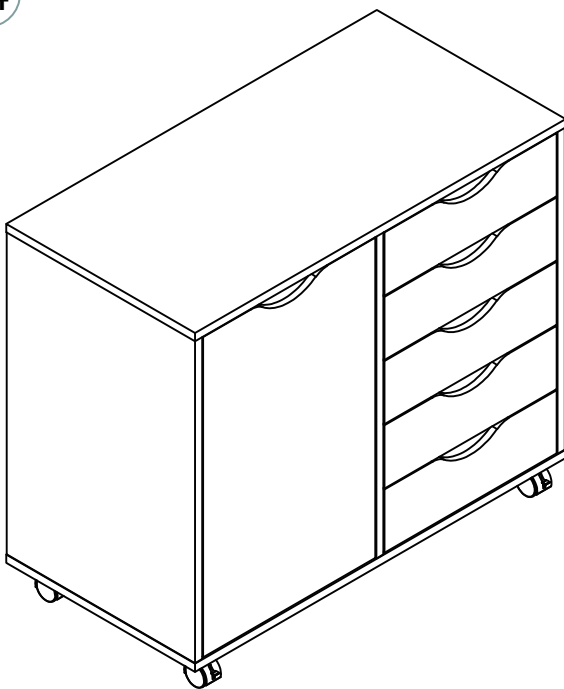

Anti-Tipping Hardware-
Opens one drawer at a time.

ASSEMBLY COMPLETE

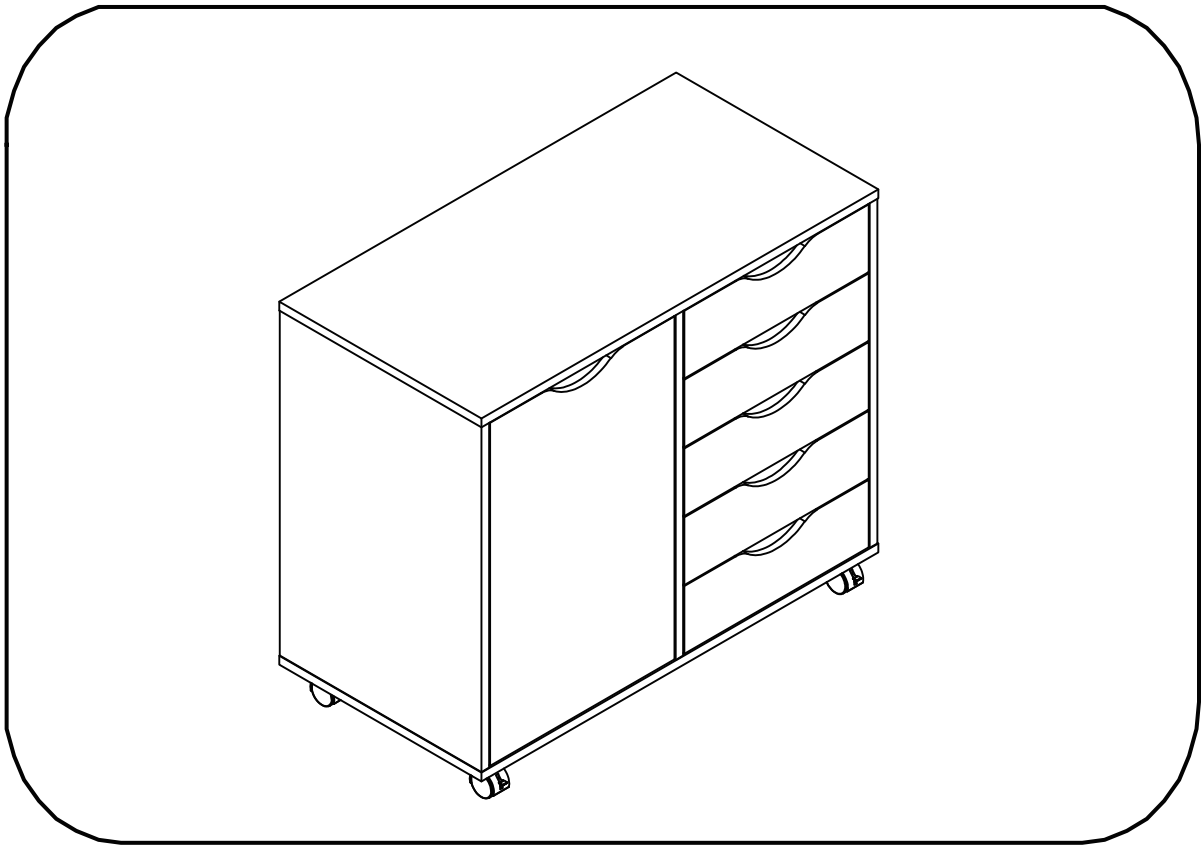

CONGRATULATIONS, YOUR OFFICE CABINET IS COMPLETE!