

Installation Manual

1

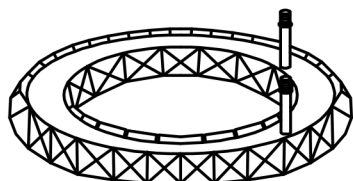

3pcs

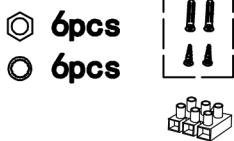

Check whether all accessories showing

2

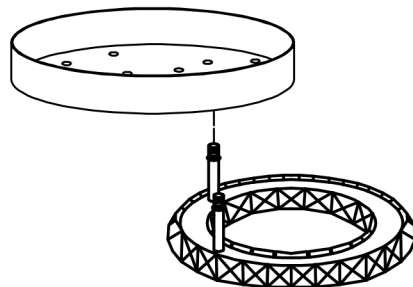

Put the each head fixed on the ceiling plate by screws

3

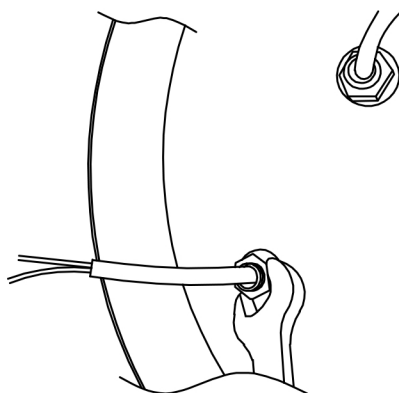

Fix the lamp body with the nut

4

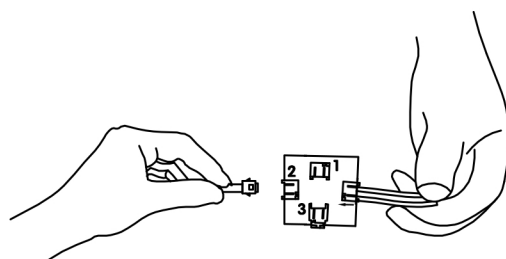

pls plug the 3 ports to the wiring board

5

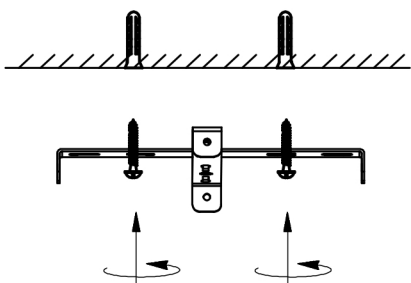

According to the position of the hole on the chassis, use an electric drill to drill the hole on the ceiling, and then install the hanging plate

6

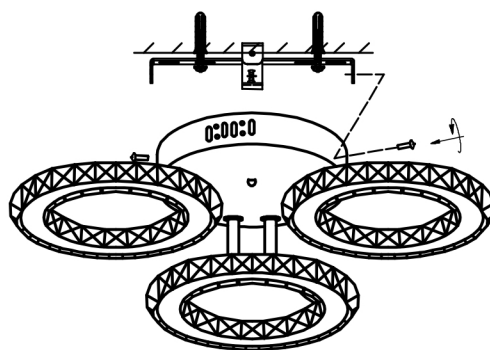

Hanging the lamp on the ceiling

7

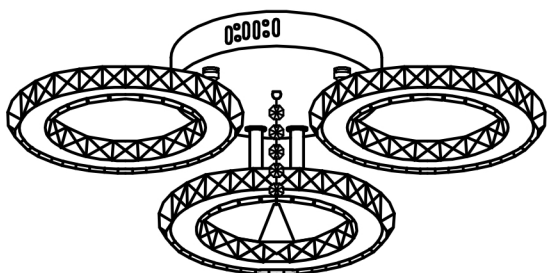

Installation is complete