

OVENTE®

CANISTER VACUUM

ST1600 SERIES



Before use, please read this manual thoroughly and save for future reference.

ovente.com



Intuitive speed settings allow you to regulate how much power and energy you want to use

CANISTER VACUUM
ST1600 SERIES

TABLE OF CONTENTS

IMPORTANT SAFETY	4 - 5
PARTS AND FEATURES	6
USING THE VACUUM	7 - 8
CLEANING THE MOTOR FILTER	9 - 10
ELECTRICAL REQUIREMENTS	10



IMPORTANT SAFEGUARDS

When using your vacuum, basic safety precautions should always be followed, including the following:

READ ALL INSTRUCTIONS

- ❗ Check to ensure your electricity supply corresponds to that shown on the rating plate, which can be found on the base of the vacuum between the wheels. The vacuum must only be used as rated.
- ❗ Do not leave appliance when plugged in. Unplug from electrical outlet when not in use.
- ❗ Do not use outdoors or on wet surfaces or to vacuum water or other liquids — electric shock and personal injury may occur.
- ❗ Do not use with a damaged cord or plug; do not pull or carry by the cord; do not use the cord as a handle; do not close a door on the cord or pull the cord around sharp edges or corners. Do not run the machine over the cord. Keep the cord away from heated surfaces and open flames.
- ❗ Do not unplug by pulling on the cord. To unplug, grasp the plug, not the cord.
- ❗ Do not handle the plug or vacuum with wet hands.
- ❗ Do not use the vacuum without the canister and the filter in place.
- ❗ Do not allow to be used as a toy. Close attention is necessary when used by or near children.
- ❗ Do not allow use to anyone unable to operate the vacuum properly.

- ❗ Use only as described in this manual. Use only with Ovente recommended attachments, accessories, and replacement parts.
- ❗ Keep hair, loose clothing, fingers, and all parts of body away from openings in the vacuum and moving parts such as the floor brush.
- ❗ Do not use without filter in place.
- ❗ Ensure that the cord is fully extended.
- ❗ Do not use the vacuum to pick up sharp hard objects, small toys, pins, paper clips, etc. They may cause damage to the vacuum.
- ❗ The use of an extension cord is not recommended.
- ❗ Store the vacuum indoors. Put the vacuum away after use.
- ❗ Turn off all controls before unplugging.
- ❗ Always make sure the cord stopper is firmly in place before rewinding. Hold plug when rewinding onto cord reel. Do not allow plug to whip when rewinding.
- ❗ Take extra care when cleaning on stairs; always work with the machine at the bottom of The stairs. Keep vacuum on the floor. Do not put on chairs, tables, etc.
- ❗ Do not pick up anything that is burning or smoking, such as cigarettes, matches, or hot ashes.

- ❗ Do not use to pick up flammable or combustible liquids, such as gasoline, or use in areas where they may be present.
- ❗ Ensure that the power cable never becomes wet or moist during operation.
- ❗ Never submerge the appliance or the power cable in water, and do not clean these components under running water.
- ❗ Do not put any objects into openings in the vacuum. Do not use with any opening blocked; keep free of dust, lint, hair, or anything that may reduce air flow.

❗ CAUTION

- Switch off the vacuum cleaner immediately if the air intakes, the floor brushes or the telescopes tube becomes blocked. Before starting the vacuum cleaner up again remove the substance causing the blockage:

- 1 Never use the vacuum cleaner in the immediate vicinity of hot bodies and do not suck up hot objects such as cigarette ends or ashes.



- 2 Only place the plug in the socket when your hands are dry.



- 3 Please remove large or sharp objects from the floor before using the vacuum cleaner to avoid any possible damage to it.



- 4 Do not pull by the mains cable when pulling out the plug.



PARTS AND FEATURES



- 1 | ENERGY SAVING SPEED CONTROL
- 2 | DUST BAG COMPARTMENT
- 3 | AUTOMATIC CABLE REWIND
- 4 | 1.5 METER CRUSH-PROOF HOSE
- 5 | 5 METER POWER CORD
- 6 | TELESCOPIC STAINLESS STEEL WAND
- 7 | THREE-STAGE FILTRATION: DUST BAG, OUTLET HEPA FILTER AND INLET FILTER
- 8 | 360 DEGREE SWIVEL HOSE

ACCESSORIES

- 9 | STANDARD FLOOR BRUSH
- ALSO INCLUDES**
- 10 | 2 in 1 CREVICE NOZZLE (NOT SHOWN)
- 11 | UPHOLSTERY NOZZLE (NOT SHOWN)



BAGGED VACUUM
WITH ALLERGEN AND
THREE - STAGE FILTRATION SYSTEM



THREE - STAGE FILTRATION
ENSURES CAPTURE OF
SMALL DUST PARTICLES



CORD REWIND
FOR QUICK AND
EASY STORAGE



CRUSH-PROOF HOSE
WITH HANDLE
AIRFLOW CONTROL

ASSEMBLING THE VACUUM

- Fit the hose onto the vacuum cleaner by inserting the rotating hose connection into the vacuum cleaner until you hear a click. To remove the hose, press the button at the side of the hose connection, and then pull it out.



- Fit the telescopic tube into the other end of the hose.



- Adjust the length of the telescopic tube by pushing the locking mechanism down and pulling in the bottom section of the tube to a suitable length. When storing, shorten the tube as far as possible.

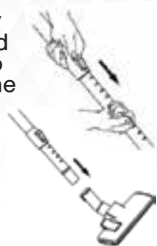

- Fit the floor brush into the telescope tube.

Floor Nozzle

- The floor nozzle has two settings. When cleaning hard surfaces (parquet flooring, flooring tiles, etc.), the nozzle brushes should be extended. When cleaning carpets and mats, the brushes should be retracted into the nozzle. Press the brush change button to switch between the two settings

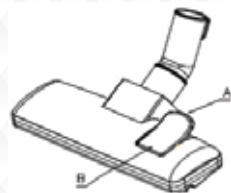

Crevice and Bristle Brush

- For radiators, corners, skirting boards, etc.

Furniture Nozzle

- For furniture, curtains, drapes, etc



Cleaning carpet

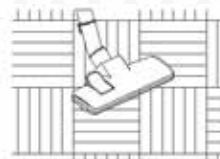

Cleaning wooden floor



USING THE VACUUM

- Before using the vacuum, first roll out a sufficient length of the electric flex cable and then plug it into the power outlet.



- 2 The yellow mark on the electric cable is its maximum length — this must not be exceeded.

- 3 To switch on the device, press the foot pedal button on the casing with your foot.

- 4 To rewind the power cable, press the button with one hand and guide the cable with the other hand to ensure that it does not whip, causing damage.

Caution:
Never operate the vacuum cleaner without the dust bag or motor filter, otherwise the device could be damaged.



CHANGING THE DUST BAG

- If the vacuum's suction is reduced, this may be because the bag needs changing. Raise the floor nozzle off the floor, set the suction force regulation to MAX, switch on vacuum cleaner using the on/off button, and keep an eye on the bag change indicator. If it is red, the bag must be changed.

- 1 Turn off and unplug cleaner.

- 2 Remove the hose, open bag cover by pushing latch up with fingers and lifting bag cover.

- 3 Grasp the millboard at the top of the dust bag and carefully.

- 4 Throw the bag in the bin. Make sure that there are no holes in it.

- 5 Insert a new dust bag in the vacuum cleaner. The vacuum cleaner must never be used without a dust bag.

- 6 Close the vacuum cleaner again.

- 7 Always replace the bag after sweeping up large quantities of fine material such as fine sand, cement, flour, etc.

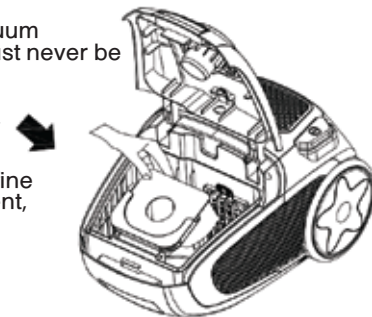
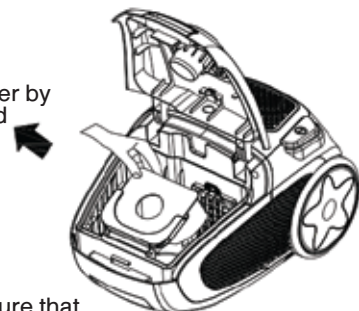



CLEANING THE MOTOR FILTER

- The motor filter can be found in the dust bag container. It protects the motor from dust and should be cleaned at least twice a year, when it is dirty, or if suction force is reduced.

1 Pull the filter holder up out of the vacuum cleaner.

2 Open the filter holder, and remove the filter.

3 Rinse the filter in tepid water, and allow it to dry completely. Do not use a hair dryer or similar to dry the filter

4 Return the filter to the holder, and replace the filter holder in the vacuum cleaner.

! **IMPORTANT!** Never use the vacuum cleaner without a motor filter.

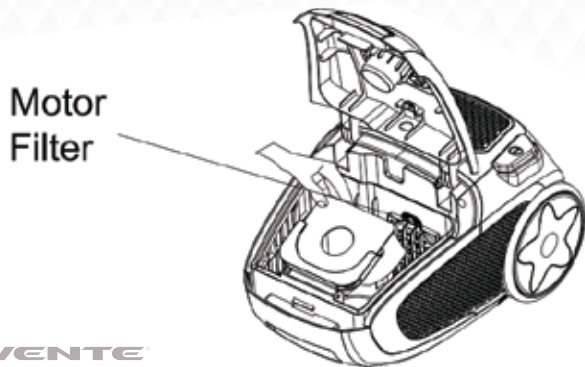

CLEANING THE EXHAUST AIR FILTER

- The exhaust air filter cleans the air one final time before it leaves the exhaust sponge filter of the vacuum cleaner. You can clean the exhaust air filter as follows:

1 Switch off the vacuum cleaner and disconnect the plug from the power outlet. To do this, always pull on the plug and not on the cable.

2 Remove the dust container.

3 Open the exhaust sponge cover.

4 Rinse the sponge filter under cold running water and allow to dry.

5 Put the exhaust air filter back into place.

6 Close the exhaust sponge cover.

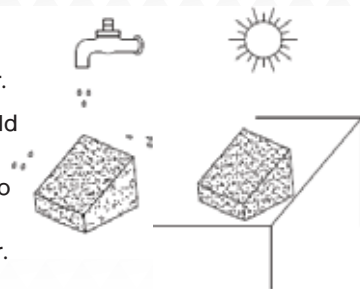

TRANSPORT AND STORAGE

- You can lift and carry the vacuum cleaner using the carrying handle. Never pull or lift the vacuum cleaner by the cord.

- Before putting the vacuum away, **ALWAYS** make sure the cord stopper is set firmly in place, or else the plug will go inside the vacuum. Switch off the socket, unplug, and press the cord rewind button until the cord is fully rewound.

- To save space, the vacuum can be stored upright on its end. The telescopic tube can be hung on the vacuum cleaner by inserting the parking fixture into the vertical parking holder.

VACUUM MAINTENANCE

- Unplug the vacuum cleaner from the power outlet.
- Clean the vacuum cleaner body by wiping it with a slightly damp cloth.
- Do NOT use any form of strong solvent or abrasive cleaning agent.
- Wait until it dries completely before next use.

Never wash the appliance or power cord; the housing may be cleaned by means of a slightly dampened cloth only.

Environmental tips

Once any electronic product is no longer functional, it should be disposed of in such a way as to cause minimum environmental impact, in accordance with the regulations of your local authority. In most cases you can take such products to your local recycling station.



ELECTRICAL REQUIREMENTS

Voltage: 120V

Power: 1400W

Hertz: 60Hz



OVENTE WARRANTY

Register your product within **30** days of purchase to activate its one-year limited manufacturer's warrant at
ovente.com/register

NOTE: WARRANTY IS ONLY VALID IF YOU REGISTERED WITHIN 30 DAYS AFTER PURCHASE.

LIMITED ONE (1) YEAR WARRANTY:

Your product has a one (1) year warranty period from the date of purchase from an authorized retailer. In the event that the product is defective, feel free to contact us to arrange for a replacement. This warranty only covers defects in workmanship and materials. The warranty does not include damage due to abuse or misuse, any commercial use or accidents.

LIMITATIONS

The warranty stated above is the only warranty applicable to this product. Other expressed or implied warranties are hereby disclaimed. No verbal or written information given by the Manufacturer, its agents or employees shall create a guarantee or in any way increase the scope and duration of this warranty. Repair or replacement as provided under this warranty is the exclusive remedy of the consumer. The manufacturer shall not be liable for incidental or consequential damages resulting from the use of this product. Any implied warranty of merchantability or fitness for a particular purpose on this product is limited to the applicable warranty period set forth above except to the extent prohibited by law. Consumer rights may vary from state to state.

Customer Support: ovente.com/support
Visit us at ovente.com

OVENTE®

Defining Housewares