

# SNAP ON PET SOFA

## NO TOOLS OR SCREWS REQUIRED

MODEL: JCW08

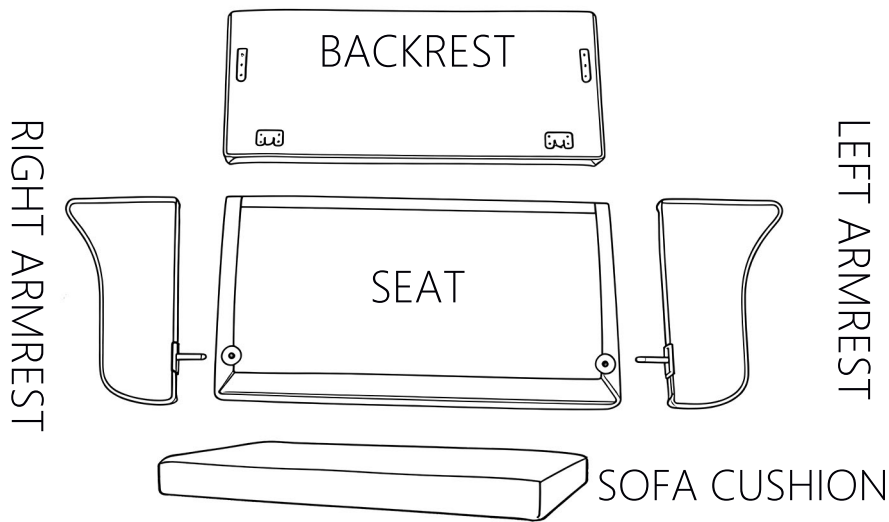

### PARTS LIST:

- 1×BACKREST
- 1×SEAT
- 1×LEFT ARMREST
- 1×RIGHT ARMREST
- 1×SOFA CUSHION
- 4 ×SOFA LEGS

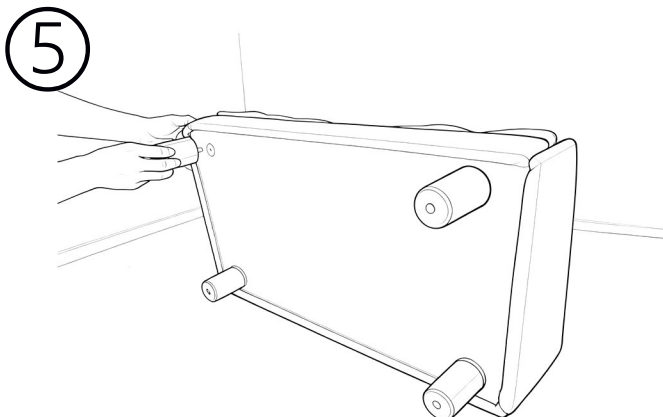
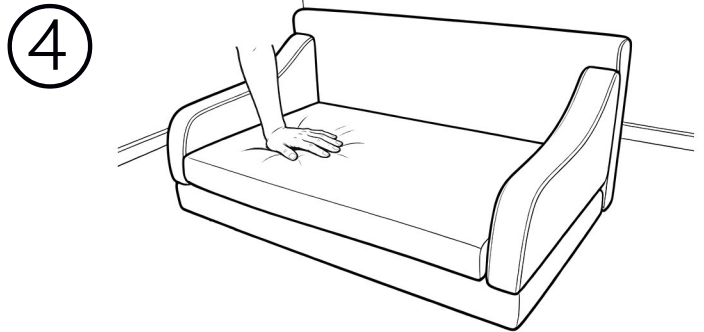
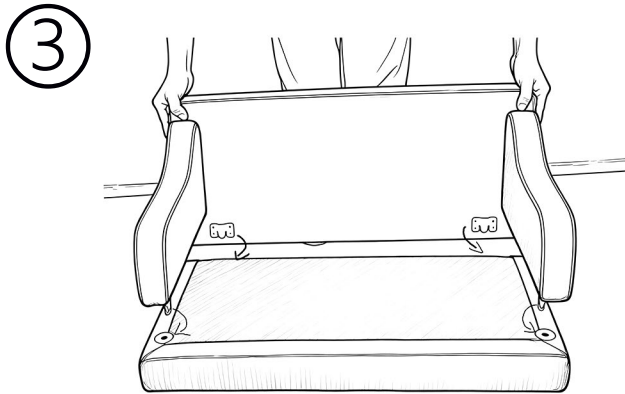
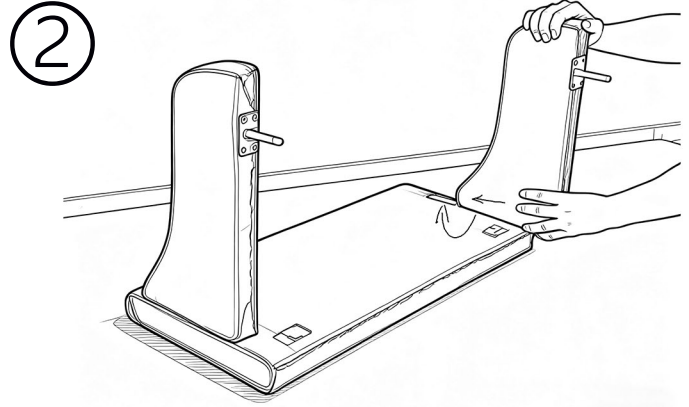
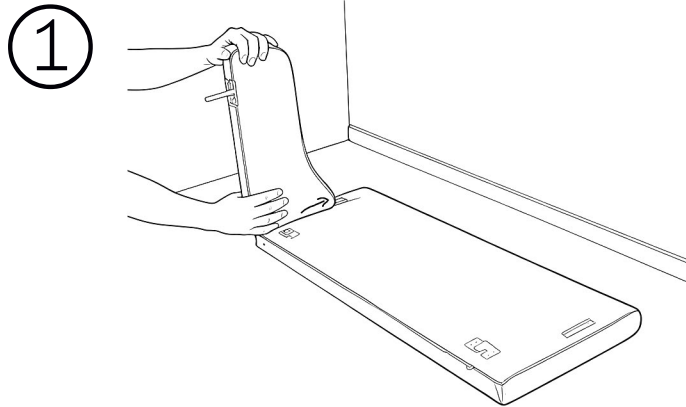

### Assembly Instructions for Snap On Pet Sofa

#### 1. Prepare the Seat Component

Lay the seat part flat on a clean surface.

#### 2. Attach the Armrests

Snap the left armrest and right armrest onto the corresponding sides of the seat. Ensure they fit securely into place.

#### 3. Install the Backrest

Align the backrest with the top of the seat and armrests assembly, then snap it into position.

#### 4. Sofa cushion installation

Place the sofa cushion on the sofa and press it lightly with your hand

#### 5. Add the Sofa Legs

Fix the four sofa legs at the four bottom corners of the seat. Align the screw mouth and rotate clockwise until it is completely fixed.

#### 6. Final Check

Ensure all parts are properly snapped together and the sofa is stable. Now your pet can enjoy their new sofa!

A video tutorial is also available on the product webpage for further guidance.