

English / Español / Français

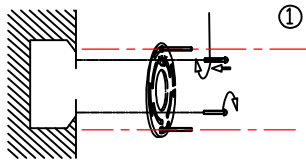

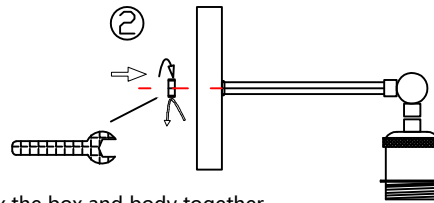

Install the bracket on top of the box



Fix the box and body together

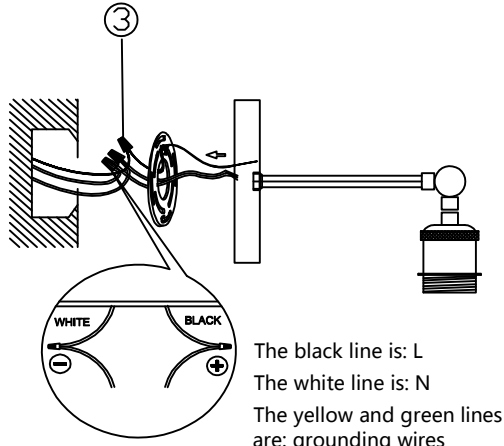

The black line is: L  
The white line is: N  
The yellow and green lines are: grounding wires

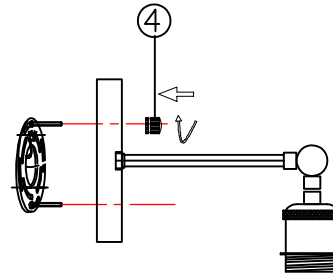

Fix the bracket screws and align them with the two holes in the box, and install the striped nuts

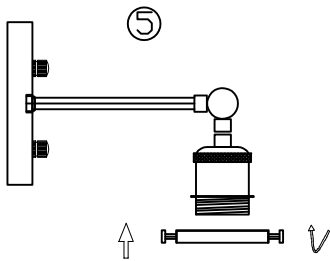

Install decorative flat cover

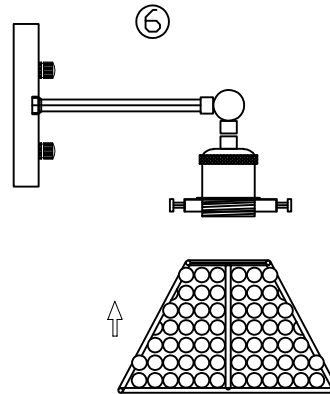

Install the lampshade

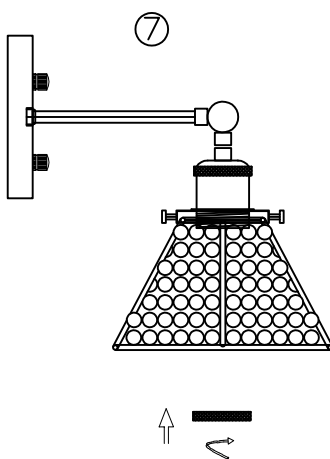

Install the lamp cap ring

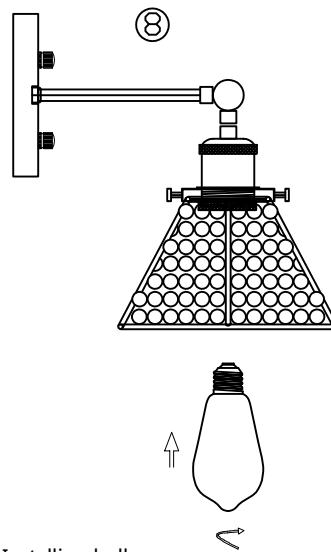

Installing bulb

TECHNICAL INFORMATION

Nominal voltage	light
AC:110-120V	1*E26 MAX.40W (Not included)

