

ASSEMBLY INSTRUCTIONS

SUNSET BED (KING)

NO	PART LIST	QUANTITY
1	HEADBOARD	1
2	FOOTBOARD	1
3	HEADBOARD LEG	2
4	FOOTBOARD LEG	2
5	HEADBOARD LEG PILLAR	2
6	BED SLATS (2 SETS)	12
7	SIDE RAIL (A)	2
8	SIDE RAIL (B)	2
9	SIDE RAIL SUPPORT	4
10	CENTER RAIL	4
11	CENTER RAIL SUPPORT	8
12	SIDE RAIL SUPPORT LEG	2
13	WINGS HEADBOARD	2
14	WINGS FOOTBOARD	2

NO	HARDWARE LIST	QUANTITY
A	CSK M4 x 16mm	16
B	CSK M4 x 32mm	8
C	JCBB M8 x 20mm	8
D	JCBC M6 x 30mm	18
E	JCBC M6 x 35mm	12
F	JCBC M6 x 50mm	12
G	FLAT WASHER M6	34
H	ALLEN KEY M4 (LONG)	1
I	ALLEN KEY M5	1
J	PLASTIC WASHER	2
K	ADJUSTABLE (BIG)	8

NOT INCLUDED

Keep dry:

Handle with care:

REMINDER: BED PARTS IS PACKED INSIDE THE HEADBOARD

Important note :

- Place all wooden part on a clean & smooth surface such as rug or carpet to avoid the part from being scratch.
- Please follow the assembly instruction step by step.
- Do not tighten all screw until the Bed is fully set-up.

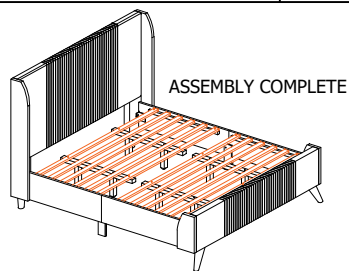

ASSEMBLY COMPLETE

STEP 1 :-

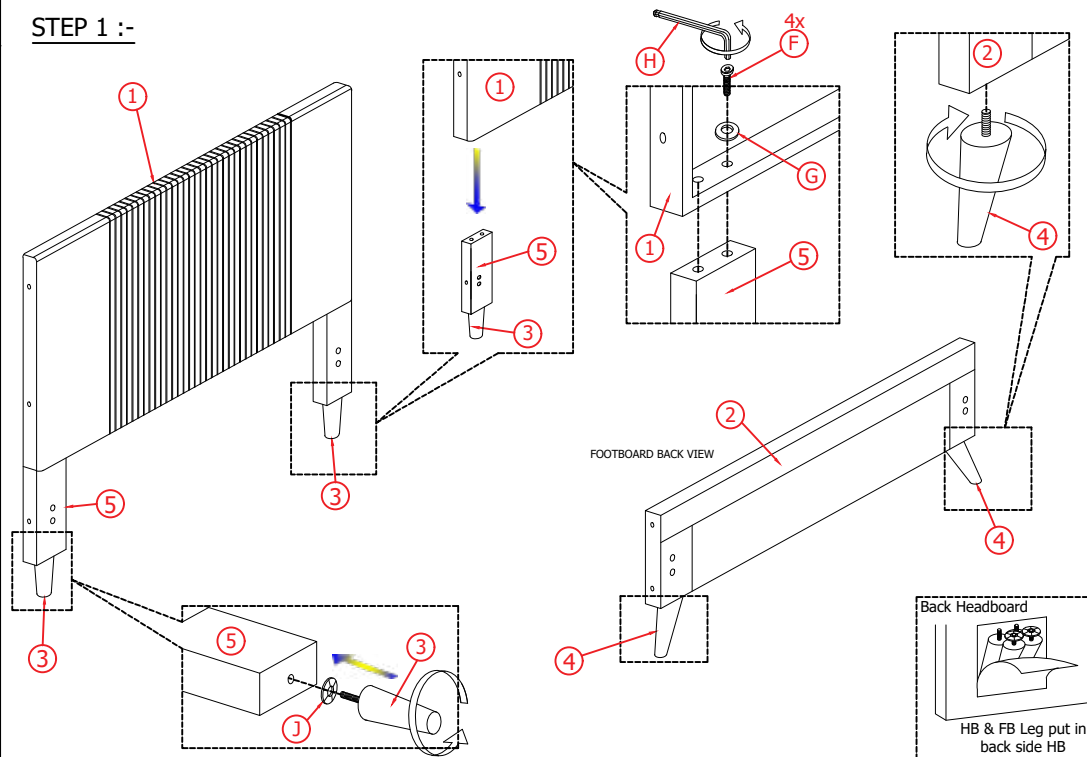

STEP 2 :-

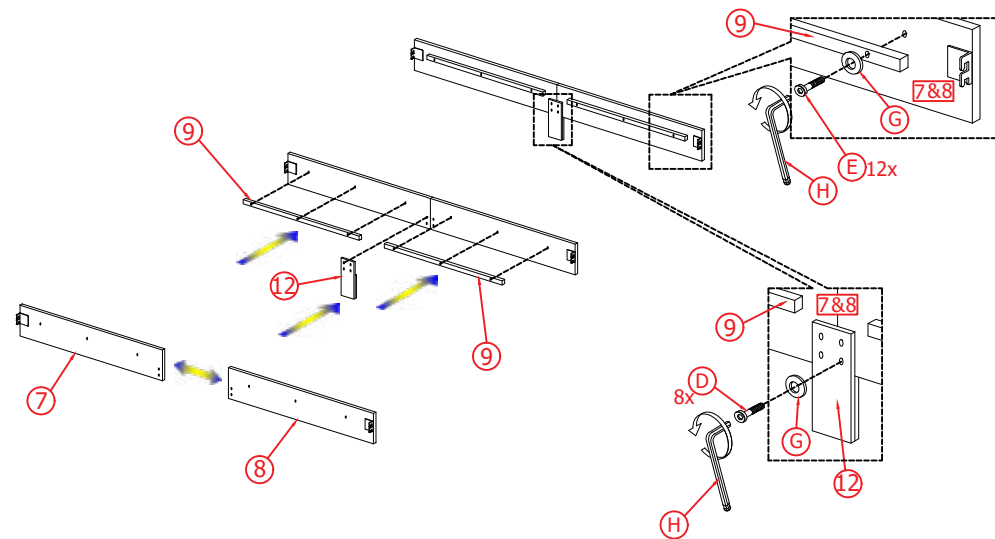

PART LIST

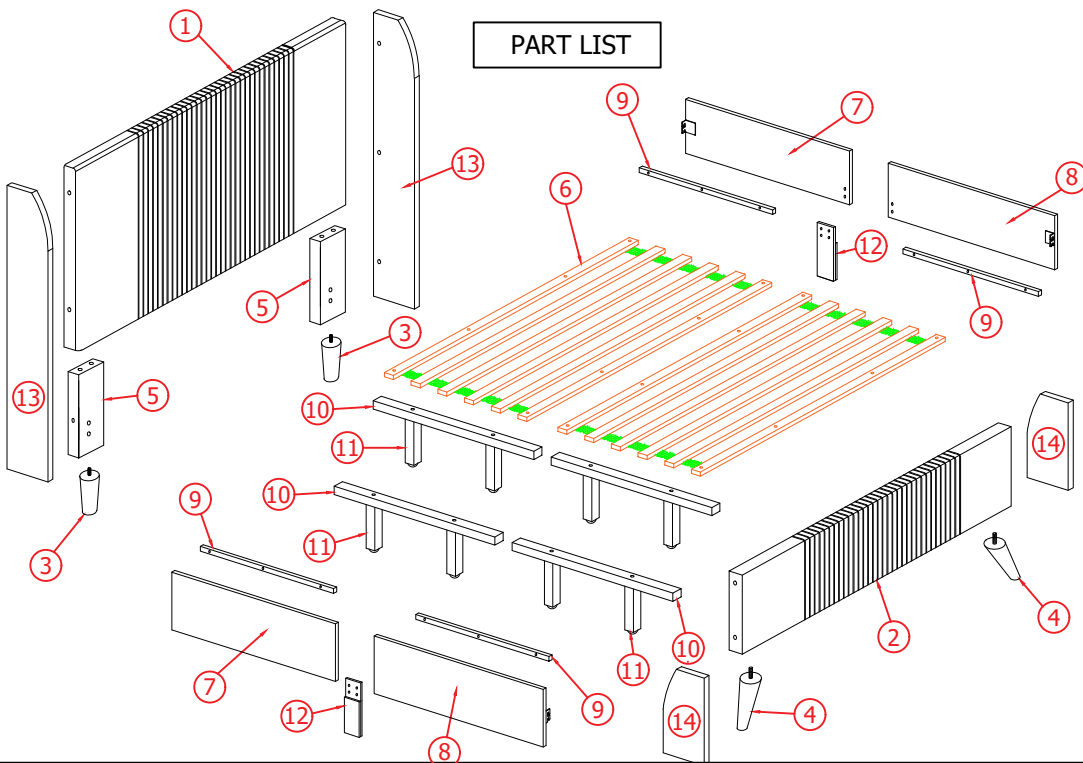

STEP 3 :-

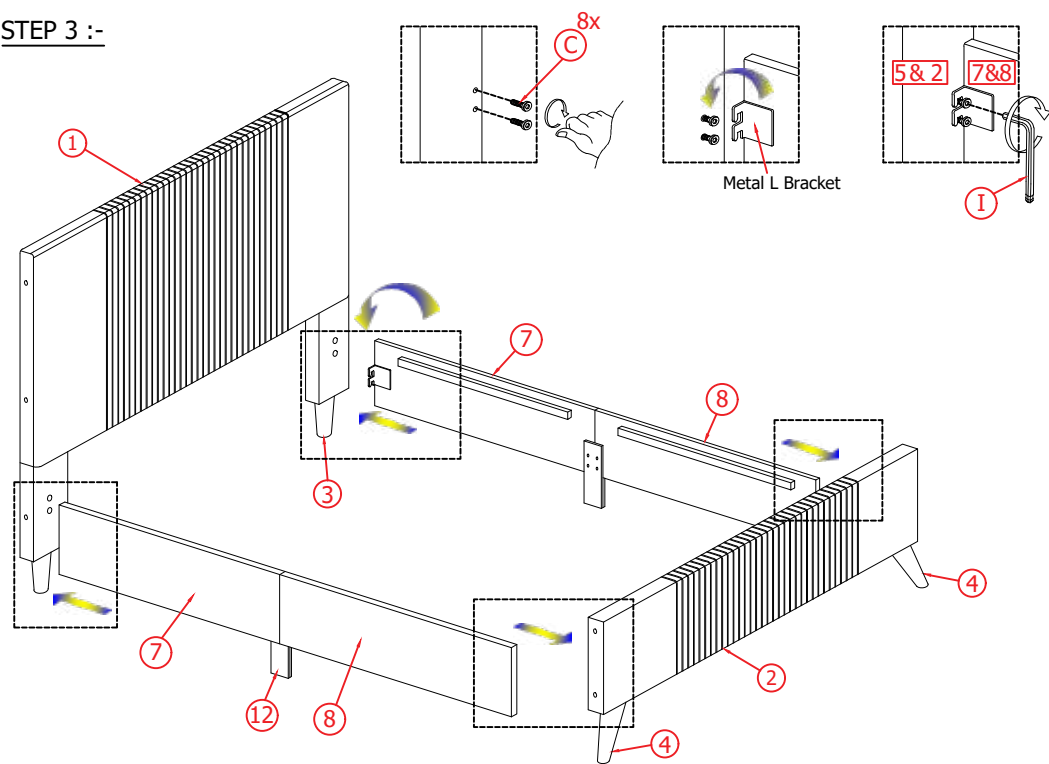

STEP 4 :-

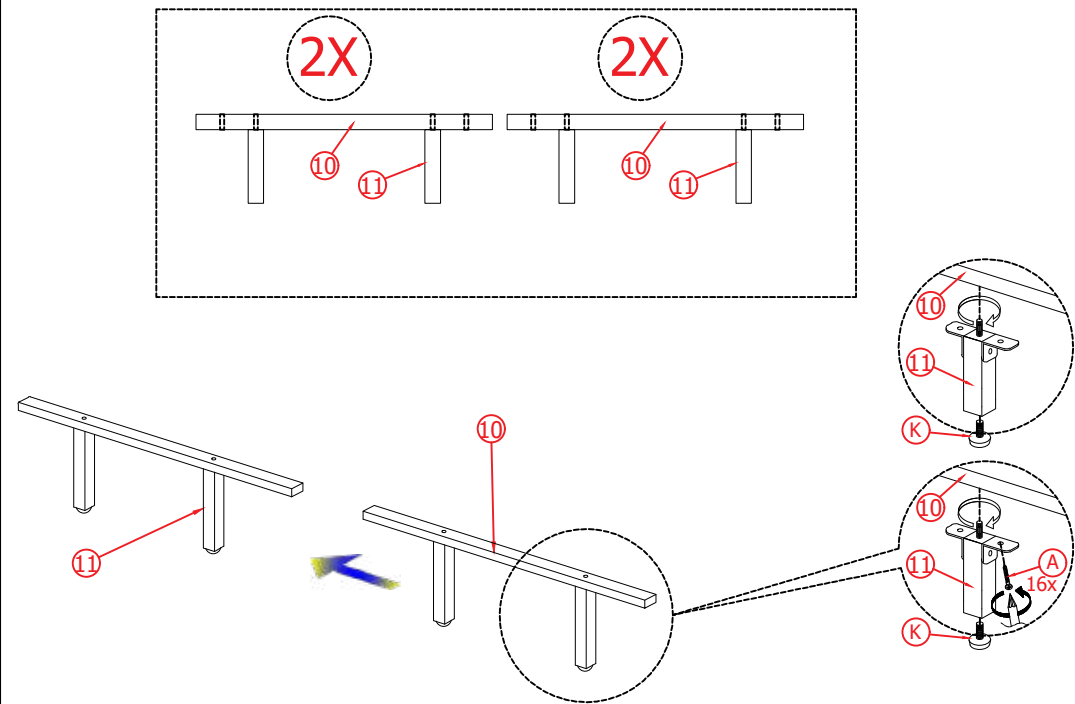

STEP 5 :-

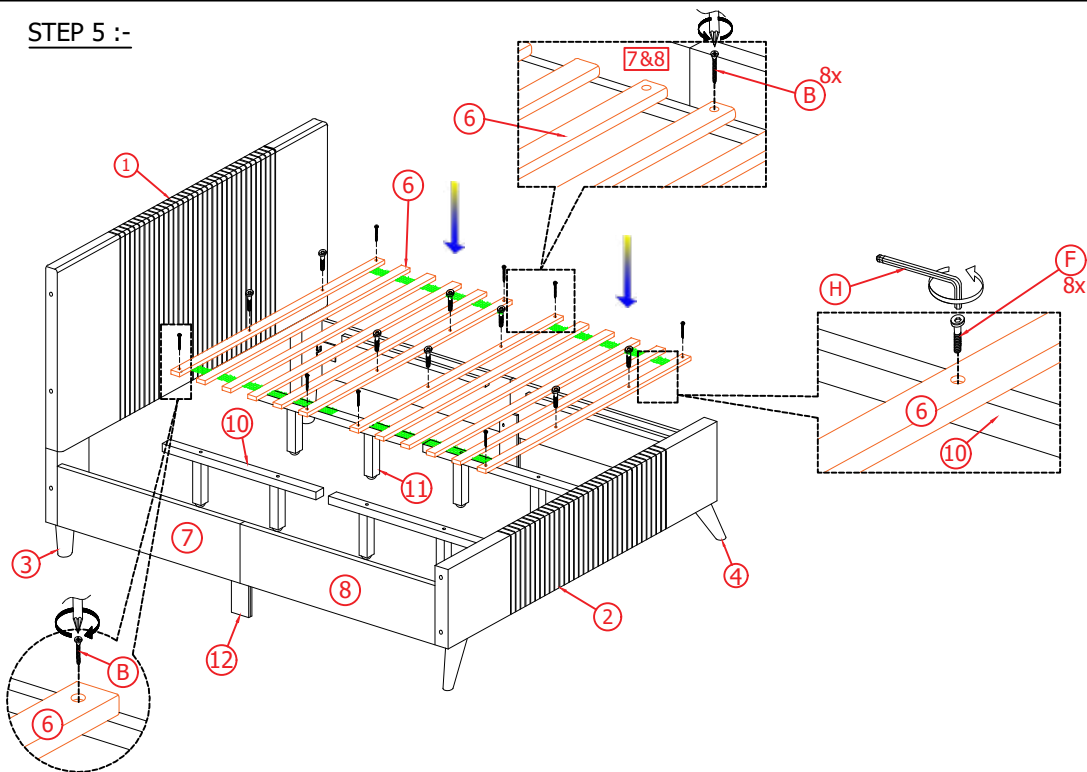

STEP 6 :-

