



Hardware included:



screw
+
anchor



allen
wrench



mounting
bracket



threaded
rod



bolt

1 - Unscrew bolt and remove the threaded rod from the mounting bracket.

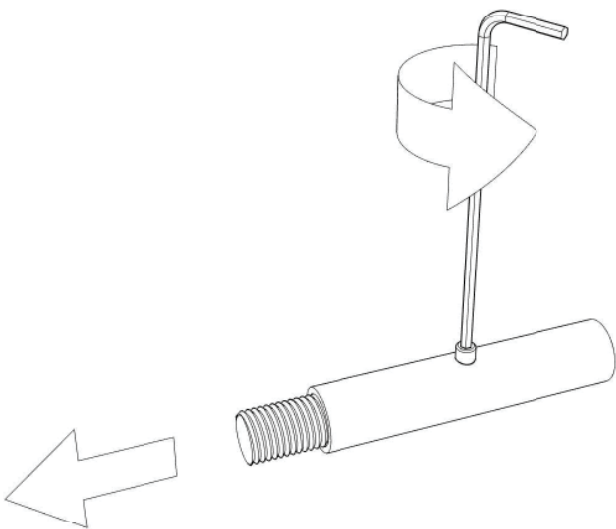

2 - Screw threaded rod into Wall decor. Make sure it's fully tightened.

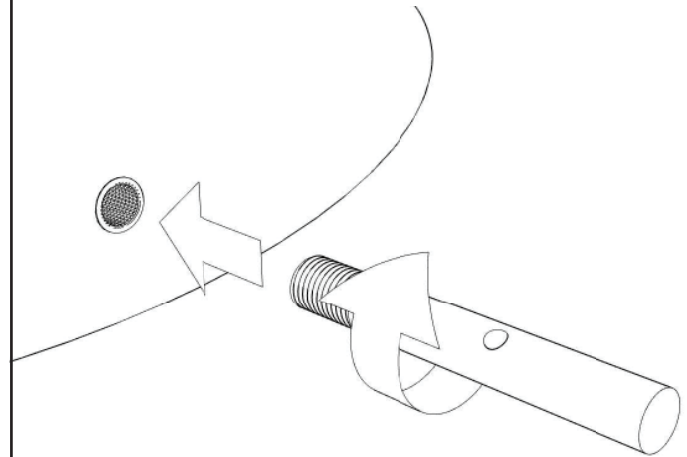

3 - Screw anchor into drywall.

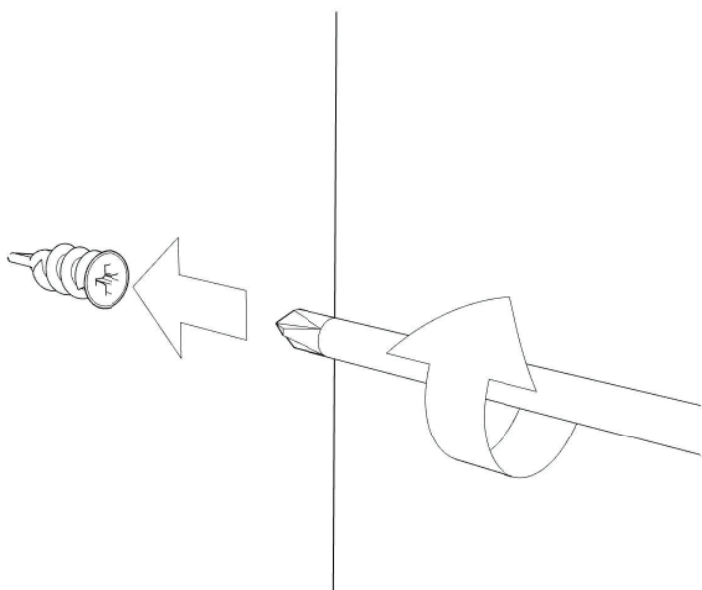

4 - Hold Wall decor against the wall on desired angle and position. **Take note of hole's position.**

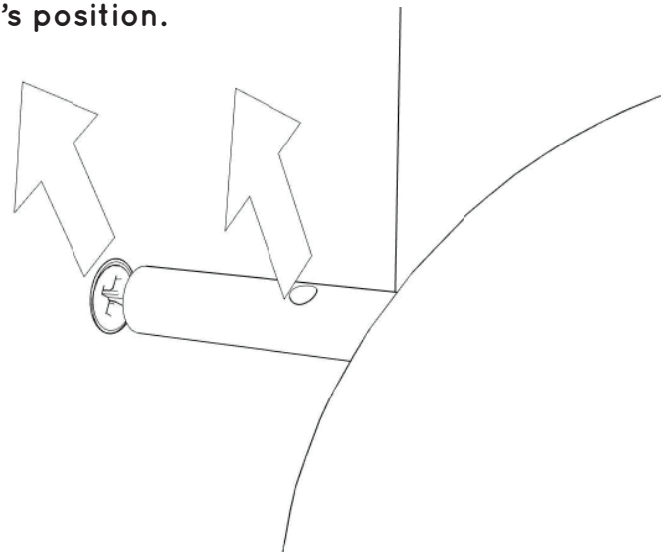

5 - Screw Mounting bracket into Anchor.

Don't fully tighten screw.

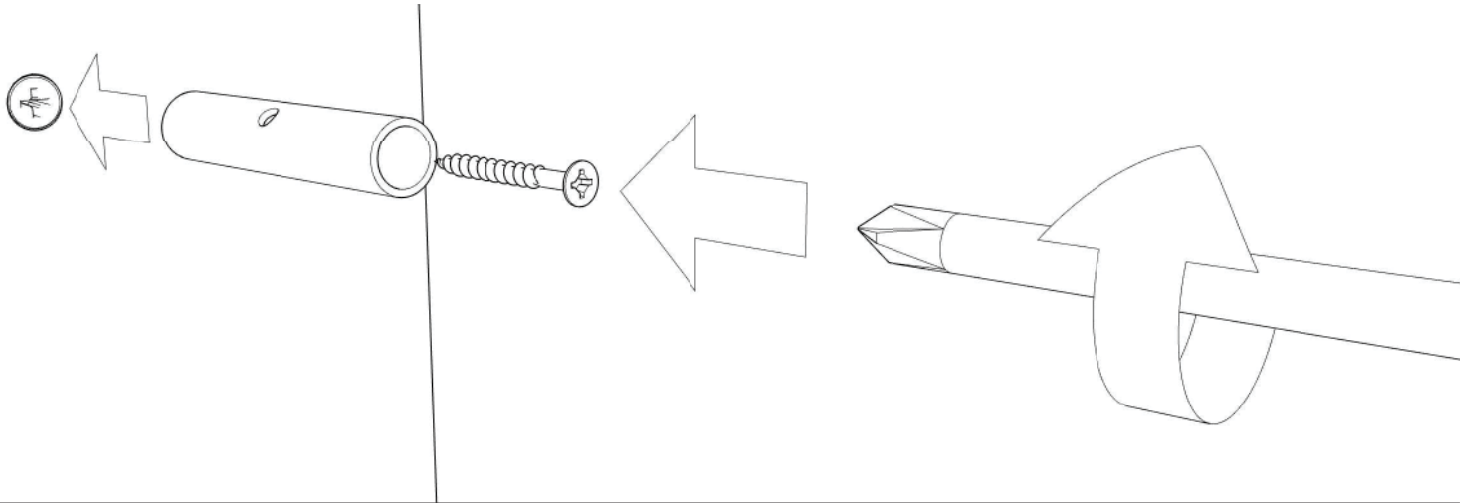

6 - Insert Rod to Mounting bracket, align holes and make sure Wall decor is at desired position noted previously.

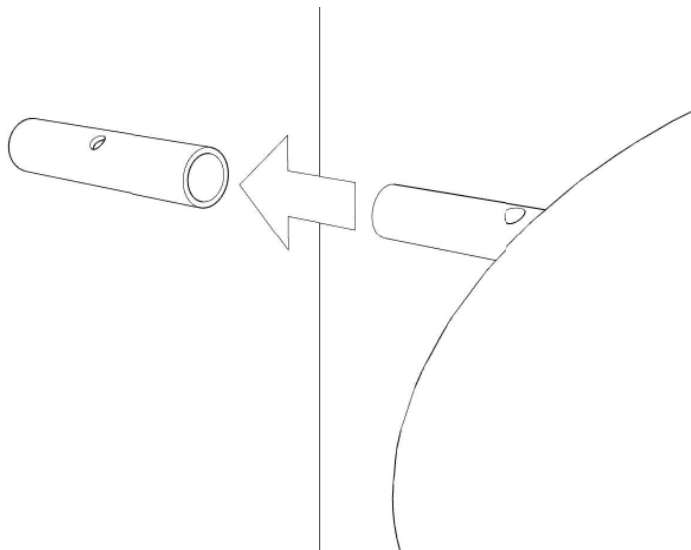

7 - If needed, rotate Mounting bracket along with Wall decor to desired position.

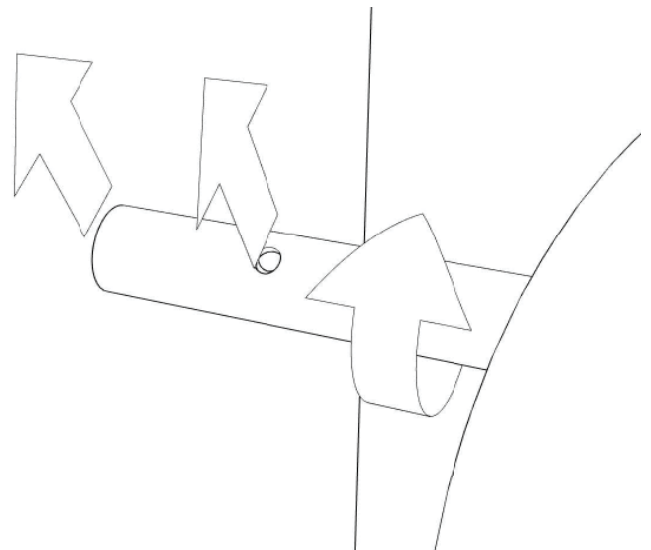

8 - Remove the Wall decor from the Mounting bracket.

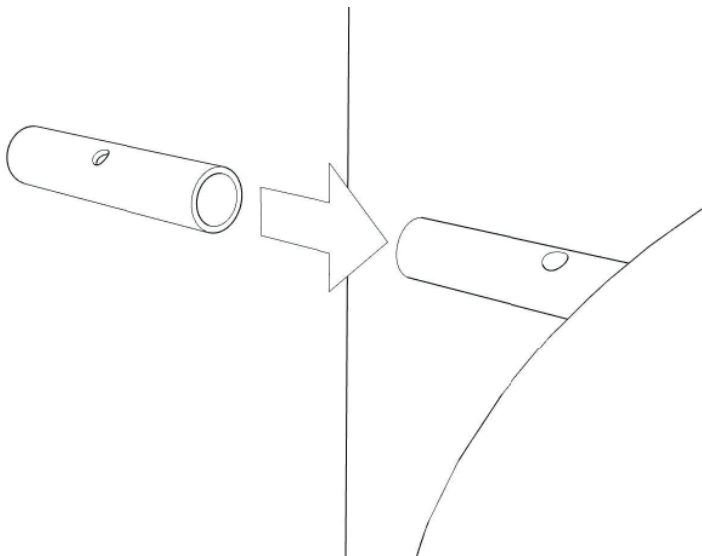

9 - Tighten screw.

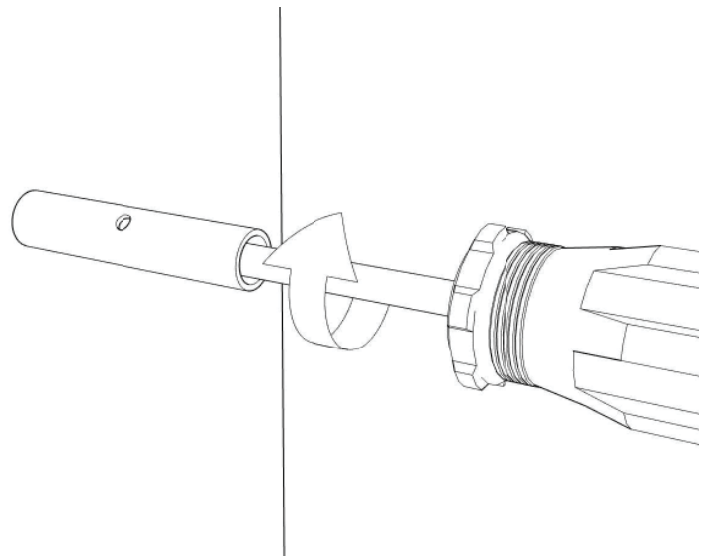

10 - Insert Rod back to Mounting bracket.

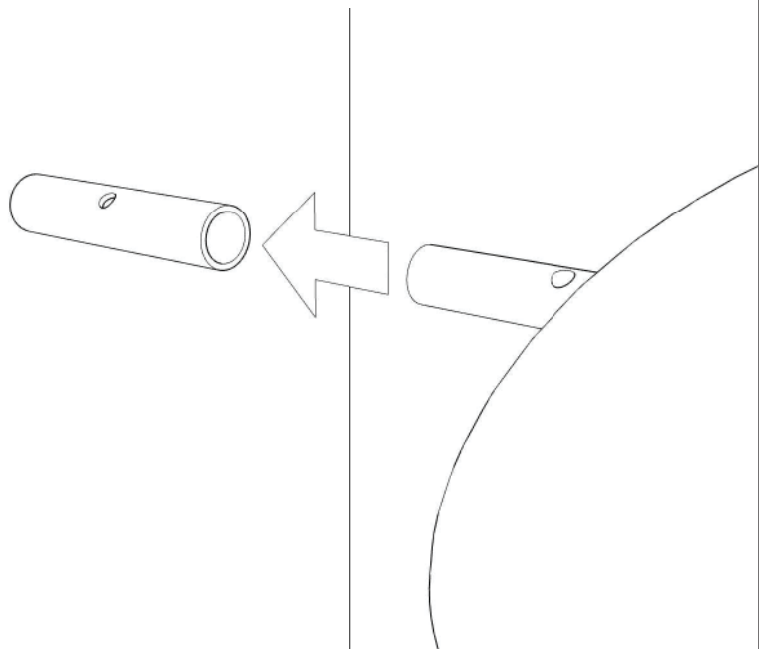

11 - Screw bolt fully tighten.

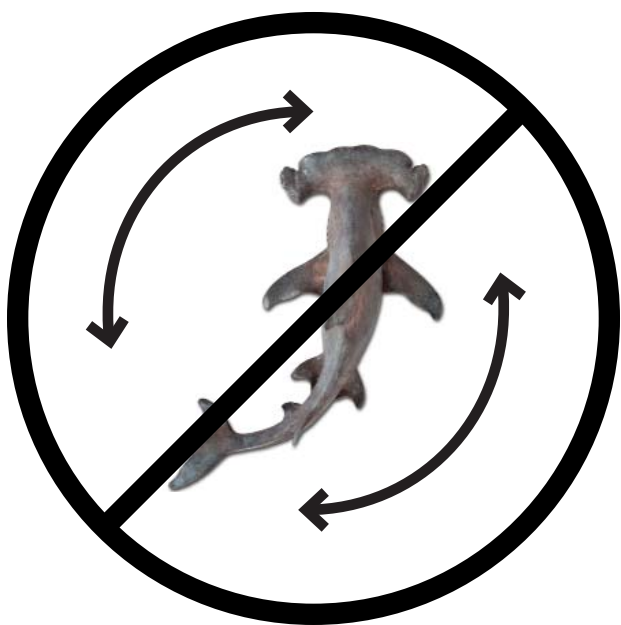
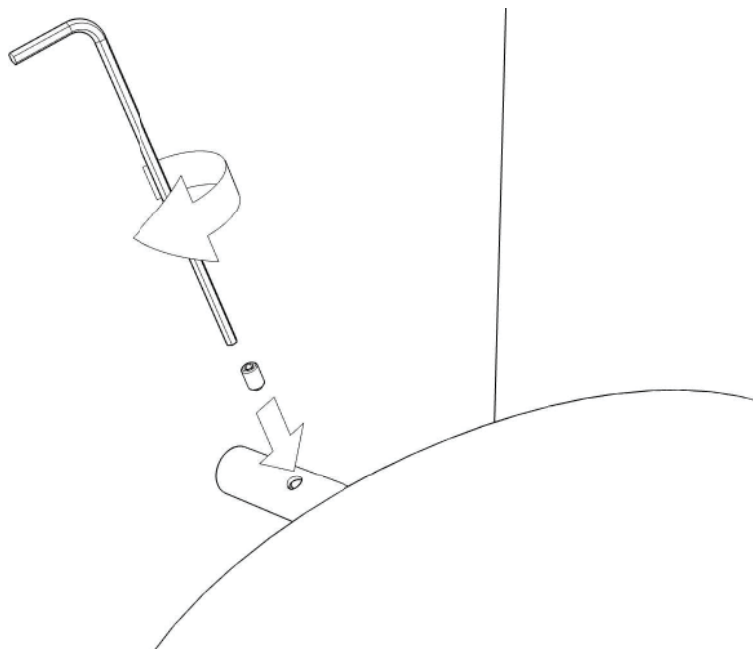

ATTENTION

Do NOT try to adjust the Wall Art's angle or position after finished installing.

If needed please remove the Wall decor from the Mounting bracket and repeat steps **6 to 11**.