

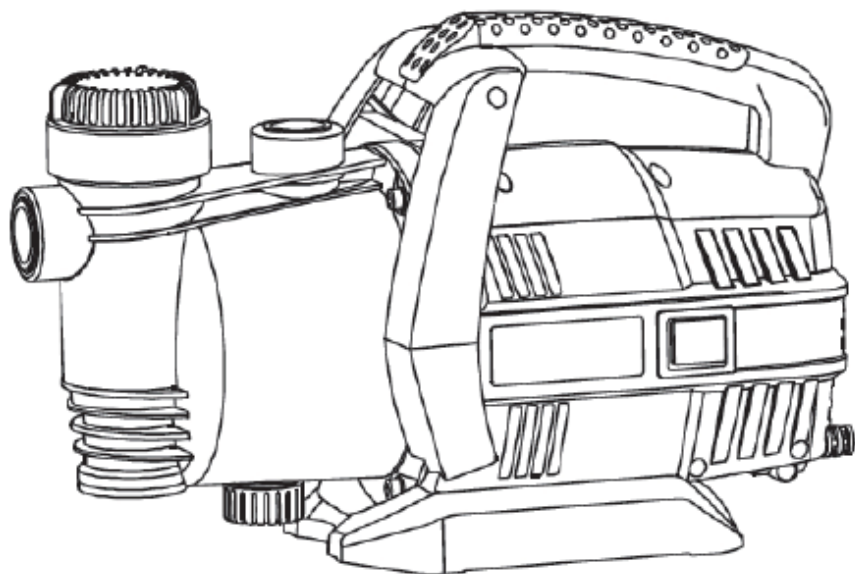

1HP GARDEN PUMP

ITEM # 71002



OWNER'S MANUAL AND SAFETY INSTRUCTIONS

SAVE THIS MANUAL. KEEP THIS MANUAL FOR SAFETY WARNINGS, PRECAUTIONS, ASSEMBLY, OPERATION, INSPECTION, MAINTENANCE AND CLEANING PROCEDURES. WRITE THE PRODUCT'S SERIAL NUMBER ON THE BACK OF THE MANUAL, OR THE MONTH AND YEAR OF PURCHASE IF PRODUCT HAS NO SERIAL NUMBER

FOR QUESTIONS, PLEASE CALL CUSTOMER SERVICE: 909.628.0880

Before you begin...

Intended use

When used for its intended purpose, this device corresponds to the state of the art, as well as to the current safety requirements at the time of its introduction.

The semi-stationary form of the device is designed for conveying clean water in the house and garden area: for sprinkling and watering, as a fountain, rain and industrial water pump or for pumping out water from swimming pools, garden ponds and water reservoirs.

The device may only be used within the allowed performance restrictions (► Technical data).

It may not be used to provide drinking water or to convey food items.

Explosive, combustible, or aggressive materials or substances which are hazardous to health and fecal matter may not be conveyed.

The device is not suitable for commercial or industrial use.

Any other type of use is inappropriate. Improper use or modifications to the device or the use of components that are not tested and approved by the manufacturer may result in unforeseen damage!

Any use that deviates from its intended use and is not included in these instructions is considered unauthorized use and relieves the manufacturer from his or her legal liability.

What are the meanings of the symbols used?

Danger notices and information are clearly marked throughout these instructions for use. The following symbols are used:



Type and source of the danger!

Failure to observe this danger notice may cause physical injury or death.



Type and source of the danger!

This danger notice warns of damage to the machine, the environment or other property.



Note:

this symbol signifies information that may help you reach a better understanding of the processes involved.

For your safety

General safety instructions

- To operate this device safely, the user must have read and understood these instructions for use before using the device for the first time.
- Observe all safety instructions! Failure to do so may cause harm to you and others.
- Retain all instructions for use, and safety instructions for future reference.
- If you sell or pass the device on, you must also hand over these operating instructions.
- The device must only be used when it functions properly. If the device or part of the device is defective, have it repaired by a specialist.

- Never use the device in a room where there is a danger of explosion or in the vicinity of flammable liquids or gases.
- Always ensure that a device which has been switched off cannot be restarted unintentionally.
- Do not use devices with an on/off switch that does not function correctly.
- Keep children away from the device! Keep the device out of the way of children and other unauthorized persons.
- Do not overload the device. Do not use the device for purposes for which it is not intended.
- Exercise caution and only work when in good condition: If you are tired, ill, if you have ingested alcohol, medication or illegal drugs, do not use the device, as you are not in a condition to use it safely.
- This product is not intended to be used by persons (including children) or who are limited in their physical, sensory or mental capacities or who lack experience and/or knowledge of the product unless they are supervised, or have been instructed on how to use the product, by a person responsible for their safety.
- Ensure that children are not able to play with the device.
- Always comply with all applicable domestic and international safety, health, and working regulations.

Electrical safety

- The device may only be connected to a socket that is correctly installed and grounded.
- The fuse must be a residual current circuit-breaker with a measured residual current of no more than 30 mA.
- Make sure that the power supply corresponds with the connection specifications of the device before it is connected.
- The tool may only be used within the specified limitations for voltage and power (see type plate).
- Do not touch the mains plug with wet hands! Always pull out the mains plug at the plug and not by the cable.
- Do not bend, crush, pull or drive over the power cable, protect from sharp edges, oil and heat.
- Do not lift the device using the cable or use the cable for purposes other than intended.
- Check the plug and cable before each use.
- If the power cable is damaged immediately disconnect the plug. Never use the device if the power cable is damaged.
- If the device is not in use make sure the plug is pulled out.
- Make sure that the device is switched off before plugging in the mains cable.
- Make sure that the device is switched off before unplugging it.
- Disconnect the power supply before transporting the device.

Maintenance

- Before conducting any maintenance on the device, disconnect the mains plug.
- Only those maintenance and fault elimination tasks described here may be carried out. Any other tasks must be completed by a specialist.
- Only use original replacement parts. Only these replacement parts are designed and suitable for the device.

Device-specific safety instructions

- Do not subject the device to rain. Do not use the device in wet surroundings.
- Do not use the device in areas where there is danger of explosion or in the vicinity of combustible liquids or gases!
- Do not aim the water jet directly toward the device or other electrical components! Mortal danger due to electric shock!
- Lay the extension cord in such a way that it cannot get into the liquid being conveyed.
- Do not install or turn on the device if there are people or animals in the conveying medium (e. g. swimming pool) or making contact with the conveying medium.
- Do not leave the device unsupervised. Unplug the mains plug during periods of extended absence.
- As a general rule, repairs are only to be carried out by an electrician. If repairs are performed improperly, there is danger of liquid getting into the electronic components of the device.
- Symbols affixed to your tools may not be removed or covered. Information on the device that is no longer legible must be replaced immediately.



Read and observe the operating instructions before commissioning.

Your device at a glance

1. Intake
2. drain plug
3. Pressure joint
4. Handle
5. On-Off switch (filler plug)
6. Filter housing

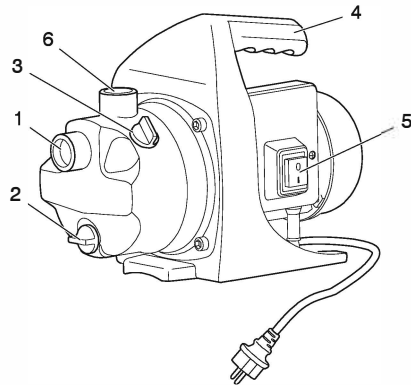

Scope of delivery

- Garden pump
- Instructions for use

Unpacking the Pump

- The device must be placed on a horizontal, level surface that is sufficiently capable of supporting the total weight of the device when filled with water.
- To prevent vibrations, the device should be placed on an elastic base [support] (e. g. a rubber mat).
- The installation site must be well ventilated and protected from the effects of weather.
- When being used on garden ponds and swimming pools, the device must be set up so as to guard against overflowing and protect against falling in. Additional legal requirements must be observed.

- When operating indoors you must ensure that there is a drain in the floor or a leak prevention mechanism.
- Before starting up, check the suction hose to ensure that it is sealed. Bubbles of air in the suction hose are an indication that there may be leaks and may lead to failure of the device!

Connect suction line



Risk of damage to the device!

The suction line must be installed so that it does not exert any mechanical force or tension on the pump.

If the conveying medium is contaminated, a suction filter must be used to protect the pump from sand and dirt.



Note:

A check valve is recommended so that the water does not run off when the pump is shut off.

- All connections must be sealed with hemp and thick paste (Fermit) or thread sealing tape (e. g. Teflon tape); leaks cause air exhaust and reduce or prevent water exhaust.
- Hemp should be used in case of pipe threads from metal; synthetic thread must be sealed with thread sealing tape.
- All components of the suction line must be professionally installed.
- The suction pipe should have an internal diameter of at least 25 mm; it must be kink resistant and suitable for vacuum use.
- The suction line should be as short as possible, since the conveying capacity decreases as the length of the line increases.
- The suction line should ascend steadily toward the pump to prevent air pockets.
- Sufficient water supply must be assured; the end of the suction line must always be in water.

Connect pressure line



Risk of damage to the device!

The suction line must be installed so that it does not exert any mechanical force or tension on the pump.

- All connections must be sealed with hemp and thick paste (Fermit) or thread sealing tape (e. g. Teflon tape); leaks cause air exhaust and reduce or prevent water exhaust.
- Hemp should be used in case of pipe threads from metal; synthetic thread must be sealed with thread sealing tape.
- All components of the pressure line must be compression-proof.
- All components of the pressure line must be professionally installed.



Risk of injury!

If the components are not compression-proof or if they are improperly installed, the pressure line could burst during operation. Risk of injury from liquid spurting out!

**Note:**

The device may only be used for industrial water supply, e. g. from the toilets, washing machine, etc.

It may not be used for drinking water supply.

Electrical connection

**Mortal danger due to electric shock!**

Do not operate the device in wet surroundings!

The device may only be operated under the following conditions:

- The device may only be connected to outlets with protective contacts that have been professionally installed, grounded and inspected.
- Mains voltage and fuse protection must comply with the technical data.
- When operating in swimming pools, garden ponds and similar places, the device must be provided with a residual current of not more than 30 mA by means of a residual current operated protective device.
- When operating outdoors, the electrical connections must be splash-proof; they must not lie in water.
- Extension cords must have sufficient wire cross section; cable drums must be complete unwound.

Operation

Filling and intake [suction]

**Risk of damage to the device!**

The pump should be filled with water after each new connection or in the event of water loss or air intake. Extended operation without a water refill (unsupervised dry run) will destroy the pump!

1. Unscrew filter housing (6) and remove filter.
2. Fill completely with water.
3. Reinstall filter and screw filter housing and seal back on.
4. If you want to shorten the intake time, fill the suction line as well (only possible with the check valve).
5. Open pressure line (turn on water spigot or nozzle), so that air can escape during intake.
6. Switch the device on.
7. When water runs out evenly, turn the device off.

**Note:**

We recommend installing a check valve between the pump and suction line, so that the water column remains in the suction line.

We recommend using a suction filter for better suction performance.

► Accessories

Operation

The pump and suction line must be connected and filled.



Danger of damage to the device!

The pump must not be allowed to run dry. Sufficient conveying medium (water) must be on hand at all times.

1. Plug in the mains plug.
2. Turn pump on at the On-Off switch.
3. Open pressure line (turn on water spigot or nozzle).
4. Check to be sure that water is coming out.

If the motor does not start up or the pump does not build up any pressure or if similar faults occur, turn the device off and try to remedy the error (► Faults and remedial measures).



Danger of damage to the device!

Do not allow the pump to run longer than 10 min. when the pressure line is closed. Allowing it to run longer can result in overheating and damage.

Maintenance



Mortal danger due to electric shock!

Disconnect the mains plug before carrying out any work on the device.



Risk of injury!

Make sure that the device and connected accessories are depressurized before carrying out any work on the device.



Risk of damage to the device!

All gaskets must be renewed after each disassembly of components.



Danger of damage to the device!

Before installing the cleaned filter cartridge, check to be sure that there are no foreign particles inside!

Intake of particles will damage the pump!

- Insert cleaned filter cartridge into the filter housing.
- Screw filter housing back down. Ensure proper location of the seal.

Storage

If there is danger of frost, dismantle the device and accessories, clean and store them in a place protected from frost.



Danger of damage to the device!

Frost will damage the device and accessories, since they always contain water!

Dismantle and store

1. Turn off the device, unplug the mains plug.
2. Open pressure line (turn on water spigot or nozzle), allow water to completely run off.
3. Completely empty the pump by unscrewing the water drain plug (2)
4. Dismantle the suction and pressure lines from the device.
5. Store device in a frost-free room (at least 5 °C).

Faults and remedial measures

When something isn't working...



Risk of injury!

Improperly performed repairs can lead to the device not functioning safely. This endangers yourself and your environment.

In many cases small defects can lead to a malfunction. You will usually be able to deal with these yourself. Please refer to the table below before contacting your local market. This may save you a lot of effort and quite often money.

Error/Fault	Cause	Remedy
Pump does not work.	No power supply?	Check the cable, plug, and the fuse.
	Motor overheats due to high liquid temperature?	Eliminate cause of overheating.
	Motor overheats due to sealed ventilation slots?	(max. liquid temperature ► Technical data)
	Residual current protection switch (FI-switch) activated?	Switch on FI-switch. If it happens again contact the electric service partner.
	Motor defective?	Contact your local store.

Disposal

Error/Fault	Cause	Remedy
Delivery rate too low. Not enough pressure.	Water shortage?	Ensure sufficient water supply.
	Suction pipe not sealed?	Seal suction pipe, tighten screwed connections.
	Suction height too high?	Observe maximal suction height (► Technical data). Suction height must be deducted from the conveyance height.
	Filter blocked or soiled?	Clean or replace filter.
	Check valve blocked?	Clean or replace valve.
	Water leak between motor and pump, shaft sealing is not sealed?	Contact your local store.
	Pump is blocked or defective?	Clean the pump with clean water and remove the cause of the contamination.
	Air in the pump or suction pipe?	Fill pump case with water. For suction pipes with check valve, fill suction pipe with water.
	Changed suction conditions in spring (springs e. g. covered in sand)?	Check spring and water quality.
	Suction pipe sucked in on the ground?	Shorten or fasten suction pipe. Use filter screen with check valve.

If you are unable to eliminate the error yourself, please contact your local market directly. Please remember that repairs carried out by non-professionals can damage the pump.

Disposal

Disposal of the appliance

Appliances which are labelled with the adjacent symbol must not be disposed of in household waste. You must dispose of such old electrical and electronic equipment separately.

Please check with your local authority about the possibilities for correct disposal.

Through separate disposal you send old equipment for recycling or for other forms of re-use. You will thus help to avoid in some cases that damaging material gets into the environment.



Technical data

Please check with your local authority about the possibilities for correct disposal.

Through separate disposal you send old equipment for recycling or for other forms of re-use. You will thus help to avoid in some cases that damaging material gets into the environment.

Disposal of the packaging

The packaging consists of cardboard and correspondingly marked plastics that can be recycled.

- Make these materials available for recycling.

Technical data

Model	71002
Nominal V/Hz	115/60Hz
Nominal output	1 HP Motor
Protection type	IPX4
Max. height	125ft
Max. suction height	26.5 ft
Max. pump rate	880GPH
Max. fluid temperature	95 F
Diameter of pipe	approx. 33 mm (1")



Danger of damage to the device!

If the conveyed water is highly contaminated, clean the filter after each use. stopped-up filter will damage the pump!

- Unscrew filter housing (A) and take out filter cartridge.
- If needed, soak filter cartridge in warm water for a short while.
- Rinse filter cartridge with clear water; brush out stubborn dirt from inside using a soft brush.

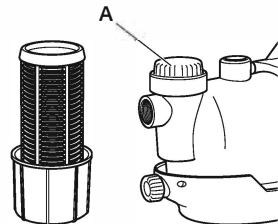

DISCLAIMER

PLEASE READ THE FOLLOWING CAREFULLY

THE MANUFACTURER AND/OR DISTRIBUTOR HAS PROVIDED THE PARTS LIST AND ASSEMBLY DIAGRAM IN THIS MANUAL AS A REFERENCE TOOL ONLY. NEITHER THE MANUFACTURER OR DISTRIBUTOR MAKES ANY REPRESENTATION OR WARRANTY OF ANY KIND TO THE BUYER THAT HE OR SHE IS QUALIFIED TO MAKE ANY REPAIRS TO THE PRODUCT, OR THAT HE OR SHE IS QUALIFIED TO REPLACE ANY PARTS OF THE PRODUCT. IN FACT, THE MANUFACTURER AND/OR DISTRIBUTOR EXPRESSLY STATES THAT ALL REPAIRS AND PARTS REPLACEMENTS SHOULD BE UNDERTAKEN BY CERTIFIED AND LICENSED TECHNICIANS, AND NOT BY THE BUYER. THE BUYER ASSUMES ALL RISK AND LIABILITY ARISING OUT OF HIS OR HER REPAIRS TO THE ORIGINAL PRODUCT OR REPLACEMENT PARTS THERETO, OR ARISING OUT OF HIS OR HER INSTALLATION OF REPLACEMENT PARTS THERETO.

Record Product's Serial Number Here: _____
Note: If product has no serial number, record month and year of purchase instead.

Note: Some parts are listed and shown for illustration purposes only and are not available individually as replacement parts.

The material in this manual is for informational purposes only. The product(s) it describes are subject to change without prior notice, due to the manufacturer's continuous development program. Stark Tools makes no representations or warranties with respect to this manual or with respect to the products described herein. Stark Tools shall not be liable for any damages, losses, costs or expenses, direct, indirect or incidental, consequential or special, arising out of, or related to the use of this material or the products described herein.

Questions, issues or missing parts?

Before returning to your retailer, our customer service team is here to help.



Call Us: 909.628.0880

Email Us: customer@xtremepowerusa.com

Hours of Operation: 9am - 3pm PST Monday - Friday

MADE IN CHINA