

INSTALLATION

Product Manual



IMPORTANT INFORMATION!

please read the entire manual before starting to assemble and/or using this product. follow the manual thoroughly and keep it for further reference.



AVOID SCRATCHES!

In order to avoid scratching this furniture should be assembled on a soft layer—could be a rug.



IMPROVE EFFICIENCY !

Try to find a partner to install with you, which can speed up the installation efficiency and shorten the time.



ANTI-TOPPLE WARNING !

Overturned furniture can cause serious or fatal crush injuries. To prevent tipping over, be sure to use the wall attachment, if not included with this product. Please purchase the wall attachment that fit your wall. If unsure, seek professional advice. Please read and follow each step of the instructions carefully.

IMPORTANT !

It is important that any product which is assembled using any kind of screw is re-tightened 2 weeks after assembly, and once every 3 months - in order to assure stability through-out the lifespan of the product.

For regular maintenance and cleaning of the product, for the frame, please use a rag dipped in neutral detergent to fully wipe it, and then dry it with a clean rag. For glass materials, wipe with a rag dampened with water glass cleaner, and then dry with a dry rag.

Do not use an electric screwdriver, and do not use too much force when installing, because the board is easy to break.



Please prepare the following tools

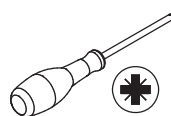
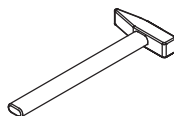
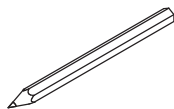

When installing, please carefully confirm whether each screw corresponds to the manual, accessories with similar shapes can be distinguished by size

A x 85

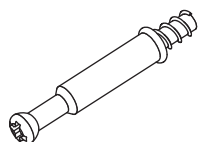

Ø 6 x 35 mm

B x 85



Ø 15 x 10 mm

C x 39



Ø 6 x 30 mm

D x 34

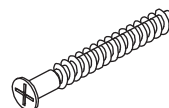

Ø 5 x 40 mm

E x 7

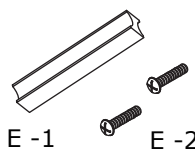

E -1 E -2

F x 106



Ø 3.5 x 14 mm

G x 6

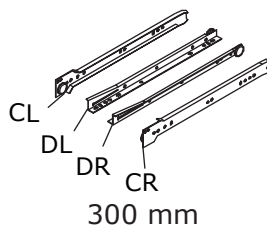

300 mm

H x 3

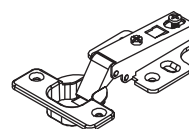

ZB

J x 40



K x 8



L x 2



Ø 3.5 x 14 mm

M x 6

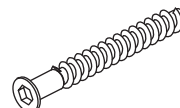

Ø 7 x 50 mm

N x 20



O x 2

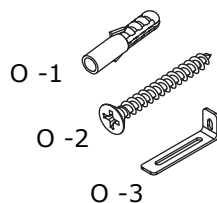

O -3

P x 1

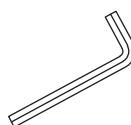

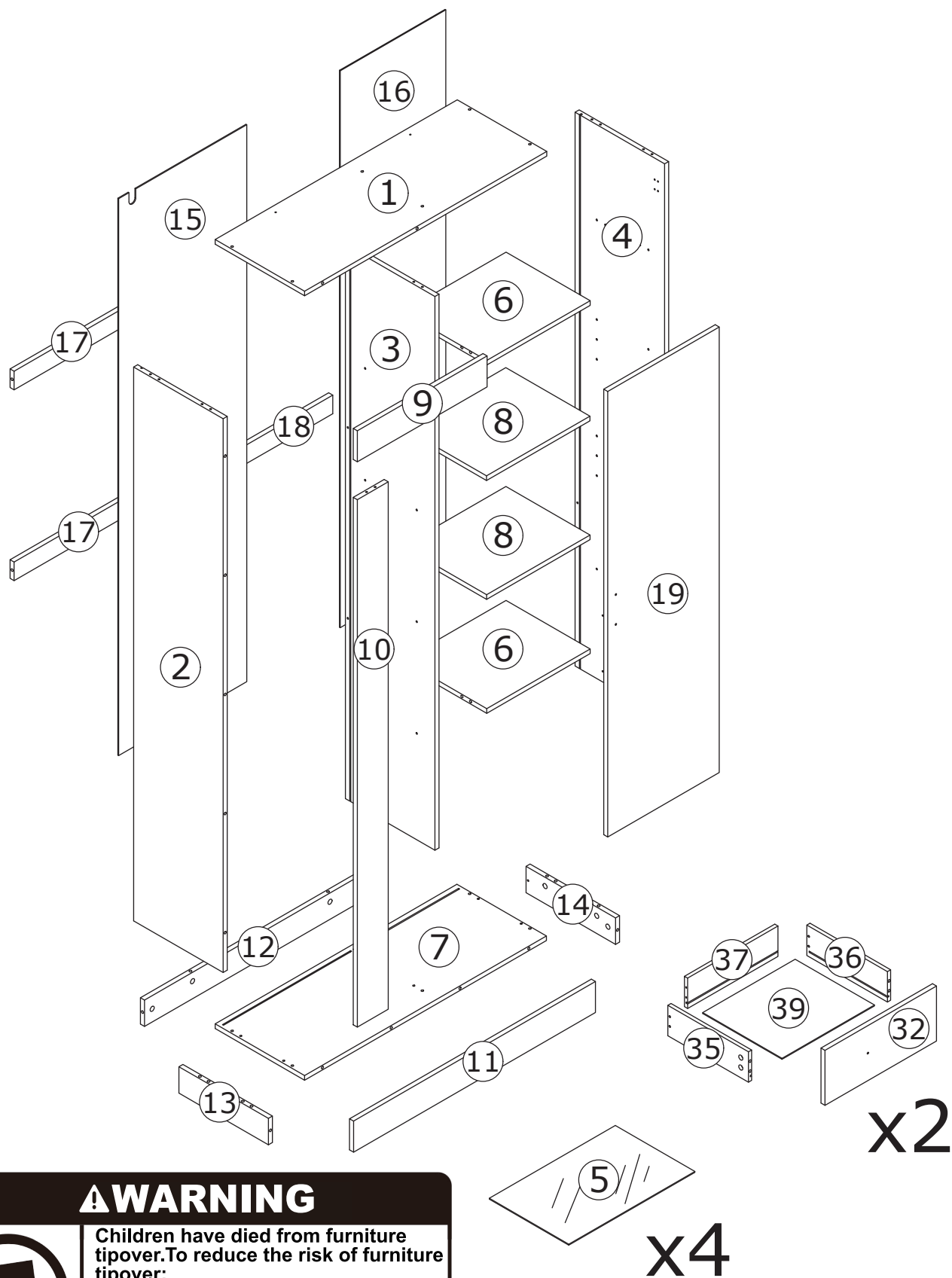

⚠ WARNING



Children have died from furniture tipover. To reduce the risk of furniture tipover:

- ALWAYS install Anti-tip device provided.
- NEVER put a TV on this product.
- NEVER allow children to stand, climb or hang on drawers, doors, or shelves.
- NEVER open more than one drawer at a time.
- Place heaviest items in the lowest drawers.

*This is a permanent label.
Do not remove!*

x4

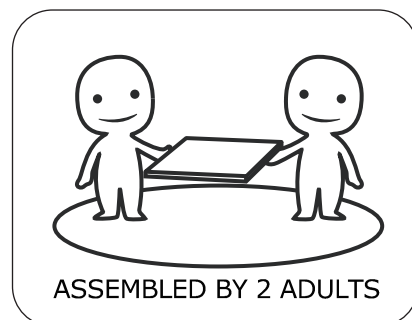

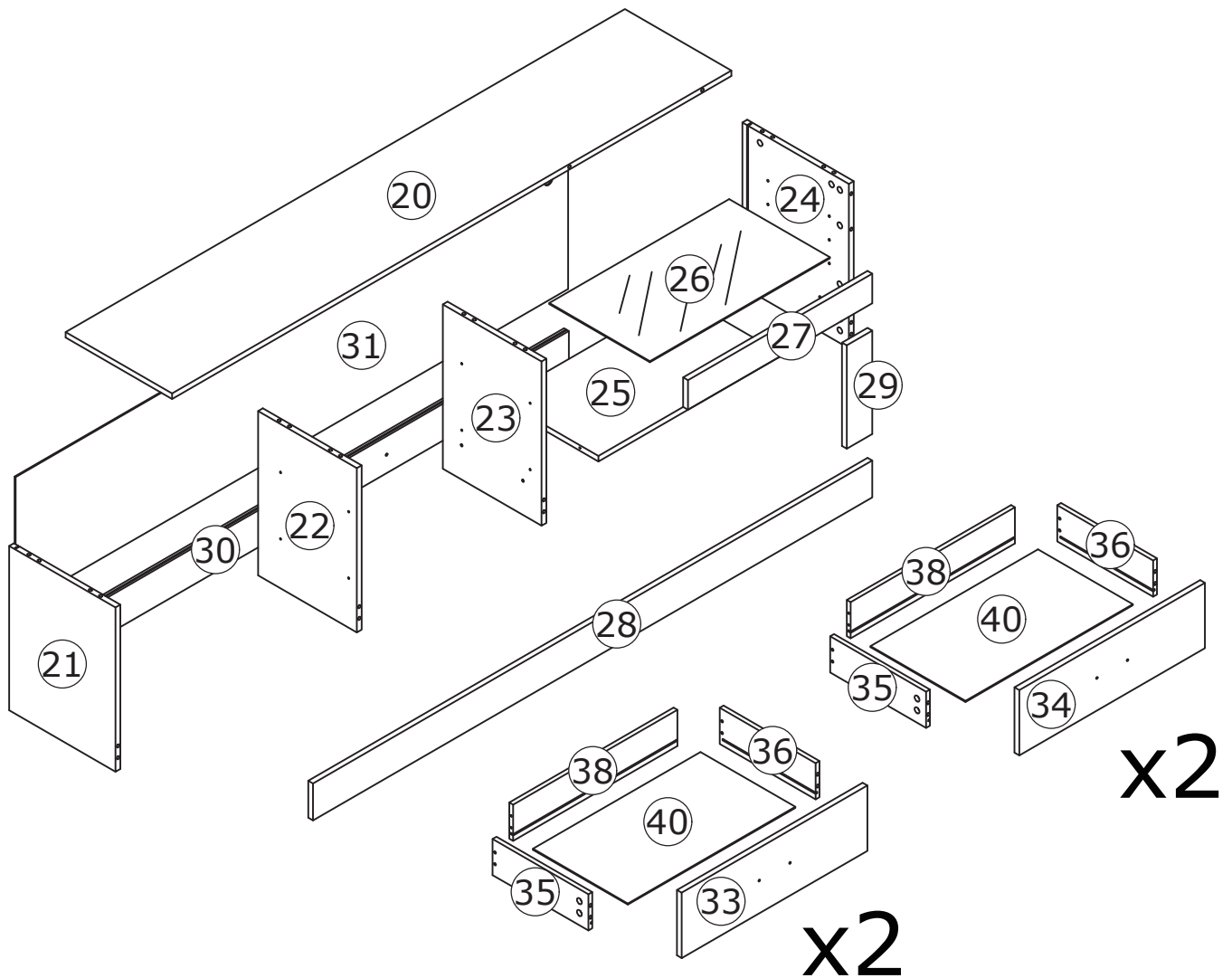

⚠ WARNING



Children have died from furniture tipover. To reduce the risk of furniture tipover:

- ALWAYS install Anti-tip device provided.
- NEVER put a TV on this product.
- NEVER allow children to stand, climb or hang on drawers, doors, or shelves.
- NEVER open more than one drawer at a time.
- Place heaviest items in the lowest drawers.

*This is a permanent label.
Do not remove!*

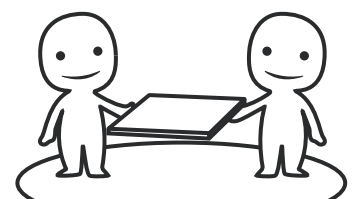



ASSEMBLED BY 2 ADULTS

1

A x 7

 Ø6 x 35 mm

F x 4

 Ø3.5 x 14 mm

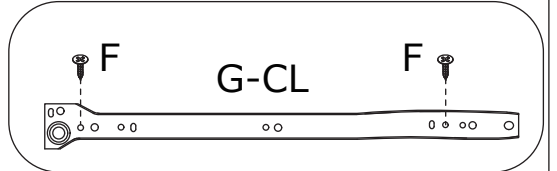
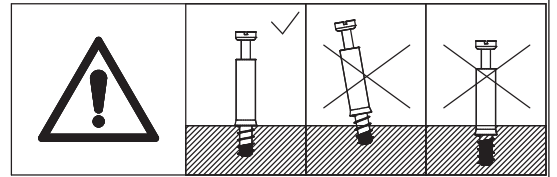
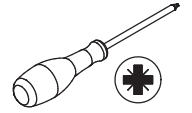

G x 2

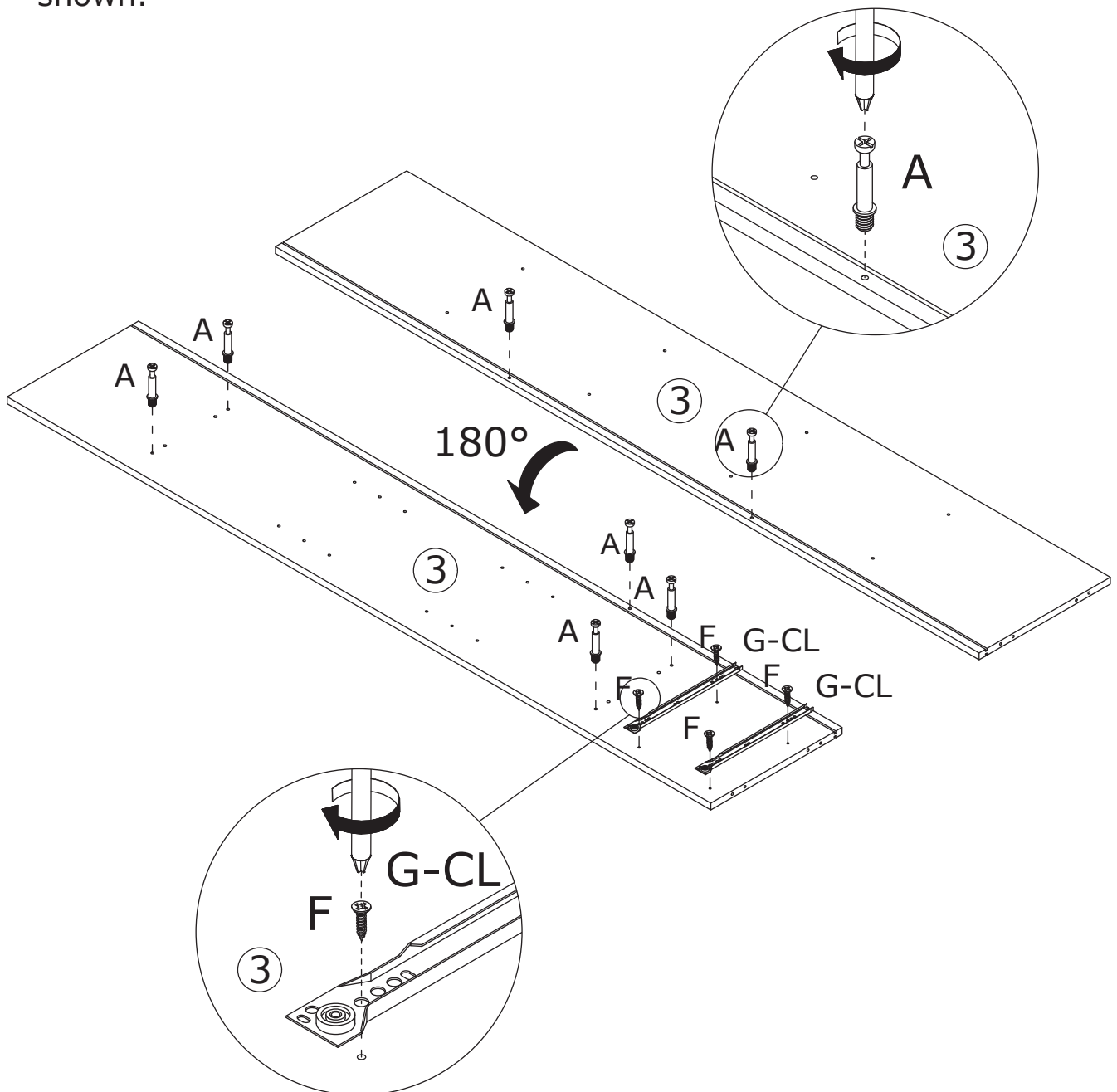
 CL
 300 mm



Screw eccentric rod(A) into board 3 at first.
 Flip to back, screw eccentric rod(A) and fix rail(CL) using screw(F) as shown.

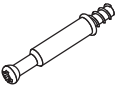

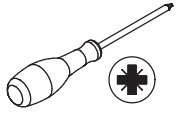
2

<p>A x 7</p>  <p>Ø6 x 35 mm</p>	<p>F x 4</p>  <p>Ø3.5 x 14 mm</p>	<p>G x 2</p>  <p>CR 300 mm</p>	
--	--	---	---

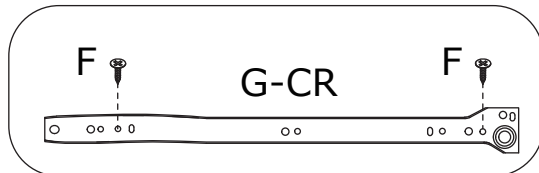
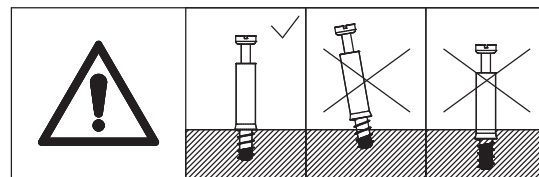

Screw eccentric rod(A) into board 2 and 4 at first.
Fix rail(CR) to board 6 using screw(F) as shown.

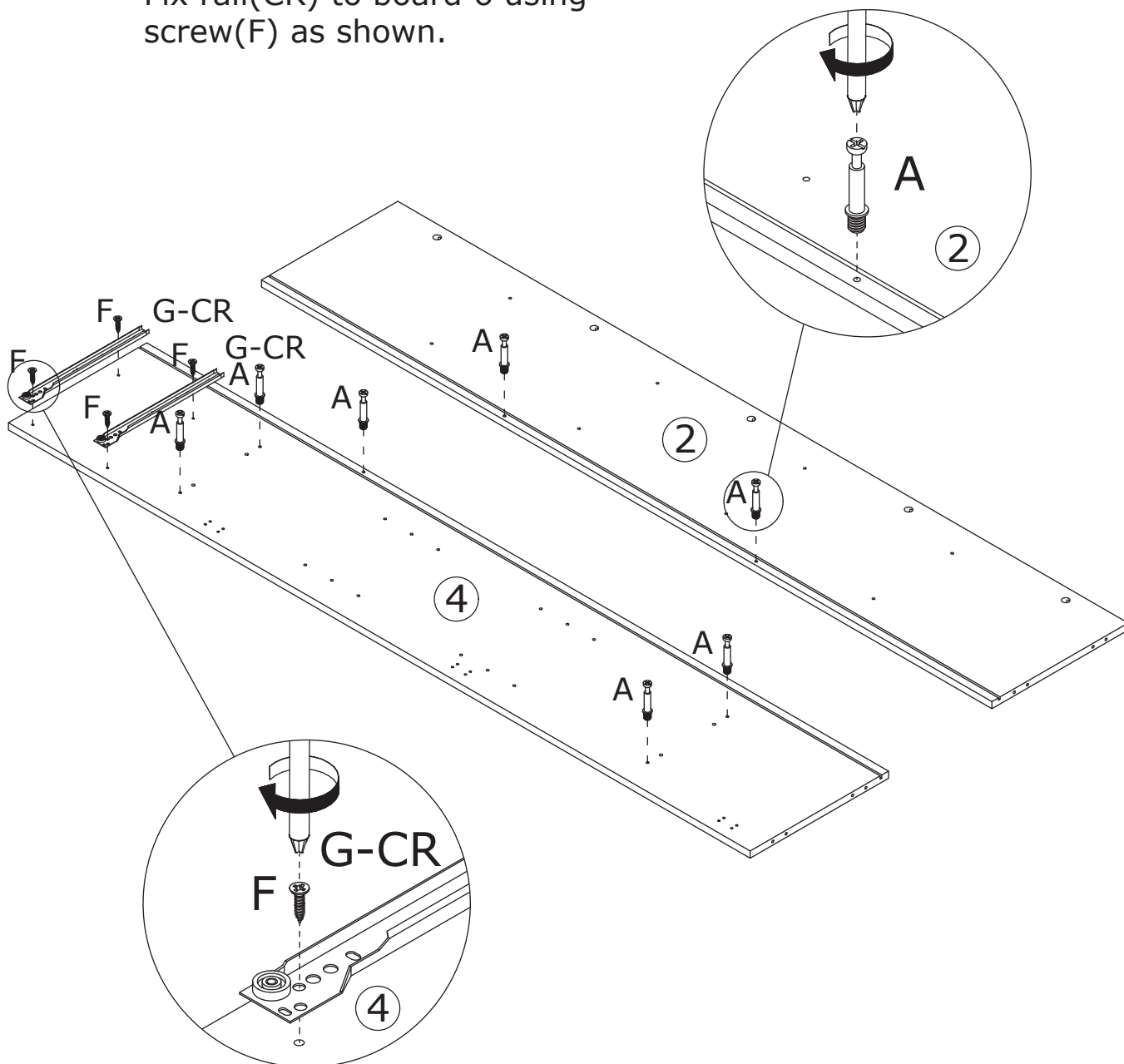

3

<p>B x 10</p>  <p>Ø 15 x 10 mm</p>	<p>C x 8</p>  <p>Ø 6 x 30 mm</p>	
---	---	---

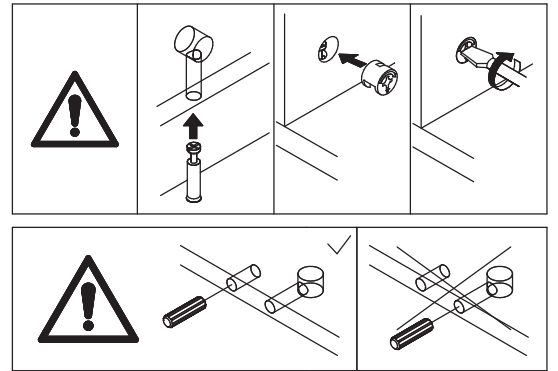

Insert wooden dowel(C)
into board 6 at first.
Connect board 6 and 18 to board
3 and 4, add cam lock(B) into board 6,
18 and turn clockwise to tighten as shown.

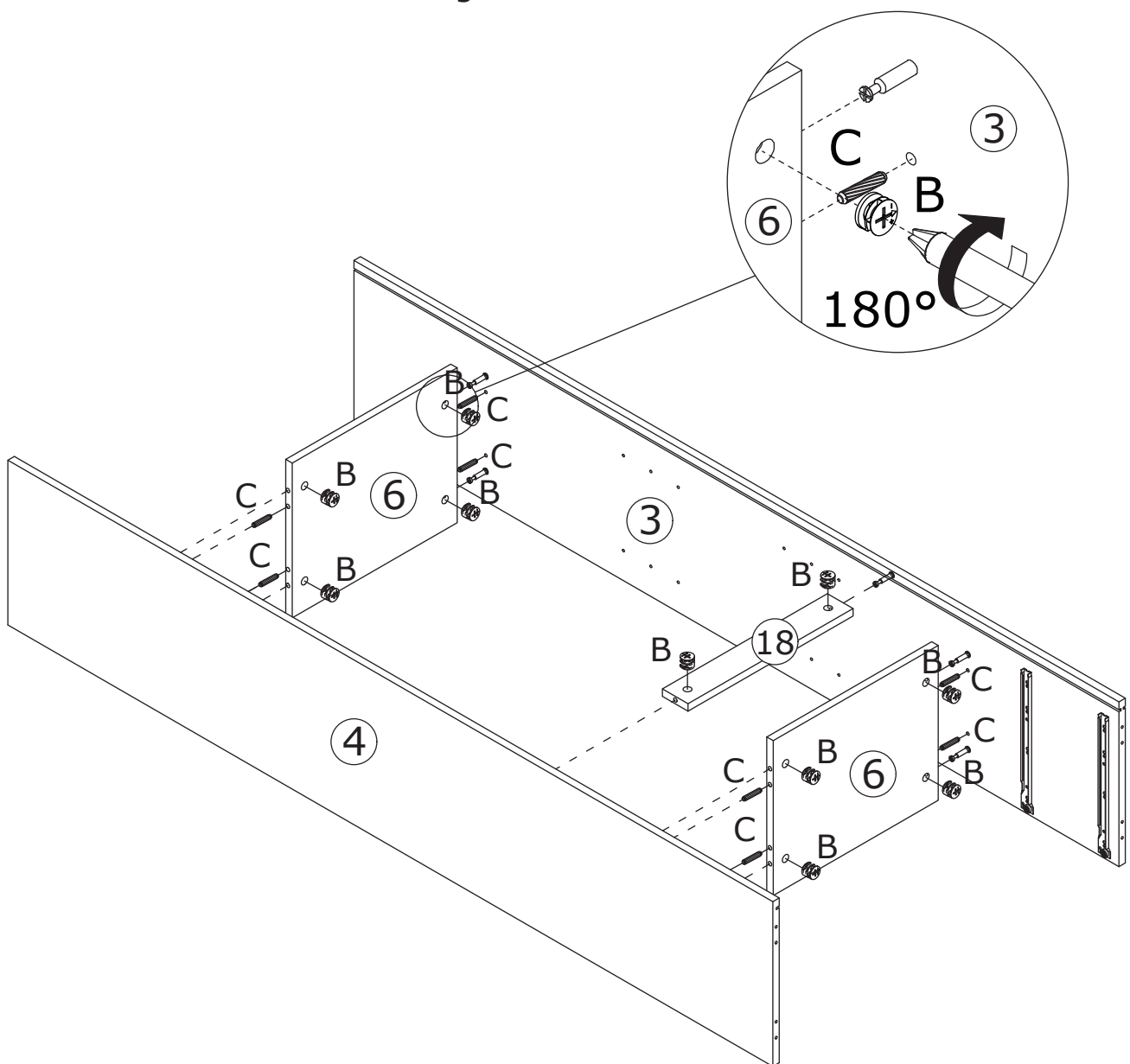

4

B x 4





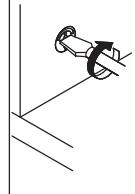
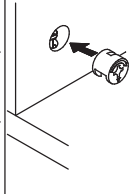
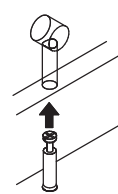

Ø 15 x 10 mm

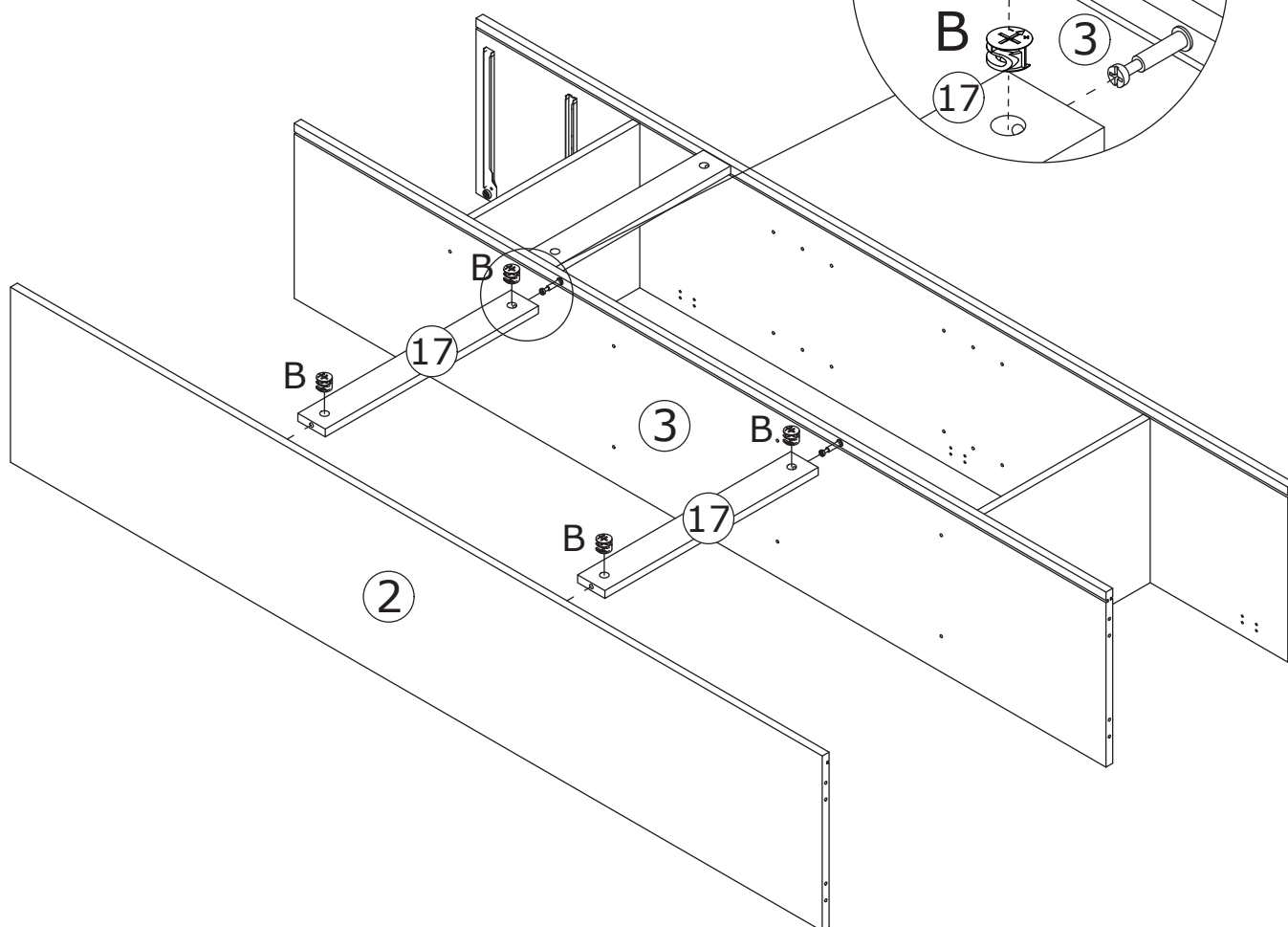
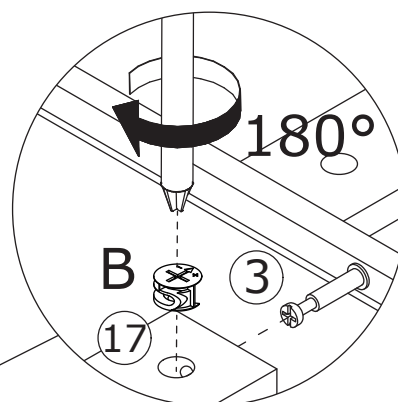

Connect board 17 to board 2 and 3,
add cam lock(B) into board 17 and
turn clockwise to tighten as shown.

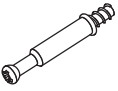

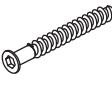
5

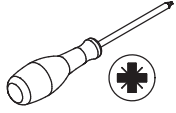
<p>A x 6</p>  <p>Ø6 x 35 mm</p>	<p>C x 6</p>  <p>Ø6 x 30 mm</p>	<p>M x 6</p>  <p>Ø7 x 50 mm</p>	<p>P x 1</p> 	
--	--	--	---	---

Attach board 7 to board 4, 3 and 2 using wooden dowel(C) and fix with screw(M) as shown.
Screw eccentric rod(A) into board 7 as shown.

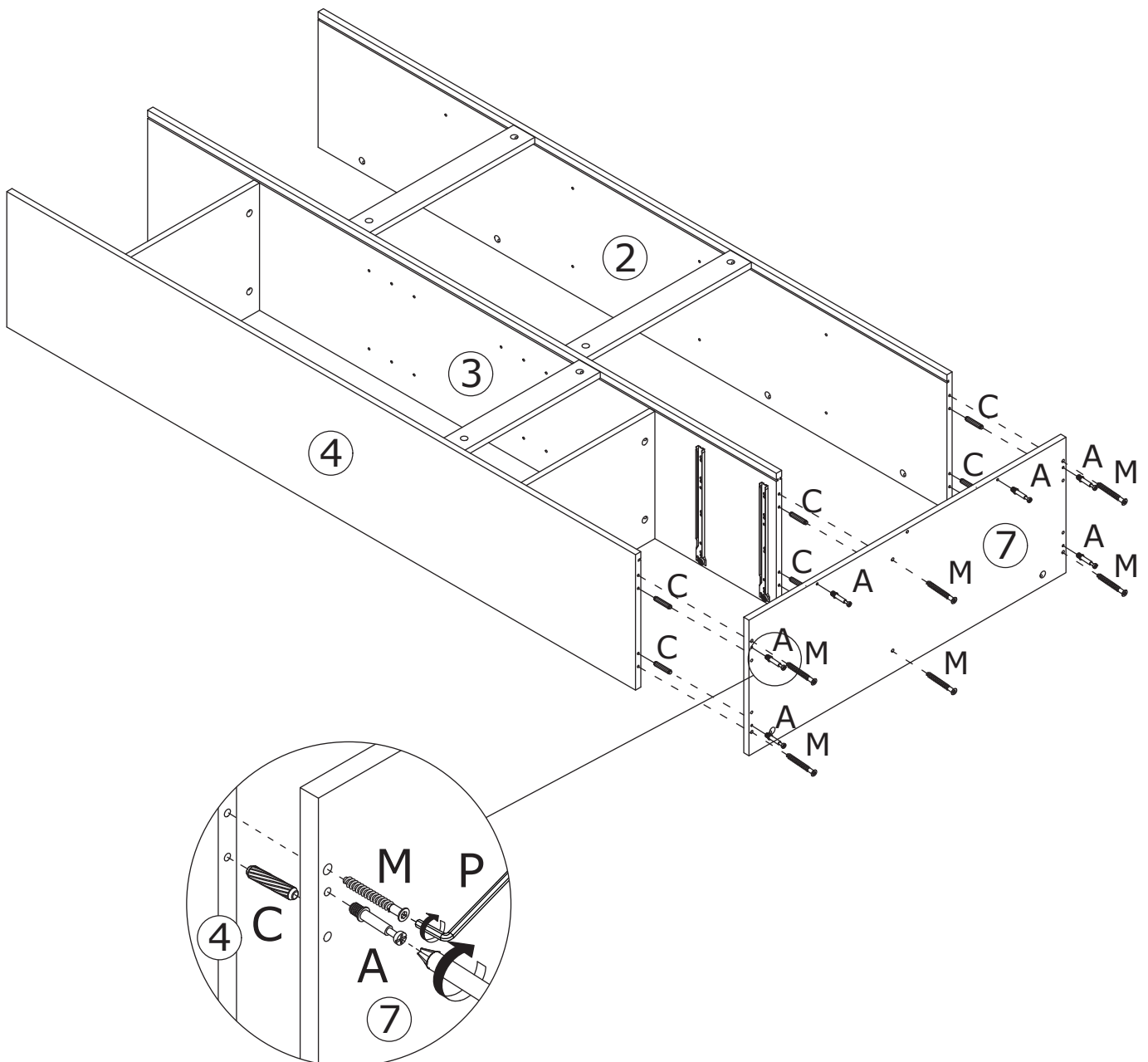
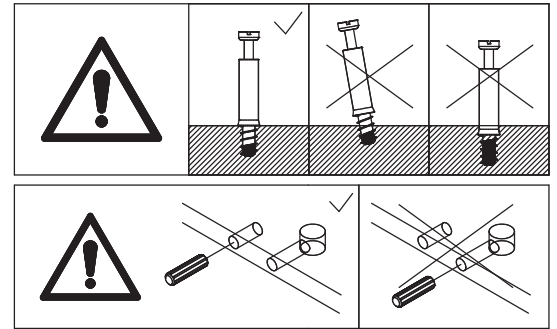

6

A x 6

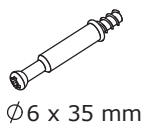

B x 2

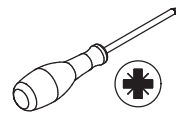
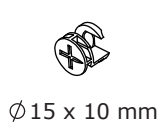

Screw eccentric rod(A) into board 13, 14 and 11 at first.

Connect board 13 and 14 to board 12, add cam lock(B) into board 12 and turn clockwise to tighten as shown.

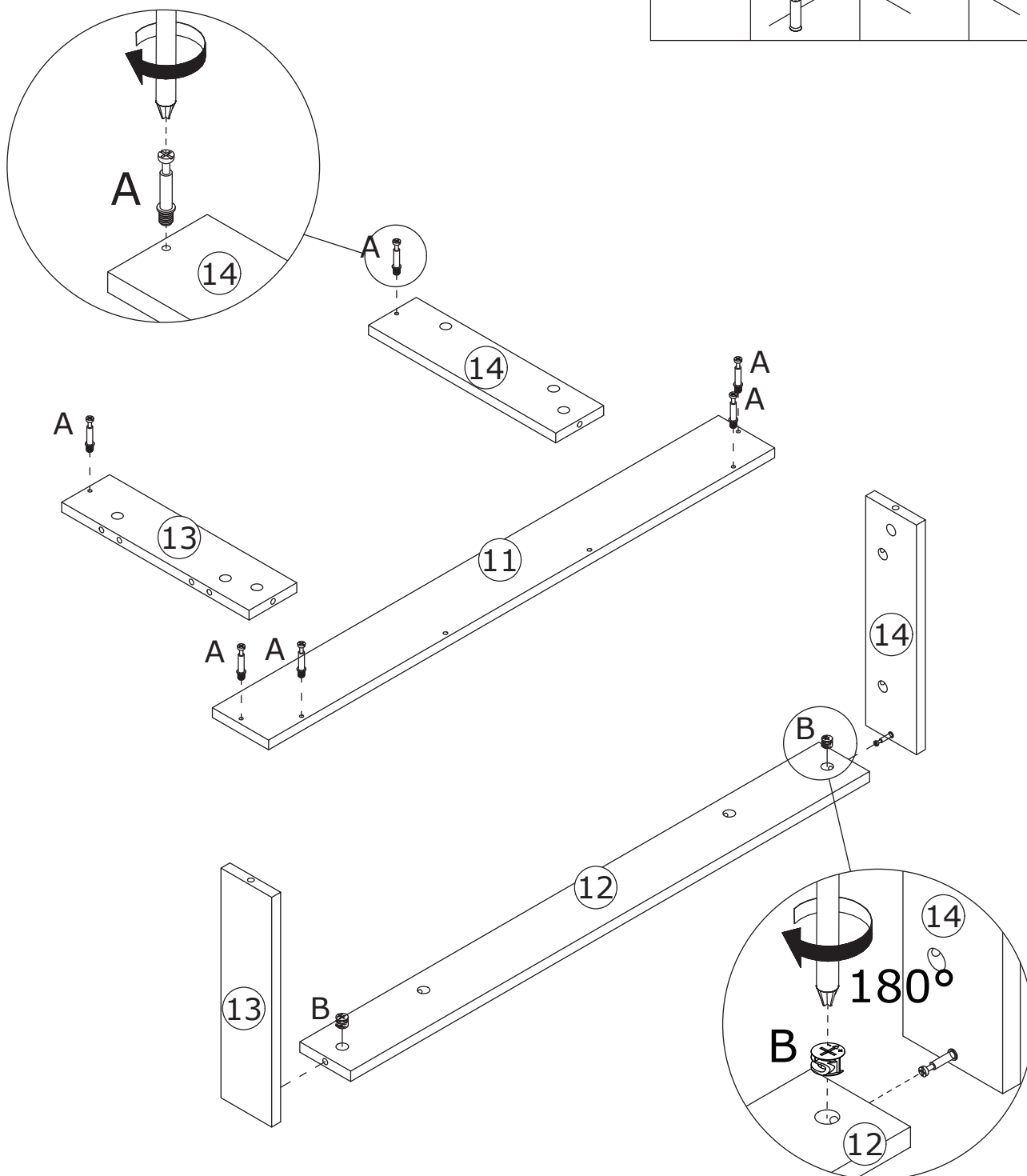
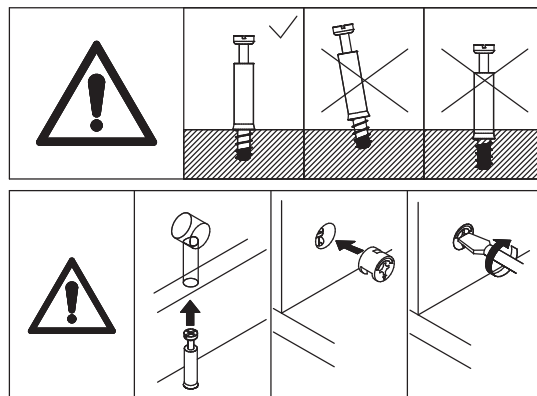

7

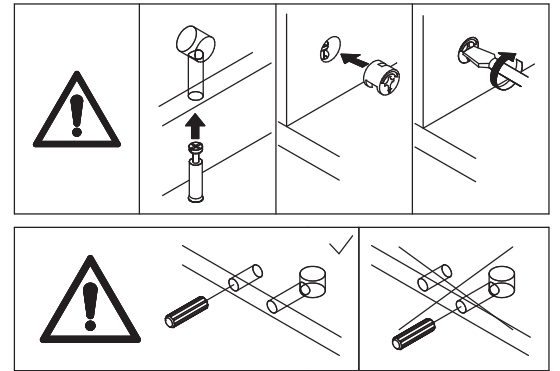

Attach the component to board 7 using wooden dowel(C), add cam lock(B) into board 13, 12, 14 and turn clockwise to tighten as shown.

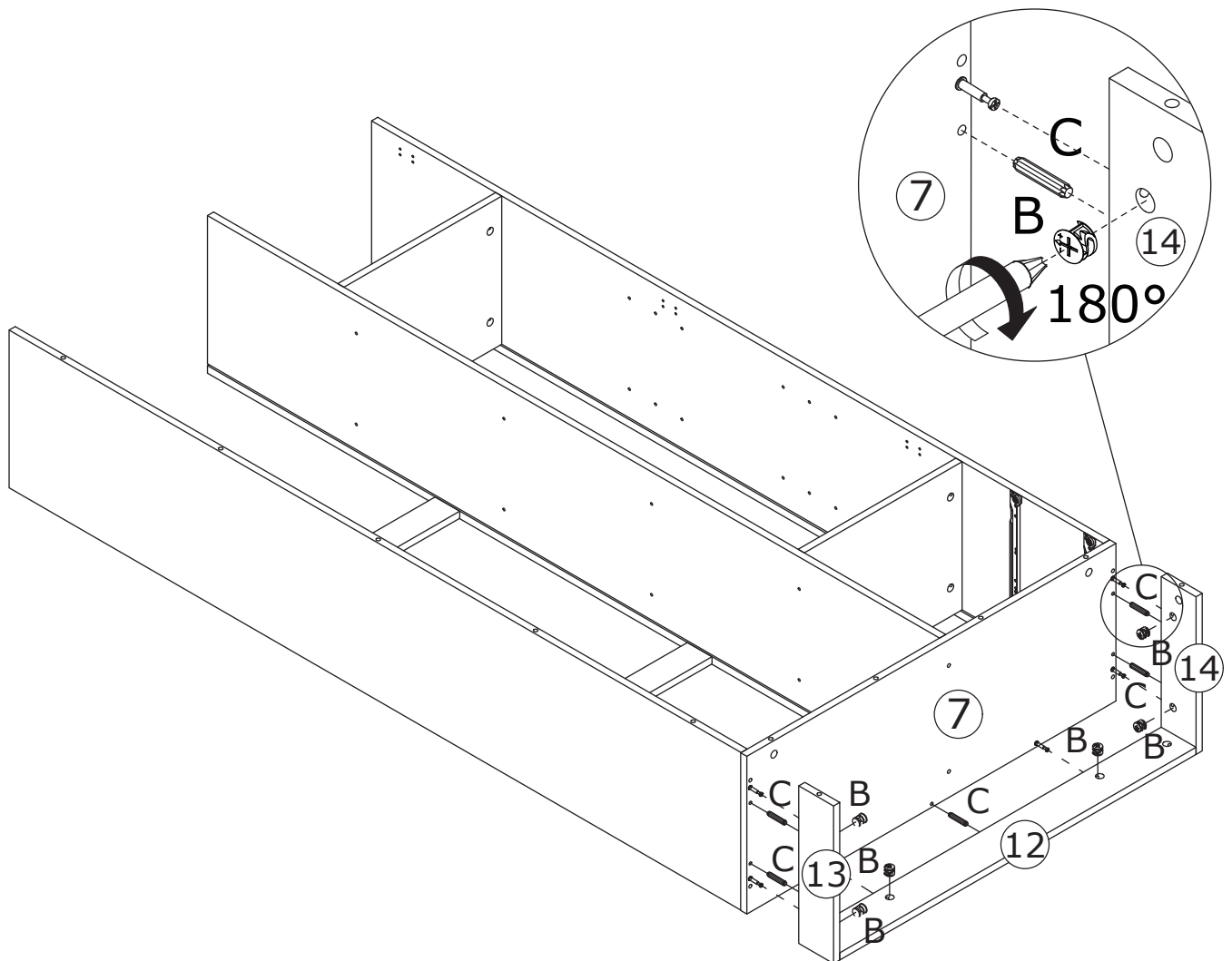

8

B x 4



Ø 15 x 10 mm

C x 2



Ø 6 x 30 mm

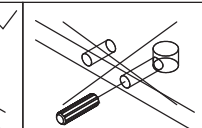
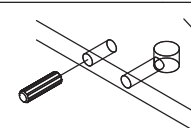
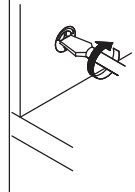
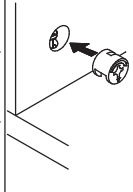
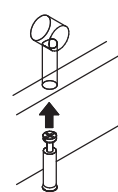
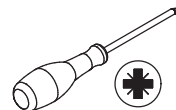

Attach board 11 to board 13, 7 and 14 using wooden dowel(C), add cam lock(B) into board 13, 7, 14 and turn clockwise to tighten as shown.

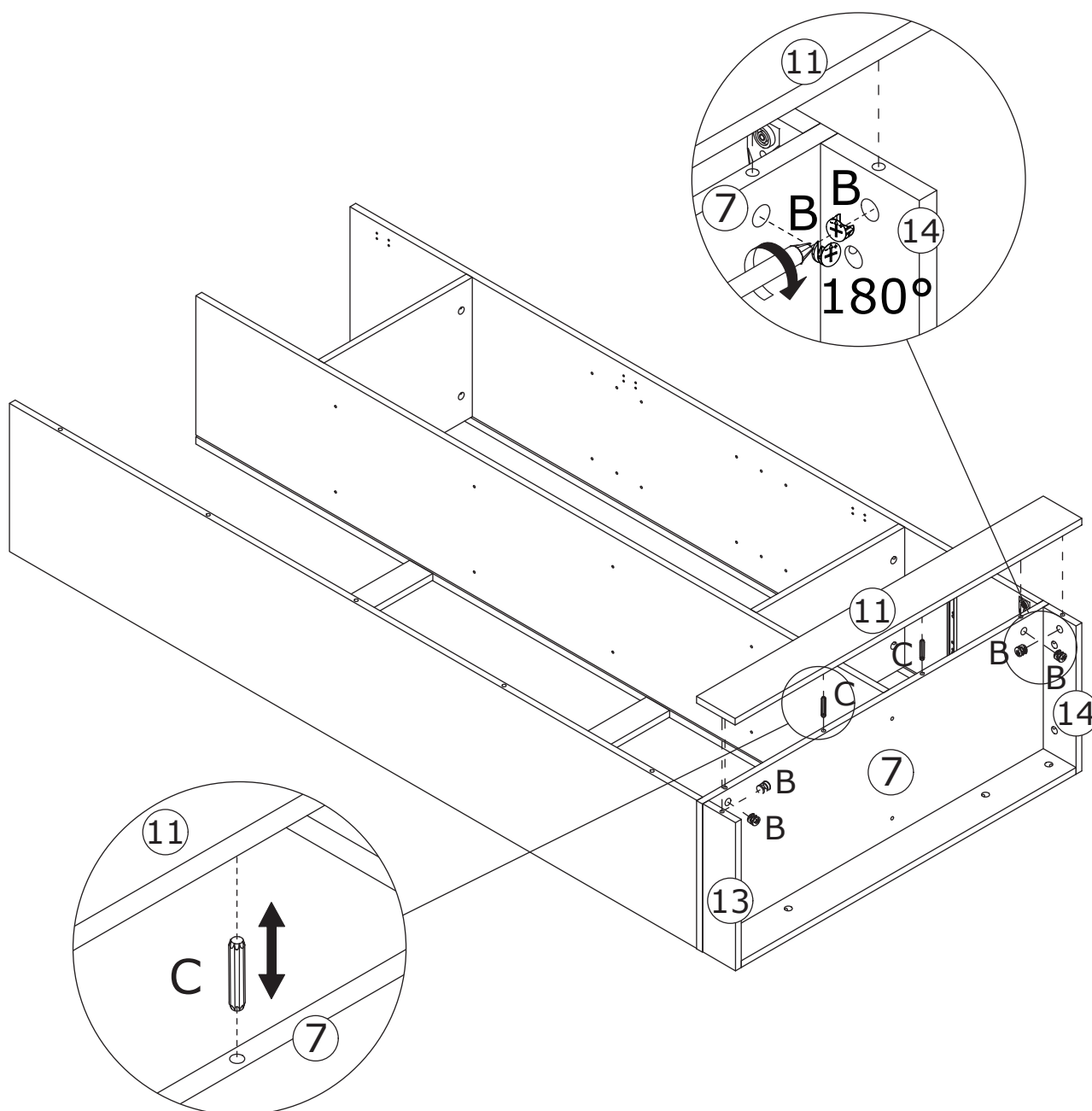

9

Insert back board 15 and 16
along available grooves.

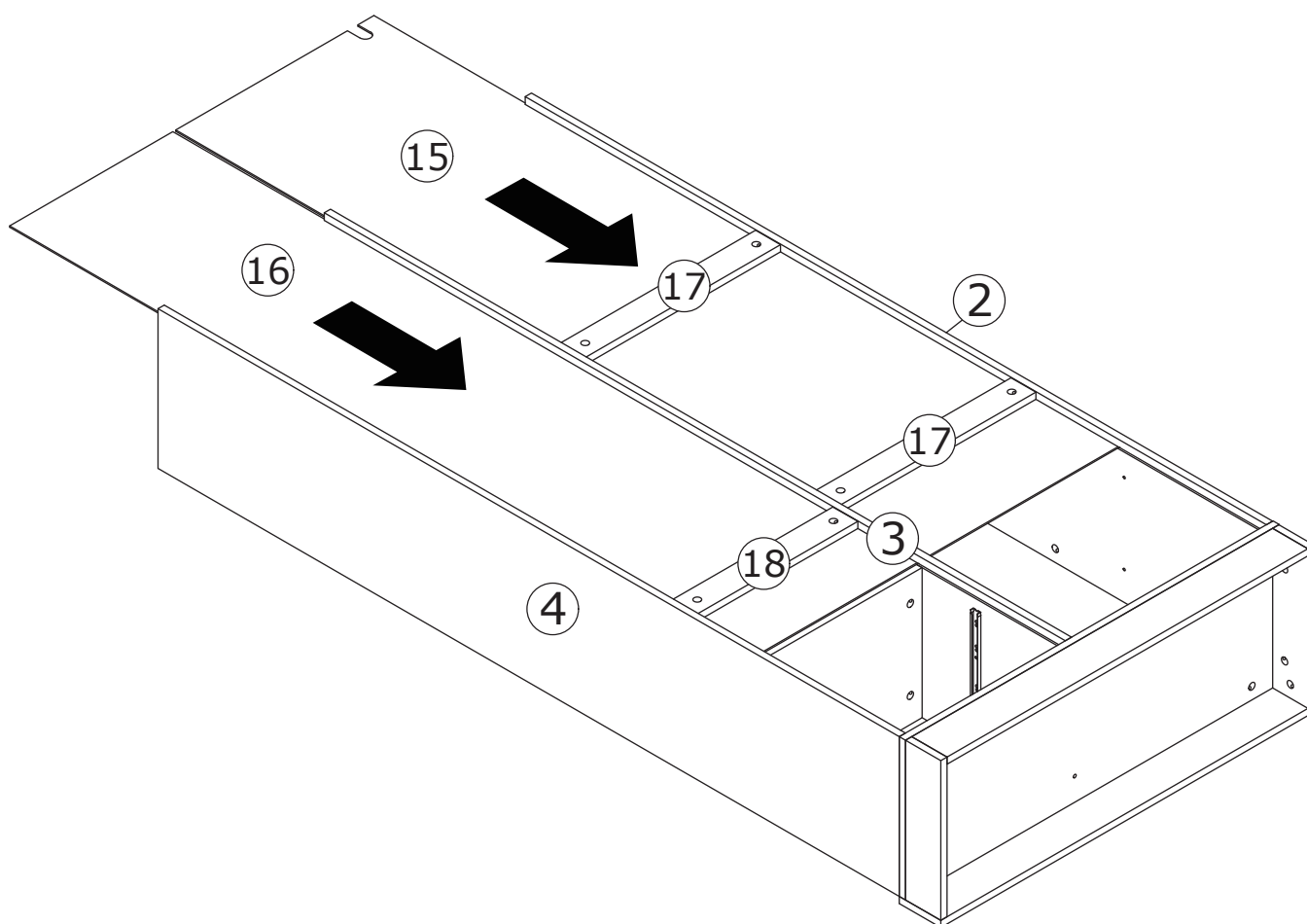

10

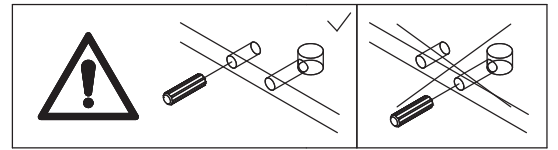

Attach board 1 to board 2, 3 and 4 using wooden dowel(C) and fix with screw(D) as shown.

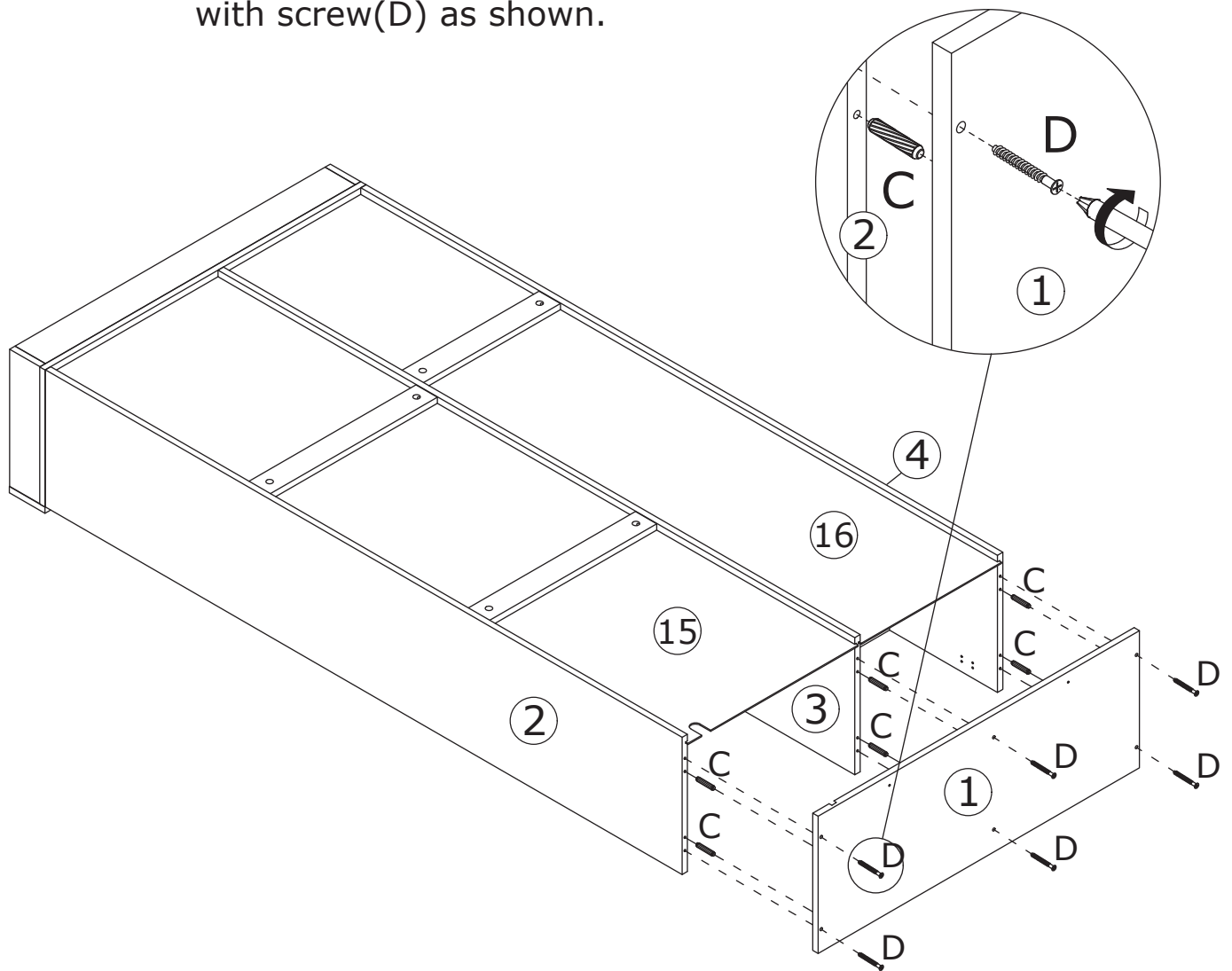

11

F x 24



Ø 3.5 x 14 mm

J x 24

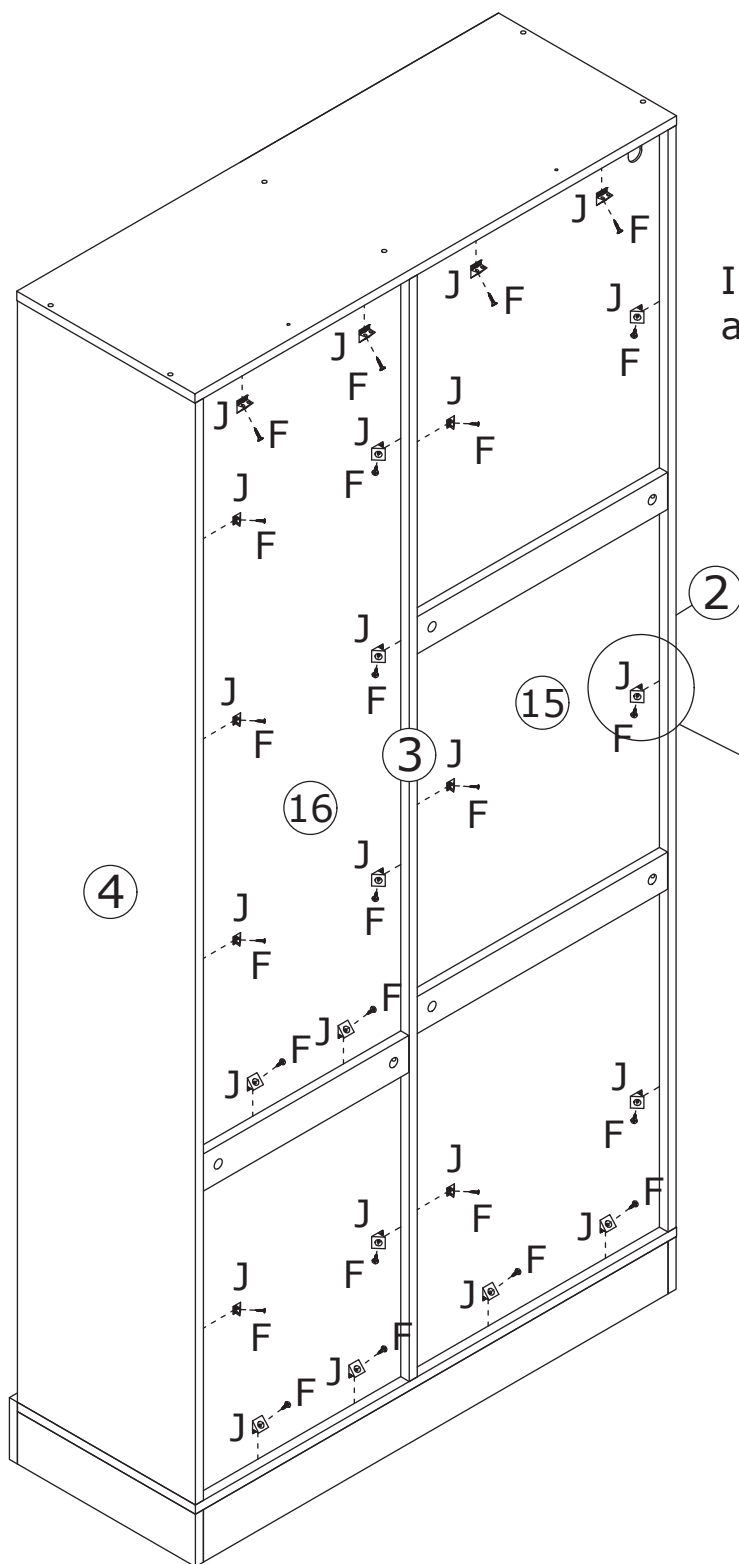
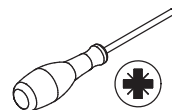

Insert buckle(L) into back slots and fix with screw(F) as shown.

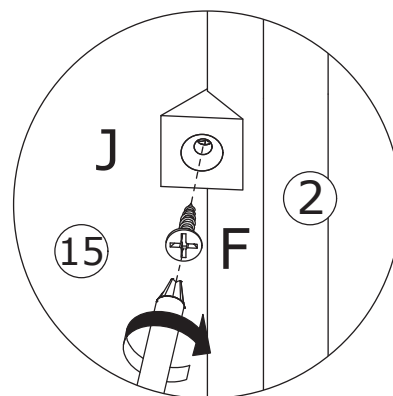
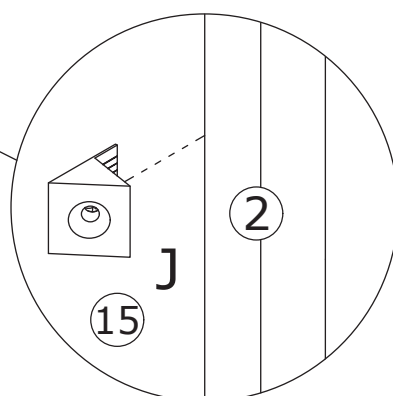

12

K x 8



N x 16



Insert layer pin(K) and (N) into board 2, 3 and 4, place shelf board 5 and 8 on as shown.

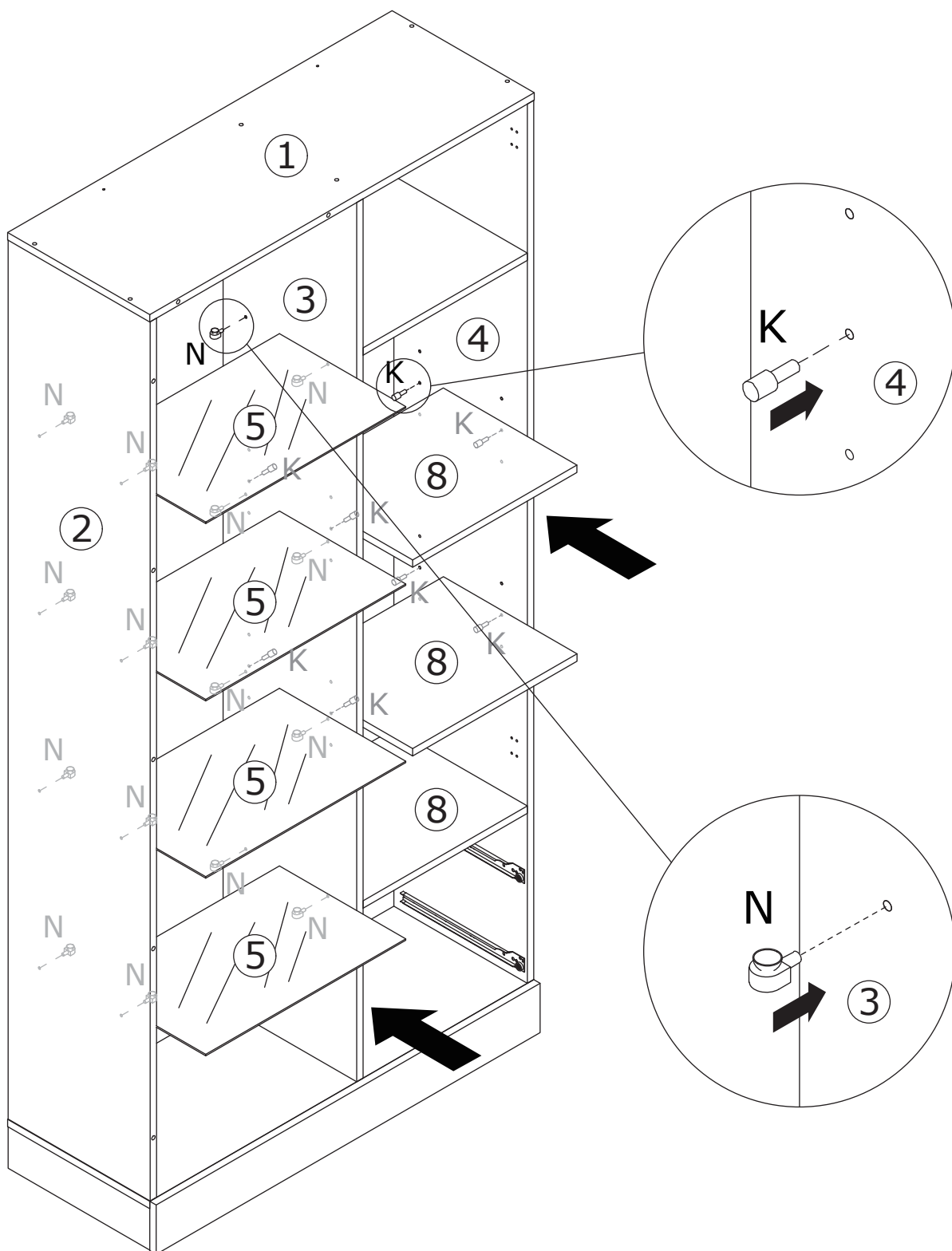

13

A x 7

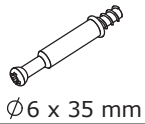

C x 2

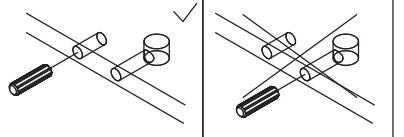
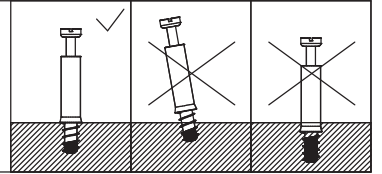
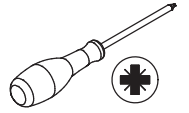

Screw eccentric rod(A) into board 9 and 10 at first.
Connect board 9 to board 10 using wooden dowel(C) as shown.

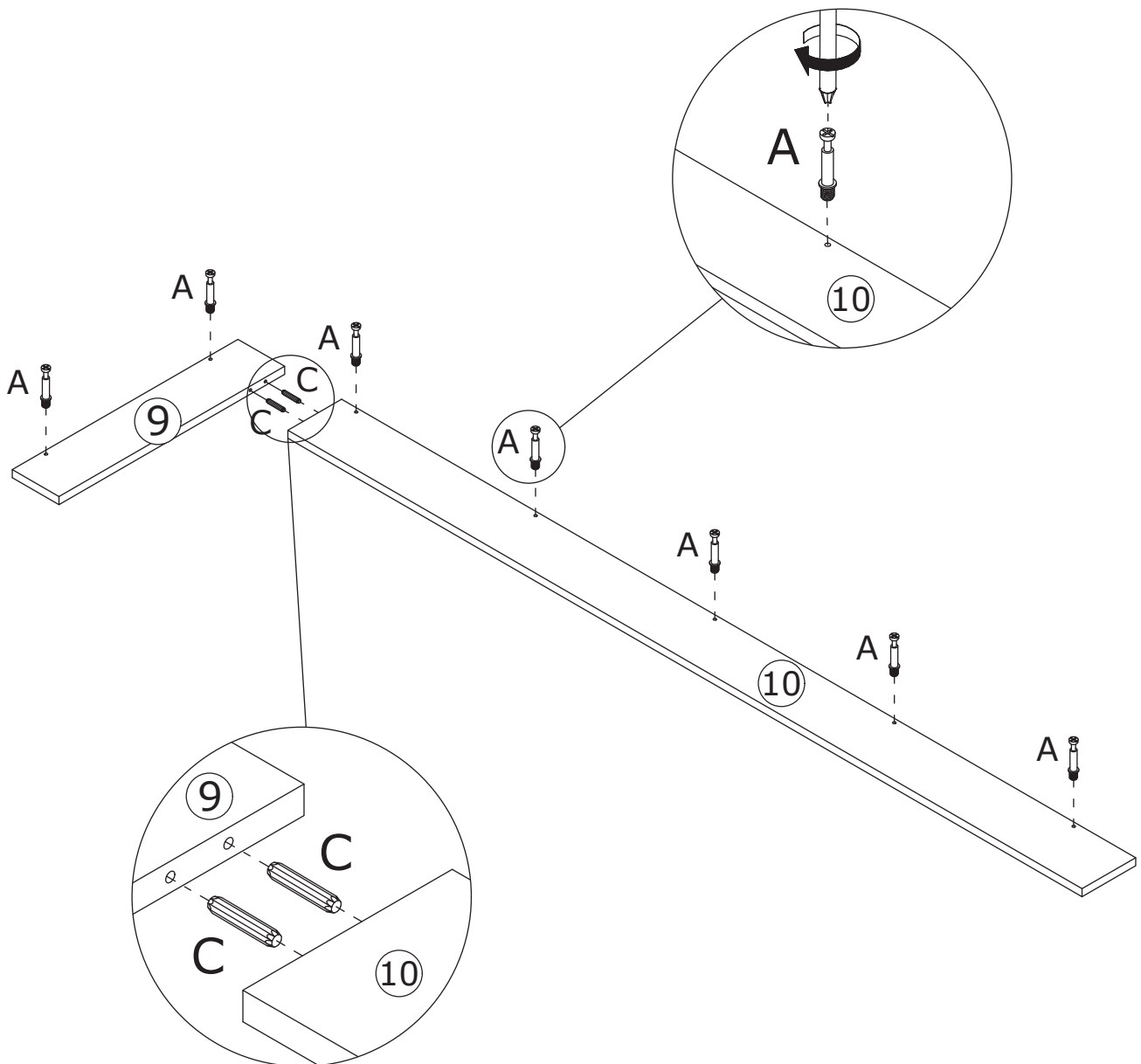

14

B x 7



Ø 15 x 10 mm

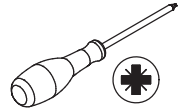

Attach board 9 and 10 to board 1 and 2, add cam lock(B) into board 1, 2 and turn clockwise to tighten as shown.

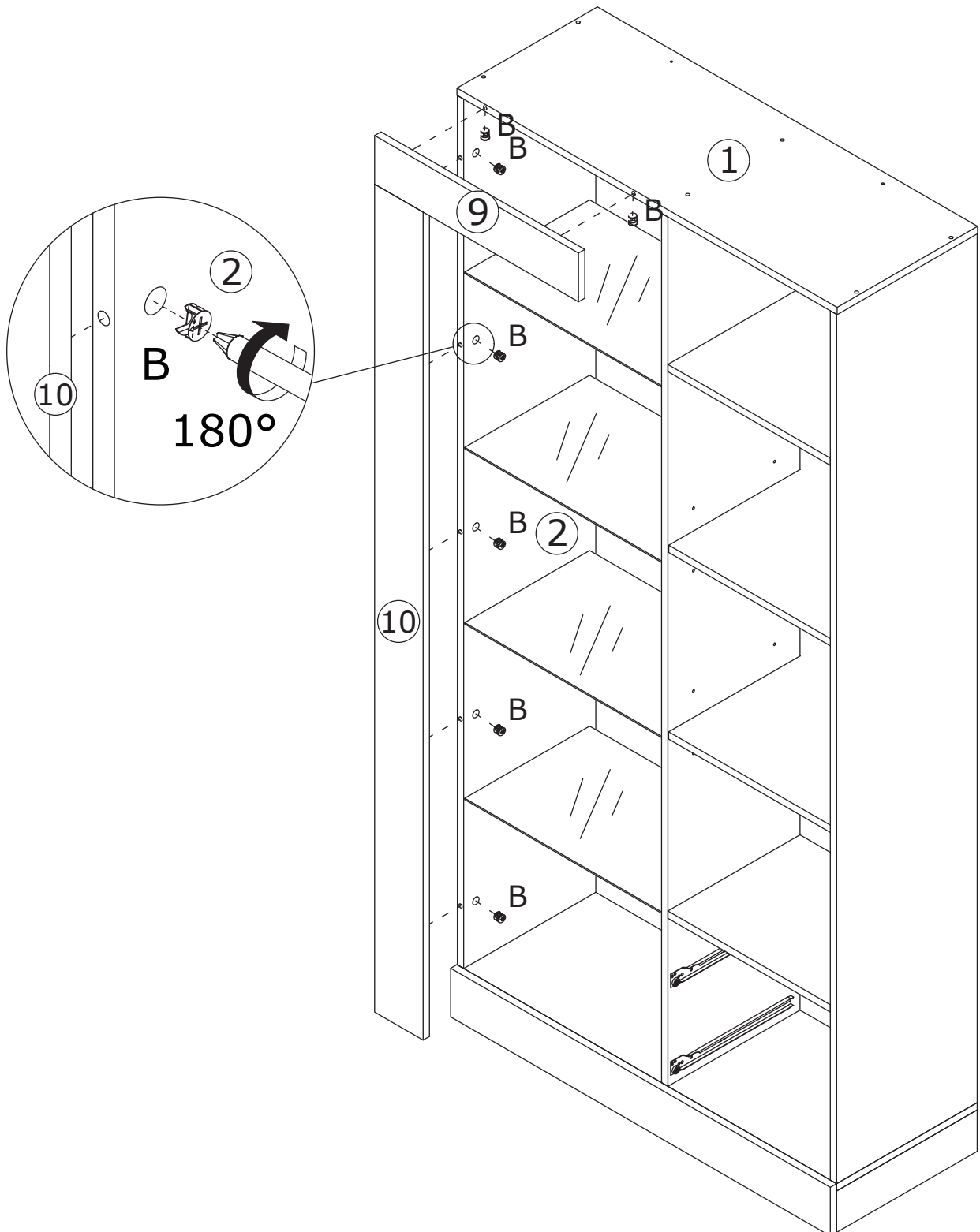
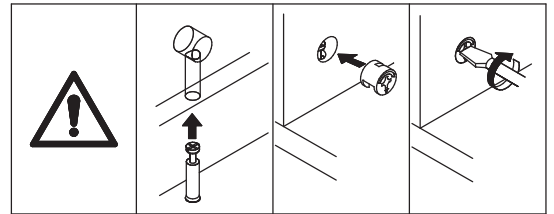

15

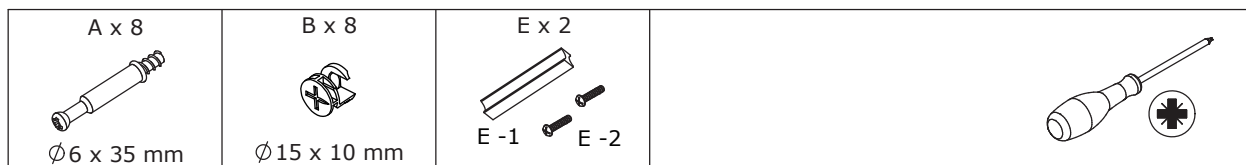

Screw eccentric rod(A) into board 32 and fix handle(E) at first.
Attach board 35 and 36 to board 32, add cam lock(B) into and turn clockwise to tighten as shown.

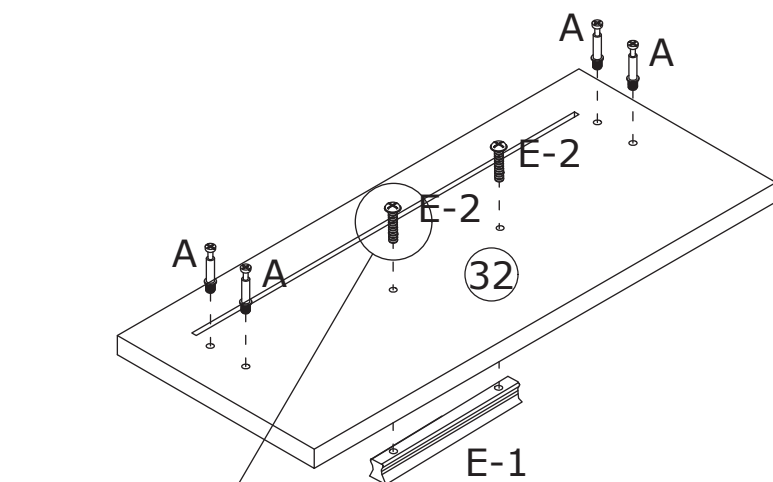
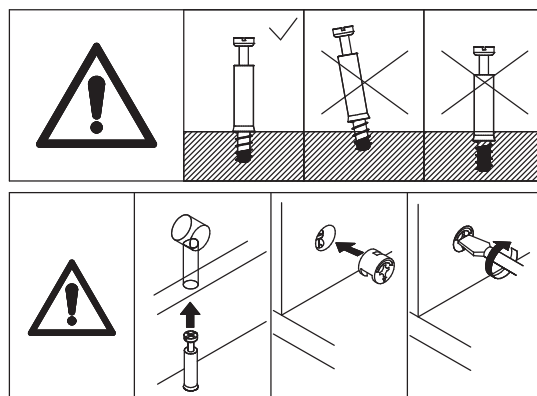

x2

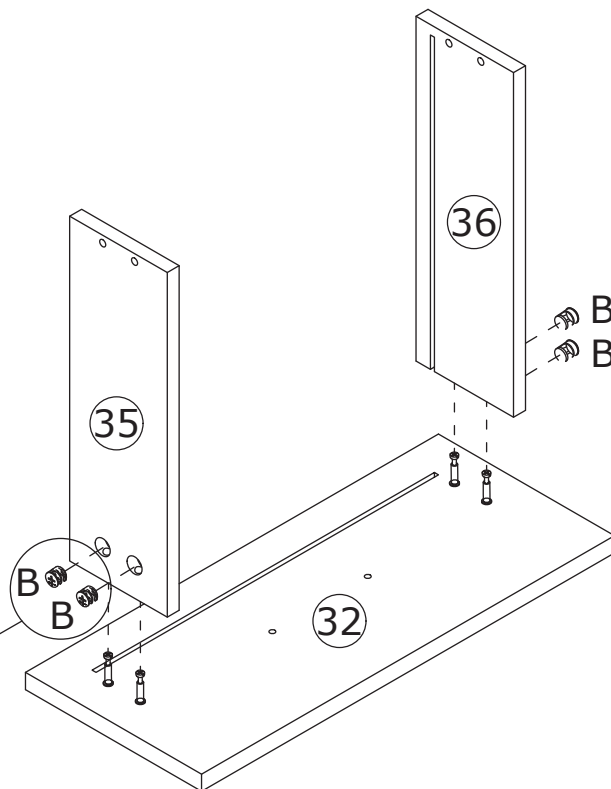
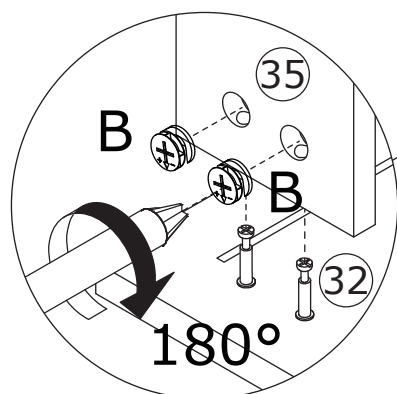
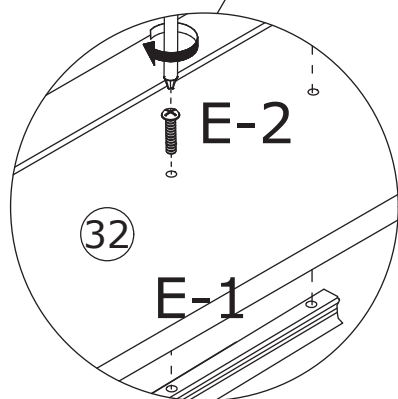

x2

16

D x 8



F x 8

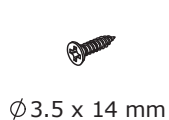

G x 2

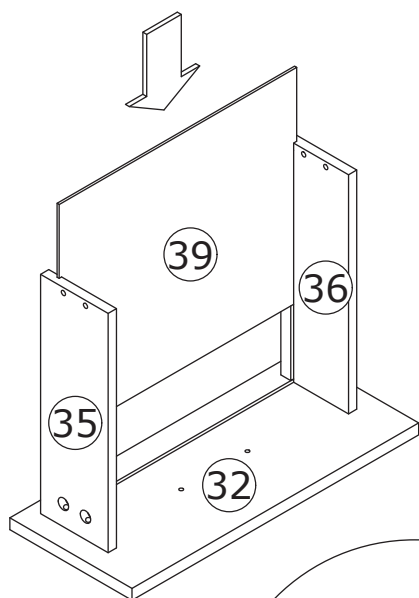
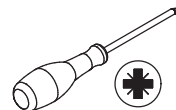
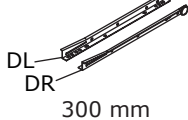

x2

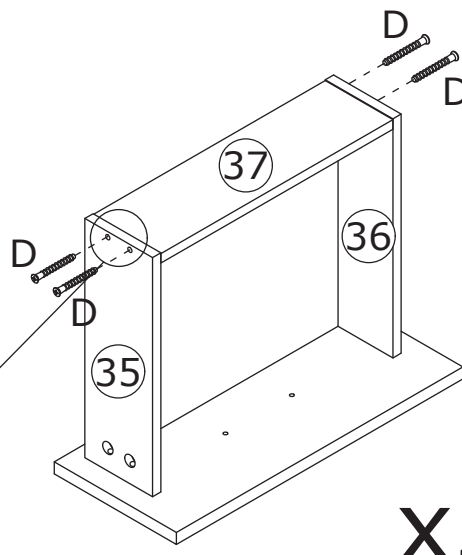

x2

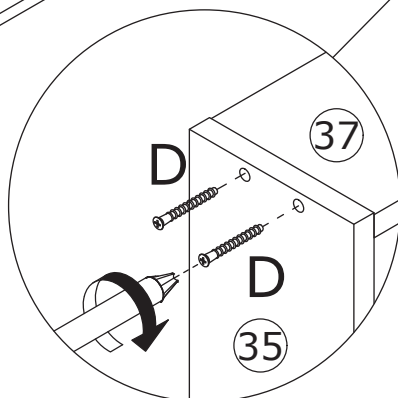

Insert bottom board 39 along available grooves.
Fix board 37 to board 35 and 36 with screw(D) as shown.
Fix rail(DL) and (DR) to board 35 and 36 with screw(F) as shown.

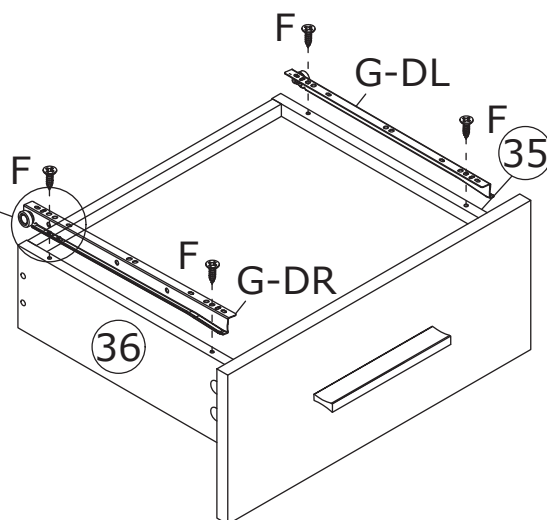
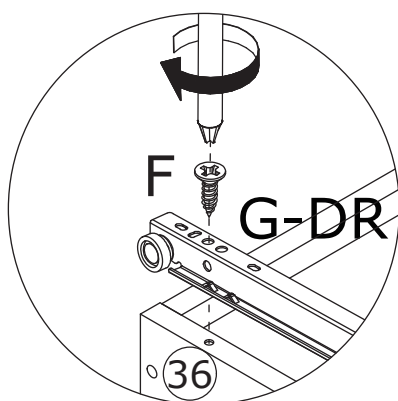



x2

17

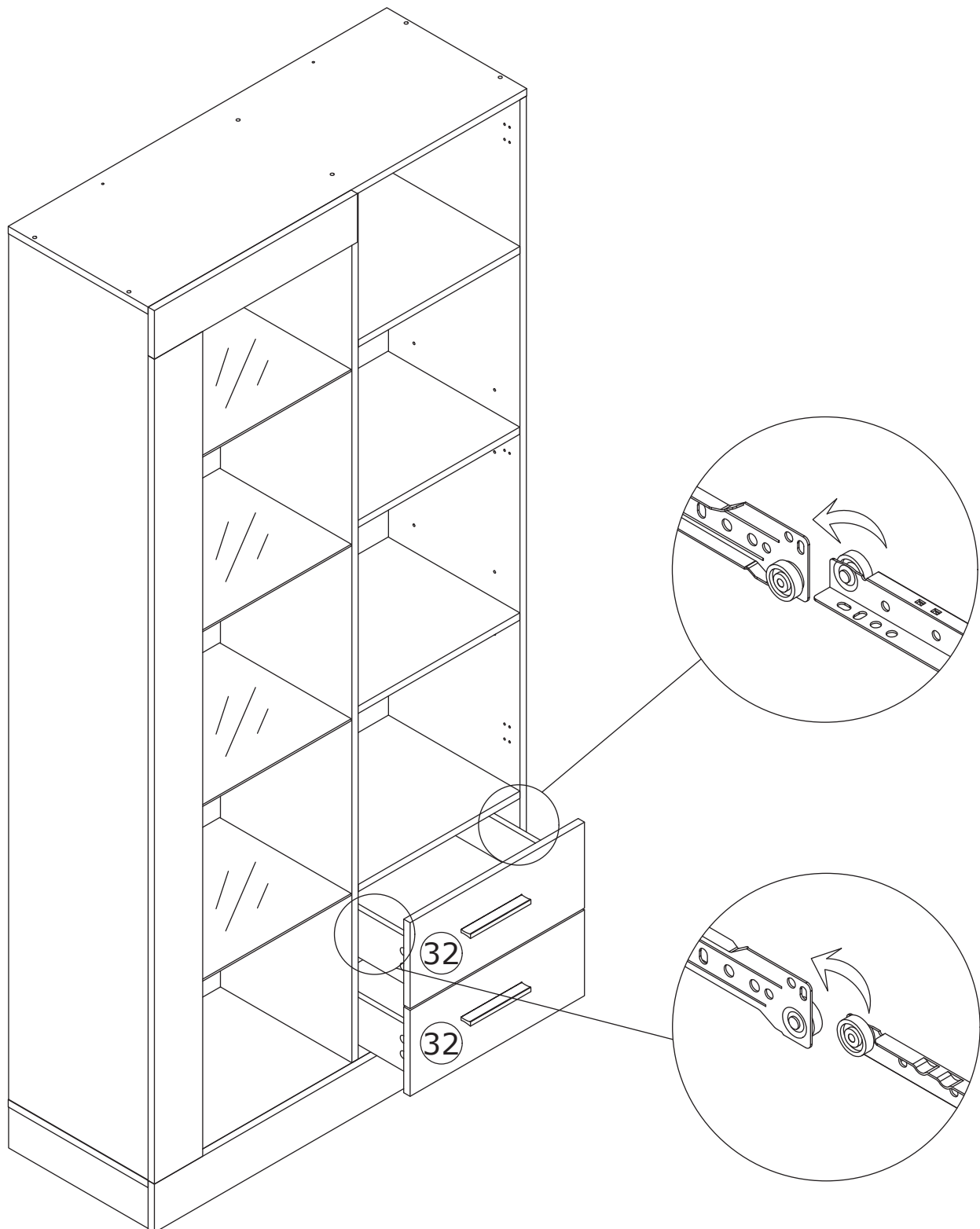
Align rails, insert the drawers in.

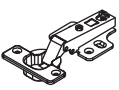
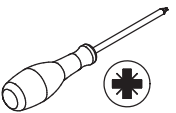

18

<p>E x 1</p>  <p>E -1</p> <p>E -2</p>	<p>F x 6</p>  <p>Ø3.5 x 14 mm</p>	<p>H x 3</p>  <p>ZB</p>	
--	--	--	---

Fix hinge(H) to board 19 with screw(F) and fix handle(E) as shown.

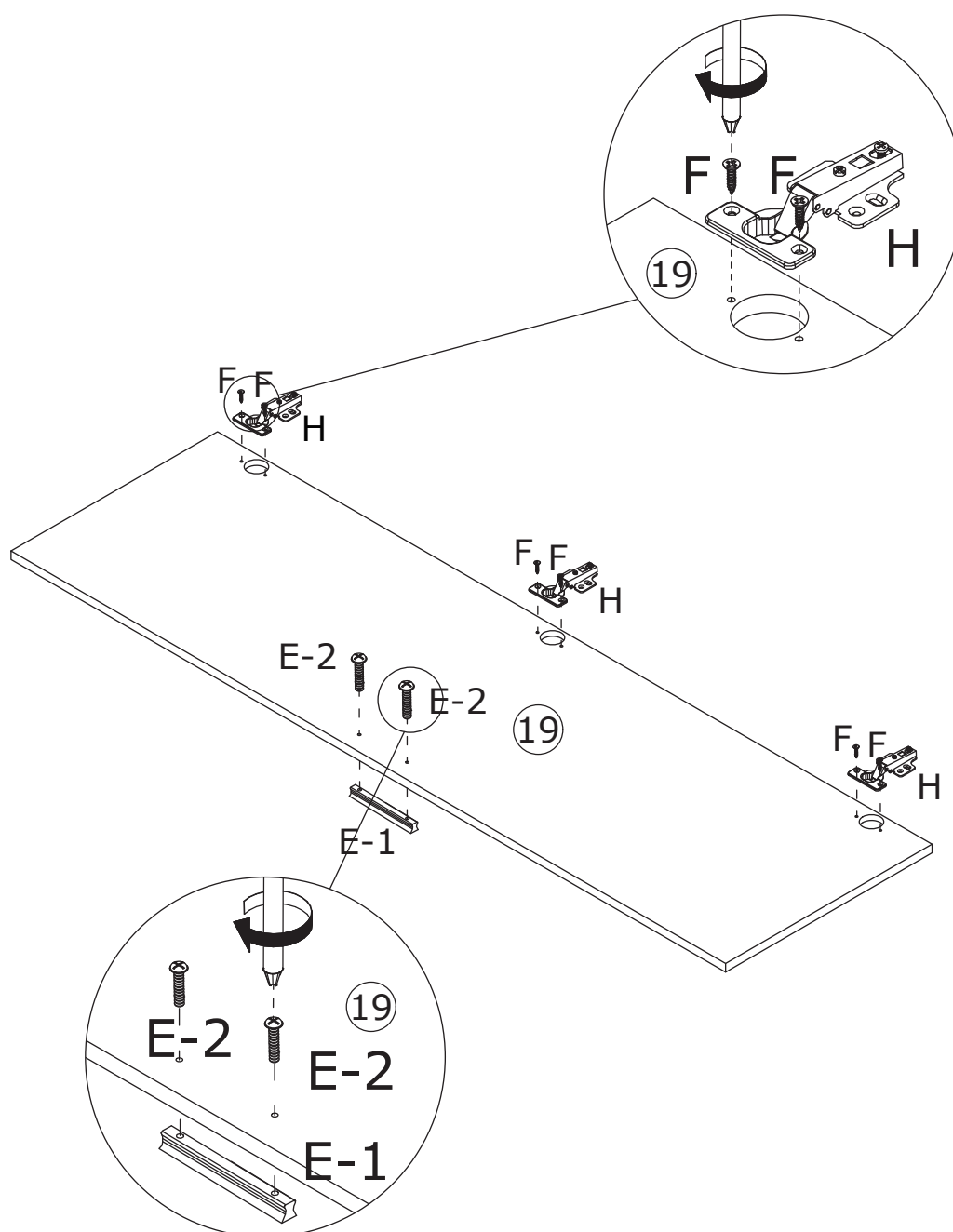

19

F x 12



Ø 3.5 x 14 mm

L x 2



Ø 3.5 x 14 mm

O x 2



O - 3

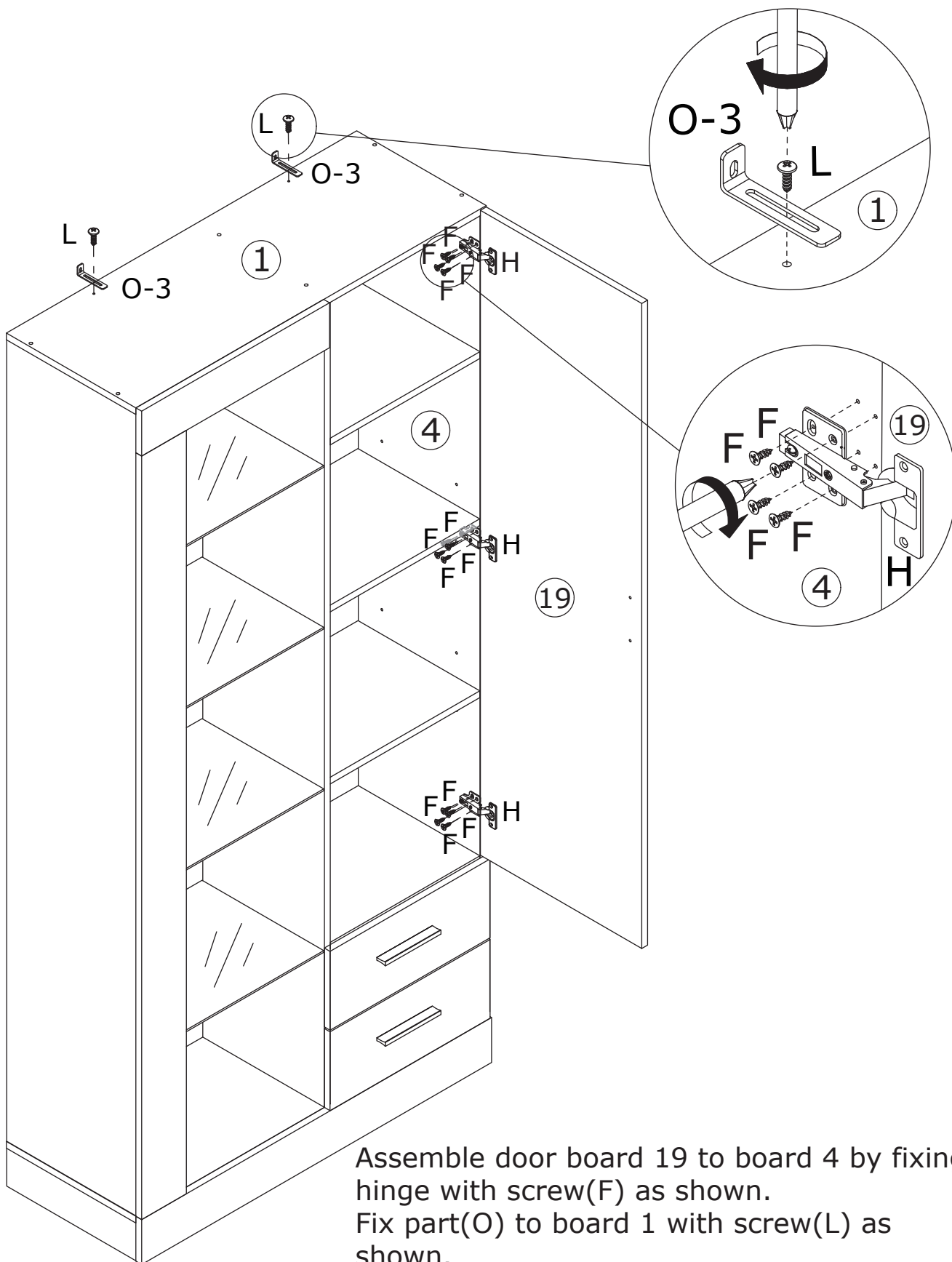
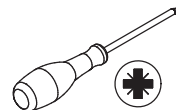

Assemble door board 19 to board 4 by fixing hinge with screw(F) as shown.
Fix part(O) to board 1 with screw(L) as shown.

20

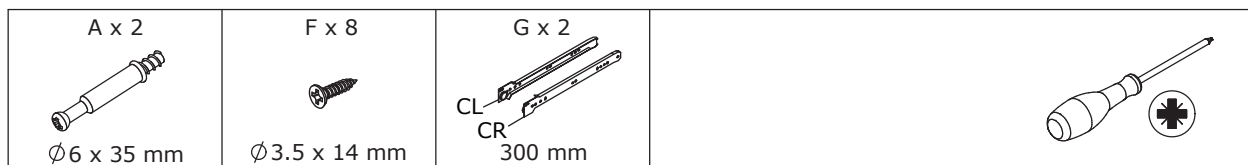

Screw eccentric rod(A) into board 21 and 23 at first.
Fix rail(CL) and (CR) to board 21 and 23 with screw(F) as shown.

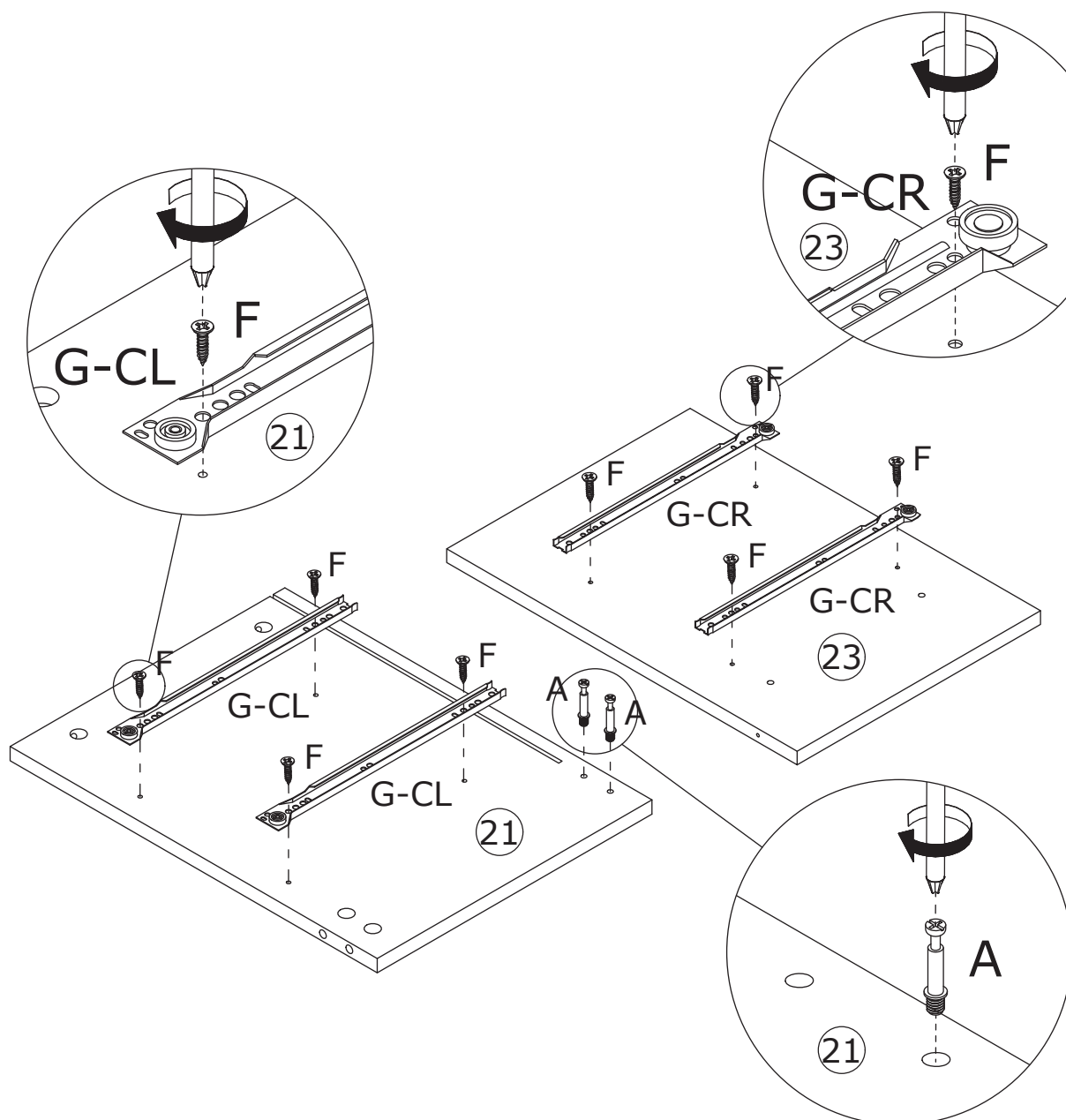
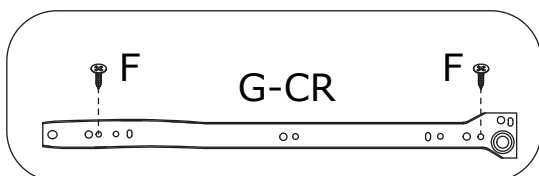
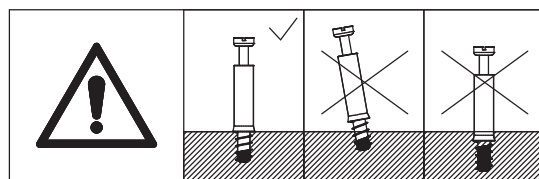

21

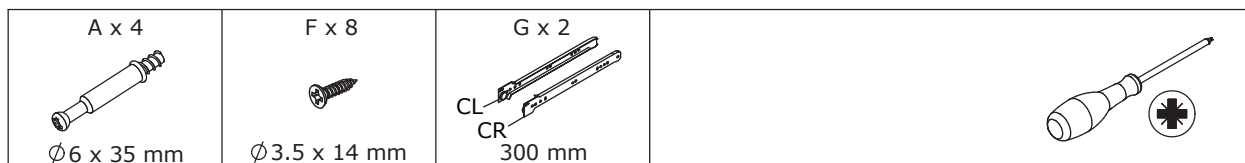

Fix rail(CL) to board 22 using screw(F) at first.

Flip to back, fix rail(CR) using screw(F) as shown.

Screw eccentric rod(A) into board 24.

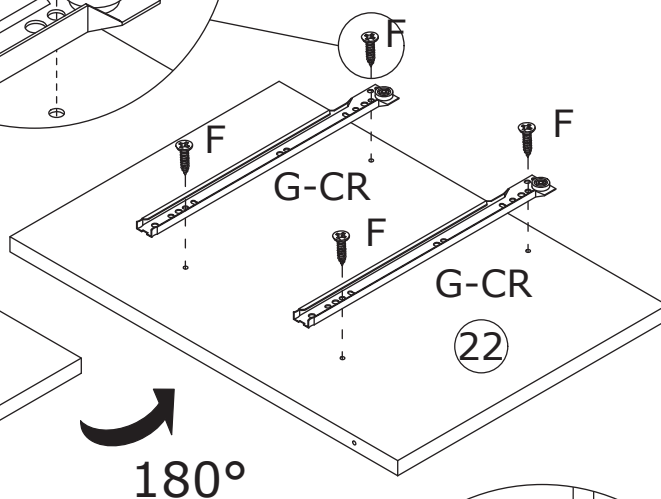
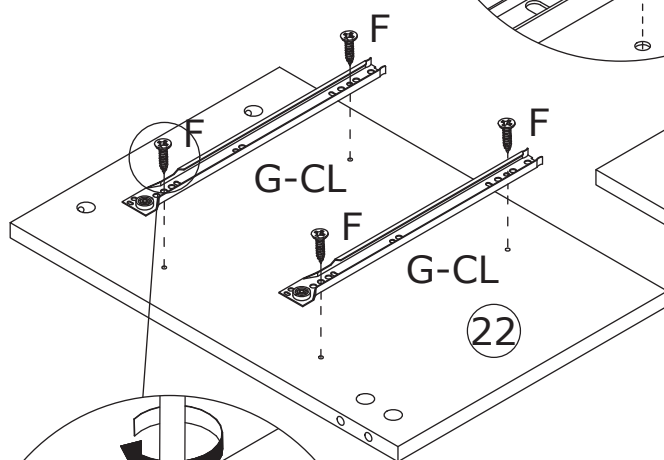
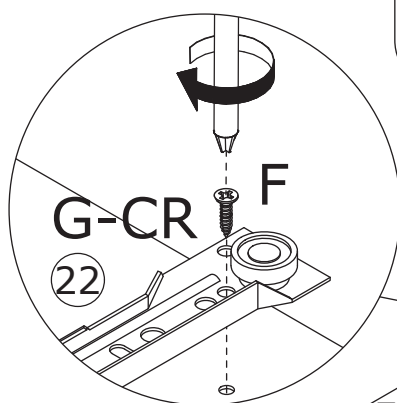
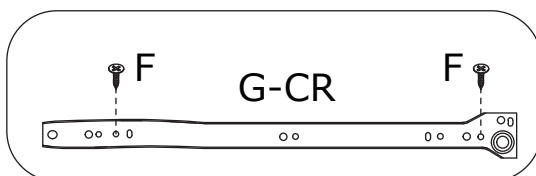
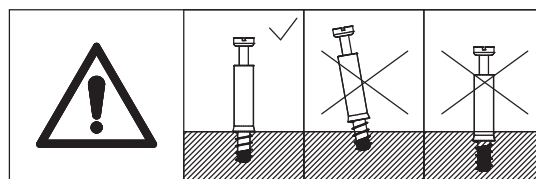

180°

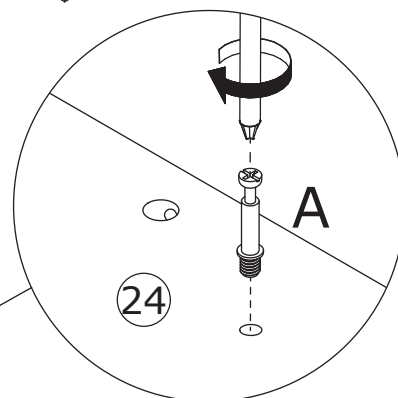
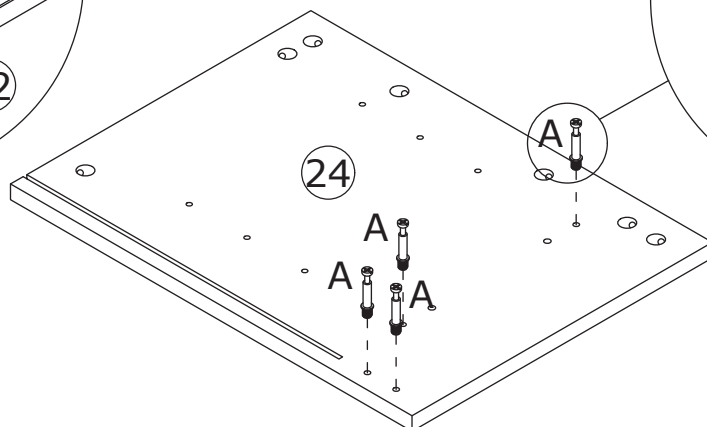
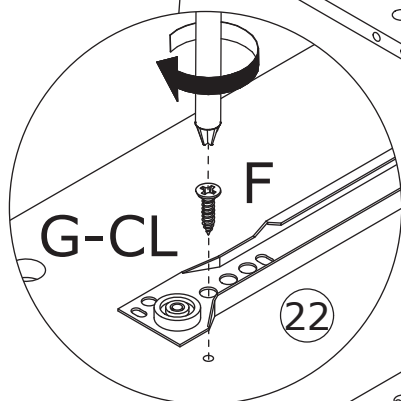

22

B x 2



Ø 15 x 10 mm

C x 2



Ø 6 x 30 mm

D x 2

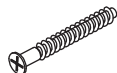

Ø 5 x 40 mm

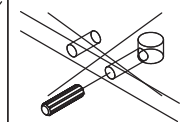
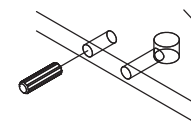
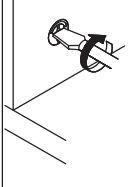
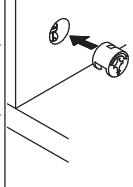
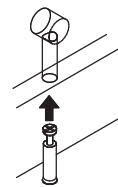
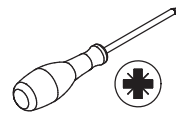

Attach board 25 to board 24 using wooden dowel(C),
add cam lock(B) into and turn clockwise to tighten as shown.
Fix board 23 to board 25 with screw(D) as shown.

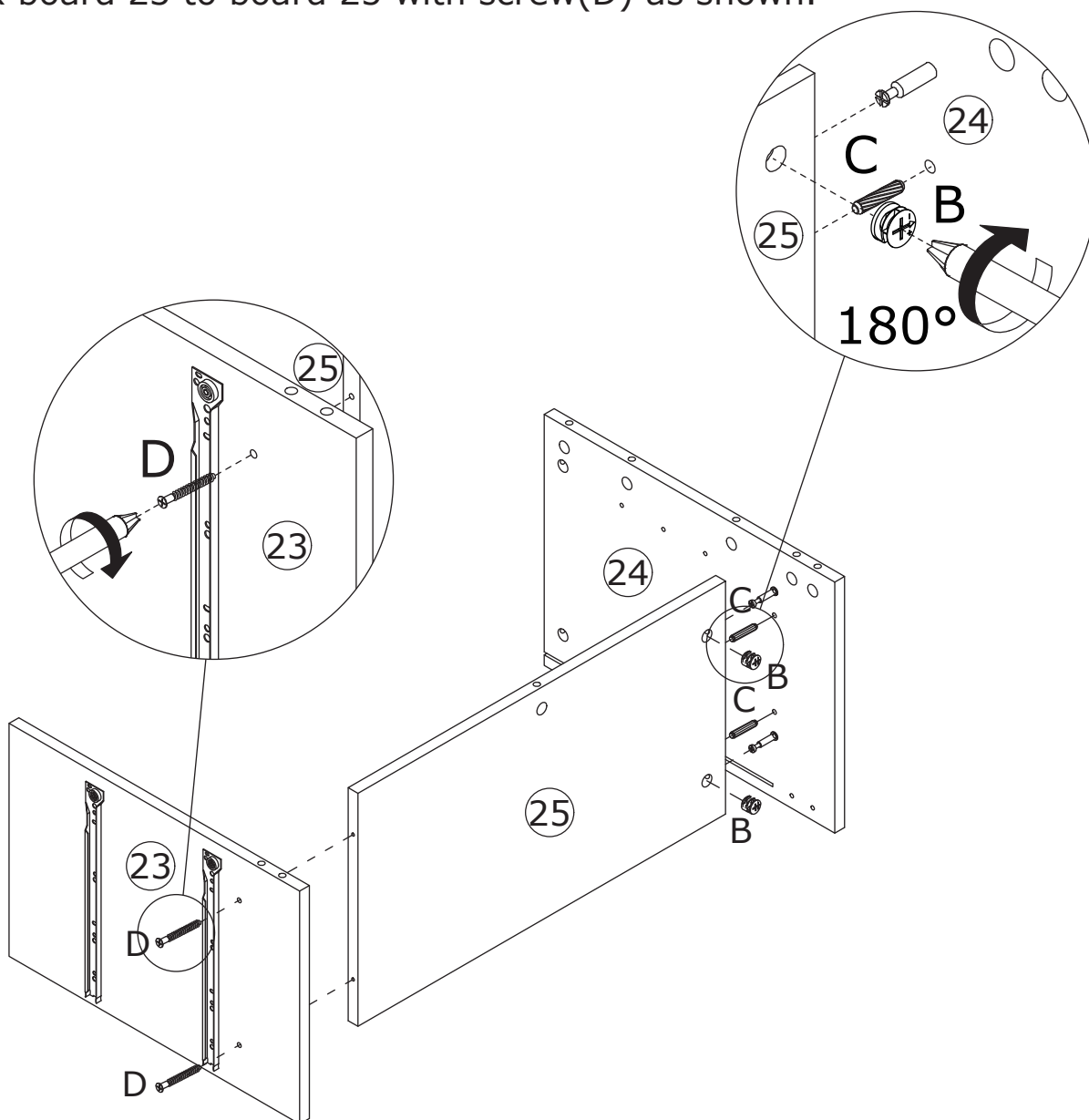

23

B x 4



Ø 15 x 10 mm

D x 2

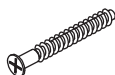

Ø 5 x 40 mm

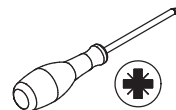

Attach board 21 and 24 to board 30, add cam lock(B) into and turn clockwise to tighten as shown.
Fix board 23 and 22 to board 30 with screw(D) as shown.

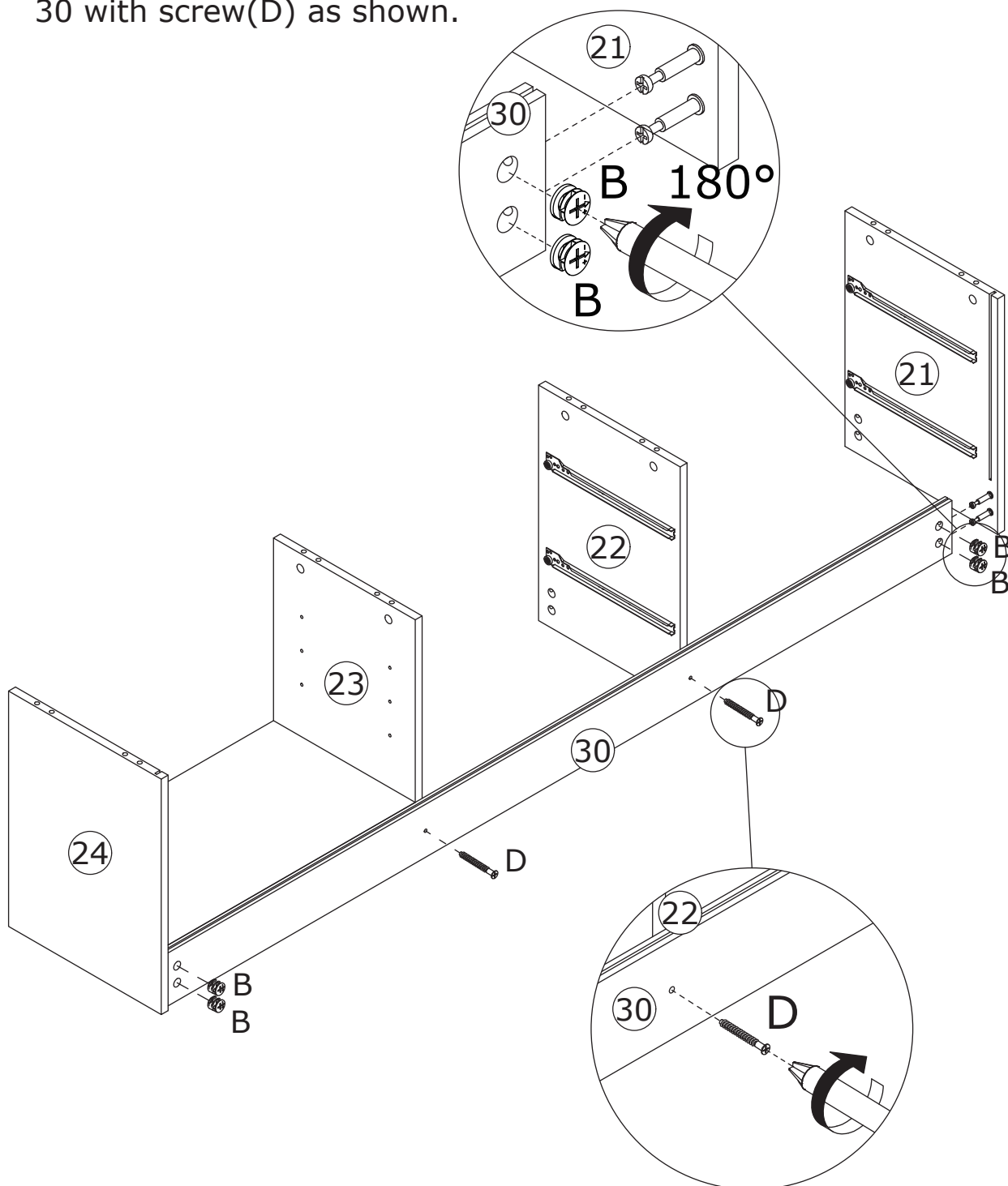
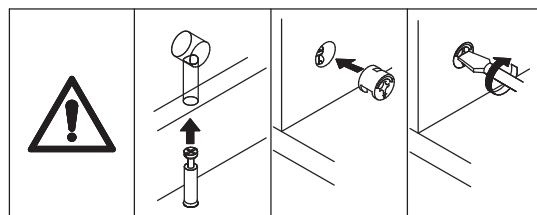

24

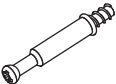
A x 14

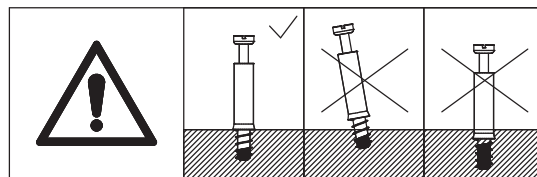
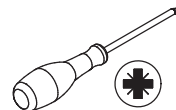
 Ø6 x 35 mm

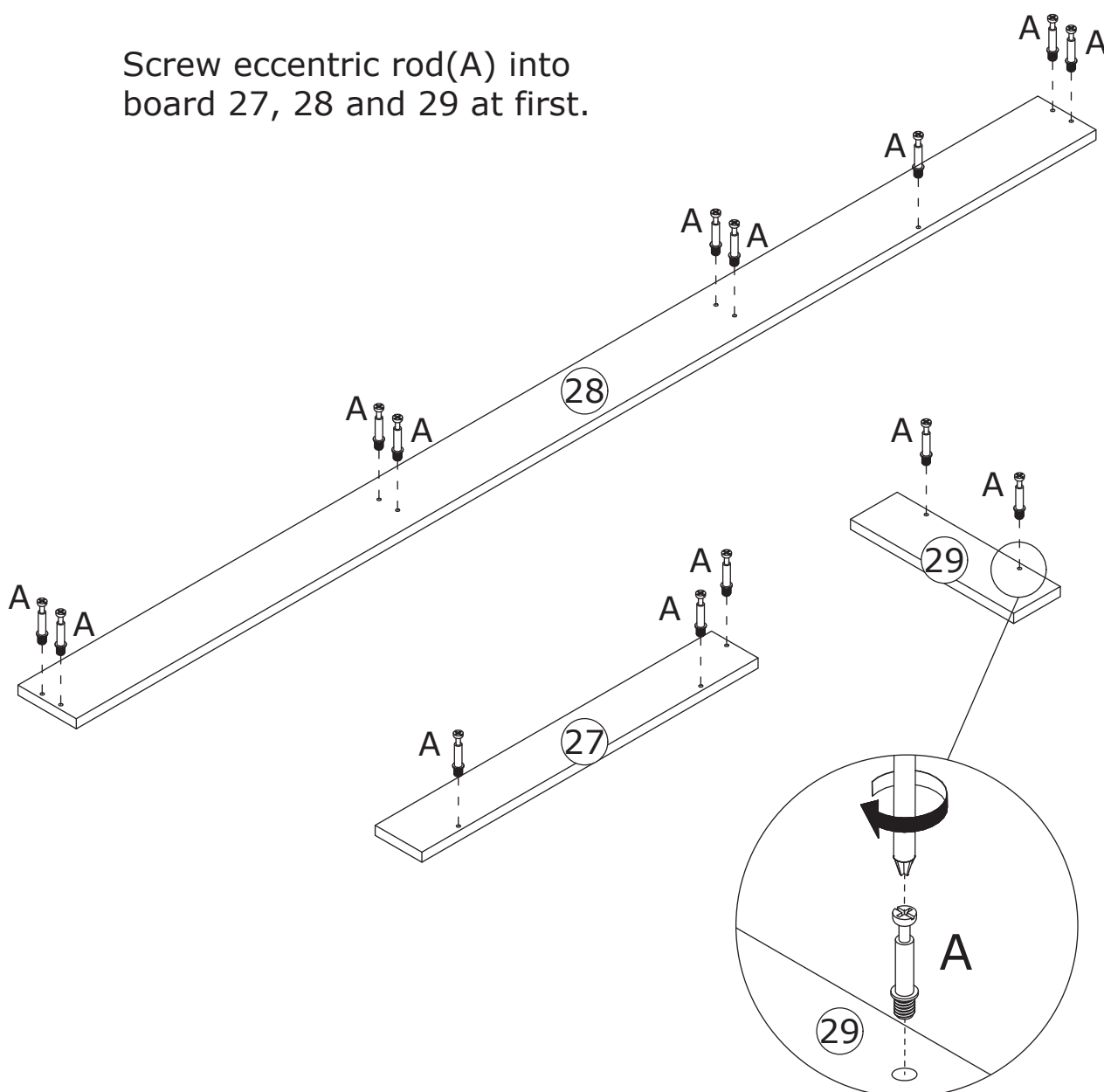

Screw eccentric rod(A) into board 27, 28 and 29 at first.



25

B x 9



Ø 15 x 10 mm

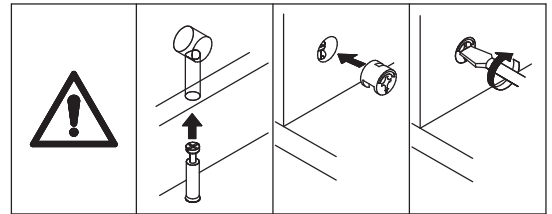
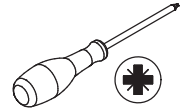

Attach board 28 to board 21, 22, 23, 25 and 24, add cam lock(B) into and turn clockwise to tighten as shown.

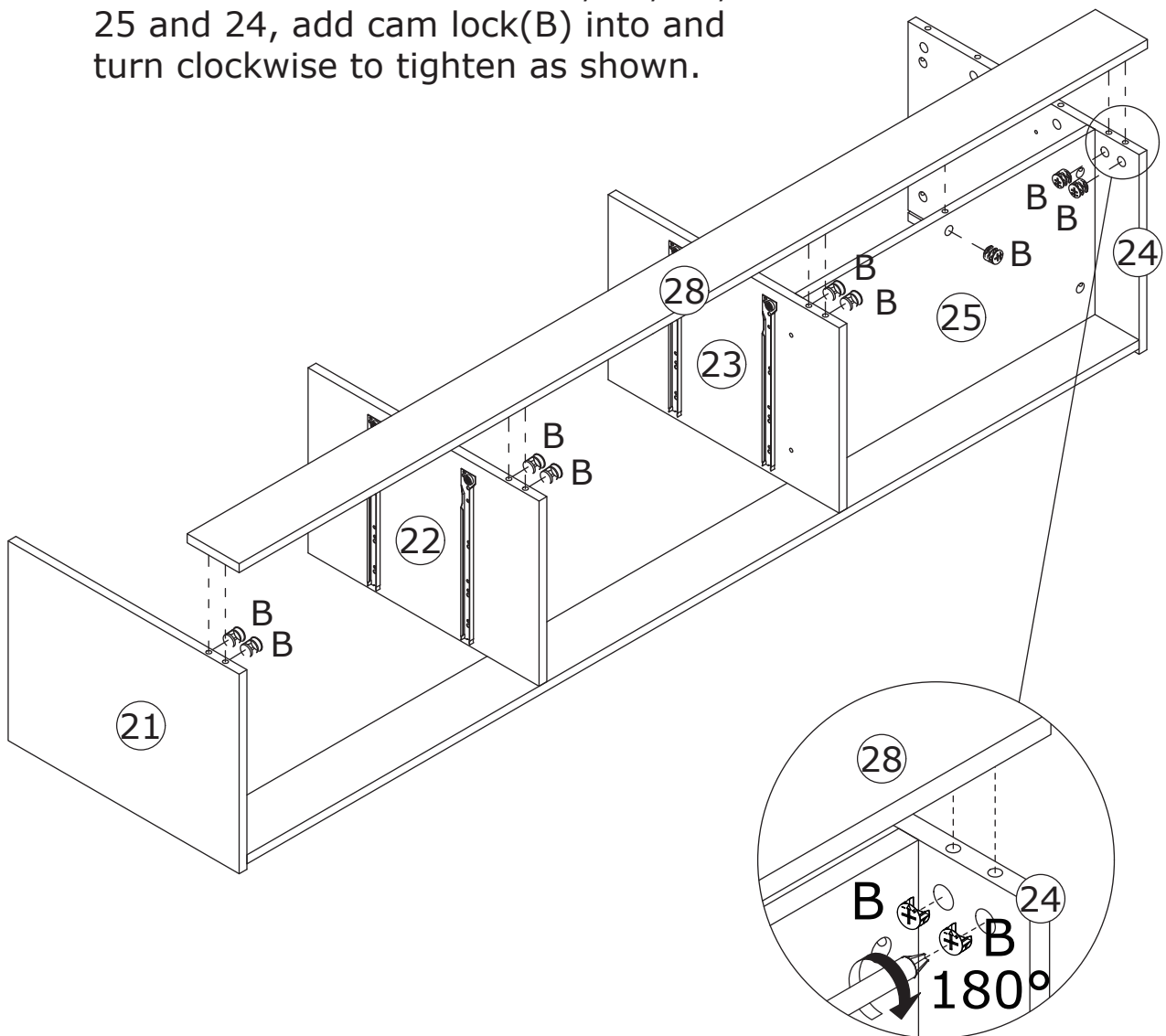

26

Insert back board 31
along available grooves.

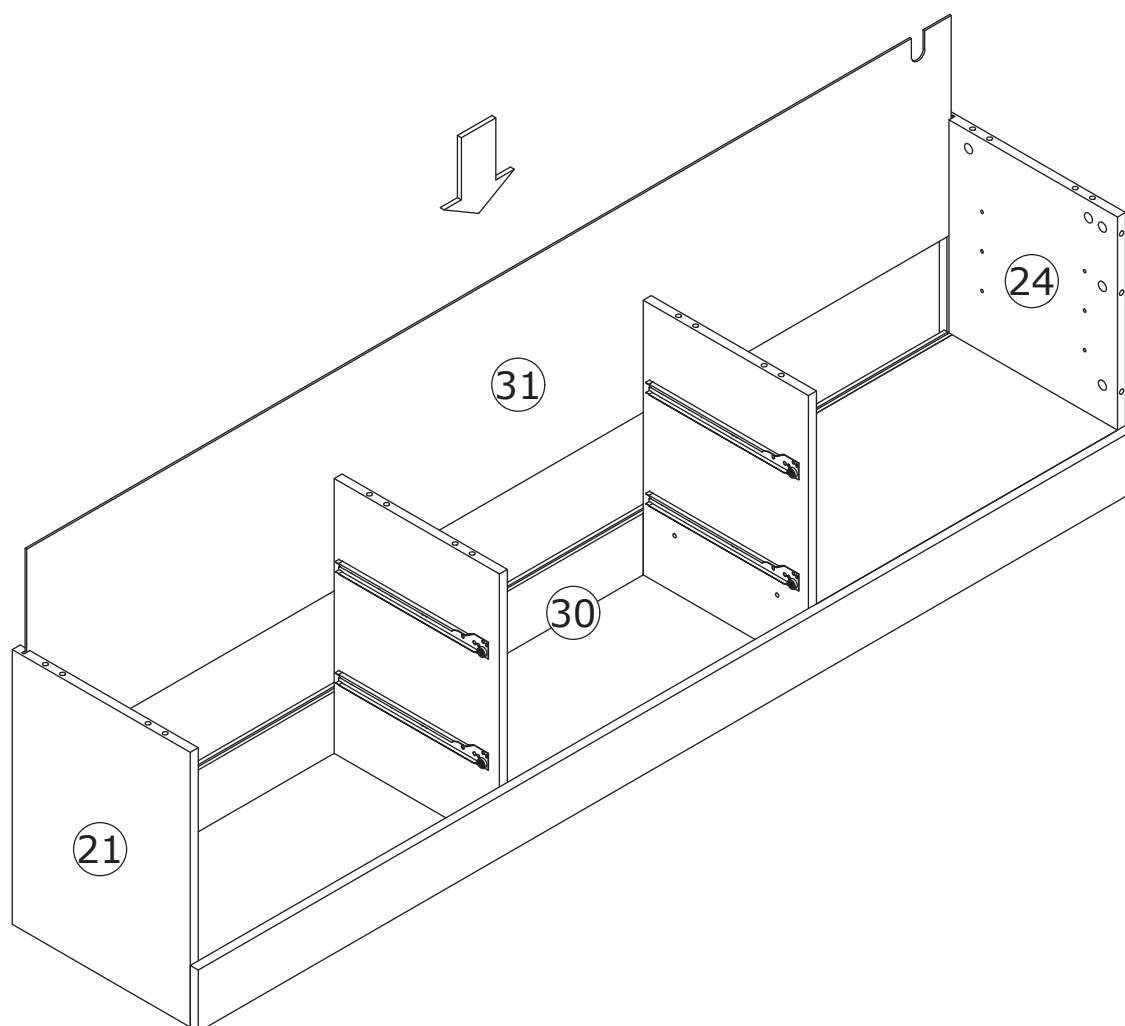

27

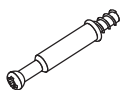
A x 8

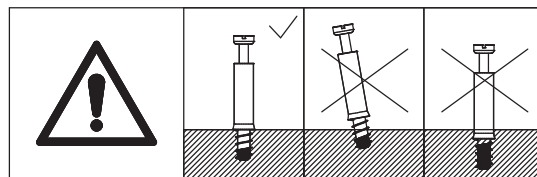
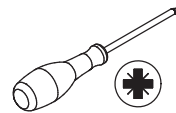
 Ø6 x 35 mm

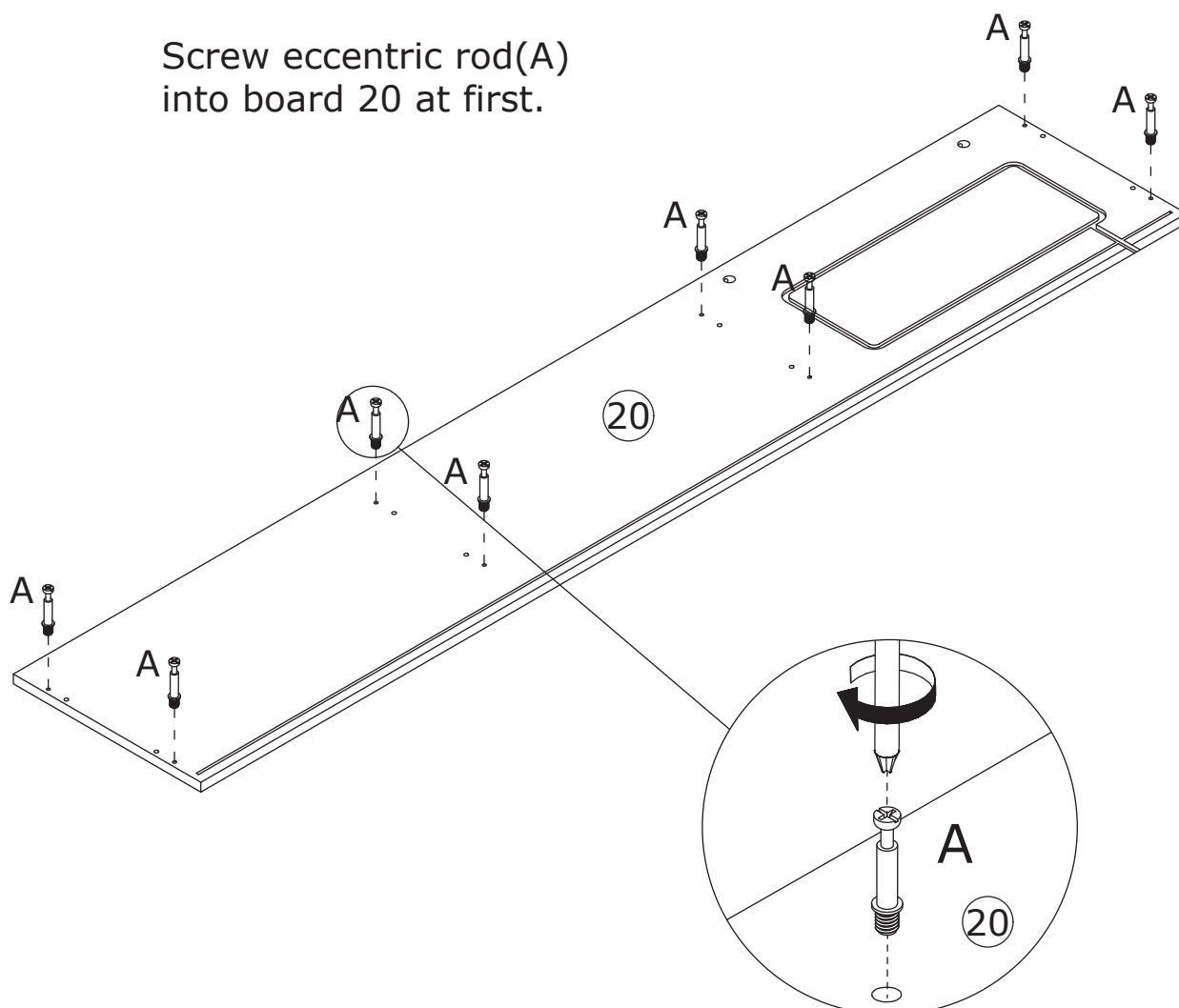

Screw eccentric rod(A)
 into board 20 at first.



28

B x 8



Ø 15 x 10 mm

C x 8



Ø 6 x 30 mm

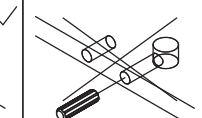
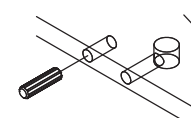
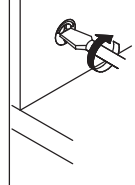
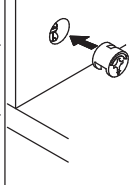
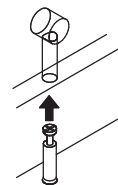
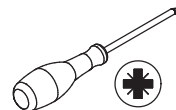

Cover board 20 to board 21, 22, 23 and 24 using wooden dowel(C), add cam lock(B) into board 13, 7, 14 and turn clockwise to tighten as shown.

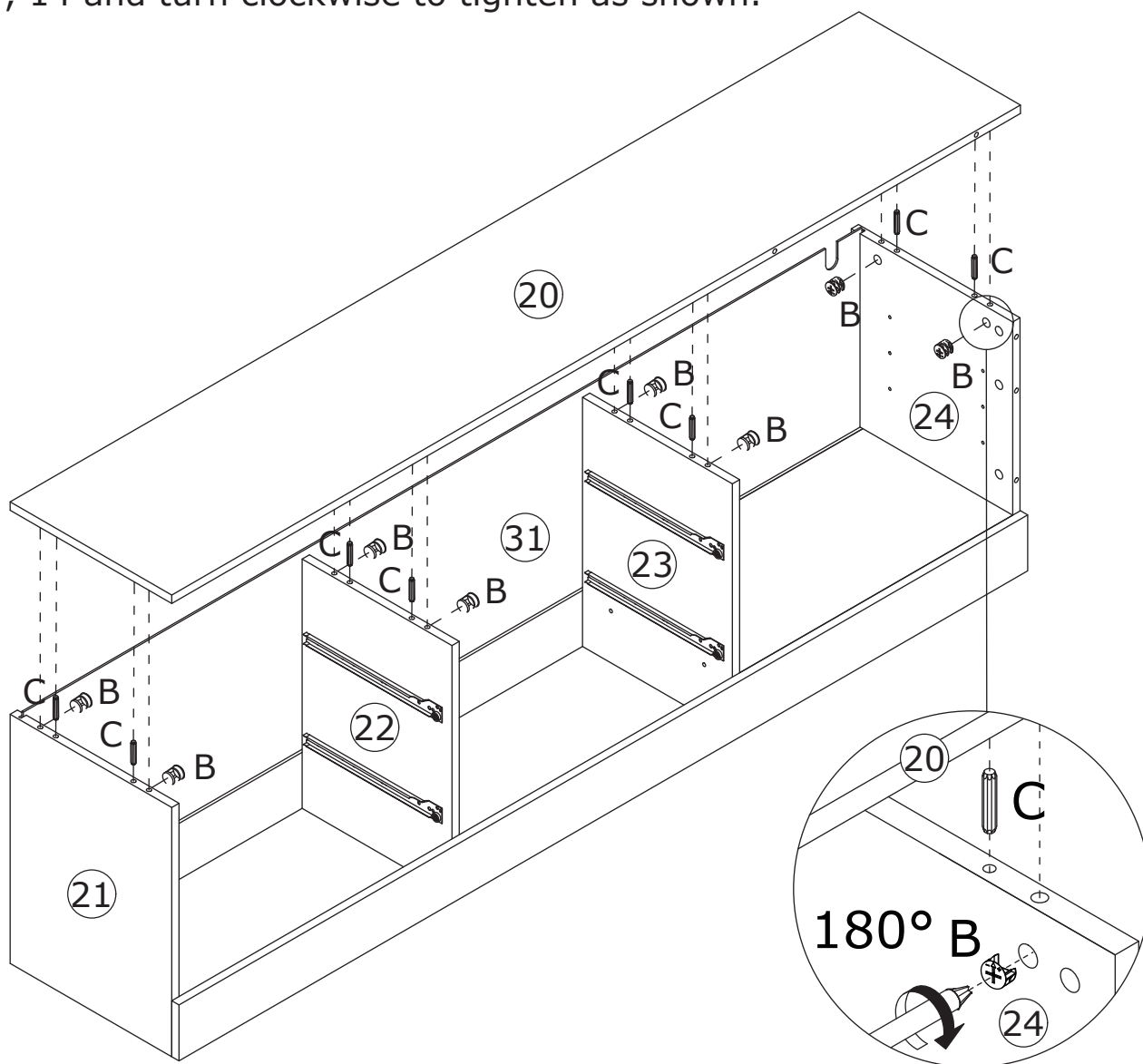

29

F x 16



Ø 3.5 x 14 mm

J x 16

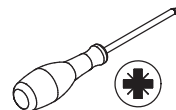

Insert buckle(J) into back slots
and fix with screw(F) as shown.

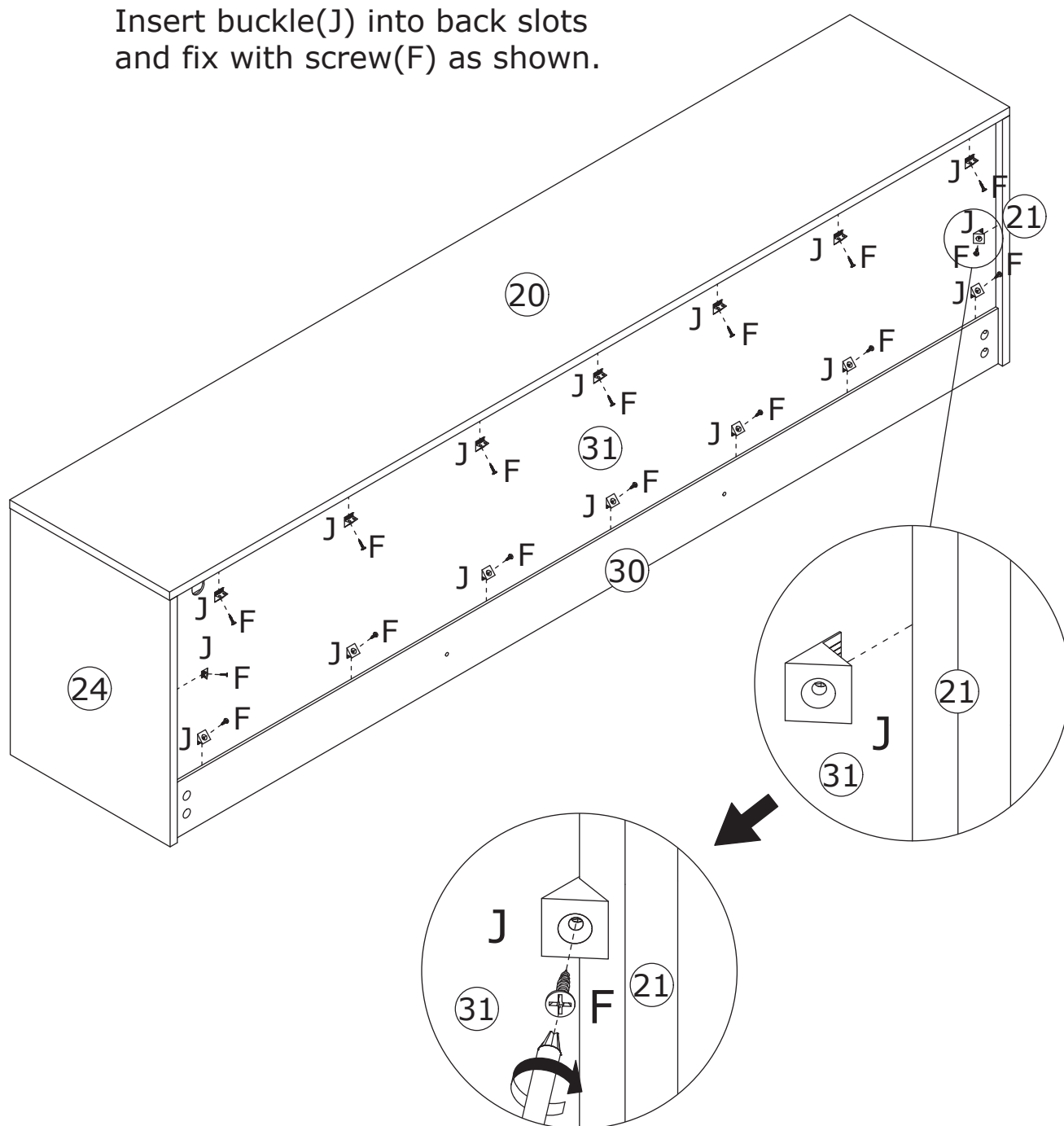

30

N x 4



Insert layer pin(N) into board 23 and 24, place shelf board 26 on as shown.

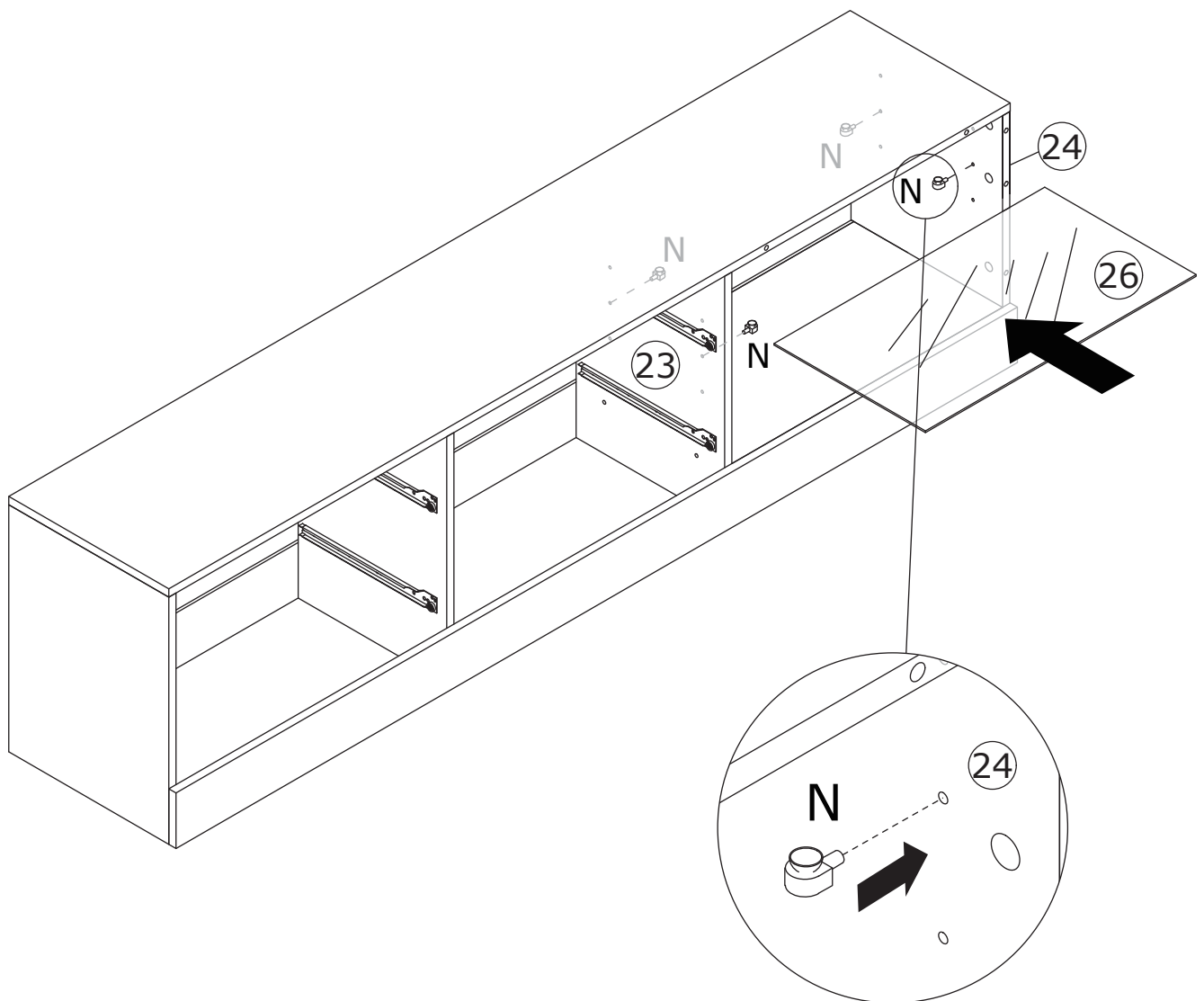

31

B x 5



Ø 15 x 10 mm

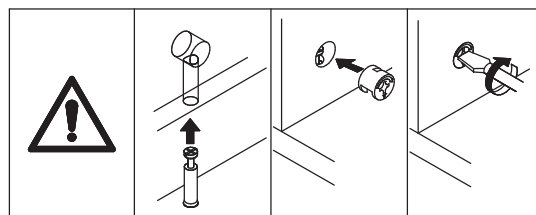
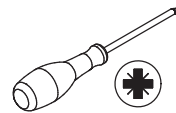

Attach board 27 and 29 to board 20 and 24, add cam lock(B) into and turn clockwise to tighten as shown.

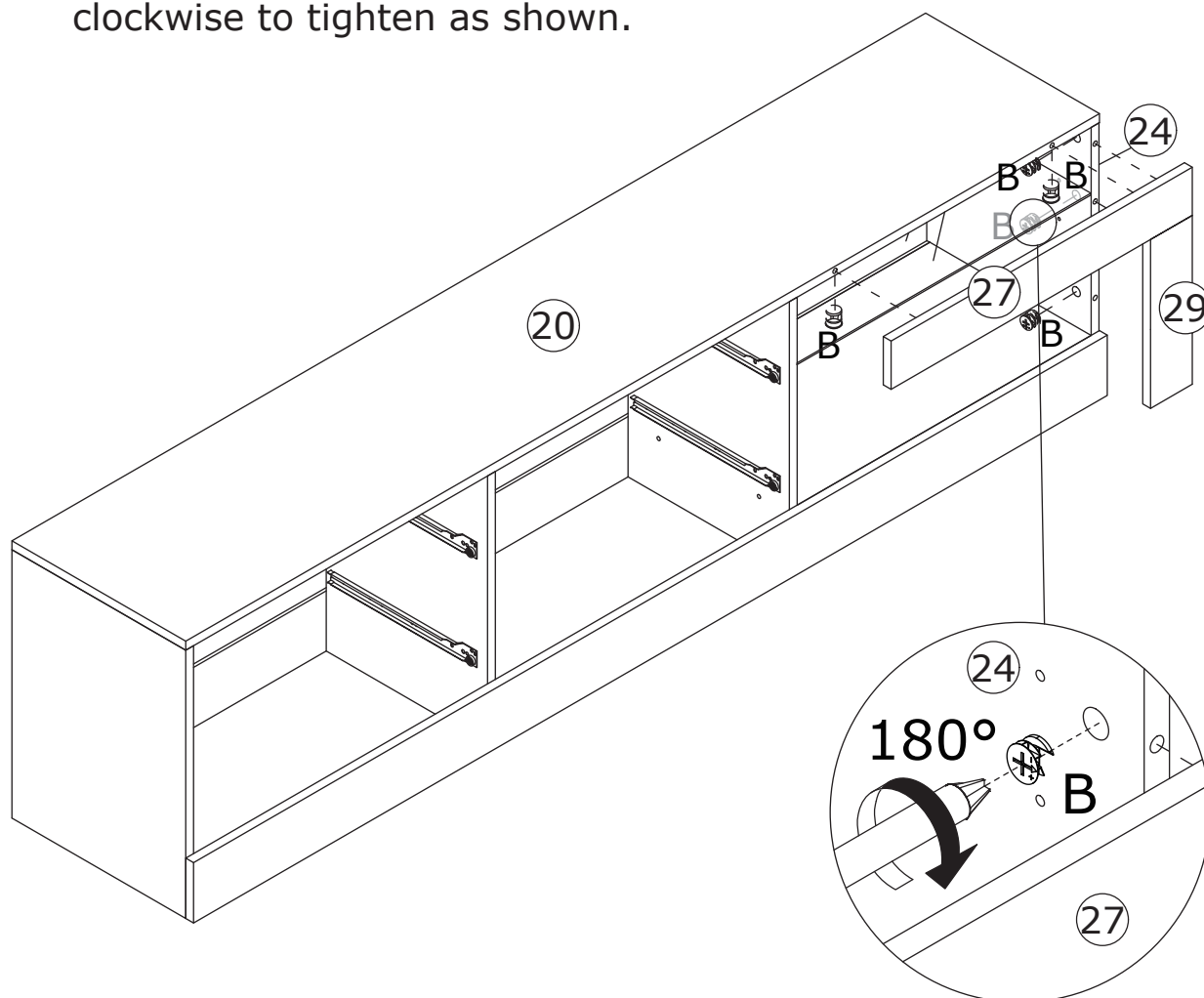

32

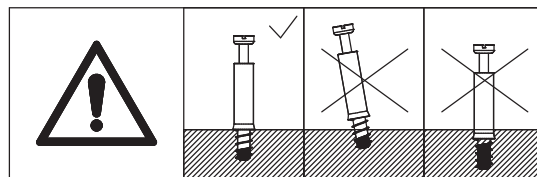
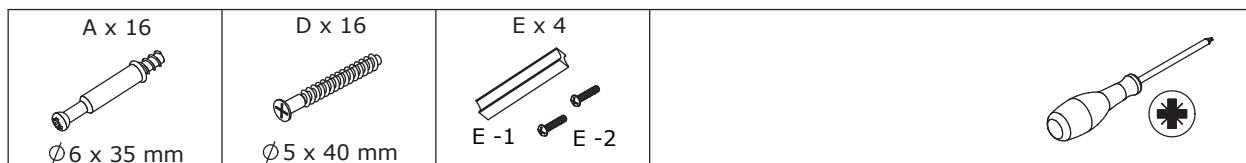

Screw eccentric rod(A) into board 33, 34 and fix handle(E) at first.
 Fix board 38 to board 35 and 36 with screw(D) as shown.
 Insert bottom board 40 along available grooves.

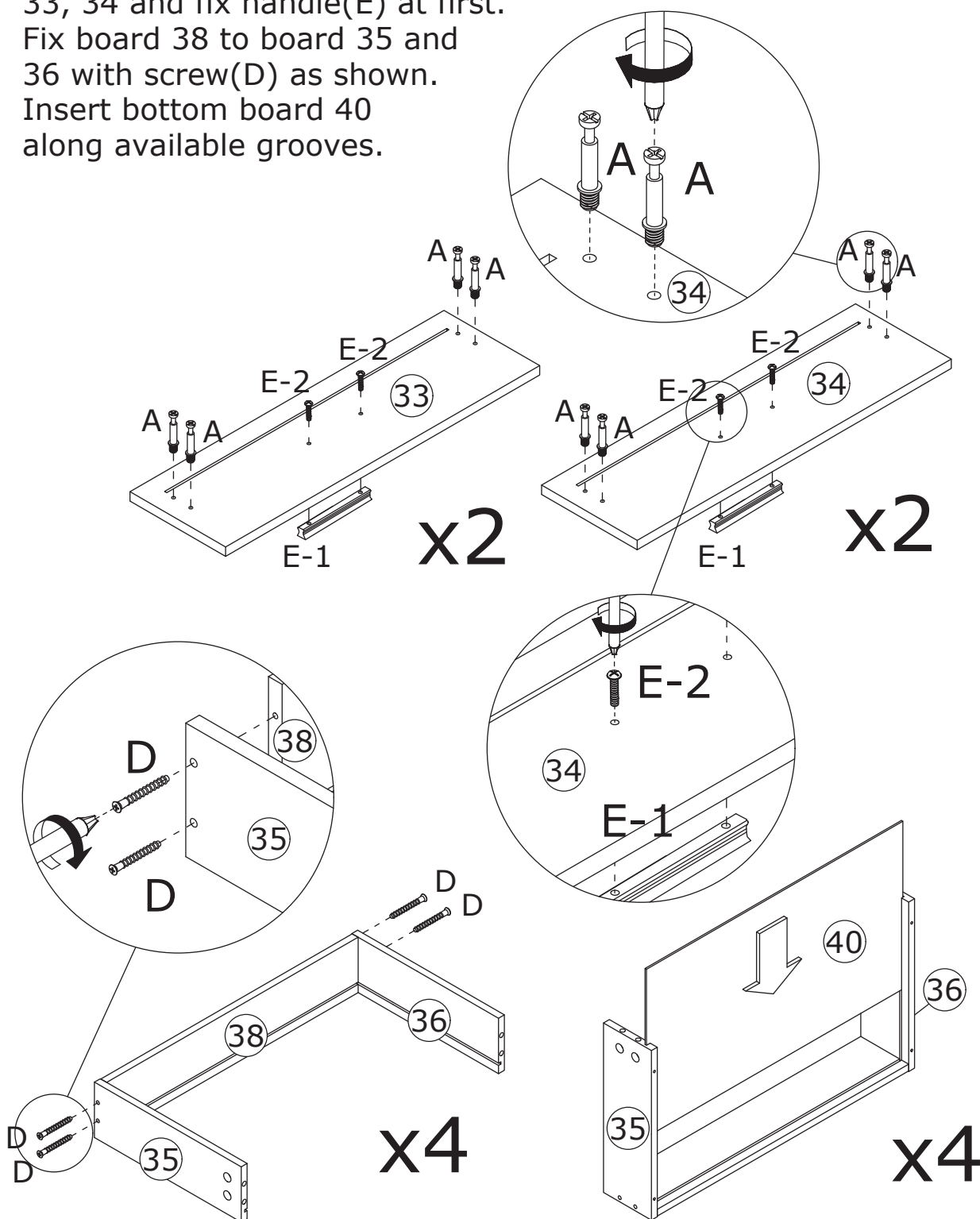

33

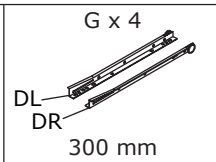
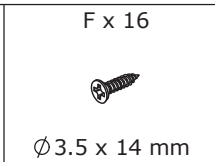
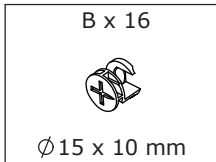

Attach board 33 and 34 to board 35 and 36, add cam lock(B) into and turn clockwise to tighten as shown. Fix rail(DL) and (DR) to board 35 and 36 with screw(F) as shown.

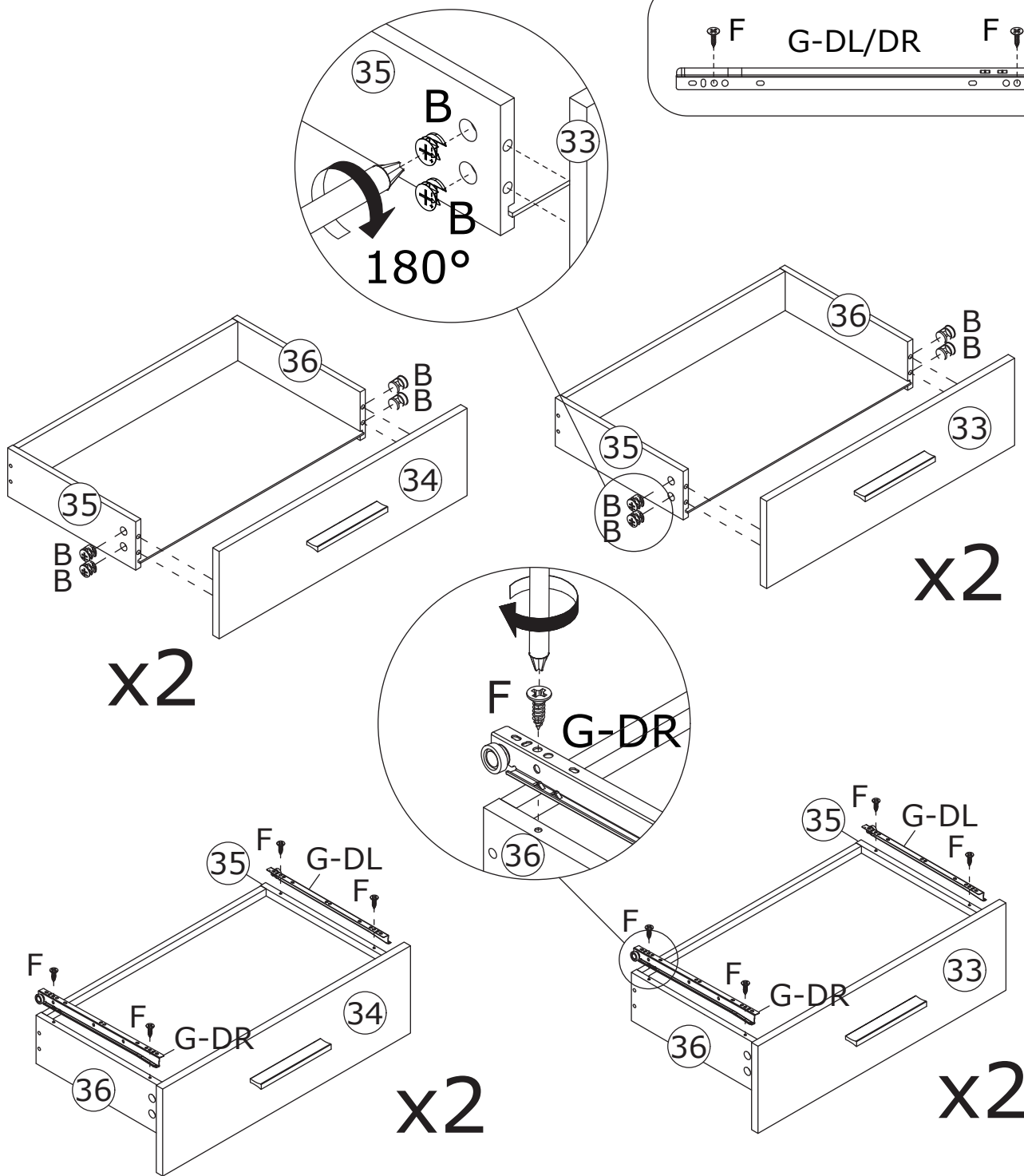
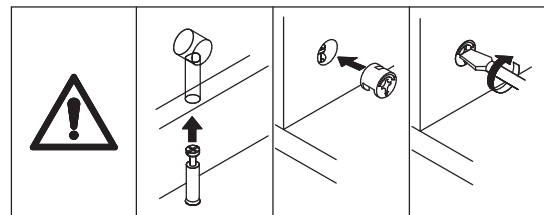

34

Align rails, insert the drawers in.

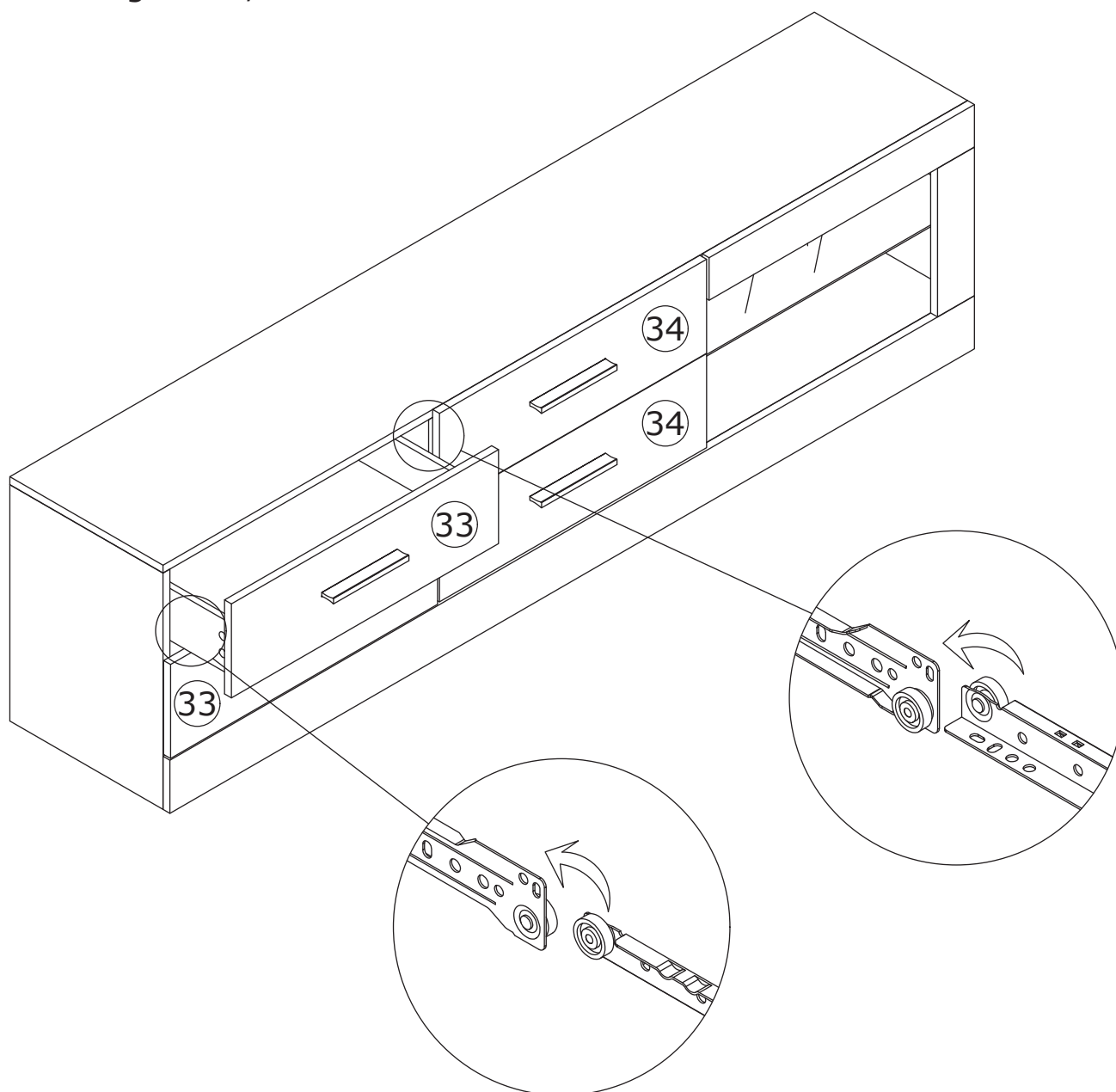

35

O x 2
O-1
O-2

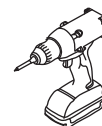
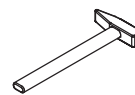
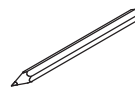

Install anti-tipping device as shown.

WALL



WALL

I x2

WALL +

drilling hole
Ø8x65mm

II x2

WALL

O-1

III x2

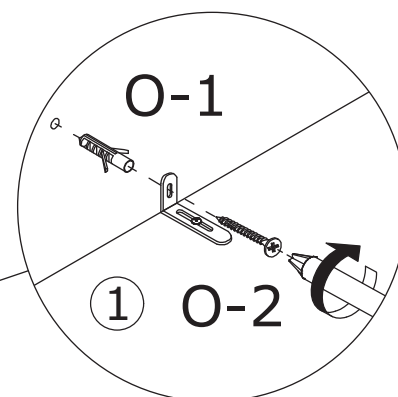

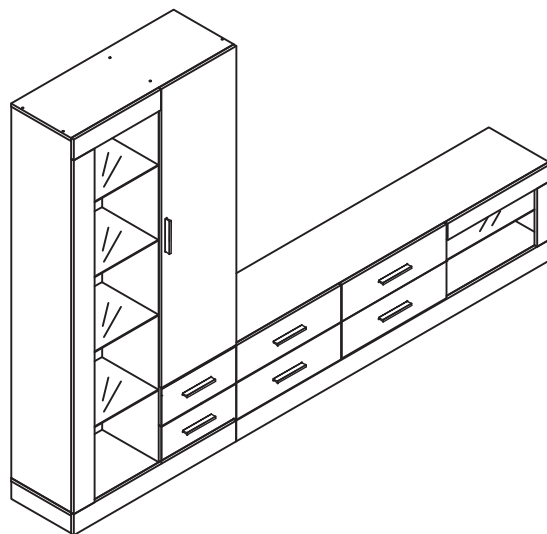
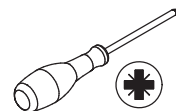

If doors are still not aligned if the hinges are properly correctly, please watch the video.

<https://youtu.be/n0Lb36SoODM>

If there is misalignment after you install, adjust the screw to the best condition

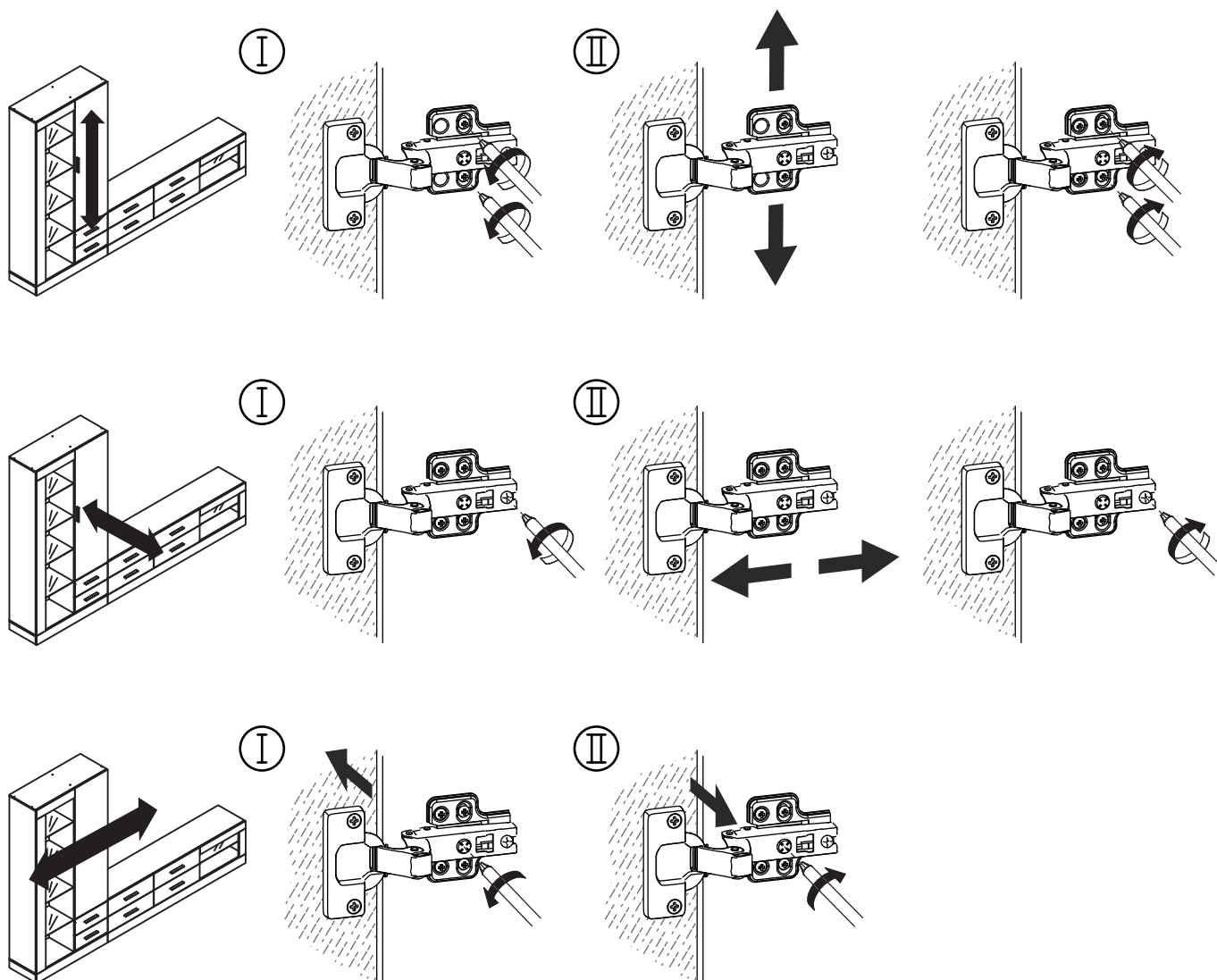

WARRANTY

WARRANTY CLAIMS

- There is a 30-day warranty for broken furniture or any other problems that do not work properly. The warranty will start from the date of purchase which must be verified by proof of purchase.
- Before making a claim, we may be able to answer your query, simply call us. Please leave your purchase order number, along with some details of the problem, if you want a replacement part. We will arrange within 48 hours. If there is out of stock, we will reply with a shipping date.
- The product must be used in accordance with the instructions provided. For health reasons.
- For other reasons, if the furniture needs to be returned, it must be cleaned and dried and operated within 30 days of receipt.

Type of Warranty Claim

- Failure to follow the furniture instructions will invalidate the warranty. Attention please.
- Does not include damage during installation, but includes damage during transportation.

Scope of responsibility

- Shall not bear any responsibility for misuse or user damage and / or loss of parts during the installation of furniture.
- After using, the damage and scratches of the furniture are not covered by the warranty.

The Warranty Relates to All Bought in The Us and Covers The Following Areas

- Sheet parts: 1 month from the date of purchase.
- Electrical parts: 1 month from the date of purchase.