

# Six-layer large shelf installation diagram

				
Spiral with bias	Bias bolt	3.5CM self-tapping screws	Foot mat	Metal pin
A*12	B*12	C*50	D*4	E*3

Caution: When installing, tighten the screws to a moderate degree. Finish the installation process and then fully tighten them!

## Principle of eccentric component installation:

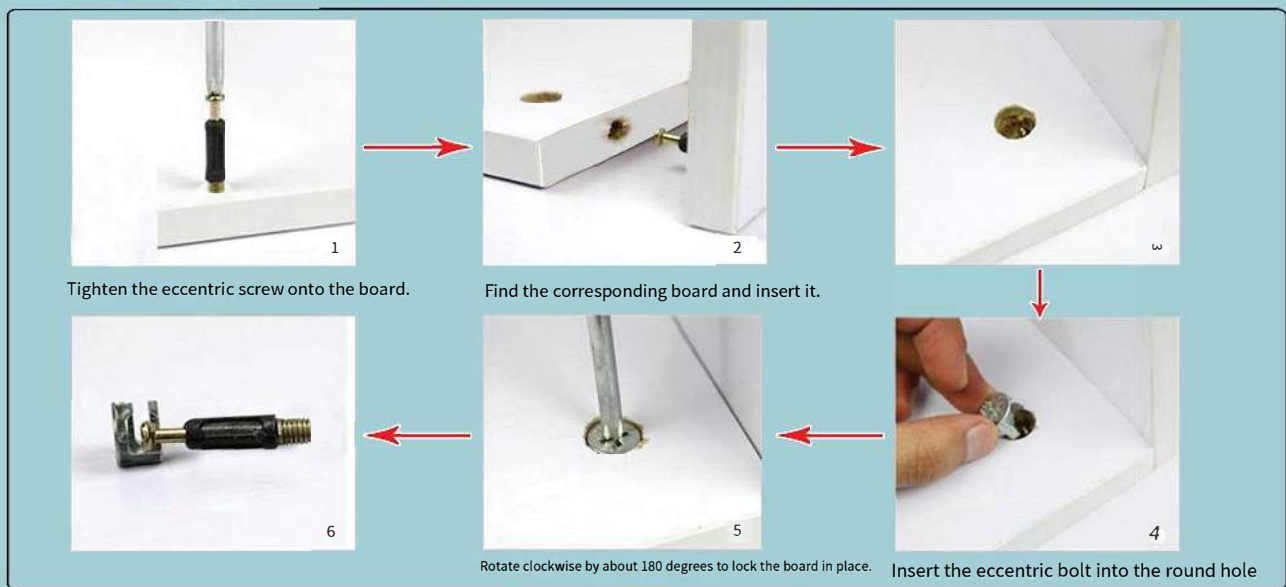

## Board name and serial number:

The incorrect sequence of the numbers in the installation diagram does not mean that the boards are missing. You just need to install them according to the sequence.

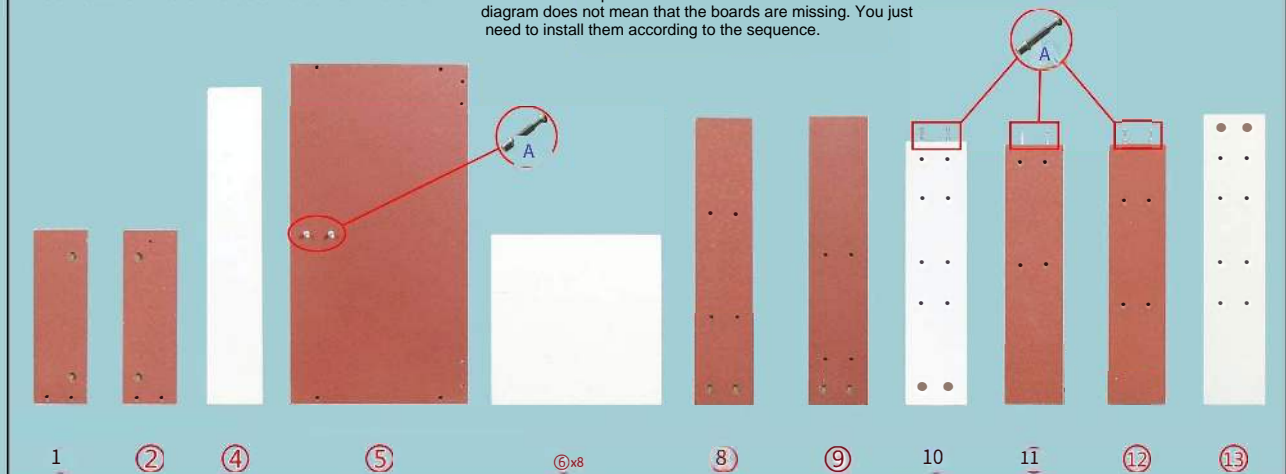

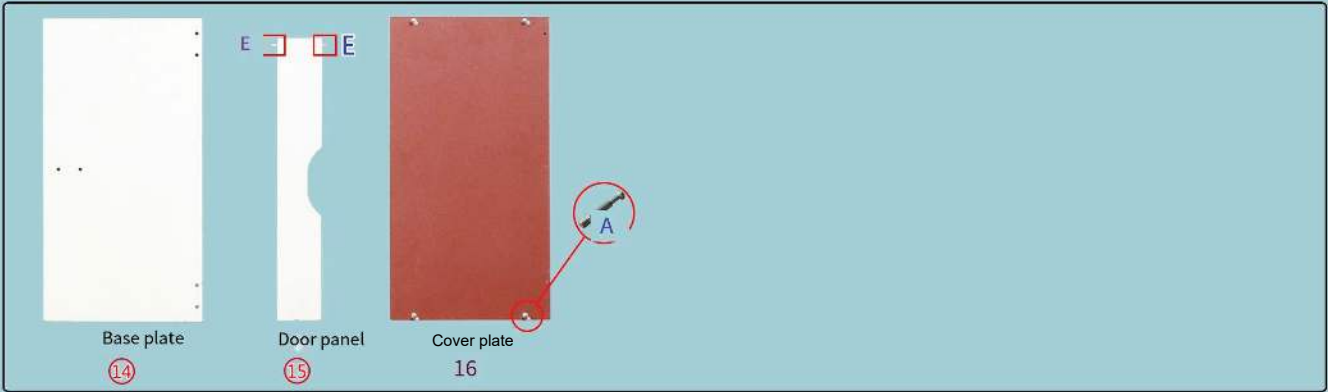

Step 1: Installation of the overall part

Note: Please read all the steps carefully to avoid rework!!!

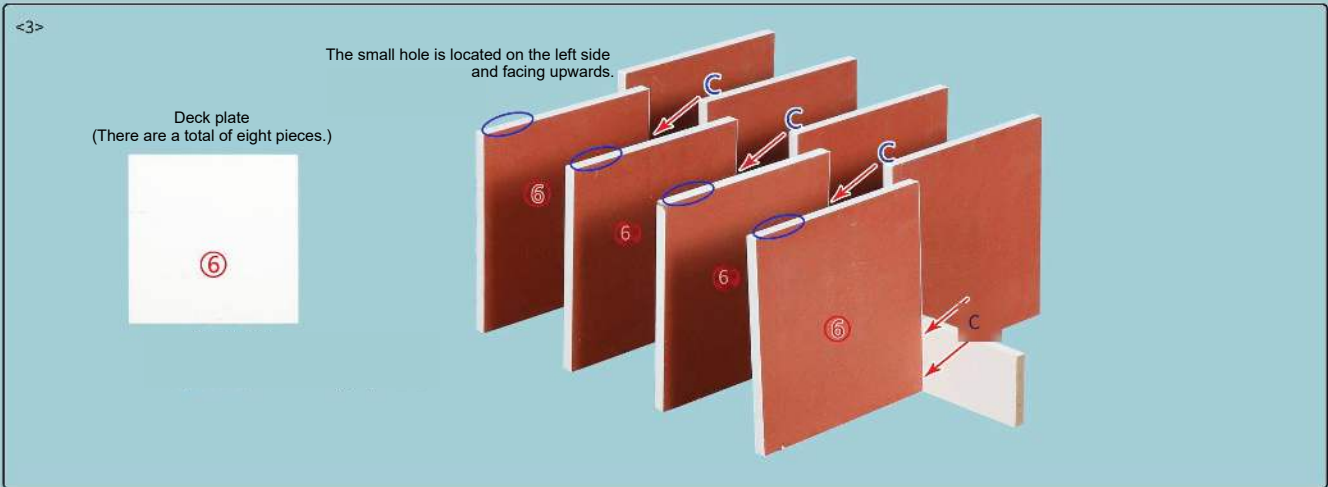
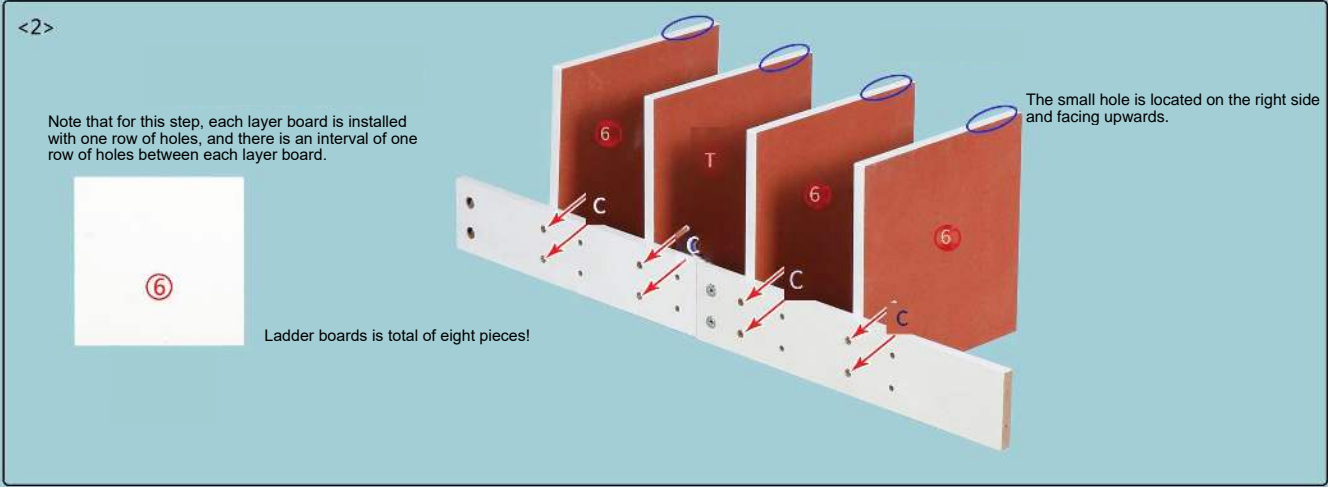
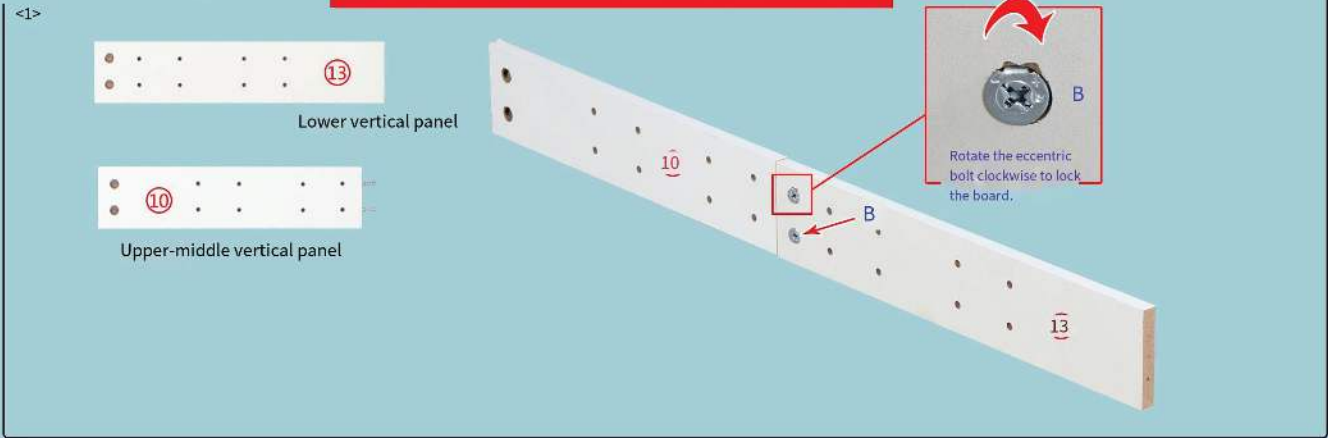

<4>

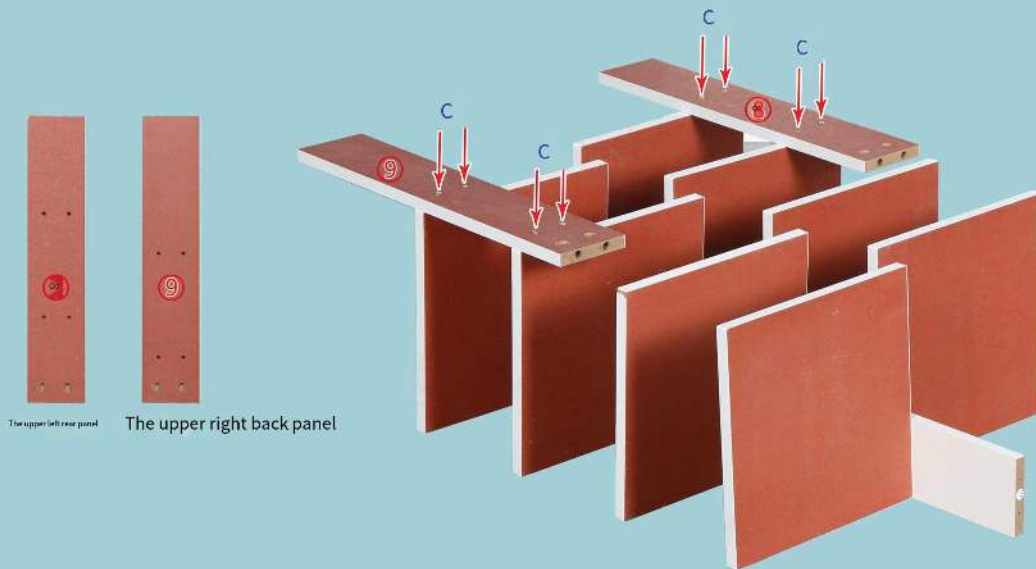

<5>

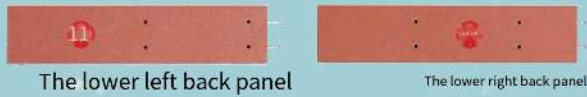

Pay attention to fixing the screws first, then fix the eccentric bolts.

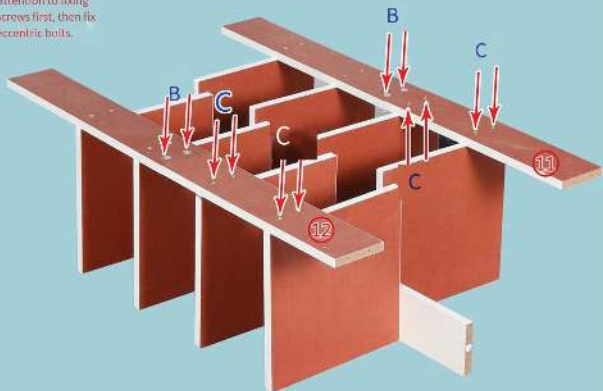

<6>

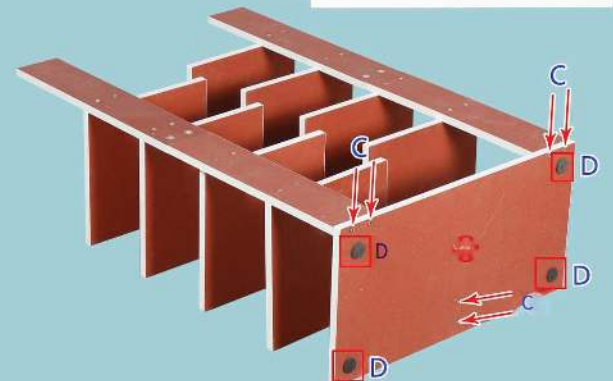

<7>

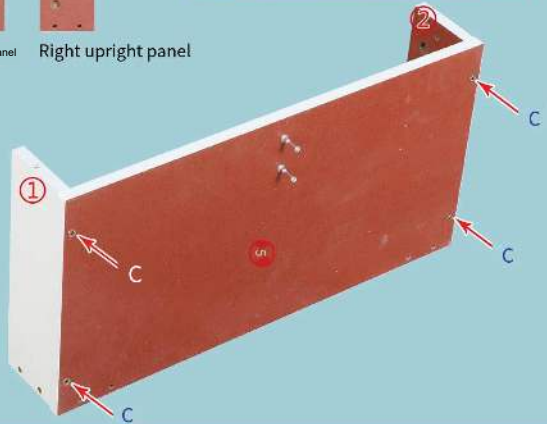
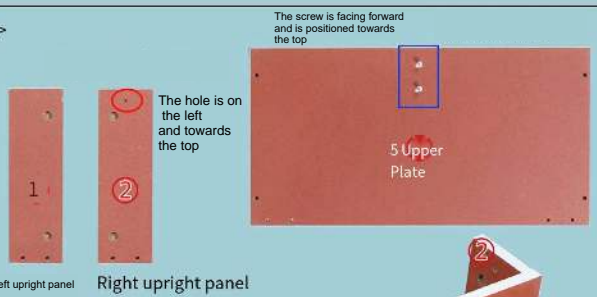

<8> Align the whole structure properly, with the front facing forward.



