

Right installation procedure

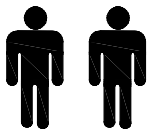

1 PERS.

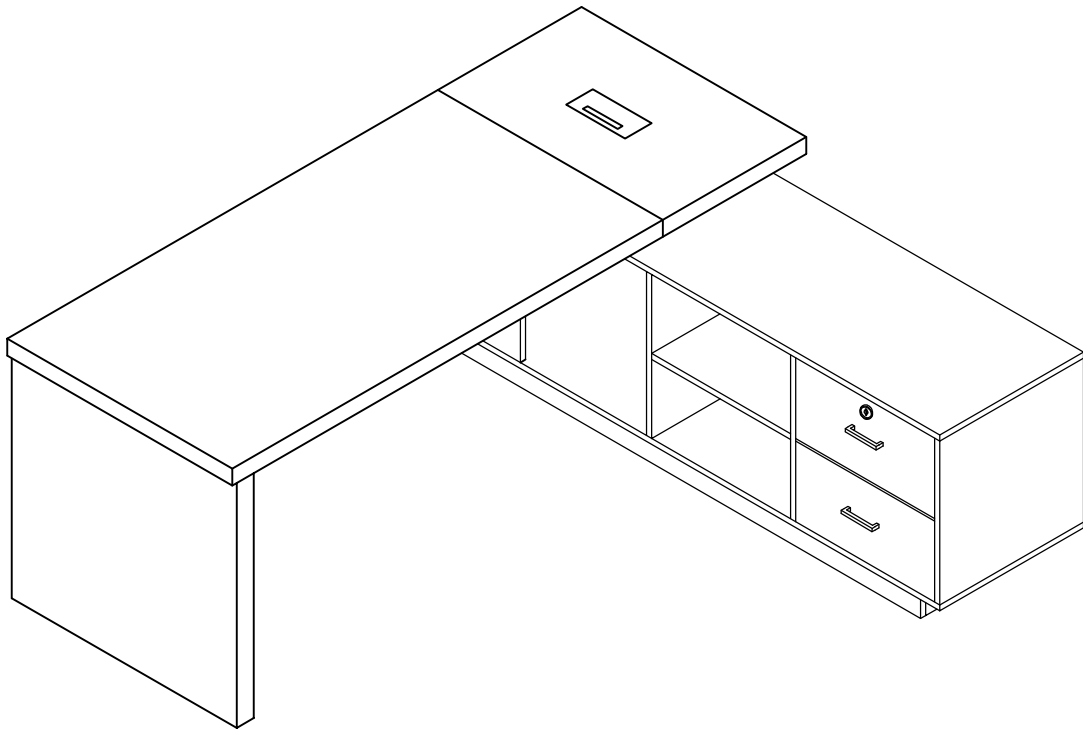
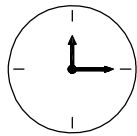

60 MIN

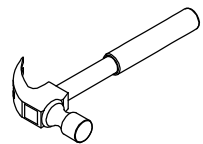
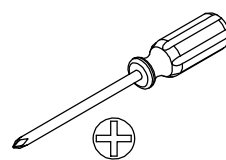
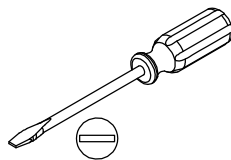

Hardware fittings

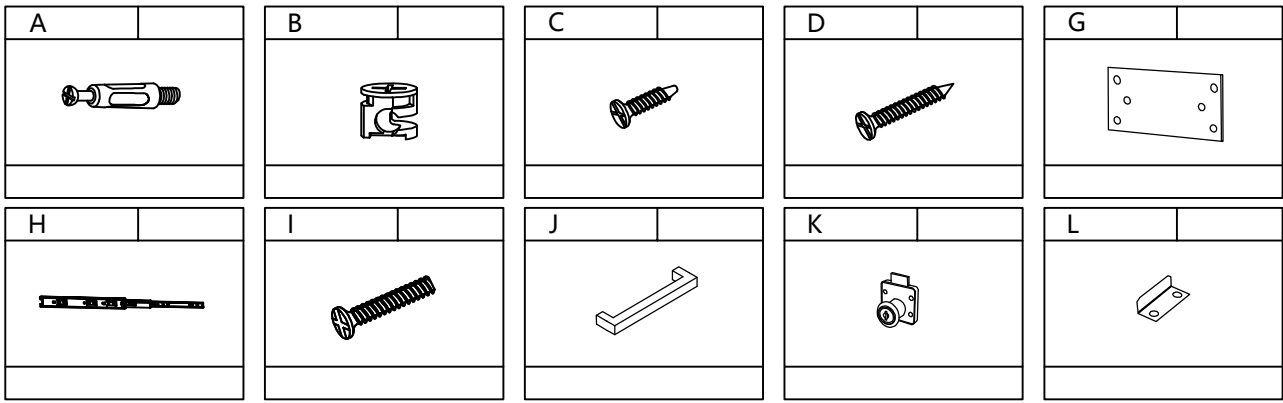

Component part

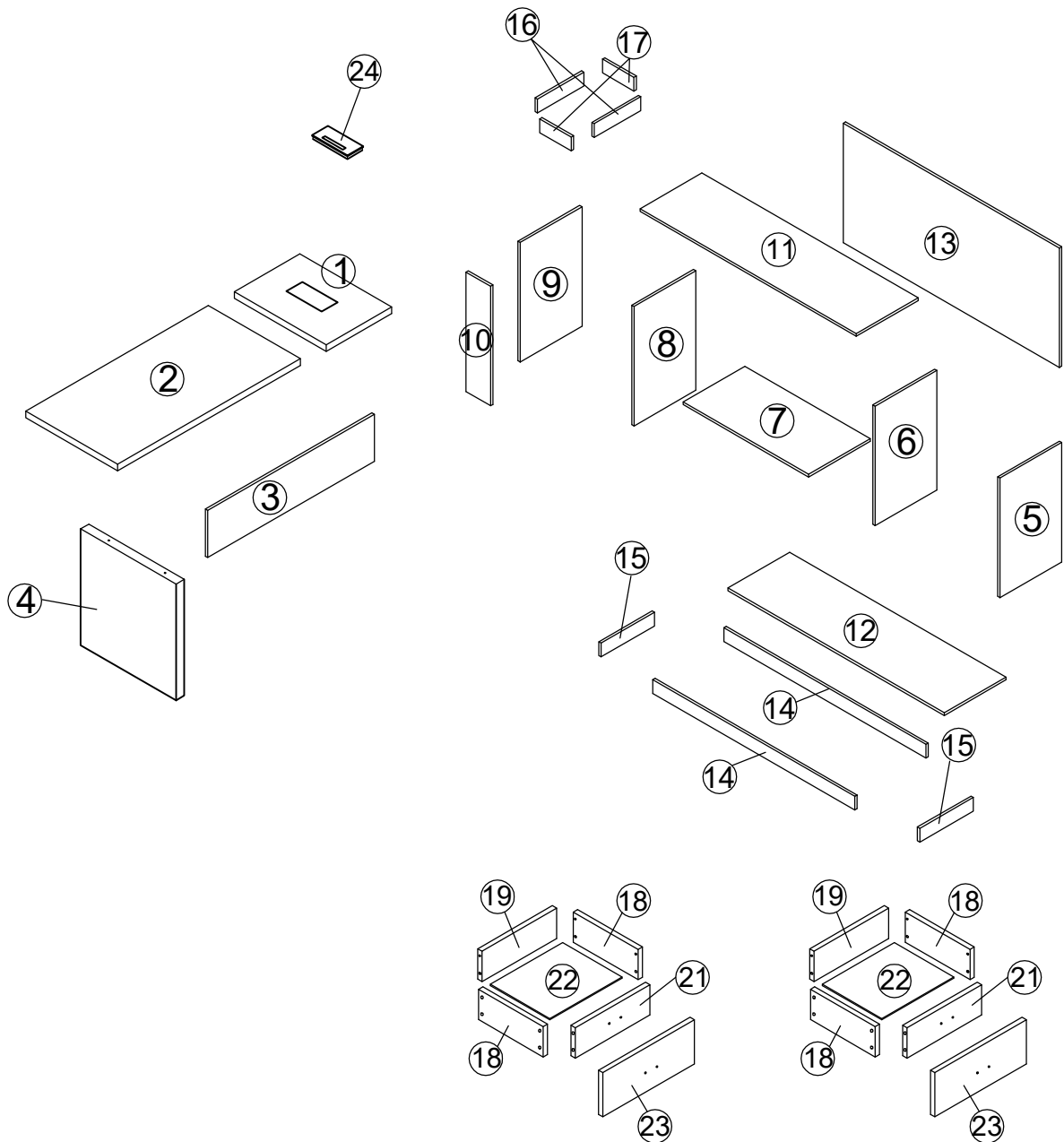

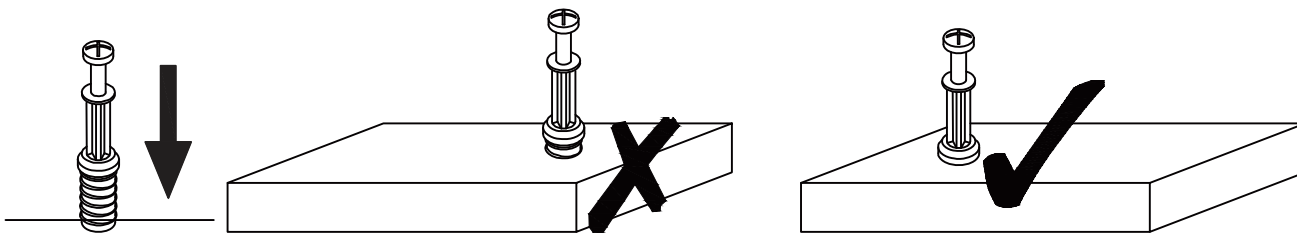

EN_QUICKFIT: Tighten quickfit until shoulder is flush with panel. Do not overtighten or undertighten.

FR_RACCORD RAPIDE: Faites serrer le raccord rapide jusqu'ce que le paulement soit parfaitement encastré dans le panneau. Il ne faut ni trop serrer ni insuffisamment serrer.

ES_QUICKFIT: Apriete quickfit hasta que el hombro se descargue con el panel. NO lo sobreapriete ni lo apriete poco.

PT_AJUSTE RAPIDO: Aperte o ajuste rapido at estar nivelada com o painel. Nao apertar demasiado ou excessivamente

DE_QUICKFIT: Ziehen Sie den Quickfit fest, bis die Schulter mit der Platte bundig ist. Bitte nicht zu fest oder zu schwach anziehen.

IT_MONTAGGIO RAPIDO: Stringere il montaggio rapido fino a quando la spalla a filo con il pannello, non stringere troppo o troppo poco.

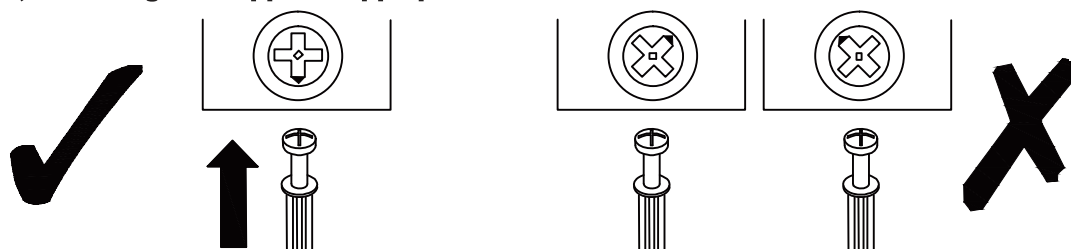

EN_CAM LOCK: When fitting cam lock, ensure starting position is correct before you insert connectina quickfit.

FR_SERRURE BATTEUSE: Avant d'insérer la serrure batteuse, veillez la bonne orientation avant d'insérer le raccord rapide.

ES_CIERRE DE LACAMARA: Cuando instale el cierre de la camara, asegurese de que la posicion de inicio es correcta antes de que inserte el quickfit conector.

PT_BLOQUEIO: Ao instalar o bloqueio, assegurar-se de que a posicao inicial est correcta antes de inserir o encaixe de ligacao rapida.

DE_CAM-LOCK: Achten Sie bei der Montage des Cam-Locks auf die richtige Ausgangsposition, bevor Sie den Quickfit einsetzen.

IT_BLOCCAGGIO ACAMMA: Quando si monta il bloccaggio a camma, assicurarsi che la posizione iniziale sia corretta prima di inserire il montaggio rapido di collegamento.

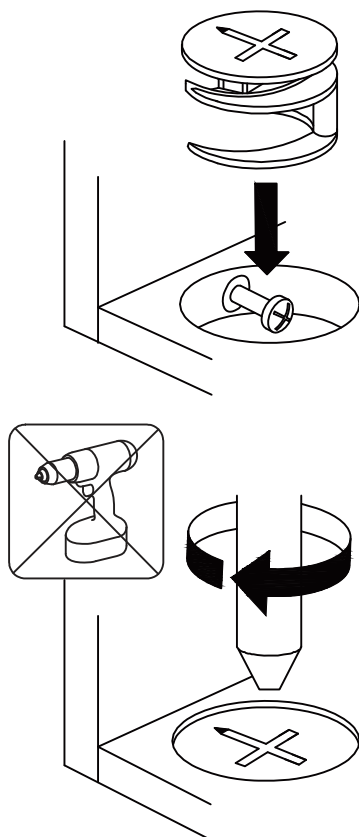

EN_Quickfit head should be in the centre of the cam lock when the two panels are joined.

Cam lock should be inserted before quickfit.

FR_Lorsque les deux panneaux sont assembles, la tete du raccord rapide doit reposer au centre de la serrure batteuse.

Il faut inserer la serrure batteuse avant le raccord rapide.

ES_El cabezal del quickfit debe estar en el centro del cierre de la camara cuando se unan los dos paneles.

Se debe insertar el cierre de la camara antes que el quickfit.

PT_A cabeca de ajuste rapido deve estar no centro da fechadura quando os dois paineis estao unidos.

A fechadura de cames deve ser inserida antes de ser rapida.

DE_Der Quickfit-Kopf sollte sich in der Mitte des Cam-Locks befinden, wenn die beiden Platten zusammengefigt sind.

Der Cam-Lock sollte vor dem Quickfit eingesetzt werden.

IT_La testa del montaggio rapido deve trovarsi al centro del bloccaggio a camma quando i due pannelli sono uniti.

Il Bloccaggio a Camma deve essere inserito prima del montaggio rapido.

EN_Turn cam lock clockwise to tighten.

FR_Faites tourner la serrure batteuse dans le sens des aiguilles d'une montre pour la resserrer

ES_Gire el cierre de la camara en sentido horario para apretarlo.

PT_Rodar o bloqueio no sentido dos ponteiros do relógio para o apertar

DE_Drehen Sie den Cam-Lock im Uhrzeigersinn, um ihn festzuziehen.

IT_Ruotare il bloccaggio a camma in senso orario per stringere.

Installation procedure

1

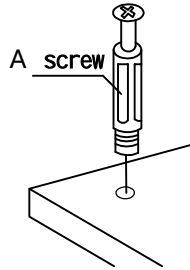

It is recommended to drive A screw into the plate with a screw hole before installation

2

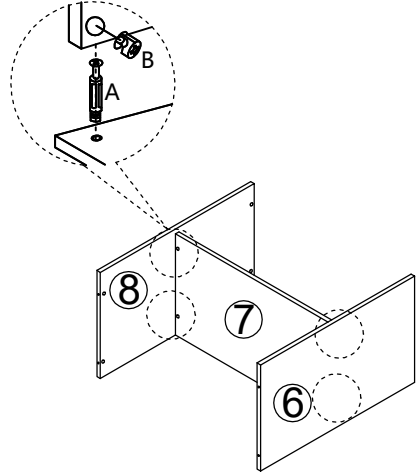

Install side cabinet partitions

3

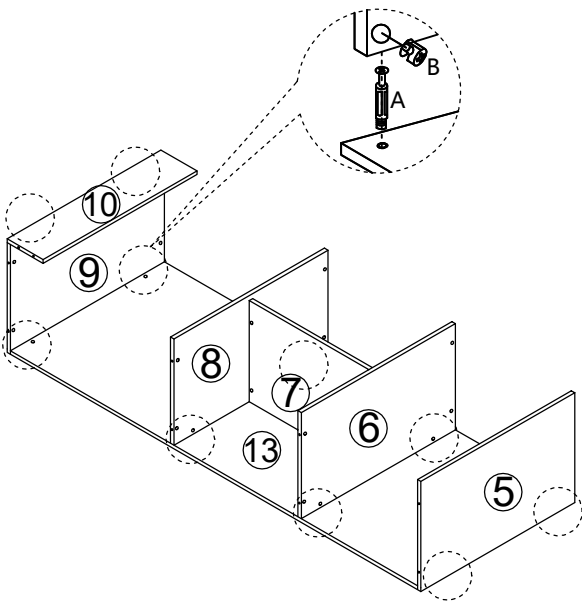

Install the back of the side cabinet and the host position

4

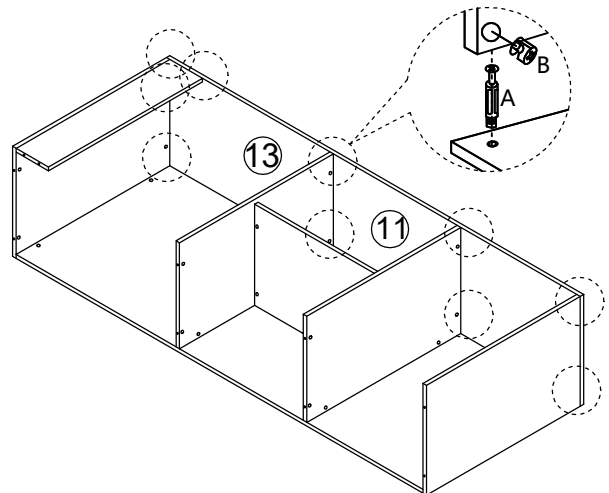

Install the top of the side cabinet

5

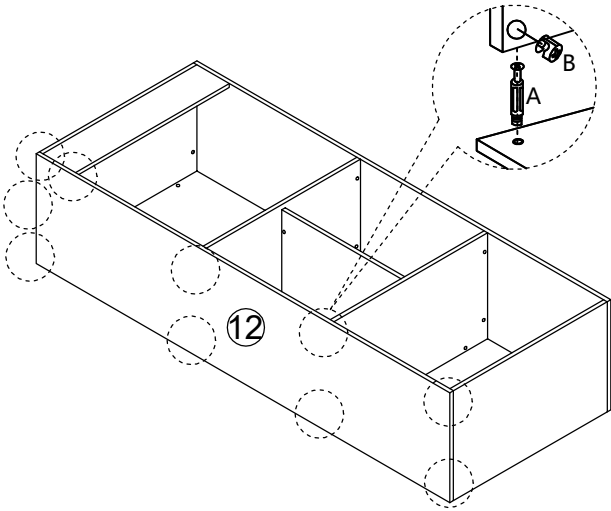

Install the bottom of the side cabinet

6

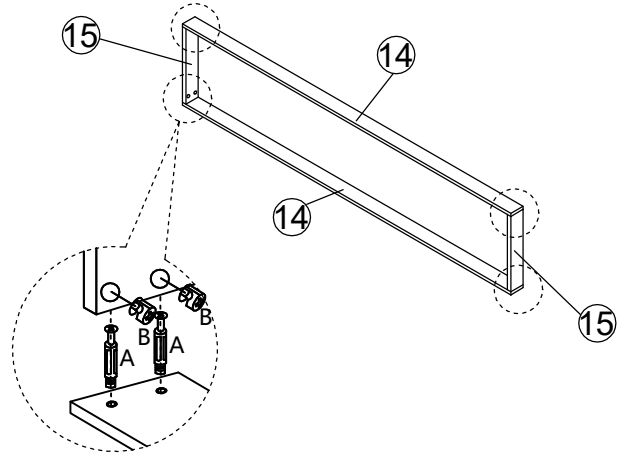

Install the bottom supports of side cabinets

7

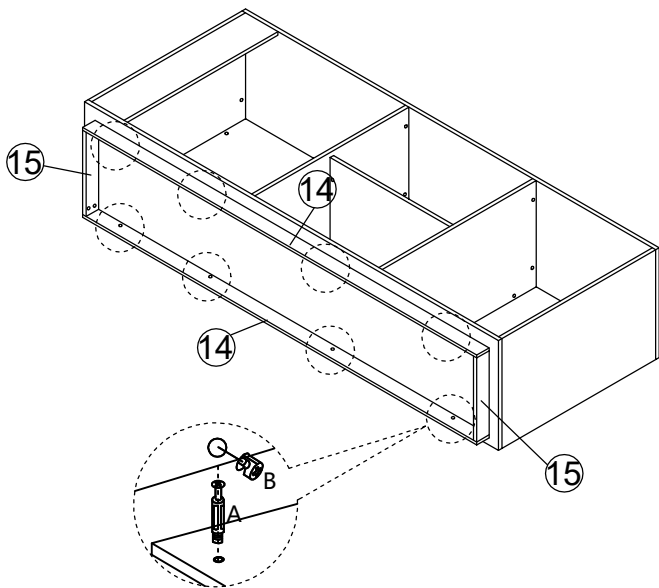

Attach the support section to the bottom

8

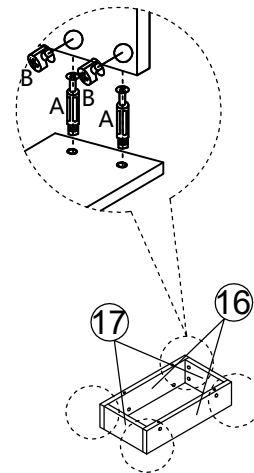

Assemble the desktop support

9

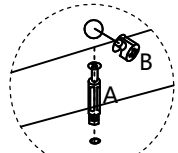

Support installation

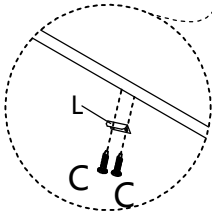
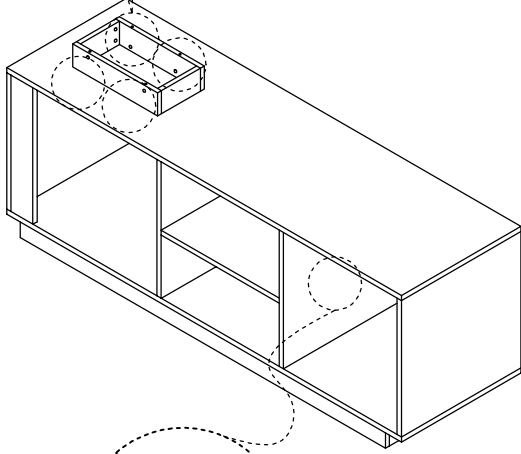

10

The table top is connected by hinges

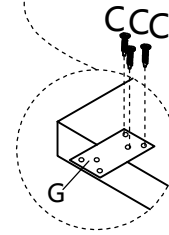
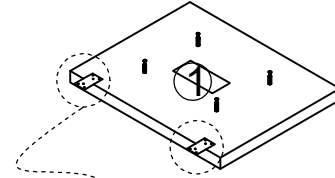

11

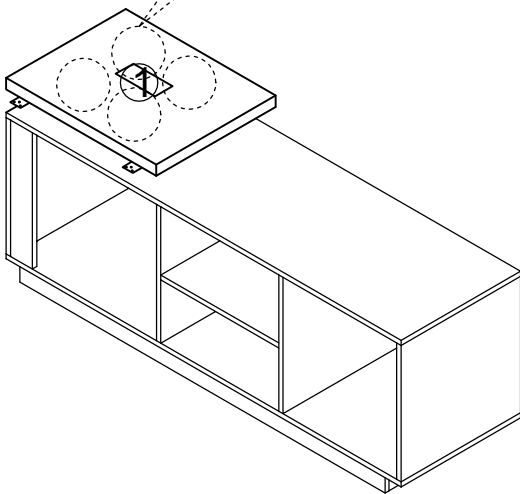
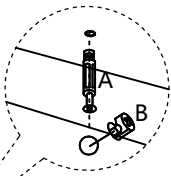

The desktop support part is connected to the desktop through A and B

12

Press the latch, and the drawer tracks separate

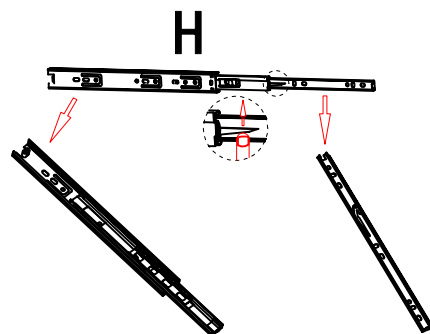

13

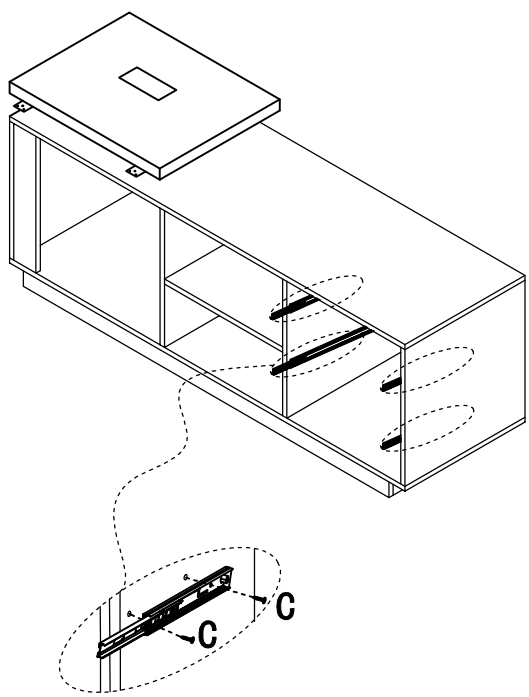

Drawer tracks are pre-installed on the side cabinets

14

Assemble drawer

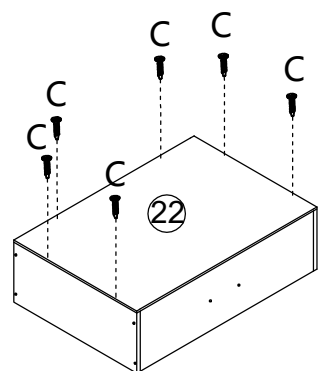
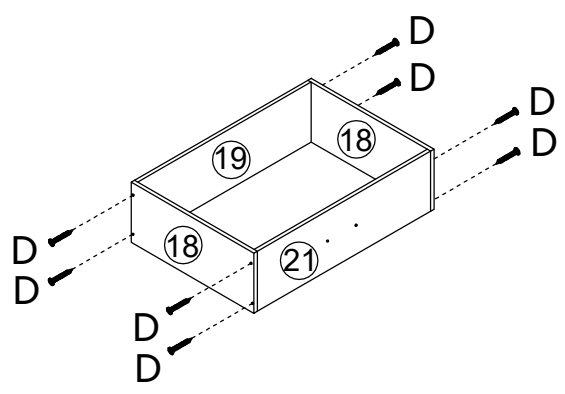

Assemble drawer bottom

15

Install drawer handles and combination locks

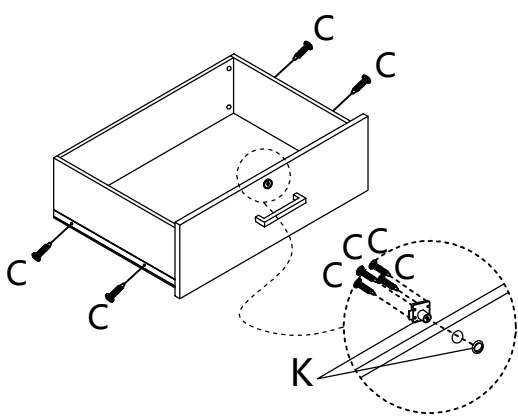
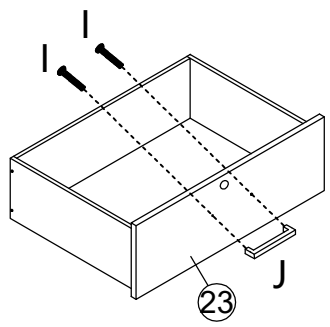

16

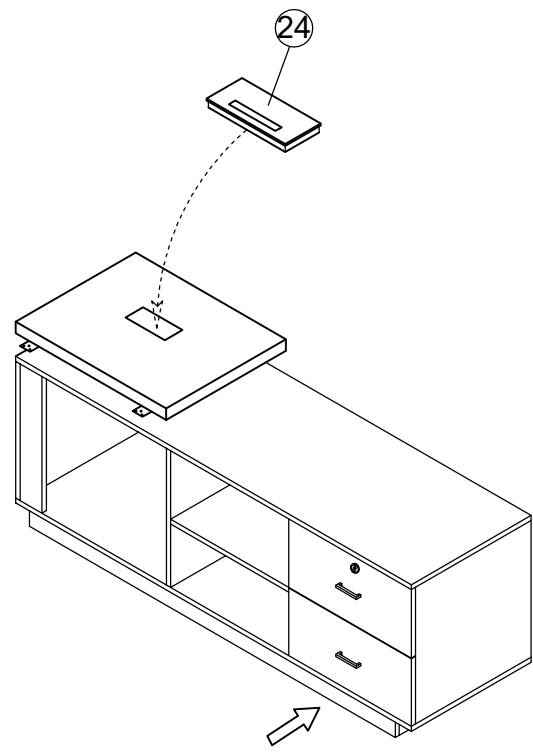





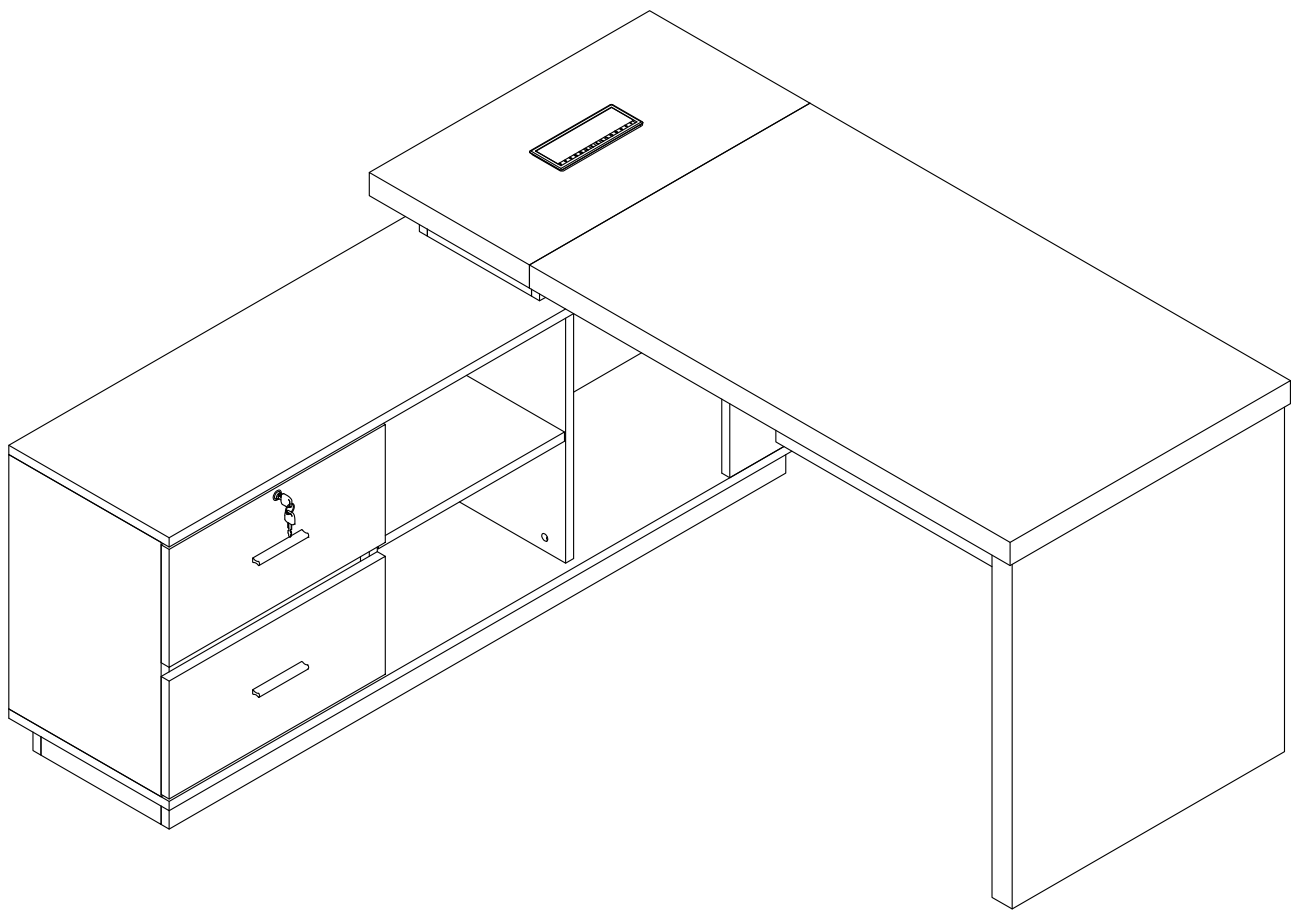

Install cable boxes and drawers

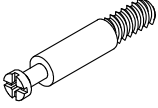
Left side installation procedure

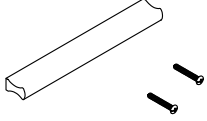
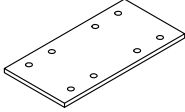

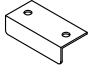
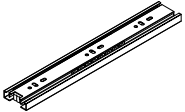
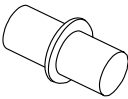
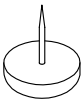
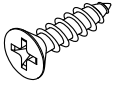
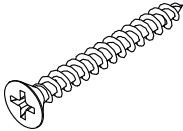
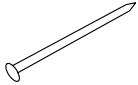
Hardware fittings

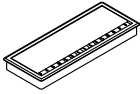
A  80	B  80	C  2
D  2	E  E1 E2 E3 1	F  1
G  4	H  4	I  14
J  80	K  16	L  12
M  4	N  1	

Component pi ece

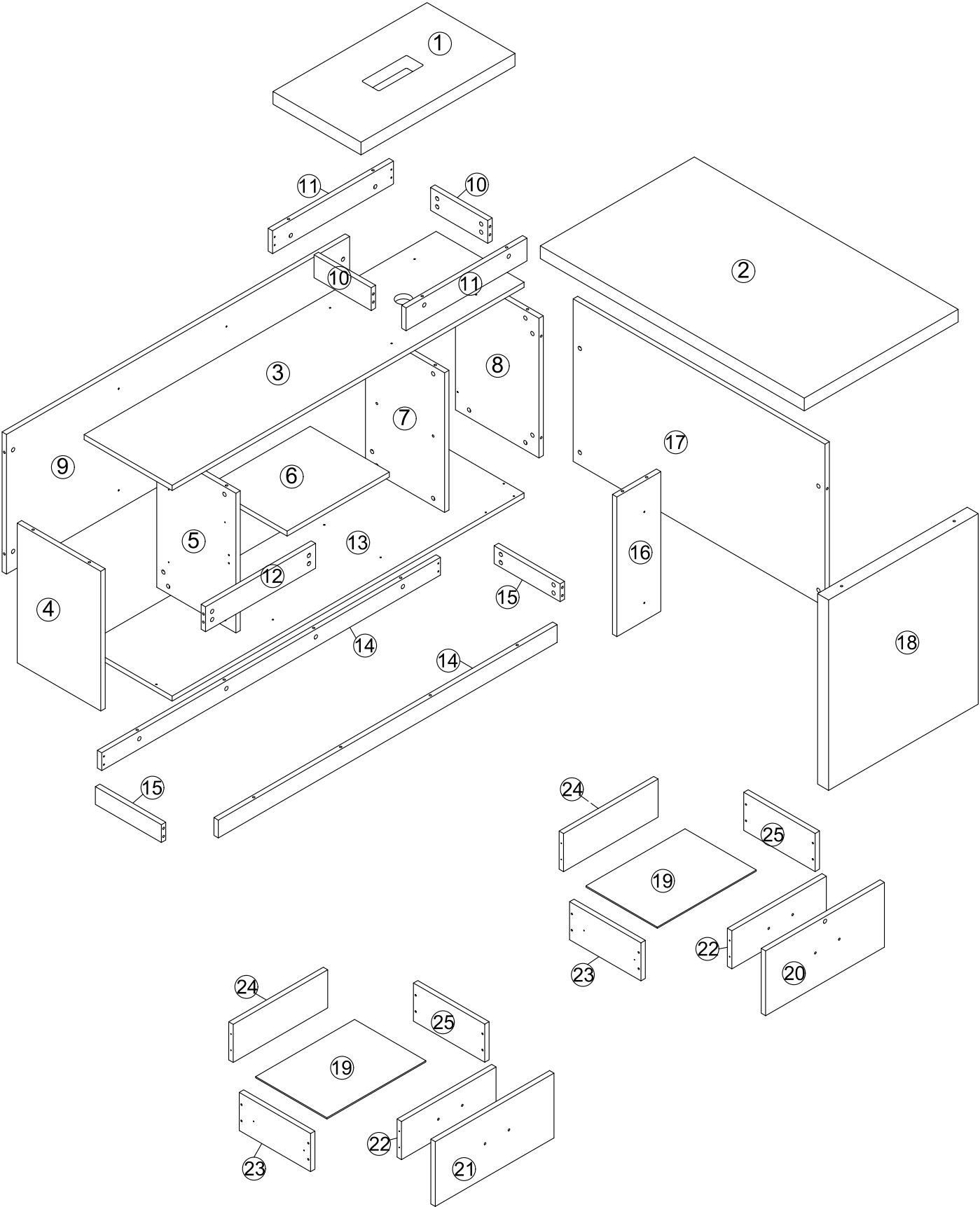

Drawer slide rail removed

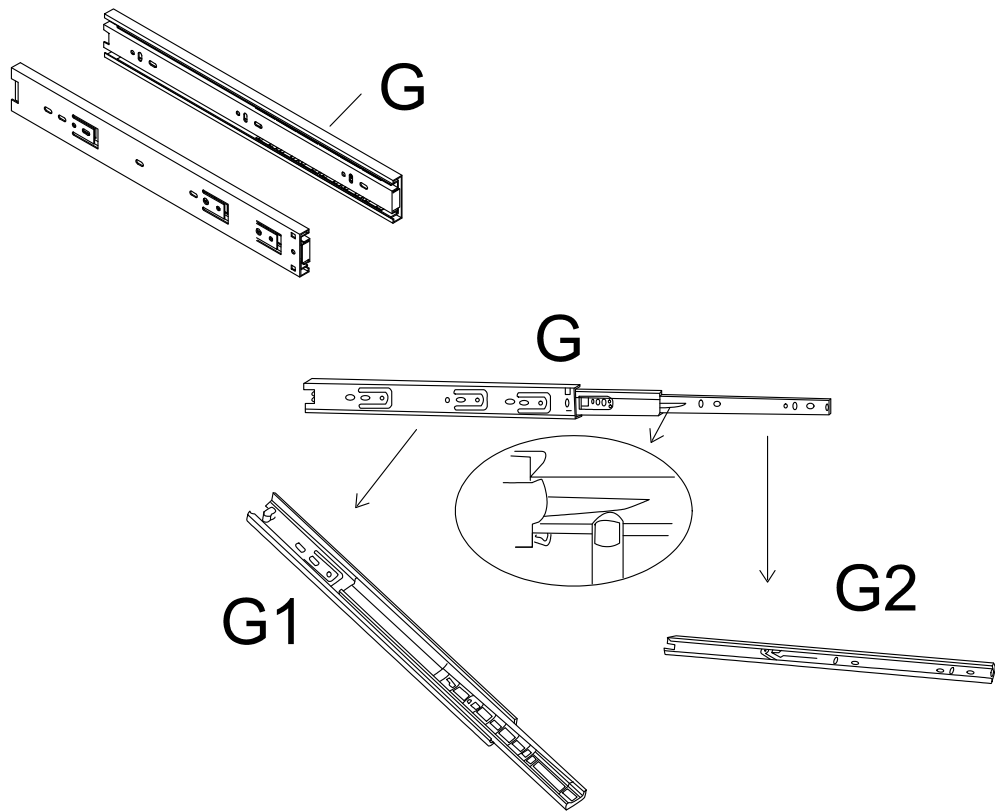

1.

Install the guide rail on the partition board of the secondary cabinet first

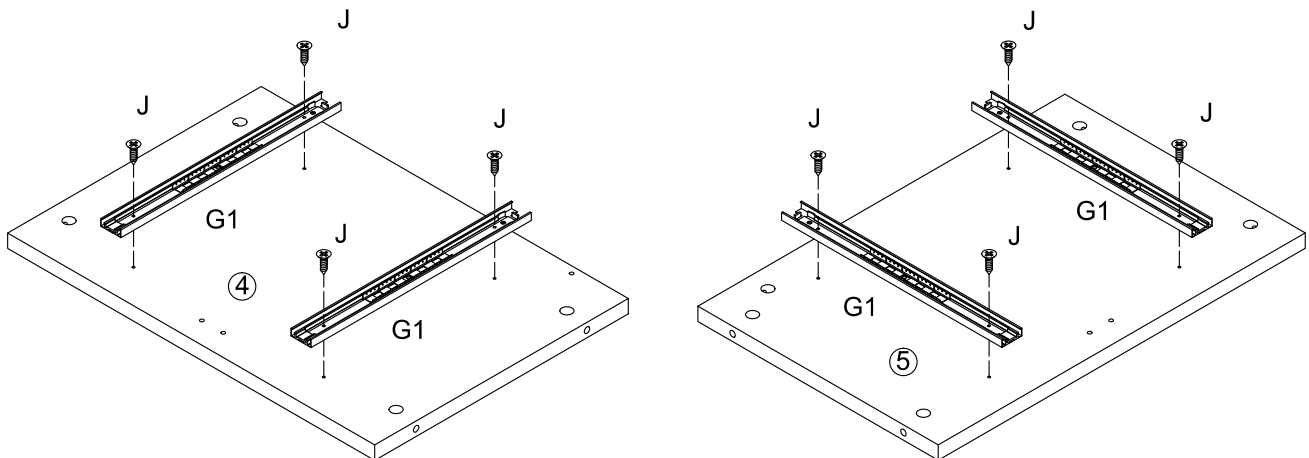
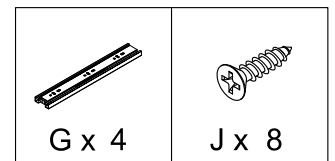

2.

3.

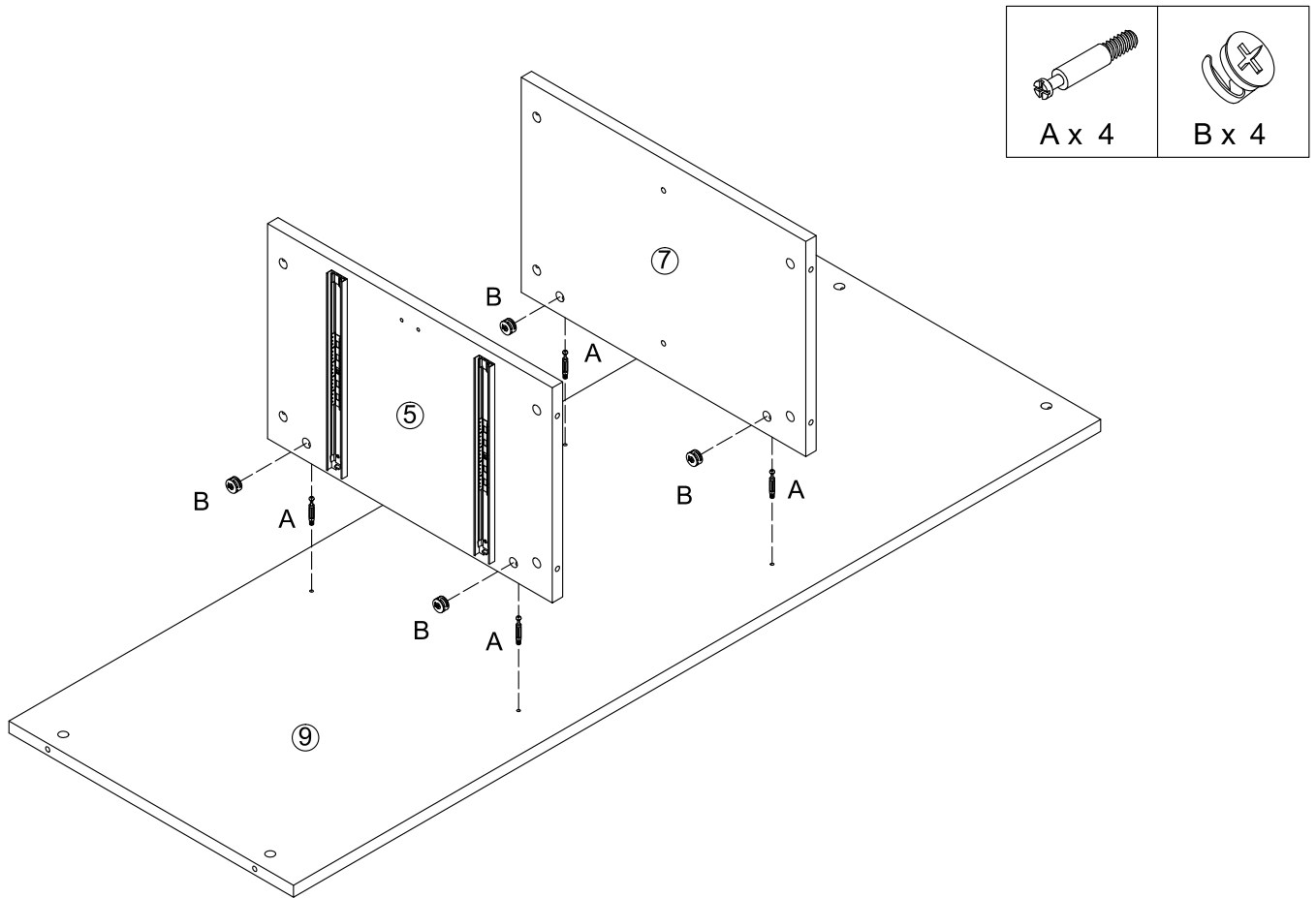

Connect the partition board to the backplane of the auxiliary cabinet

4.

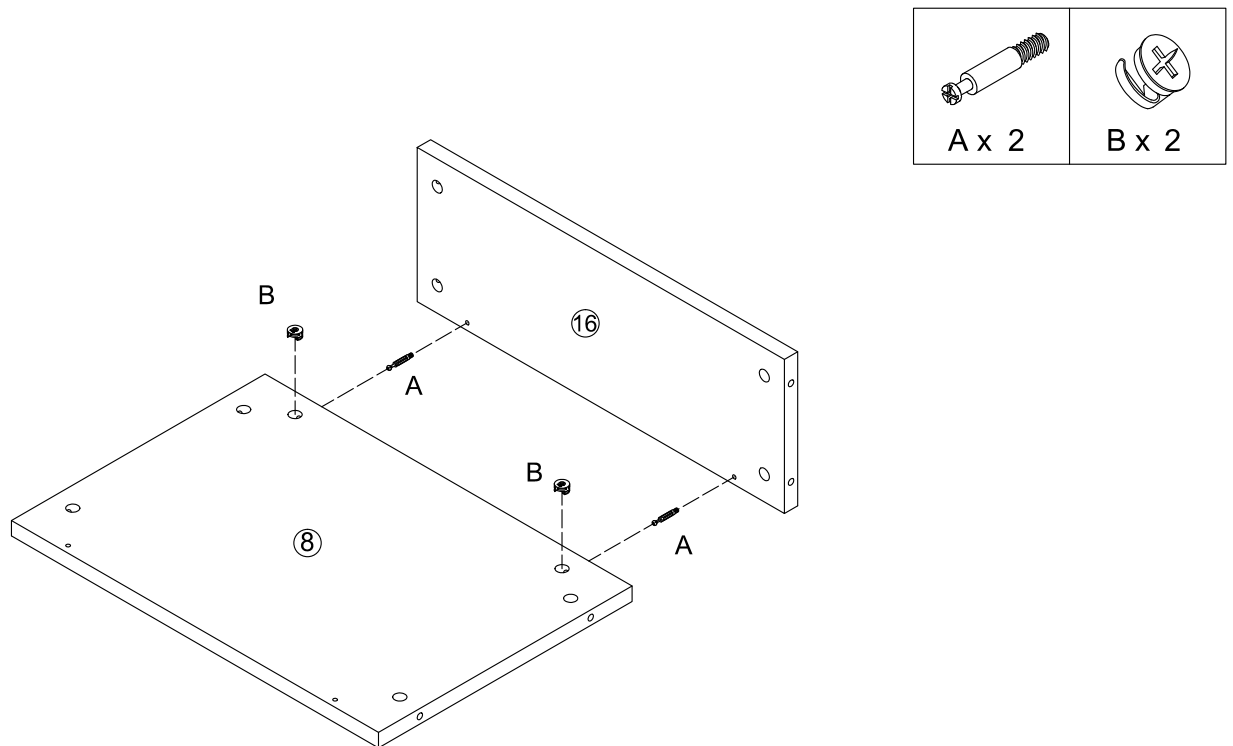

Assemble side cabinet host placement position partition

5.

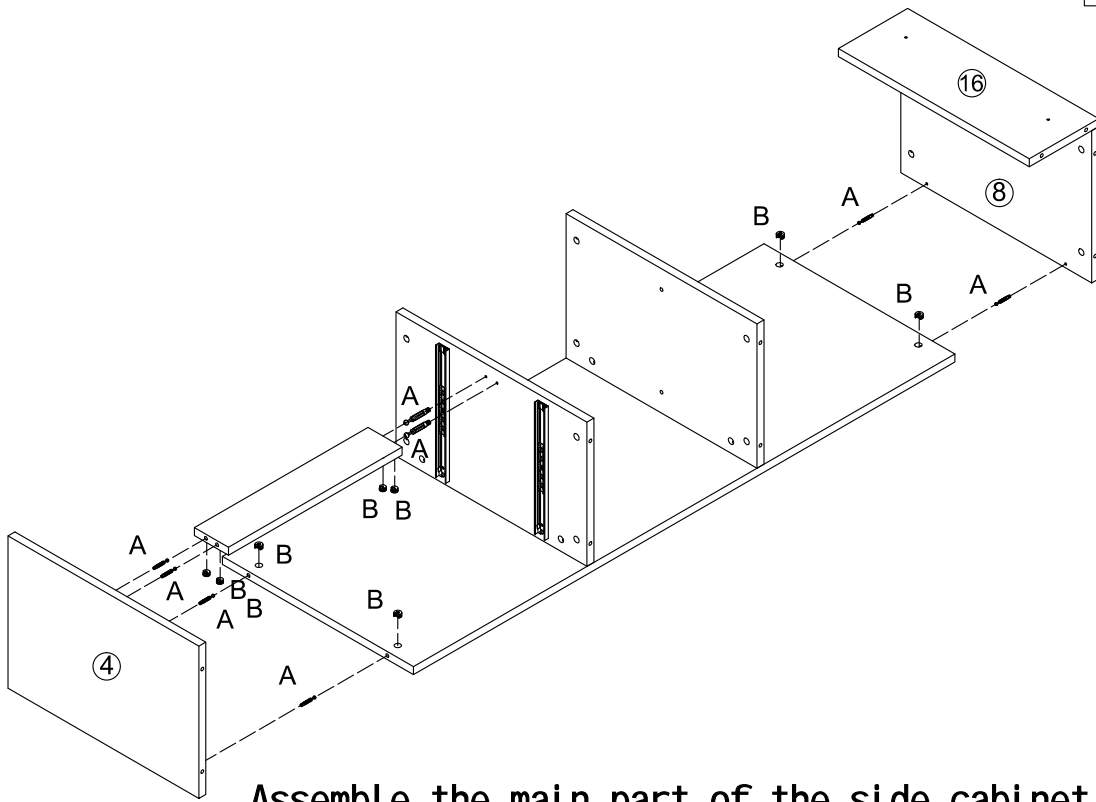
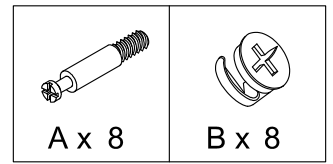

Assemble the main part of the side cabinet

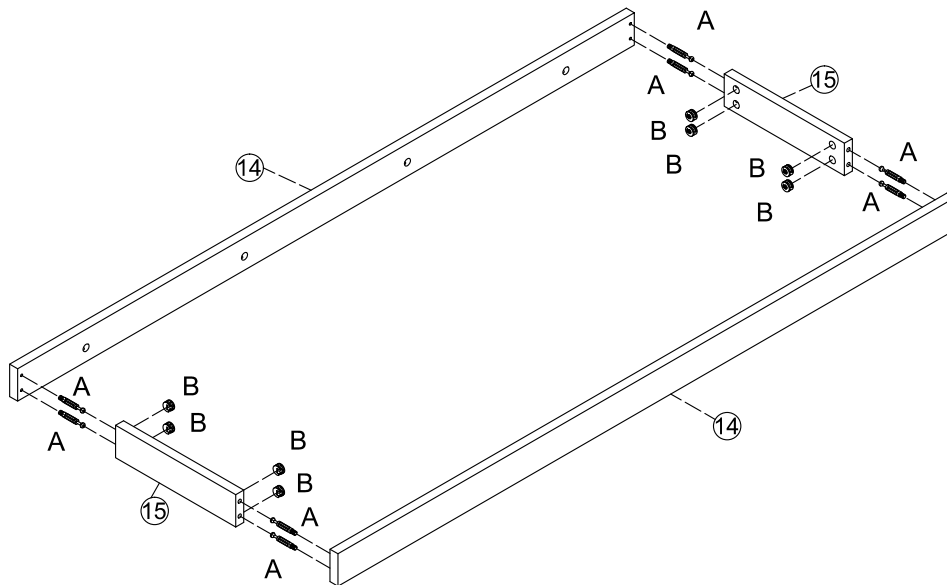
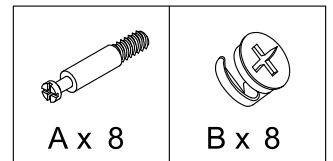

Assemble the side cabinet bottom support

6.

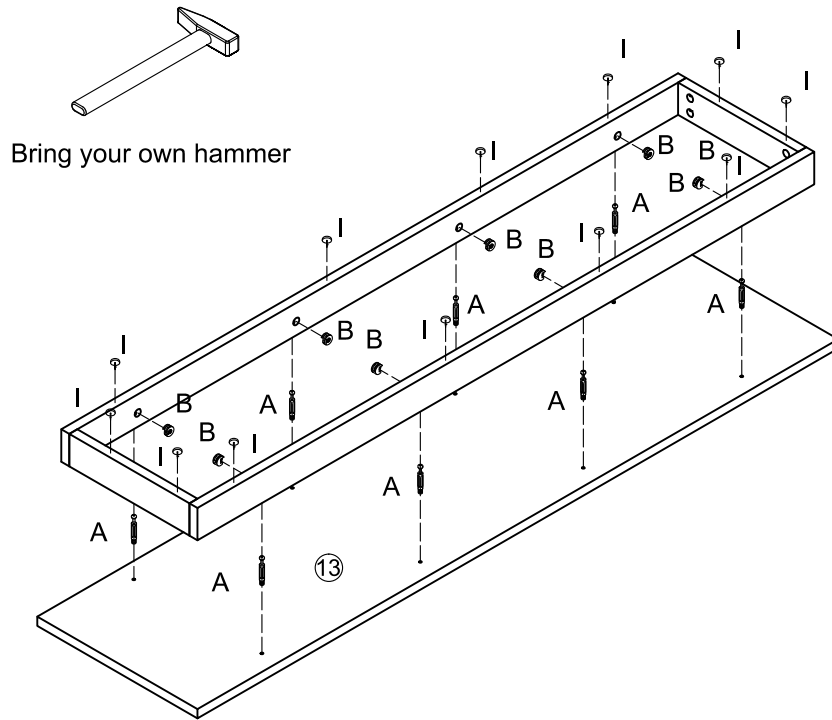
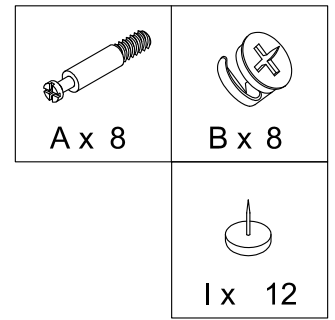

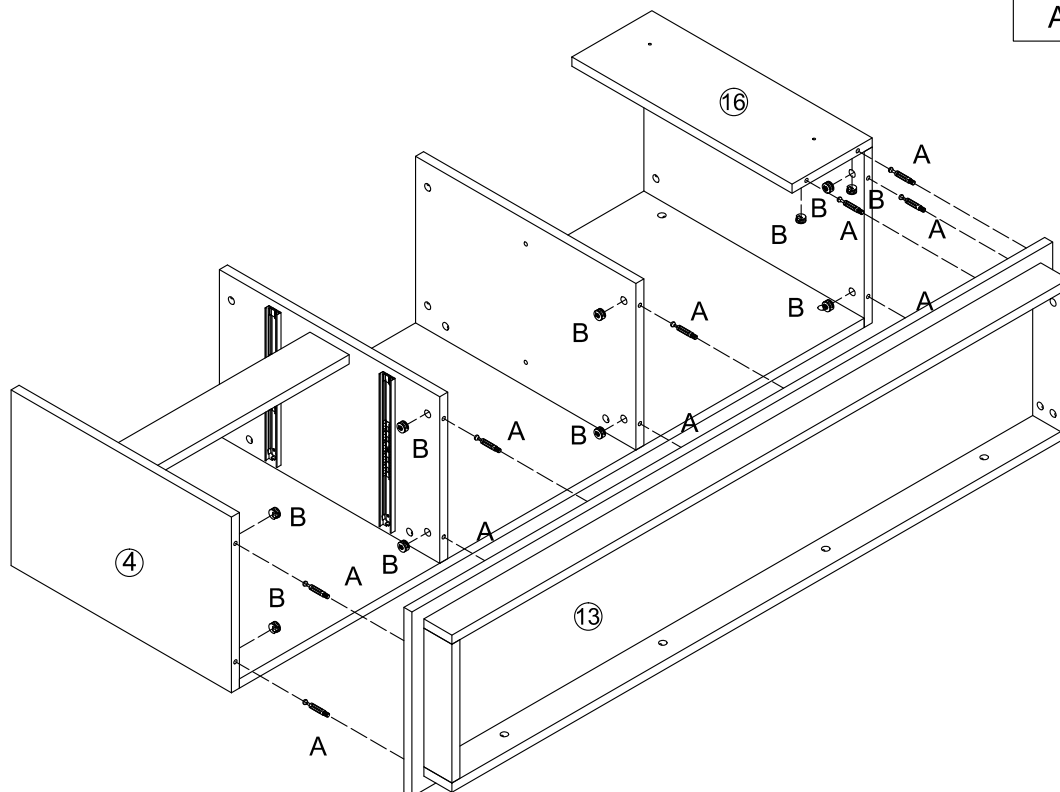
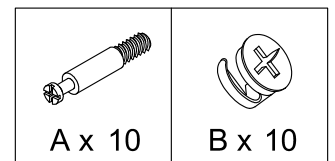

7. Install the side cabinet bottom supports together with the side cabinet bottom plates



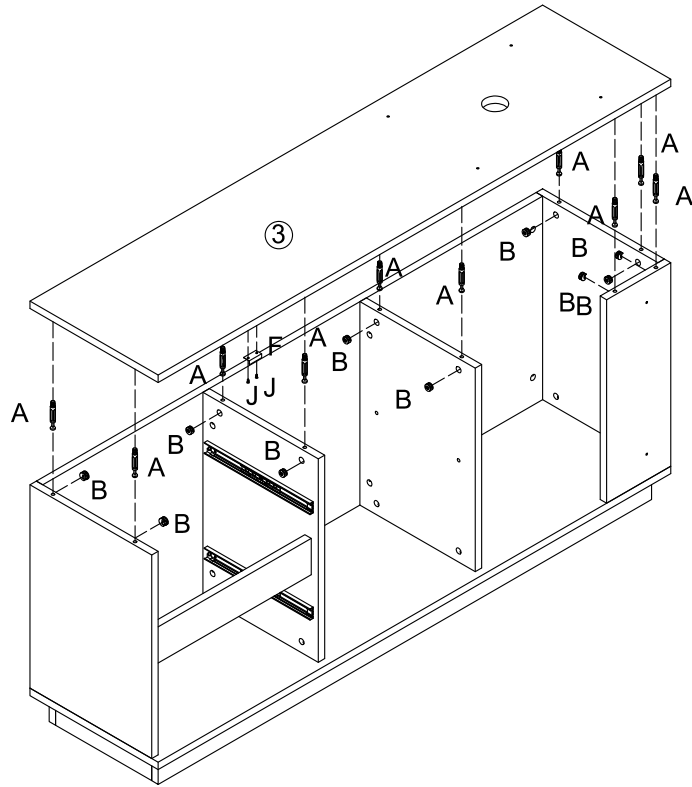

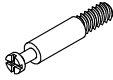

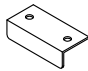
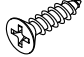
8. Connect the side cabinet bottom plate to the side cabinet body

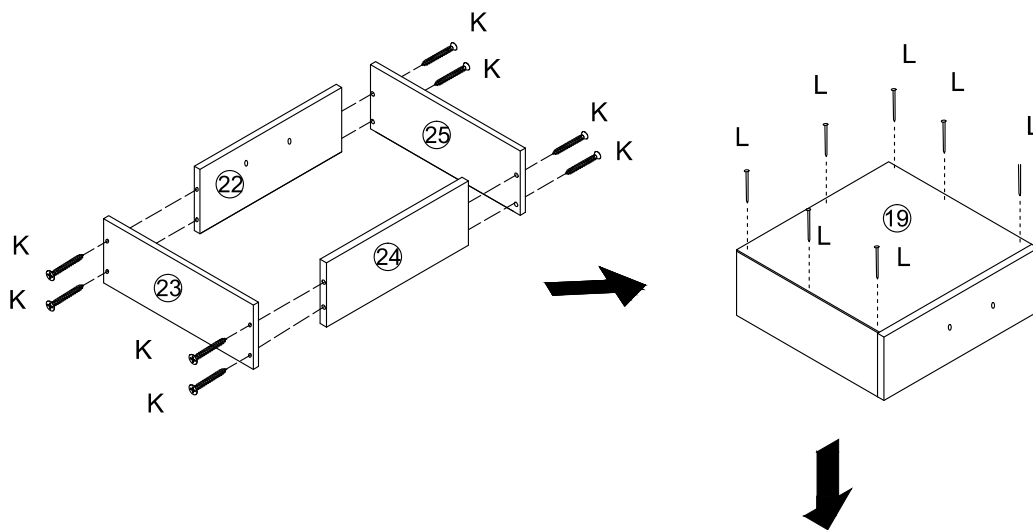

 A x 10	 B x 10
 F x 10	 J x 2

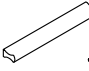
9. Link the top of the side cabinet to the body of the side cabinet

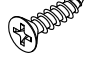

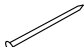
 C x 2	 G x 4
 J x 8	 K x 16
 L x 12	

Installation steps Assemble the drawer

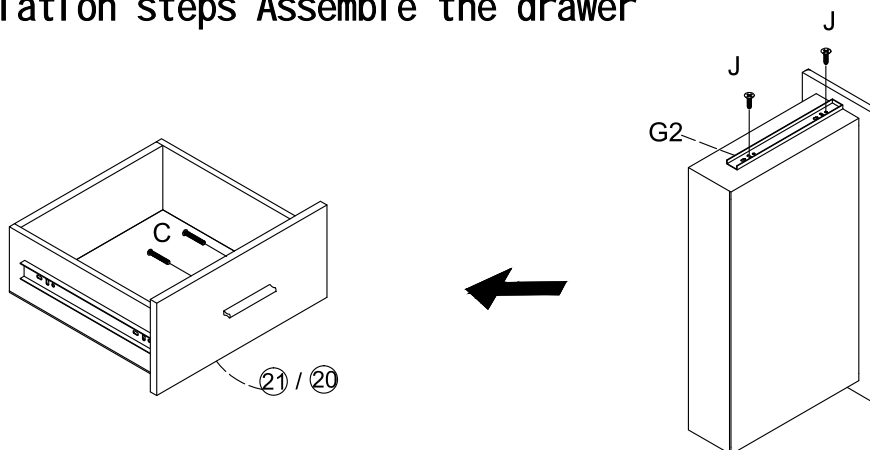

×2

10.

Install the assembled drawers and partitions

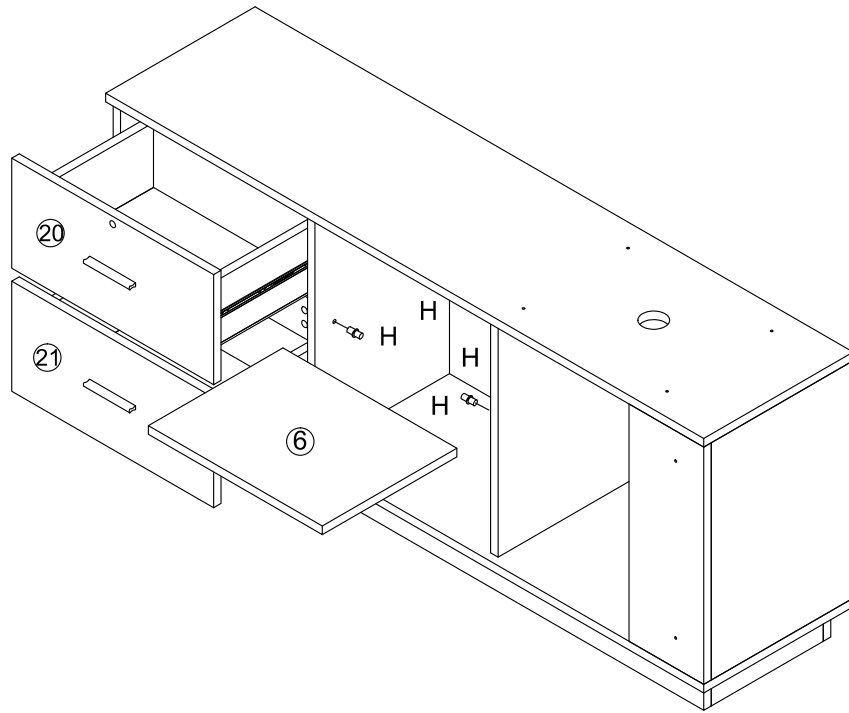
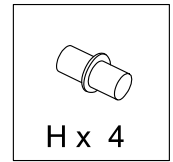

11.

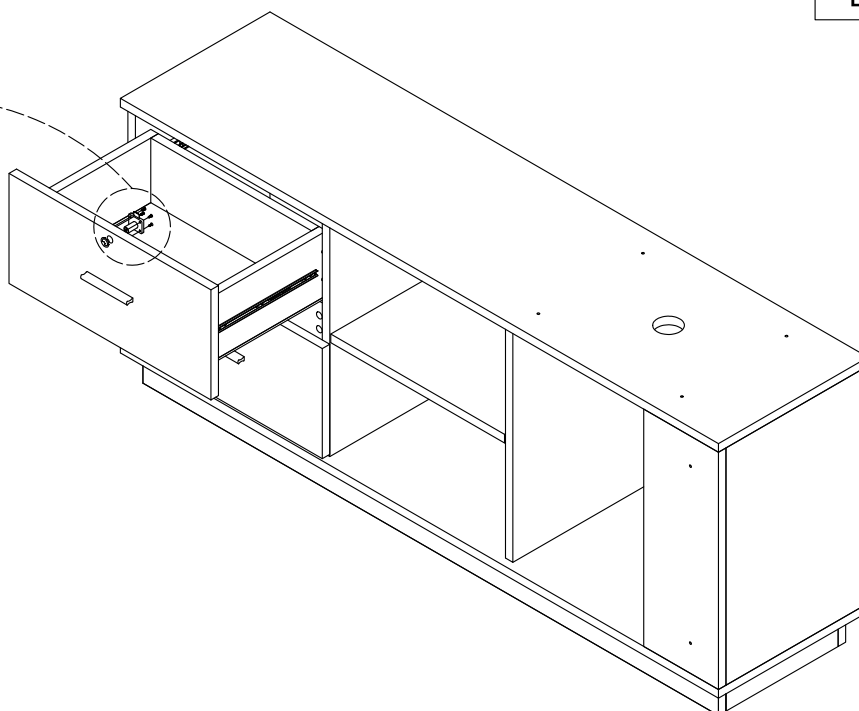
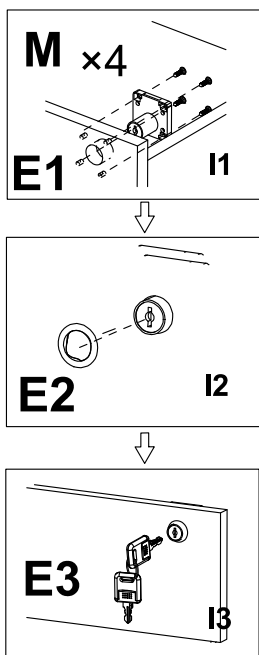
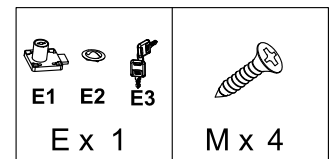

12.

Install drawer locks and handles

Assemble the table support

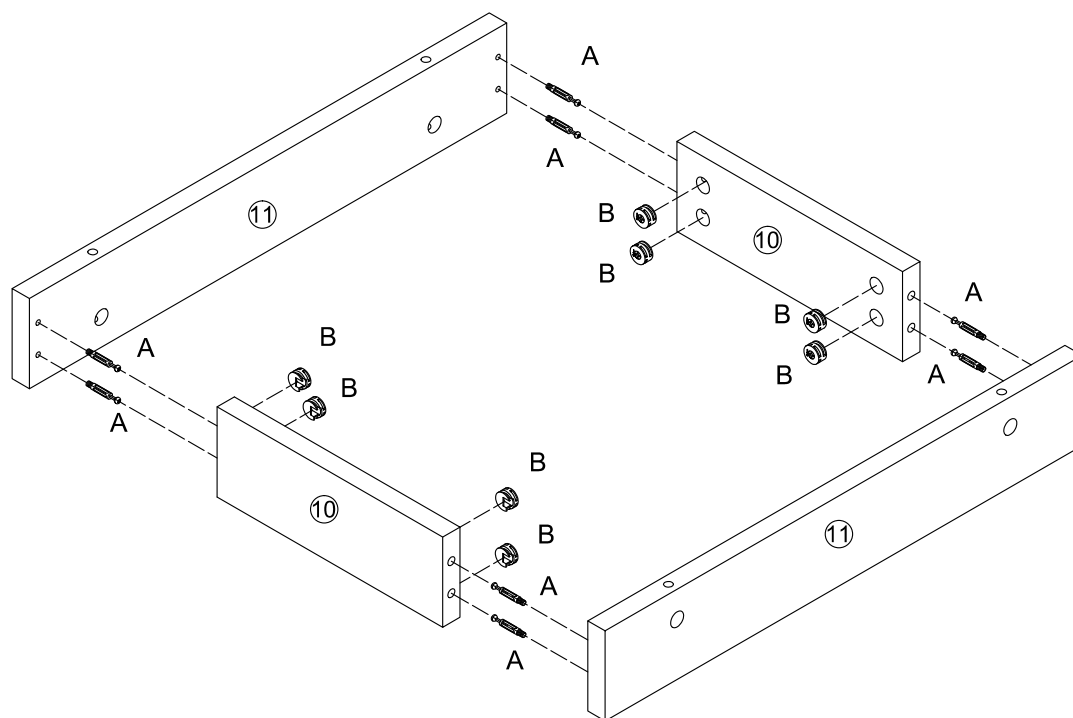
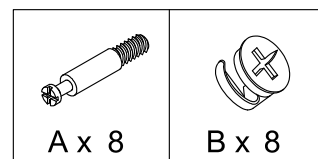

13.

Install the desktop support on the side cabinet

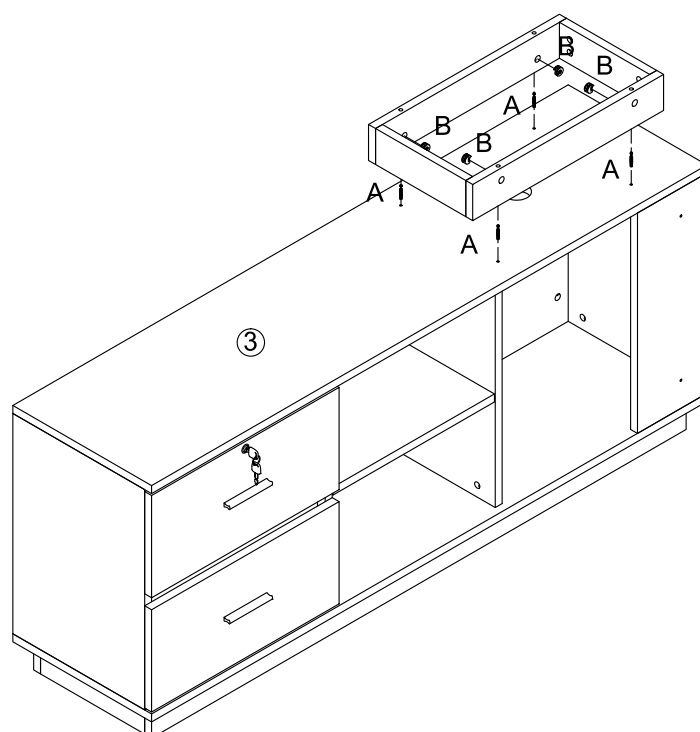
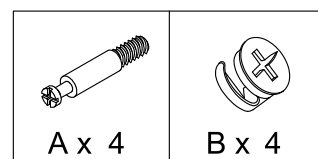

14.

The desktop is mounted via a hinged link

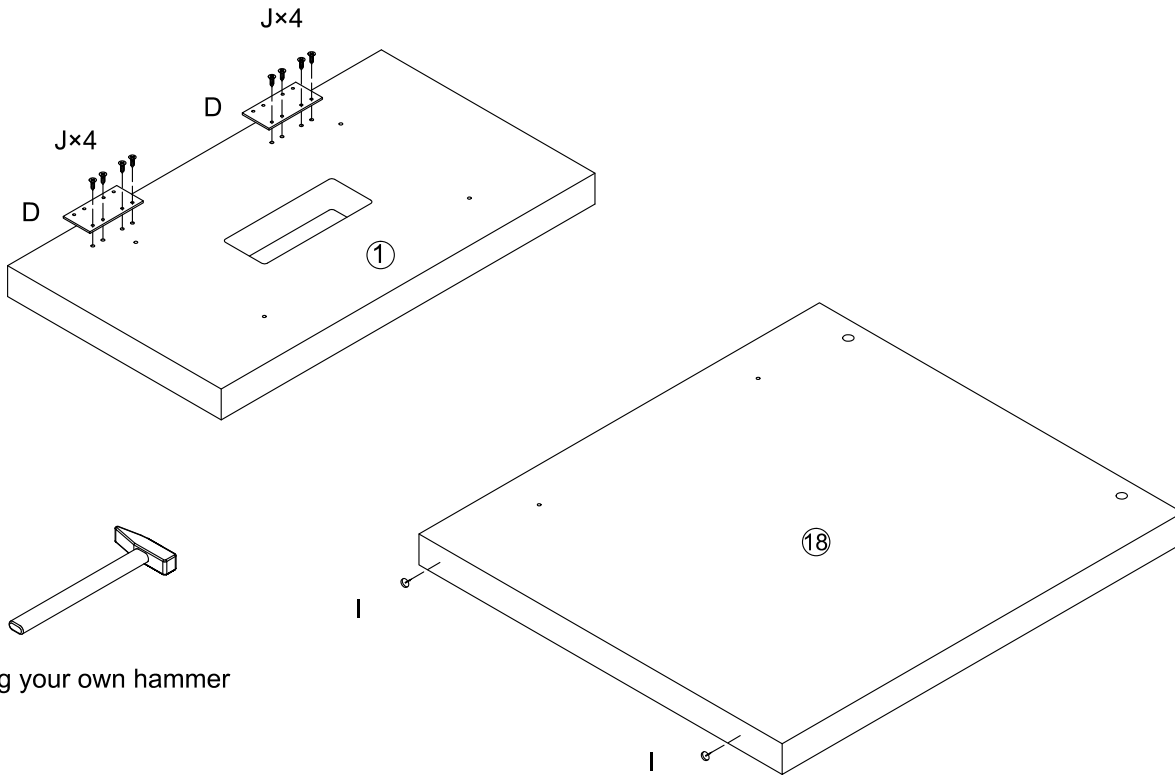
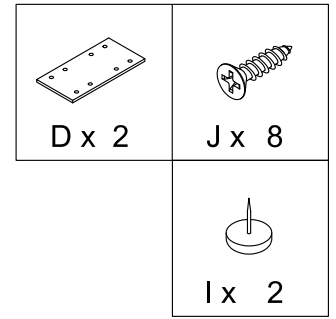

Bring your own hammer

15.

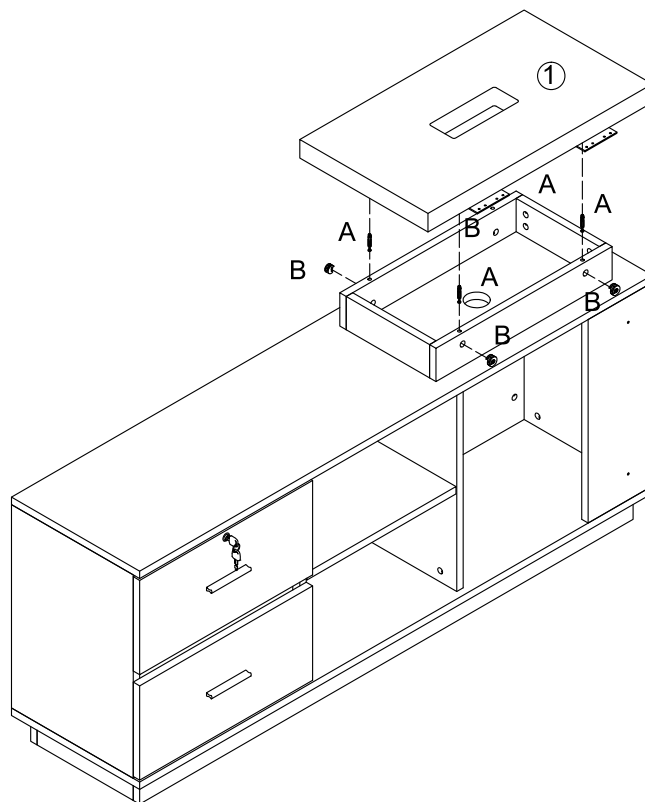
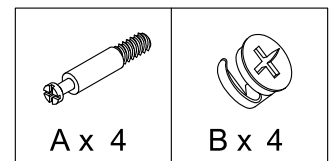

16.

Small desktop mounted via AB and support section

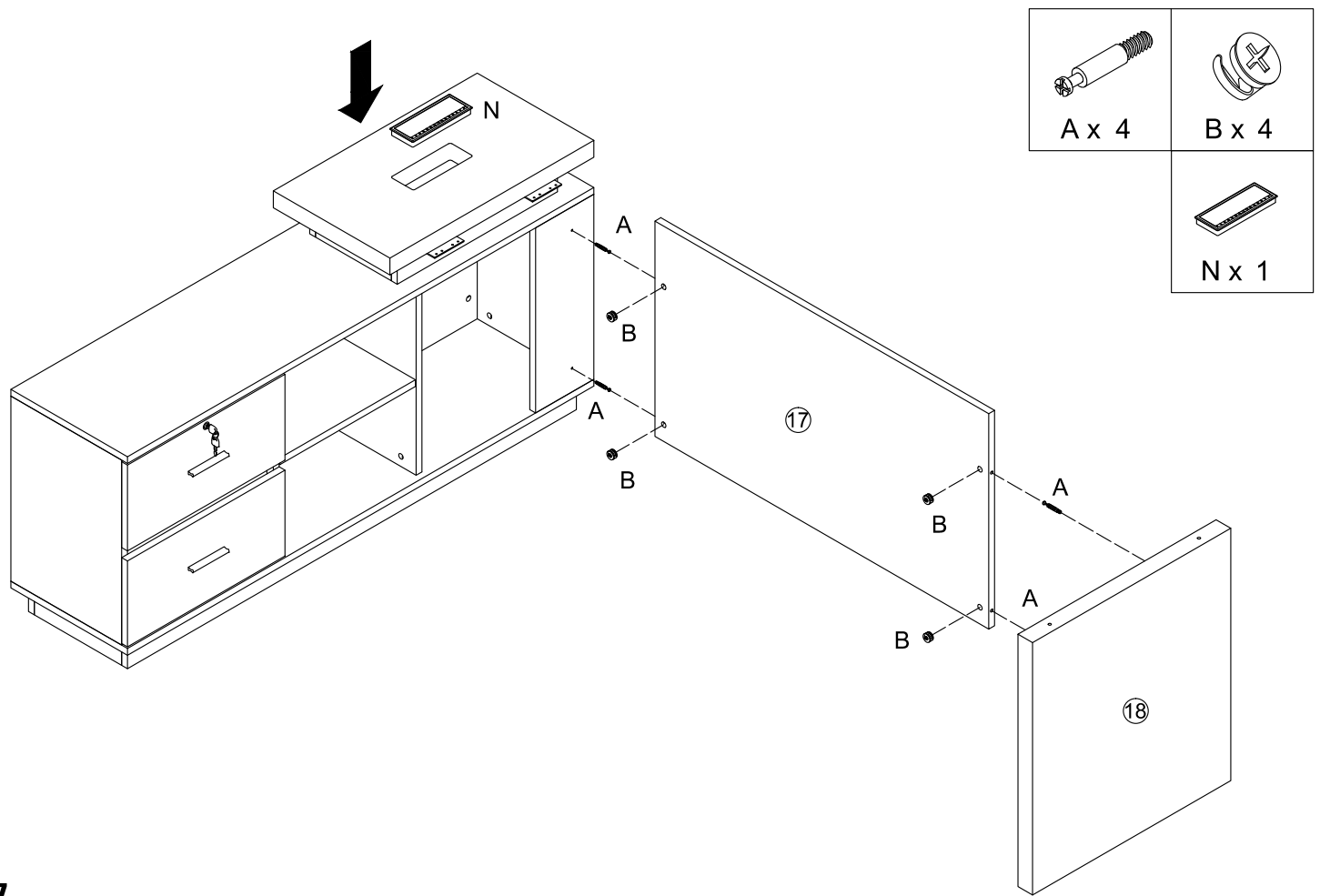

17. Install the front baffle and support feet

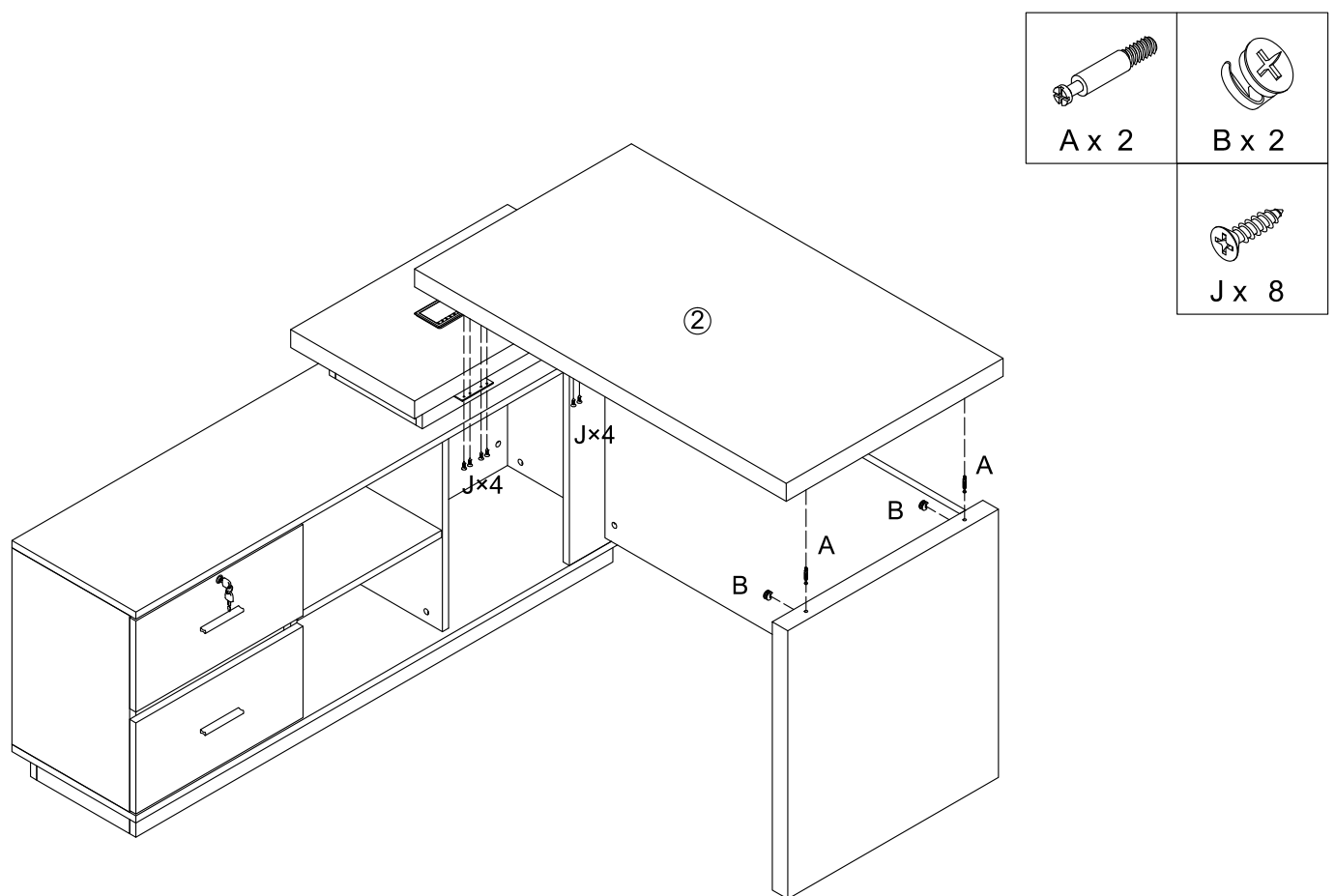

18. The desktop is installed and the desk is installed