

DEFIANT®

Item #1008006852
Model #IS06a300025W-01

USE AND CARE GUIDE

MOTION SECURITY LIGHT

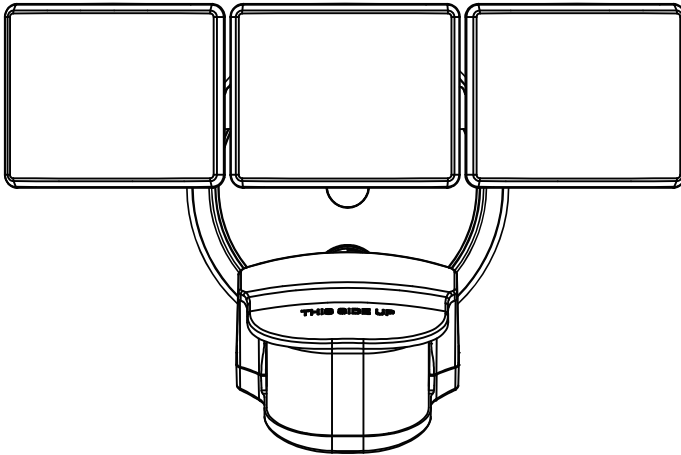

Questions, problems, missing parts?
Before returning to the store, call Defiant Customer Service
8 a.m.-7 p.m., EST, Monday-Friday, 9 a.m. - 6 p.m., EST, Saturday

1-866-308-3976

HOMEDEPOT.COM

THANK YOU

We appreciate the trust and confidence you have placed in Defiant through the purchase of this motion security light. We strive to continually create quality products designed to enhance your home. Visit us online to see our full line of products available for your home improvement needs. Thank you for choosing Defiant!

Table of Contents

Table of Contents	2	Tools Required	3
Safety Information	2	Hardware Included	4
Warranty	3	Package Contents	4
5-Year Limited Warranty	2	Installation	5
Pre-Installation	3	Operation	7
Planning Installation	3	Care and Cleaning	9
Specifications	3	Troubleshooting	9

Safety Information

PRECAUTIONS

- Please read and understand this entire manual before attempting to assemble, install, or operate this light fixture.
- This light fixture requires a 120-Volt AC power source.
- Some codes require installation by a qualified electrician.
- This light fixture should be installed outdoors to a wall or eave.
- The light fixture should be mounted approximately 8 ft. (2.4 m) above the ground. If the light fixture is mounted higher than recommended, aiming the sensor down will reduce the coverage area. .



WARNING: Turn the power off at the circuit breaker or fuse. Place tape over the circuit breaker switch and verify power is off at the light fixture.



WARNING: Risk of fire. Keep the lamp heads at least 2 in. (51 mm) from combustible materials.



CAUTION: Burn hazard. Allow the light fixture to cool before touching.

NOTICE: Do not connect this light fixture to a dimmer switch or timer.

NOTICE: Any changes or modifications to this unit not expressly approved by the party responsible for compliance could void the user's authority to operate the equipment.

NOTICE: This equipment has been tested and found to comply with the limits for a Class B digital device, pursuant to part 15 of the FCC Rules. These limits are designed to provide reasonable protection against harmful interference in a residential installation. This equipment generates, uses and can radiate radio frequency energy and, if not installed and used in accordance with the instructions, may cause harmful interference to radio communications. However, there is no guarantee that interference will not occur in a particular installation. If this equipment does cause harmful interference to radio or television reception, which can be determined by turning the equipment off and on, the user is encouraged to try to correct the interference by one or more of the following measures:

- Reorient or relocate the receiving antenna.
- Increase the separation between the equipment and receiver.
- Connect the equipment into an outlet on a circuit different from that to which the receiver is connected.
- Consult the dealer or an experienced radio/TV technician for help.

- This device complies with Part 15 of the FCC Rules. Operation is subject to the following two conditions:
(1) this device may not cause harmful interference, and (2) this device must accept any interference received, including interference that may cause undesired operation.

FCC compliance information is listed as below:

Responsible party: Leedaron America, Inc.

Responsible party address: 300 Technology Court SE Suite 100, Smyrna, GA 30082

Telephone number: (678) 293-8382

Warranty

5-YEAR LIMITED WARRANTY

WHAT IS COVERED

This product is guaranteed to be free of factory defective parts and workmanship for a period of 5 years from date of purchase. Purchase receipt is required for all warranty claims.

WHAT IS NOT COVERED

This guarantee does not include repair service, adjustment and calibration due to misuse, abuse or negligence, or LEDs. Unauthorized service or modification of the product or of any furnished component will void this warranty in its entirety. This warranty does not include reimbursement for inconvenience, installation, setup time, loss of use, unauthorized service, or return shipping charges. This warranty is not extended to other equipment and components that a customer uses in conjunction with this product.

No service parts available for this product.

Contact the Customer Service Team at 1-866-308-3976 or visit www.homedepot.com.

Pre-Installation

PLANNING INSTALLATION

Before installing the light fixture, ensure that all parts are present. Compare parts with the *Hardware Included* and *Package Contents* sections. If any part is missing or damaged, do not attempt to assemble, install, or operate this light fixture.

SPECIFICATIONS

Range	Up to 40 ft. (12.2 m) (Varies with surrounding temperature)
Sensing angle	Up to 240°
Wattage	26 Watts
Lumens	3000lm
Input voltage	120 VAC, 60 Hz
Operating modes	Test, Motion on, DTD(motion off)

TOOLS REQUIRED



Phillips screwdriver



1/8 in. Flathead screwdriver



Wire strippers/cutters



Circuit tester



Work gloves



Silicone sealant



Ladder



Safety goggles

Pre-Installation (continued)

HARDWARE INCLUDED

 **NOTE:** Hardware shown to actual size.

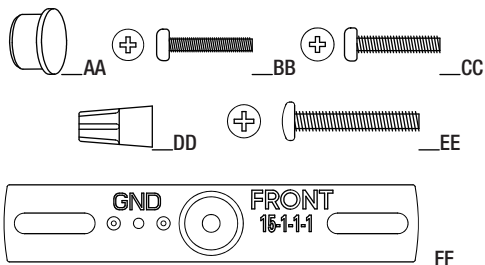

Part	Description	Quantity
AA	Rubber plug	1
BB	Mounting bracket screw	2
CC	Mounting bracket screw	2
DD	Wire nut	2
EE	Mounting bolt	1
FF	Mounting bracket (not to scale)	1

PACKAGE CONTENTS

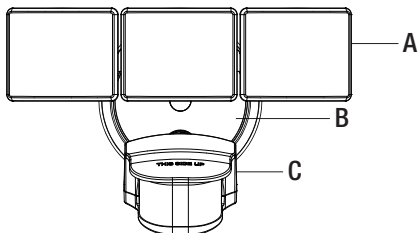

Part	Description	Quantity
A	Lamp head	3
B	Light fixture	1
C	Motion sensor	1

Installation

1 Determining the mounting location



NOTE: The light fixture should be mounted approximately 8 ft. (2.4 m) above the ground. If the light fixture is mounted higher than recommended, aiming the sensor down will reduce the coverage area.

- Determine the mounting location – wall or eave mount.
- Position the lamp heads (A) in the general direction of the desired light coverage.

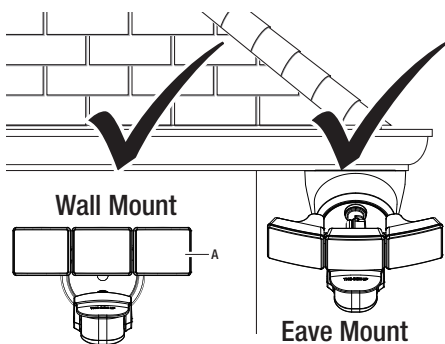

2 Installing the mounting bracket



WARNING: Turn the power off at the circuit breaker or fuse. Place tape over the circuit breaker switch and verify power is off at the light fixture.



NOTE: Four mounting bracket screws of various sizes are included. The installation will only require two. Discard the unused mounting bracket screws after installation.

- Remove the existing light fixture.
- Install the mounting bracket (FF) with the stamped word “FRONT” facing away from the junction box. Use the mounting bracket screws (BB or CC) that best fit the junction box. If necessary, use the screws that were removed from the existing light fixture.
- Firmly pull on the mounting bracket (FF) to verify it is securely mounted to the junction box.

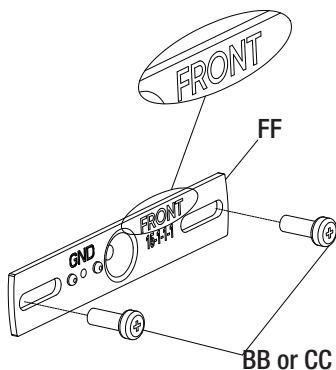

3 Making the electrical connections

- Connect the white wire of the fixture to the white wire from the junction box with wire nut (DD).
- Connect the black wire of the fixture to the black wire from the junction box with wire nut (DD).

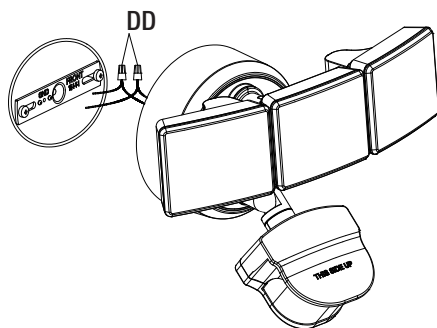

4 Mounting the light fixture

- Align the fixture (B) with the mounting plate (FF). And then tighten the mounting bolt (EE) securely through the center of the mounting plate (FF). Do not over tighten.
- Push the rubber plug (AA) firmly into the mounting bolt hole on the light fixture (B).

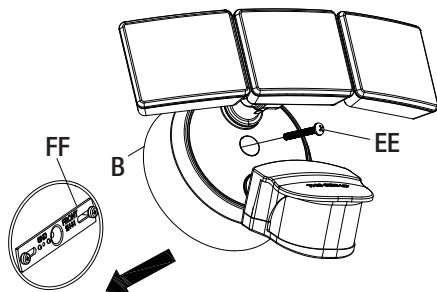
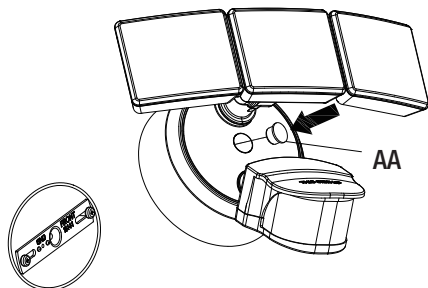

NOTICE: When attaching this light to an external, surface mount junction box, caulk around the inside of the light fixture (B) before attaching to the light fixture (B).

5 Caulking around the light fixture

IMPORTANT: Failure to completely caulk around the light fixture base (B) could lead to water damage and is not covered under warranty.

- Caulk around the light fixture base (B) and mounting surface with silicone sealant (not included).

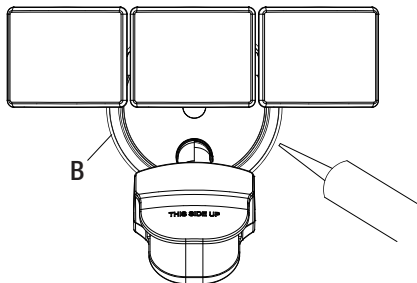

1 Adjusting the lamp heads



WARNING: Risk of fire. Keep the lamp heads at least 2 in. (51 mm) from combustible materials.

- Turn the power on at the circuit breaker or fuse and turn on the wall switch.
- If needed, gently grasp the lamp heads (A) and tilt them up or down or side to side to adjust the light coverage area.

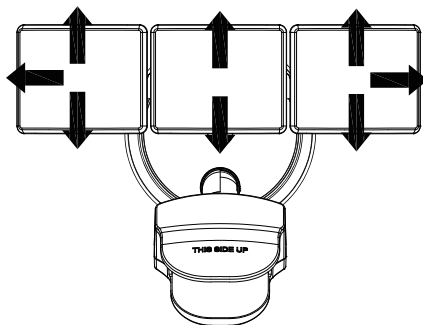

2 Setting the sensor for testing



NOTE: When the "Test / Timer" control is set to the "Test" position, the light fixture will operate during the day or night. The light will stay on for 5–8 seconds after all motion is stopped.

- Turn the "TIMER MINUTES" control to the "Test" position. And the indicator will flash 6 times.
- Turn the "SENSITIVITY" control to the position you want.



NOTE: The motion sensor will need to completely warm up (30 seconds) before beginning the setup process.

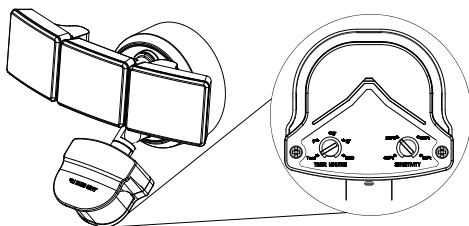

3 Adjusting the motion sensor detection zone

- Perform a "walk test": walk in an arc across the front of the motion sensor (C).
- Watch the light. The light will come on and the red LED will flash indicating motion has been detected.
- Stop, wait for the light to turn off, and then begin walking again.
- Continue this process until the detection zone has been established.

- If needed, gently grasp the motion sensor (C) and move it from side to side or up and down to adjust the detection zone.
- To ensure the motion sensor work properly, please keep the marking "THIS SIDE UP" on the motion sensor up.



- It's recommended to keep the motion sensor tilt angle within 40° under daily usage.

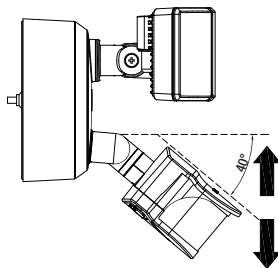
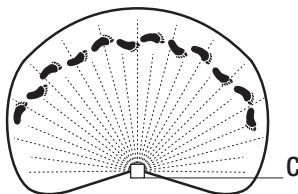

4 Adjusting the SENSITIVITY control

- To increase the sensitivity, turn the "SENSITIVITY" control counterclockwise.
- To decrease the sensitivity, turn the "SENSITIVITY" control clockwise.



NOTE: The motion sensor (C) is more sensitive to motion moving across the front of the sensor. The motion sensor (C) is less sensitive to motion moving directly toward the front of the sensor.



NOTE: The higher the "SENSITIVITY" setting, the greater the possibility of false triggering. To reduce false triggering, please choose the sensitivity you need.

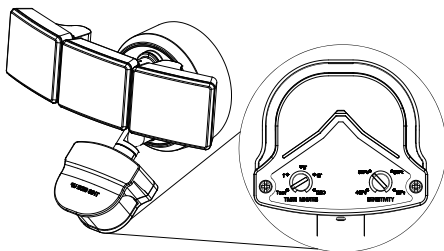

5 Adjusting the TIMER control



NOTE: The "TIMER MINUTES" control determines the amount of time the light will stay on full bright after all motion has stopped. And if you turn to "D2D" position, it will be a dusk to dawn (night time) light.

- Auto mode: After all adjustments are complete, turn the "TIMER MINUTES" control clockwise and select a time 1/5/10 minutes. The light will only work at night after a time has been selected.
- D2D mode: If you turn the "TIMER MINUTES" to "D2D" position, it will be a dusk to dawn (night time) light. The motion detection will be off, and the light will be always on at night, will turn off in the day time.
- Manual Override mode: When the light is on and setting the "TIMERS MINUTES" at 1'1/5'/10' position, if you quickly switch off and then on within 3 seconds, the light will enter the "Manual Override" mode. In this mode, the light will keep on around 5.5 hours and then return to "Auto" mode and work according to your setting(1/5/10 minutes). If you don't want keep "Manual Override" mode, switching off and on within 3 seconds to change it back to "Auto" mode. Or you can switch off for more than 5 seconds before switching on, the light will restart.

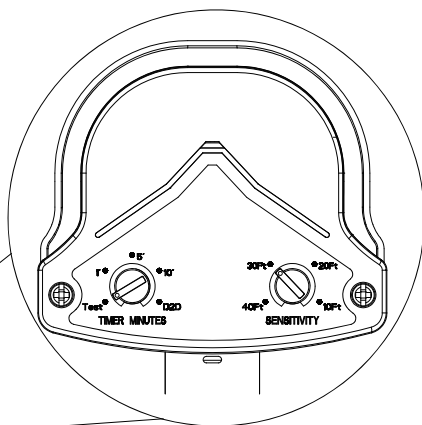
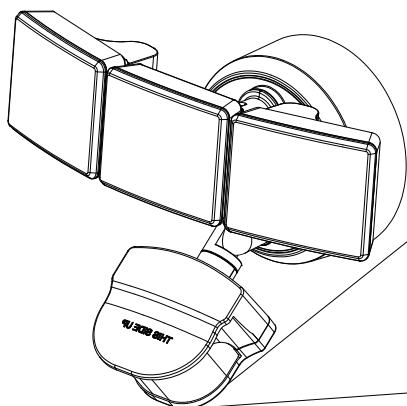

Care and Cleaning

- To prolong the original appearance, clean the light fixture with clear water and a soft, damp cloth only.
- Do not use paints, solvents, or other chemicals on this light fixture. They could cause a premature deterioration of the finish. This is not a defect in the finish and will not be covered by the warranty.
- Do not spray the light fixture with a hose or power washer.

Troubleshooting

Problem	Possible Cause	Solution
The light will not come on.	<ul style="list-style-type: none"> □ The light switch is turned off. □ The fuse is blown or the circuit breaker is turned off. □ Daylight turn-off (photocell) is in effect. □ The circuit wiring is incorrect (if this is a new installation). □ The motion sensor is aimed in the wrong direction. 	<ul style="list-style-type: none"> □ Turn the light switch on. □ Replace the fuse or turn the circuit breaker on. □ Recheck after dark. □ Verify the wiring is correct. □ Re-aim the motion sensor to cover the desired area.
The light comes on during the day.	<ul style="list-style-type: none"> □ The motion sensor may be installed in a relatively dark location. □ The "Test / Timer" control is in the "Test" position. 	<ul style="list-style-type: none"> □ The light fixture is operating normally under these circumstances. □ Set the "TIMER MINUTES" control to a timed setting.
The light comes on for no apparent reason.	<ul style="list-style-type: none"> □ The motion sensor may be sensing small animals, automobile traffic, or other heat sources. □ The "SENSITIVITY" control is set too high. □ The outside temperature is much warmer or cooler than a person's body heat (summer or winter). □ The light fixture is wired through a dimmer or timer. 	<ul style="list-style-type: none"> □ Decrease the "SENSITIVITY" setting or reposition the motion sensor. □ Decrease the "SENSITIVITY" setting. □ Decrease the "SENSITIVITY" setting. □ Do not use a dimmer or timer to control the light fixture. Replace the dimmer or timer with a standard on/off wall switch.

Troubleshooting (continued)

Problem	Possible Cause	Solution
The lights stay on continuously.	<ul style="list-style-type: none"> <li data-bbox="346 167 713 264">□ The motion sensor may be picking up a heat source, such as an air vent, dryer vent, or brightly painted, heat-reflective surface. <li data-bbox="346 280 713 329">□ The light fixture is wired through a dimmer or timer. <li data-bbox="346 410 713 492">□ The light fixture is on the same circuit as a motor, transformer, or fluorescent bulb. 	<ul style="list-style-type: none"> <li data-bbox="735 167 1004 232">□ Decrease the “SENSITIVITY” setting or reposition the motion sensor. <li data-bbox="735 280 1004 394">□ Do not use a dimmer or timer to control the light fixture. Replace the dimmer or timer with a standard on/off wall switch. <li data-bbox="735 410 1004 508">□ Install the light fixture on a circuit without motors, transformers, or fluorescent bulbs.
The lights flash on and off.	<ul style="list-style-type: none"> <li data-bbox="346 532 713 581">□ Heat or light from the bulbs may be turning the motion sensor on and off. <li data-bbox="346 613 713 695">□ Heat is being reflected from other objects and may be turning the motion sensor on and off. <li data-bbox="346 711 713 760">□ The motion sensor is in “TEST” mode and warming up. 	<ul style="list-style-type: none"> <li data-bbox="735 532 1004 597">□ Reposition the lamp heads away from the motion sensor. <li data-bbox="735 613 1004 695">□ Decrease the “SENSITIVITY” setting or reposition the motion sensor. <li data-bbox="735 711 1004 824">□ While in “TEST” mode, the light only stays on for 5~8 seconds. Set the “TIMER MINUTES” control to a timed setting.



Questions, problems, missing parts?
Before returning to the store, call Defiant Customer Service
8 a.m.-7 p.m., EST, Monday-Friday, 9 a.m. - 6 p.m., EST, Saturday

1-866-308-3976

HOMEDEPOT.COM

Retain this manual for future use.