

Hall Tree

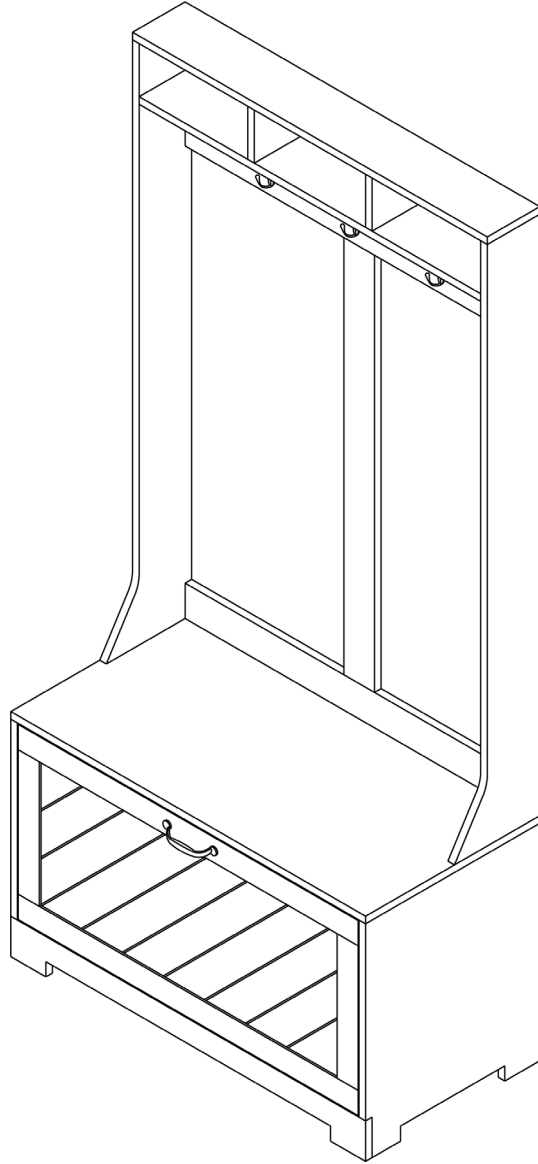



Estimated time for assembly:

120 mins



Weight limitations are as follows:

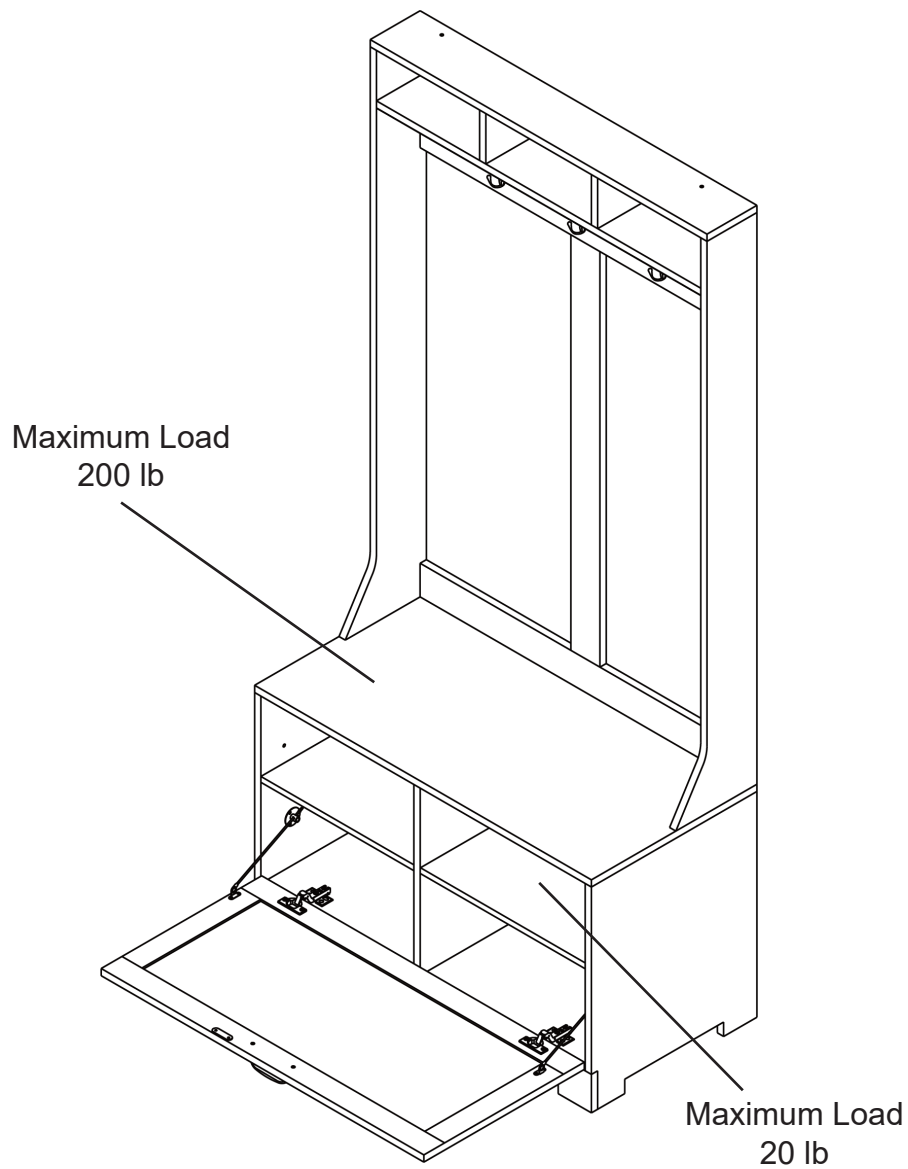

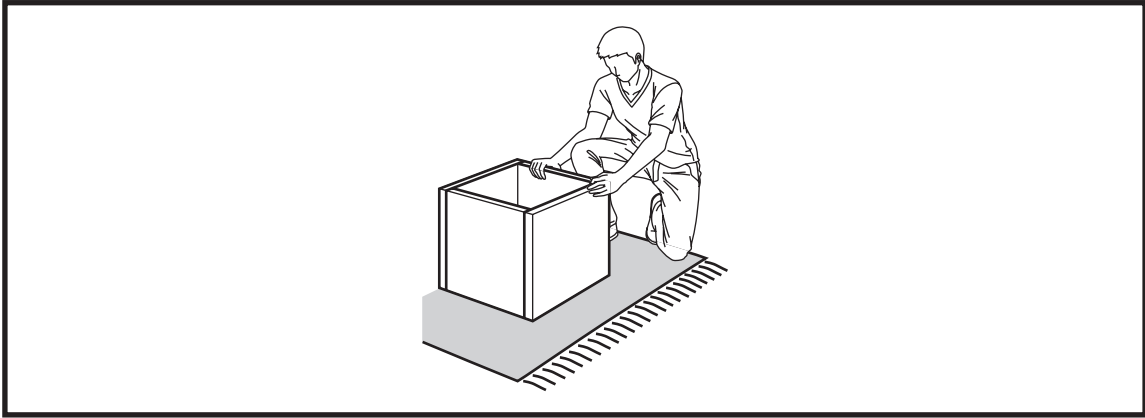

Assemble the furniture on an empty carton, carpet, or rug to prevent scratches or damage.

For safety, please keep pets and children away from the assembly area.

Ensure the product is fully assembled before use. If you are missing any hardware or products, do not use it until you have restored the missing parts.

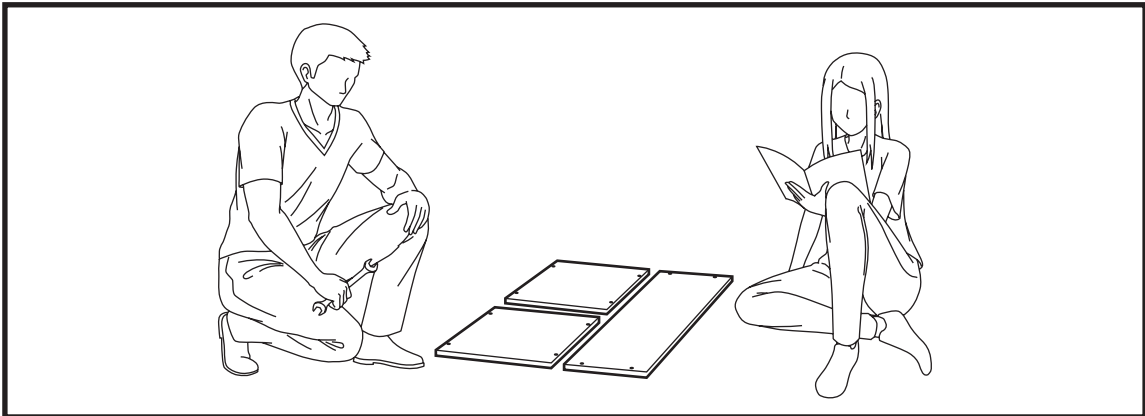

This furniture requires 2 people for assembly.

Read this instruction manual prior to assembly to familiarize yourself with the various steps.

Lay out all components and hardware separately on a flat surface and make sure that no parts are missing or damaged before assembly. Do not destroy or discard any packaging until you are certain that you have all the necessary parts for assembly.

CAUTION

There are small components used in the construction of this product. Loose items should be kept away from pets and children to avoid a choking hazard.

Keep all plastic bags and packaging film away from pets and children to avoid suffocation.

PACKAGE CONTENTS

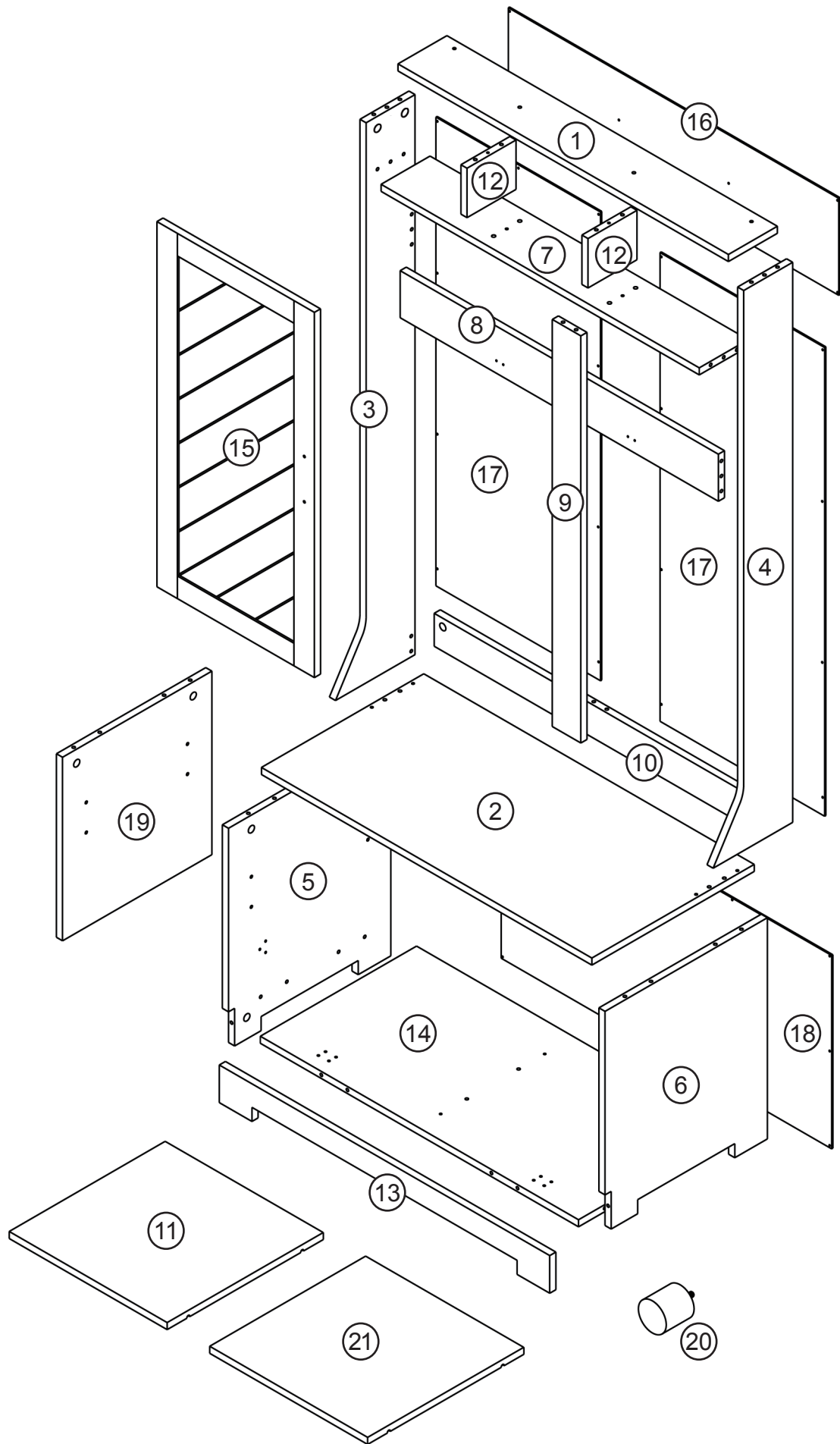

PACKAGE CONTENTS (A)

CODE	DESCRIPTION	QTY
1	Upper Shelf Top Panel	1
2	Bottom Storage Top Panel	1
3	Left Panel	1
4	Right Panel	1
5	Left Leg Panel	1
6	Right Leg Panel	1
7	Upper Shelf Bottom Panel	1
8	Upper Crossbar	1
9	Support Bar	1
10	Lower Crossbar	1
11	Storage Shelf	1
12	Upper Storage Vertical Panel	2
13	Toe Kick Panel	1
14	Bottom Storage Bottom Panel	1
15	Door	1
16	Top Back Panel	1
17	Center Back Panel	2
18	Bottom Back Panel	1
19	Bottom Storage Vertical Panel	1
20	Support Leg	1
21	Storage Shelf	1

PACKAGE CONTENTS

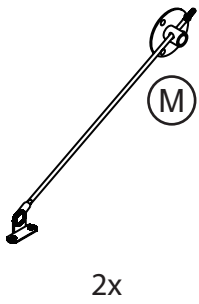
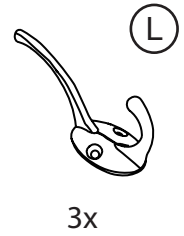
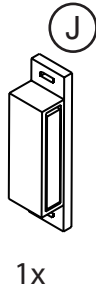
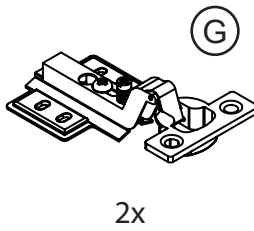
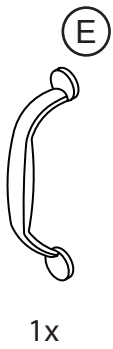
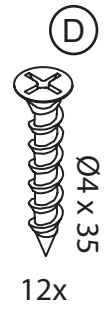
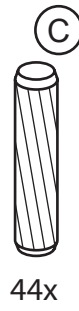
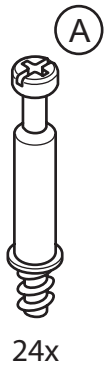

Install all hardware perpendicular to the opening.

PACKAGE CONTENTS

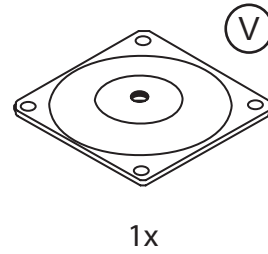
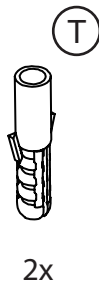
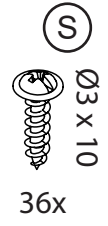
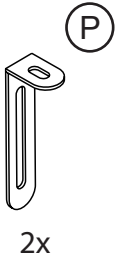

Required tools for assembly (Not included)

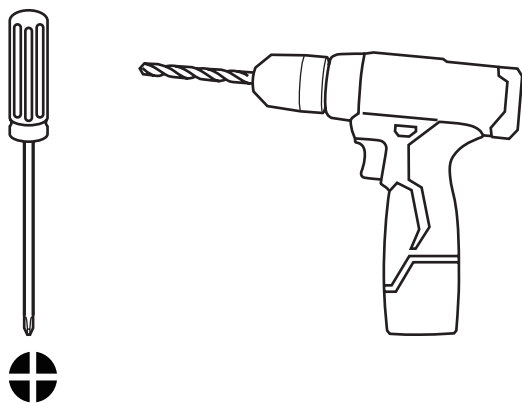

1

Attach cam bolts on the left panel, right panel, and upper shelf top panel.

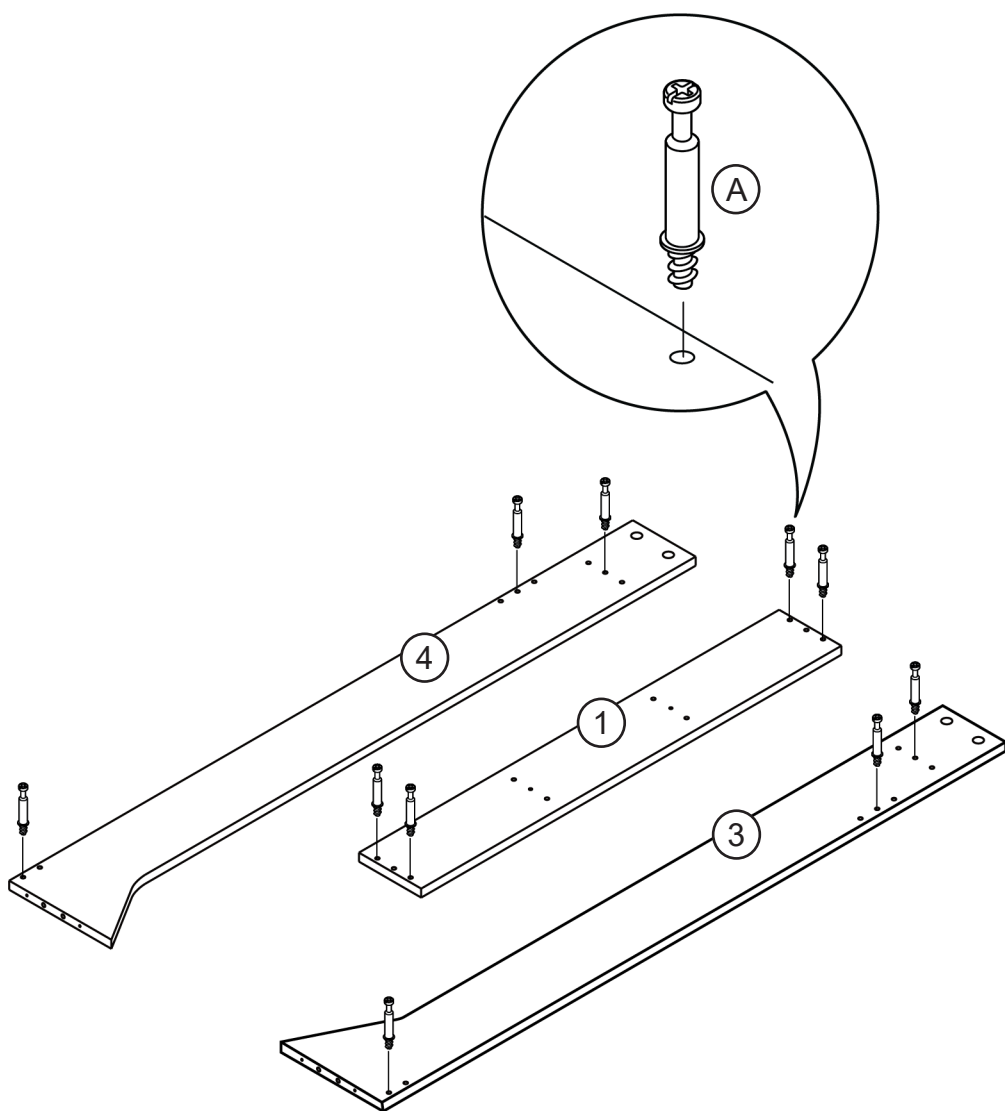
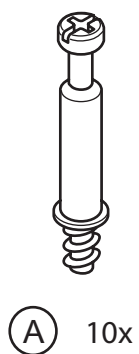

2

Attach hooks to the upper crossbar.



(K) 6x



(L) 3x

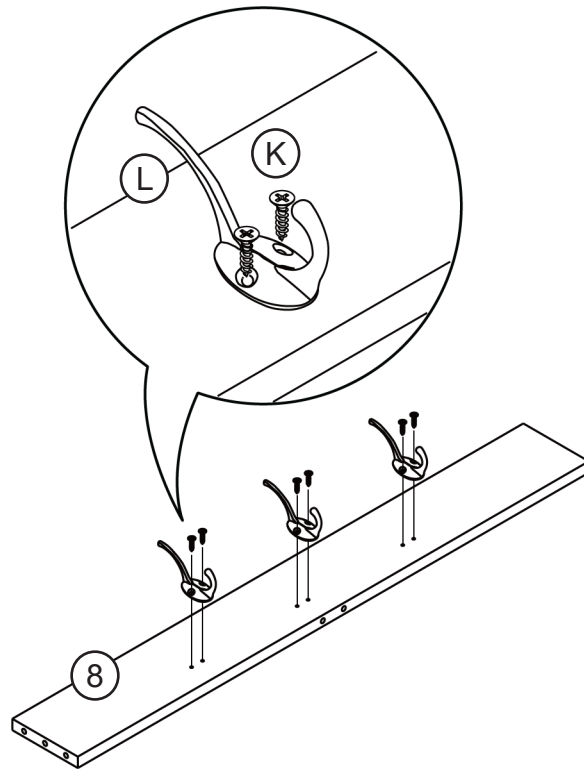

3

Attach wood dowels to the upper shelf bottom panel and vertical panels.



(C) 8x

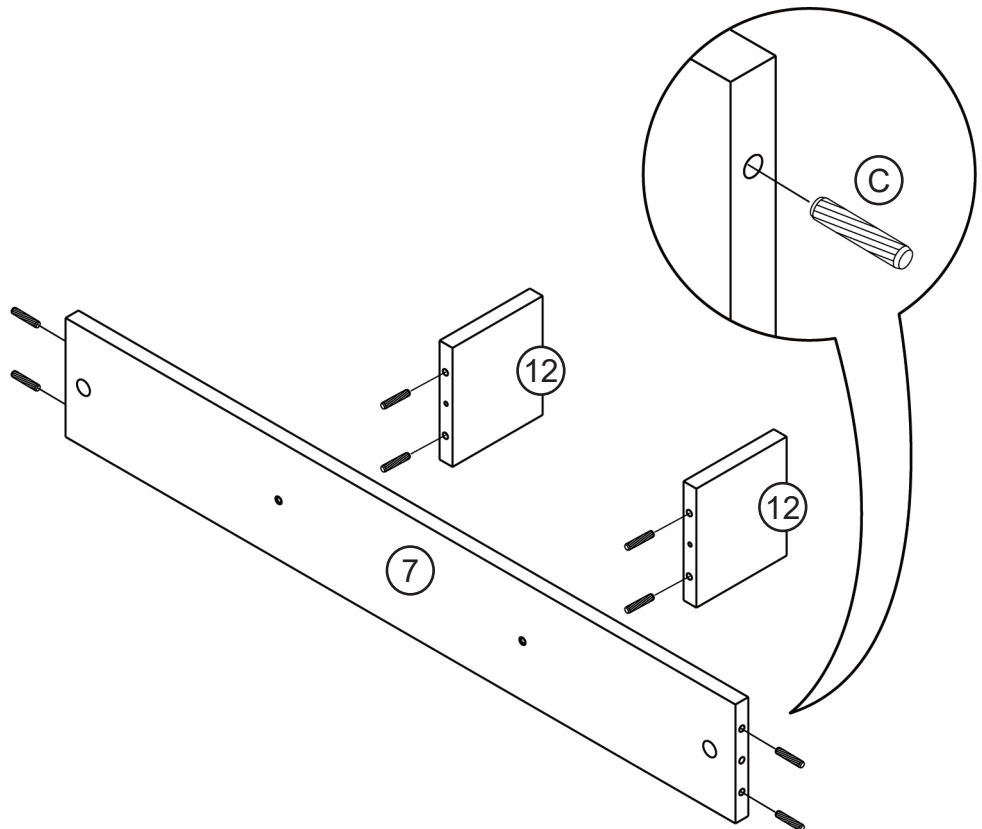

4

Attach the upper storage vertical panel to the upper storage bottom panel.



(D) 2x

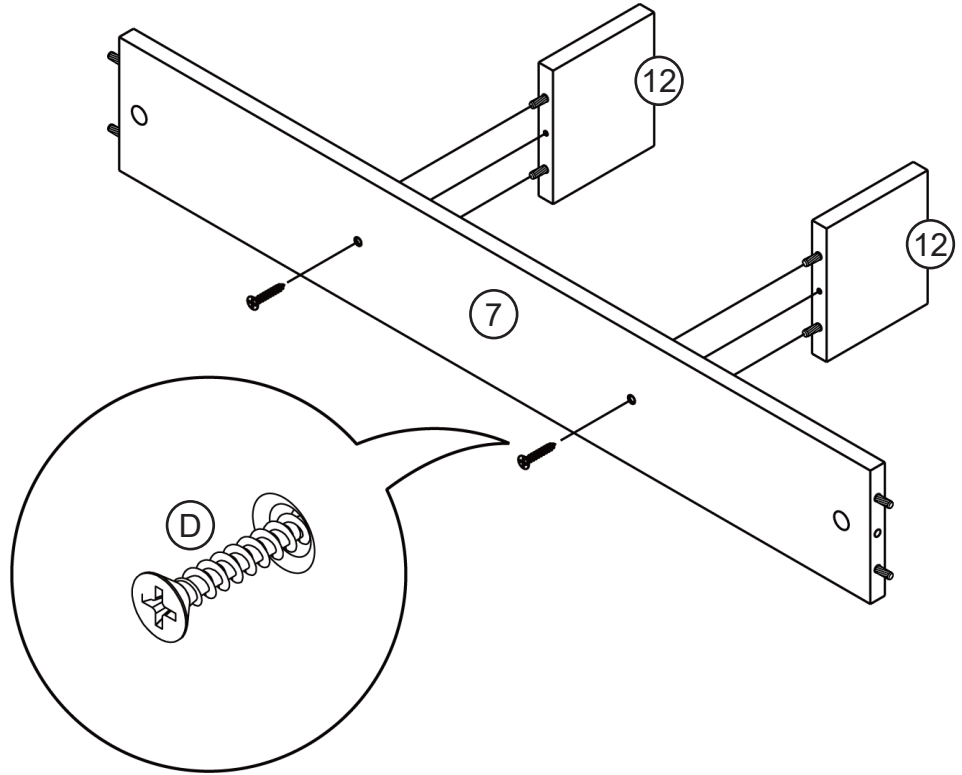

5

Attach wood dowels to the crossbars and the support bar, and assemble the support bar between the two crossbars.



(C) 10x

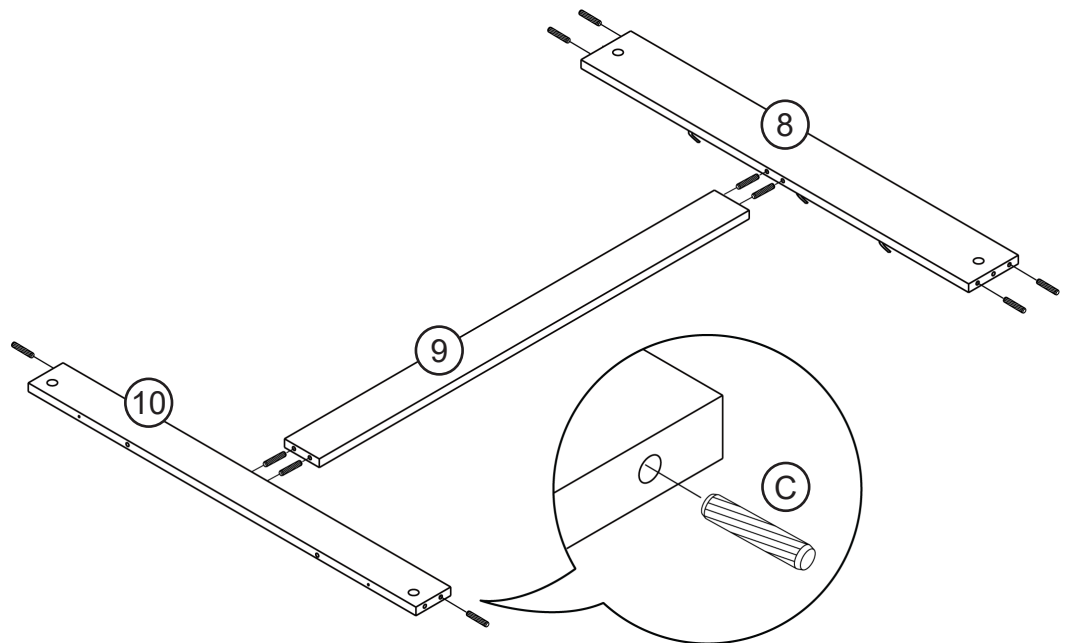

6

Attach the crossbars and the upper storage bottom panel to the right panel.



(B) 3x

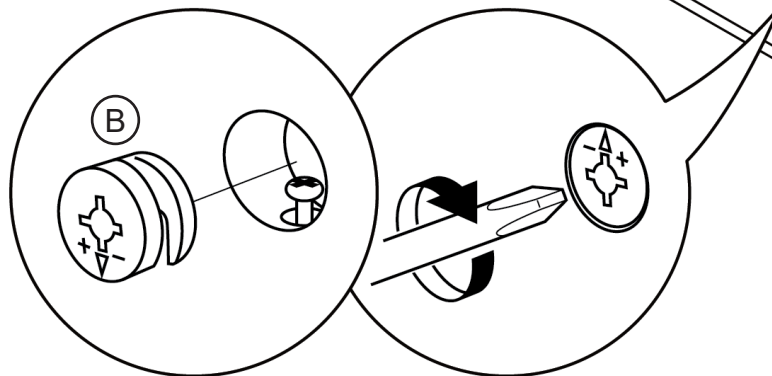
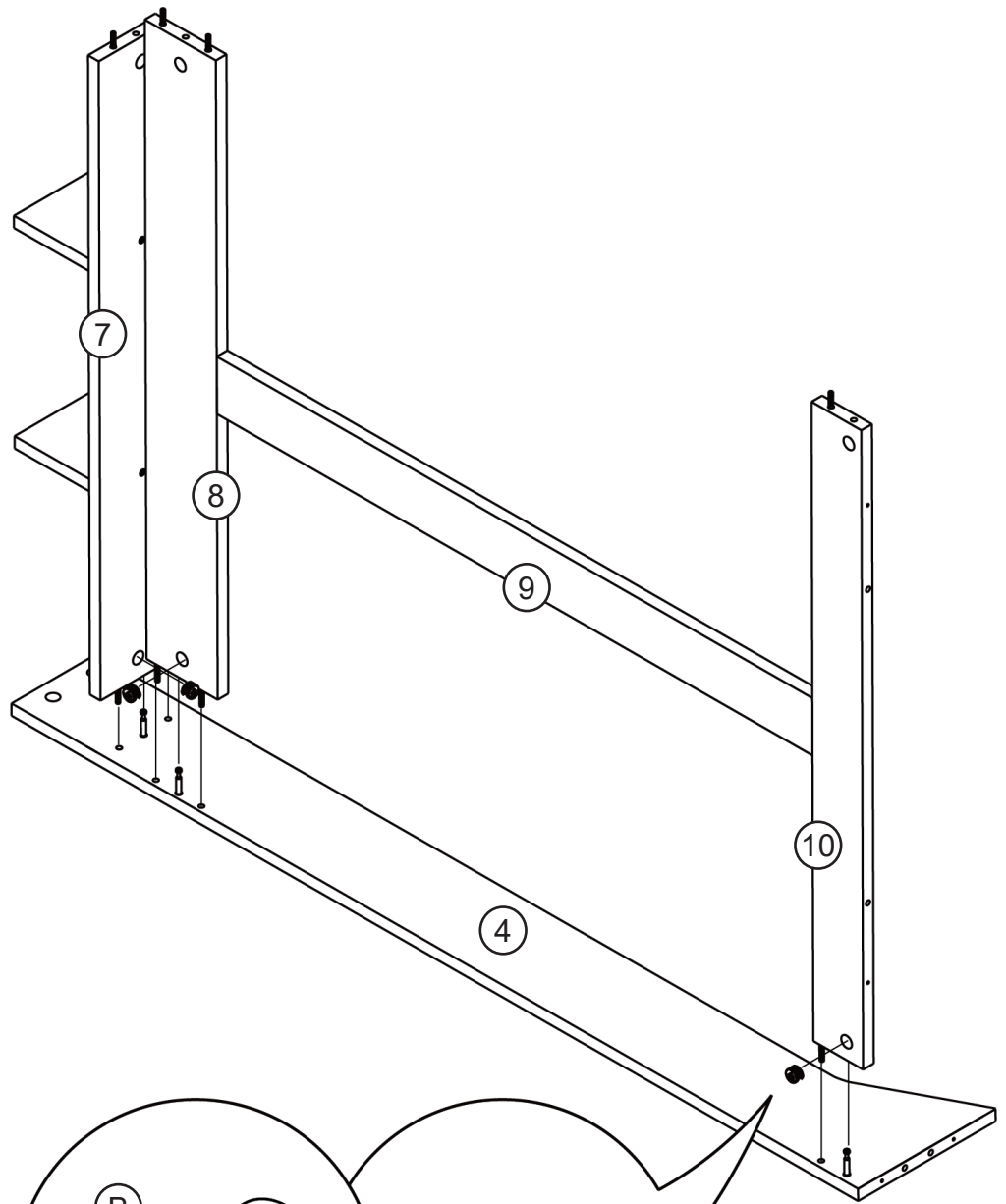

7

Attach the left panel to the assembly.



(B) 3x

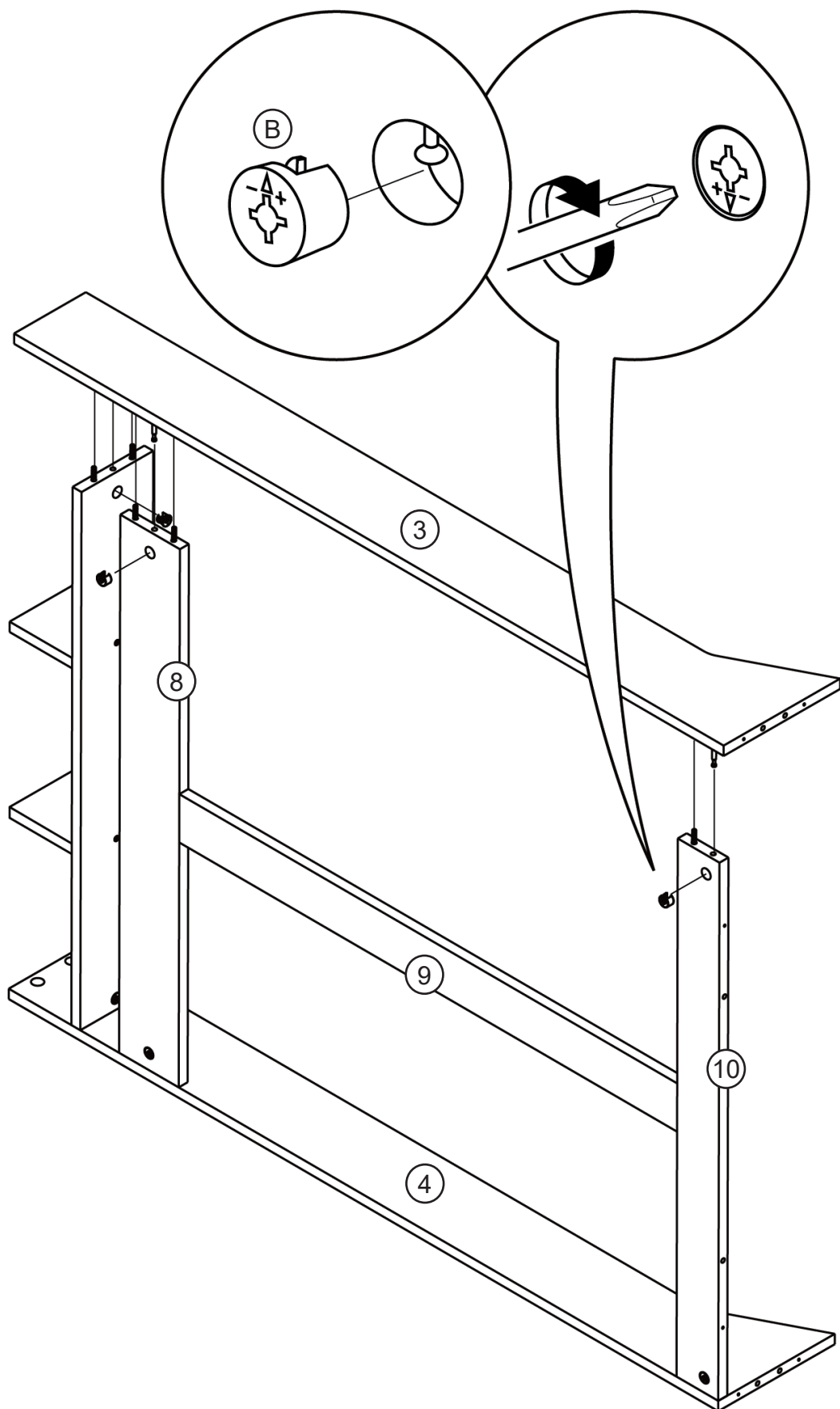

8

Attach wood dowels to the top side of the vertical panels and side panels.

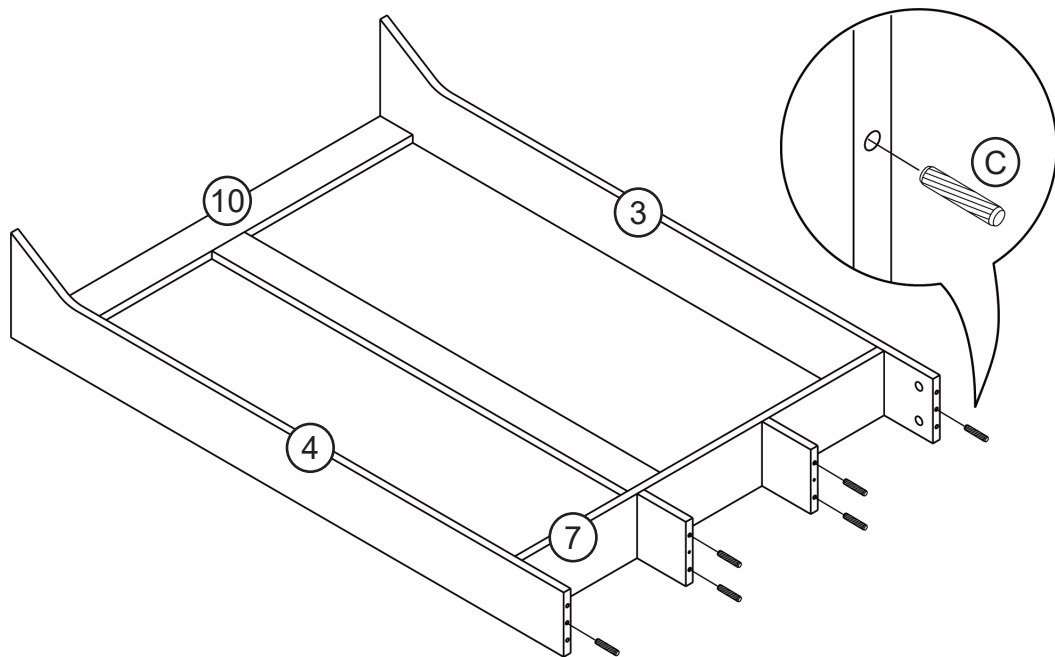
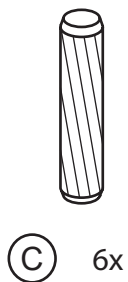

9

Attach the upper shelf top panel to the assembly.

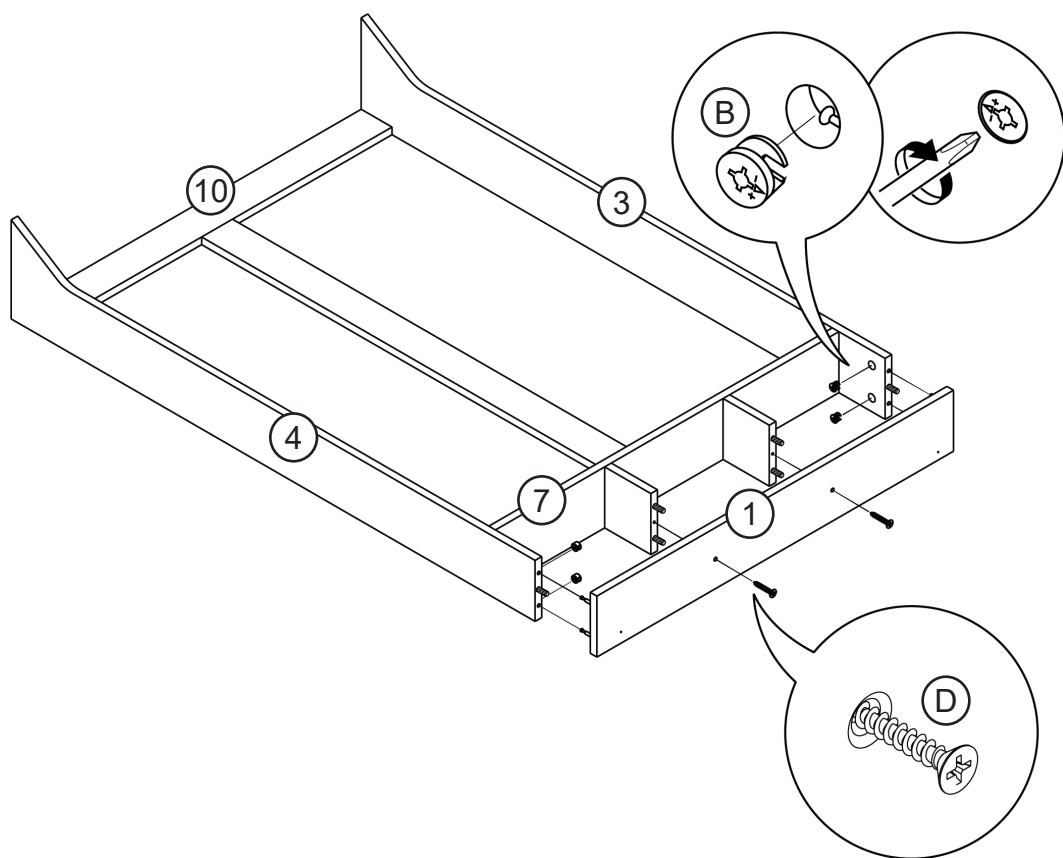

10

Attach cam bolts to the leg panels.

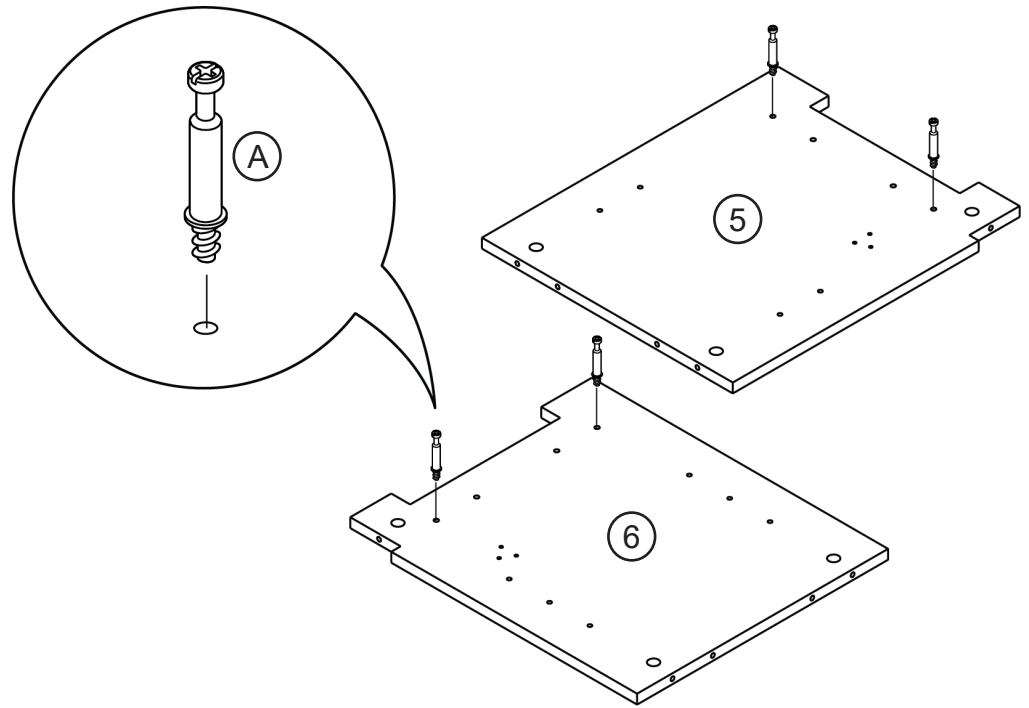
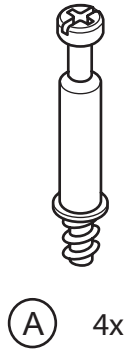

11

Assemble the flap stays on the leg panels.

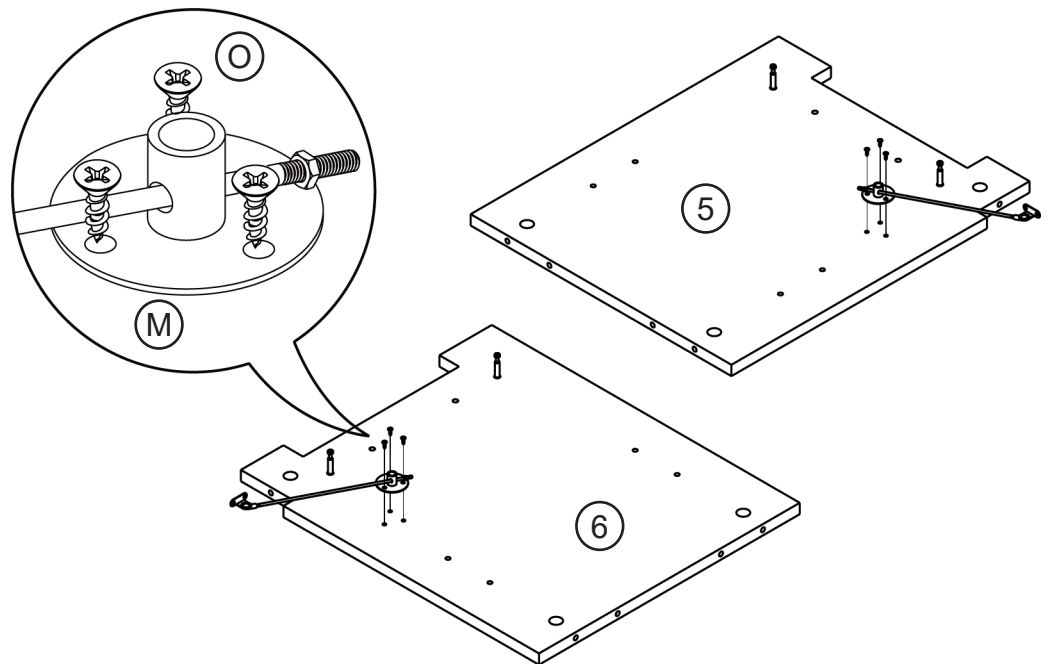
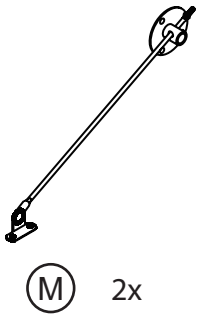

12

Attach the support leg bracket underneath the bottom storage bottom panel.



Q 4x

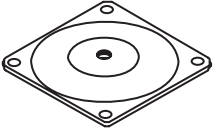

V 1x

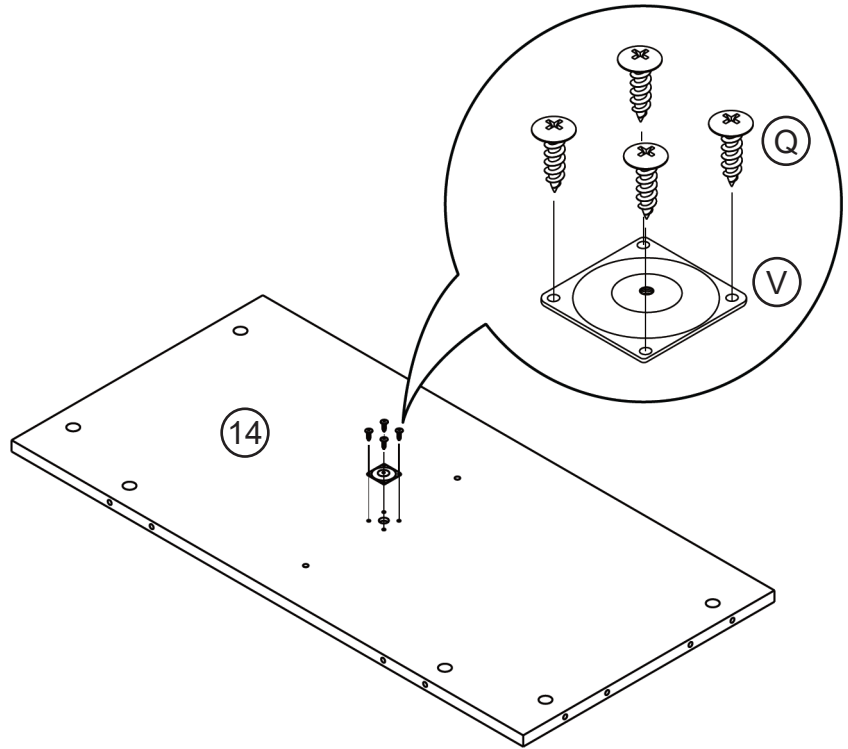

13

Attach wood dowels to the bottom storage bottom panel and vertical panel.



C 6x

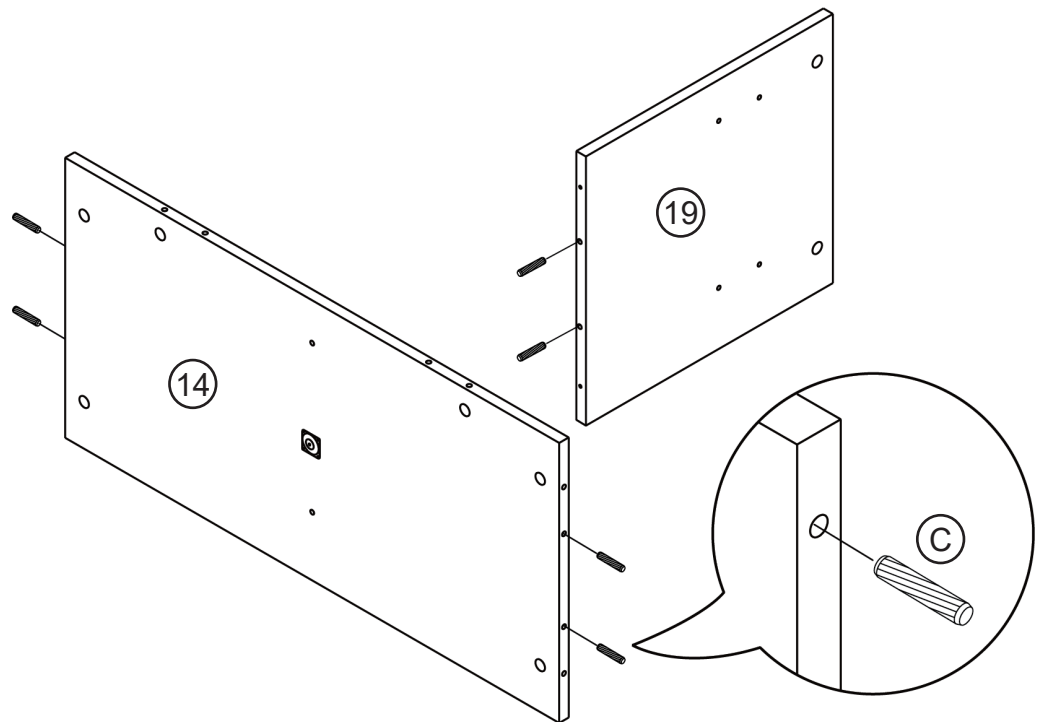

14

Attach the bottom storage vertical panel to the bottom storage.



(D) 2x

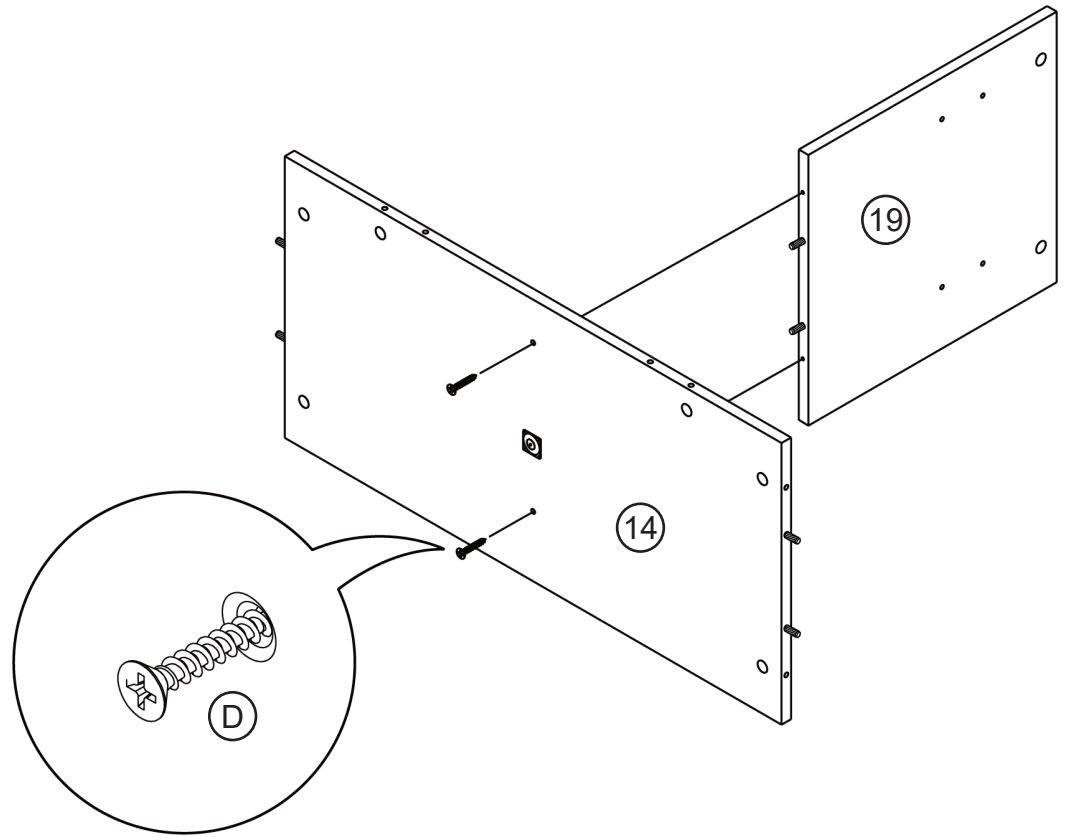

15

Attach the leg panels to the bottom storage bottom panel.



(B) 4x

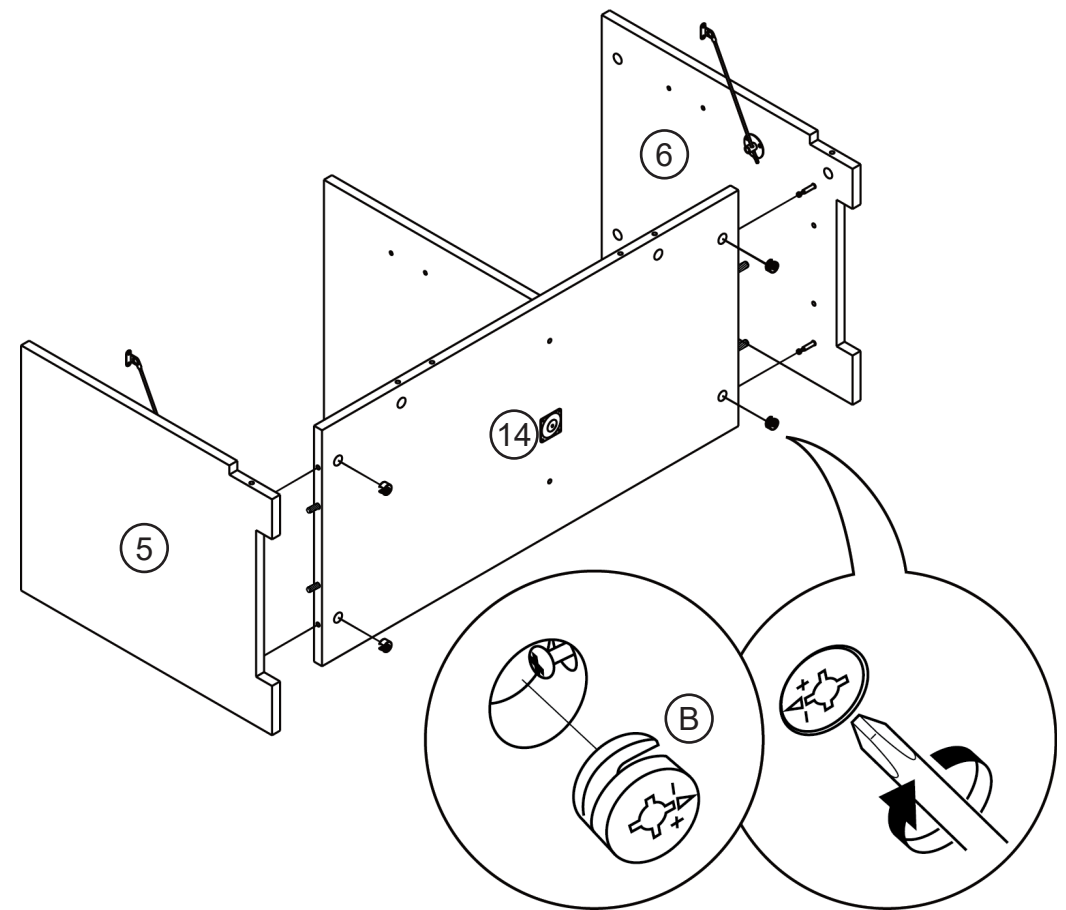

16

Attach cam bolts to the bottom storage top panel and the toe kick panel.

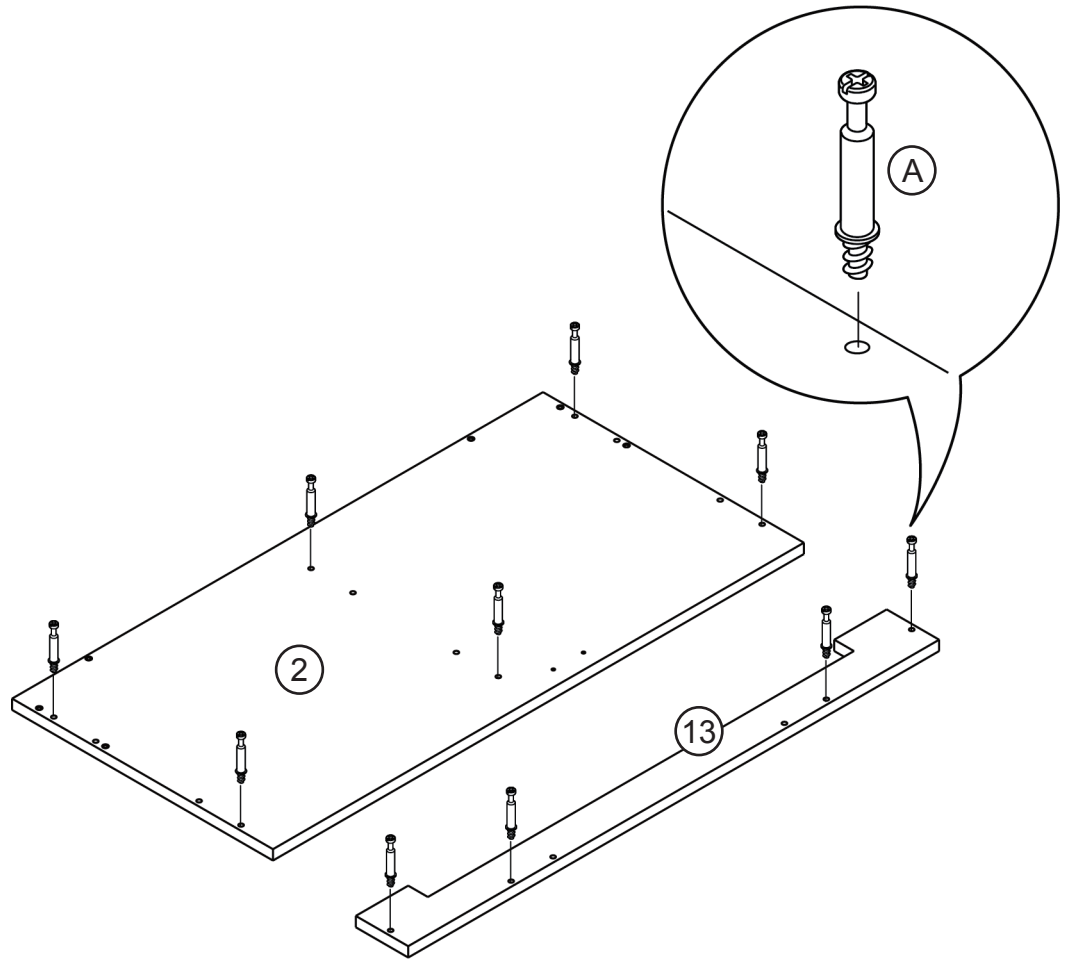
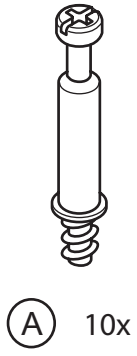

17

Attach the magnetic catch to the bottom storage top panel.

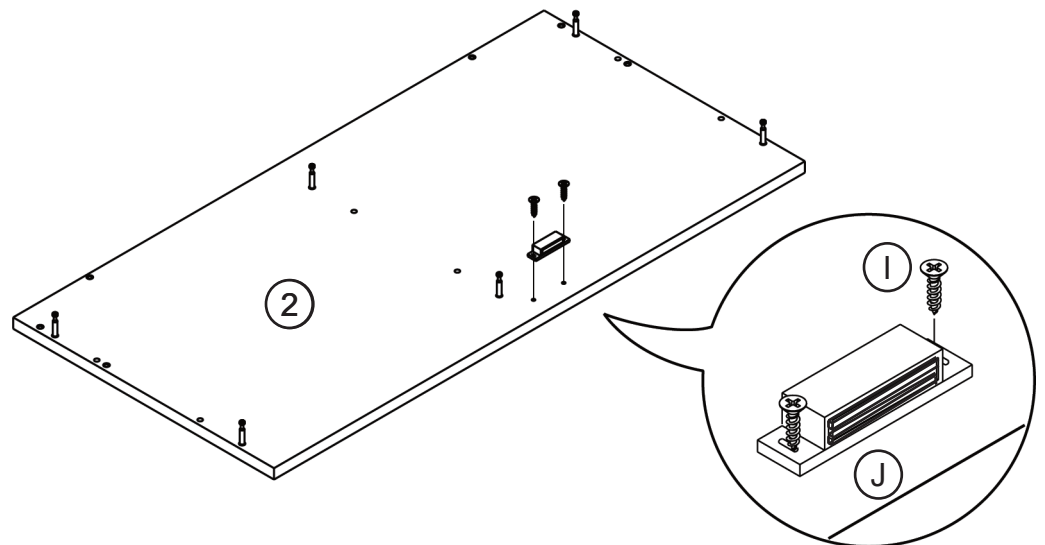
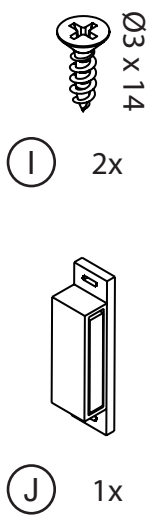

18

Attach wood dowel and the support leg to the bottom panel.

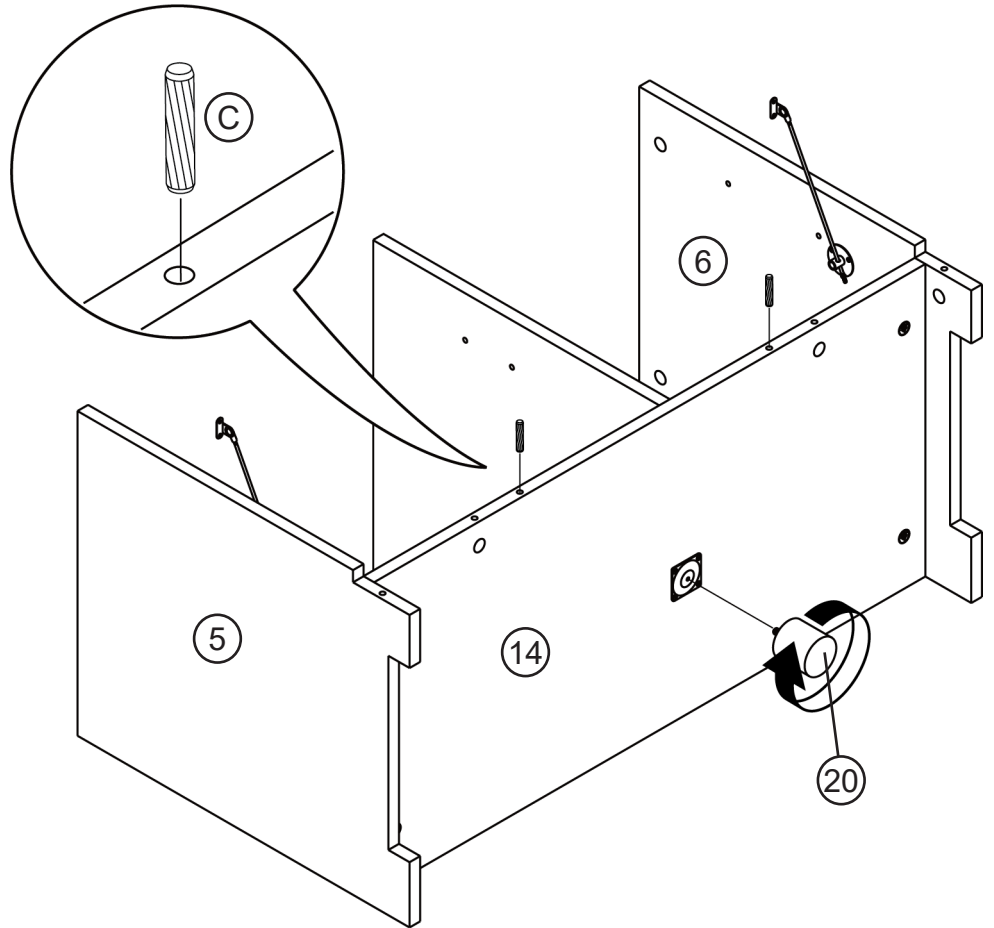
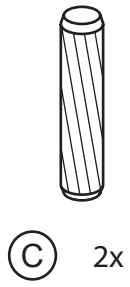

19

Attach the toe kick panel in front of the bottom storage assembly.

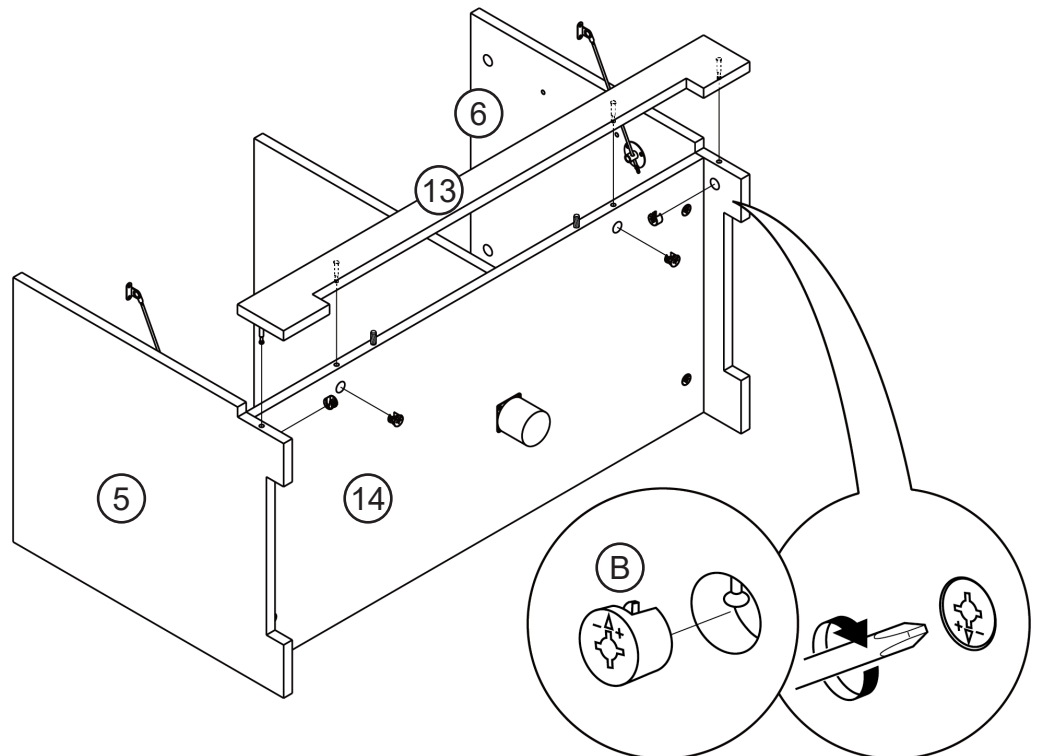

20

Attach wood dowels underneath the side panels and lower crossbar.

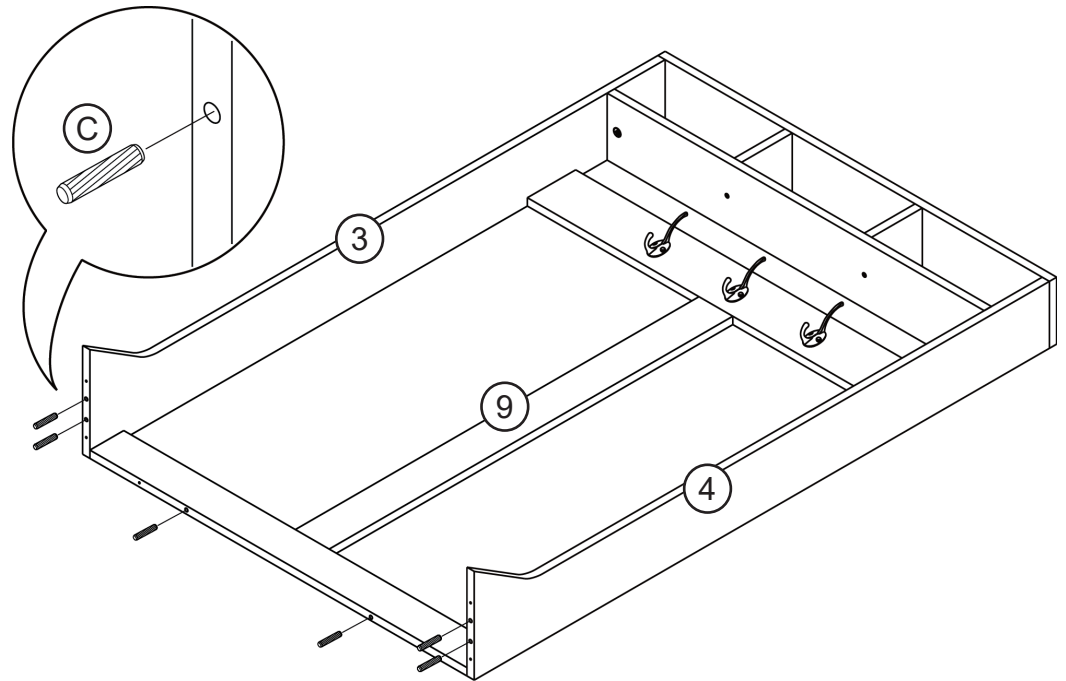
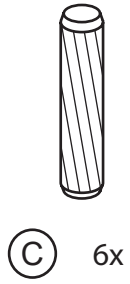

21

Attach the bottom storage bottom panel underneath the side panels.

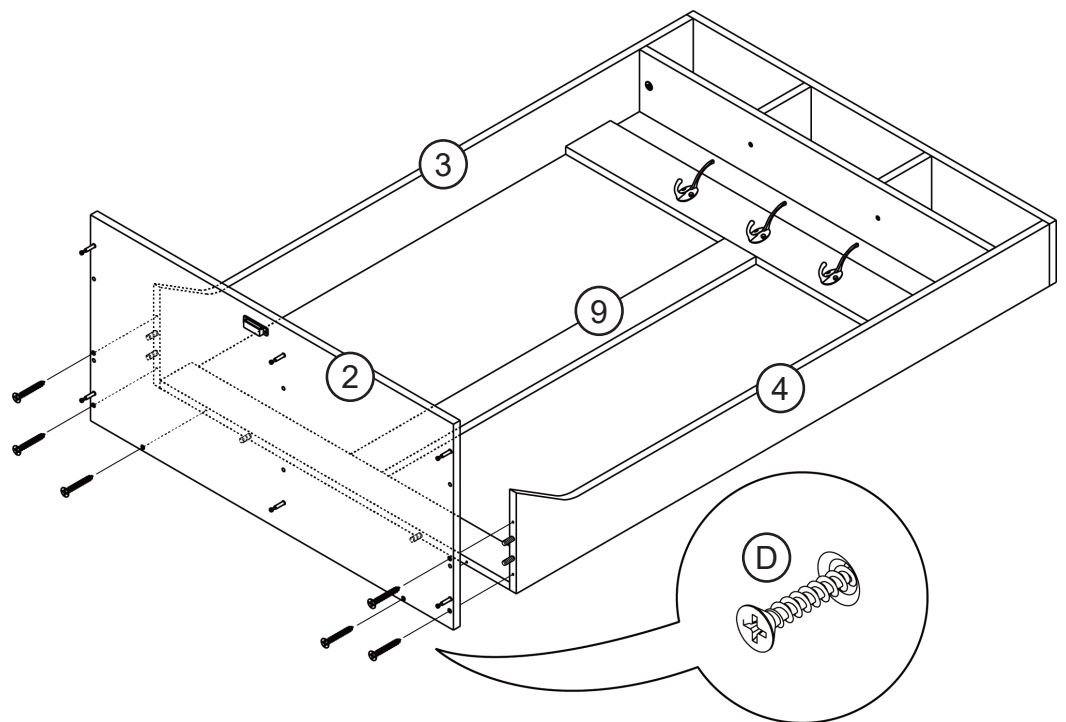

22

Attach the wood dowels underneath the bottom storage top panel.

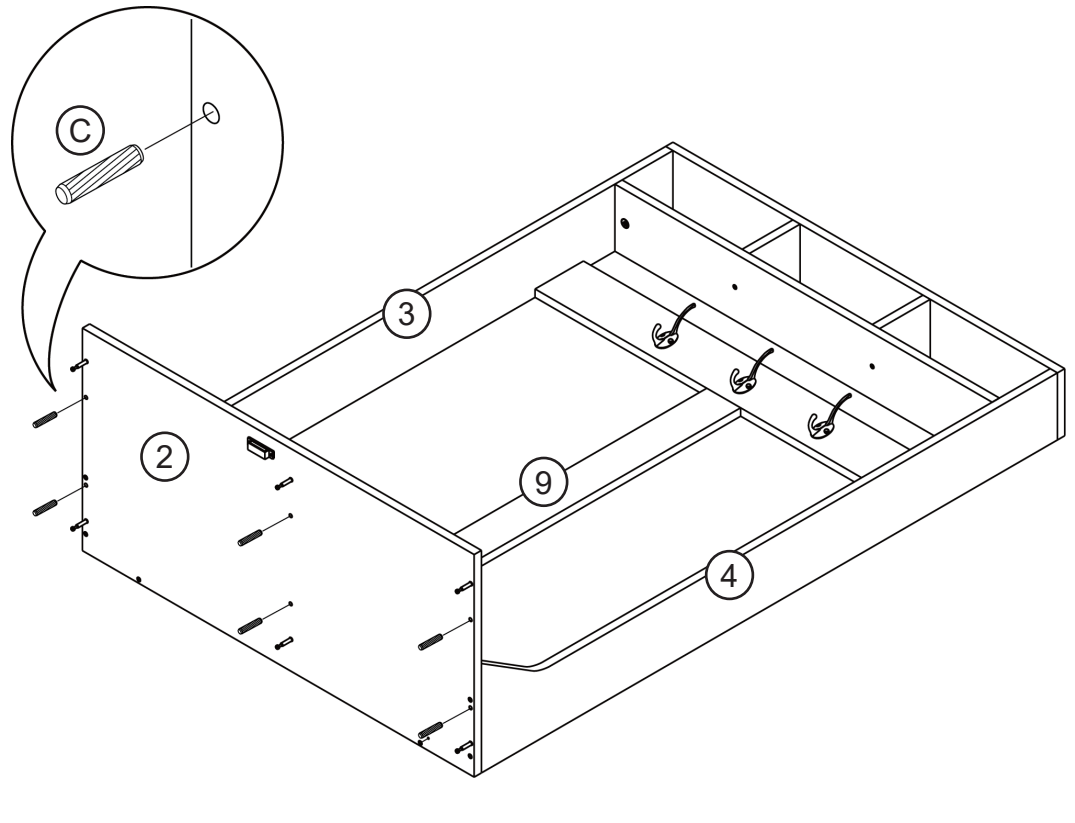
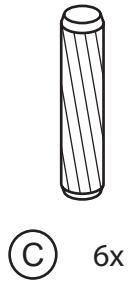

23

Connect the upper and lower storage assembly.

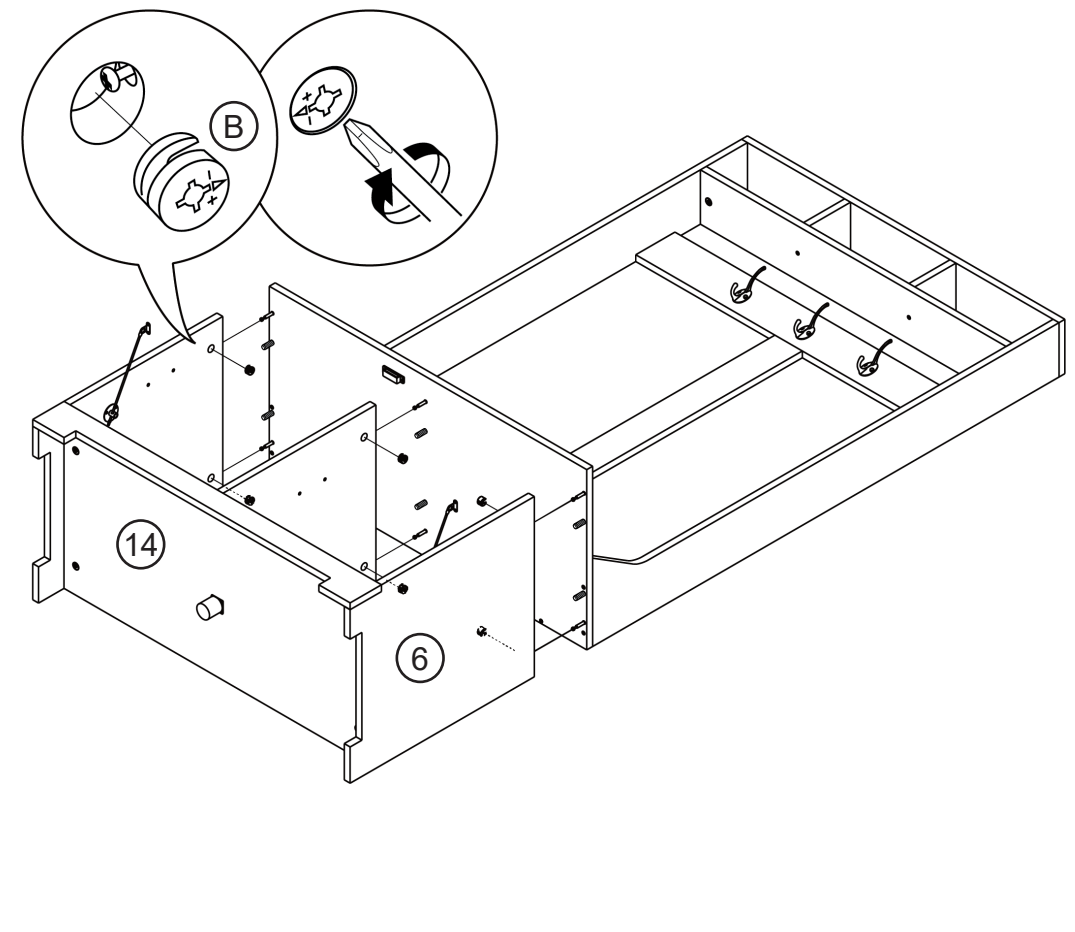

24

Attach door hinges and magnetic catch plate to the door.

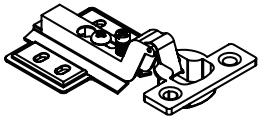

G 2x



H 4x



N 1x



O 2x

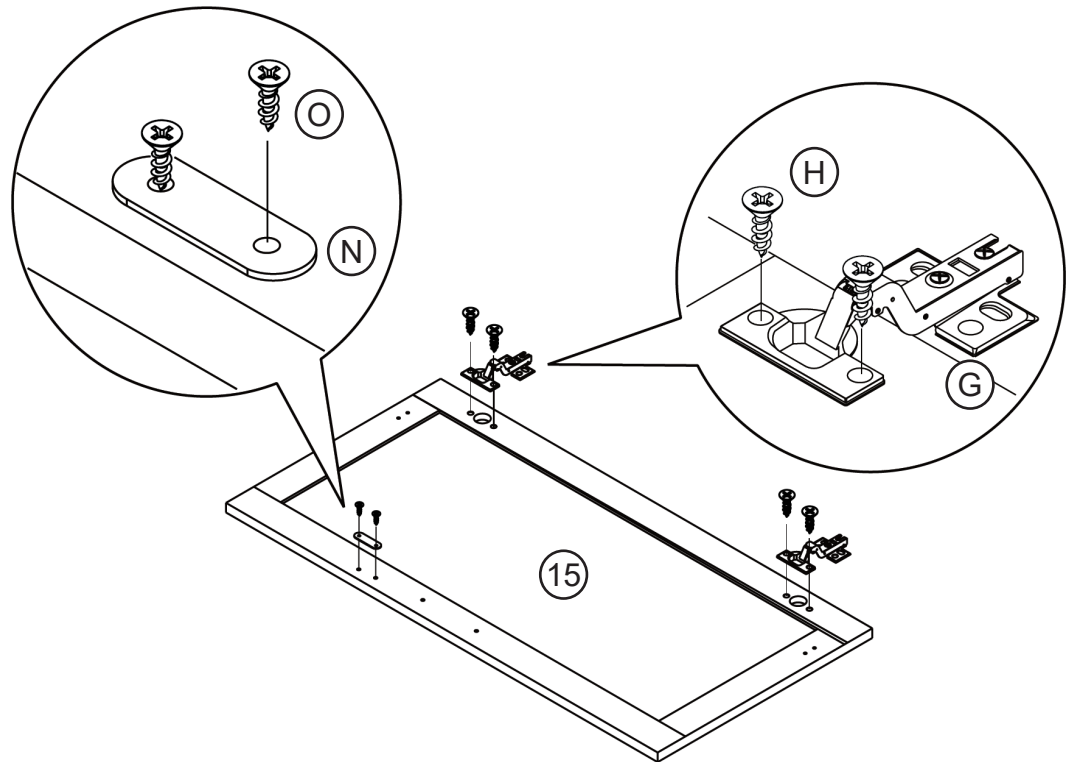

25

Attach door handle to the door.



E 1x



F 2x

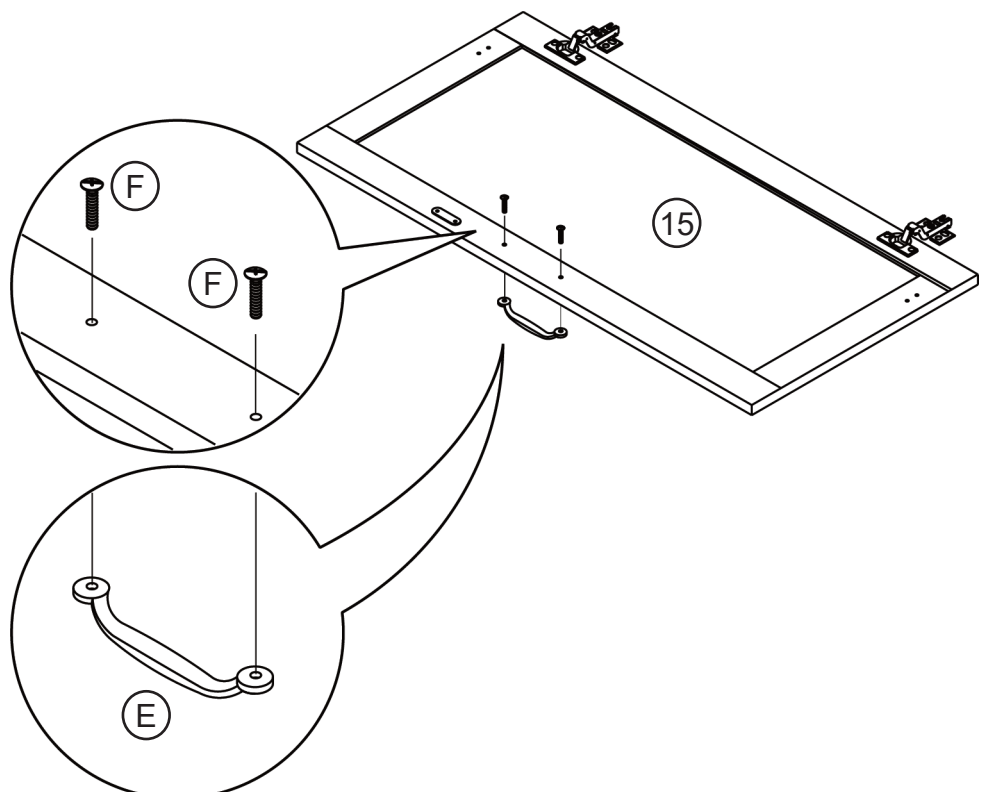

26

Attach door to the hall tree.



(H) 4x



(O) 2x

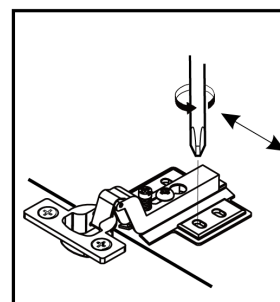
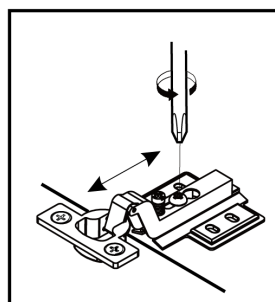
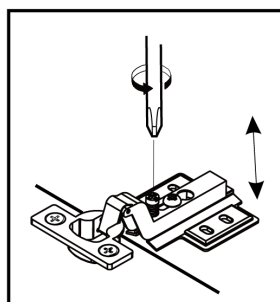
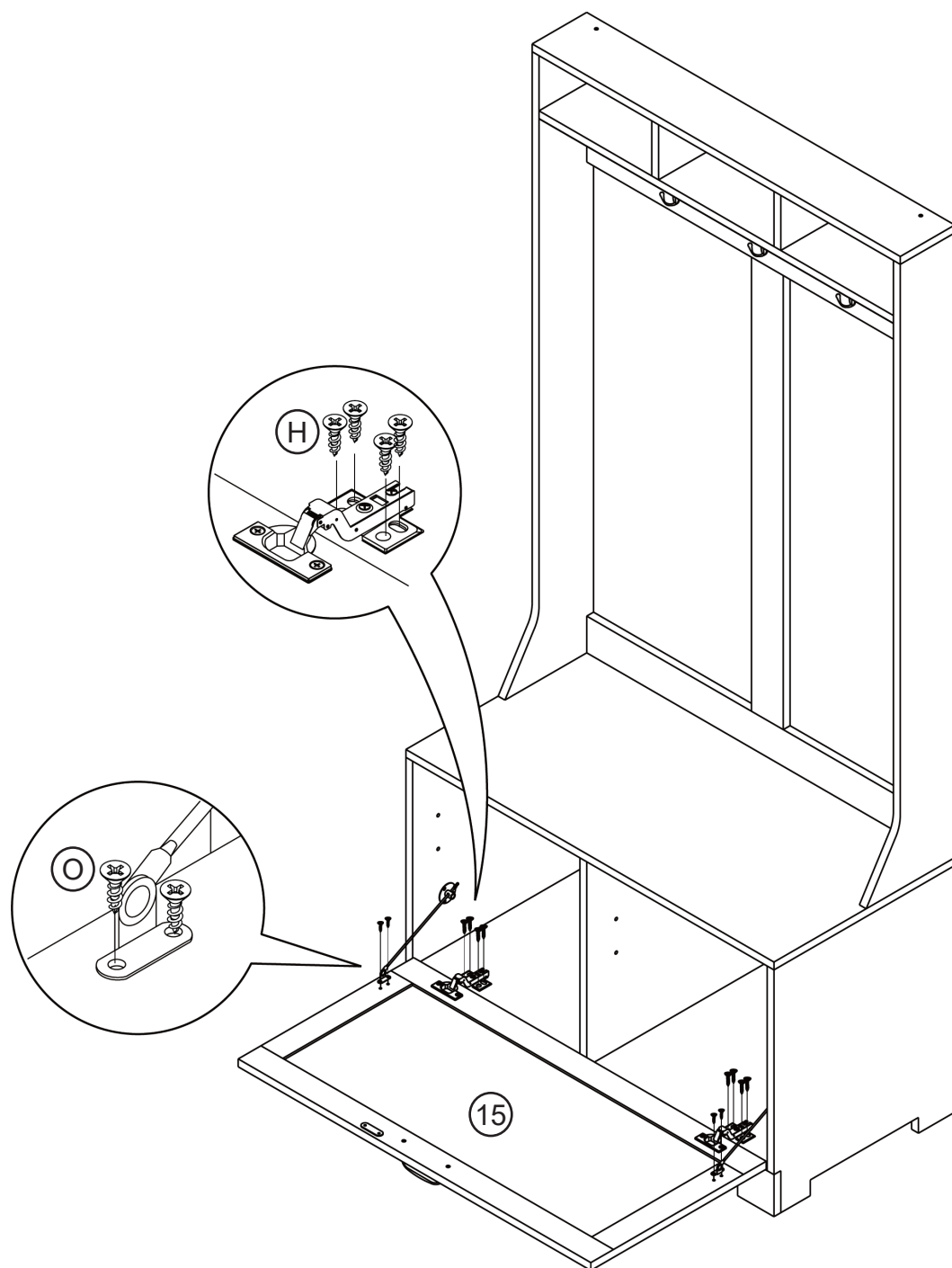

27

Attach shelf pegs into the bottom storage and put on the storage shelf.

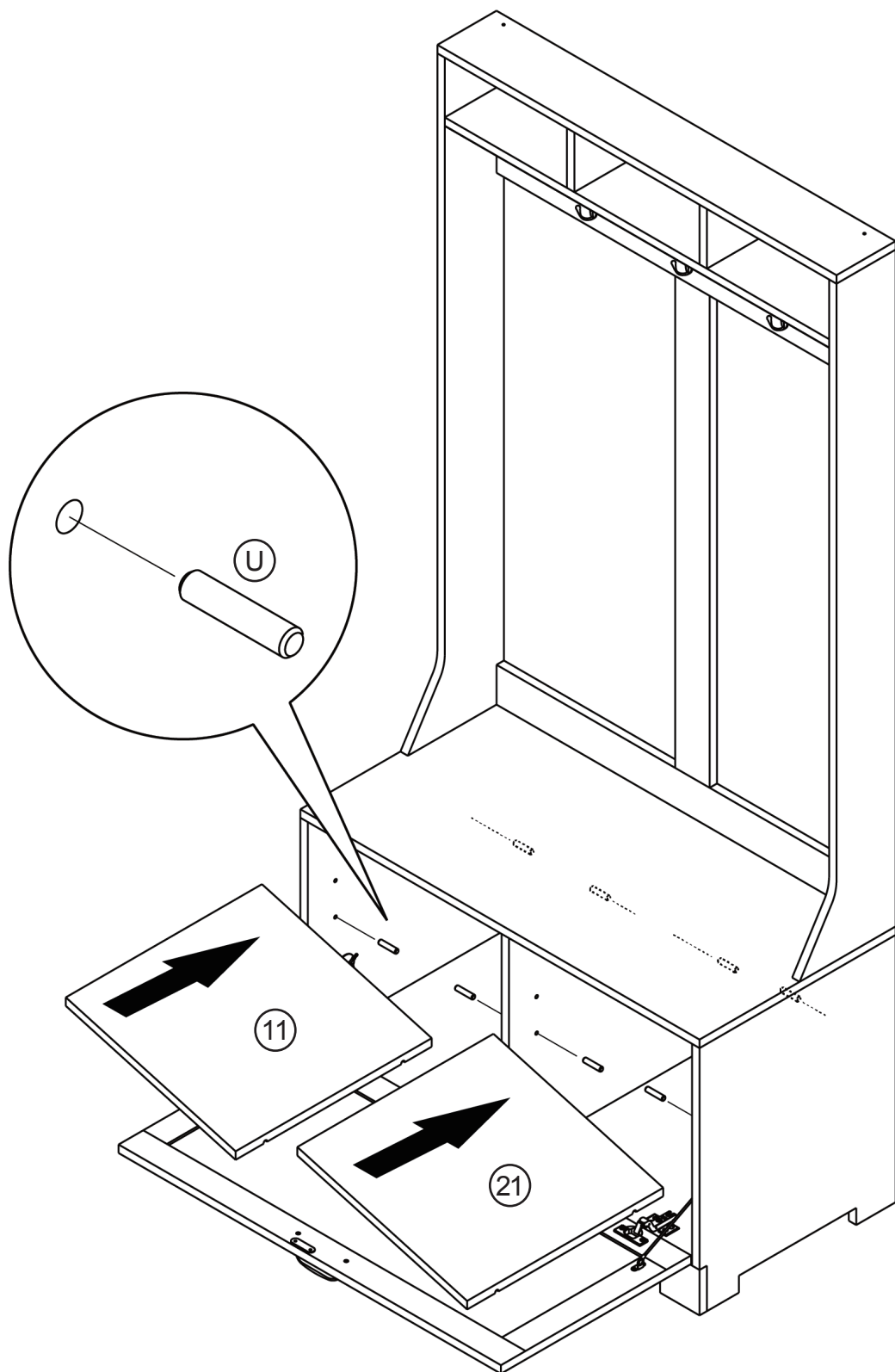
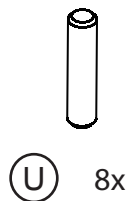

28

Attach back panels to the hall tree.



(S) 36x

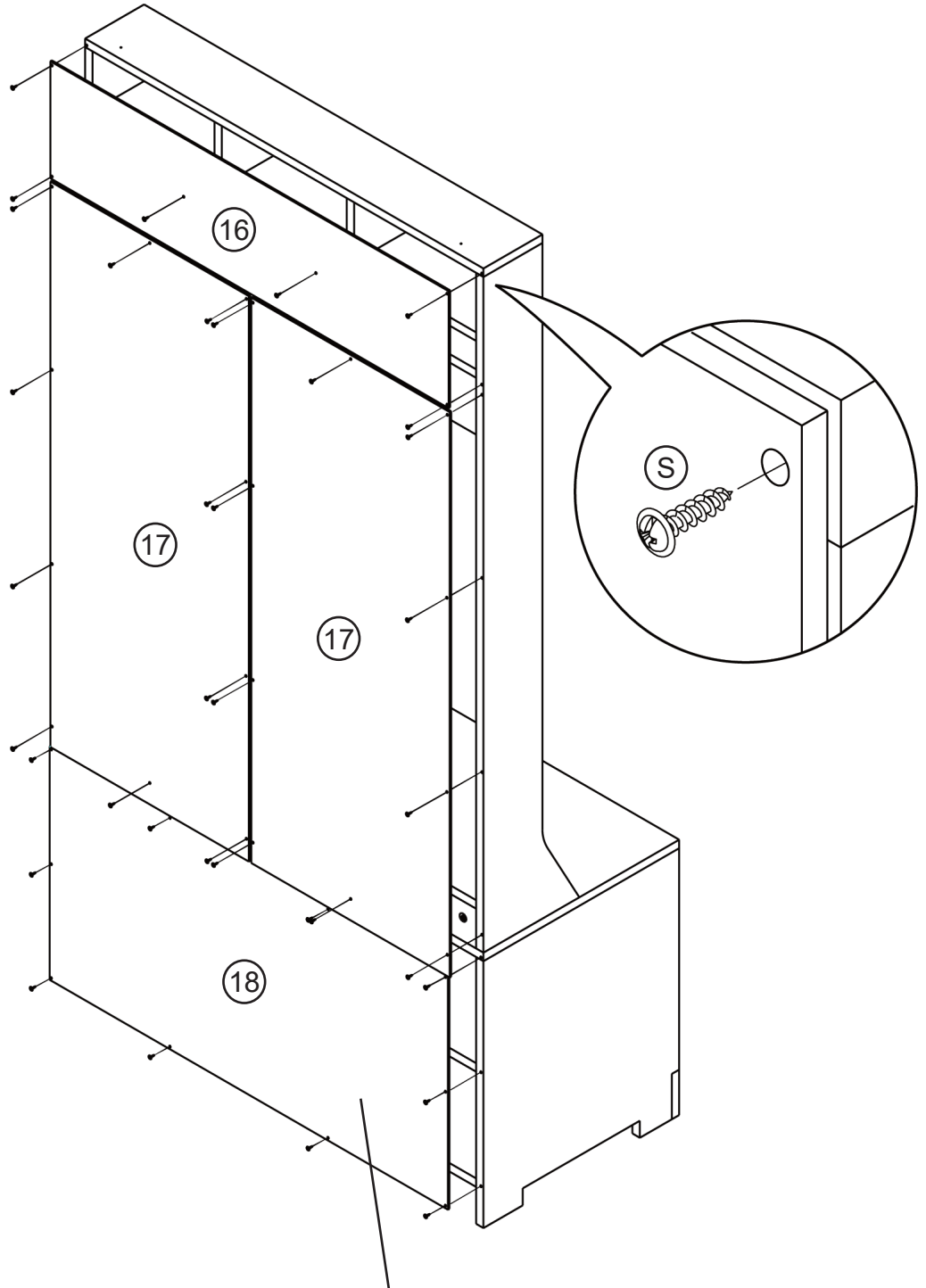

Attach the bottom back panel first, follow by the center and top back panels.

29

Attach the anti-tipping bracket on the top of the hall tree.

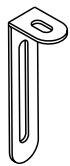

(P) 2x



(Q) 2x

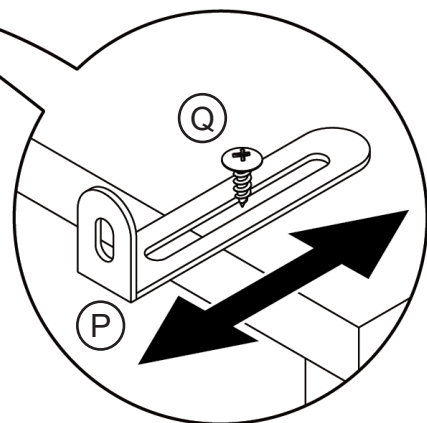
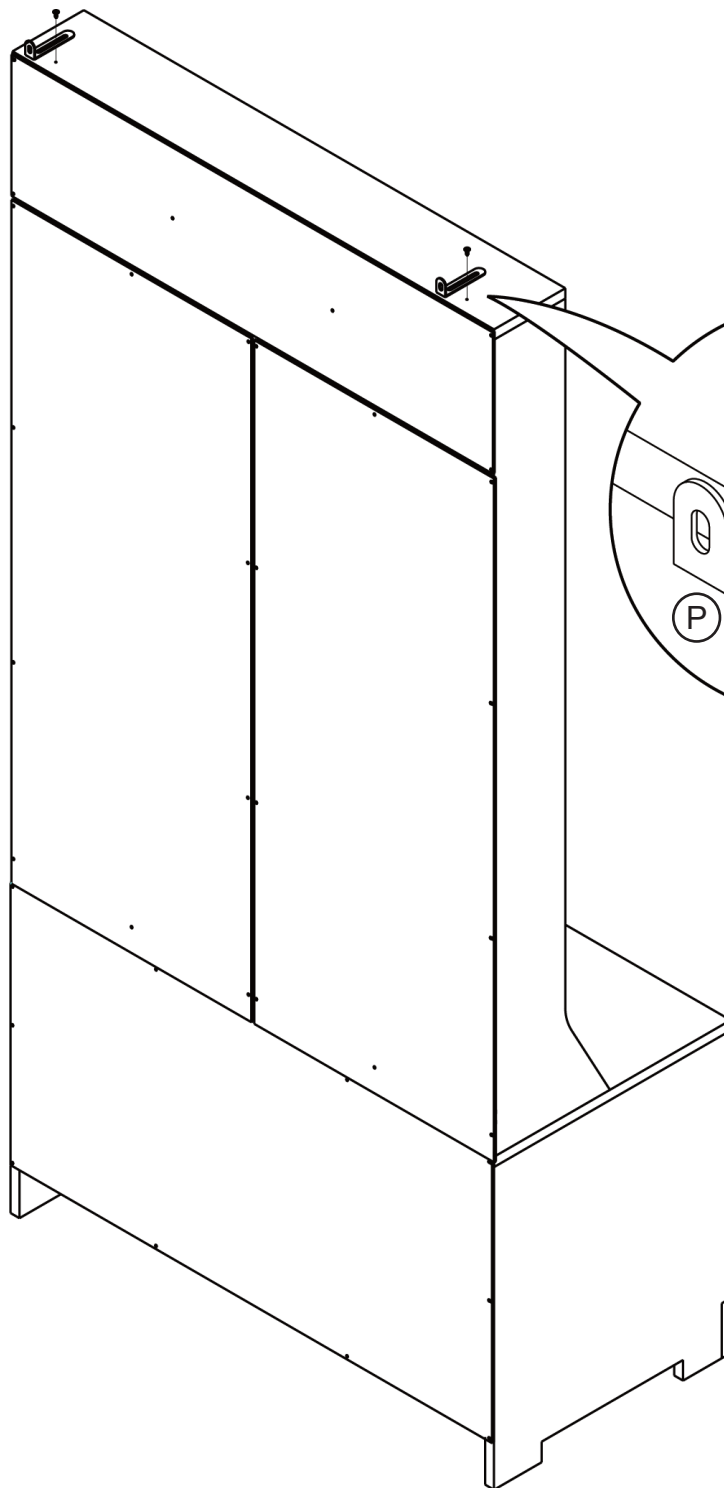

30

Affix the hall tree to a wall.



(R) 2x

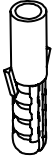

(T) 2x

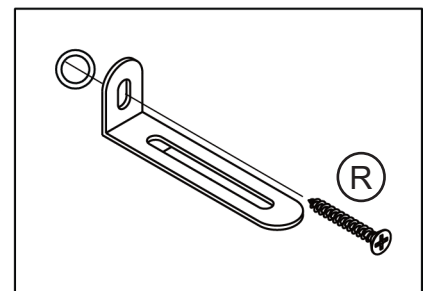
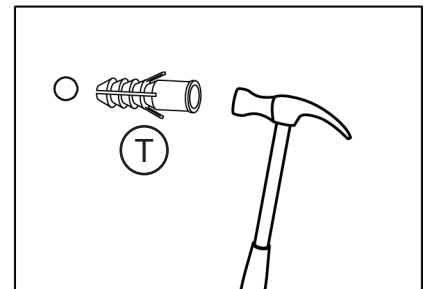
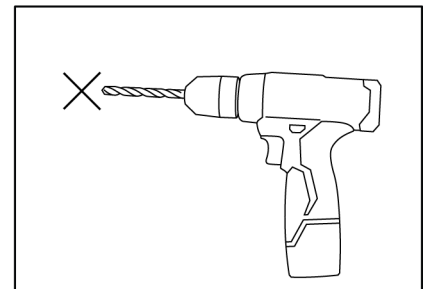
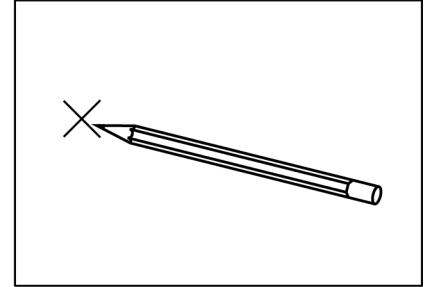
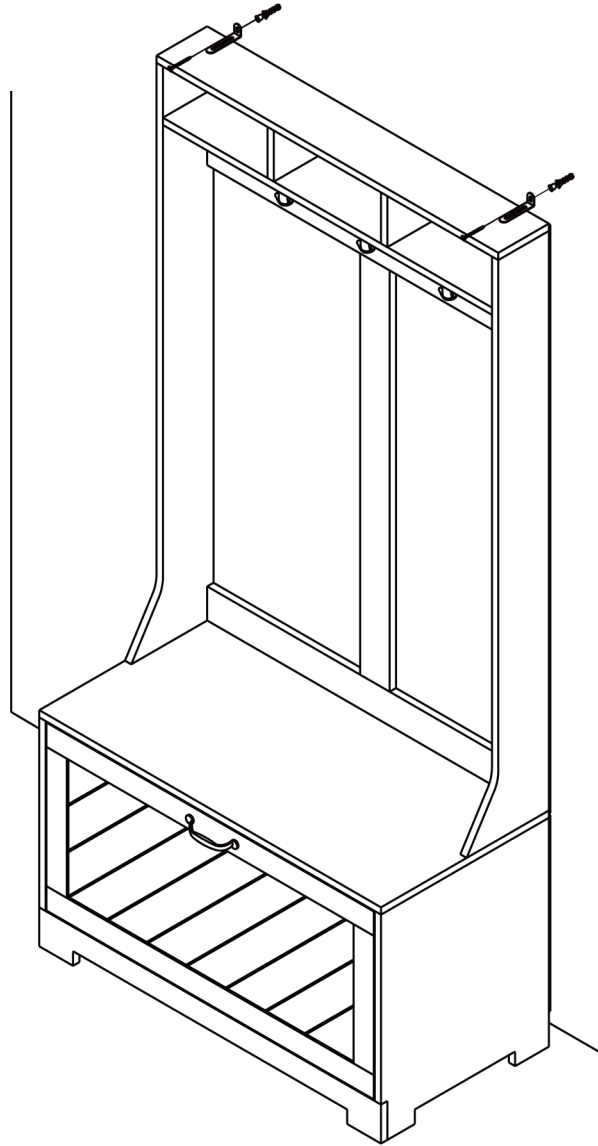

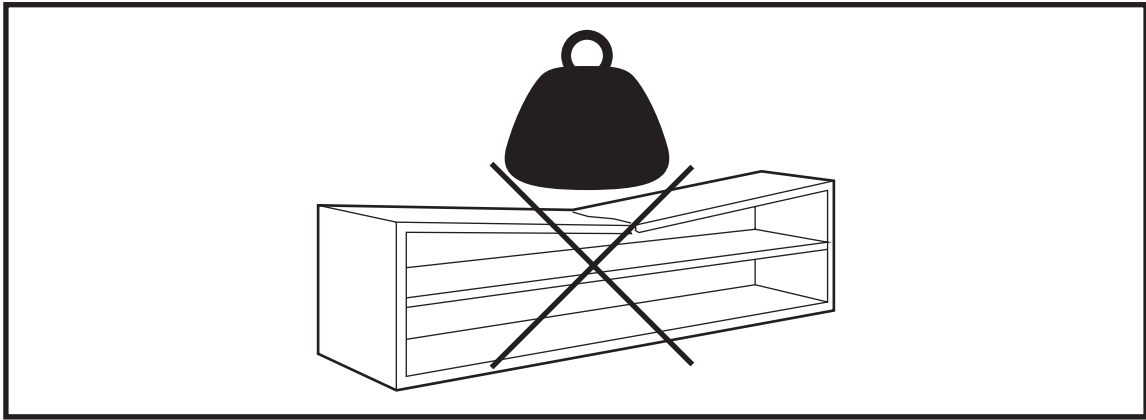

Warning

Only place items on top of the product if they meet the recommended size and weight limits.

Climbing on, stepping on, or placing overweighted objects on the product may cause property damage and/or injuries.

Items placed onto this product must be resting on a support surface without hanging over the edges.

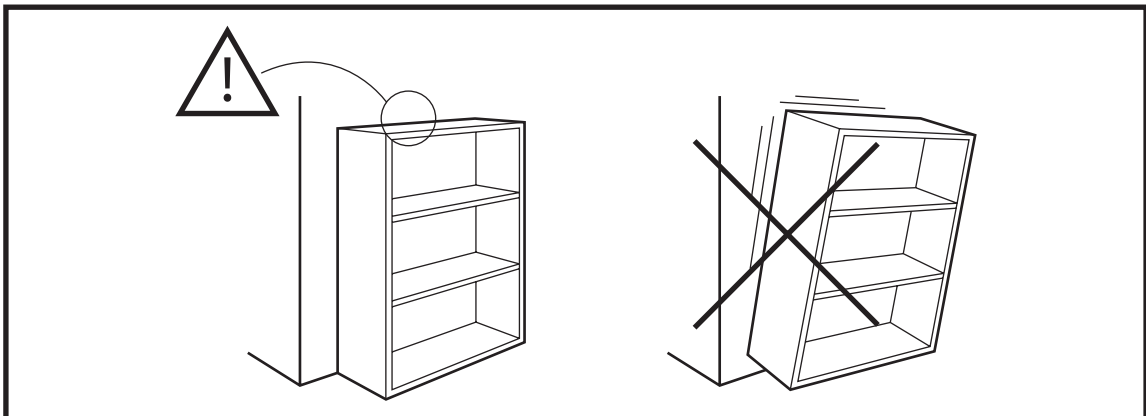

Warning

Serious or fatal crushing injuries may occur if the furniture tip-over. Furniture must permanently affixed to the wall with included anti-tipping device in order to prevent the furniture from tipping over.

Different wall materials requires different types of wall anchors or screws. Use a suitable wall anchors or screws for your specific wall in order to secure the stability and load bearing capacity of the furniture. If you are uncertain about which type of device to use, please contact a hardware store.

FURNITURE CARE AND MAINTENANCE

Medium - Density Fiberboard

Thank you for your purchase. We want your item to last as long as possible. To ensure the product gives you years of longevity, please follow the recommendations in this care and maintenance guide.



MAINTENANCE

- Tighten all bolts and screws again within the first 2 weeks of assembly.
- Check the tightness of all bolts every 2 months and tighten them if necessary.



CLEANING

- Clean the surface of the MDF (medium - density fiberboard) with a lightly dampened cloth.
- A small amount of mild soap can be used if necessary.
- Dry the surface immediately after cleaning.

⚠ DO NOT use bleach or alcohol to clean the surface.

⚠ DO NOT apply wood treatment on parts made with MDF.

MDF will swell and distort when exposed to water damage. Make sure to dry the furniture immediately after cleaning.

⚠ WARNING

The manufacturer and seller are not responsible for any and all liability relating to personal injury, property damage or losses, whether direct, indirect, or incidental, resulting from the incorrect attachment, improper use, inadequate maintenance, unapproved modification or neglect of this product.

WARRANTY

Our products come with a 1-year warranty from the date of delivery. **Register your product on our website to enjoy our limited lifetime warranty!**

AFTER-SALE SERVICE



Encounter any difficulties or missing parts?



Contact us or email us We will send you replacement.



Hassle free!
No need to worry about repackaging and sending your item back.

We hope you enjoy your new furniture!