

# Installation Instructions

SHOWER WALL

**ATTACH YOUR RECEIPT HERE**

Purchase Date \_\_\_\_\_

---

## SAFETY INFORMATION

Please read and understand this manual before attempting to install the product.

### **WARNING**

Do not proceed if any question or concern of performing anything found in this manual. If necessary, hire or consult a certified plumber or licensed general contractor to install for you.

### **CAUTION**

Carefully open the box to prevent any damage to the base surface.

### **CARE AND MAINTENANCE**

Simply wipe the surface with a damp towel to remove watermarks and stains. For basic stains, clean with mild detergent or general purpose cleaner. For corners and seams cleaning, spray with mildew cleaner.

### **WARRANTY**

One (1) Year .

## PREPARATION

### Shower Wall

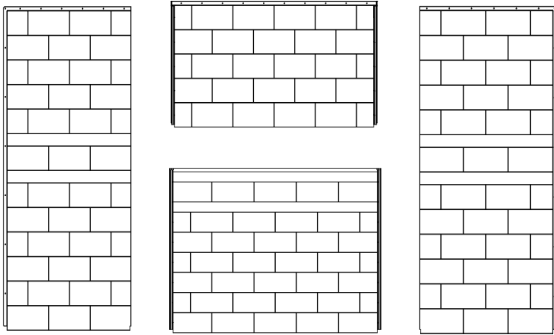

Option 1

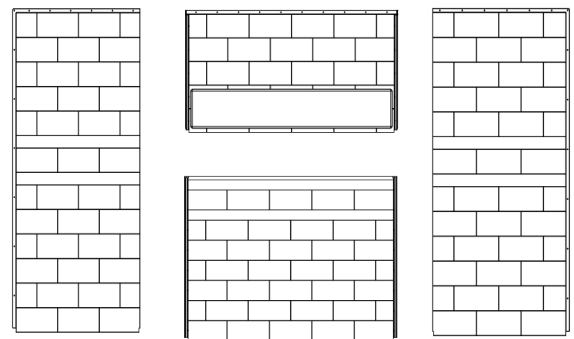

Option 2

### Tools and Materials

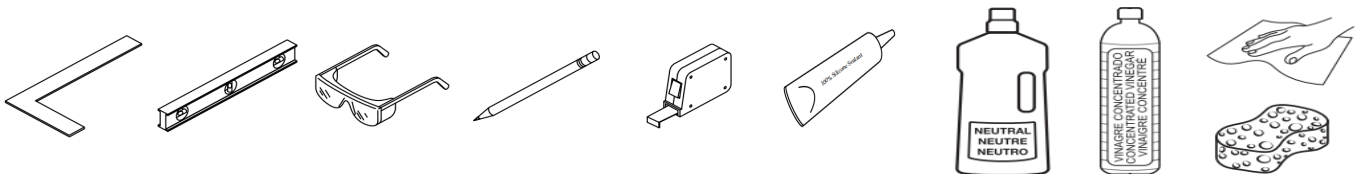

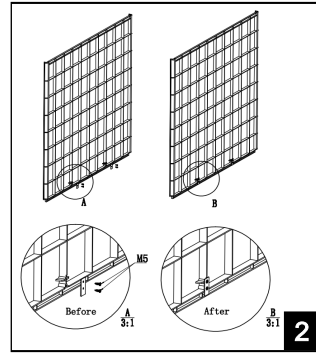
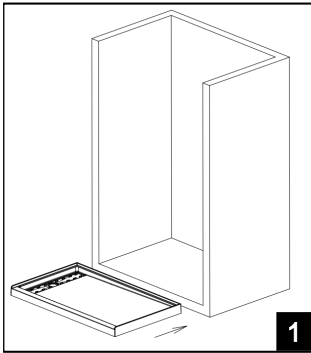

1. Put the shower base or bathtub into the installation position, and fix the shower base or bathtub.

2. Secure the fastener to backplane 1 and tighten the screws.

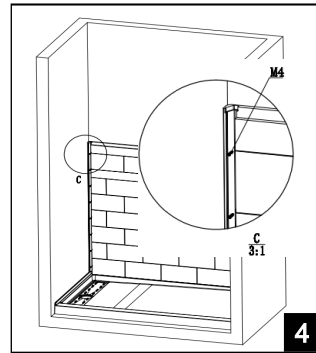
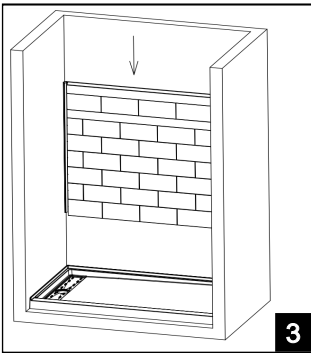

3. Along the direction of the arrow to insert the backplane 1, in order to facilitate installation, it can be tilted to the position of the construction personnel at a certain Angle. After the installation is completed, the bottom of the wall panel is closely fitted with the shower base, and there is no large gap.

4. After the backplane 1 is installed, secure it with screws, as shown in the figure. Determine the number of screws to be used according to the site construction conditions.

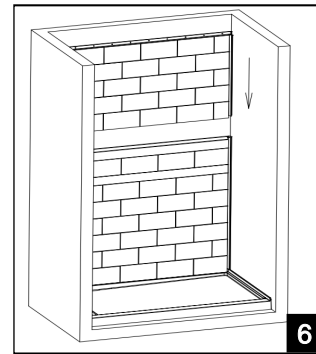
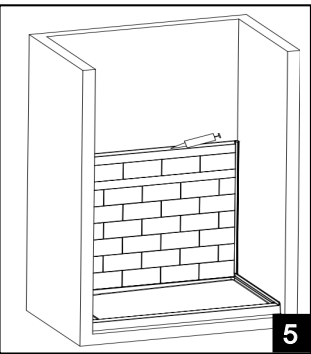

5. Before installing backplane 2, evenly apply sealant on the installation contact surface of backplane 1 as shown in the figure.

6. Install the backplane 2. Follow the direction shown by the arrow, in order to facilitate installation, you can tilt to the position of the construction personnel at a certain Angle. After backplane 2 is installed, ensure that there is no large gap between backplane 1 and backplane 2. Use a clean soft cloth to clean up excess sealant.

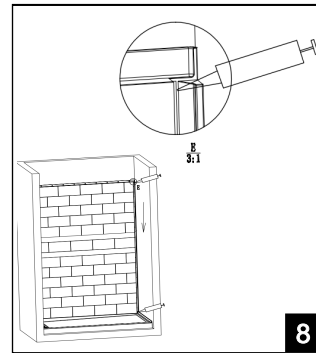
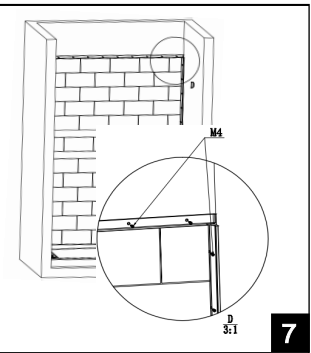

7. As shown in the figure, use screws to fix backplane 2, and tighten the screws.

8. Before the right panel is installed, evenly drive the sealant into the backplane groove, as shown in the figure. The installation method of the left panel is the same as that of the right panel.

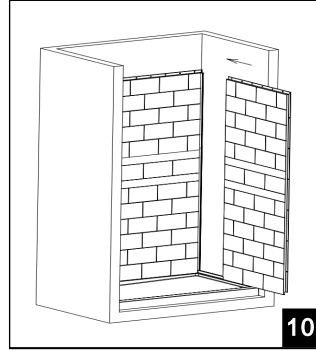
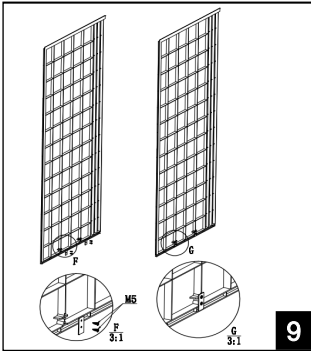

9. Install the fastener on the right panel, tighten the screws. Install the left panel in the same way as the right panel.

10. As shown in the figure, install the right panel in the direction of the arrow. After the right panel is installed, ensure that there is no large gap between the right panel and the backplane.

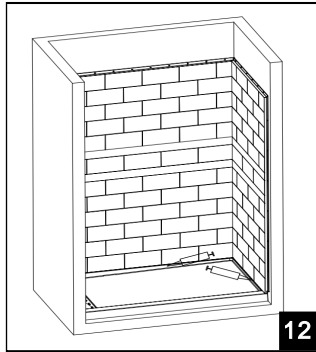
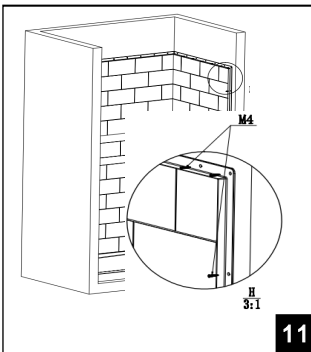

11. Using screws to fix the right panel, and tighten the screws. The left panel and the right panel installation method is the same.

12. After all the wall panels are installed, drive the sealant into the contact position between the wall panels and the shower base. Clean up the excess glue and ensure the overall appearance. After the sealant curing can be put into use.



Allow the shower wall to cure for 24 hours before working in the area.