

INSTRUCTION MANUAL

Parts



3 pcs



4 pcs



6 pcs



8 pcs



MOUNTING BRACKET



CANOPY
FASTENER



SWIVEL



1x15" HANG ROD



1x13.7" HANG ROD



1x11.7" HANG ROD



1x6" HANG ROD

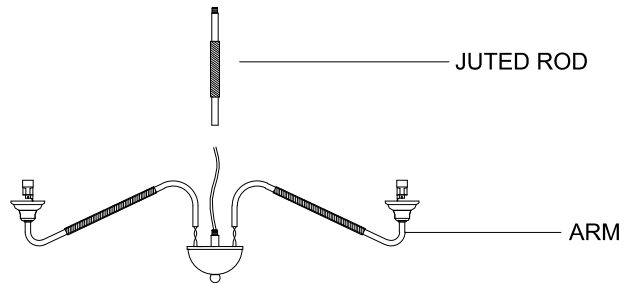

JUTED ROD

ARM

SOCKET TUBE x 6pcs

①

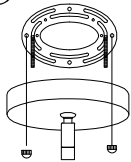

Release the Fasteners from the Canopy, take out the Mounting Bracket.

⑤

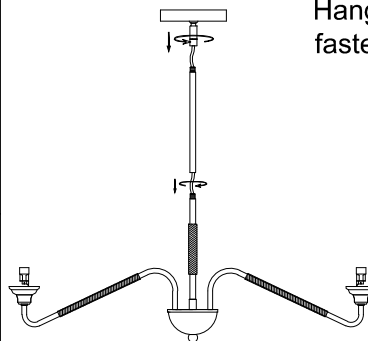

Let the Cable goes through the Hang Rod and the Canopy, then fasten it.

②

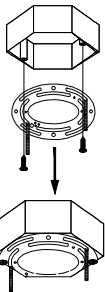

Fasten the Mounting Bracket to the ceiling Junction box by the screws.

⑥

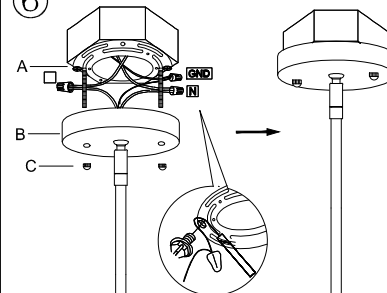

Hang up the Lamp body, then connect the wires. Position the Canopy over Mounting Bracket then lock it by Fasteners.

③

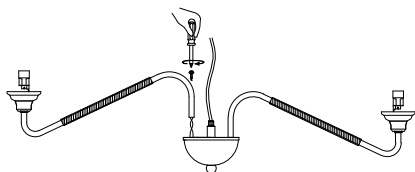

Attach the arm to the mid cylinder and lock it with the screws.

⑦

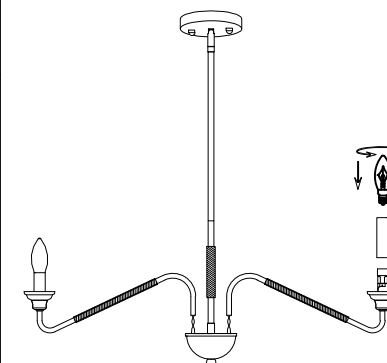

Put on the Socket Tube and then fasten the Lamp bulbs to the lampholders, E12x6 pcs, type B, 60W Max is recommended.

④

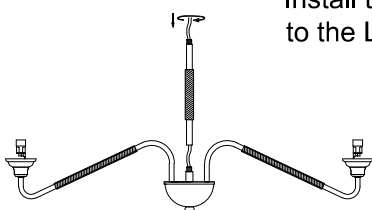

Install the Juted Rod to the Lamp Body.