



ATTENTION



- The floor on which the installation will be made must be smooth and dry.
- Avoid direct contact of your cabinets with heat sources.
- Avoid direct contact with sunlights
- For the cleaning of the cabinets, do not use anything other than a slightly damp cleaning cloth and special furniture cleaners.
- All parts to prevent your cabinets from being scratched and broken in case of transportation; should be wrapped with a material such as sponge, thick fabric etc.

Manual Installation Guide

Medicine Cabinet 24 Inch

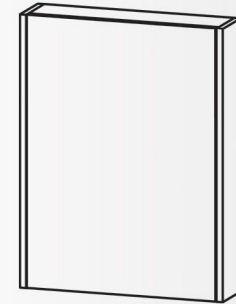



A. Left Panel

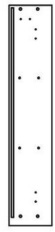

B. Right Panel

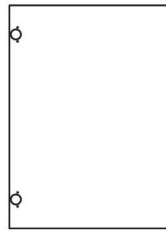

D. Door



G. Hinges x2

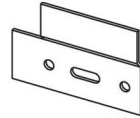

E. Frame Panel x2

H. Wall Fitting Sheet
(One sheet, split from the middle before using it)

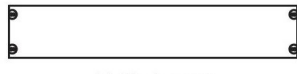

F. Shelves x2

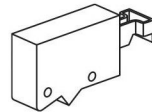

I. Wall Fitting Accessories x2



C. Back Side Panel

4

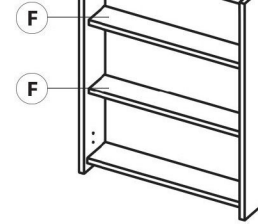

Place the Shelves (F)

5

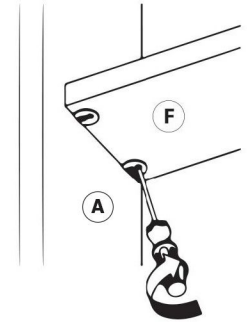

Screw cabineo of Shelves, (F) by using allen key.

6

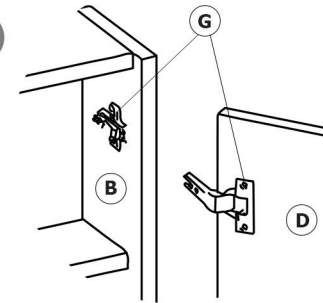

Place the Hinges (G) to Door (D) and Right Panel (B)

7

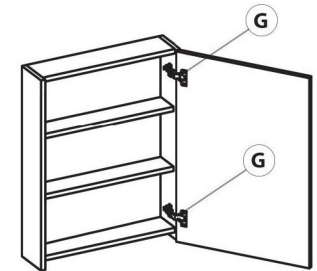

Screw the Hinges (G) to eachother from the middle

8

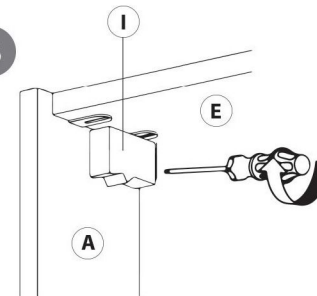

Place Wall Fitting Accesories (I) to the both up corner sides of the cabinets then screw them

9

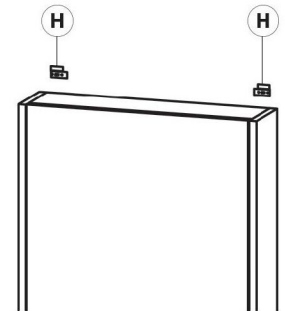

Split Wall Fitting Sheet (H) from the middle then place them to the wall as it's shown. Then you can hang your cabinet to the wall

1

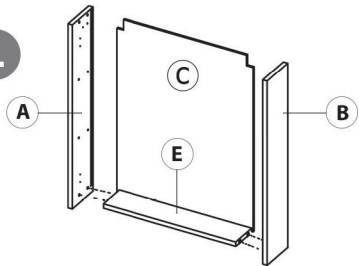

Place the Back Side Panel (C) over the Bottom Frame Panel.(E) Then, screw Left (A) and Right Panel (B) Screw cabineo by using allen key to the Frame Panel(E) by using cabineo linking accessory

2

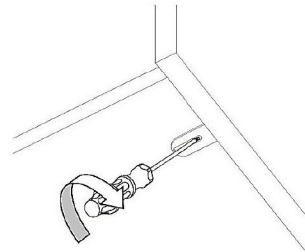

3

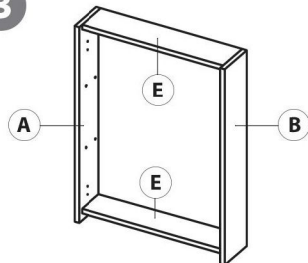

Place the top Frame Panel (E)