

# avanti®

## REFRIGERATOR/TOP FREEZER

### Instruction Manual

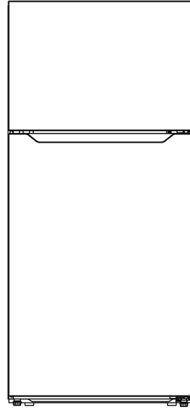

**Models : FF14D0W-4 / FF14D3S-4**



Register this and other Avanti® products through our website:  
<https://www.avantiproducts.com/pages/product-registration>  
Product registration is not required to activate warranty.

Important Safeguards .....	2 - 5
Before First Use .....	5
Know Your Refrigerator .....	6
Energy Saving Tips .....	5
Changing The Light .....	6 - 7
Electrical Connection .....	7
Operating Instructions .....	8
Reverse Door Hinge .....	8 - 11
Leveling Feet .....	12
Care And Maintenance .....	13
Troubleshooting .....	14
Warranty .....	15 - 16

**SAVE THIS INSTRUCTION MANUAL FOR FUTURE REFERENCE**

# IMPORTANT SAFEGUARDS



1. **WARNING:** Risk of fire/ Flammable materials
2. **For EN (European) Standard:** This appliance can be used by children aged from 8 years and above and persons with reduce physical sensory or mental capabilities or lack of experience and knowledge if they have been given supervision or instruction concerning use of the appliance in a safe way and understand the hazards involved. Children shall not play with the appliance. Cleaning and user maintenance shall not be made by children without supervision. Children aged from 3 to 8 years are allowed to load and unload refrigerating appliances.
3. **For IEC (International Electrotechnical Commission) Standard:** This appliance is not intended for use by persons (including children) with reduced physical, sensory or mental capabilities, or lack of experience and knowledge, unless they have been given supervision or instruction concerning use of the appliance by a person responsible for their safety.
4. When children are present, they should be supervised to ensure that they do not play with this refrigerator.
5. If the power cord is damaged or the socket hole is loose, it must be replaced by the manufacturer, its service agent or similar institutions to avoid danger.
6. Do not store explosive substances (such as aerosol tanks with flammable propellants) in the refrigerator.
7. The power plug of the equipment must be unplugged after use and before self cleaning of equipment.
8. LED lamp were used, it can only be replaced by the manufacturer or its service agent, together with a part of the appliance.
9. **WARNING:** Ensure there are no obstacles in the ventilation holes in the equipment shell or built-in structure.
10. **WARNING:** Do not use mechanical devices or other means to speed up defrosting except the process recommended by the manufacturer.
11. **WARNING:** Do not damage the pipes of the refrigerant circuit.
12. **WARNING:** Do not connect the plug adapter or other accessories to the power plug.
13. **WARNING:** Please dispose the refrigerator according to local regulations, because it uses flammable cyclopentane and refrigerant.
14. **WARNING:** When positioning the equipment, make sure that the power cord is not clamped or damaged.
15. **WARNING:** Do not locate multiple portable socket-outlets or portable power supplies at the rear of the appliance.
16. **WARNING:** Do not modify or extend the power cord.
17. **WARNING:** Risk of child entrapment. Before you throw away your old refrigerator or freezer:
  - Take off the doors.
  - Leave the shelves in place so that children may not easily climb inside.
18. **WARNING:** Keep ventilation openings, in the appliance enclosure or in the built-in structure, clear of obstruction.
19. **WARNING:** Do not use mechanical devices or other means to accelerate the defrosting process, other than those recommended by the manufacturer.
20. **WARNING:** Do not use electrical appliances inside the food storage compartments of the appliance, unless they are of the type recommended by the manufacturer.

21. **WARNING:** Connect to potable water supply only.
22. Before disposing the old refrigerator:
  - Remove the refrigerator doors.
  - Put the bottle racks and doors in a proper place to prevent children from entering and playing to cause accidents.
23. To avoid food contamination, please abide by the following instructions:
  - Please do not open the door for a long time, otherwise it will lead to leakage of cold air, causing the internal temperature of the refrigerator to rise and food to easily deteriorate.
  - Store raw meat and fish in proper containers in the refrigerator so that they do not touch on other foods.
  - If the refrigeration equipment is idle for a long time, please thaw, clean and dry the equipment before leaving, close the door and cut off the power to prevent mold in the container.
24. The refrigeration equipment is not intended to be used as a built-in equipment appliance.

### REFRIGERANT GAS WARNINGS

1. **DANGER:** Risk of Fire or Explosion. Flammable Refrigerant Used. Do not use mechanical devices to defrost the refrigerator. Do not puncture refrigerant tubing.
2. **DANGER:** Risk of Fire or Explosion. Flammable Refrigerant Used. To be repaired only by trained service personnel. Do not puncture refrigerant tubing.
3. **CAUTION:** Risk of Fire or Explosion. Flammable Refrigerant Used. Consult the repair manual or owner's guide before attempting to service this product. All safety precautions must be followed.
4. **CAUTION:** Risk of Fire or Explosion. Dispose of the unit in accordance with federal and local regulations. Flammable refrigerant used.
5. **CAUTION:** Risk of Fire or Explosion Due to Puncture of Refrigerant Tubing. Follow handling instructions carefully. Flammable refrigerant used.
6. **CAUTION:** To Prevent a Child from Being Entrapped. Keep out of reach of children and do not place the unit in an area accessible to children.
7. **CAUTION:** Risk of Fire.



**R600a**  
**ISOBUTANE**



**FLAMMABLE LIQUID**  
**LÍQUIDO INFLAMABLE**  
**LIQUIDE INFLAMMABLE**

**CAUTION:** Risk of fire or explosion due to flammable refrigerant used. Follow handling instructions carefully in compliance with U.S. government regulations.

**ADVERTENCIA:** Riesgo de incendio o explosión debido al refrigerante inflamable utilizado. Siga las instrucciones de manejo con cuidado, cumpliendo con las regulaciones del gobierno de EE. UU.

**ATTENTION :** Risque d'incendie ou d'explosion en raison du réfrigérant inflammable utilisé. Suivez attentivement les instructions de manipulation conformément aux règlements du gouvernement des États-Unis.

# ELECTRICAL CONNECTION



Improper use of the grounded plug can result in the risk of electrical shock. If the power cord is damaged, submit a warranty service request via our website at:  
<https://avanti.thelegacycompanies.com/support/tickets/new>

This appliance should be properly grounded for your safety. The power cord of this appliance is equipped with a three-prong plug which mates with standard three prong wall outlets to minimize the possibility of electrical shock.

Do not under any circumstances cut or remove the third ground prong from the power cord supplied. For personal safety, this appliance must be properly grounded.

This appliance requires a standard 115/120 Volt AC ~/60Hz electrical ground outlet with three-prong. Have the wall outlet and circuit checked by a qualified electrician to make sure the outlet is properly grounded. When a standard 2-prong wall outlet is encountered, it is your responsibility and obligation to have it replaced with a properly grounded 3-prong wall outlet.

The cord should be secured behind the appliance and not left exposed or dangling to prevent accidental injury.

The appliance should always be plugged into its own individual electrical outlet which has a voltage rating that matches the rating label on the appliance. This provides the best performance and also prevent overloading house wiring circuits that could cause a fire hazard from overheated. Never unplug the appliance by pulling the power cord. Always grip the plug firmly and pull straight out from the receptacle. Repair or replace immediately all power cords that have become frayed or otherwise damaged. Do not use a cord that shows cracks or abrasion damage along its length or at either end. When moving the appliance, be careful not to damage the power cord.

## **EXTENSION CORD**

Because of potential safety hazards under certain conditions, it is strongly recommended that you do not use an extension cord with this appliance. However, if you must use an extension cord it is absolutely necessary that it be a UL/CUL-Listed, 3-wire grounding type appliance extension cord having a grounding type plug and outlet and that the electrical rating of the cord be 115 volts and at least 10 amperes.

## **SURGE PROTECTOR**

Most electrical appliances use a series of electric control boards to operate. These boards are very susceptible to power surges and could be damaged or destroyed.

If the appliance is going to be used in an area or if your city / country is prone to power surges / outages; it is suggested that you use a power surge protector for all electrical devices / appliances you use. The surge protector that you select must have a surge block high enough to protect the appliance it is connected to. If you have any questions regarding the type and size of surge protector needed contact a licensed electrician in your area.

Damages due to power surges are not considered a manufacturer covered defect and will void your product warranty.



To reduce the risk of fire, electrical shock, or injury when using your refrigerator-freezer, follow these basic precautions:

- Read all instructions before using the refrigerator-freezer.
- **DANGER** or **WARNING**: Risk of child entrapment.
- Child entrapment and suffocation remain significant safety hazards. Unused or discarded refrigerator-freezers must be properly secured or disposed of to prevent accidents.
- Before you throw away your old refrigerator-freezer: Take off the doors. Leave the shelves in place so that children may not easily climb inside.
- Never allow children to operate, play with, or crawl inside the refrigerator-freezer.
- Never clean refrigerator-freezer parts with flammable fluids. The fumes can create a fire hazard or explosion.
- Do not store or use gasoline or any other flammable vapors and liquids in the vicinity of this or any other refrigerator-freezer. The fumes can create a fire hazard or explosion.

## BEFORE FIRST USE

- Before use, remove all packing materials, including bottom pads, foam pads and tapes inside of the refrigerator; tear off the protective film on the doors and the refrigerator body.
- Keep away from heat and avoid direct sunlight. Do not place the refrigerator in moist or wet places to prevent rust or reduction of the insulating effect.
- Do not spray or wash the refrigerator; do not place the refrigerator in moist places easy to be splashed with water so as not to affect the electrical insulation properties of the refrigerator.
- The refrigerator is placed in a well-ventilated indoor place; the floor must be flat and sturdy (rotate left or right to adjust the wheel for leveling if unstable).
- The space on top of the refrigerator shall be greater than 11.8" (30cm), and the refrigerator should be placed against a wall with a distance of more than 3.9" (10cm) to facilitate heat dissipation.
- Spare enough space for convenient opening of doors and drawers according to the statement of the distributor.

**NOTE:** This refrigerator needs to be installed independently and cannot be used as a built-in. Otherwise, it will cause problems such as failure to install into the cabinet, the performance and life of the product are reduced. And the manufacturer does not provide basic product warranty.

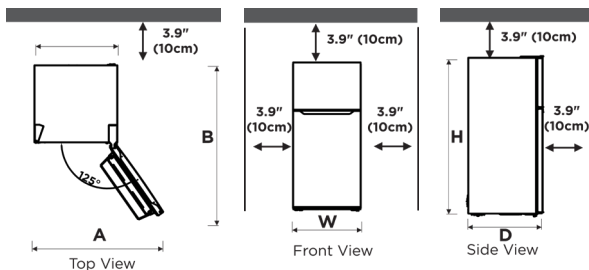

Width "W"	27.6" (70cm)
Depth "D"	28.8 (73.1cm)
Height "H"	60.6" (154cm)
A	42.7" (108cm)
B	51.6" (131cm)

# SAVE THESE INSTRUCTIONS HOUSEHOLD USE ONLY

Congratulations on your purchase of an Avanti® Refrigerator/Top Freezer

## KNOW YOUR REFRIGERATOR

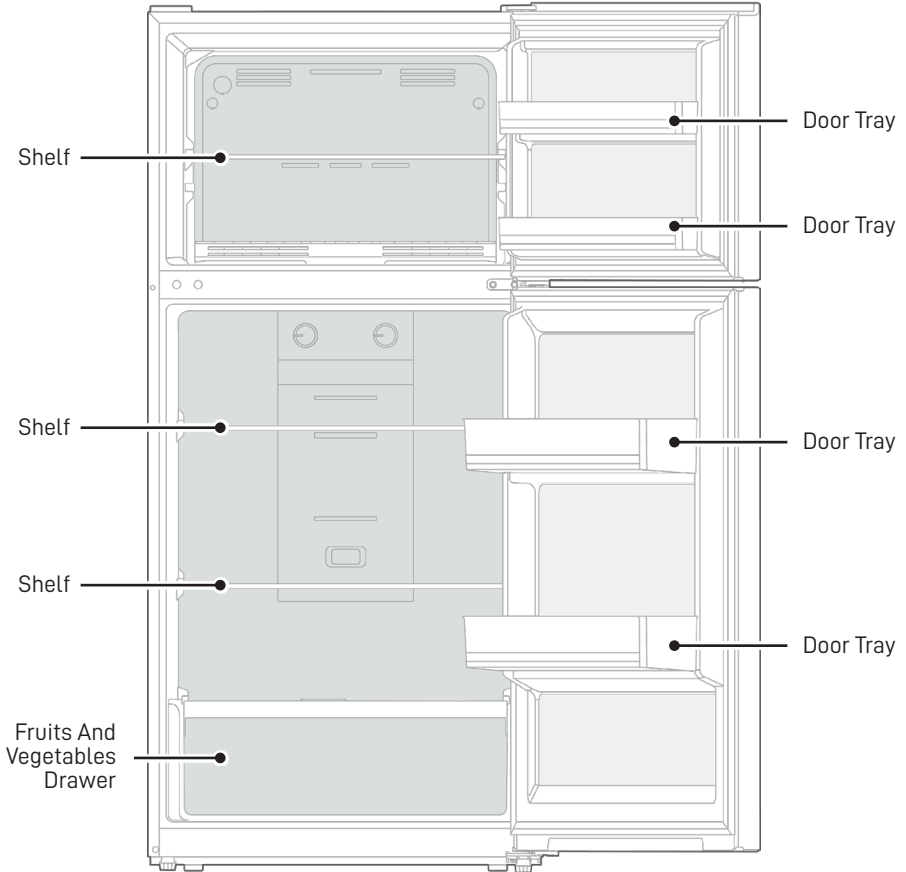

**Important:** Drawers, food boxes, shelves, etc. placed according to the position in the picture above are the most energy efficient.

(Product may be subject to change without prior notice)





## ENERGY SAVING TIPS

- The appliance should be located in the coolest area of the room, away from heat producing appliances or heating ducts, and out of direct sunlight.
- Let hot foods cool down to room temperature before placing it in the appliance. Overloading the appliance forces the compressor to run longer. Food that freezes too slowly may lose quality, or spoil.
- Be sure to wrap food properly, and wipe containers dry before placing them in the appliance. This cuts down on frost build-up inside the appliance.
- Appliance storage bins should not be lined with tin foil, wax paper, or paper toweling. Liners interfere with cold air circulation, making the appliance less efficient.
- Organize and label food to reduce door openings and extended searches. Remove as many items as needed at one time, and close the door as soon as possible.

## CHANGING THE LIGHT

Any replacement or maintenance of the LED lamps is intended to be made by the manufacturer, its service agent or similar qualified persons.

The light source in this product is only to be replaced by qualified engineers.

	<b>1.</b> First remove the plug.
	<b>2.</b> Remove the light cover with a screwdriver.
	<b>3.</b> Take down the lamp panel.
	<b>4.</b> Remove the connection terminal.

## ELECTRICAL CONNECTION

- Before initial start, keep the refrigerator still for two hours before connecting it to power supply.
- Before placing any fresh or frozen foods, the refrigerator should have run for 2 - 3 hours, or for above 4 hours in summer when the ambient temperature is high.

**NOTE:** This product is not recommended for use with sockets or main switch with the A/GFCI function, otherwise it may cause false tripping.

- 1.** It's not pose a safety risk when tripped.
- 2.** If tripping persists, it is recommended to replace the sockets or main switch without A/GFCI function.

# OPERATING INSTRUCTIONS

## REFRIGERATING CHAMBER

- The Refrigerating chamber is suitable for storage of a variety of fruits, vegetables, beverages and other short-term food, but the vegetables should be as far away from the refrigeration air supply outlet as possible.
- Cooking foods shall not be put in the refrigerating chamber until cooled to room temperature.
- Foods are recommended to be sealed up before putting into the refrigerator.
- The glass shelves can be adjusted up or down for a reasonable amount of storage space and easy use.

## FREEZING CHAMBER

- The low temperature freezing chamber may keep food fresh for a long time and it is mainly used to store frozen foods and making ice.
- The freezing chamber is suitable for storage of meat, fish, rice balls and other foods not to be consumed in short term.
- Chunks of meat are preferably to be divided into small pieces for quick freezing and easy access. Please be noted food shall be consumed within the shelf time.

## TEMPERATURE CONTROLLING KNOB

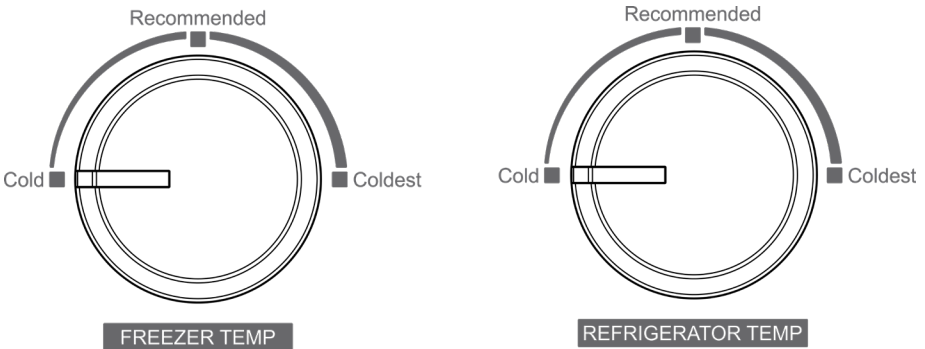





The temperature control dials are located at the rear wall of the fridge. The freezer dial is on the left and the refrigerator dial is on the right. The recommended settings are sufficient for home use.

## REVERSE DOOR HINGE (OPTIONAL)

### PRECAUTIONS BEFORE OPERATION:

- Before making changes the refrigerator must be disconnected from power. Before adjusting the door, precautions should be taken to prevent any personal injury.

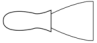
#### List of tools to be provided by the user

	Allen Wrenches		Flat-Head Screwdriver
	Phillips Screwdriver		Putty Knife
	5/16" Socket and Ratchet		Masking Tape

1. Unplug the refrigerator and take out all the food in the refrigerator;
2. Remove the right hinge cover, screws and upper hinge on the top of the box, and the hole cover on the left; take out the freezing door upwards.

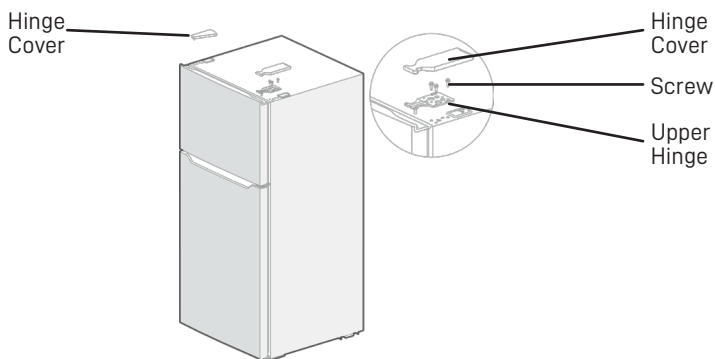

3. Unscrew the hinge screws, remove the middle hinge, remove the hole cover (plug screw), screw cap and middle beam screw on the middle beam, and take out the door body of the cold storage chamber upwards.

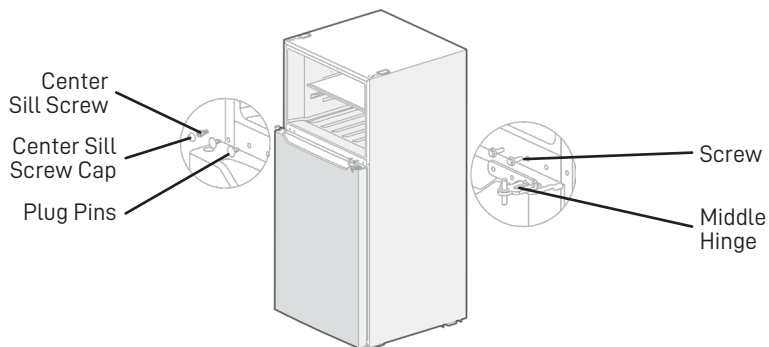

## REVERSE DOOR HINGE (OPTIONAL)

4. Put the refrigerator down, unscrew the lower hinge screw and adjusting foot, remove the lower hinge, remove the lower hinge shaft and install it into the shaft hole on the other side of the hinge;

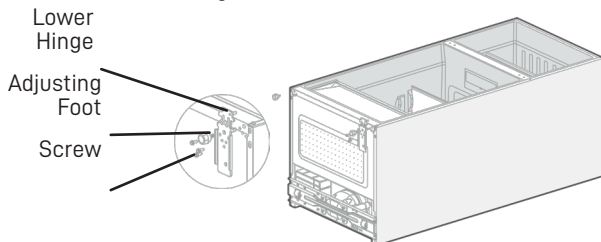

5. Install the lower hinge and tighten the screws on the left side of the refrigerator, install two adjusting feet, and erect the refrigerator.

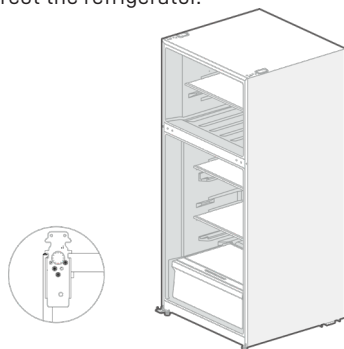

6. Unscrew and remove the shaft sleeves, door stops and right door self-locking screws of the two door bodies, take out the left door self-locking from the accessory bag, and install it to the left corner of the door body together with the door stops and shaft sleeves. Take out the hole plug and shaft sleeve on the upper part of the cold storage door and adjust their positions before installing them into the door body. Take out the shaft sleeve on the freezing door and install it on the other side.

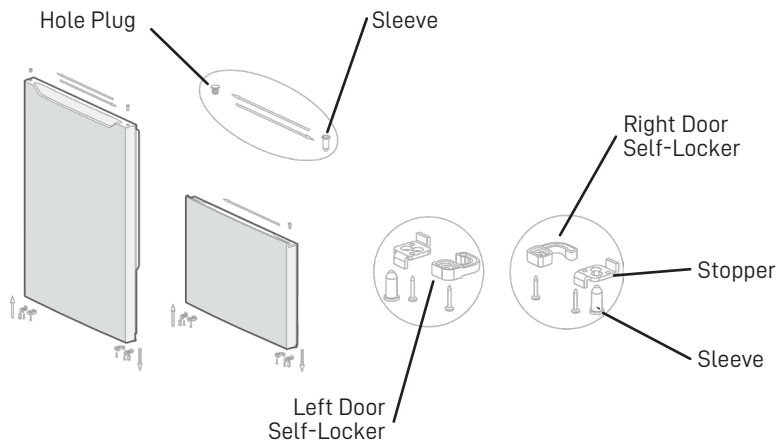

7. Install the refrigerated door on the lower hinge, install the center beam screws, center hinge and tighten the screws on the left side, and cover the hole cover (plug screw), center beam screws and screw caps on the right side.

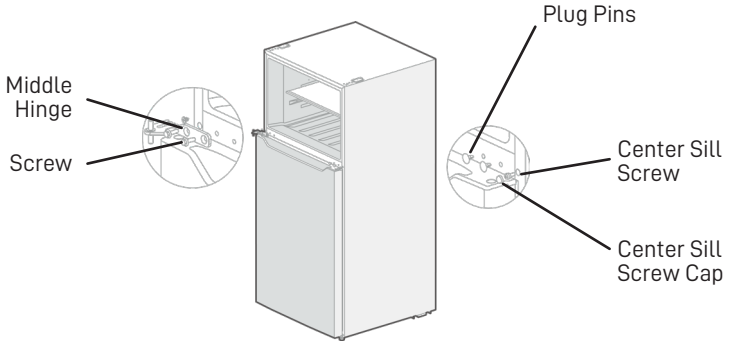

8. Install the freezing door on the middle hinge, remove the upper hinge shaft and install it into the shaft hole on the other side of the hinge, install the upper hinge and tighten the screws, and install the upper hinge cover and the right hole cover;

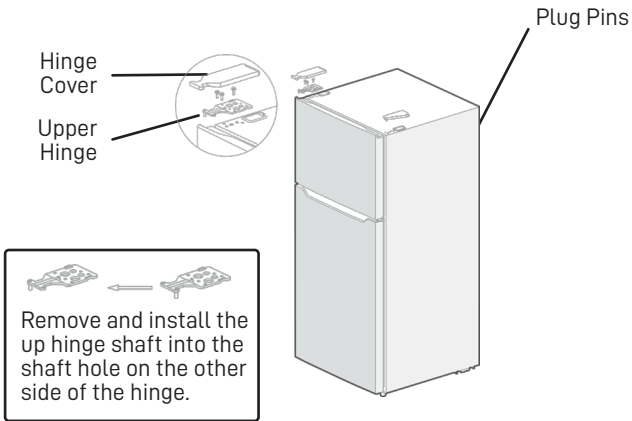

## LEVELING FEET

1. Precautions before operation:
  - Before making changes the refrigerator must be disconnected from power.
  - Before adjusting the leveling feet, precautions should be taken to prevent any personal injury.
2. Adjusting procedures:
  - a. Turn the feet clockwise to raise the refrigerator.
  - b. Turn the feet counter-clockwise to lower the refrigerator.
  - c. Adjust the right and left feet based on the procedures above to a horizontal level.

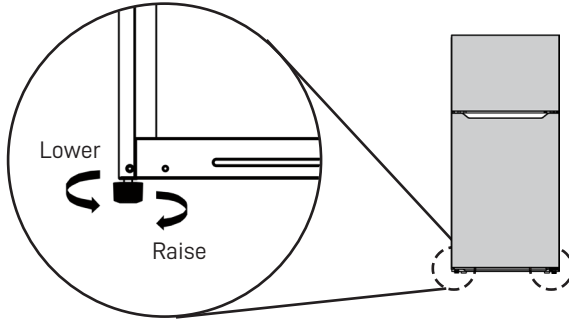

## CARE AND MAINTENANCE

- Dust behind the refrigerator and on the floor must be cleaned to improve the cooling effect and energy saving.
- Check the door gasket regularly to make sure there is no debris. Clean the door gasket with a soft cloth dampened with soapy water or diluted detergent.
- The interior of the refrigerator should be cleaned regularly to avoid odors.
- Please turn off the power before cleaning the interior, remove all food, drink, shelves, drawers, etc.
- Use a soft cloth or sponge to clean the inside of the refrigerator with two tablespoons of baking soda and a quart of warm water. Then rinse with water and wipe clean. After cleaning, open the door and let it dry naturally before turning on the power.
- For areas that are difficult to clean inside the refrigerator (such as narrow places, gaps or corners), we recommend to wipe them regularly with a soft rag, soft brush, etc. and when necessary, with some tools (such as thin sticks) to ensure no contaminants or bacterial accumulation in these areas.
- Do not use soap, detergent, scrub powder, spray cleaner, etc., as these may cause odors inside the refrigerator or contaminate food.
- Clean the door tray, shelves and drawers with a soft cloth dampened with soapy water or diluted detergent. Dry with a soft cloth or dry naturally.
- Wipe the outer surface of the refrigerator with a soft cloth dampened with soapy water, detergent, etc., and then wipe dry.
- Do not use hard brushes, scouring pads, wire brushes, abrasives (such as toothpaste), organic solvents (such as alcohol, acetone, banana oil, etc.), boiling water, acid or alkaline items, which may damage the fridge surface and interior. Boiling water and organic solvents such as benzene may deform or damage plastic parts.
- Do not rinse directly with water or other liquids during cleaning to avoid short circuit or affect electrical insulation after immersion.

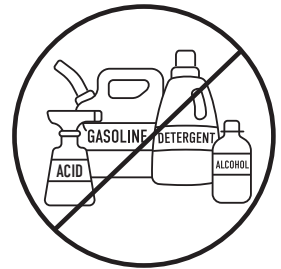

### DEFROSTING

- Frost formed due to change of season or temperature may also be manually removed by disconnection of the appliance from power supply or by wiping with a dry towel.

### OUT OF OPERATION

- Power failure: In case of power failure, even if it is in summer, food inside the appliance can be kept for several hours; during the power failure, the times of opening the doors must be reduced, and no more fresh food should be placed into the appliance.
- Long-term non-use: Unplug and clean the appliance and leave the doors open to prevent odors.
- Moving: Before the refrigerator is moved, take all objects out, fix the glass partitions, vegetable holder, freezing chamber drawers etc. with tape, and tighten the leveling feet; close the doors and fix them with tape. During the move, the appliance must not be laid upside down or horizontally, or be exposed to strong vibration; the inclination during the move should be no more than 45°.

**IMPORTANT:** The appliance shall run continuously once it is started. Generally, the operation of the appliance shall not be interrupted; otherwise the service life may be impaired.

## TROUBLESHOOTING

The following simple issues can be handled by the user. Please call the after-sale service department if the issues are not solved.

Malfunction	<p>Check whether the appliance is connected to power or whether the plug is inserted properly.</p> <p>Check whether the voltage is too low.</p> <p>Check whether there is a power failure or circuits have tripped.</p>
Odor	<p>Odorous food should be tightly wrapped.</p> <p>Check whether there is any rotten food.</p> <p>Clean the inside of the refrigerator.</p>
Long operation of the compressor	<p>Long operation of the refrigerator is normal in summer when the ambient temperature is high.</p> <p>We do not suggest placing too much food in the appliance at the same time.</p> <p>Food must cool down before being placed in the appliance.</p> <p>The doors are opened too frequently.</p>
Light fails to turn on	<p>Check whether the refrigerator is connected to power supply and whether the illuminating light is damaged.</p> <p>Have the light replaced by a specialist.</p>
Door cannot be properly closed	<p>The door is stuck by food packages.</p> <p>The refrigerator is tilted.</p>
Loud noises	<p>Check whether the floor is level and whether the refrigerator is placed in a stable position.</p> <p>Check whether accessories are placed at proper locations.</p>
Door seal fails to be tight	<p>Remove foreign matters on the door seal.</p> <p>Heat the door seal and then cool it for restoration (or blow it with an electrical drier or use a hot towel for heating).</p>
Water pan overflows	<p>There is too much food in the chamber or food stored contains too much water, resulting in heavy defrosting.</p> <p>The doors are not closed properly, resulting in frosting due to entry of air and increased water due to defrosting.</p>
Hot housing	<p>Heat dissipation of the built-in condenser via the housing, which is normal. When the housing becomes hot due to high ambient temperature, storage of too much food or shutdown of the compressor, provide good ventilation to facilitate heat dissipation.</p>
Surface condensation	<p>Condensation on the exterior surface and door seals of the refrigerator is normal when the ambient humidity is too high. Just wipe the condensate with a clean towel.</p>
Abnormal noise	<p>Buzz: The compressor may produce buzzes during operation, and the buzzes are loud particularly upon start or stop. This is normal.</p> <p>Creak: Refrigerant flowing inside the appliance may produce creak, which is normal.</p>

## YOUR AVANTI PRODUCTS WARRANTY

Staple your sales receipt here. Proof of original purchase date is needed to obtain service under warranty.

### WHAT IS COVERED – LIMITED ONE-YEAR WARRANTY

Avanti Products warrants that the product is free from defects in materials and/or workmanship for a period of twelve (12) months from the later of the date of purchase by or delivery to the original owner, under normal use. This warranty shall not be stalled, tolled, extended, or suspended for any reason unless specifically described in this document. During this period, Avanti Products will, at its option, repair or replace any part of the product which proves to be defective in material or workmanship under normal use. Avanti Products will provide you with a reasonably similar product that is either new or factory refurbished.

All Avanti appliances of 3.5 cubic feet capacity or less must be brought/sent to the appliance service center for repair.

For rental or commercial use, the warranty period is 90 days.

#### **FULL 30-DAY WARRANTY (COOKTOPS ONLY)**

From the date of purchase or delivery on glass parts and finishes of porcelain enamel, painted, or bright metal finished parts.

### EXTENDED WARRANTY COVERAGE

- **Refrigeration Products:** For the second through the fifth year from the later of the date of purchase or delivery, the sealed system, including the compressor, evaporator, condenser, and tubing, is covered for replacement parts only under normal use. Avanti Products will provide a replacement compressor free of charge if a failure occurs within this period; however, the customer is responsible for all service labor, transportation, and freight charges. For rental or commercial use, the limited compressor warranty is one year and nine months. If the product requires transport to a service center for repairs, all associated costs are the customer's responsibility.
- **Laundry Products:** The plastic tub is covered for 5 years, and the stainless-steel tub is covered for 7 years from the later of the date of purchase or delivery, under normal use. Coverage applies to replacement parts only; the customer is responsible for labor and transportation costs.
- **Microwave Ovens:** The magnetron tube is covered for years 2 through 7 from the later of the date of purchase or delivery, under normal use. The second year includes replacement parts only, with the customer responsible for labor and transportation costs. Years 3 through 7 provide magnetron tube replacement only, excluding labor and transportation costs.
- **Ranges, Cooktops, Dishwashers, and Other Products:** No extended warranty beyond the one-year standard coverage.

### WARRANTY EXCLUSIONS / WHAT IS NOT COVERED:

The warranty coverage described herein excludes all defects or damage that are not the direct fault of Avanti Products, including without limitation, one or more of the following:

- Failure to comply with any applicable state, local, city, or county electrical, plumbing, or building codes.
- This warranty does not cover the cost of disposal, removal, or uninstallation of the appliance, including any associated labor or transportation fees. The customer is responsible for properly discarding or recycling the unit in accordance with local regulations.
- This warranty does not cover white glove delivery, installation, or setup of warranty replacement products. The customer is responsible for any associated costs, including transportation, unpacking, and installation services.
- External, elemental, and environmental forces, including rain, wind, sand, floods, fires, mudslides, freezing temperatures, excessive moisture, extended exposure to humidity, lightning, power surges, structural failures, and acts of God.
- Content losses of food or other stored materials due to spoilage.
- Incidental or consequential damages.

*CONTINUED*

- Failure of the product if used for other than its intended purpose or not under normal use.
- Cosmetic damage, including scratches, nicks, minor dents, or other external surface issues, must be reported within 30 days of delivery to be covered.
- Shipping and handling costs associated with product replacement.
- Repairs performed by unauthorized service providers.
- Consumable parts (i.e. light bulbs, batteries, air or water filters, preservation solutions, etc.)
- Discoloration, rust or oxidation of surfaces resulting from caustic or corrosive environments including but not limited to high salt concentrations, high moisture or humidity or exposure to chemicals.
- Parts and labor costs for the following will not be considered as warranty:
  - Plastic cabinet liners.
  - Light bulbs and/or plastic housing
  - Microwave inner door panels, door shelves, door rails, and/or door supports.
  - Punctured evaporator that voids the warranty on the complete sealed system.
- Service calls related to abuse, misuse, inadequate electrical power, accidents, fire, floods, or other acts of God.
- Surcharges, including after-hour, weekend, or holiday service calls, tolls, ferry trip charges, or mileage expenses for service calls to remote areas.
- Damage resulting from improper voltage, electrical surges, or circuit breaker failures is not covered.
- Extended warranty coverage does not apply to commercial, rental, or business use.
- Water damage resulting from improper installation, clogged drains, leaking supply hoses, or external flooding is not covered.
- This warranty does not apply outside the continental USA.

In no event shall Avanti Products have any liability or responsibility whatsoever for damage to surrounding property, including cabinetry, floors, ceilings, and other structures and/or objects around the product. Also excluded from this warranty are scratches, nicks, minor dents, and other cosmetic damages on external surfaces and exposed parts; Products on which the serial numbers have been altered, defaced or removed; service visits for customer education, or visits where there is nothing wrong with the product; correction of installation problems (you are solely responsible for any structure and setting for the product, including all electrical, plumbing and/or other connecting facilities, for proper foundation/flooring, and for any alterations including without limitation cabinetry, walls, floors, shelving etc., as well as the resetting of breakers or fuses.

### **OUT OF WARRANTY PRODUCT**

Avanti Products is under no obligation, at law or otherwise, to provide you with any concessions, including repairs, pro-rates, or product replacement, once this warranty has expired.

Avanti Products  
 3355 Enterprise Avenue,  
 Suite 160, Weston, FL 33331







