

2 DRAWER NIGHTSTAND

Assembly Instruction

A. Component :

1. 2 Drawer Nightstand 1 Pc

Qty



A

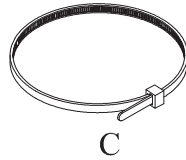

C



B



D



E

B. Hardware :

Qty

A. Screw Ø8 x 2" 1 Pc

B. Screw Ø8 x 5/8" 1 Pc

C. Restrain Strap 1 Pc

D. Metal Tabs 2 Pcs

E. Plastic Wall Anchor 1 Pc

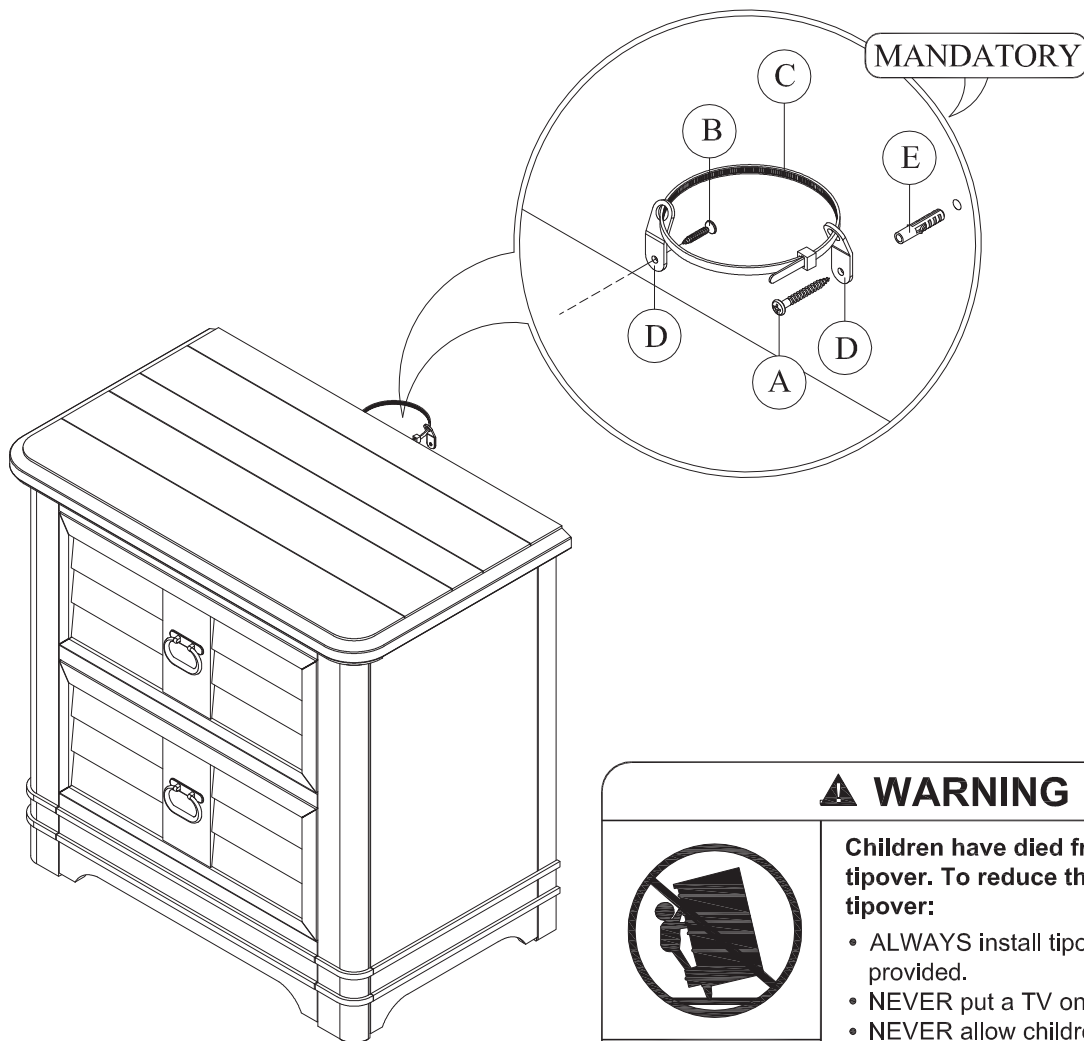

⚠ WARNING



Children have died from furniture tipover. To reduce the risk of furniture tipover:

- ALWAYS install tipover restraint provided.
- NEVER put a TV on this product.
- NEVER allow children to stand, climb or hang on drawers, doors, or shelves.
- NEVER open more than one drawer at a time.
- Place heaviest items in the lowest drawers.



*This is permanent label.
Do not remove !*