

# Outdoor Entertainment



MADE IN THE USA

# Table of Contents

## Unit Dimensions

Outdoor Entertainment Measurements . . . . .	1
--	---

## Bracket Installation for HDMI

1. Drill for the Placement of Metal Brackets . . . . .	2
2. Plug in Your TV's HDMI . . . . .	3
3. Power to the Recessed Lighting and Alternate Outlet . . .	3
4. Power Switch Turns Recessed Lighting & Power On/Off .	3

## Warranty

Limited Warranty. . . . .	4
---------------------------	---

## Unit Dimensions

### Outdoor Entertainment Measurements

**Width 84"**

**Height 84"**

**Depth 36"**

**Weight 700 lbs.**

**Shipping Weight 750 lbs.**

The Outdoor Entertainment Measurements are provided for backyard planning. If the Guide steps are followed, there will be little trouble hooking up a television for HDMI and Power Supply.



**The Outdoor Entertainment system is also available with shelves in place of the refrigerators.**



# Bracket Installation for HDMI

## 1. Drill for the Placement of Metal Brackets

Drill and place 2 brackets (if desired) for the back wall placement in the cabinet of a wall-mounted television. The placement of these brackets and the cabinet space allotted for a flat-screen television are shown below.

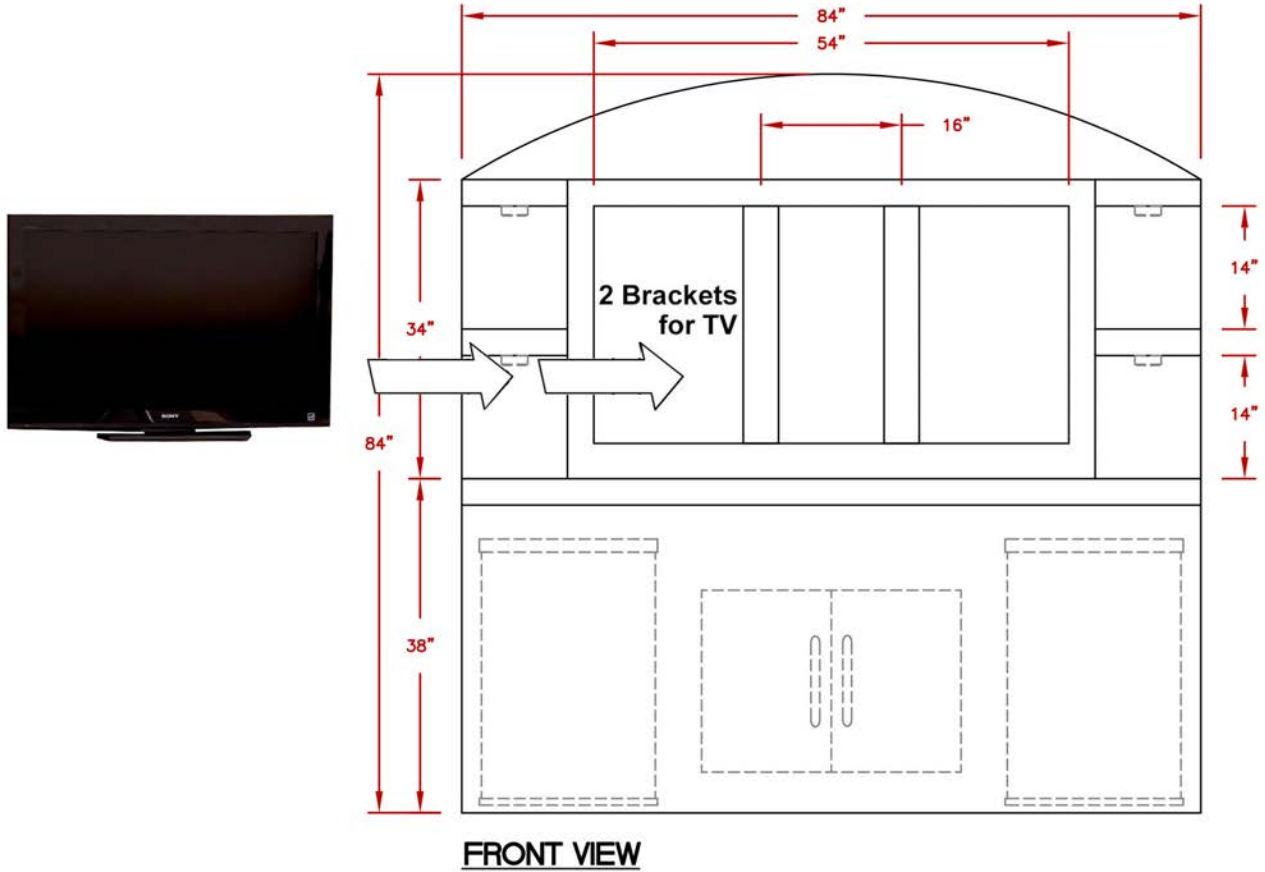

The television enclosure is 54" Wide by 27" Tall. Please note that diagonal screen measurements will not give the true physical dimensions of the television because the diagonal measurement does not take into account the television's housing. Therefore, the best measurement to use is the actual height and width of your television (including the base if used).

## 2. Plug in Your TV's HDMI



## 3. Power to the Recessed Lighting and Alternate Outlet



## 4. Power Switch Turns Recessed Lighting & Power On/Off



# Warranty

## Limited Warranty

Extent of Warranty

Manufacturer Warranty

Warranty Performance

**Warranty Limitations**

**Disclaimers**

**Legal Remedies**

**Customer Service**

