



Assembly Instruction

Collection: CARISSA

Item No: D422-23

CARISSA COUNTER BENCH (1 PER CARTON)

Thank you for purchasing this quality product. Be sure to check all packing materials carefully for small parts which may have come loose inside the carton during shipment. Identify and count all items and compare with the PARTS LIST and/or HARDWARE LIST shown below.

1. We recommend that you assemble this product with the assistance of another person; this will make the assembly easier, and will help eliminate damage to the product or injury to persons during assembly.
2. Please do not tighten screws or bolts until the assembly is completed.
3. To level the chairs or table, before tightening all the screws, the chairs or table must be placed on a flat surface and then tighten the screws.
4. Please put all parts on a non-abrasive floor before assembly and follow the assembly steps to assemble your newly purchased product correctly and efficiently.

| PARTS LIST | | | |
|-----------------------------|-----------------------------|---------|------|
| No. | DESCRIPTION | SKETCH | Q'TY |
| A | SEAT CUSHION | | 1 |
| B | RIGHT SIDE FACING (RSF) LEG | | 2 |
| C | LEFT SIDE FACING (LSF) LEG | | 2 |
| D | LONG STRETCHER | | 2 |
| E | SHORT STRETCHER | | 2 |
| F | MIDDLE STRETCHER | | 1 |
| WEIGHT CAPACITY (PER BENCH) | | 507 LBS | |

| HARDWARE LIST | | | |
|---------------|-------------------------|--------|------|
| No. | DESCRIPTION | SKETCH | Q'TY |
| 1 | BOLT (5/16"x2-1/4") | | 8 |
| 2 | SPRING WASHER (5/16") | | 8 |
| 3 | FLAT WASHER (5/16"x3/4) | | 8 |
| 4 | SCREW M4x1-1/2" | | 10 |
| 5 | ALLEN KEY (M5x2-1/2") | | 1 |

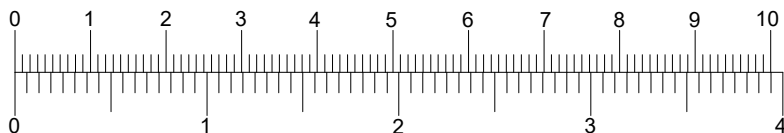

STEP 1:

Assemble the RSF legs (B) and LSF (C) with the seat cushion (A) by using Allen Key (5) with hardware 1, 2, and 3.

****Attention: DO NOT TIGHTEN THE BOLTS.**

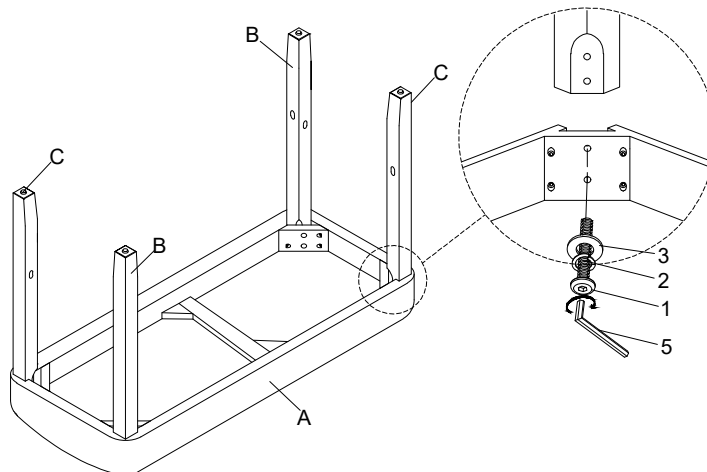

MADE IN VIETNAM

Assembly Instruction

Collection: CARISSA

Item No: D422-23

CARISSA COUNTER BENCH (1 PER CARTON)

STEP 2:

Install the long stretcher (D), short stretcher (E) and middle stretcher (F) between the RSF legs (B) and LSF legs (C). Assemble the stretchers to the legs by using a screwdriver with hardware (4).

****Attention: DO NOT TIGHTEN THE SCREWS.**

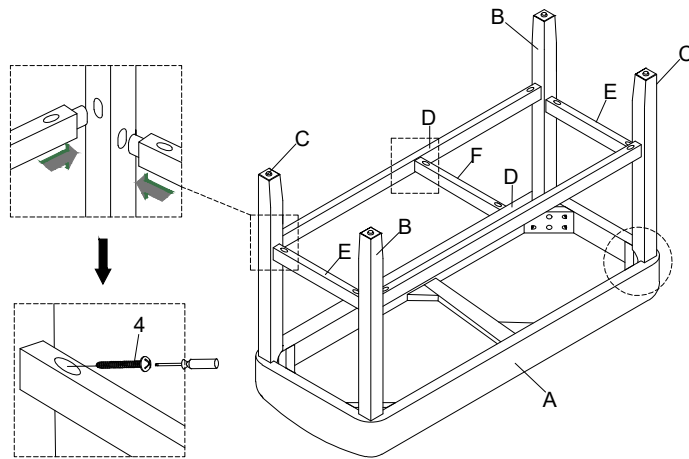

STEP 3:

To level the bench, turn the bench right side up on a flat surface and tighten the bolts with Allen Key (4) and the screws with a screwdriver.

****Attention: DO NOT OVERTIGHTEN THE BOLTS AND SCREWS.**

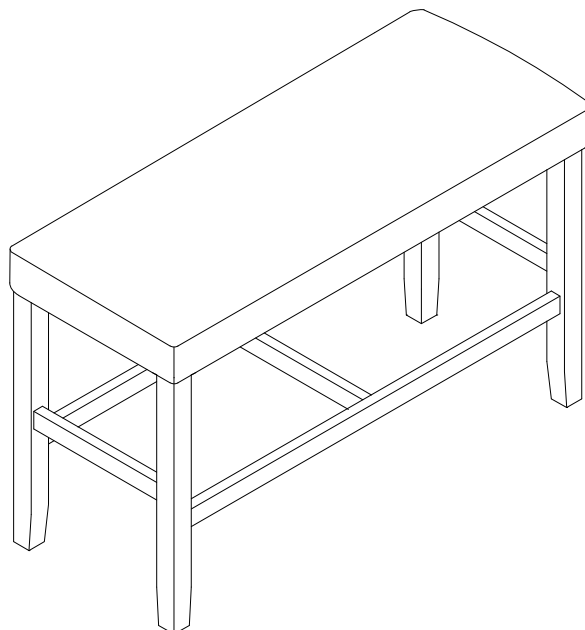

MADE IN VIETNAM