

# Outdoor Pole Operated Sun Shade with Valance & PVC Fabric

## INSTALLATION INSTRUCTIONS

We recommend two (2) people install this shade. A power drill, tape measure, leveling device, and Phillips screwdriver bit are recommended for installation (not included). Some parts shown in this manual may differ slightly than the product you have purchased.

Please lay out and take an inventory of all parts prior to assembly. Please give us a call if you are missing any parts. Read the instructions in their entirety prior to beginning assembly and installation. Note: this shade must be installed into wood studs. If wood studs are not available, anchoring hardware must be used (not included).

### Parts in hardware box (parts not shown to scale)



### Parts in pole package (parts not shown to scale)

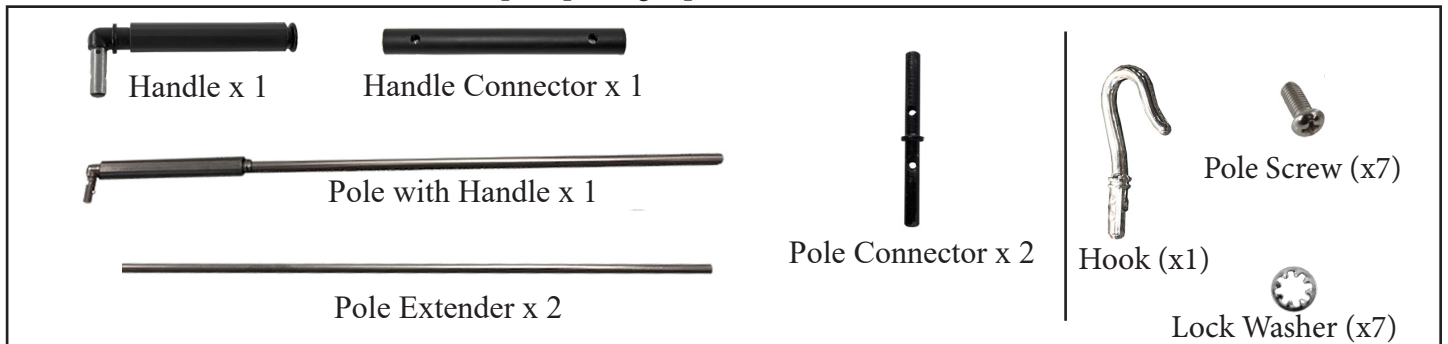

Note: some parts may be slightly different than shown in this manual.

## Install Ring

Before you install your Valance Brackets, you will need to install the ring onto the Crank Bracket. Using the Ring Screw provided in the pole package, attach the Ring to the Crank Bracket. See Fig A. Be sure to tighten this screw completely.

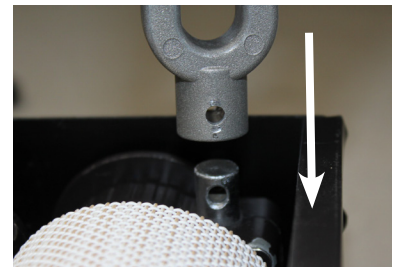

Fig A

## STEP 1: Install Valance Brackets

Determine your type of installation. Your solar shade can be hung from a wall or a ceiling. See Figures B and C.

Your shade is shipped with a protective film to prevent scratching during shipping. Remove this film prior to installation.

Wall Installation



Fig B

Ceiling Installation



Fig C

Your shade includes three (3) Valance Brackets, you must install at least two (2) of them. Install one (1) Valance Bracket near each end of the shade. Note: the Valance Brackets cannot be installed on the extreme edges of the shade, you will need to allow at least 2 inches (5.08 cm) at the ends of each side. We recommend installing the brackets on the closet stud to each end of the shade, remembering to allow at least 2 inches (5.08 cm) from each end. If you are installing a third bracket, install it near the center of the shade (ideally on a wood stud). Install the Valance Brackets into wood studs. If wood studs are not available, you will need to use anchors (not included). See your local hardware store for more information.

Some shade models include a paper template to help align your pilot holes. If your shade includes a template, temporarily adhere it to your installation area, making sure it is straight and level, then mark and drill your pilot holes. Remove the paper template before installing your Valance Brackets.

Wall Installation

For wall installations, you need to allow at least 1 inch (2.54 cm) above the bracket to allow the valance to hook onto the bracket (only if there is a ceiling that overhangs the shade). See Fig D.



Fig D

Ceiling Installation

For ceiling installations, you need to allow at least 1 inch (2.54 cm) behind the bracket to allow the valance to hook onto the bracket (only if there is a wall behind the shade). See Fig E.



Fig E

It is very important that your brackets are perfectly aligned with each other (your shade will not install correctly unless your brackets are perfectly aligned with each other). We recommend using a laser level to align the screw holes.

Wall Installation

For a wall installation, make sure the plastic tabs on your Valance Brackets are pointing towards the ground (Fig F). Use the screws from your hardware box to install these brackets.



Fig F

Ceiling Installation

For ceiling installation, make sure the plastic tabs on your Valance Brackets are pointing out, towards you (Fig G). Use the screws from your hardware box to install these brackets.



Fig G

## STEP 2: Install the shade

For wall installations, first hook the back of the Valance on the top of Valance Brackets (Fig H), then rotate the shade down and click into place (Fig I).

Note: you may need to push the plastic tabs on the Valance Brackets to help the shade click into place.

### Wall Installation

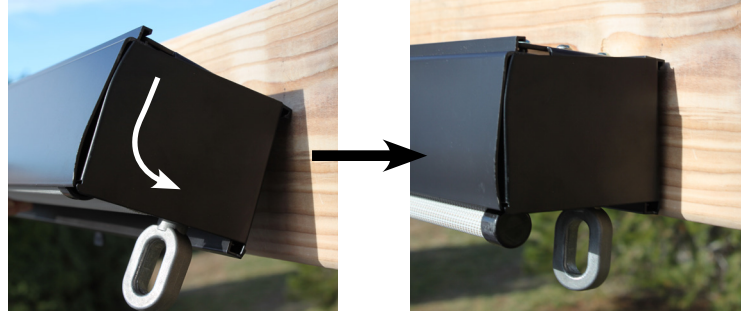

Fig H

Fig I

For ceiling installations, first hook the back of the Valance on the back of the Valance Brackets (Fig J), then rotate the Valance upwards and click it into place (Fig K).

Note: you may need to push the plastic tabs on the Valance Brackets to help the shade click into place.

### Ceiling Installation

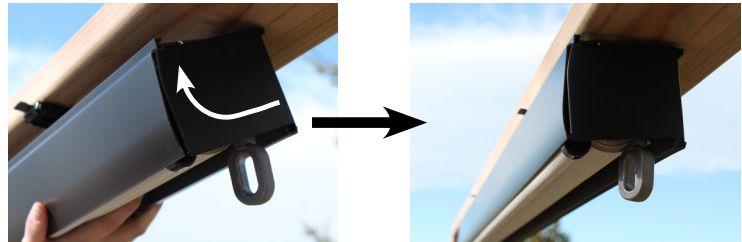

Fig J

Fig K

## STEP 3: Assemble Pole

Before you begin, please note that your Pole can be assembled to be any of the following three (3) lengths:

- 2 ft. long
- 4 ft. long
- 6 ft. long

Using two (2) Pole Screws and two (2) Lock Washers, attach the Handle to the Pole with Handle Connector (Fig L).

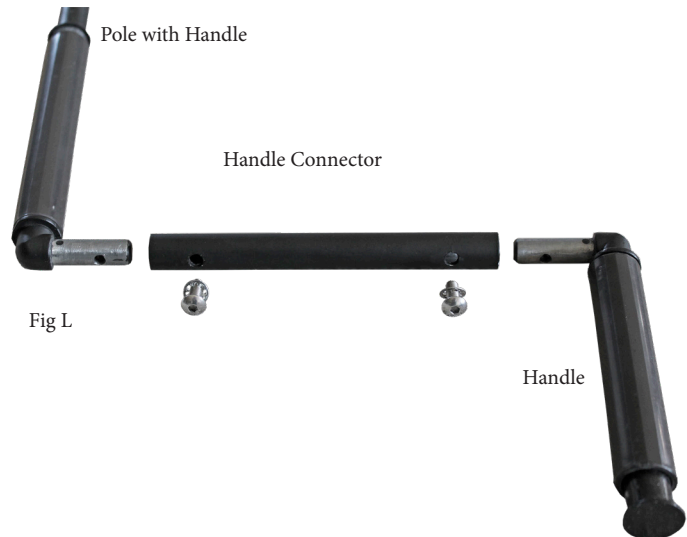

Fig L

If you desire a 2 ft. Pole, you can now attach the Hook to the Pole with Handle (using a Pole Screw and Lock Washer; see Fig. M) If you desire a longer pole, please continue reading Step 6.

For a 4 ft. Pole:

Attach a Pole Extender to the Pole with Handle using one (1) Connector Piece and two (2) Pole Screws and two (2) Lock Washers (Fig N). Then, attach the Hook to the Pole Extender (Fig M).

For a 6 ft. Pole:

Attach a Pole Extender to the Pole with Handle using one (1) Connector Piece and two (2) Pole Screws and two (2) Lock Washers (Fig N). Then, connect the two (2) Pole Extenders to each other using a Pole Connector. Finally, attach the Hook to the Pole Extender (Fig M).



Fig. M

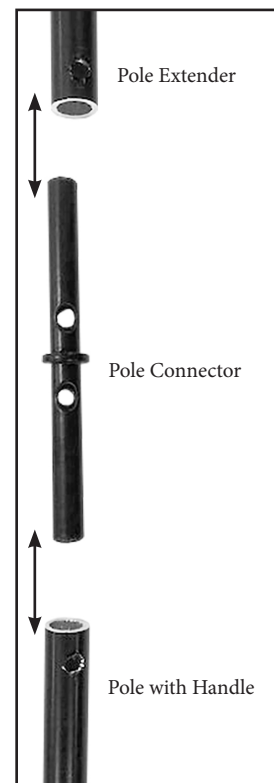

Fig. N



2' Pole



4' Pole



6' Pole

### Install bungee system (optional step)

The shade includes two (2) Bungee Systems to secure the bottom of both sides of your shade. To install the Bungee System, start by feeding the Bungee through the Bottom Tube Plugs located at each end of your Bottom Tube (Fig O). Then insert the Bungee into the Hook and drill the Hook into a wall/post using one (1) Bracket Screw (Fig P) from your hardware box. To prevent fabric stretching/damage, hooks should be installed directly underneath the Bottom Tube Plugs and so there is equal tension on each bungee.

Important: Your shade should be rolled up during windy conditions. The Bungee System is only effective in light wind. When using your shade, we recommend leaving at least one (1) roll of fabric wrapped around the top tube.



Fig O

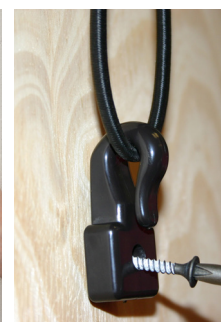

Fig P

## Reversing the roll direction of your shade (optional)

Note: if you do this step, you will need to flip the gear on the Crank Bracket to prevent the fabric from interfering with the ring. Please see the section below called “Flipping the Gear” for more information.

If you want to reverse the roll of your fabric, simply roll the shade down completely. After the fabric is completely lowered, continue rolling the shade...it will roll itself back up in the opposite direction. .

## Switching Crank Bracket to the Left Side of the Shade (optional)

Note: if you do this step, you will need to flip the gear on the Crank Bracket to prevent the fabric from interfering with the ring. Please see the section below called “Flipping the Gear” for more information.

1. Remove both Valance Covers. After you have removed the Valance Covers, switch their positions (move the left cover to the right side of the shade, and move the right cover to the left side of the shade).
2. Next, remove the Plug Bracket and the Crank Bracket by loosening the screws and set the Plug Bracket and Crank Bracket on the ground. It is not necessary to completely remove the screws, you only need to loosen the screws. **DO NOT** reverse the Plug Bracket and Crank Bracket positions.
3. Remove the Valance (leaving the shade on the ground) and reverse (flip around) the Valance . You do not need to reverse the shade fabric or the Valance Covers.
4. Replace the Plug Bracket and Crank Bracket as well as both Valance Covers. **IMPORTANT:** When replacing the Plug Bracket and Crank Bracket, be sure to push them in completely before tightening the screws. The screws should align with the threaded screw holes.

## Flipping the Gear (optional)

If you changed the roll direction of your shade, or you moved your Crank Bracket to the left side of your shade, you will need to flip the gear portion of your Crank Bracket to prevent the ring portion of the Crank Bracket from interfering with your fabric.

Remove the Valance Covers from the shade. Next, remove the Crank Bracket from the shade by loosening the three (3) screws that secure the Crank Bracket to the Valance. Then remove the two (2) screws on the outside of the Crank Bracket (See Fig Q).



Fig Q

Separate the two (2) pieces of the Crank Bracket (See Fig R).



Fig R

Flip the gear portion and re-attach with the two (2) screws (See Fig S).



Fig S

## Care & Maintenance

To clean your shade, simply rinse with water and soap, scrub with a soft brush. Note: Using bleach or an abrasive cleaner will void your warranty. Roll the shade down to air dry. Your shade should be rolled up during windy conditions.

To prolong the life of your shade, we recommend leaving one (1) roll of fabric wrapped around the top tube when using your shade.

---

Don't forget to send us your warranty/registration card.