



## Before You Start

- △ Please read all instructions carefully.
- △ Retain instructions for future reference.
- △ Separate and count all parts and hardware.
- △ Read through each step carefully and follow the proper order.
- △ We recommend that, where possible, all items are assembled near to the area in which they will be placed in use, to avoid moving the product unnecessarily once assembled.
- △ Always place the product on a flat, steady and stable surface.
- △ Keep all small parts and packaging materials for this product away from babies and children as they potentially pose a serious choking hazard.



## Return / Damage Claim Instructions

- △ **DO NOT discard the box / original packaging.**  
In case a return is required, the item must be returned in original box. Without this your return will not be accepted.
- △ **Take a photo of the box markings.**  
A photo of the markings (text) on the side of the box is required in case a part is needed for replacement. This helps our staff identify your product number to ensure you receive the correct parts.
- △ **Take a photo of the damaged part (if applicable).**  
A photo of the damage is always required to file a claim and get your replacement or refund processed quickly. Please make sure you have the box even if it is damaged.
- △ **Send us an email with the images requested.**  
Email us directly from marketplace where your item was purchased with the attached images and a description of your claim.

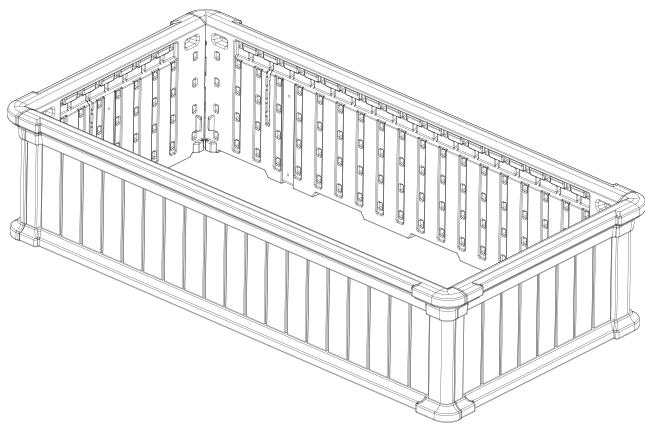
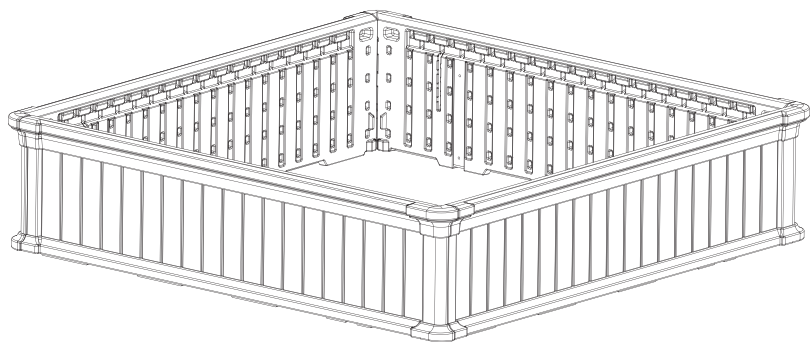

Step1: insert the tabs in the end of a Panel into the slot in a second Panel.

Slide the the second Panel downward.

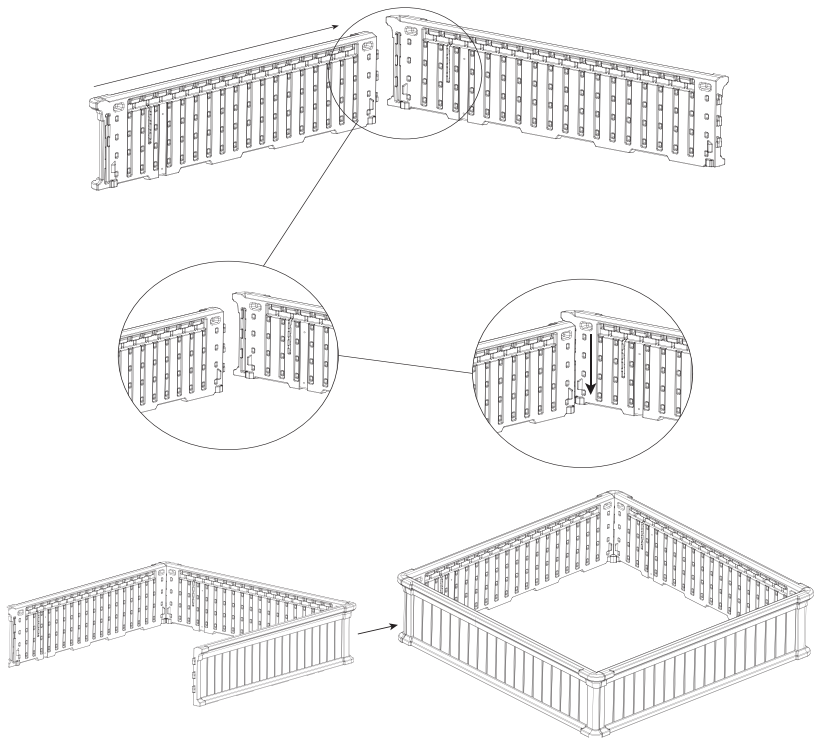

6  
6

Step2: If you make a single bed, insert a Short Corner Bracket into each corner as shown to help hold the Panels in place.

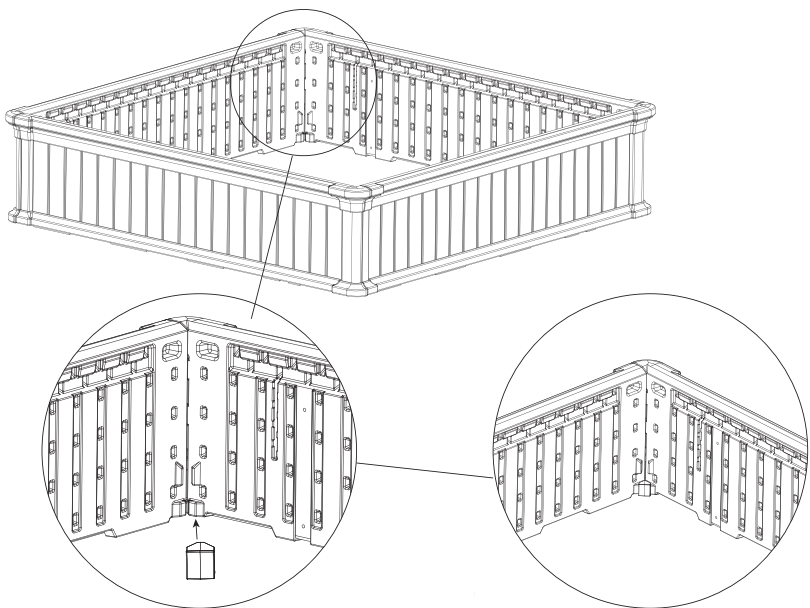

Step3: Screw the “L” metal piece into the panel. Insert the “L” pin into ground.

