



Manufactured by:  
Backyard Discovery  
3305 Airport Drive, Pittsburg, KS 66762  
800-856-4445

Basepoint Business Centre: Rivermead Drive, Westlea, Swindon SN5 7EX Phone: 0800-118-2476  
J.P. Coenstraat 7, The Bridge, The Hague, 2595 WP, Netherlands Phone: 08005678990

# BEAUMONT 14X12 PERGOLA

MODEL: # 2101555



**WARNING**

Cancer and Reproductive Harm

[www.P65Warnings.ca.gov](http://www.P65Warnings.ca.gov)

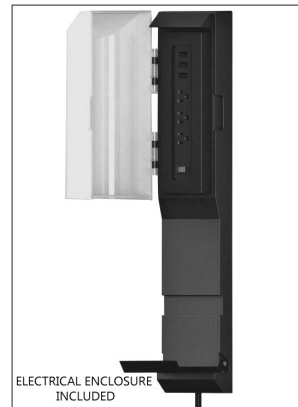
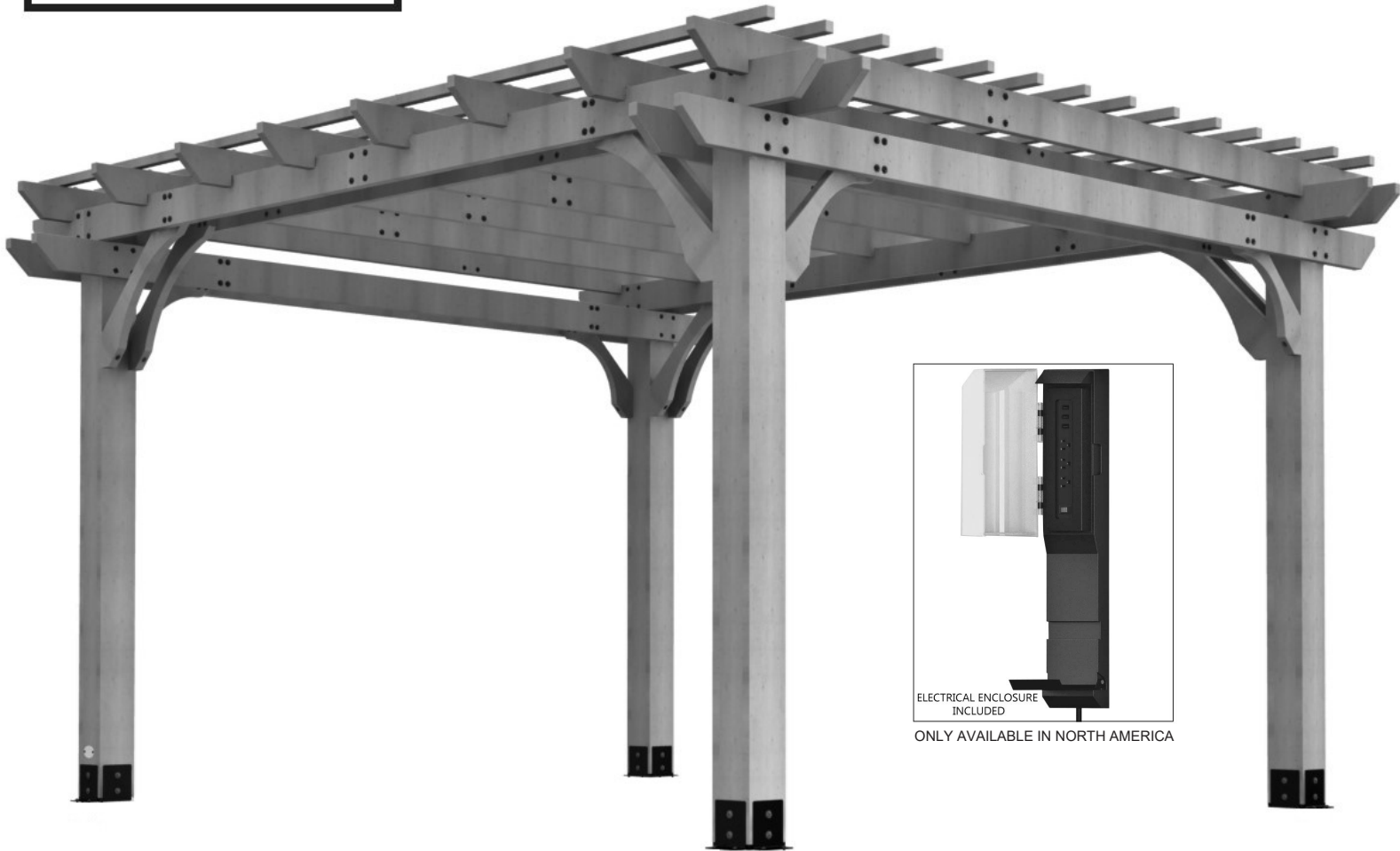

ELECTRICAL ENCLOSURE  
INCLUDED

ONLY AVAILABLE IN NORTH AMERICA

Please visit [www.backyarddiscovery.com](http://www.backyarddiscovery.com)

For the most up to date assembly manual, to register your product, or to order replacement parts

Para obtener instrucciones en español, visite [www.backyarddiscovery.com](http://www.backyarddiscovery.com)



**EASY STEP-BY-STEP**  
**3D INTERACTIVE INSTRUCTIONS**  
DOWNLOAD THE FREE APP



Made in China

INS-2101555-A-BEAUMONT 14X12 PERGOLA ENG 9-25-2023

# OWNER'S MANUAL - BASIC SETUP DIMENSIONS & ASSEMBLY NOTES

It is critically important that you start with square and level footings, concrete pad or deck to attach your structure

- Pay close attention to the items needed for each step. Make sure you are using the correct hardware for each step. Using incorrect hardware may result in improper assembly
- Remember to double check for underground utilities and overhead electrical lines

Post mounts are provided with your structure which allows you to permanently install your structure to a pre-existing or new wood or concrete surface. See Anchor Instructions for further details and recommendations.

- The hardware to attach the post mounts to the structure is included.
- The hardware to mount the structure permanently to a concrete surface is included.
- The hardware to mount the structure permanently to a wood deck is NOT included and will need to be purchased separately. You must ensure there is ample structural support under the deck before permanently attaching.

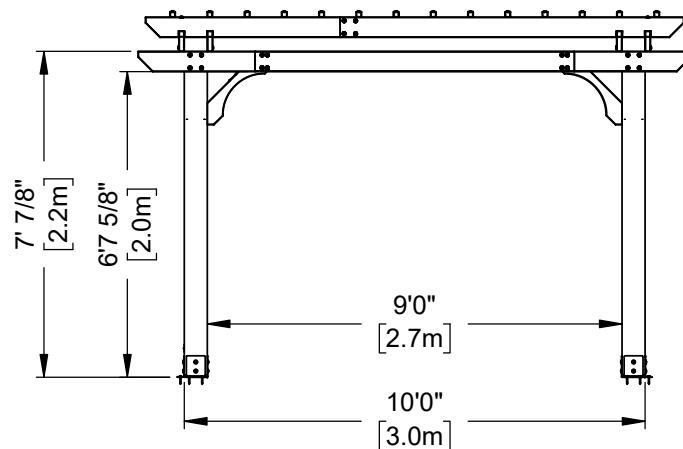
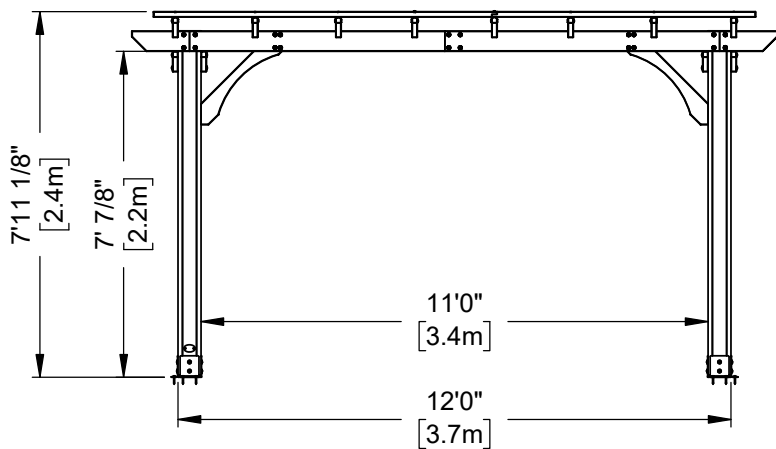
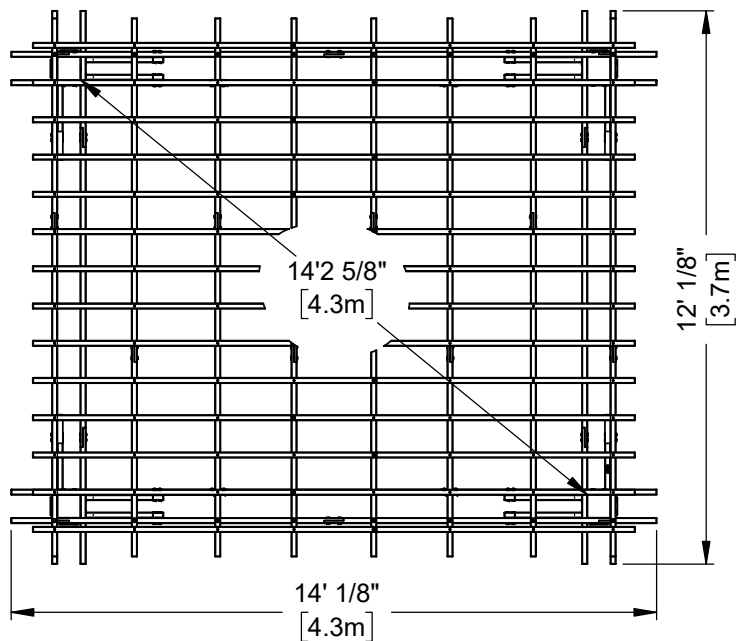

# OWNER'S MANUAL - ANCHORING LAYOUT

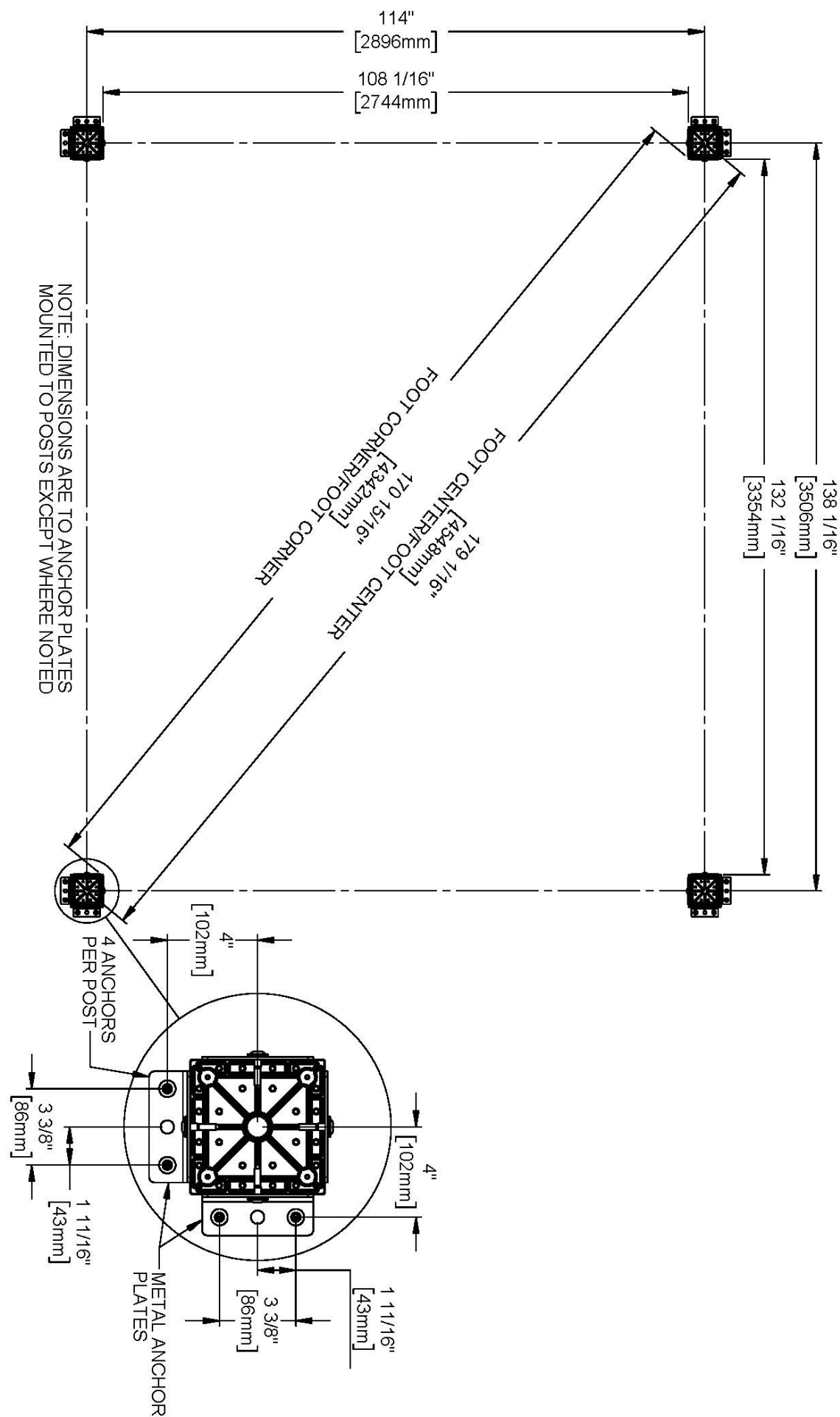

# OWNER'S MANUAL - PARTS IDENTIFICATION

## Wood Components (Not to Scale)

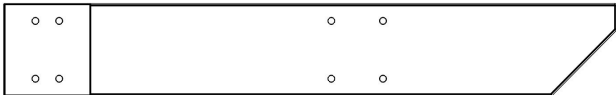

**D01 | JOIST END - W4L15500**  
(4) | 1 3/8"x5 1/4"x35 1/2" (36x134x902)

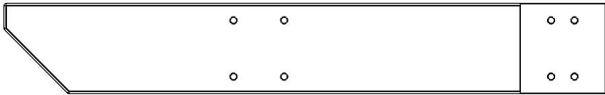

**D02 | JOIST END - W4L15501**  
(4) | 1 3/8"x5 1/4"x35 1/2" (36x134x902)



**D03 | JOIST END - W4L15502**  
(2) | 1 3/8"x5 1/4"x15" (36x134x382)



**D04 | JOIST END - W4L15503**  
(2) | 1 3/8"x5 1/4"x15" (36x134x382)

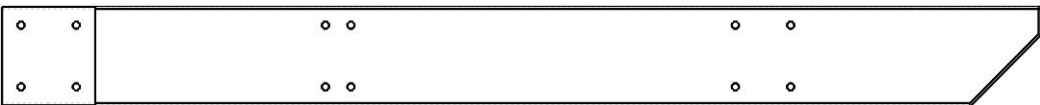

**D05 | JOIST END - W4L15504**  
(2) | 1 3/8"x5 1/4"x56 3/8" (36x134x1431)

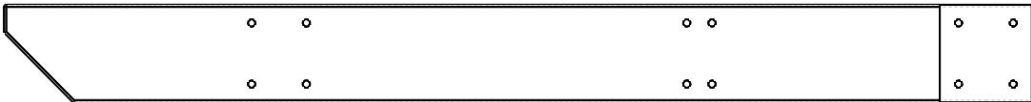

**D06 | JOIST END - W4L15505**  
(2) | 1 3/8"x5 1/4"x56 3/8" (36x134x1431)



**D07 | JOIST - W4L15506**  
(4) | 1 3/8"x5 1/4"x83 1/8" (36x134x2112)



**D08 | JOIST - W4L15518**  
(2) | 1 3/8"x5 1/4"x65 1/2" (36x134x1664)



**D09 | JOIST - W4L15519**  
(2) | 1 3/8"x5 1/4"x74 1/2" (36x134x1893)



**D10 | JOIST - W4L15520**  
(2) | 1 3/8"x5 1/4"x74 1/2" (36x134x1893)



# OWNER'S MANUAL - PARTS IDENTIFICATION

## Wood Components (Not to Scale)

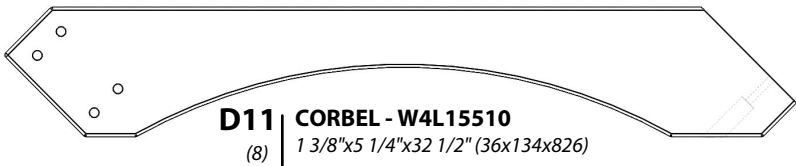

**D11** | CORBEL - W4L15510  
(8) | 1 3/8"x5 1/4"x32 1/2" (36x134x826)

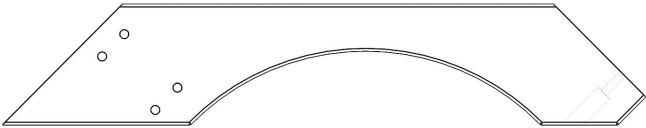

**D12** | CORBEL - W4L15513  
(3) | 1 3/8"x5 1/4"x28 1/4" (36x134x719)

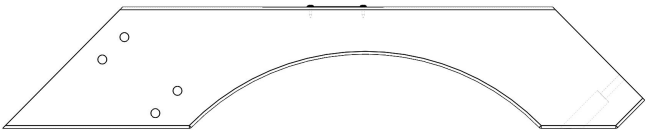

**D13** | CORBEL - W2A03243  
(1) | 1 3/8"x5 1/4"x28 1/4" (36x134x719)

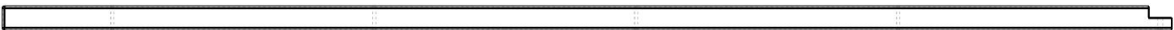

**P10** | PURLIN END - W4L15521  
(14) | 1 3/8"x1 3/8"x68 3/4" (36x36x1746)



**P11** | PURLIN END - W4L15522  
(14) | 1 3/8"x1 3/8"x89 1/2" (36x36x2274)



**D14** | SLOTTED JOIST - W4L15515  
(8) | 1 3/8"x5 1/4"x55 3/4" (36x134x1416)



**D15** | SLOTTED JOIST - W4L15517  
(8) | 1 3/8"x5 1/4"x89 1/2" (36x134x2274)

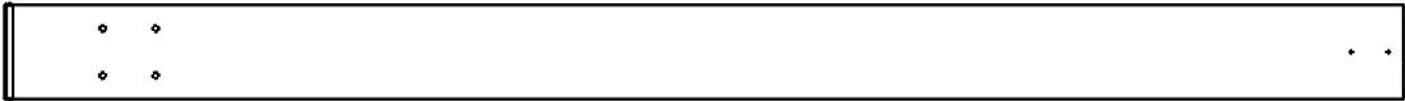

**P01** | POST - W2A03241  
(2) | 6"x6"x89 1/2" (152x152x2274)

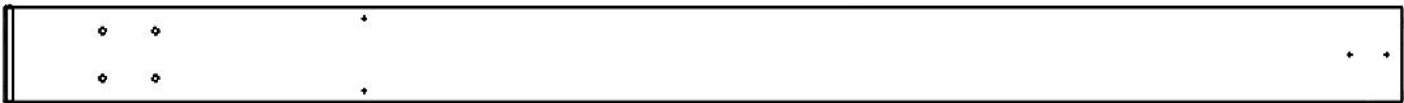

**P02** | POST - W2A03242  
(2) | 6"x6"x89 1/2" (152x152x2274)

# OWNER'S MANUAL - PARTS IDENTIFICATION

## Hardware Components

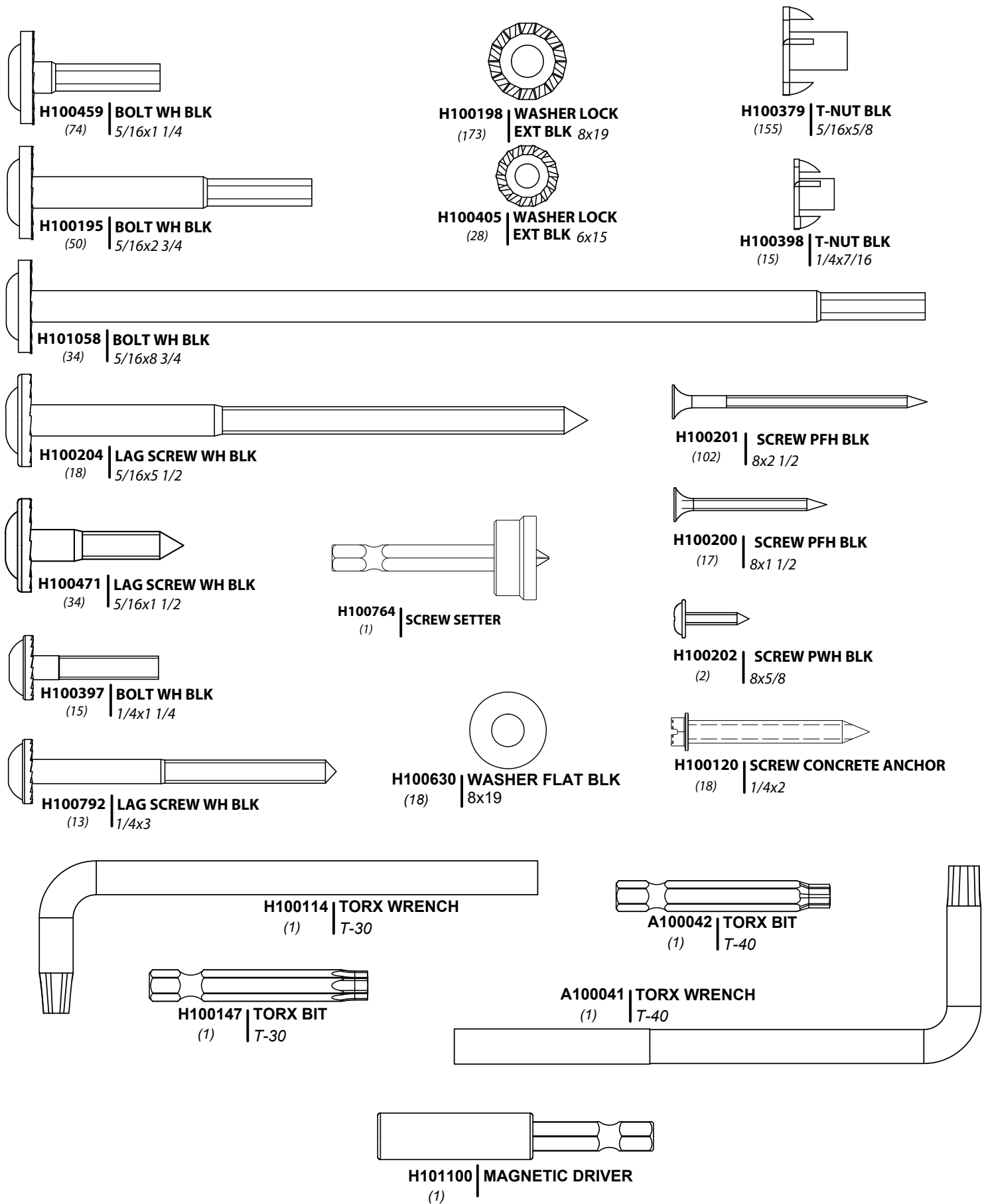

# OWNER'S MANUAL - PARTS IDENTIFICATION

## Accessory Components (Not to Scale)



**A100241**  
(1) **BYD ID TAG  
(SMALL)  
WITHOUT AGES**

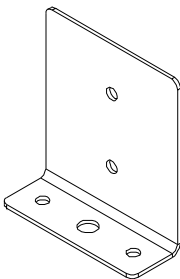

**A4M00977**  
(x8) **POST ANCHORING PLATE**

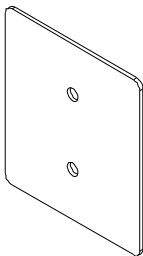

**A4M00978**  
(x8) **POST PLATE**

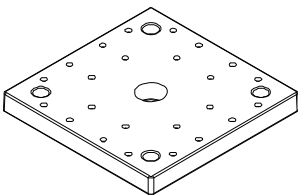

**A6P00308**  
(x4) **6x6 POST FOOT**

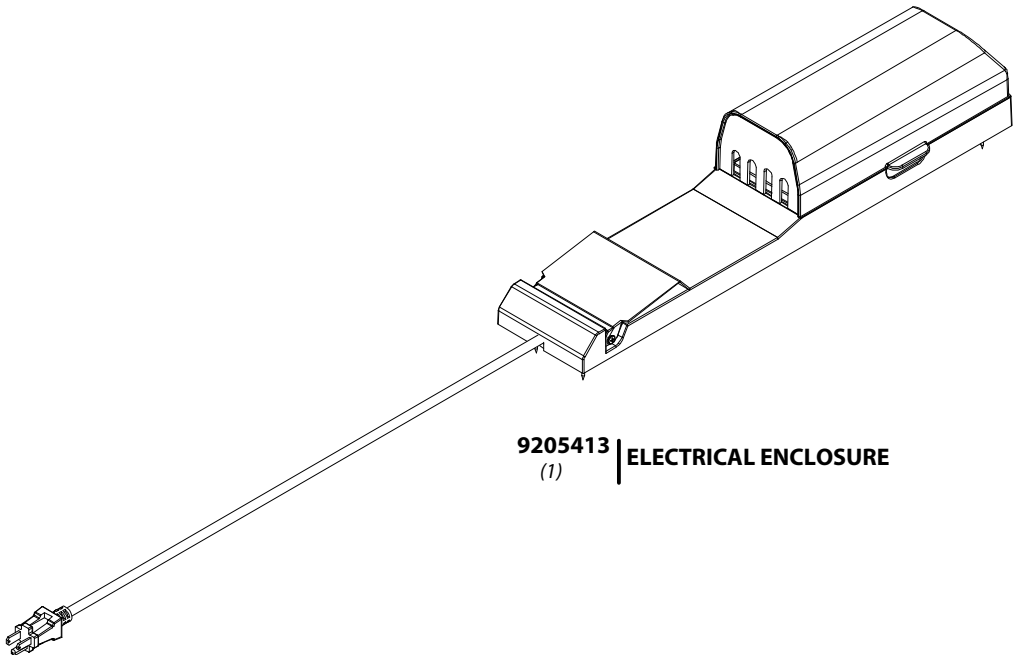

**9205413**  
(1) **ELECTRICAL ENCLOSURE**

# PRE-ASSEMBLY STEP 1 - SORTING PARTS

It is critical for ease of assembly that you take the time to sort and organize the wood and hardware.

---

## WOOD PARTS:

- Organize wood parts by the three-digit, alpha-numeric number stamped on each board (ex. P01).
- If there are multiple boards with the same stamped number, stack those pieces together.
- Stamps can be found on the flat surface of the boards or on the end of the boards.
- Allow yourself plenty of room - the wood pieces can take up a significant amount of space.

**NOTE: CARTONS ARE NOT ORGANIZED BY BOARD NUMBER.**



---

## HARDWARE PARTS:

- We recommend that you have a separate table to organize the hardware.
- Hardware bags are printed with a seven-digit, alpha-numeric part number.
- You can organize your hardware by part number or group by hardware type (i.e. bolts, nuts, etc.).
- During assembly you only need to reference the last four digits of the number.

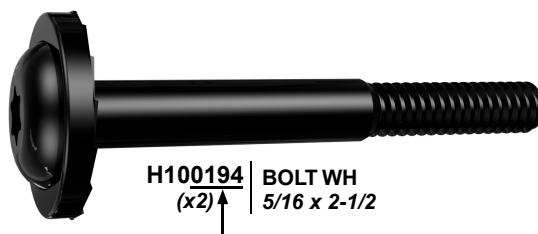

**PRE-ASSEMBLY STEP 2 - TOOLS REQUIRED**



Cordless Drill  
or Electric Drill



Drill  
Attachments:  
Phillips Head



1/8", 3/16", 3/8" &  
7/16" Drill Bits



Phillips Screw Driver



Open End  
Wrenches 1/2" &  
9/16"



3/8" Drive Ratchet, 1/2" &  
7/16" STD Sockets 1/2" & 7/16"  
Deep Sockets



Claw Hammer



Rubber Mallet  
- Optional

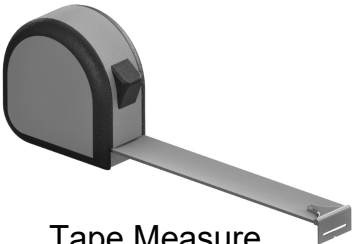

Tape Measure

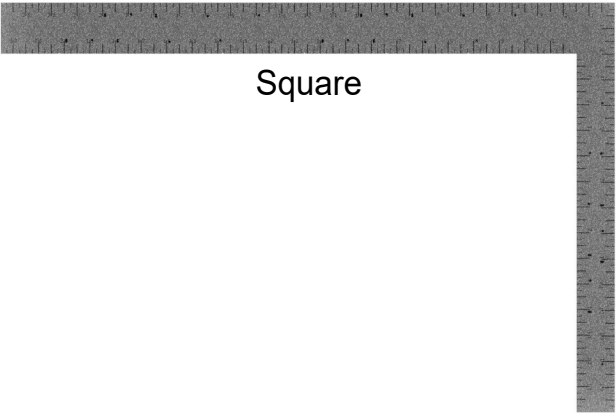

Square





Level 24"

## PRE-ASSEMBLY STEP 3 - CHOOSE YOUR ASSEMBLY METHOD



There are several types of assembly instructions available to you.

1. Printed Assembly Manual included with your set
2. BILT APP - 3D interactive instructions
3. Combination of the Printed Manual and BILT APP (Note: Step numbers can differ between the two methods)



### Scan for easy 3D instructions

Download the BILT app  
before you begin



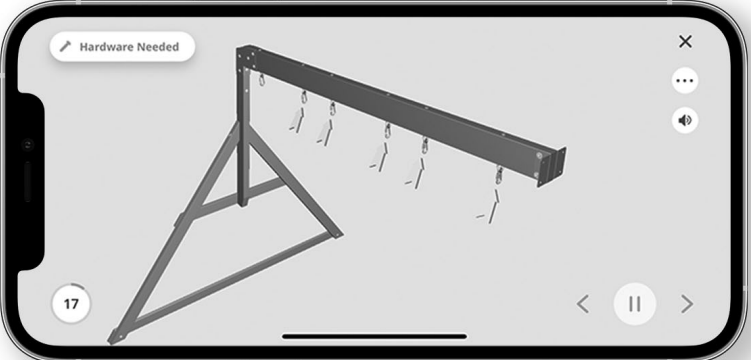

# STEP 4 - PERGOLA ASSEMBLY

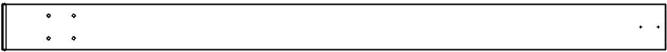

**P01 POST - W2A03241**  
(2) 6"x6"x89 1/2" (152x152x2274)



**P02 POST - W2A03242**  
(2) 6"x6"x89 1/2" (152x152x2274)

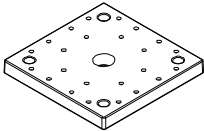

**A6P00308 6x6 POST FOOT**  
(x4)

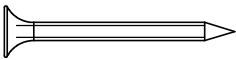

**H100200 SCREW PFH BLK**  
(16) 8x1 1/2

**COMPLETE THIS STEP TWICE.**

FOR EASE OF ASSEMBLY, WE RECOMMEND  
USING SAW HORSES FOR STEPS 4-10.

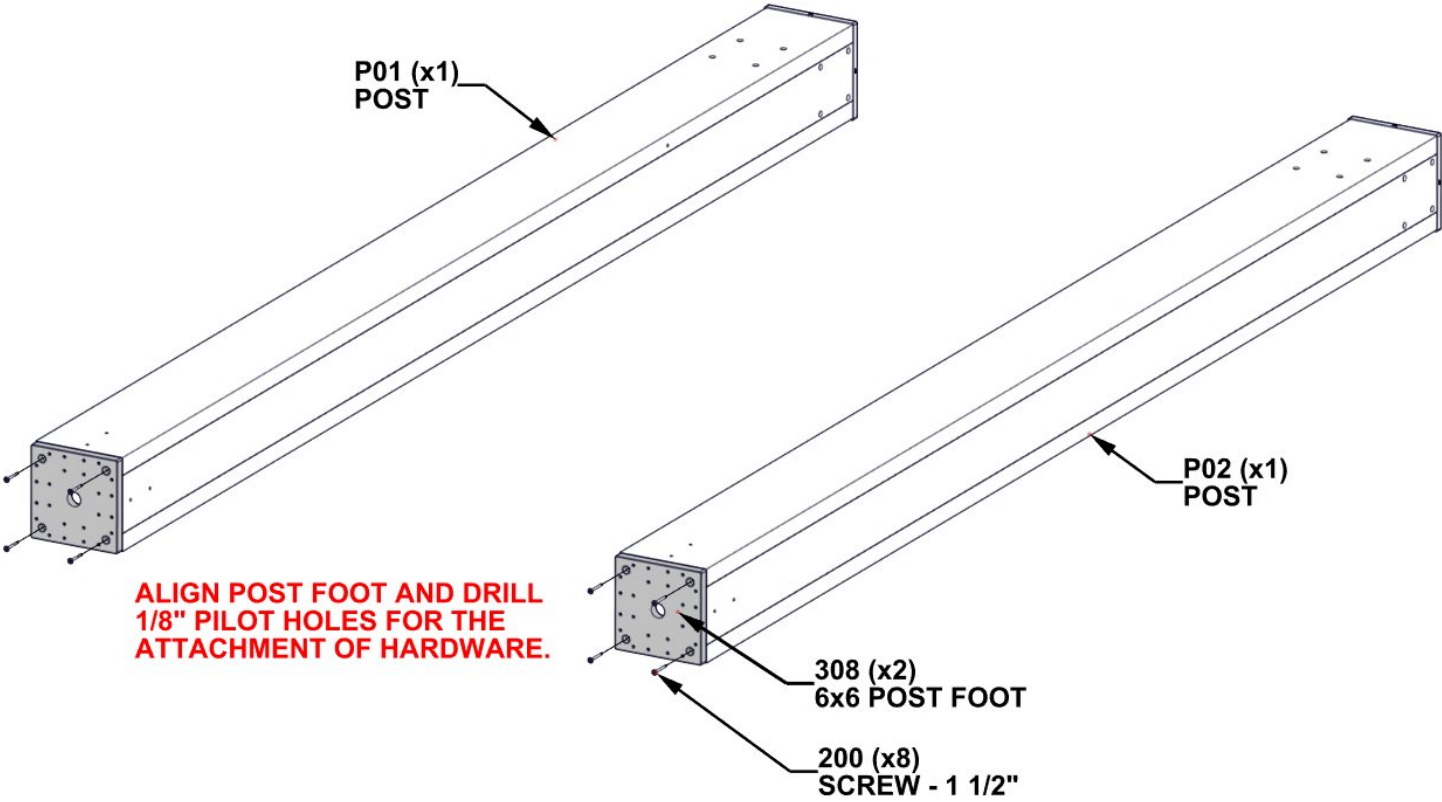

# STEP 5 - PERGOLA ASSEMBLY

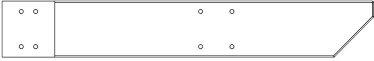

**D01** | **JOIST END - W4L15500**  
(1) | 1 3/8"x5 1/4"x35 1/2" (36x134x902)



**D02** | **JOIST END - W4L15501**  
(1) | 1 3/8"x5 1/4"x35 1/2" (36x134x902)



**D07** | **JOIST - W4L15506**  
(1) | 1 3/8"x5 1/4"x83 1/8" (36x134x2112)

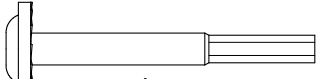

**H100195** | **BOLT WH BLK**  
(8) | 5/16x2 3/4

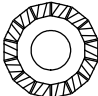

**H100198** | **WASHER LOCK**  
(8) | **EXT BLK** 8x19

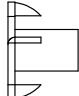

**H100379** | **T-NUT BLK**  
(8) | 5/16x5/8



**D12** | **CORBEL - W4L15513**  
(1) | 1 3/8"x5 1/4"x28 1/4" (36x134x719)



**D13** | **CORBEL - W2A03243**  
(1) | 1 3/8"x5 1/4"x28 1/4" (36x134x719)

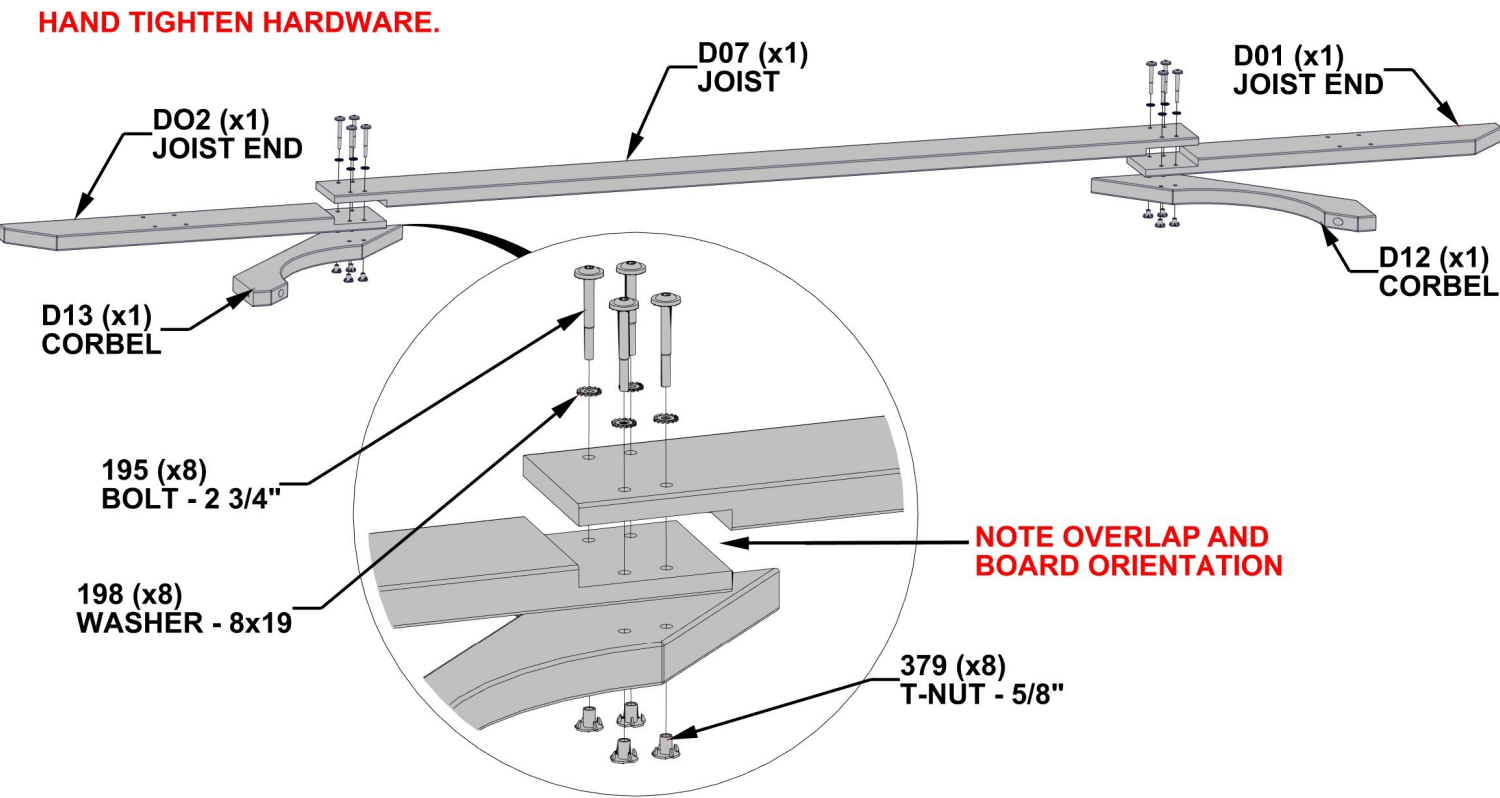



# STEP 6 - PERGOLA ASSEMBLY



**D01** | JOIST END - W4L15500  
(1) | 1 3/8"x5 1/4"x35 1/2" (36x134x902)



**D02** | JOIST END - W4L15501  
(1) | 1 3/8"x5 1/4"x35 1/2" (36x134x902)



**D07** | JOIST - W4L15506  
(1) | 1 3/8"x5 1/4"x83 1/8" (36x134x2112)

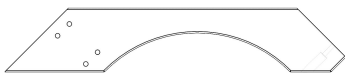

**D12** | CORBEL - W4L15513  
(2) | 1 3/8"x5 1/4"x28 1/4" (36x134x719)

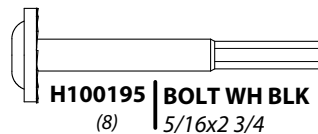

**H100195** | BOLT WH BLK  
(8) | 5/16x2 3/4

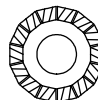

**H100198** | WASHER LOCK  
(8) | EXT BLK 8x19

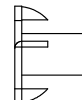

**H100379** | T-NUT BLK  
(8) | 5/16x5/8

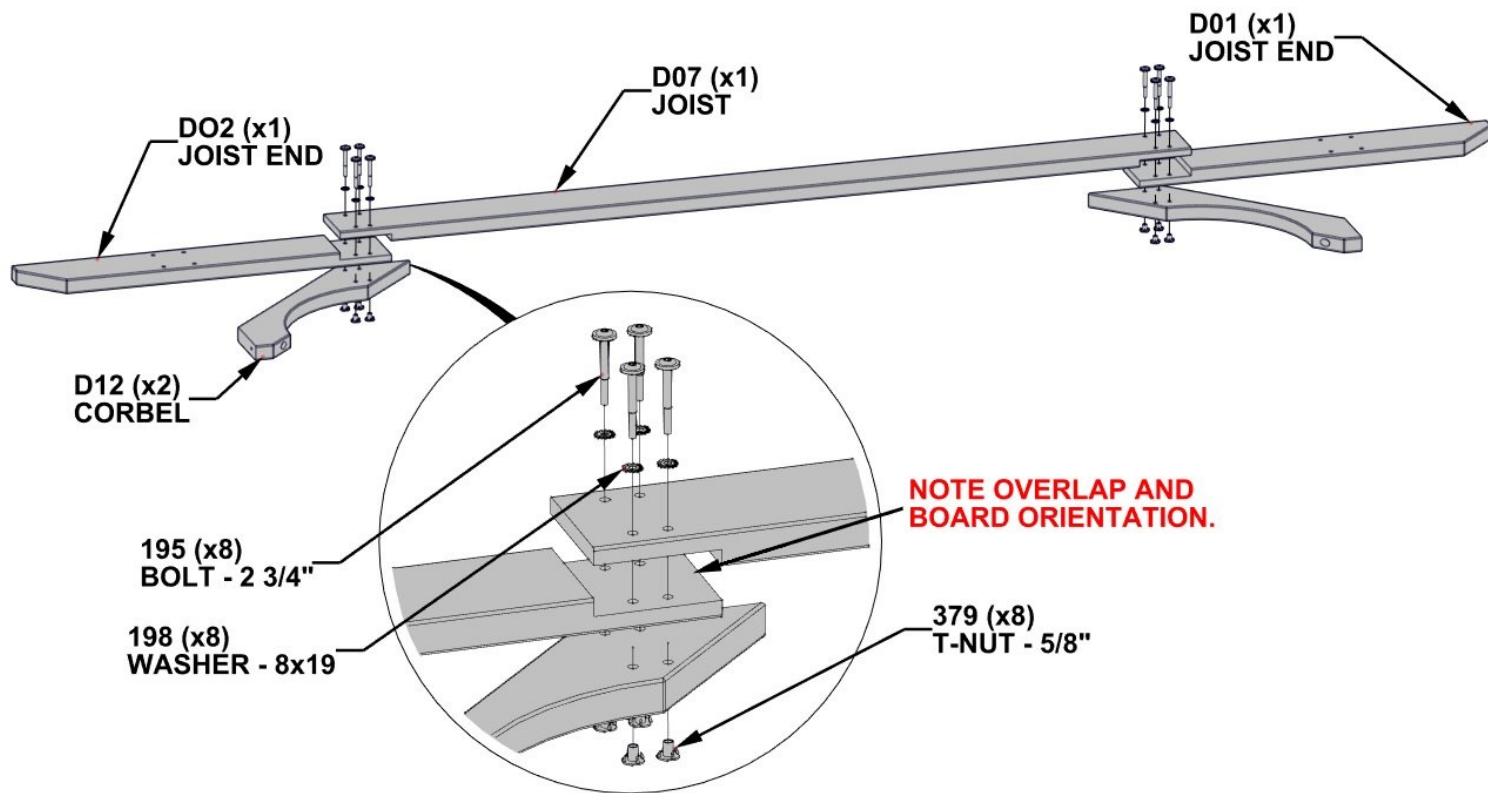

# STEP 7 - PERGOLA ASSEMBLY



**D01 | JOIST END - W4L15500**  
(2) | 1 3/8"x5 1/4"x35 1/2" (36x134x902)



**D02 | JOIST END - W4L15501**  
(2) | 1 3/8"x5 1/4"x35 1/2" (36x134x902)

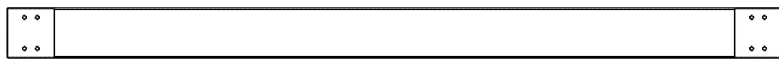

**D07 | JOIST - W4L15506**  
(2) | 1 3/8"x5 1/4"x83 1/8" (36x134x2112)

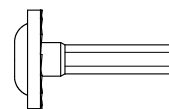

**H100459 | BOLT WH BLK**  
(16) | 5/16x1 1/4

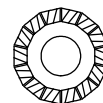

**H100198 | WASHER LOCK  
EXT BLK 8x19**  
(16)

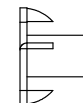

**H100379 | T-NUT BLK**  
(16) | 5/16x5/8

**COMPLETE THIS STEP TWICE.**

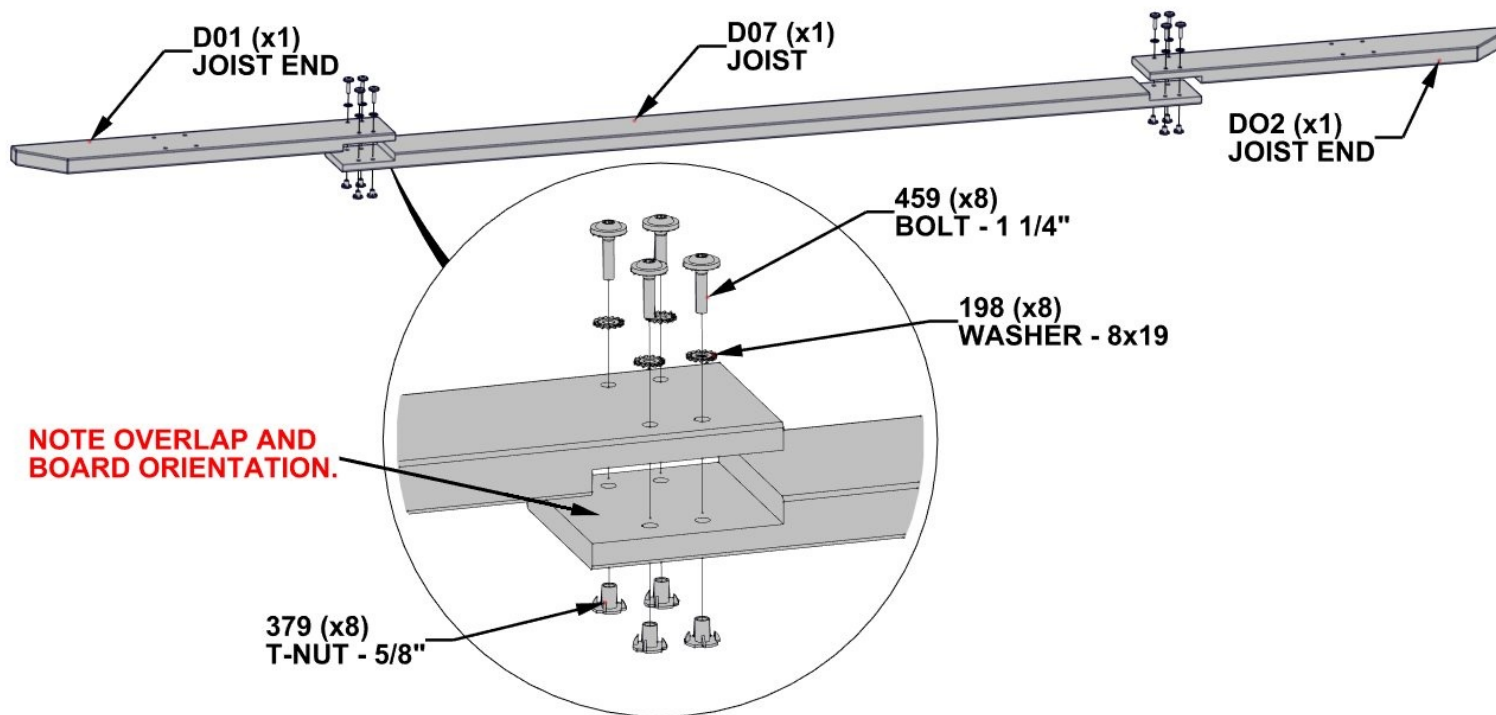

# STEP 8 - PERGOLA ASSEMBLY

**P01 | POST - W2A03241**

(2) 6"x6"x89 1/2" (152x152x2274)

**P02 | POST - W2A03242**

(2) 6"x6"x89 1/2" (152x152x2274)

(2) **OUTER JOIST ASSEMBLY - FROM PREVIOUS STEPS**

(2) **INNER JOIST ASSEMBLY - FROM PREVIOUS STEPS**

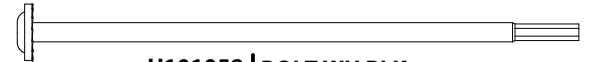

**H101058 | BOLT WH BLK**

(16) 5/16x8 3/4

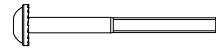

**H100792 | LAG SCREW WH BLK**

(4) 1/4x3



**H100405 | WASHER LOCK**

(4) EXT BLK 6x15



**H100198 | WASHER LOCK**

(16) EXT BLK 8x19



**H100379 | T-NUT BLK**

(16) 5/16x5/8

**COMPLETE THIS STEP TWICE.**

**ASSEMBLE AS SHOWN USING THE PRE-DRILLED PILOT HOLES IN POSTS.**

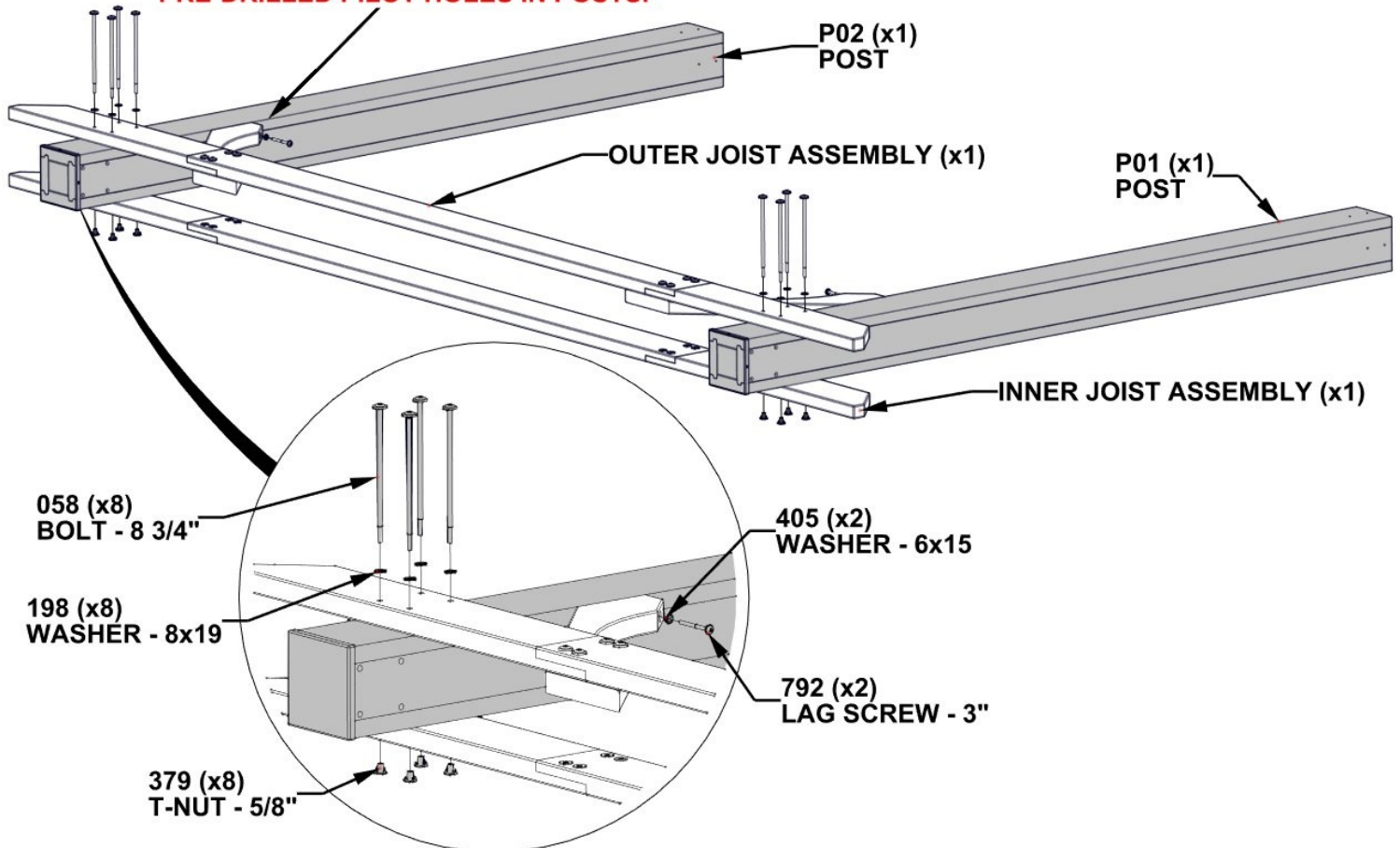

# STEP 9 - PERGOLA ASSEMBLY



**D09 | JOIST - W4L15519**  
(2) | 1 3/8"x5 1/4"x74 1/2" (36x134x1893)



**D10 | JOIST - W4L15520**  
(2) | 1 3/8"x5 1/4"x74 1/2" (36x134x1893)



**D11 | CORBEL - W4L15510**  
(4) | 1 3/8"x5 1/4"x32 1/2" (36x134x826)

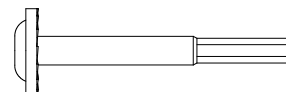

**H100195 | BOLT WH BLK**  
(16) | 5/16x2 3/4

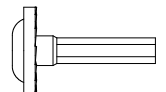

**H100459 | BOLT WH BLK**  
(8) | 5/16x1 1/4



**H100198 | WASHER LOCK**  
(24) | EXT BLK 8x19



**H100379 | T-NUT BLK**  
(24) | 5/16x5/8

**COMPLETE THIS STEP TWICE.**

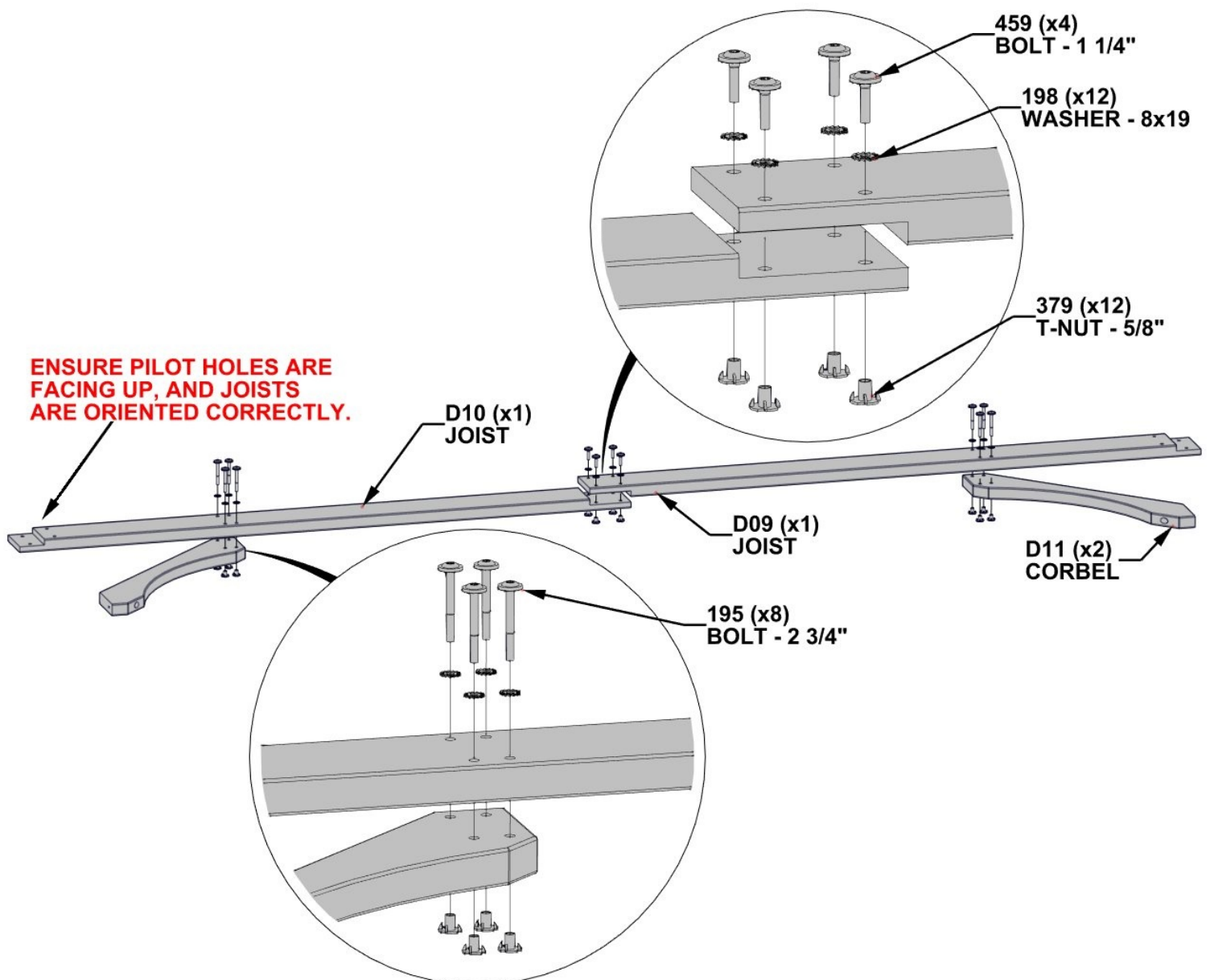

# STEP 10 - PERGOLA ASSEMBLY

**D05** | JOIST END - W4L15504  
(2) | 1 3/8"x5 1/4"x56 1/4" (36x134x1431)

**D06** | JOIST END - W4L15505  
(2) | 1 3/8"x5 1/4"x56 1/4" (36x134x1431)

**D08** | JOIST - W4L15518  
(2) | 1 3/8"x5 1/4"x65 3/4" (36x134x1664)

**D11** | CORBEL - W4L15510  
(4) | 1 3/8"x5 1/4"x32 1/2" (36x134x826)

**H100195** | BOLT WH BLK  
(16) | 5/16x2 3/4

**H100459** | BOLT WH BLK  
(16) | 5/16x1 1/4

**H100198** | WASHER LOCK  
(32) | EXT BLK 8x19

**H100379** | T-NUT BLK  
(32) | 5/16x5/8

**COMPLETE THIS STEP TWICE.**

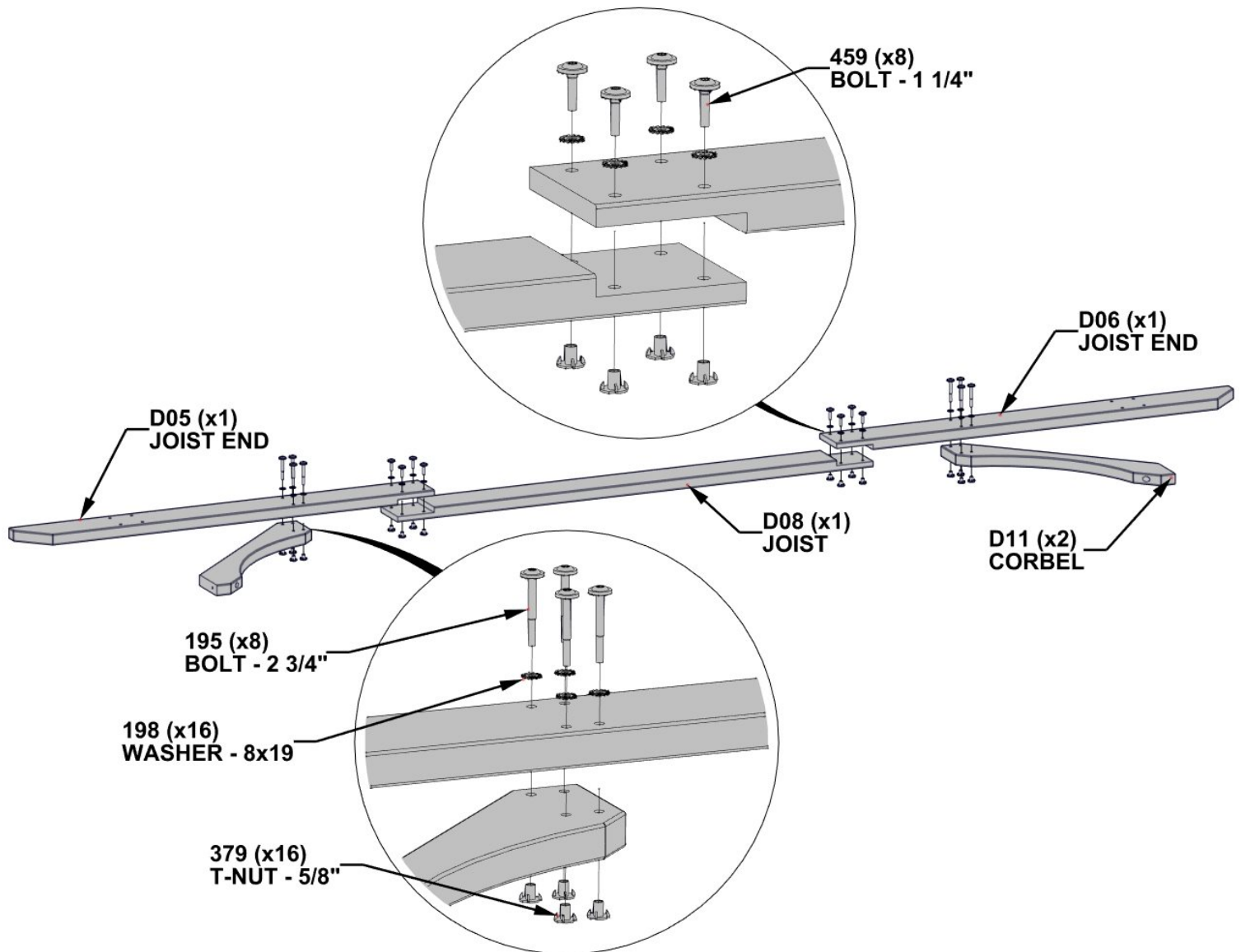



# STEP 11 - PERGOLA ASSEMBLY

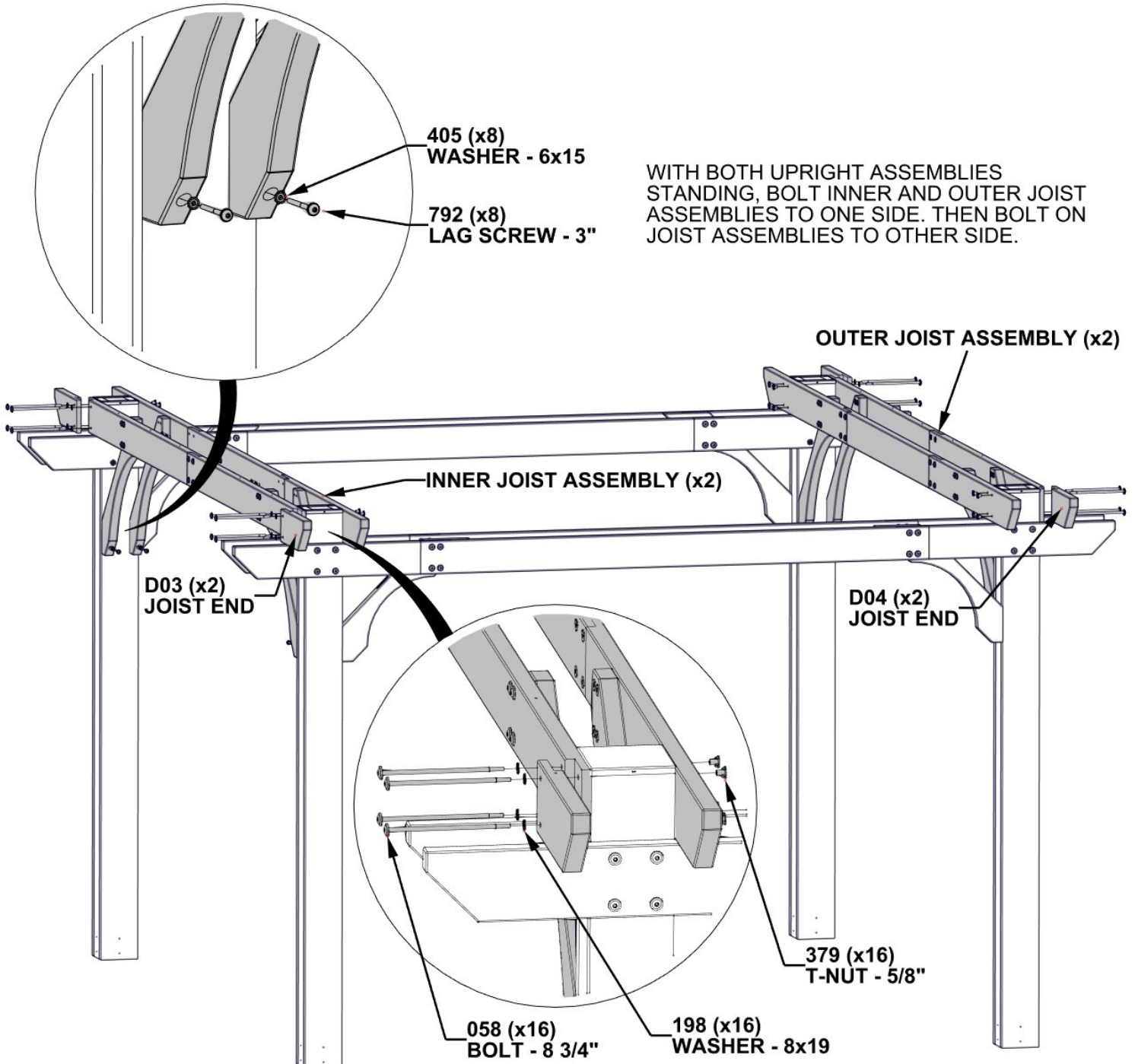
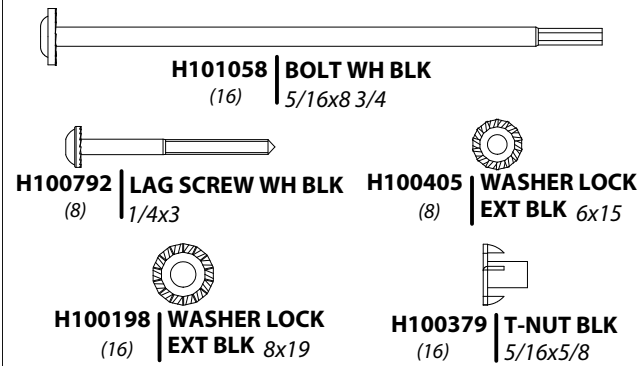
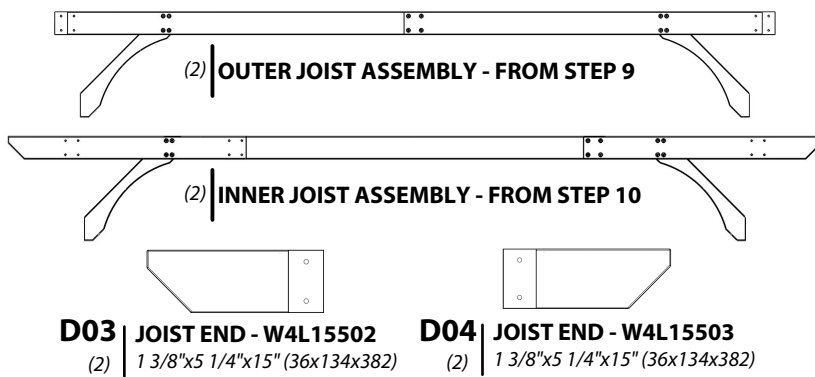

SQUARE UP ALL POSTS TO JOISTS AND FULLY TIGHTEN ALL BOLTS AND SCREWS.

NOTE: A THIRD PERSON IS HELPFUL FOR THIS STEP.

# STEP 12 - PERGOLA ASSEMBLY



**D14 | SLOTTED JOIST - W4L15515**  
(8) 1 3/8"x5 1/4"x55 3/4" (36x134x1416)

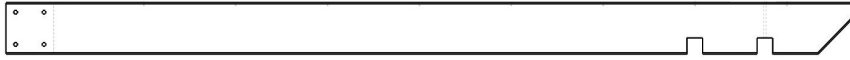

**D15 | SLOTTED JOIST - W4L15517**  
(8) 1 3/8"x5 1/4"x89 1/2" (36x134x2274)

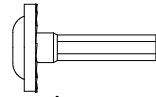

**H100459 | BOLT WH BLK**  
(32) 5/16x1 1/4



**H100198 | WASHER LOCK  
EXT BLK 8x19**  
(32)



**H100379 | T-NUT BLK**  
(32) 5/16x5/8

**COMPLETE THIS STEP EIGHT TIMES.**

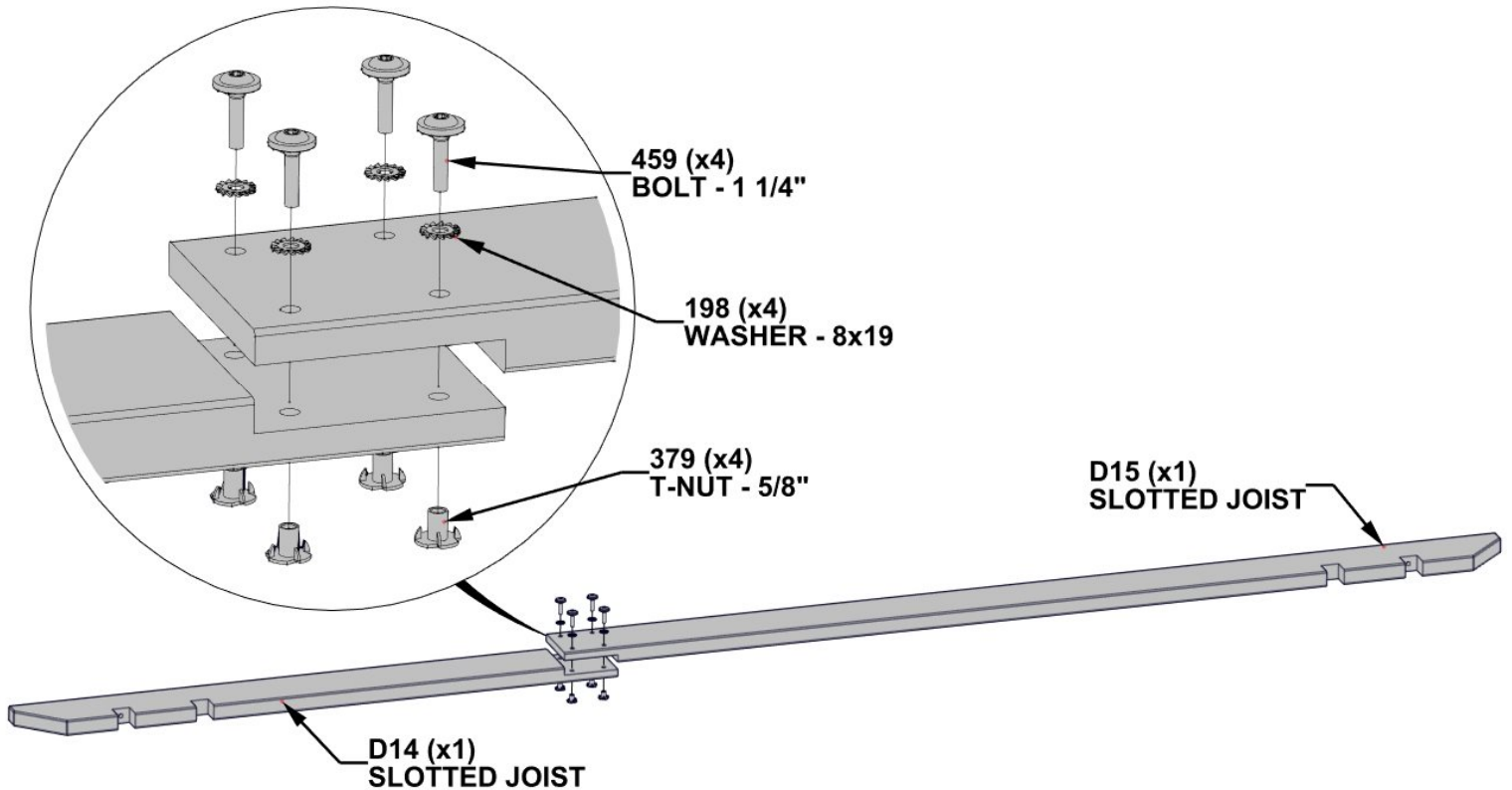

## STEP 13 - PERGOLA ASSEMBLY

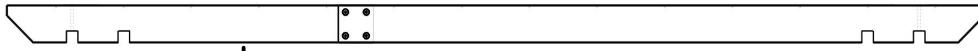

(8) SLOTTED JOIST ASSEMBLY - FROM PREVIOUS STEPS



H100204 | LAG SCREW WH BLK  
(16) 5/16x5 1/2



H100198 | WASHER LOCK  
(16) EXT BLK 8x19

**ATTACH SLOTTED JOIST ASSEMBLIES USING  
PILOT HOLES IN OUTER JOIST ASSEMBLY.**

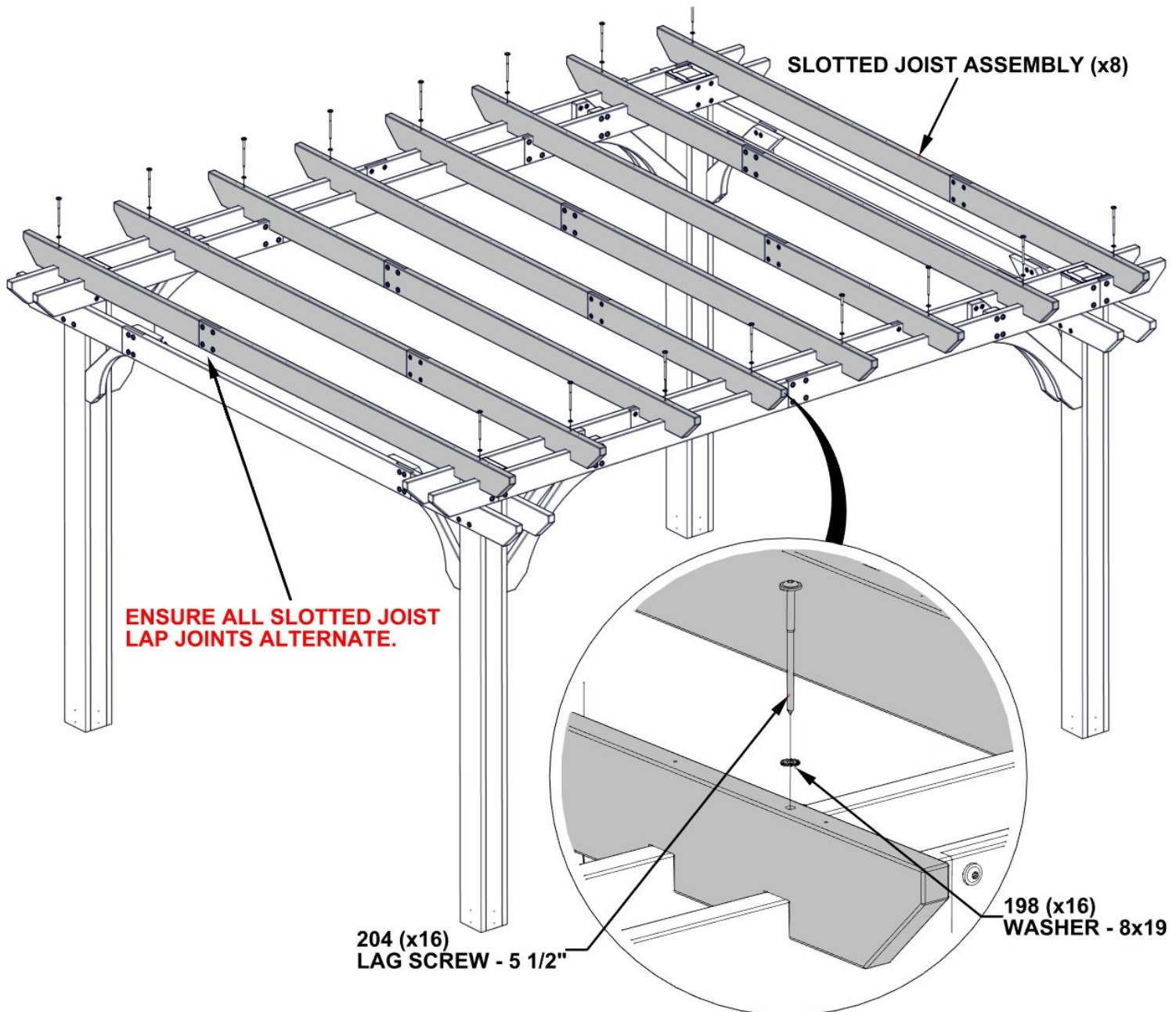



# STEP 14 - PERGOLA ASSEMBLY

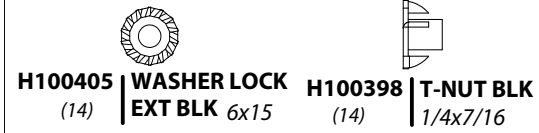
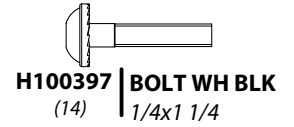
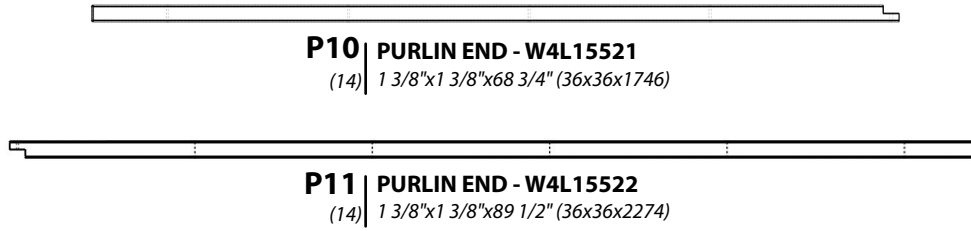

**COMPLETE THIS STEP FOURTEEN TIMES.**

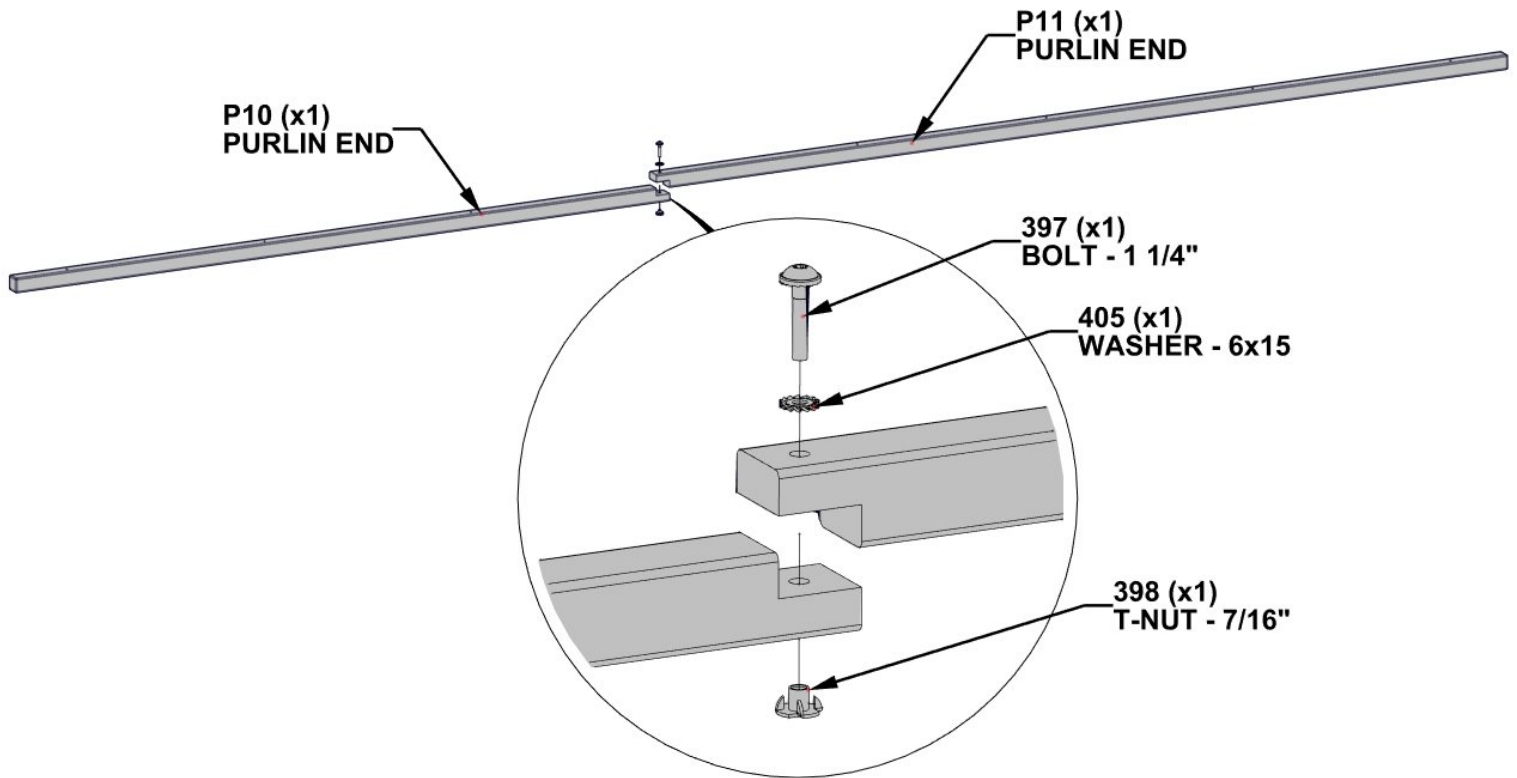

# STEP 15 - PERGOLA ASSEMBLY

(14) PURLIN ASSEMBLY - FROM PREVIOUS STEPS

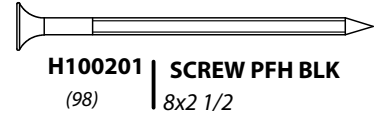

**WHEN LIFTING UP EACH PURLIN ASSEMBLY ENSURE THAT JOINTS ARE SUPPORTED AND PURLIN IS KEPT LEVEL.**

PURLIN ASSEMBLY (x14)

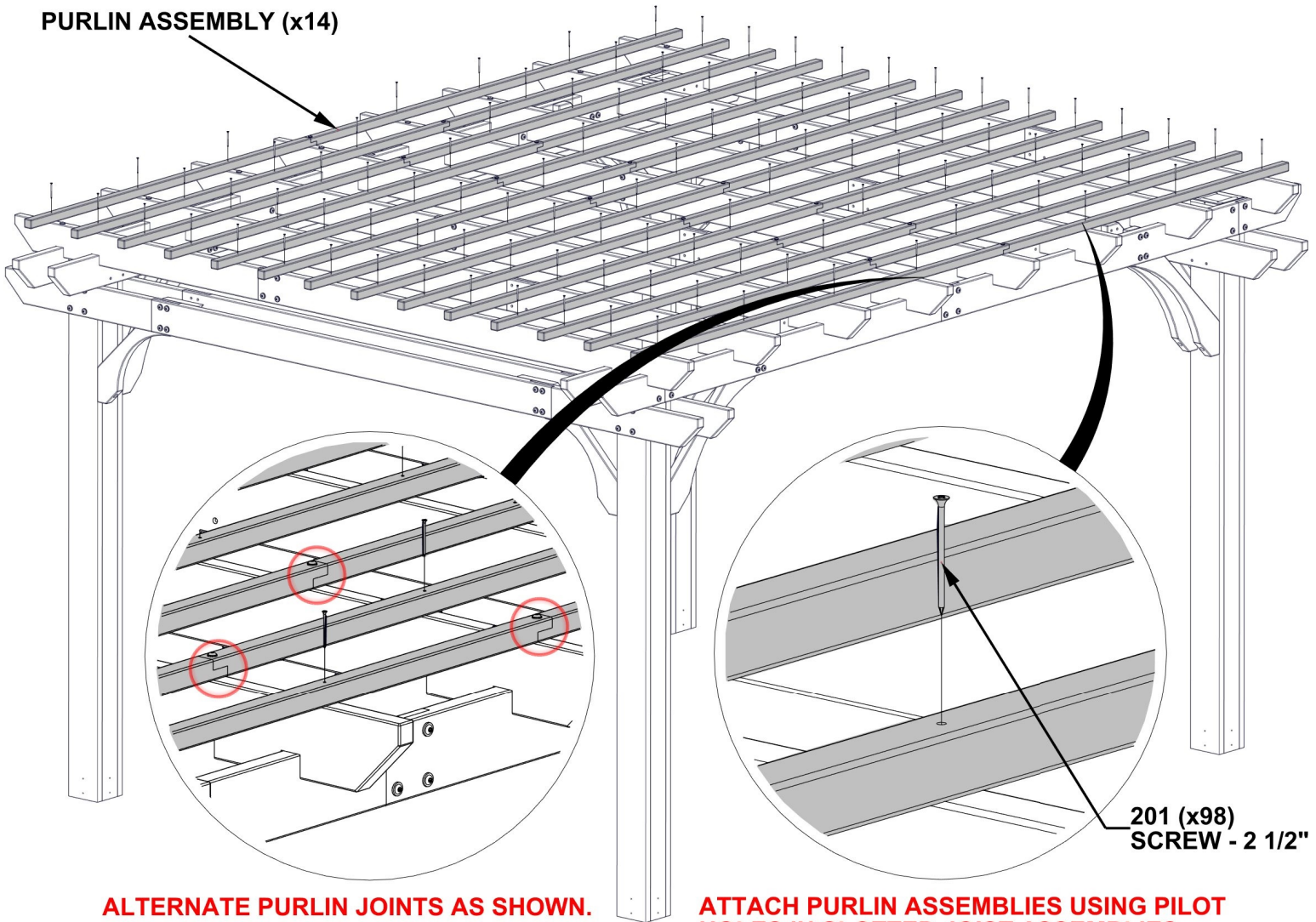

## STEP 16 - PERGOLA ASSEMBLY

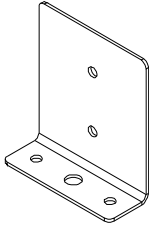

**A4M00977**  
(x8) | **POST ANCHORING PLATE**

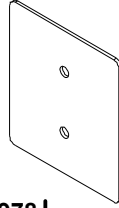

**A4M00978**  
(x8) | **POST PLATE**

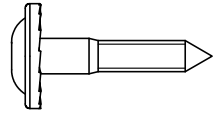

**H100471**  
(32) | **LAG SCREW WH BLK**  
5/16x1 1/2

**REPEAT THIS STEP FOR EACH POST.**

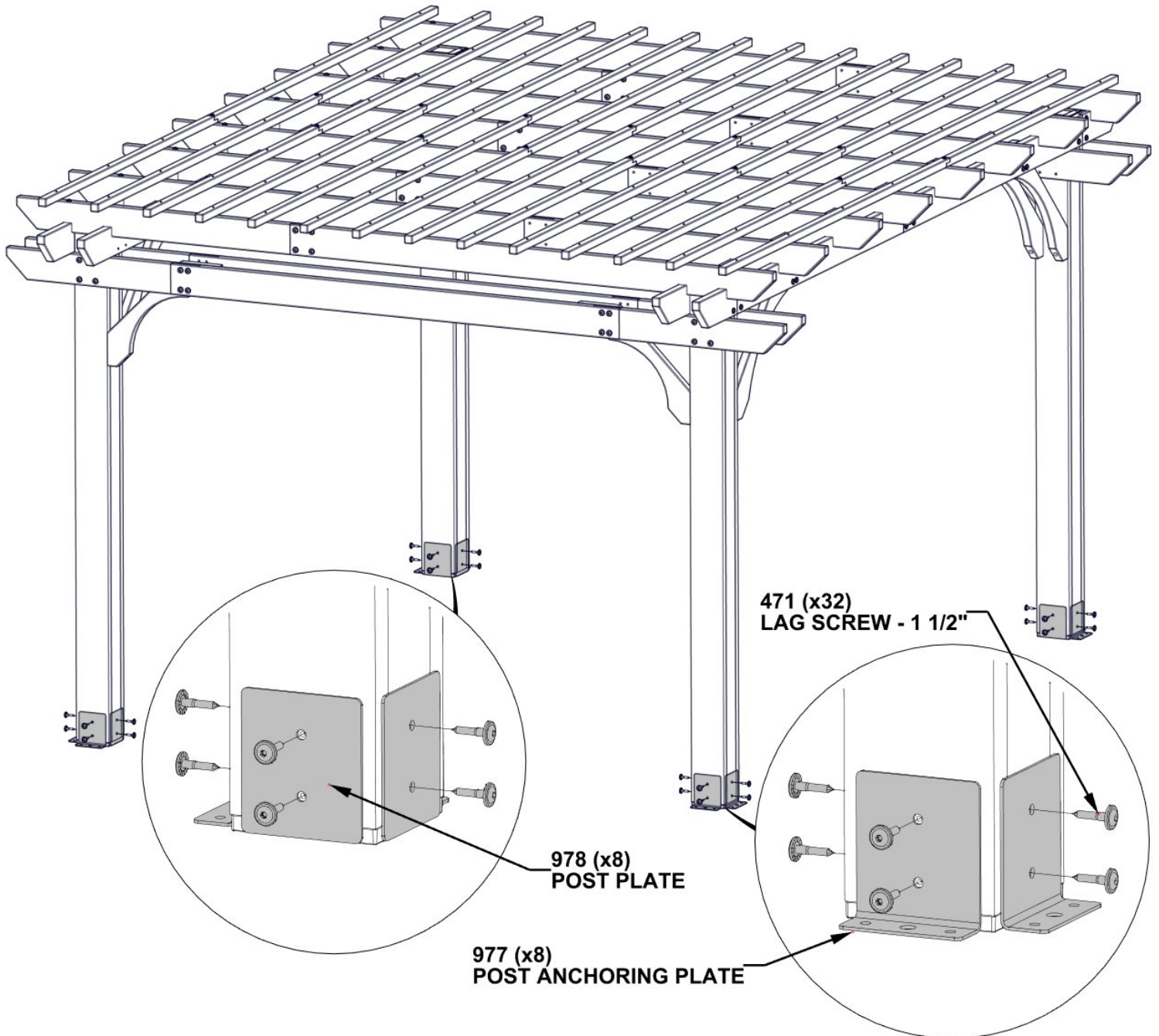

# STEP 17 - PERGOLA ASSEMBLY



**A100241** | **BYD ID TAG**  
(1) | **(SMALL)**  
**WITHOUT AGES**



**H100202** | **SCREW PWH BLK**  
(2) | **8x5/8**

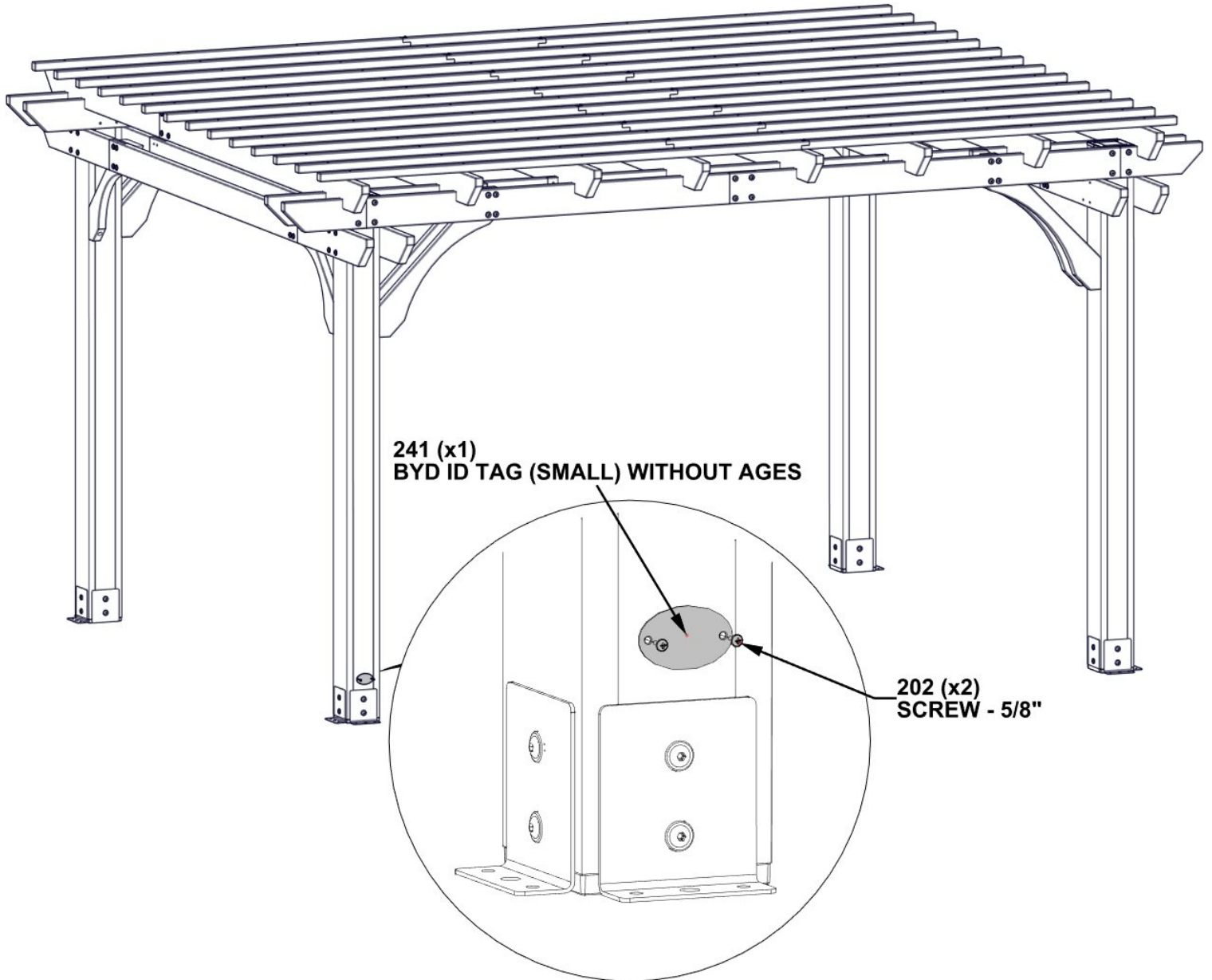



## STEP 18 - PERGOLA ASSEMBLY



H100120 | SCREW CONCRETE ANCHOR  
(16) | 1/4x2

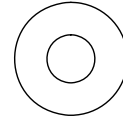

H100630 | WASHER FLAT BLK  
(16) | 8x19

**REPEAT THIS STEP FOR EACH POST FOOT.**

**MANUFACTURER RECOMMENDS INSTALLATION ON CONCRETE SURFACE OR CONCRETE POST PAD AS SHOWN BELOW.**

**FOR INSTALLATION ON WOOD DECKS, YOU MUST ENSURE THERE IS AMPLE STRUCTURAL SUPPORT UNDER THE DECK. HARDWARE NOT INCLUDED FOR DECK ATTACHMENT.**

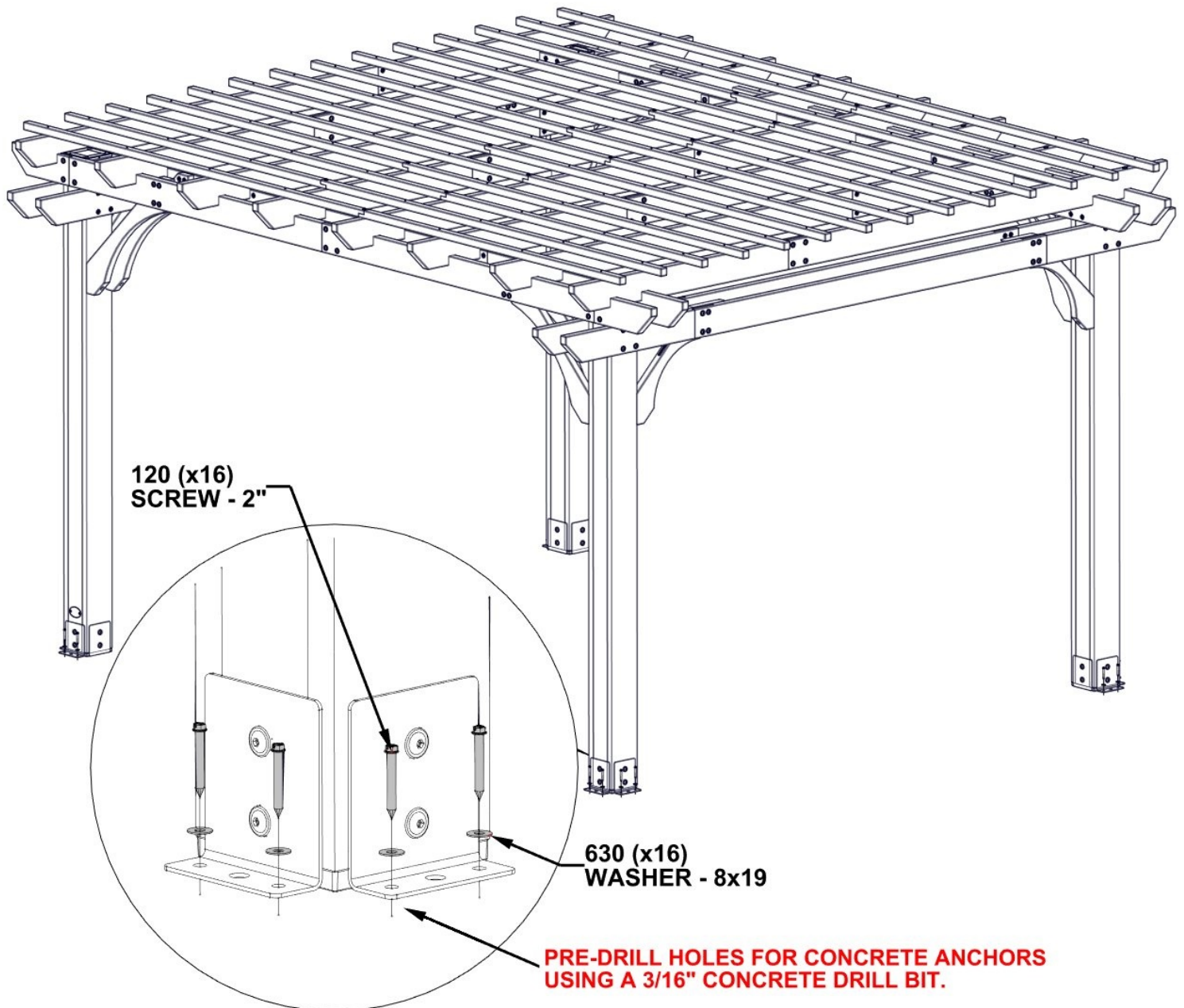

# ELECTRICAL ENCLOSURE

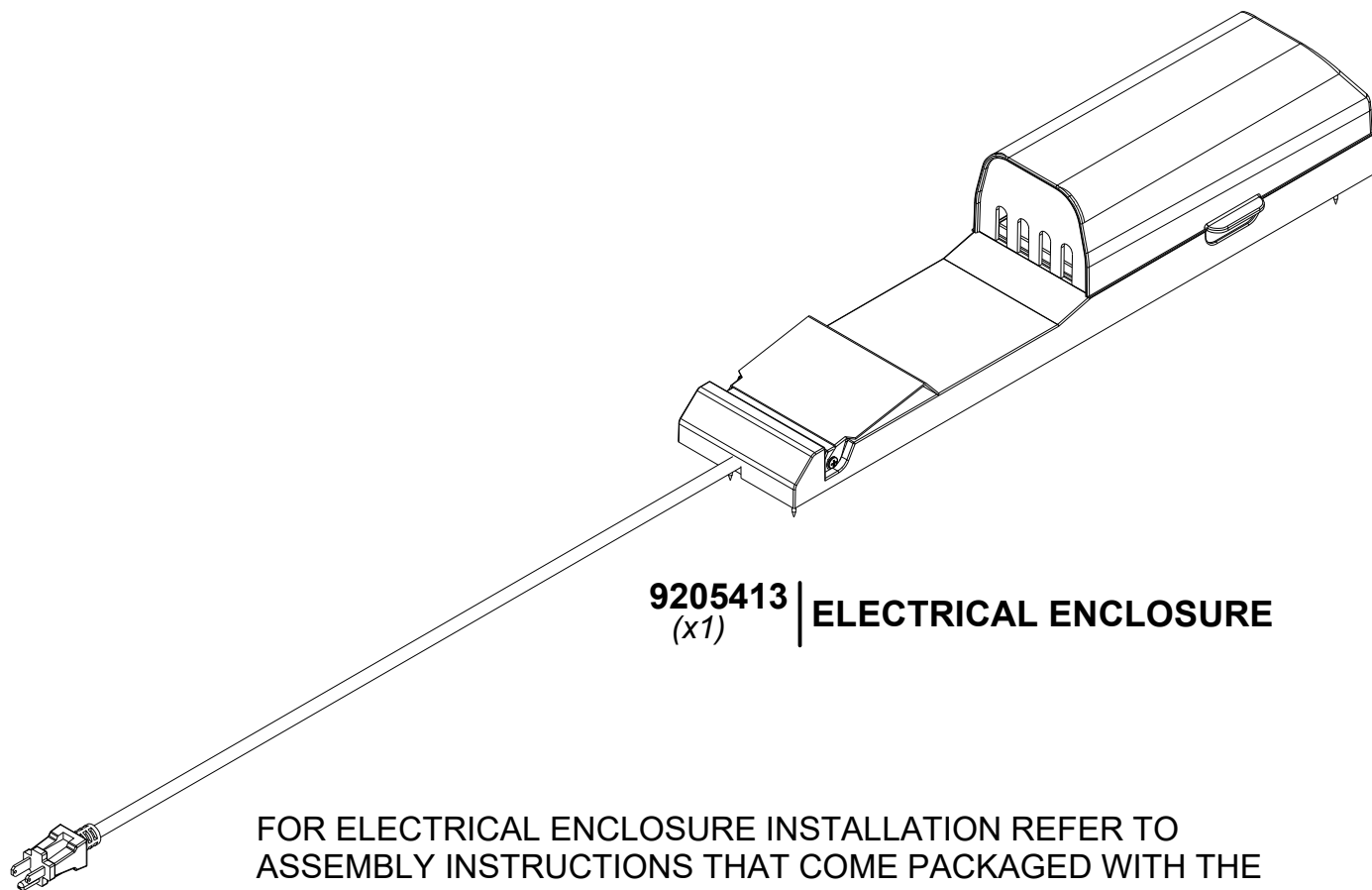

**9205413** | **ELECTRICAL ENCLOSURE**  
(x1)

FOR ELECTRICAL ENCLOSURE INSTALLATION REFER TO ASSEMBLY INSTRUCTIONS THAT COME PACKAGED WITH THE ELECTRICAL ENCLOSURE KIT. INSTALL ON ANY POST THAT IS DESIRED. FOLLOW DIRECTIONS FOR PROPER INSTALLATION.