

INSTALLATION INSTRUCTION

① X1

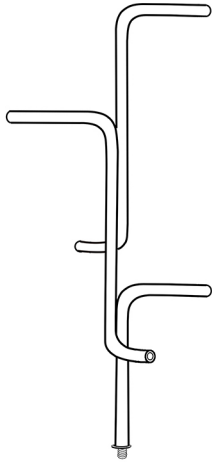

STEP 1

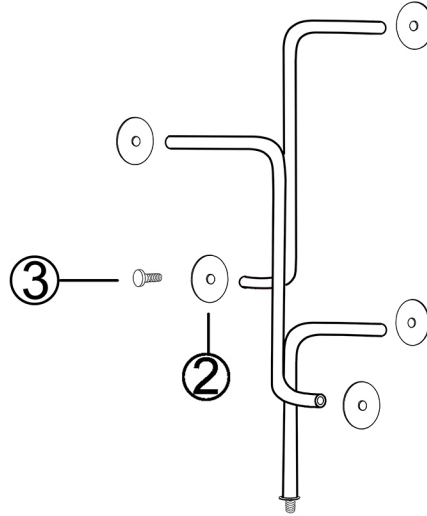

Remove the protective film from both sides of acrylic disc before installation

② X5



③ X5



M8-1

Tighten the M8 chrome-plating stainless steel screws by hand

④ X1



⑤ X1

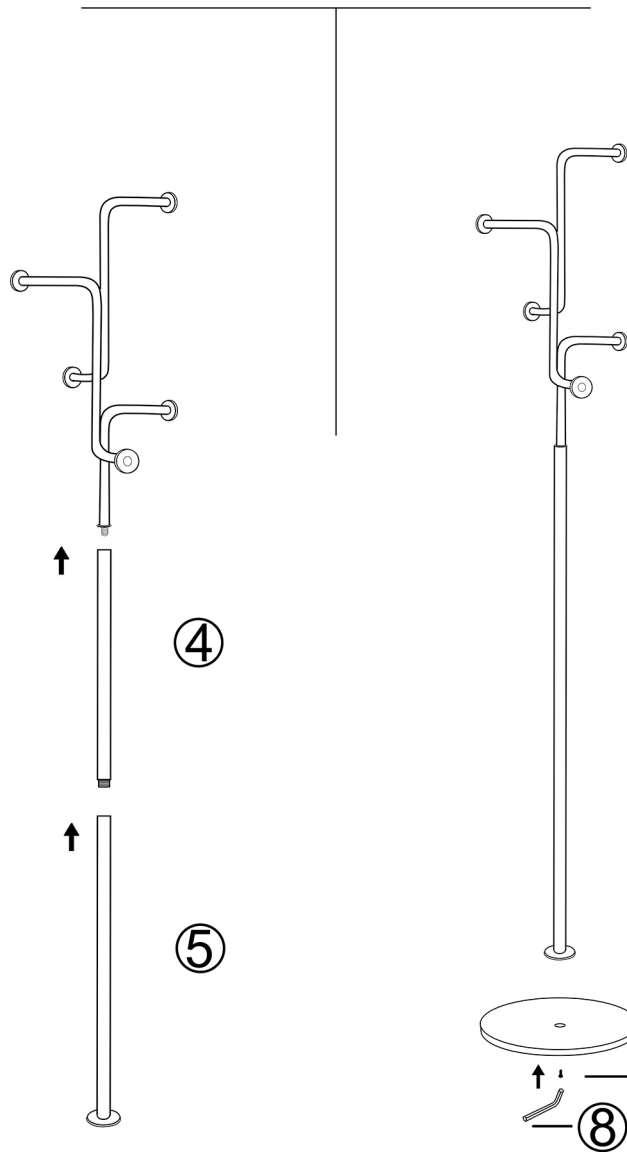
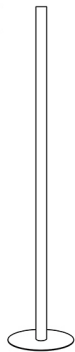

⑥ X1

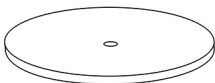

⑦ X1



M8-2

(Note: Bolt 7 preinstalled on Part 5)

⑧ X1



STEP 2

STEP 3