



For The ON-THE-GO Pet™

# INSTRUCTION MANUAL NO-ZIP EXPEDITION PET STROLLER

PG8850NZ



Interior Dimensions:  
35"L x 23"W x 24"H

To see our full line of products, visit us online at: [www.petgearinc.com](http://www.petgearinc.com)

## CUSTOMER SERVICE HELP DESK

[customerservice@petgearinc.com](mailto:customerservice@petgearinc.com)

Toll-Free 877-752-9123 - Eastern Standard Time 8am-3pm, Monday through Friday

# PARTS LIST

Check that you have all the parts shown BEFORE assembling your product.  
If any parts are missing, call Customer Service.



**Stroller**



**2-Front Wheels**



**Removable Internal Liner**



**2-Back Wheels**

# BACK WHEEL ASSEMBLY

Step 1. Hold down lock release button shown in Figure A and slide back wheel into axle shown in Figure B.

When the wheel meets the stroller, let go of the lock release.

Step 2. Pull on wheel to make sure the wheel is engaged.

Repeat on other side.

When finished it should look like Figure C.

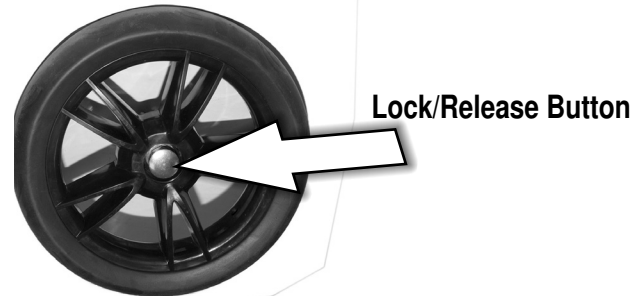

To Remove Back Wheels :  
Hold down the lock/release  
button (Figure A) and pull  
wheel off.

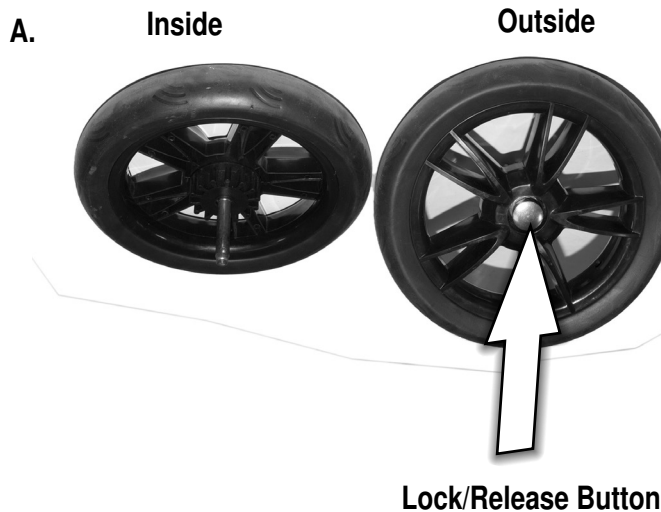

## FRONT WHEEL ASSEMBLY

Step 1. To attach front wheel, hold down on the wheel release button as shown in Figure D.

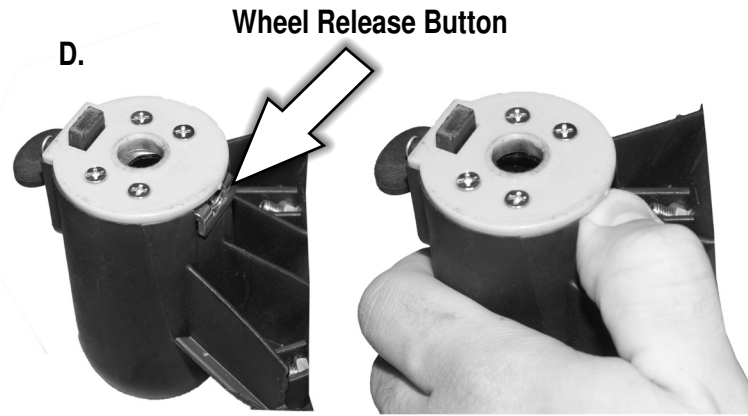

Step 2. While holding down the wheel release button, insert the metal post on the wheel and push down until the wheel meets the stroller (Figure E.) Let go of the wheel release. Pull up slightly on wheel to be sure it's locked in place. Repeat for other front wheel.



Stroller with wheels assembled.



To Remove Front Wheels :  
Hold down wheel release button and pull wheel out.

## STROLLER ASSEMBLY

When all wheels are on stroller, carefully place the stroller on all 4 wheels and begin to pull up on handle to unfold the stroller shown in Figure F.

F.



# STROLLER ASSEMBLY

As you unfold the stroller, straighten the side latches until they lock in place shown in Figures G and H. You will hear a click when the slide latches are engaged.

G.



H.



To adjust handlebar, push in buttons located on each side of the handlebar and adjust to comfort shown in Figure I.

I.



# STROLLER ASSEMBLY

To open the front canopy on your stroller, simply push the release button located on the front of your stroller and lift the canopy shown in Figures J and K. To close the front of your stroller, clip the canopy back into the front of the stroller.

J.



K.



To open the back of your stroller, simply push the release button located on the back of your stroller and open the rear door shown in Figures L and M. To close the back of your stroller, clip the rear door into the back of the stroller.

L.

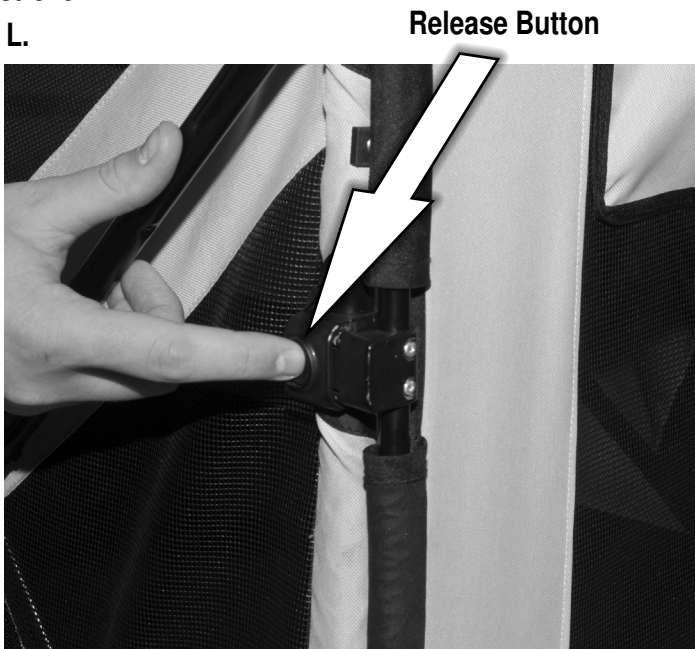

M.



## FRONT WHEEL LOCKING INSTRUCTIONS

Step 1. To use stroller in locked position for jogging, push wheel lock down shown in Figure N.

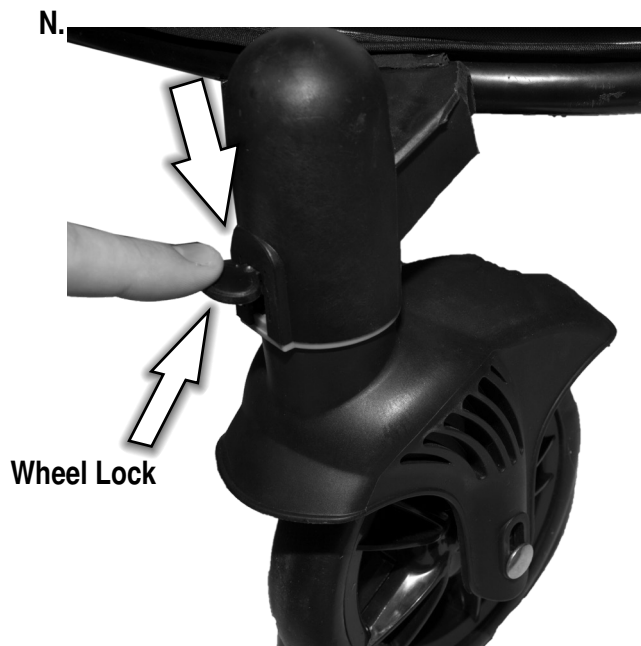

Step 2. To use stroller in swivel position, push wheel lock up, shown in Figure O.



## TO ASSEMBLE BACK TRAY

Step 1. To assemble the back tray, align the holes on the front of the tray with both of the knobs on the stroller, and secure into place by pushing forward, then down.



## TO FOLD/PACK UP STROLLER

Step 1. Fold down handlebar by pushing in the buttons located on each end of the handlebar shown in Figure P.

P.



Step 2. Pull up on the hooked part of the side latch (Figure Q.) until latch disengages.

Q.



## TO FOLD/PACK UP STROLLER

Step 3. Fold sides inward and push forward shown in Figure R.

R.

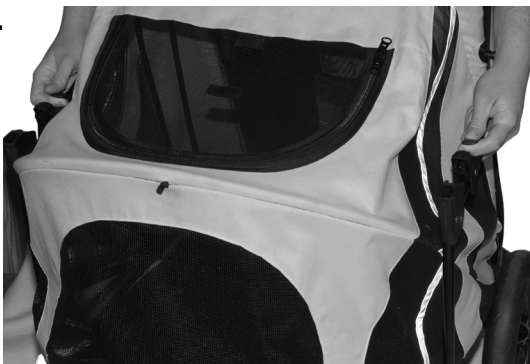

## LOOKING AFTER YOUR STROLLER

- Always store product in a clean, dry place.
- Not recommended for use on the beach.
- Do not put heavy items on top of the stroller.
- Clean frame by wiping with a lightly oiled cloth.
- Do not use detergent or abrasives. Spot clean fabric with dry cleaning fluid or mild soap and warm water.
- To ensure easy maneuverability and to minimize wear and tear, (especially wheels, axles, and swivels), keep all moving parts clean and lubricated with WD40® or light machine oil.
- NOTE: Do not lubricate brake components or swivel locks.
- Regularly check stroller for loose parts. These should be tightened or replaced.

## WHEEL MAINTENANCE

- To clean and lubricate front and rear wheels, push out locking lever under wheel housing to release rear wheel.
- To ensure ease of maneuverability and to minimize wear and tear, keep all moving parts clean and lubricated with WD40® or light machine oil.
- Push wheel sets back on until they click and lock in position; pull on wheel housings to ensure they are secure.
- Push stroller back and forth and rotate swivels around to work in lubricant.
- Clean the rear wheel assembly and the rest of the frame with warm, soapy water; clean off with warm water and dry thoroughly.
- NOTE: Do not lubricate brake components or swivel locks.

## **⚠ WARNING!**

### **FOR PETS ONLY.**

Not intended to be used as a restraining device for aggressive or dangerous animals that dig, chew or paw aggressively. Do not leave your pet unattended. **PET GEAR** is not liable for any damage caused by aggressive, destructive, immature or untrained animals. Do not use near an open or exposed flame. Failure to follow these warnings and the instructions could result in serious injury or death.

- Do not carry additional bags, goods, or accessories in or on stroller except as recommended in the manufacturer's instructions.
- Recommended use of an approved safety restraint correctly fitted and adjusted.
- Do not leave pet unsupervised in stroller.
- Before making adjustments to stroller ensure that pet's body is clear of any moving parts.
- Do not hang bags from handles as this may cause the product to become unstable.
- Do not use on escalator or stairs; fold stroller and carry.
- Put on brake whenever you park the stroller.
- Ensure stroller is completely erected and check that all locks are engaged before placing pet in stroller.
- Do not overload as stroller may become unstable; maximum weight of pet using this stroller not to exceed 150 lbs.

## **REPLACEMENT PARTS**

Use only **PET GEAR** replacement parts.

Please have your model number ready before calling.

You can also request parts: <http://www.petgearinc.com/main.asp?sel=2>



192 Sheldon Avenue • West Rutland, VT 05777 • 877-752-9123 • [www.petgearinc.com](http://www.petgearinc.com)