

ASSEMBLY INSTRUCTIONS

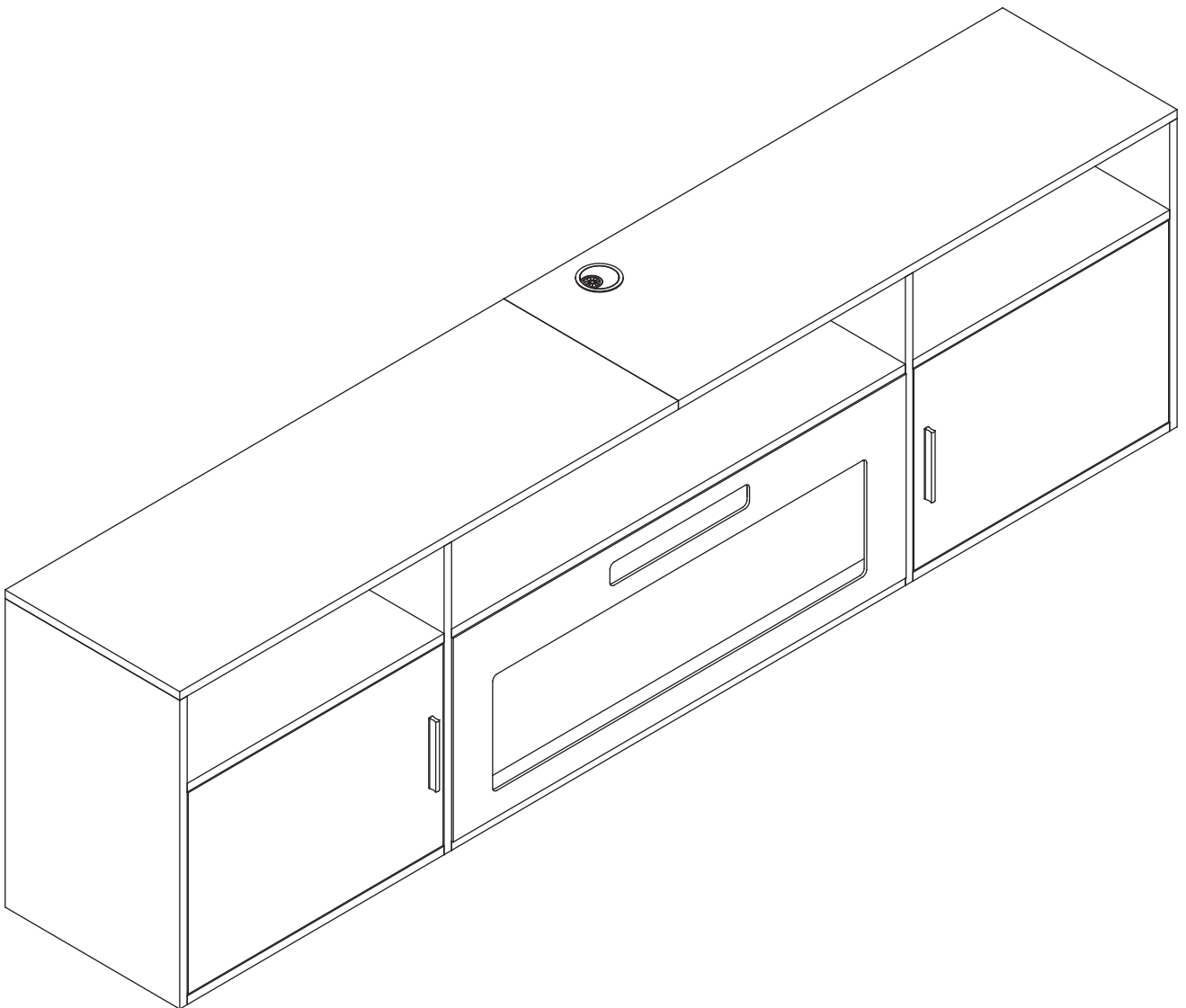

Two people needed during installation

Attention: The Fireplace and TV stand come in TWO PACKAGES
Please don't be confused if only one package was received.

Parts list

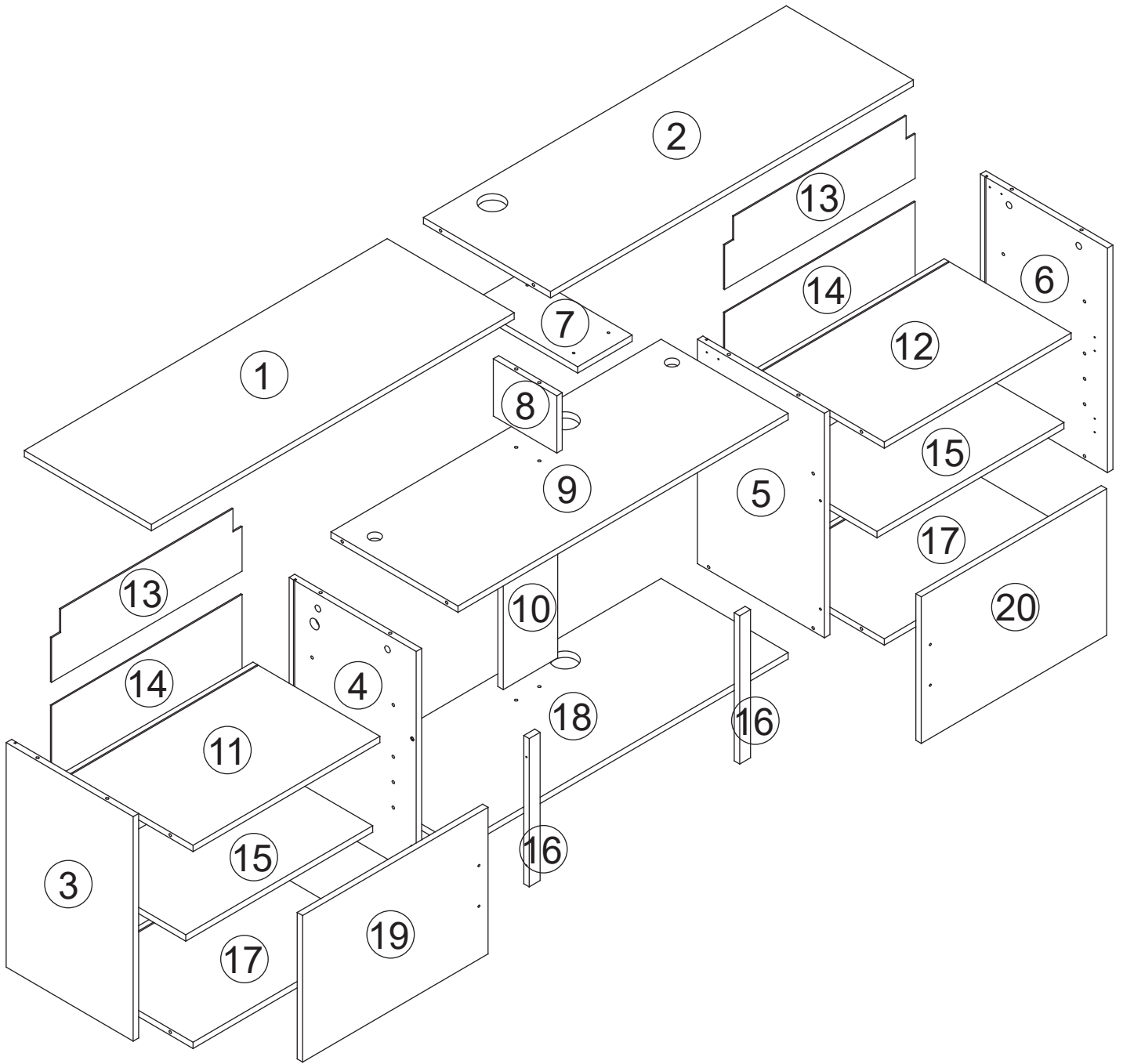

Ax40+1

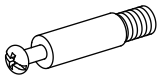

Bx44+1



Cx16+1



M4x40

Dx44+1



Ex4

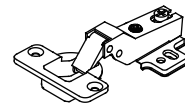

Fx8+1



Gx38+2

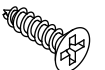

M3.5x14

Hx2

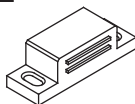

Ix2

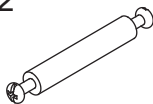

Jx2

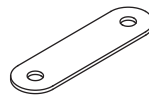

Kx8

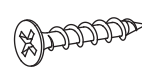

M4x25

Lx4

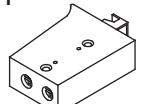

Mx4

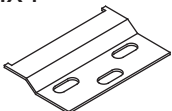

Nx4

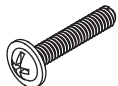

Ox2

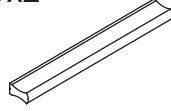

Px12

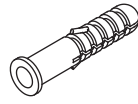

Qx4

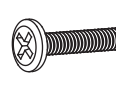

Rx3



Sx2



Installation steps

STEP 1

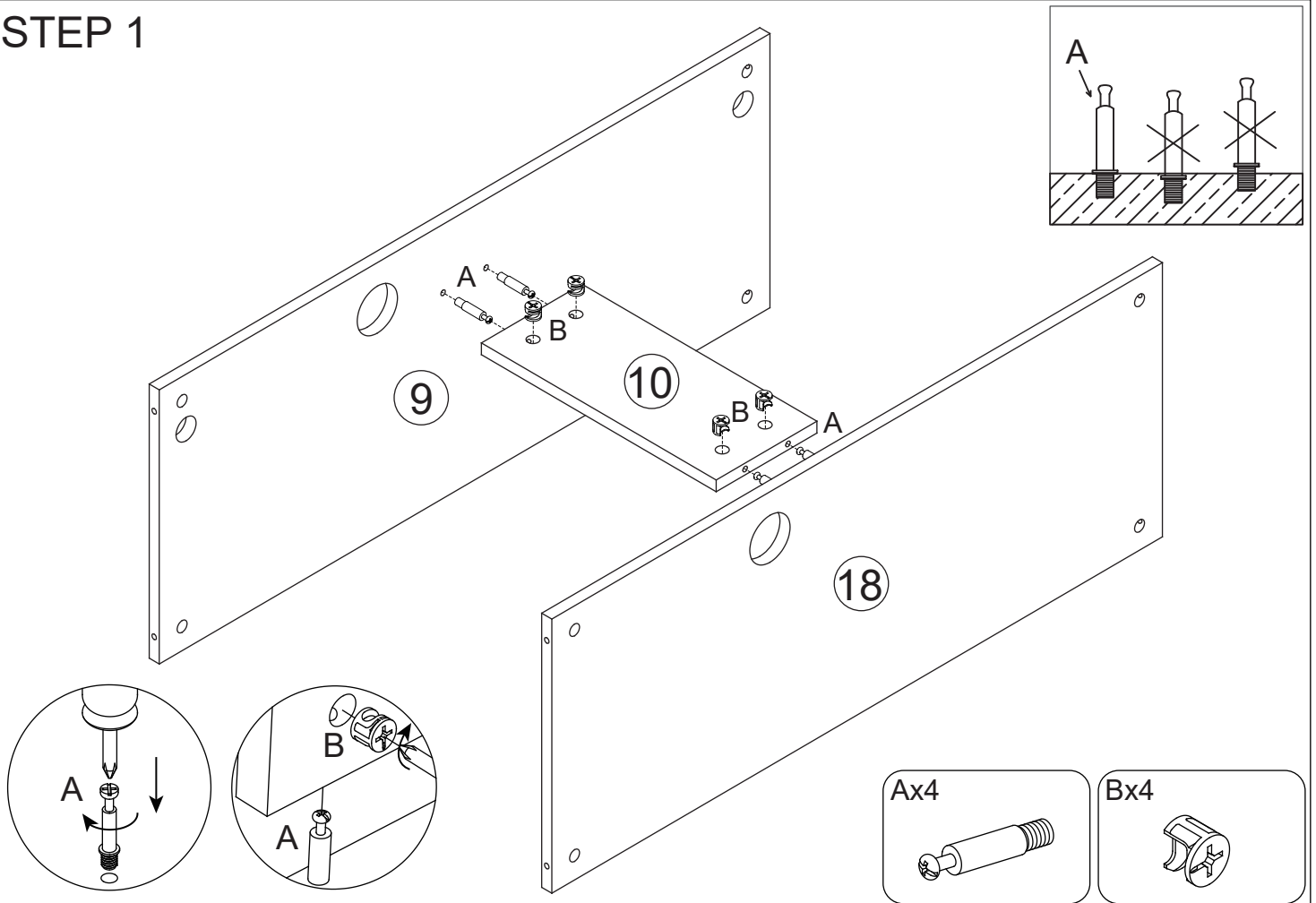

STEP 2

The grooved side of Panel 4 must face outward.

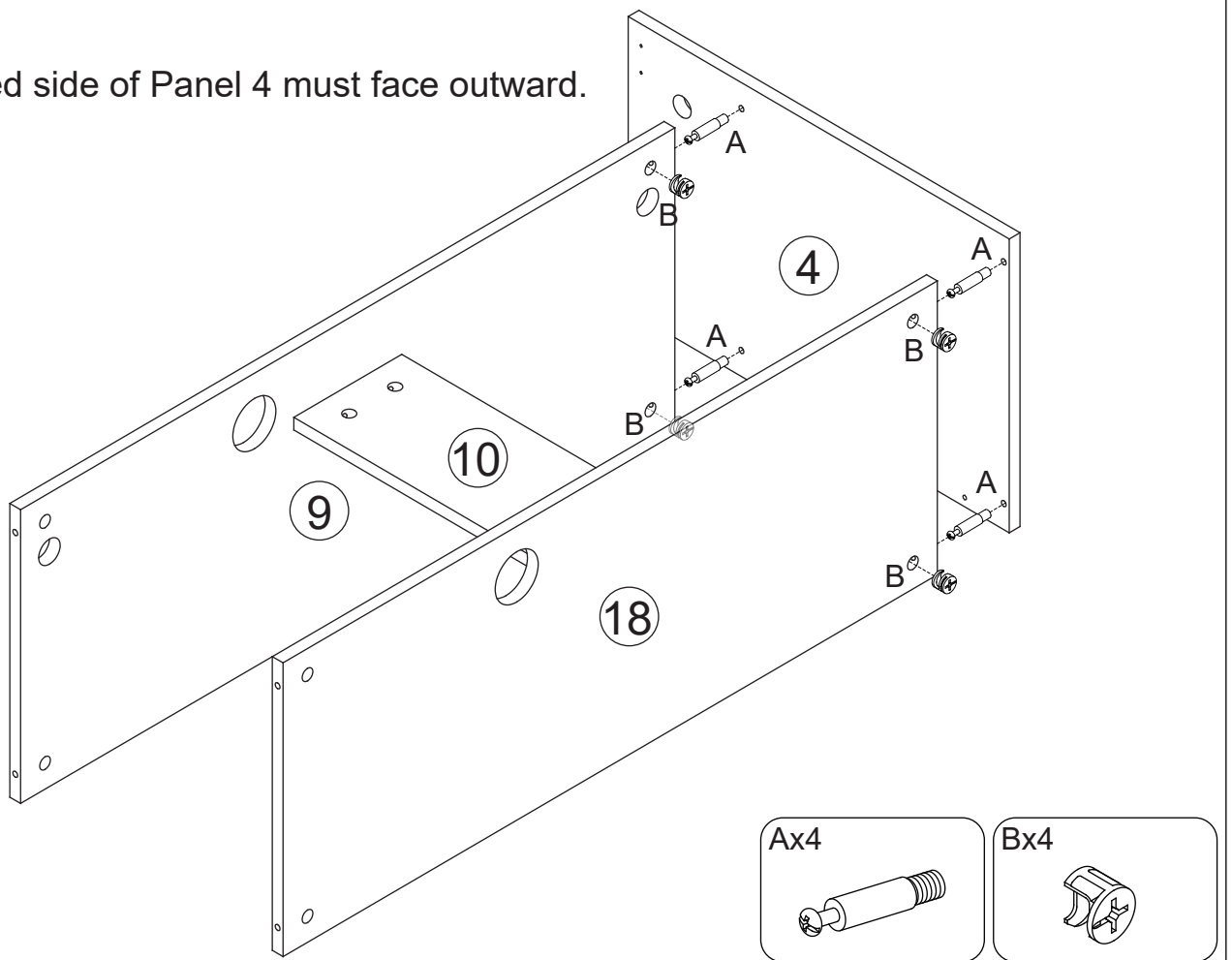

Installation steps

STEP 3

The grooved side of Panel 5 must face outward.

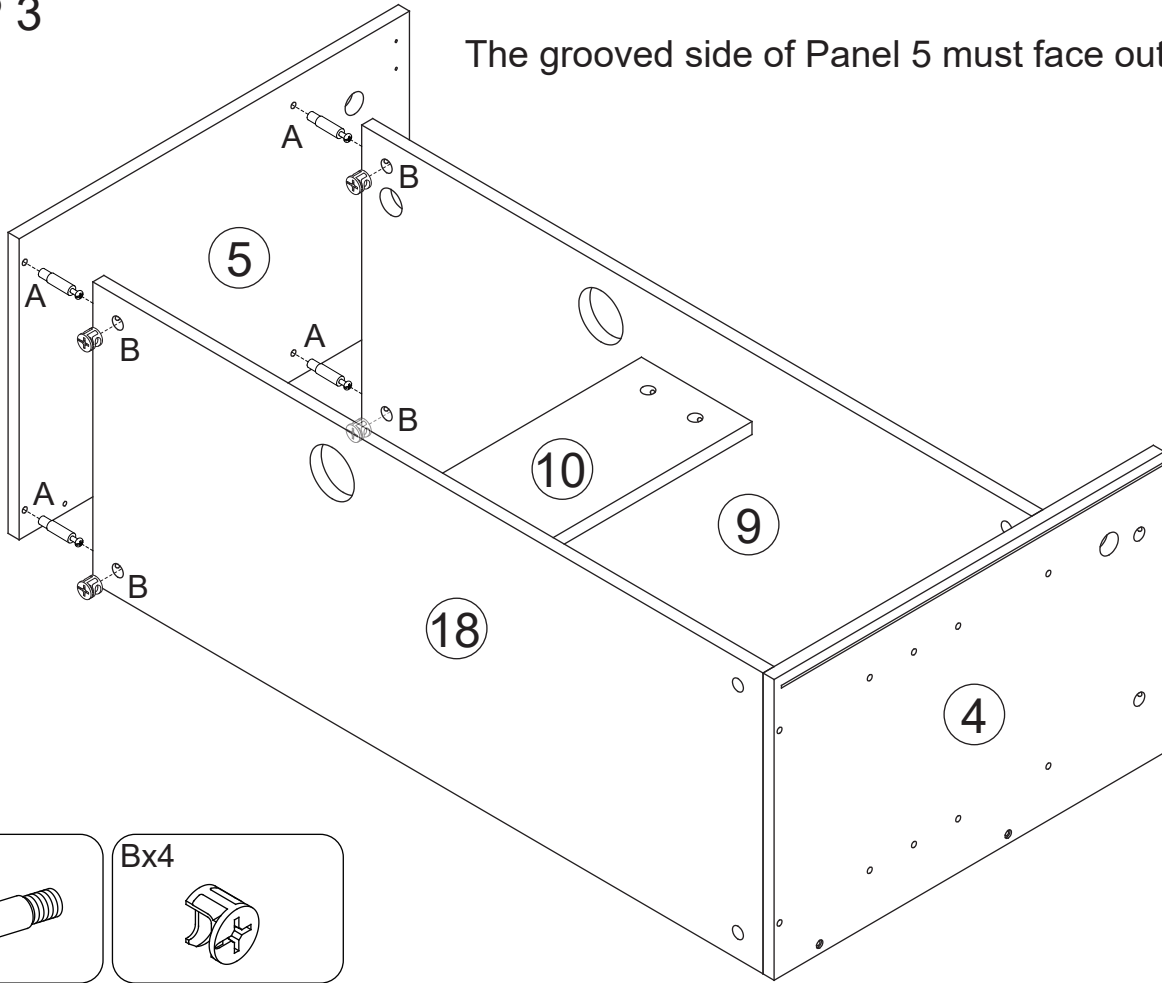

Ax4

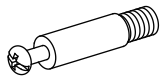

Bx4



STEP 4

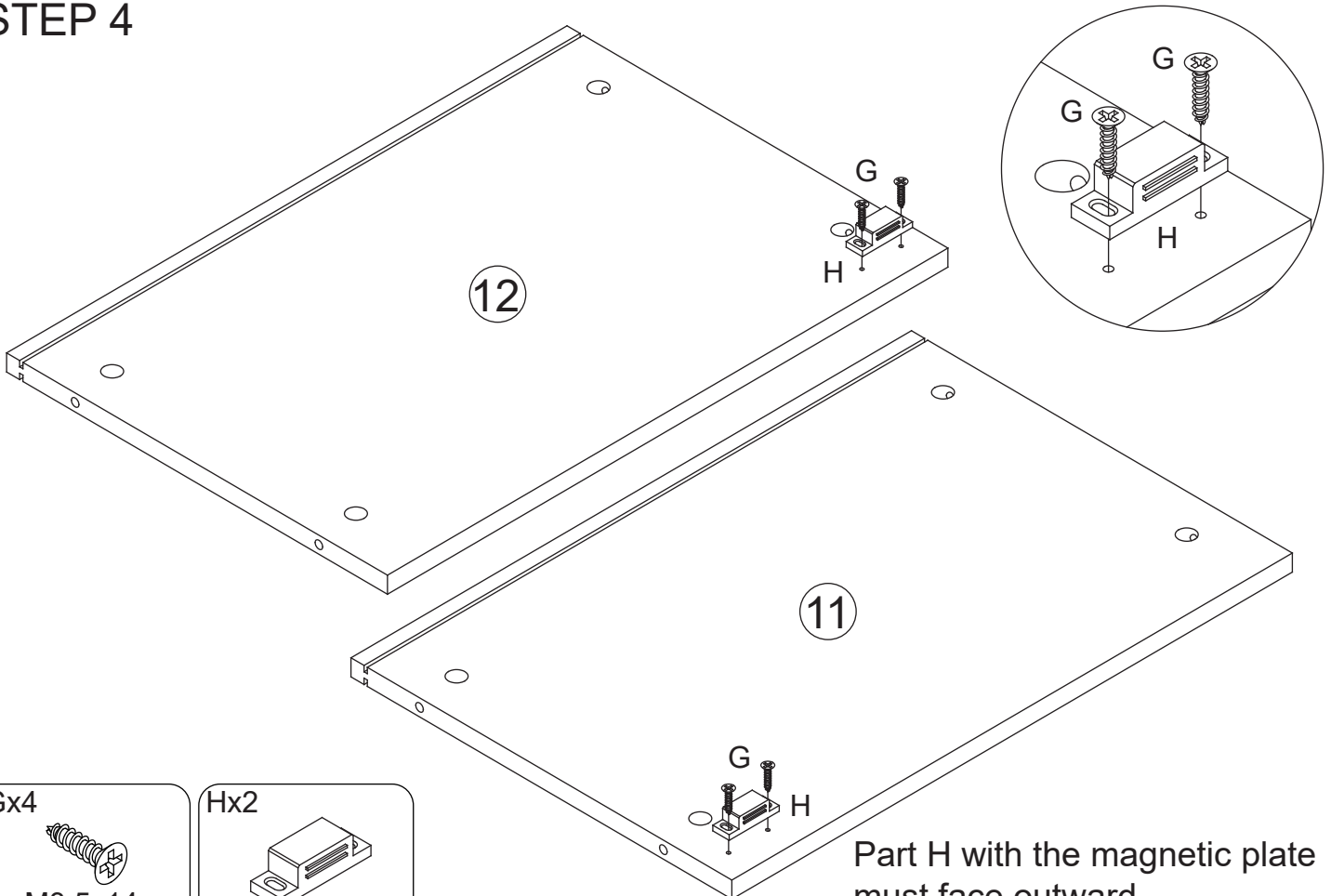

Gx4

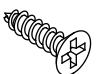

M3.5x14

Hx2

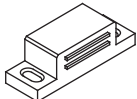

Part H with the magnetic plate must face outward.

Installation steps

STEP 5

The dotted line indicates the grooved section.

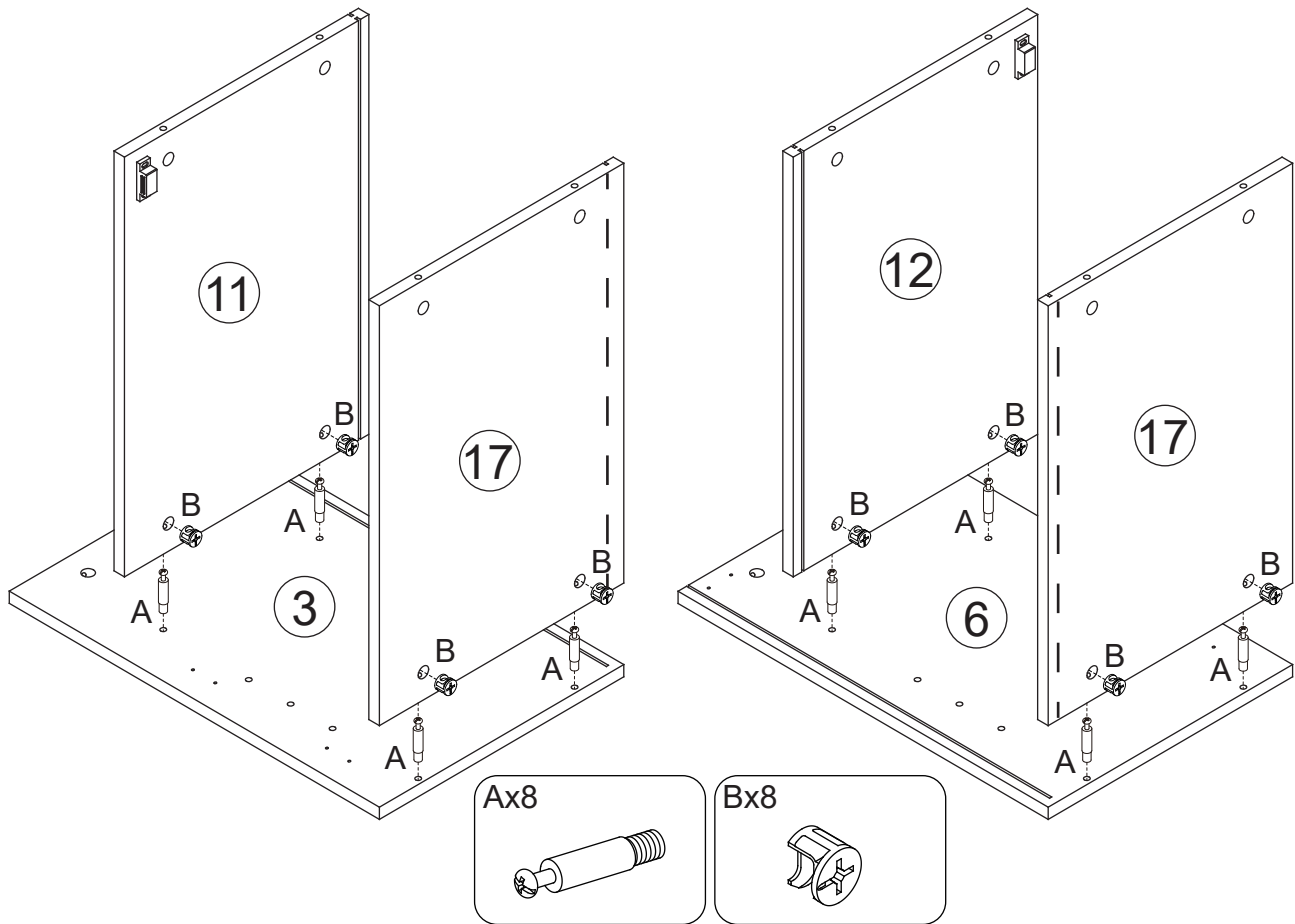

STEP 6

The coated side must face inward.

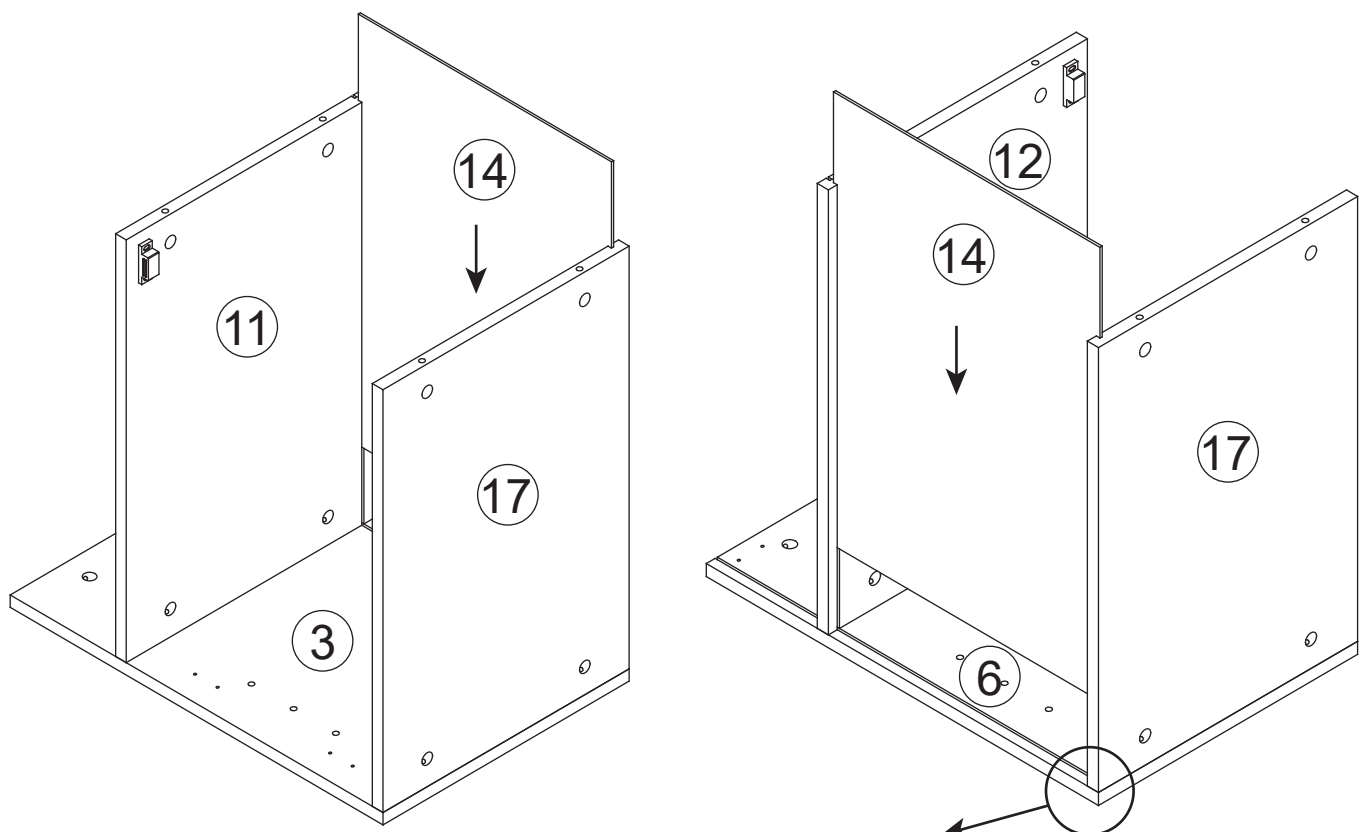

Ensure Part 14 is fully seated into the bottom groove.

Installation steps

STEP 9

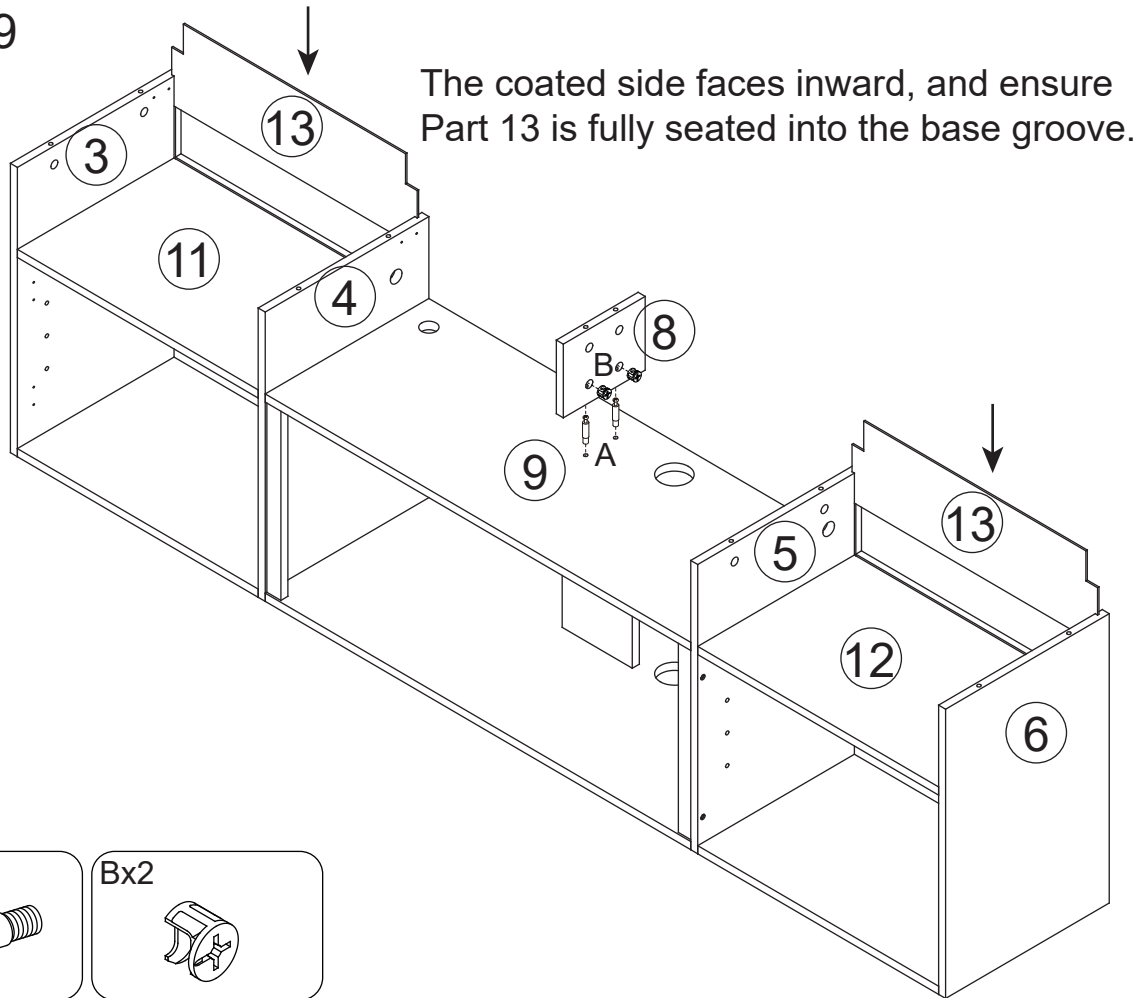

STEP 10

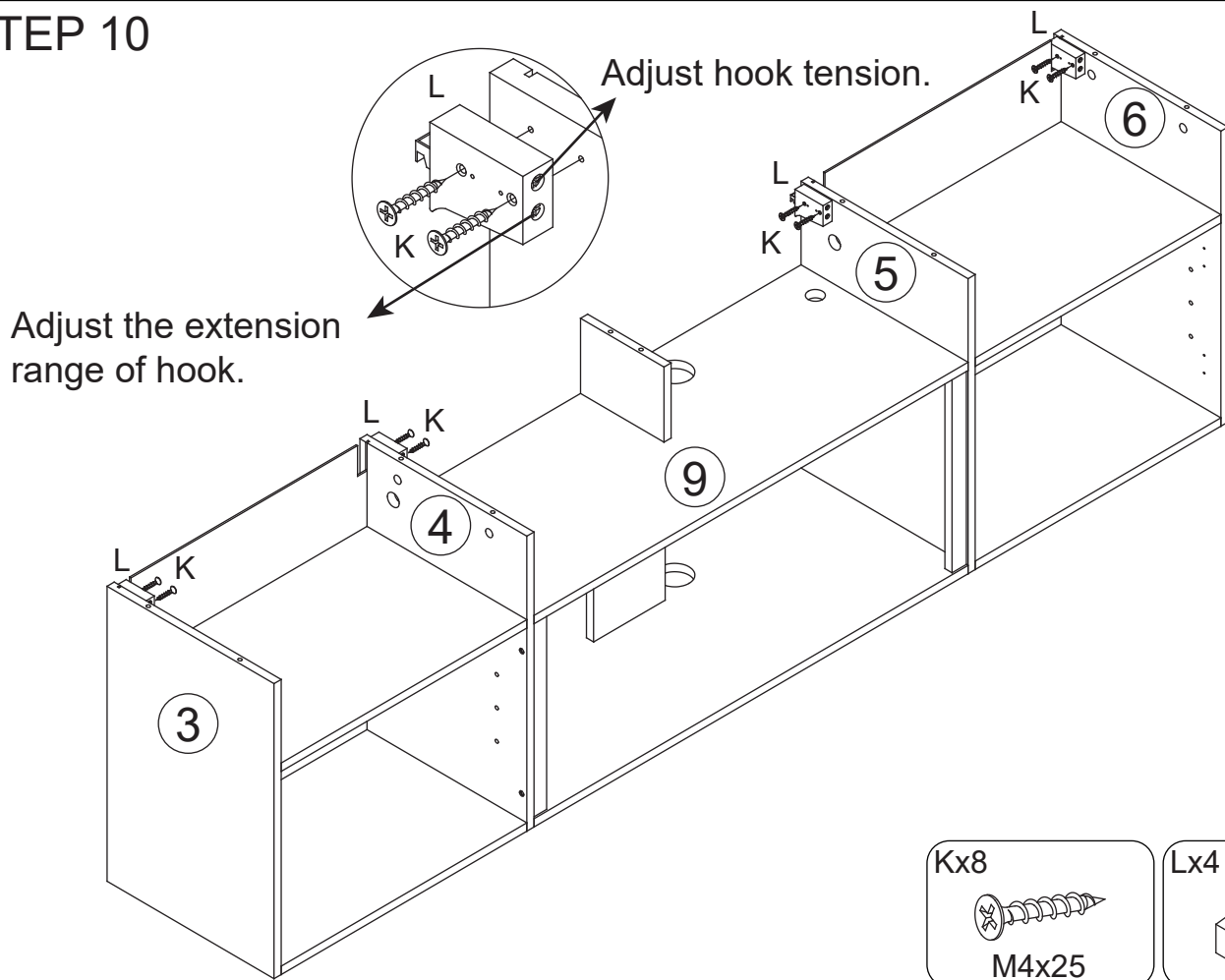

Installation steps

STEP 11

First lightly tighten one side, then install both sides into Screw B before fully tightening each side.

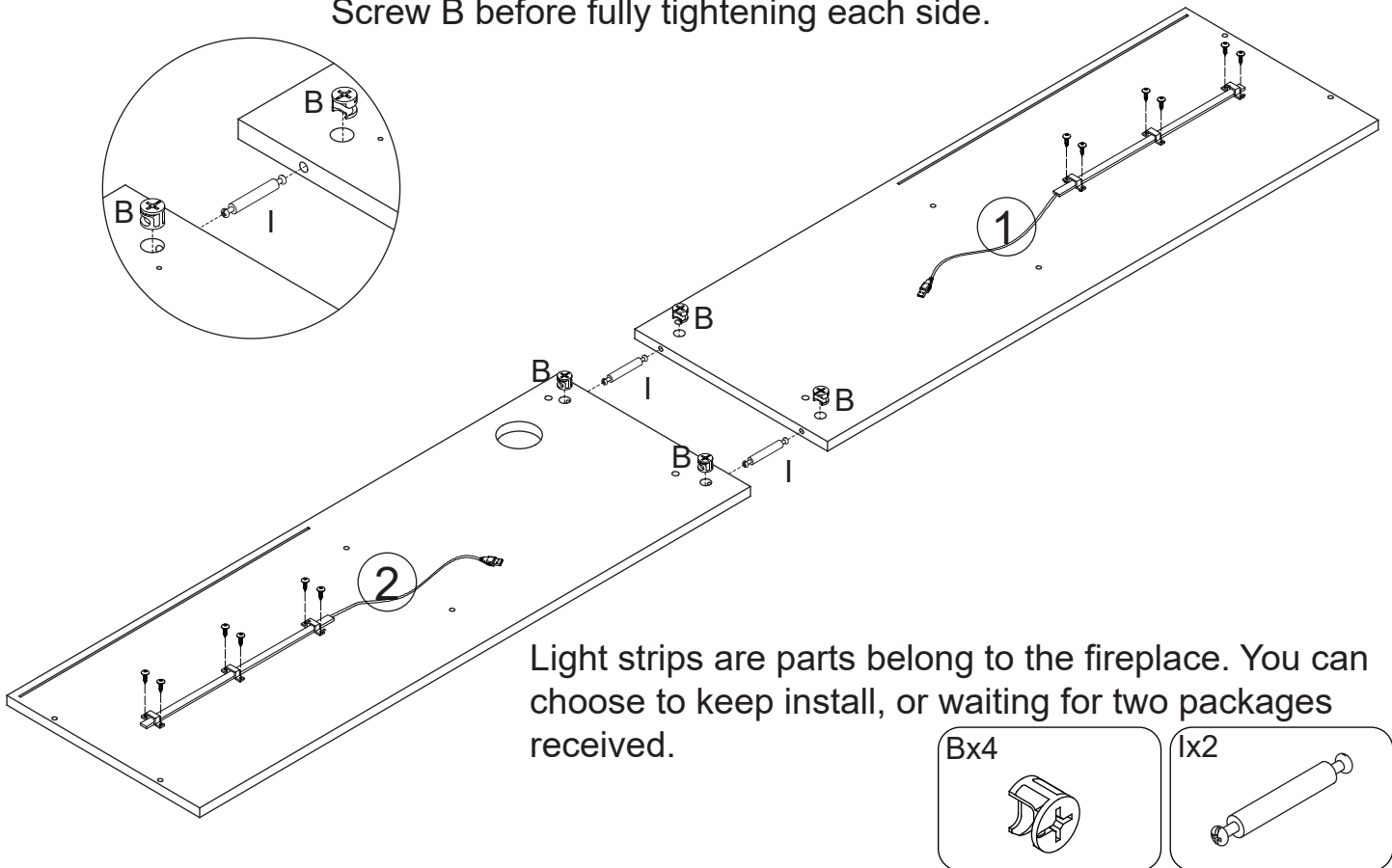

STEP 12

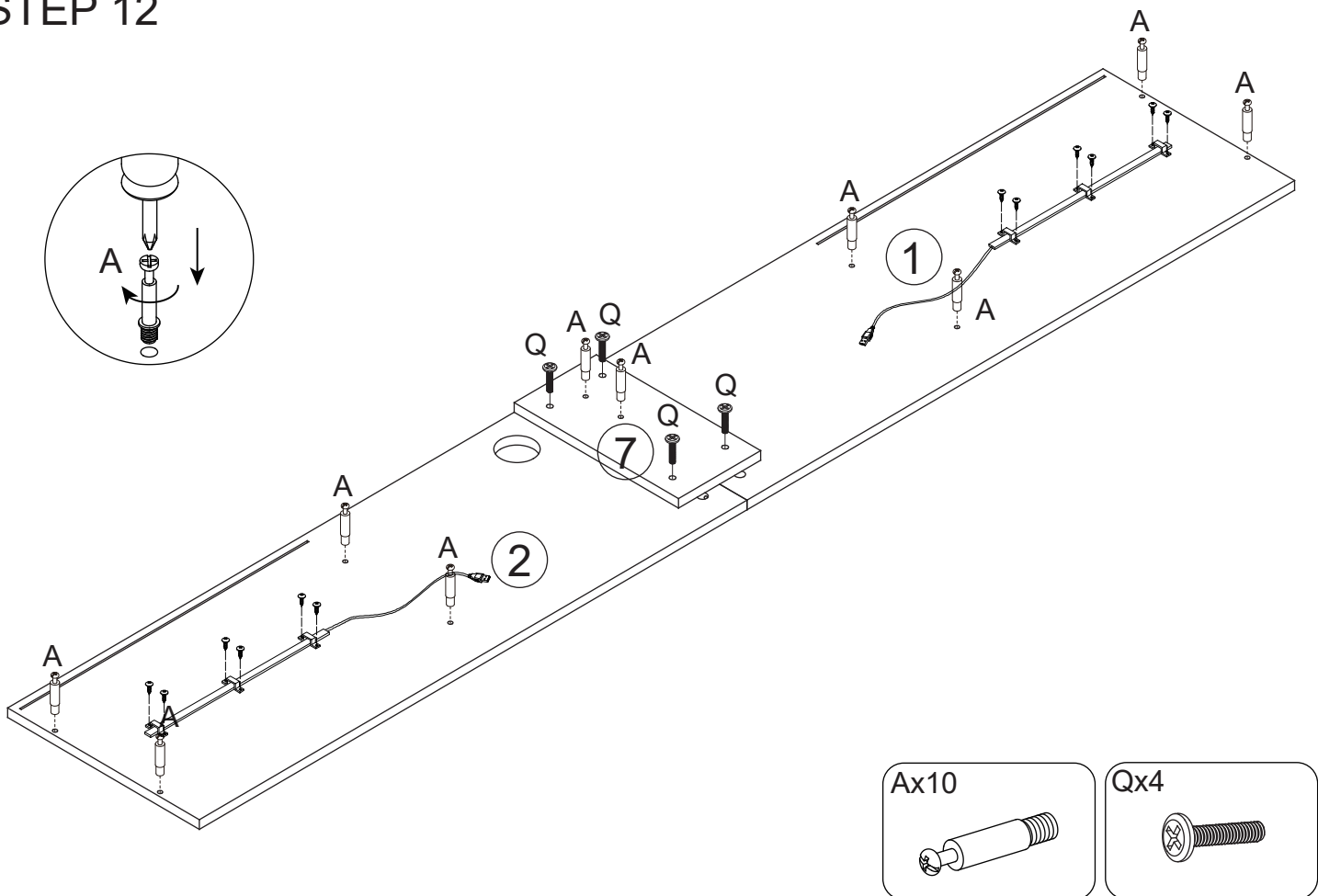

Installation steps

STEP 13

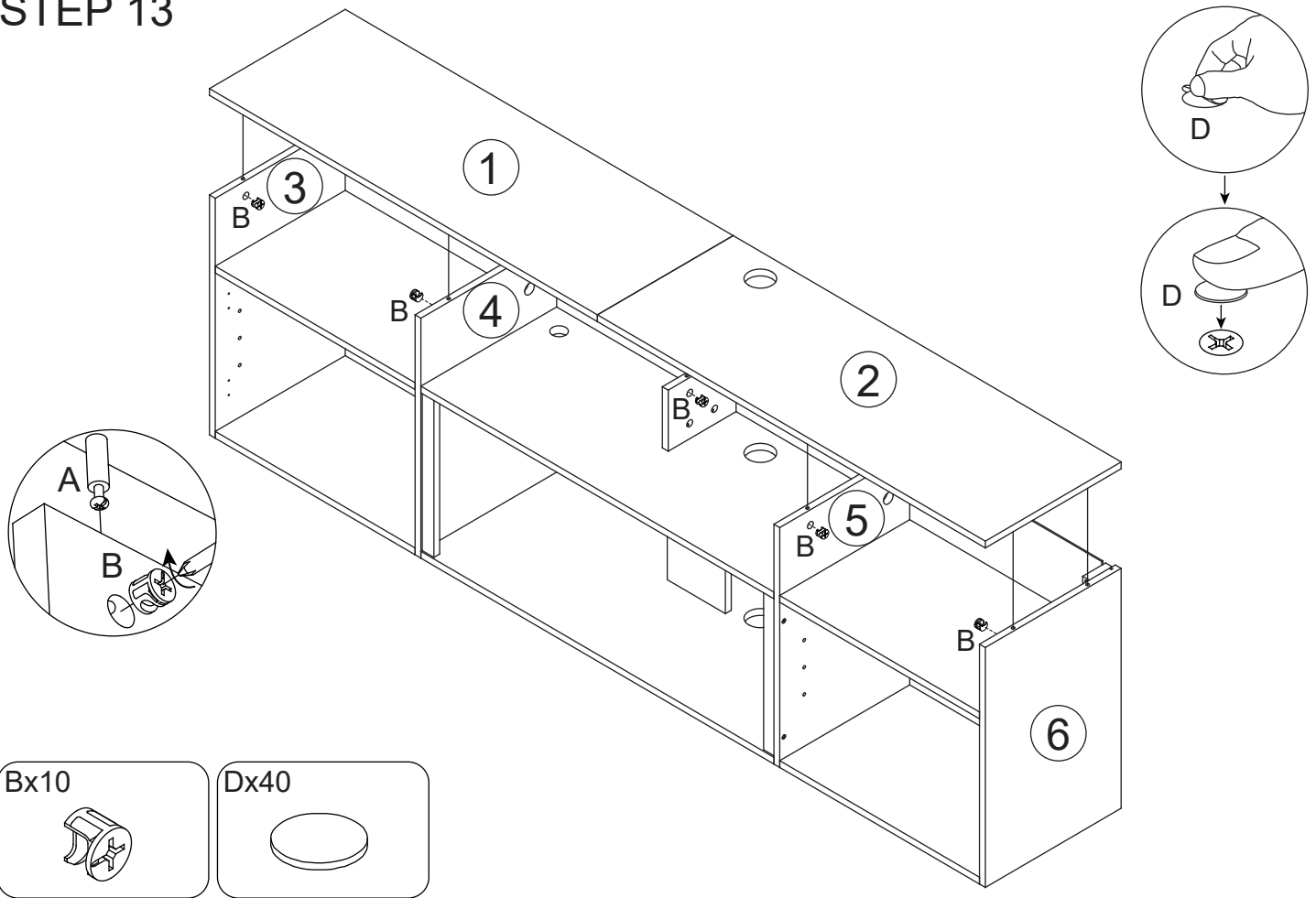

STEP 14

Note: The fireplace installation method in this manual is a simplified version. For detailed installation procedures, please refer to the fireplace's dedicated instruction manual.

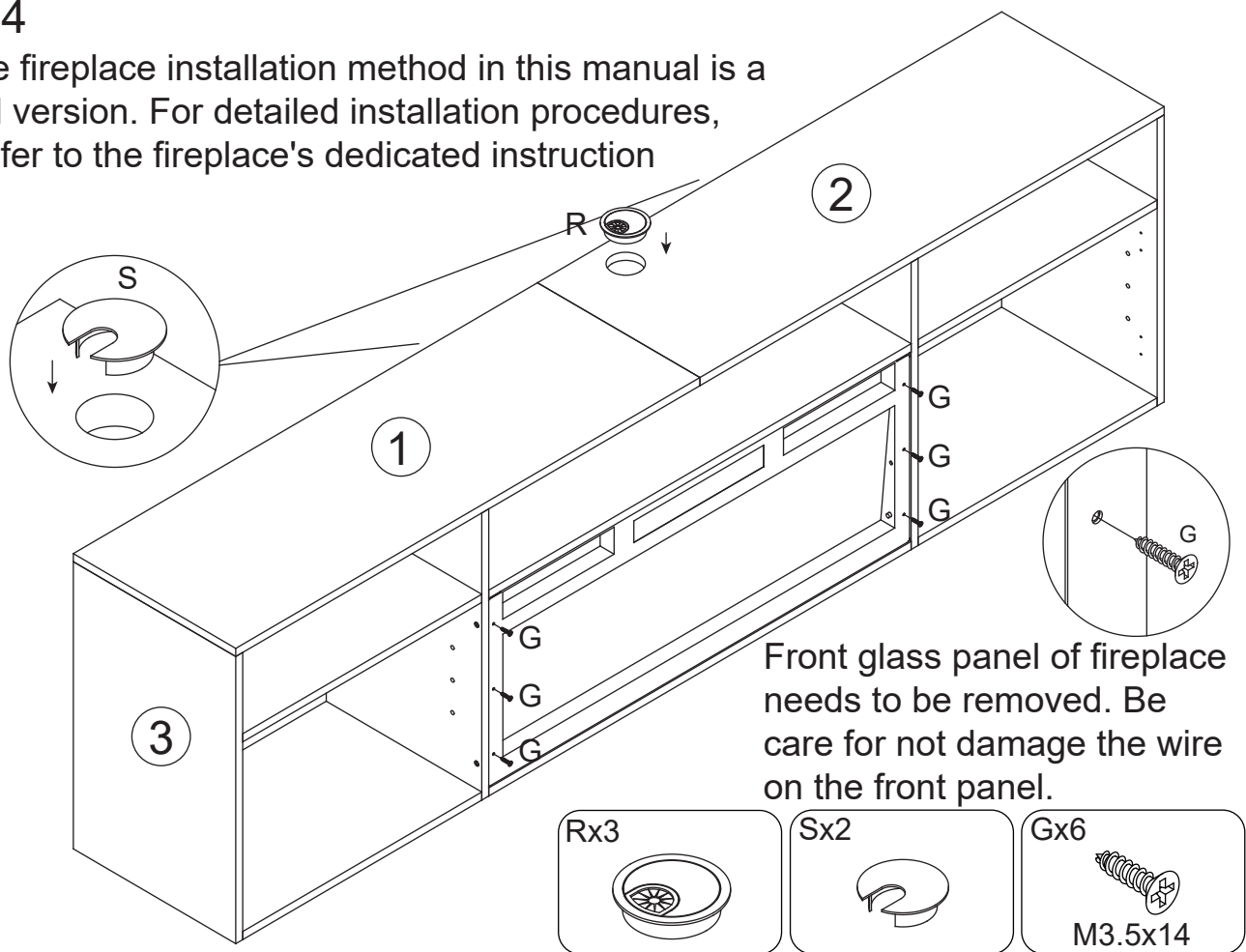

Installation steps

STEP 15

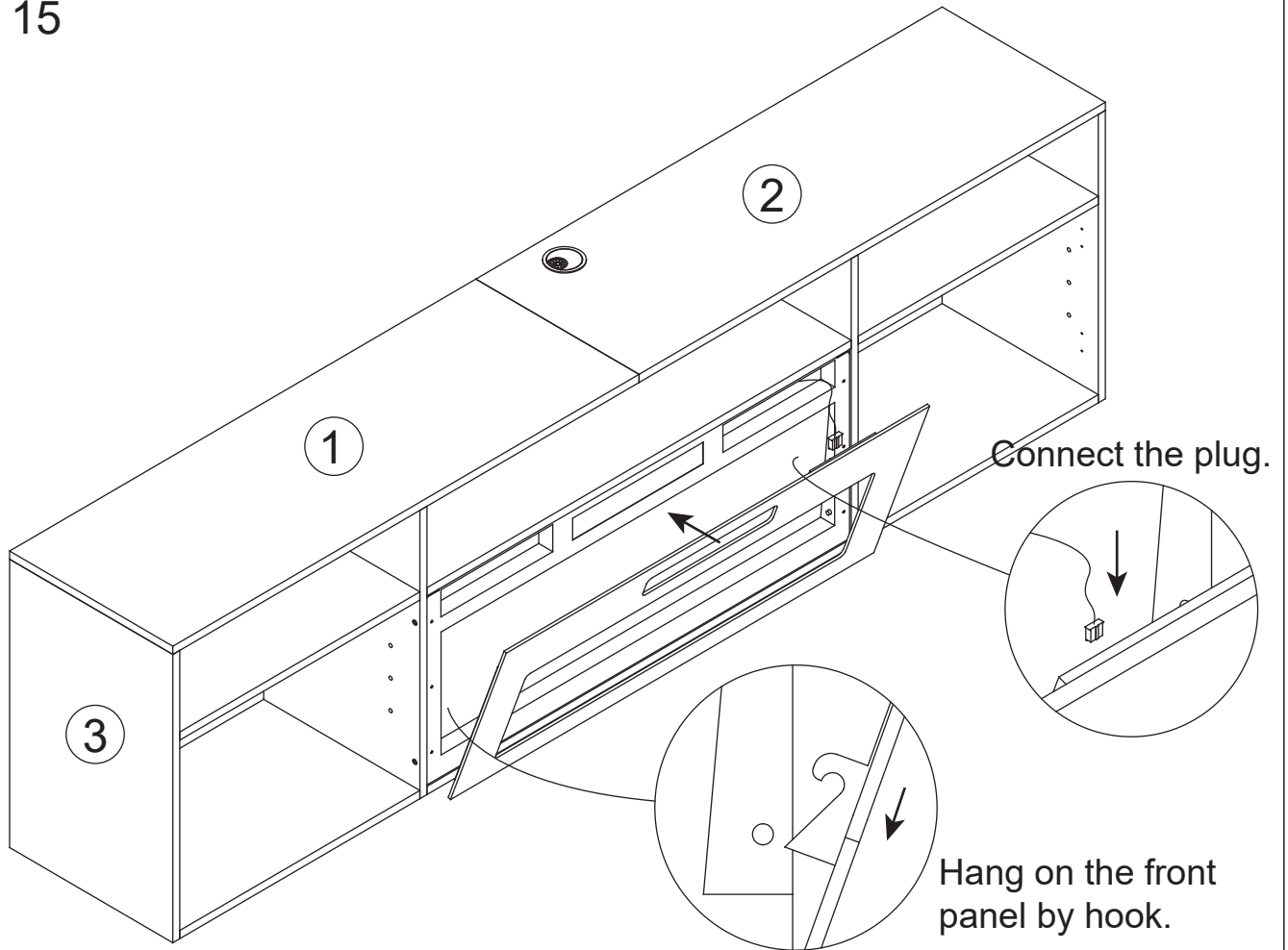

STEP 16

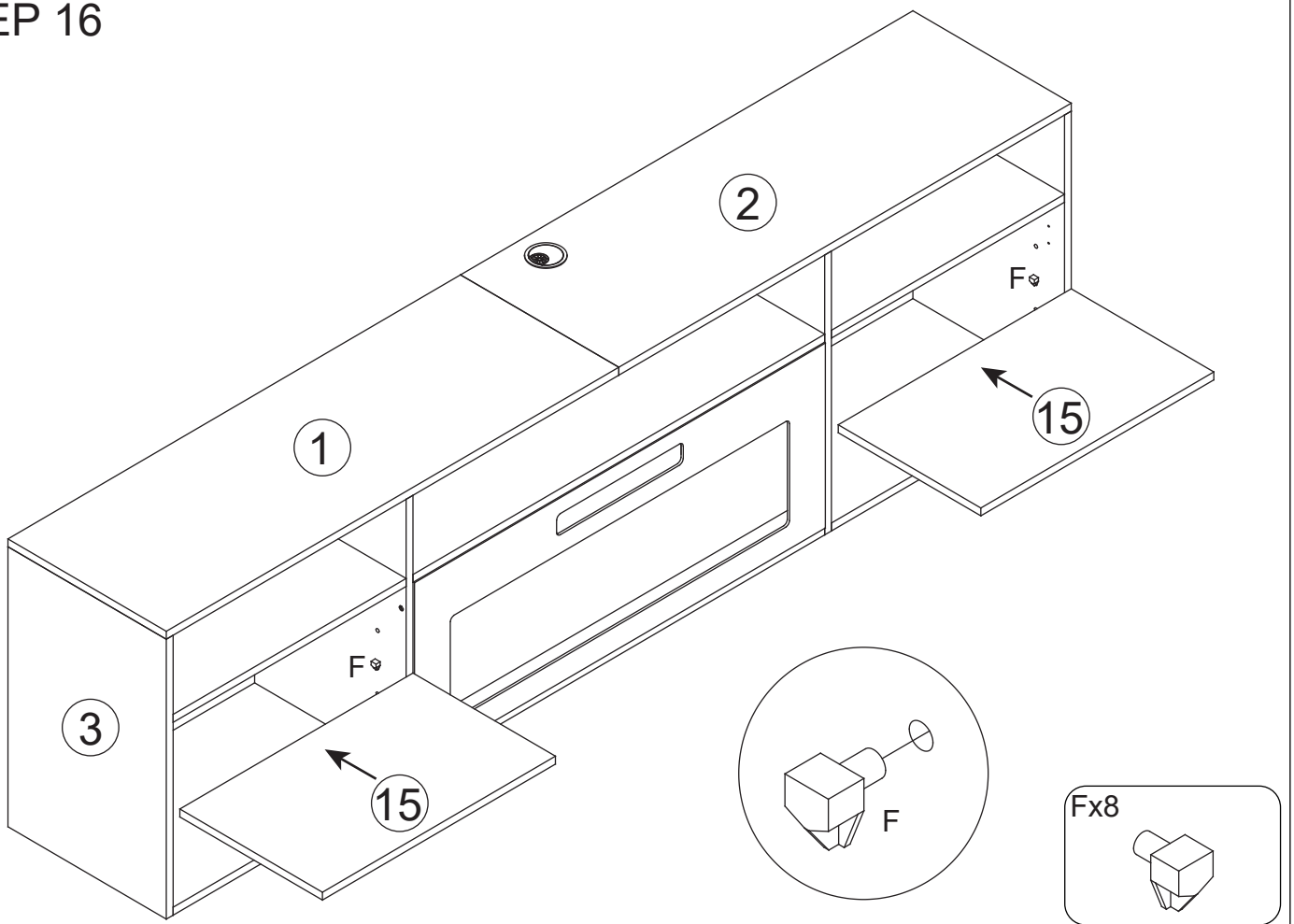

Installation steps

STEP 17

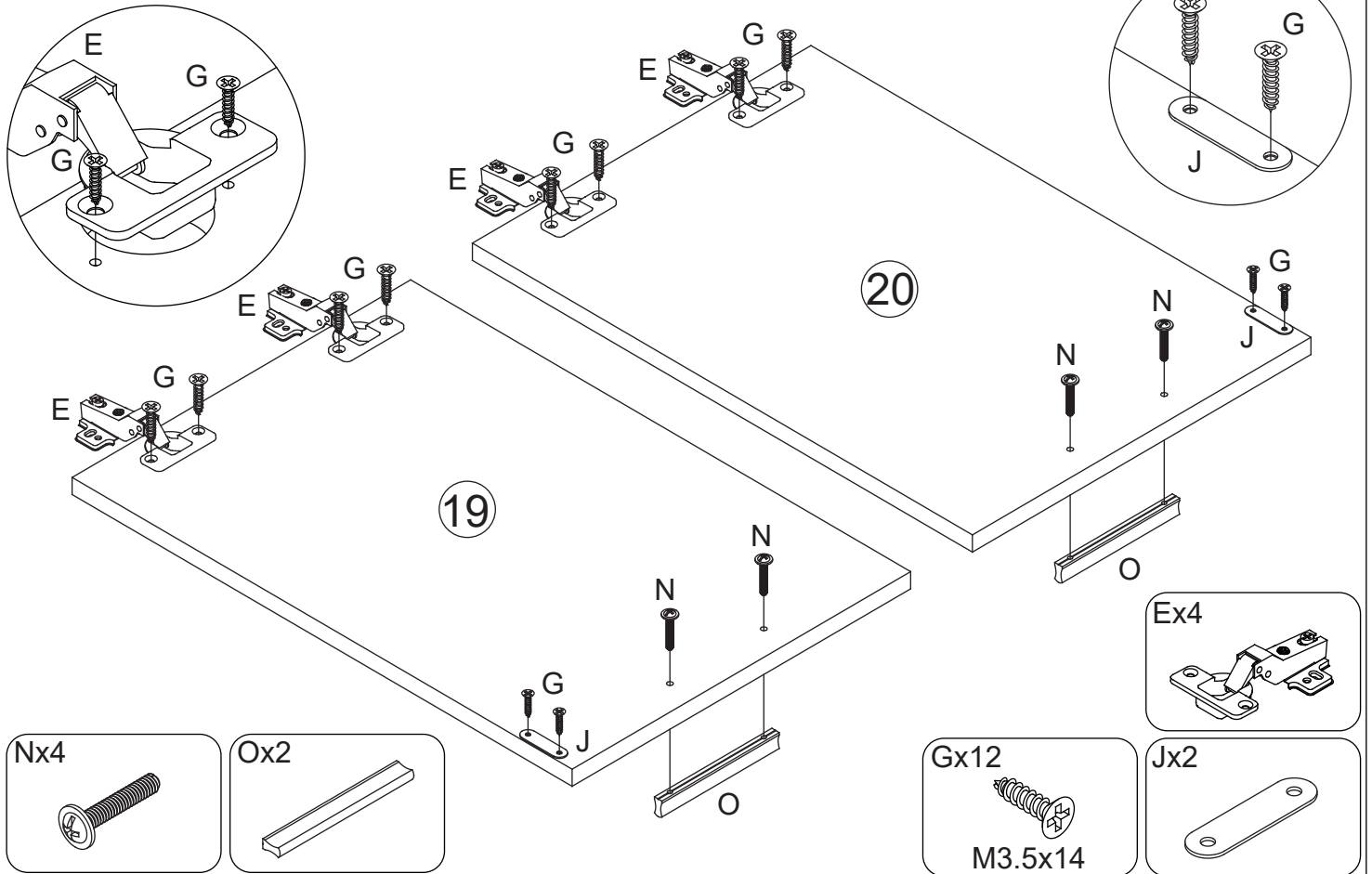

STEP 18

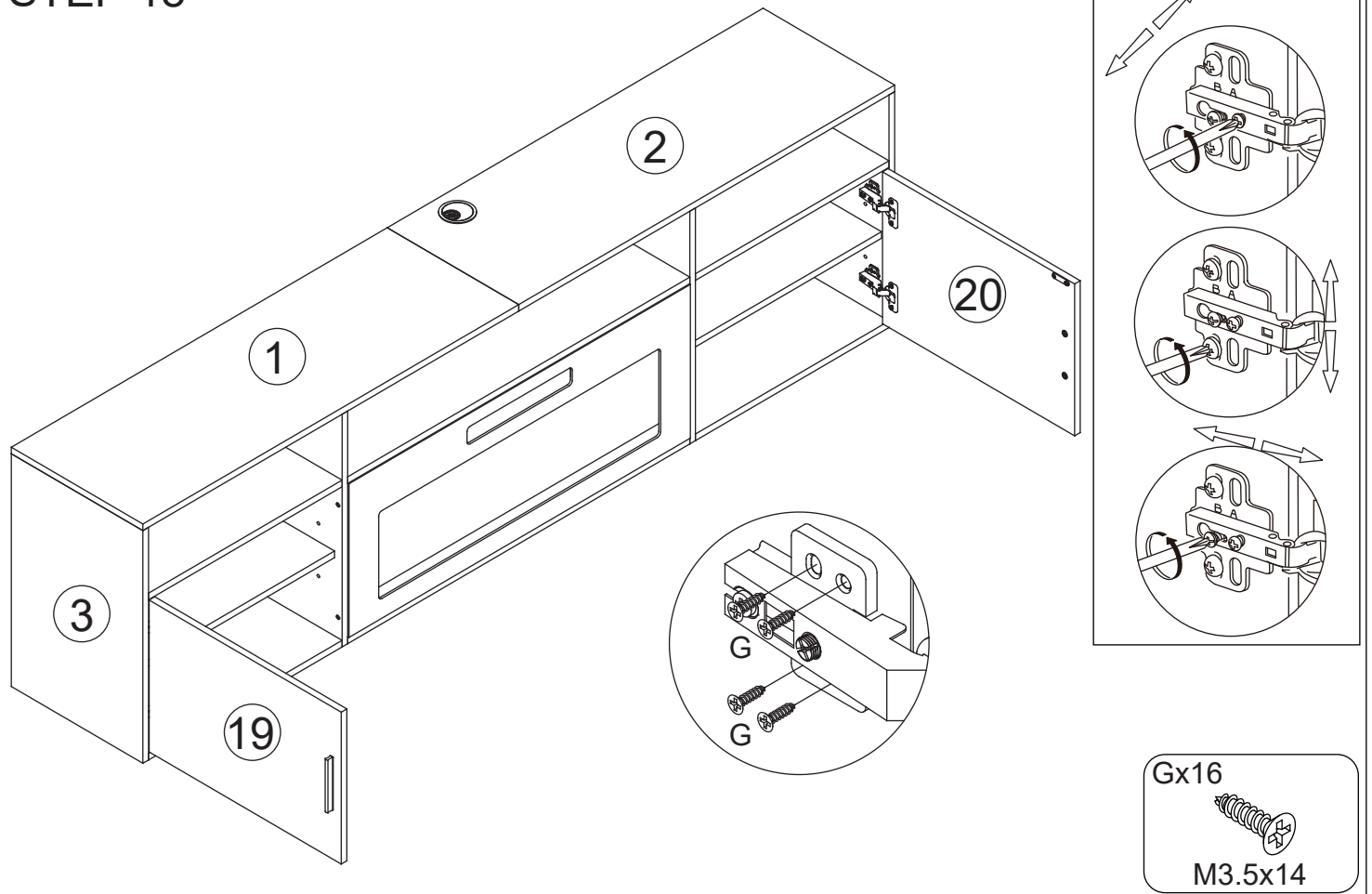

Installation steps

STEP 19

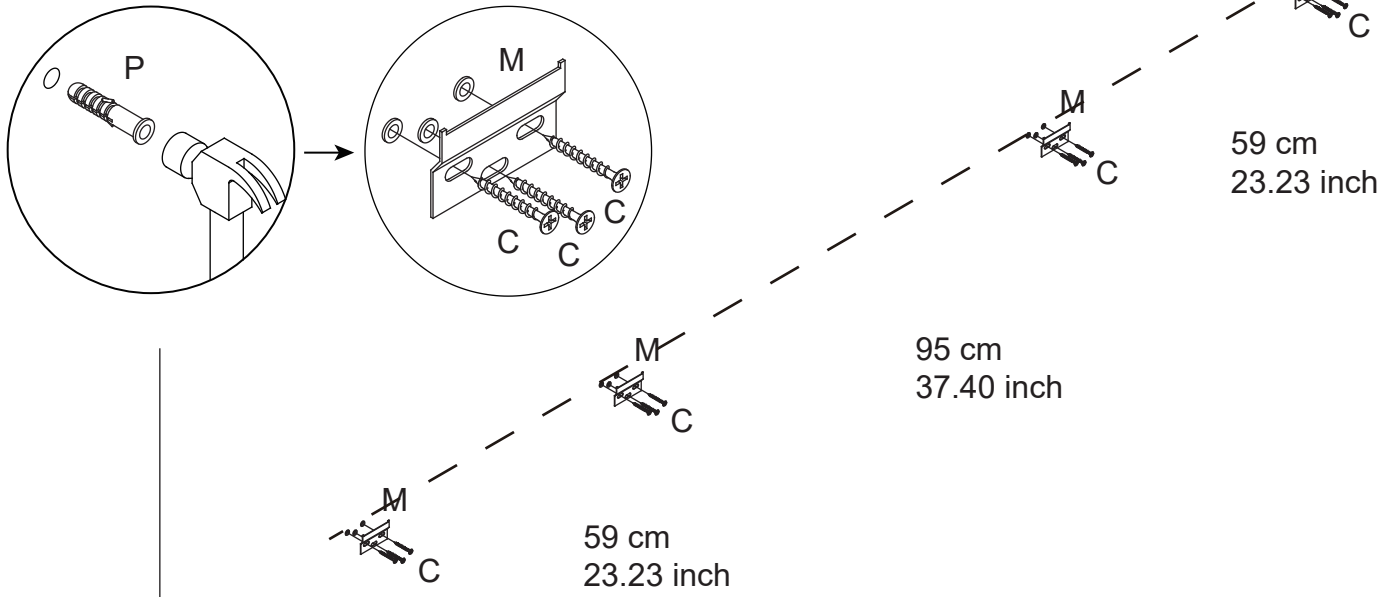

The dimensions in this manual are recommended values. Customers should conduct actual measurements prior to installation.

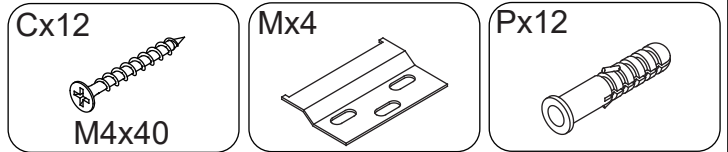

STEP 20

Two-person installation required for mounting the TV console on the wall.

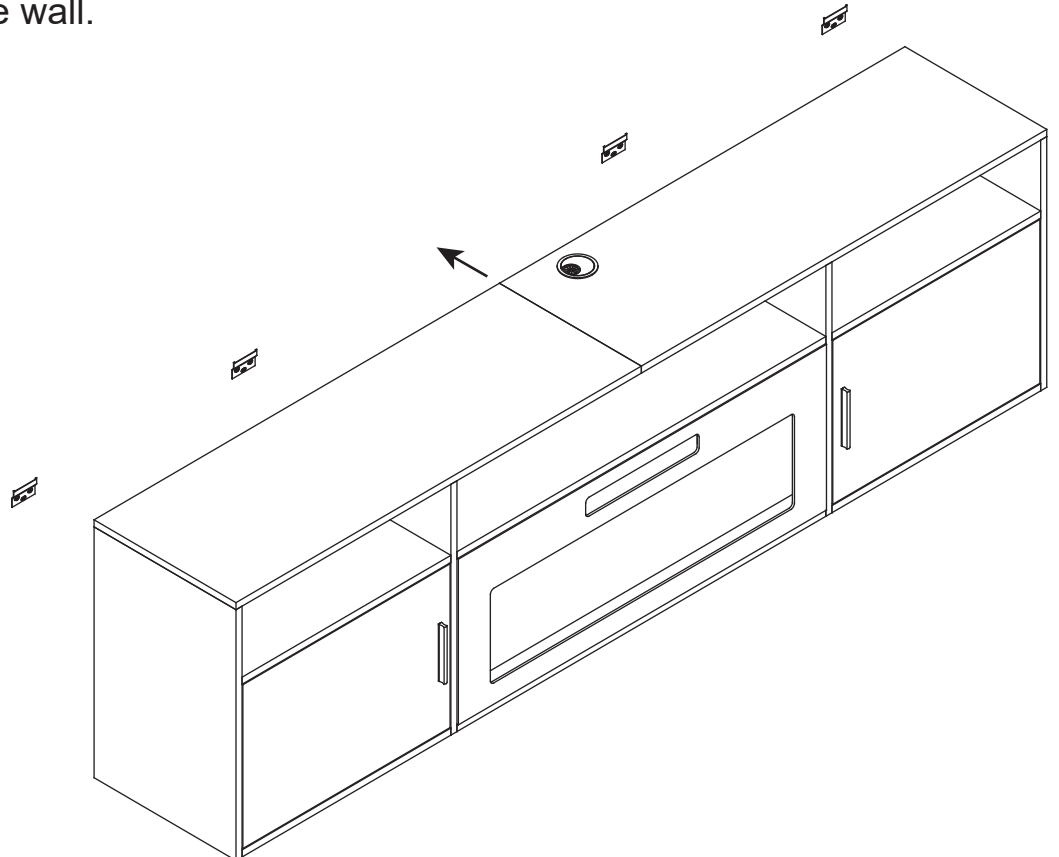
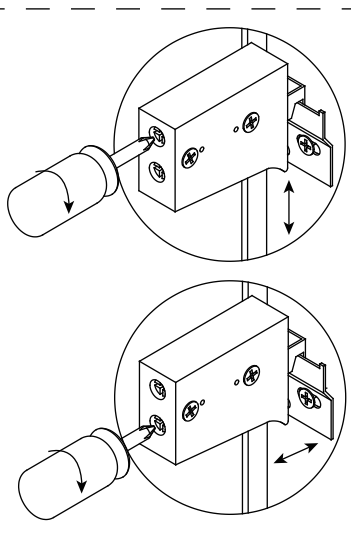
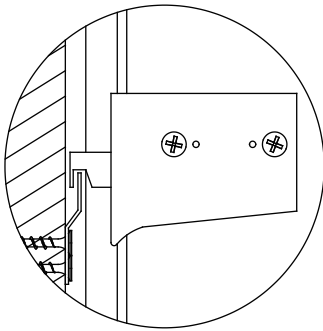

HELP CENTER

WE STAND BEHIND THE QUALITY OF OUR PRODUCT

1. If you have any other issues with your item(s), please feel free to contact us! We will always do our best to come up with a solution that you will be happy with.
2. Please get in touch with our customer service team before returning the item(s).
3. Please do not throw away the original box(es) if you have not finished assembling and confirmed no quality issues.

RETURN POLICY

Length of return period:

You can return the item(s) within 30 days of purchase.

In the meanwhile, everything you purchased from us comes with a one-year warranty.

Who is responsible for the return shipping fee:

We will cover the return shipping fees if:

1. Your item has a manufacturing defect in materials or workmanship. For example, material cracking or screw hole misalignment. We will send you a prepaid shipping label after you send us photos or videos of the defects.
2. Your item has been damaged in transit. For example, metal part is broken or product is damaged. We will send you a prepaid shipping label after you send us photos of the damage.
3. You receive the wrong box(es) due to a warehouse error, We will send you a prepaid shipping label after you send us photos of the item(s), shipping label(s) and words(SKU) on the outer box(es).

* However, we still hope to work with you for a better solution instead of a return. Please don't hesitate to contact our customer service team.

Customer will cover the return shipping fees if:

1. You don't like the item(s) after receiving the box(es).
2. You no longer need the item(s) but have received the box(es).
3. You buy the item(s) by mistake but have received the box(es).
4. Order/shipment cancellation failed, and you have received the box(es).

Return Request

In order to get a full refund as described in this return policy, all items must be:

1. In a brand new/unused condition. Please provide photos before and after packaging.
2. All accessories and parts must be firmly packed in all original packaging before returning. If your return does not meet these requirements, you may not receive a full refund.

When can I receive a refund?

After you return it using the prepaid shipping label we provided and inform us, the refund will be issued once the package(s) have been returned to our warehouse.

What if the product is damaged/defective outside of the valid return period?

We want you to be a happy customer. Please reach out to us via email or text, and we will work on a solution to ensure your satisfaction.