

STEP 4

- No.1 and No.2 wire connect with the backrest and chair base.
- No.3 wire connects with backrest and power cord(D).
- No.4 wire connects with backrest and remote control(E).
- No.5 wire connect the motor and the wire from rightside armrest, which use to connect the control panel.
- No.6 wire connect the motor and power source (F).

NOTE

- 1: Two same color wires connect.
- 2: Plug power cord and power source into outlet, then you can use all function.

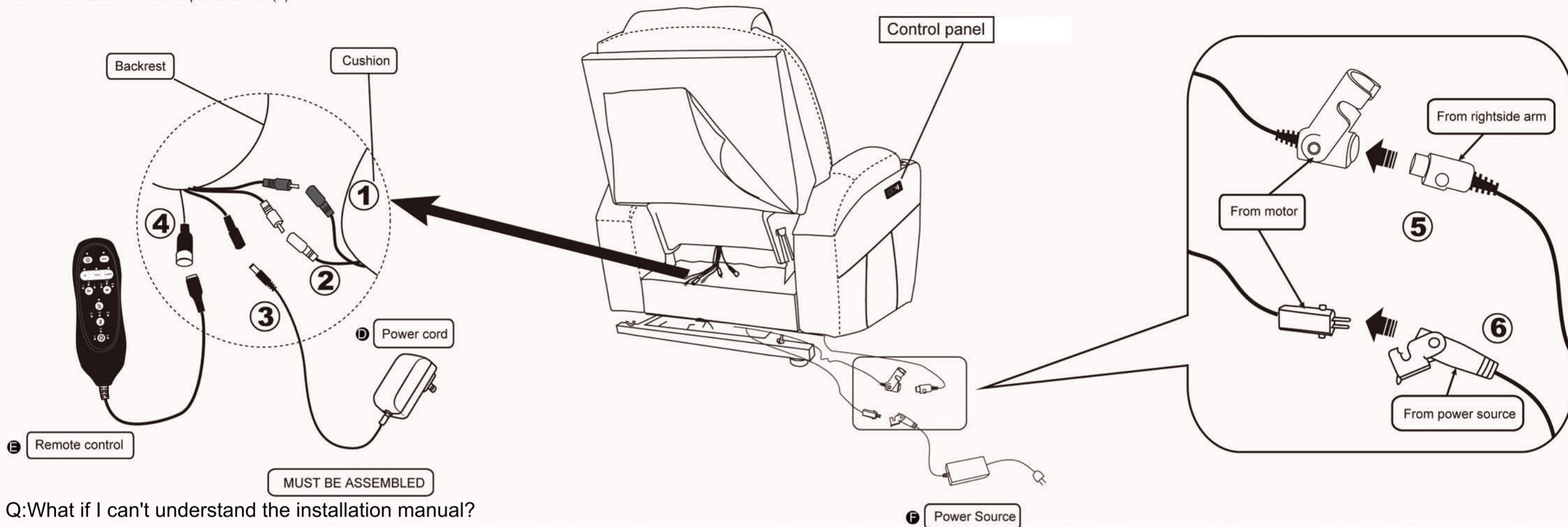

MUST BE ASSEMBLED

Q:What if I can't understand the installation manual?

A:Please scan the code to view our installation video

Our installation video is on YouTube:

<https://www.youtube.com/watch?v=y9ZXN5zct4M>

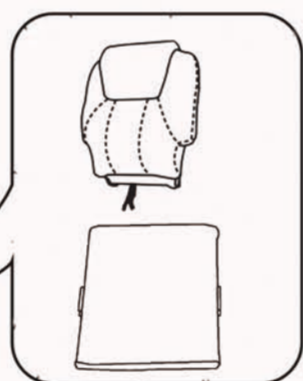

Please connect the soft bag to the backrest bracket

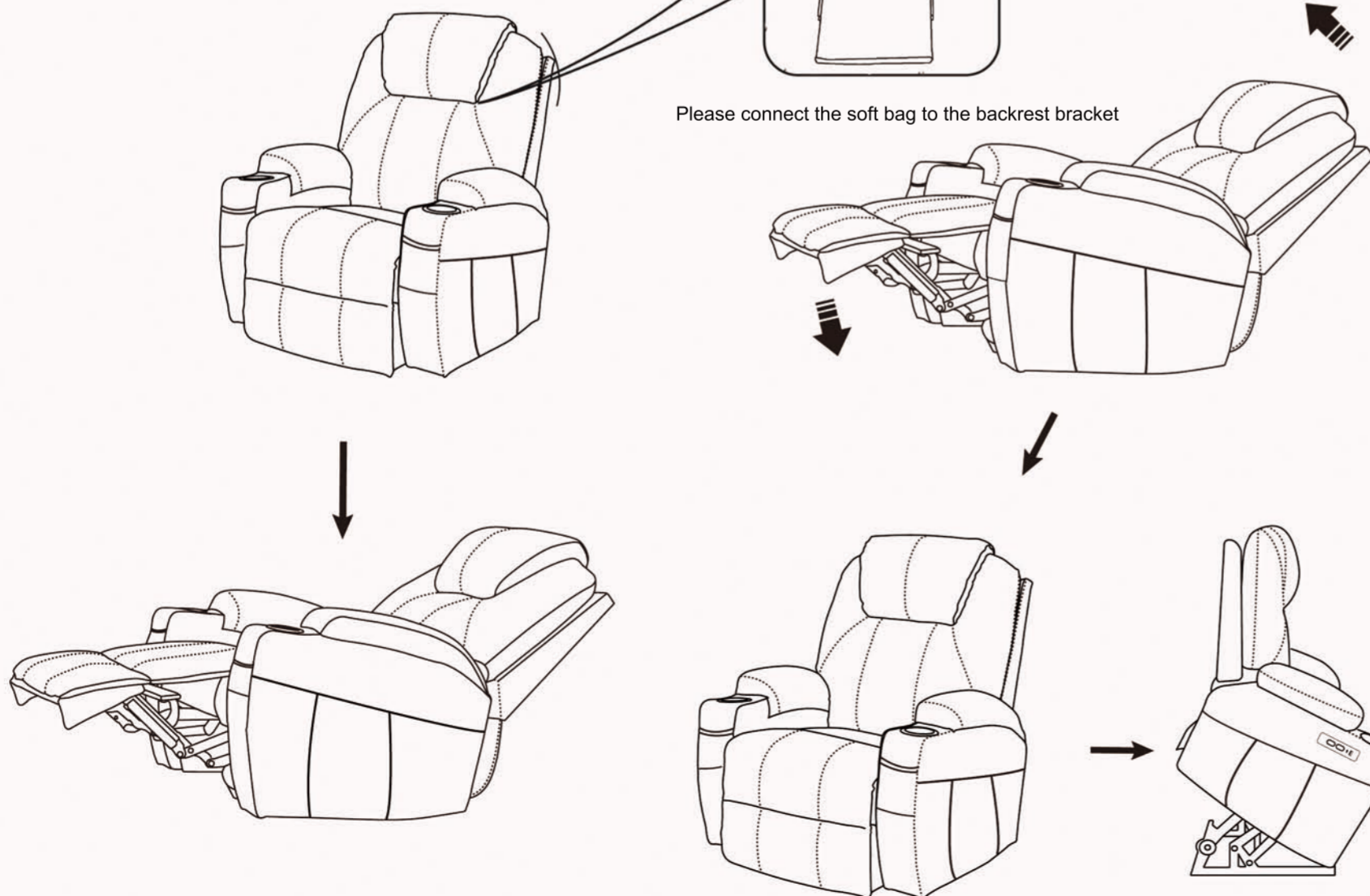

How to use remote control?

