



**400-WATT
COUNTERTOP BLENDER
Model: BL3431**



User Manual

-READ ALL INSTRUCTIONS BEFORE USE-

IMPORTANT SAFEGUARDS

READ ALL INSRUCTIONS

When using electrical appliances, basic safety precautions should always be taken:

1. Always unplug the product from the electrical outlet before relocating, servicing, or cleaning it.
2. Keep hands and utensils out of container while blending
3. Do not plug/unplug the product into/from the electrical outlet with a wet hand.
4. Do not operate the product if the power cord is cut, damaged, or if the wires are exposed.
5. Keep the power cord and product away from heated surfaces, including stovetops.
6. Do not immerse in or expose the base, power cord, or plug to water or other liquids. Do not attempt to open any part of the base.
7. To disconnect the product from an electrical outlet, pull directly on the plug; do not pull on the power cord.
8. Do not put any stress on the power cord where it connects to the product, as the power cord could fray and break.
9. If using an extension cord with this product, the marked electrical rating of the cord set or extension cord must be at least as great as the electrical rating of the product.
10. Keep hands and utensils out of container while blending to reduce the risk of severe injury to persons or damage to the blender."
11. Do not operate the product if it has a damaged power cord or plug, malfunctions, or is dropped or damaged. This product has no user-serviceable parts. Do not attempt to examine or repair this product yourself. Only qualified service personnel should perform any servicing; take the product to the appliance repair shop of your choice for inspection and repair.

TO REDUCE THE RISK OF PERSONAL INJURY

This product is intended for use in blending food products; do not use the product for any other purpose:

1. Keep the product out of the reach of children and pets. This product is not intended for use by children.
2. Do not leave the product unattended while it is in use, especially when children are present. Extra caution is necessary when using this product near children. Always unplug the product from the electrical outlet when it is not in use.
3. Do not use attachments, including canning jars, not recommended or sold by the manufacturer. The use of attachments, including canning jars, not recommended by the manufacturer may cause a risk of injury to persons.
4. This product contains exposed sharp metal blades. Use extreme caution when handling.
5. Avoid contact with moving parts.
6. Always operate blender with cover in place.
7. Always operate the product on a flat, level, stable surface to avoid overturning it.
8. Ensure the product is off before adding or removing parts. Do not attempt to place the Pitcher onto the Base while the motor is running. Do not attempt to remove the Pitcher from the Base while the motor is running.
9. Correctly attach the blade assembly to the pitcher correctly before putting the Pitcher onto the Base. To reduce the risk of injury, never place cutter-assembly blades on the base without pitcher properly attached.
10. When blending hot liquids, remove center piece of two-piece cover.
11. After operating continuously for three minutes, wait at least one minute before operating the product again to help prevent the motor from overheating.
12. Do not run motor while Pitcher is empty.
13. This product is intended for indoor, non-commercial, non-industrial, household use only. Do not use outdoors.
14. Do not let cord hang over the edge of a table or counter.
15. This product uses a short power cord to reduce the risk of personal injury resulting from becoming entangled in or tripping over a longer cord.

WARNING: This product is equipped with a polarized plug (one blade is wider than the other blade) to reduce the risk of electrical shock. This is a safety feature. The plug will fit into a polarized outlet only one way. If you are unable to insert the plug into the electrical outlet, try reversing the plug. If the plug still does not fit, contact a qualified electrician. Never use the plug with an extension cord unless you can fully insert the plug into the extension cord. Do not alter the plug. Do not attempt to defeat the safety purpose of the polarized plug.

PARTS

1. Plastic Lid with Feeding Hole
2. Pitcher
3. Plastic Ring
4. Blades and Spin Base
5. Motor Drive Coupling
6. Motor Housing
7. Panel Control

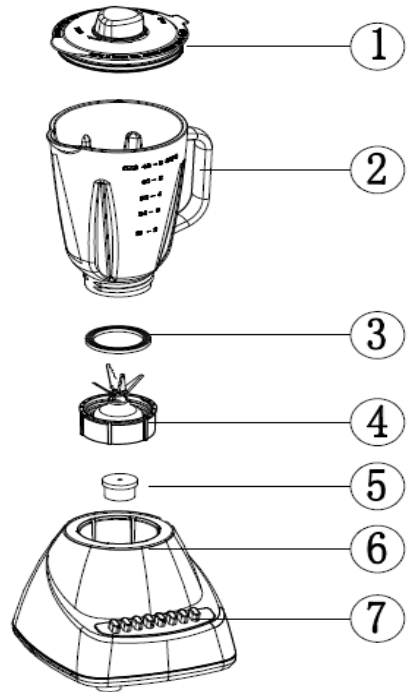

SAVE THESE INSTRUCTIONS!
FOR HOUSEHOLD USE ONLY

TO ASSEMBLE

WARNING:

- Do not activate or plug the product into an electrical outlet until the product is completely assembled.
 - The Blades of the product are very sharp; handle with care.
1. Ensure the product is unplugged from the electrical outlet.
 2. Place the Motor Housing on a flat, stable surface.
 3. Wash and dry the Pitcher.
 4. Ensure the Plastic Ring is attached around the Spin Base.
 5. Insert the Blades and Spin Base into the bottom of the Pitcher and turn clockwise (follow the arrows inscribed on the bottom of the Spin Base) until the plastic latches of the Pitcher bottom and the Spin Base lock into place.
 6. Place the Pitcher onto the Motor Housing ensure the Motor Drive Coupling and the fittings located on top of the Motor Housing are aligned.
 7. Twist the Pitcher counterclockwise until the plastic latches of the Pitcher and the Motor Housing lock into place.

NOTE: Ensure the arrow below the Pitcher handle is aligned with the arrow below the plastic latch of the Motor Housing.

8. Place the Plastic Lid on top of the Pitcher and secure it into position.

NOTE: The Pitcher handle has a slide release mechanism to hold the Plastic Lid to the Pitcher. Make sure the Plastic Lid is always securely in place on top of the Pitcher before operating the product.

OPERATION

1. Wash the ingredients you want to blend and cut them into pieces small enough to fit into the Plastic Lid Feeding Hole.
2. Once cleaned and cut, add the ingredients into the blender through the Plastic Lid Feeding Hole. NOTE: The Pitcher has a six cup (48 oz. / 1.5 liter) capacity. Do not overload the Pitcher with ingredients.
3. After filling the Pitcher with ingredients, secure the Plastic Lid with Feeding Hole into position. Plug the product into a standard 120-volt AC electrical outlet.

4. Push the desired blender speed button (e.g., CHOP, PUREE).

CAUTION: Never operate the product's motor for more than a few minutes at a time. Select and depress a blender speed button, allow the motor to cool for a few seconds; then press the blender speed button again until you achieve the desired results.

5. To turn off the product, press the "OFF" Button on the 10-Speed Control Panel.
6. Unplug the product from the electrical outlet when finished blending ingredients, when the product is not in use, or if leaving it unattended.

CAUTION: Do not use the product for blending heavy foods or thick mixtures.

NOTE: The PULSE Button can be used for more control during short processing jobs to run the blender motor at a high speed. When finished processing ingredients with the PULSE Button feature, release the PULSE Button to turn off the product.

CLEANING AND MAINTENANCE

WARNING: Always unplug the product from the electrical outlet before assembling, disassembling, or cleaning it.

MAINTENANCE

If the product's motor does not run freely while blending ingredients, perform one or more of the following steps, as necessary:

1. Press the OFF Button and add water to the ingredients
2. Press the PULSE Button for a few minutes and the motor blends freely
3. Press the OFF Button, unplug the blender from the electrical outlet and use a rubber spatula to clear the sides of the Pitcher and push the ingredients toward the Blades
4. Reduce the amount of ingredients inside of the Pitcher

CLEAN

1. Clean the product immediately after each use. Before cleaning and putting your hands and fingers inside of the Pitcher, remove the Pitcher from the Motor Housing and the Plastic Lid, Blades and Spin Base from the Plastic Pitcher.
2. Use a small toothbrush (not included) to remove particles of food lodged underneath the Blades.
3. Clean the exterior surface of the Motor Housing by wiping it with a soft, damp cloth.
4. Do not use abrasive cleaners or scouring pads to clean the product.
5. To clean the Pitcher, add $\frac{1}{4}$ teaspoon of liquid soap to the Pitcher and fill with warm water. Place the Pitcher on the Motor Housing and press the PULSE Button several times for a few seconds. Remove the Pitcher from the Motor Housing and rinse the Pitcher underneath running water.

CAUTION: Do not place the Pitcher and the Plastic Lid into a dishwasher or extremely hot water.

6. Dry all product parts thoroughly before storing.
7. Store the product in a clean, dry place with the Plastic Lid removed from the Pitcher.

ELECTRICAL SPECIFICATIONS

Voltage	Frequency	Power
120VAC	60HZ	400W

iCucina Limited Warranty

LIMITED ONE-YEAR WARRANTY: Thank you for choosing iCucina 700W Countertop Blender. This product is warranted to be free from defects in material and workmanship under normal household use during the first one year from the date of original purchase with receipt. We will repair or replace it at our option. The limited warranty shall not apply to damages resulting from accidents, abuse, misuse, damage caused by shipping, or failure to follow safety instruction. The warranty is valid only for first quality goods purchased from an authorized resale and only valid in the United States.

Customer Service Information:

If you have any questions regarding to the warranty, the operation of iCucina appliances, or need parts for your appliance, please contact us via email: service@icucinakitchen.com. Inquires will be answered promptly. Thank you and we are happy to be cooking with you!



Thimax Inc. Irvine, CA92618