

# ASSEMBLY INSTRUCTIONS

ITEM DESCRIPTION : WALL MOUNTING OPEN MEDIA UNIT



1. Insert the plastic dry wall anchor inside the hole drilled into the wall through the wooden support



2. Thread the metal screw through the plastic washer until it threads till the wall

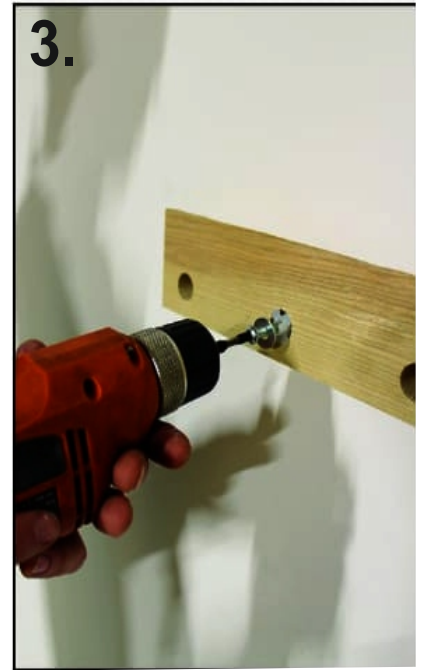

3. Secure the screws tight into the hole drilled in the wall with the help of drill



4. Fix all the screws firmly in the 5 slots provided

---

## WALL MOUNTING INSTRUCTIONS

---

