

ASSEMBLY INSTRUCTIONS

Read this instruction carefully. Refer hardware and furniture parts list for guidance. Be sure all parts are complete, before assembling. Place all wooden furniture part on a clean and flat soft surface to prevent scratches. Refer steps provided as assembling guide.

CAUTIONS :

1. Do not **FULLY-TIGHTEN** the nuts or nut bolts until all are in place.
2. To prevent thread damage. Ensure that nuts or nut bolts are not over-tighten.
3. Hardware are to be kept out of reach from children.

PART LIST			HARDWARE LIST		
ITEM	DESCRIPTION	QTY	ITEM	DESCRIPTION	QTY
A	HEADBOARD	1 PC	1	JCBB SCREW M8 x 16MM	8 PCS
B	FOOTBOARD	1 PC	2	ALLEN KEY M5 (SHORT)	1 PC
C	SIDE TABLE	2 PCS	3	JCBC SCREW M6 x 50MM	5 PCS
D	SIDE RAIL (L & R)	2 PCS	4	SPRING WASHER 1/4"	5 PCS
E	SLAT	11 PCS	5	PAN HEAD SCREW M4 x 25MM	28 PCS
F	CENTER SLAT	1 PC	6	PAN HEAD SCREW M4 x 32MM	16 PCS
G	CENTER SLAT SUPPORT	3 PCS	7	ALLEN KEY M4 BALL SHAPE (LONG)	1 PC
H	SLAT WITH HOLE	3 PCS	8	ADJUSTABLE SCREW	3 PCS
			9	WOOD DOWEL DIA Ø8 - 25mm	16 PCS
			10	FLAT WASHER 1/4"	2 PCS

STEP 1

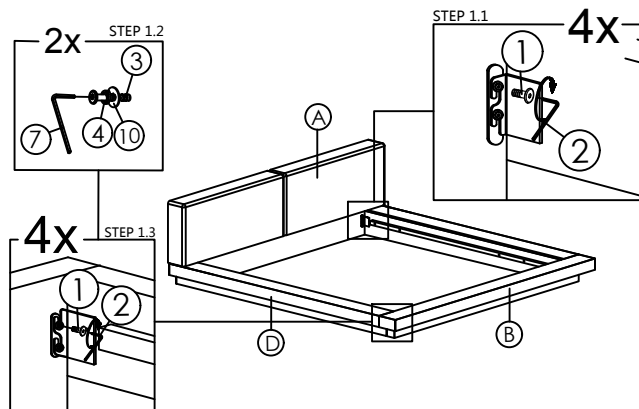

STEP 2

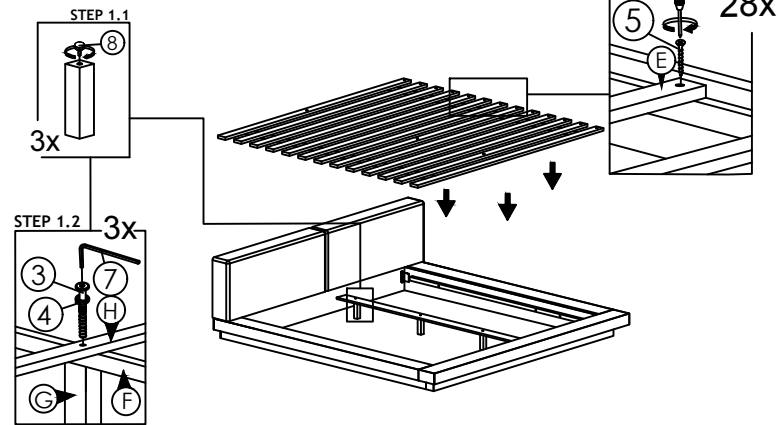

STEP 3

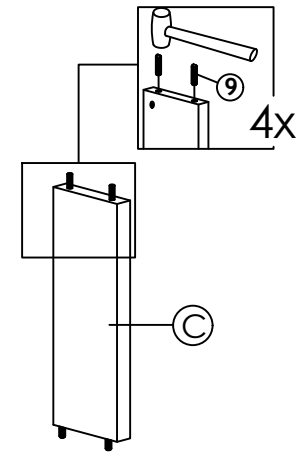

STEP 4

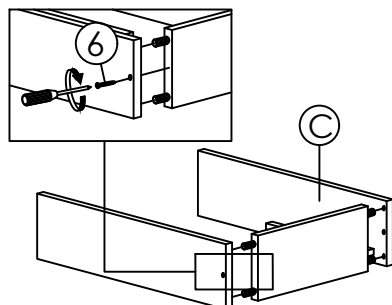

STEP 5

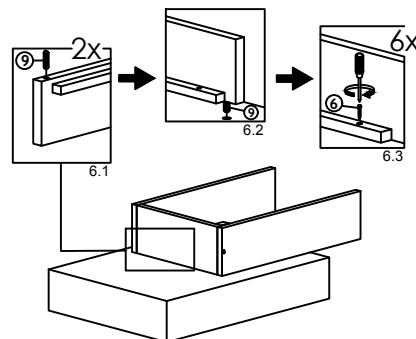

STEP 6

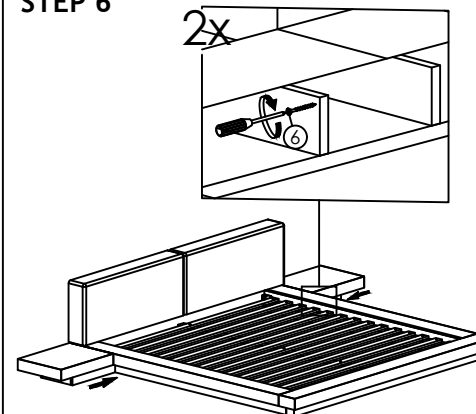

STEP 7

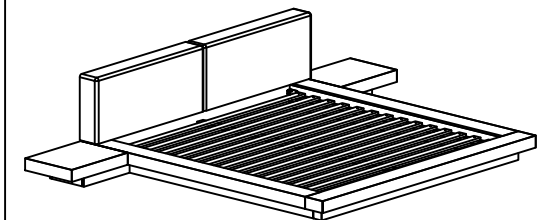

ASSEMBLY COMPLETED