

ECOSELF

SLOW JUICER USER MANUAL

SJ-050C

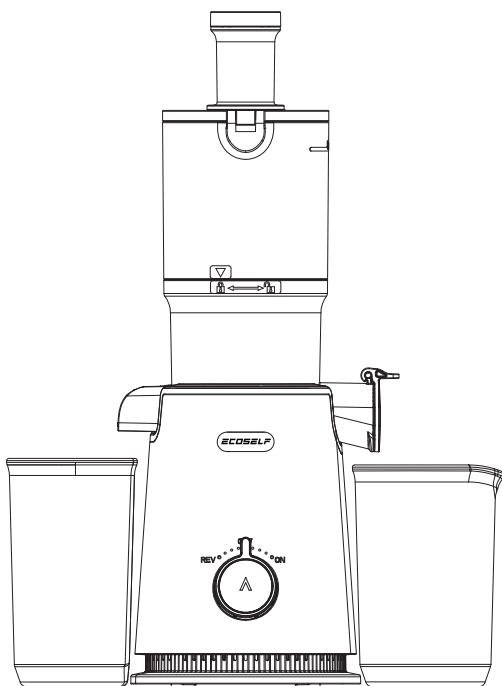

Before using the device for the first time, please read through these operating instructions carefully and keep them for future reference and other users. They form an integral part of the device.

CONTENTS

PRECAUTIONS FOR SAFETY USE	01
KNOW YOUR JUICER	02
HOW TO ASSEMBLE	04
HOW TO USE	05
HOW TO DISASSEMBLE & CLEAN	06
MAINTENANCE	08
TROUBLE SHOOTING	09
SPECIFICATIONS	11
WARRANTY	12

**REGISTER
NOW!**

for an additional

**12 months
Warranty**

As a special thank-you for registering your ECOSELF unit, you'll automatically receive an additional 12 months added to your limited manufacturer's warranty!

All you need to do is send your order ID to our service Email: support@myecoself.com, or enter your order ID to activate the extended warranty online at www.myecoself.com/?vipwarranty.



FREE upgrade to FULL Replacement Guarantee - no need to return.



Once registered, you will be ensured that if anything goes wrong with your product, we will either send you a brand new unit as a replacement (Absolutely FREE) or provide a FULL refund of your order.



Just send your Amazon Order ID to Email support@myecoself.com or scan the QR code to activate the extended warranty.



Send:

Subject:

Order ID:



NOTE: Must register within 7 days after receiving your new product.

PRECAUTIONS FOR SAFETY USE

When using electrical appliances, basic safety precautions should always be followed including the following.

1. READ ALL INSTRUCTIONS BEFORE USING.
2. To protect against electrical shock, do not immerse cord, plug, or main body (motor) in water or other liquid.
3. Close supervision is necessary when any appliance is used by or near children.
4. Unplug from outlet when not in use, before putting on or taking off parts, and before cleaning.
5. Avoid contact with moving parts. Unplug from outlet when not in use, before putting on or taking off parts, and before cleaning.
6. Do not operate any appliance with a damaged cord or plug or after the appliance malfunctions or has been damaged in any manner. Please contact our customer service (Email: support@myecoself.com) for examination, repair, or electrical or mechanical adjustment.
7. The use of attachments not recommended or sold by manufacturer may cause fire, electric shock or injury.
8. Do not let cord hang over edge of table or counter or touch heated surfaces.
9. Always make sure juicer cover is clamped securely in place before motor is turned on. Do not unfasten clamps while juicer is in operation.
10. Be sure to turn switch to OFF position after each use of your juicer. Make sure the motor stops completely before disassembling.
11. Do not put your fingers or other objects into the juicer while it is in operation. If food becomes lodged in opening, use food pusher or another piece of fruit or vegetable to push down the lodged food. When this method is not possible, turn off the machine, remove the plug from wall outlet and disassemble juicer to remove the remaining food.
12. Do not use outdoors.
13. Do not place on or near a hot gas or electric burner or in a heated oven.
14. Do not use appliance for anything other than its intended use.
15. Keep hands and utensils away from moving blades or discs while processing food to reduce the risk of severe injury to persons or damage to the food processor.
16. DO NOT plug in until familiar with all the instructions and operating procedures.
17. DO NOT unplug from electrical outlet by pulling on the cord. To unplug, grasp the plug, not the cord, and pull.
18. Turn off all controls before unplugging from or plugging into an electrical outlet.

19. This appliance cannot grind meat.
20. Moving parts – Keep fingers out of discharge openings.
21. Do not clean the appliance with steel wool, abrasive cleaning agents or corrosive liquids (such as gasoline or acetone).
22. Always disconnect the appliance from the supply if it is left unattended and before

KNOW YOUR JUICER

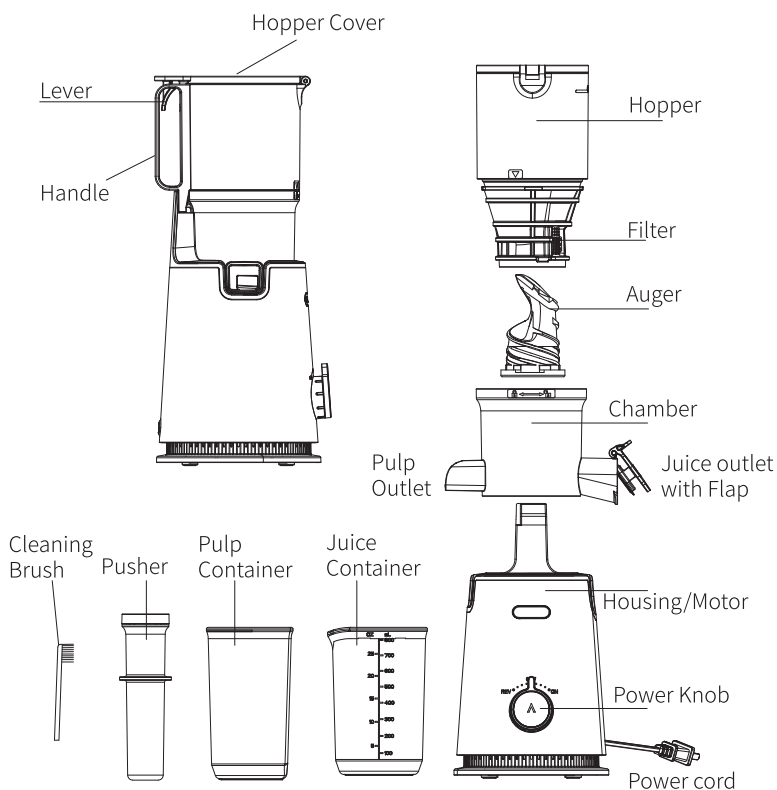

Power Knob (ON/OFF/REV)

“ON”: Switch the power knob to “ON” to start.

“OFF”: When juicing finished, switch to “OFF” to stop.

“REV”: Switch to “REV” to back up the ingredients when clogged.

Note: Press and hold the “REV” to back up. When release, appliance stops.

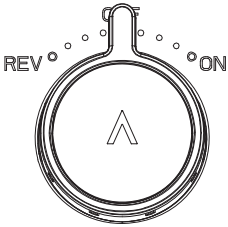

Note: Before plug in the Power Cord, confirm that machine is switch to “OFF” to avoid danger.

HOW TO ASSEMBLE

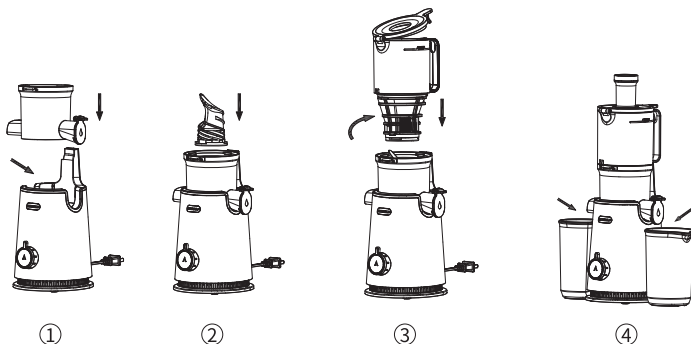

1. Place the Chamber onto the top of Housing.

Note: Make sure the Silicone Valve of the Chamber is well closed before assemble.

If it is opened, close it properly and tightly by pressing.

Silicone Valve Closed

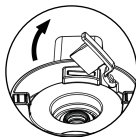

Silicone Valve
Opened

2. Insert the Auger firmly into the center Chamber.

3. Open the Hopper Cover by pressing the Lever.

Position the Hopper vertically onto the Chamber.

Align the hopper assembly guide mark “▼” with the Chamber assembly guide mark “☐”.

4. Turn the Hopper clockwise up to the Chamber assembly guide mark “☐” to assemble them. If the internal parts are not assembled correctly, the hopper will not close.

Note: Do not close the Hoper Cover until juicing starts.

HOW TO USE

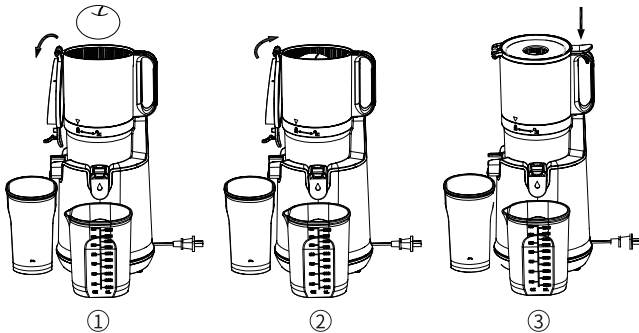

1. Add ingredients only up to the limit mark of the Hopper.

Note: For soft ingredients, mix them with other ingredients for extraction.

2. Close the Hopper Cover and keep the Juice Cap open.

- Before pressing the Power knob, place the Juice Container and Pulp Container first.
- The juice may flow backwards into the Hopper if the Juice Cap is closed during extraction.

3. Switch to “ON” to start.

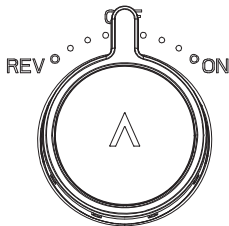

4. To add more ingredients during operation, use the additional inlet or open the Hopper Cover.

- When the Hopper Cover is opened, the operation stops.
- Do not use anything other than the designated Pusher.

5. When clogged, Switch to “REV” to back up the ingredients.

- Press and hold the “REV” to back up. When release, appliance stops.

6. When juicing finished, switch to “OFF” to stop the machine.

HOW TO DISASSEMBLE & CLEAN

After the product stops operating completely, turn off and pull the power cord plug with dry hands.

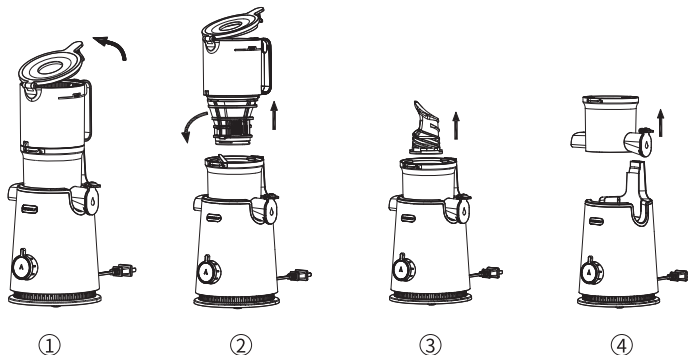

1. Open the Hopper Cover by pressing the Lever.
2. Turn the Hopper anti-clockwise until the Hopper assembly guide mark “▽” aligns with the Chamber assembly guide mark “▽”, and lift it upward vertically to remove.
3. Remove the Auger by pulling it upward.
4. Remove the Chamber by lifting it upward vertically.
5. Rinse each part with the cleaning brush. Brush the inside and outside of each part thoroughly under running water.

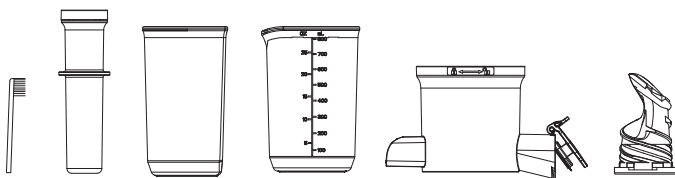

IMPORTANT :

Detach the Silicone Valve (at the button) to clean the Chamber.

After cleaning, close it properly and tightly. Otherwise, juice leakage occurs.

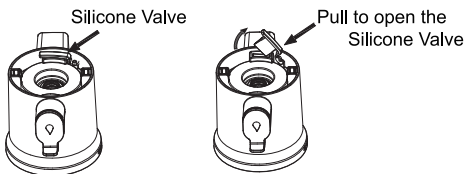

6. Wipe the Housing with a damp towel or soft cloth.

7. After cleaning, allow the parts to air-dry completely and store in a clean and safe place.

- Be sure to clean and air-dry it completely immediately after use and store it in a clean place.
- Without prompt cleaning, the pulp residue may dry and crust on the parts, making it difficult to disassemble or clean at a later time.
- Improper cleaning may also cause decreased performance of the appliance.
- Do not clean with steel sponge, abrasives and other sharp cleaning tools.

MAINTENANCE

1. Clean and airdry it completely immediately after use.
2. Before cleaning this product, be sure to unplug the power cord.
3. The Housing cannot be washed under water.

Tips: Wipe the Housing with a damp towel or soft cloth

4. Clean and airdry it completely before storing.

TROUBLE SHOOTING

Before contacting customer service, reviewing this list can save time. This list includes the most common occurrences that are not the result of defective workmanship or materials in this juicer.

Problem	Solutions
The appliance does not work.	Check if the power cord is properly inserted.
	Check if the hopper is assembled properly. If the hopper has not been locked into place, the appliance will not operate for safety reasons.
	Check if the appliance has been assembled according to the directions given in the manual.
An unusual noise is heard while juicing.	It is a natural sound produced when ingredients are being crushed. If the ingredients are hard or tough like apples, carrots, etc., the extraction noise may be louder than that heard when juicing softer ingredients. Recommended: You can juice apple with lower noise by peeling.
The appliance stops during normal operation.	The appliance has operated continuously for long time. Your ECOSELF motor is designed to protect itself from overheating. Disconnect the appliance from the supply for up to 30 minutes to reset. Reset time will be extended if high room temperatures exist.
The Chamber shakes when squeezing.	Depending on the texture of the ingredient, there may be slight to more pronounced shaking of the appliance. There is some level of shaking when the auger is rotating. This is a normal occurrence and not a malfunction. Hard ingredients (e.g. carrot, potato, radish, beet, etc.) may cause more shaking than soft ingredients.

<p>The hopper does not open.</p>	<p>Before disassemble the Hooper, open the Hopper Cover by pressing the Lever. For safety reason, the Hooper cannot be disassembled without Hooper Cover opened.</p>
<p>Juice leaks over the base.</p>	<p>Make sure appliance is assembled properly. Overloading may be the problem. If the chamber is overloaded with ingredients, the extraction seal may be pushed out of position. Always juice manageable amount of ingredients at a time and avoid processing heavy loads. Open the Juice Cap when juicing.</p>
<p>Juice leaks through the pulp outlet immediately after the ingredients are inserted.</p>	<p>This is not a product defect but, rather, a normal phenomenon. The leakage will stop after seconds' running.</p>
<p>During the early uses the motor generates unpleasant smell.</p>	<p>It is a normal phenomenon. If this phenomenon occurs frequently, contact after sales support email: support@myecoself.com</p>
<p>Juice flows back into the hopper.</p>	<p>Extract juice with the juice cap opened. When juicing with the juice cap closed, the juice may flow backward into the hopper. If the contents are not sufficiently discharged even after opening the juice cap again, open the hopper cover and empty out the contents.</p>
<p>Auger or accessories are dyed after use.</p>	<p>It is a normal phenomenon due to specific veggies such as carrot.</p>

SPECIFICATIONS

Product Name	Slow Juicer
Model Name	SJ-050C
Rated Voltage	AC 120V
Rated Frequency	60Hz
Rated Power Consumption	200W
Capacity	Juice Cup 27oz (800ml)
	Pulp Container 23.7 oz (700ml)
Continuous Operating Time	≤20 min.
Time Interval	≥20 min.

WARRANTY

We are delighted that you have chosen the ECOSELF slow juicer and hope you have a fun with it. The manufacturer's warranty covers the product for a period of 12 months from the date of purchase against manufacturing faults.

If you have any questions about the device and about spare parts/accessories, contact the customer service department via:

 support@myecoself.com

 www.myecoself.com

 facebook.com/Ecoself.Official

Through the following channels,
you can quickly contact us.



support@myecoself.com



www.myecoself.com



facebook.com/Ecoself.Official