

DEERTALK

Smart RGB Flush Ceiling Light

WiFi



Smart Life



Tuya Smart



User Manual

READ BEFORE INSTALLATION

SAVE THESE INSTRUCTIONS

Please read and understand this entire manual before attempting to assemble, operate or install this product. This product must be installed in accordance with any applicable installation code(s) by a qualified electrician or person familiar with the construction and operation of the product and the hazards involved.

1. **WARNING: RISK OF SHOCK.** House electric current can cause painful shock or serious injury unless handled properly. For your safety, always remember to:
 - A. Turn off the power supply at the fuse or circuit breaker box before you install the fixture.
 - B. Ground the fixture to avoid potential electric shocks and to ensure reliable starting.
 - C. Double-check all connections to be sure they are tight and correct.
 - D. Wear rubber soled shoes and work on a sturdy ladder.
2. This fixture is designed for use in a circuit protected by a fuse or circuit breaker. It is also designed to be installed in accordance with local electrical codes. If you are unsure about your wiring, consult a qualified electrician or a local electrical inspector and check your local electrical code.
3. **WARNING: RISK OF CUTS.** Some metal parts in the fixture may have sharp edges. To prevent cuts and scrapes, wear gloves when handling the parts.
4. Account for small parts and destroy packing material, as these may be hazardous to children.

NOTICE:

- All electrical connections must be in accordance with local and National Electrical Code (N.E.C) standards. If you are unfamiliar with proper electrical wiring connections, obtain the services of a qualified electrician.
- Remove the fixture and the mounting package from the box to make sure that no parts are missing by referencing the illustrations on the installation instructions.



CAUTION: Turn off the main power at the circuit breaker before installing the fixture in order to prevent possible shock.

This device complies with part 15 of the FCC Rules. Operation is subject to the following two conditions: (1) This device may not cause harmful interference, and (2) this device must accept any interference received, including interference that may cause undesired operation. Note: This equipment has been tested and found to comply with the limits for a Class B digital device, pursuant to part 15 of the FCC Rules. These limits are designed to provide reasonable protection against harmful interference in a residential installation. This equipment generates, uses and can radiate radio frequency energy and, if not installed and used in accordance with the instructions, may cause harmful interference to radio communications. However, there is no guarantee that interference will not occur in a particular installation. If this equipment does cause harmful interference to radio or television reception, which can be determined by turning the equipment off and on, the user is encouraged to try to correct the interference by one or more of the following measures: Reorient or relocate the receiving antenna. Increase the separation between the equipment and receiver. Connect the equipment into an outlet on a circuit different from that to which the receiver is connected. Consult the dealer or an experienced radio/TV technician for help. Any changes or modifications not expressly approved by the manufacturer could void the user's authority to operate the equipment.

PACKAGE CONTENTS

Before beginning installation of this product, make sure all parts are present. Compare parts with package contents list and diagram. If any part is missing or damaged, do not attempt to assemble, install or operate this product.

Tools Required

- Screw driver
- Recessed lighting hole saw (recommended)
- Scissors

	COMPONENTS INCLUDED
A	(1) POWER SUPPLY BOX
B	(1) RECESSED DOWNLIGHT
C	(3) WIRE NUTS
D	(1) INSTRUCTION MANUAL

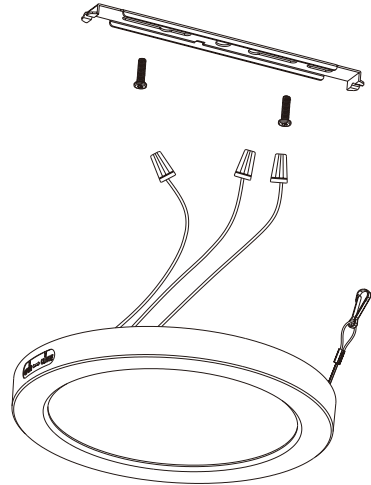

PRE-INSTALLATION REVIEW

- Turn the power OFF from the breaker panel before starting installation.
- Locate a suitable location for the fixture and cut the correctly sized hole in the drywall or ceiling tile (for a suspended T-Bar type ceiling) – refer to Hole Cut Out Template for appropriate size.
- Know the location of your joist before making any cuts.
- Run electrical wire from the switch (power supply) through the mounting hole; use NM cable or Flexible Metal Conduit Cable.

INSTALLATION INSTRUCTIONS FOR RECESSED HOUSING

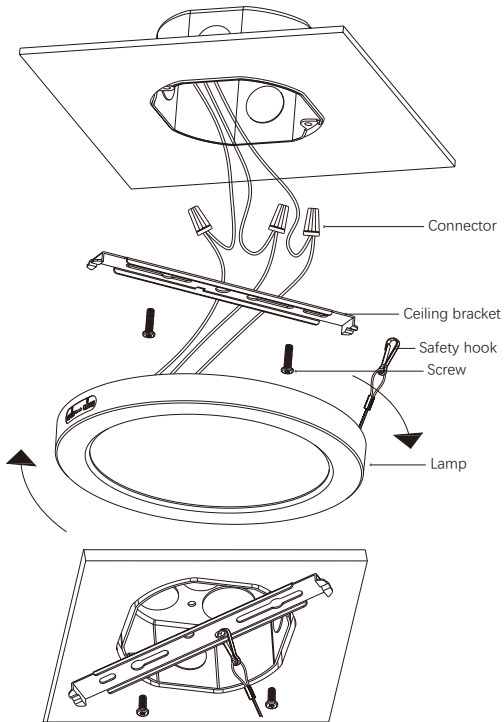

Note: Power off before installation, and set the color temperature on the lamp to the desired color temperature

1. Fix the ceiling bracket on the junction box with screws.
2. Hook the safety hook on the lamp into the bracket hole.
- Note: The mounted ceiling bracket must be flush with the top mounting surface.
3. Connect the wire, white to N, black to L, green to GND.

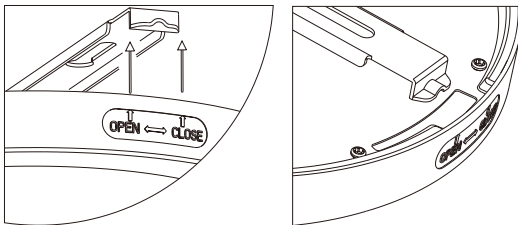

4. Align the installation groove on the back of the lamp with the installation bracket, and then push it upwards. Tighten the installation by turning it right.

APP SETUP

Step 1: Download App

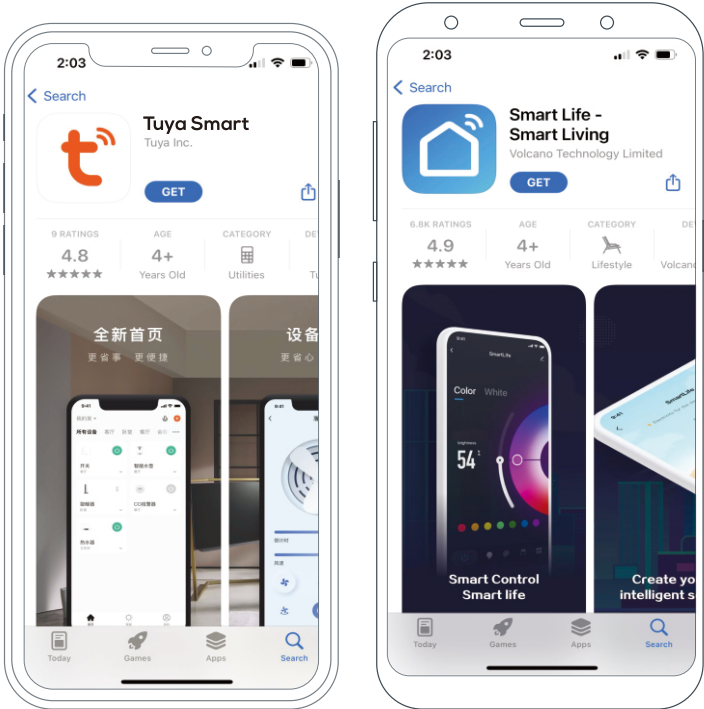

Search "Tuya Smart" or "Smart Life" on Apple App Store or Google Play Store and download it. Or scan the QR code on the user manual to download it.

Smart RGB Flush Ceiling Light

Step 2: Register and Log in

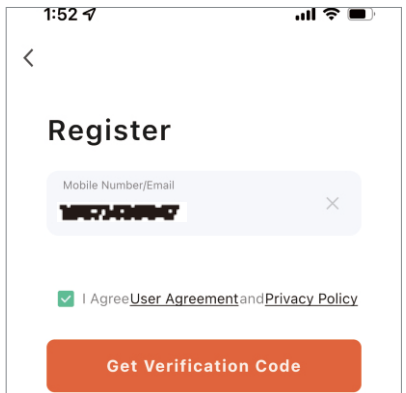
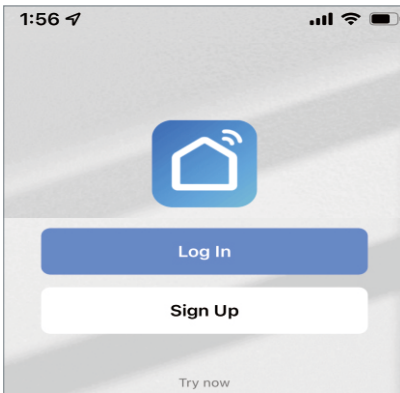
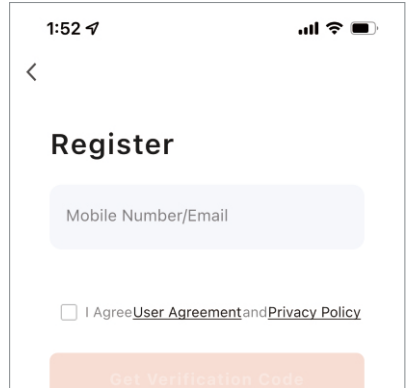
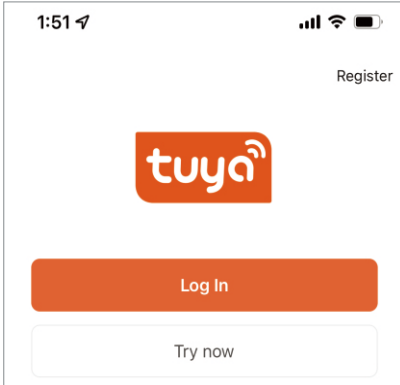

Create a new account Or
log in directly if you have
an existing account.

Enter your mobile phone
number or email address,
then get the verification code.
(Select a region before
your phone number)

Smart RGB Flush Ceiling Light

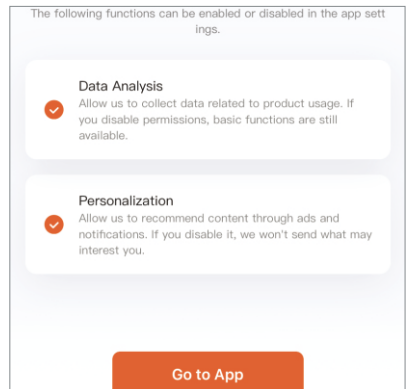
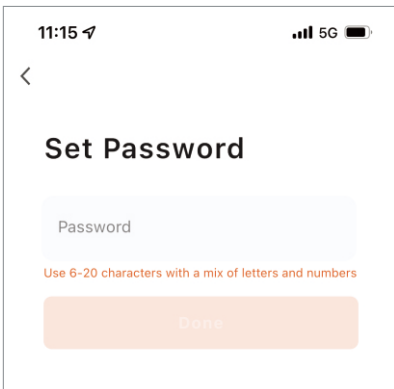
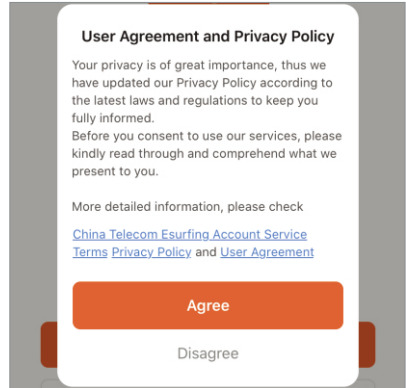
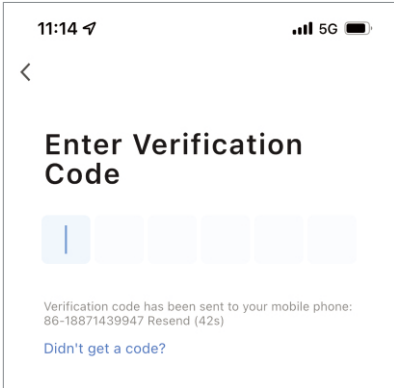

Enter the verification code and set a password, then log into the APP.

Allow relevant conditions.

Smart RGB Flush Ceiling Light

Step 3: Add Device

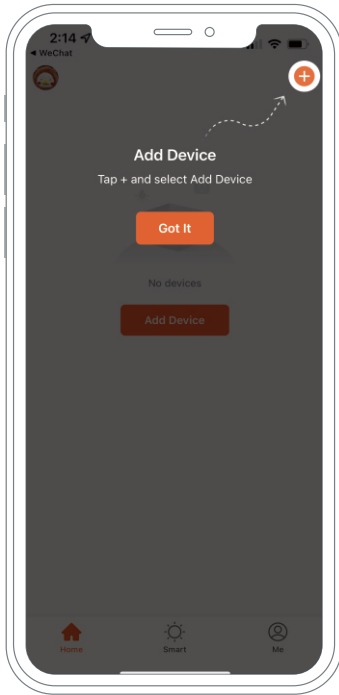

Tap + in the upper right corner.
NOTE: If this is the first device
you are setting up, you can
also select Add Device

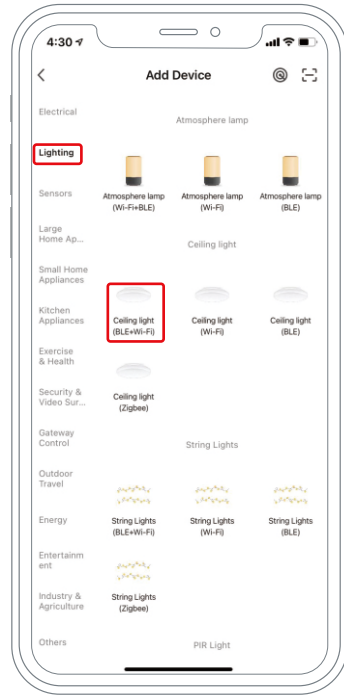

Choose "Lighting--Ceiling light
(BLE+Wi-Fi)" from the device list

Smart RGB Flush Ceiling Light

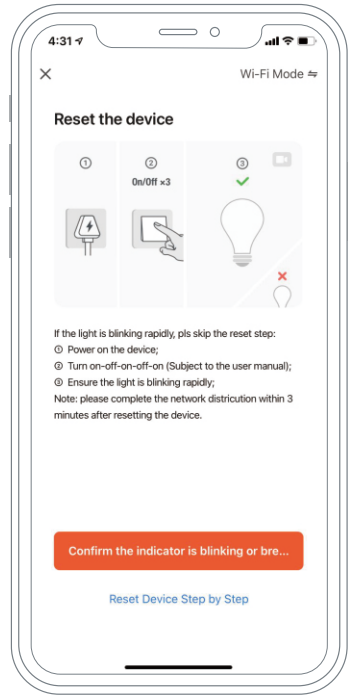
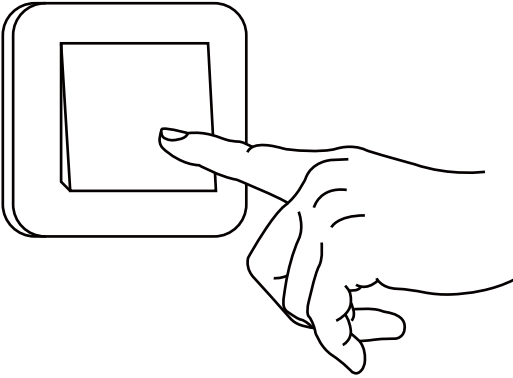

Turn the downlight ON-OFF-ON-OFF-ON-OFF-ON
until the downlight start blinking or breathing,
and then click "Confirm the indicator is blinking or breathing"

Smart RGB Flush Ceiling Light

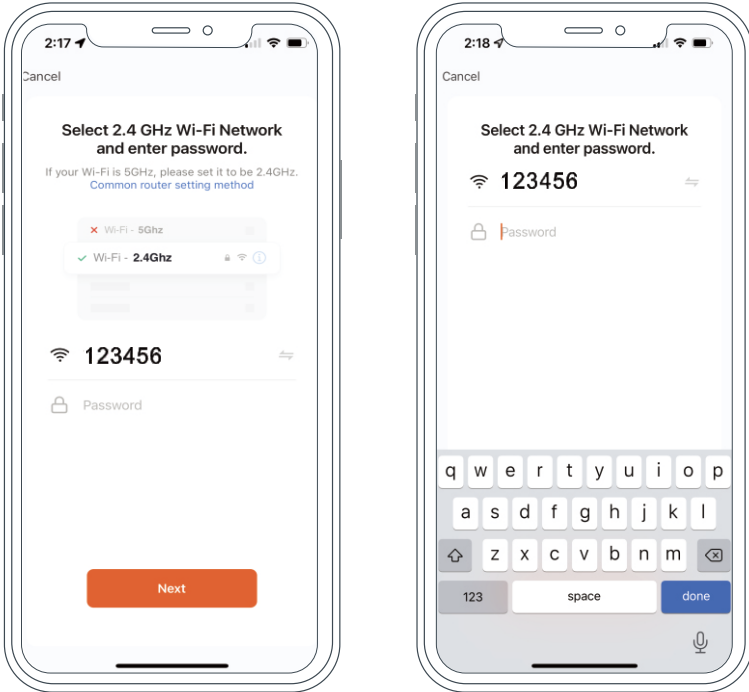

After confirming that you are on a 2.4GHz network and open bluetooth, enter your password and then tap Next.
(Make sure you are close to router)

Smart RGB Flush Ceiling Light

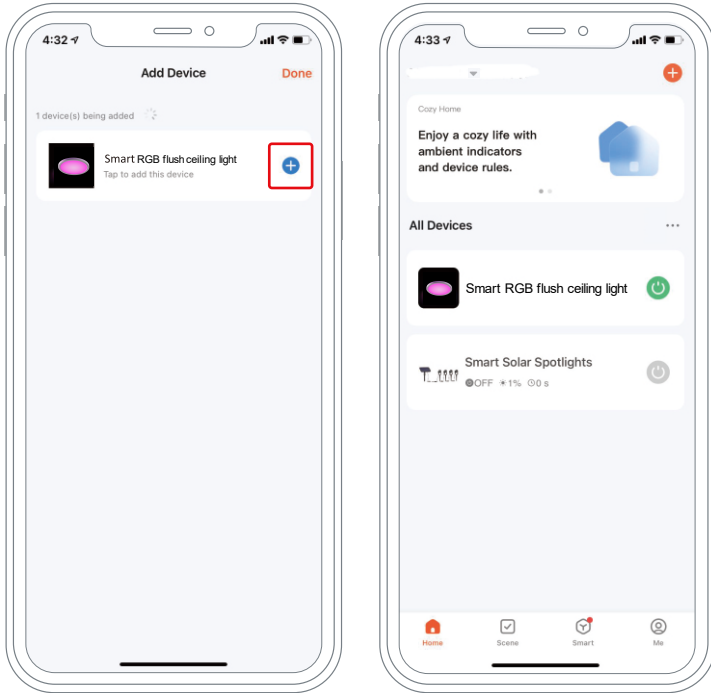

Click "+" and it will come to Home page

Smart RGB Flush Ceiling Light

White

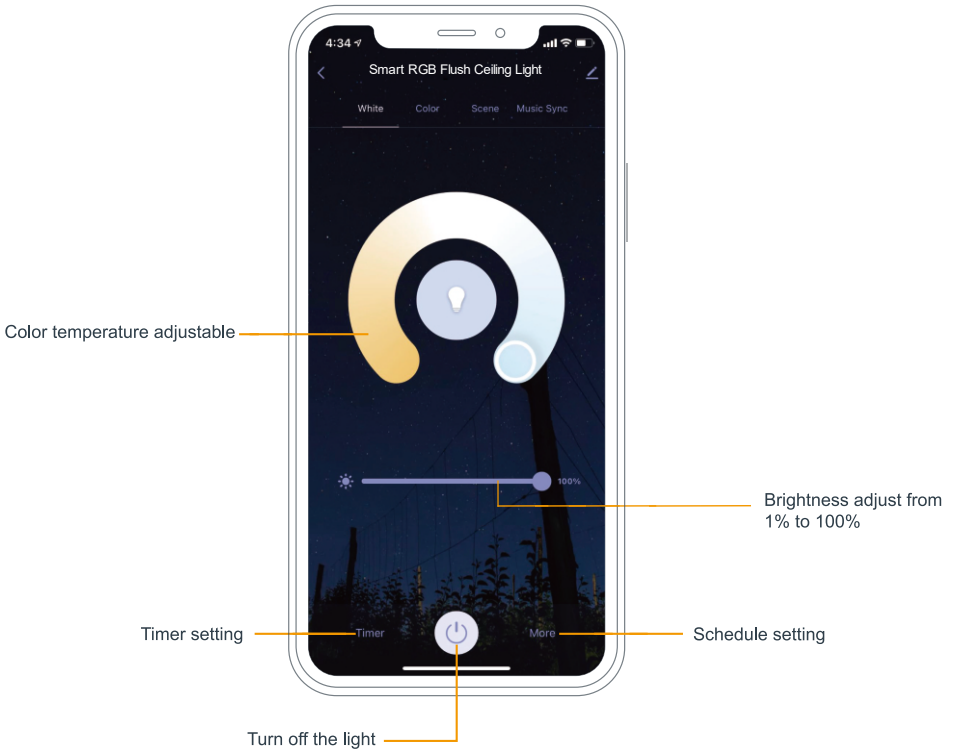

Smart RGB Flush Ceiling Light

Color



Smart RGB Flush Ceiling Light

Scene

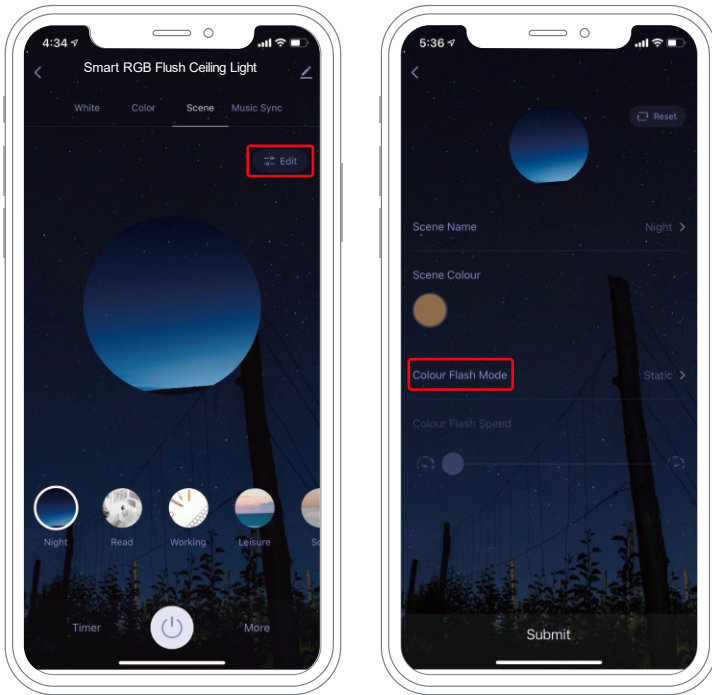

8 different scenes for choose, and you could click "Edit" and name it as you like. 3 flash mode(Static, Flash, Breath) and different flash speed for your option

Smart RGB Flush Ceiling Light

Music Sync

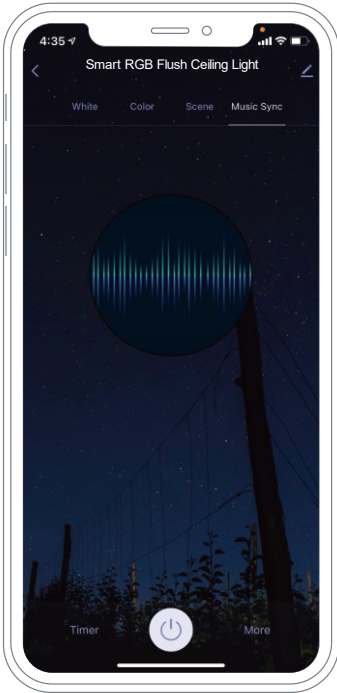

Create Group

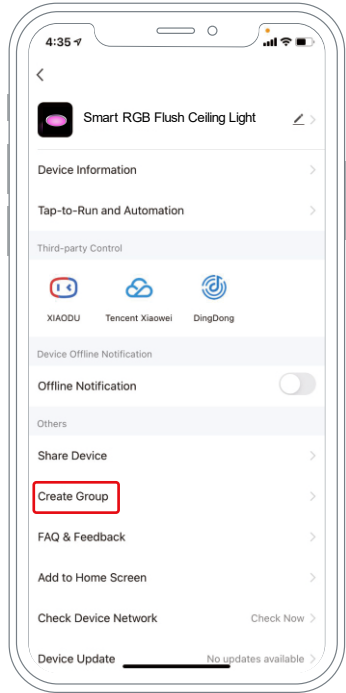

TROUBLESHOOTING TIPS

If you are having difficulty connecting:

- Make sure the Wi-Fi network is a 2.4 GHz network. Smart Wi-Fi Downlight will not connect to a 5 GHz network.
- Test your Wi-Fi network with other devices such as your phone to make sure it is operating properly.
- The Wi-Fi connection may not have good coverage during set up. Try moving the Smart Wi-Fi Downlight closer to your Wi-Fi router.
- Your Wi-Fi network password is case sensitive, make sure you are entering correctly
- The Smart Wi-Fi Downlight must be ON in order to be controlled via the mobile app. Please also check the App User Guide for more information.



Smart Life



Tuya Smart



Only supports
2.4GHz Wi-Fi
networks