

6 CONVERTING TO BED:

From sofa position, lift backrest all the way upwards until the last click is heard which unlocks the mechanism and carefully return to a flat position.

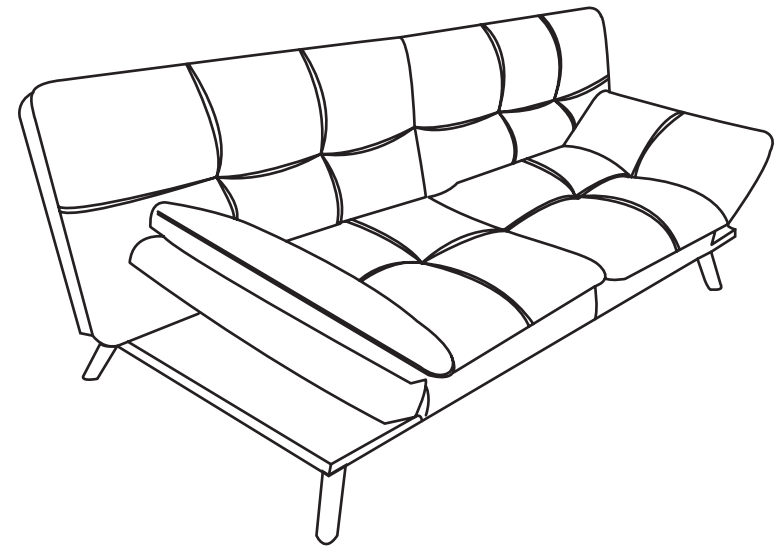
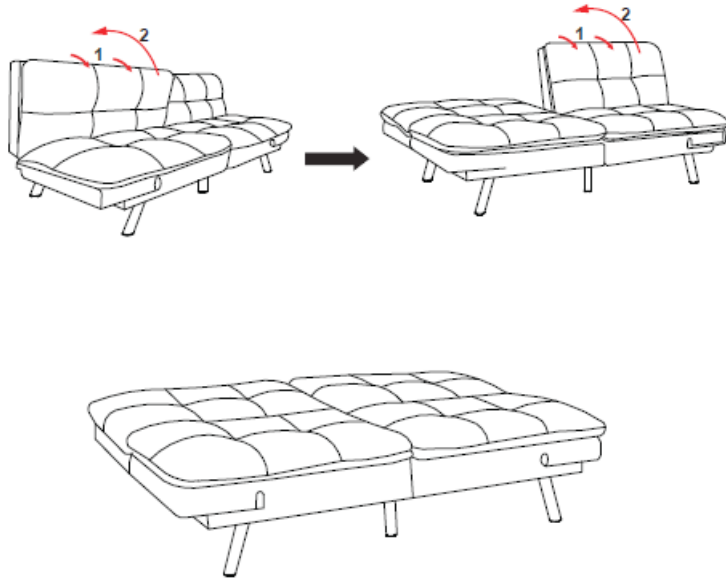

ADULT ASSEMBLY REQUIRED

If you are missing any parts or have any questions regarding assembly, do not return this item to the retailers store. Please call our toll-free, customer service number and have this assembly manual open to the parts list ready to provide the model name, number and part name or number.



PARTS

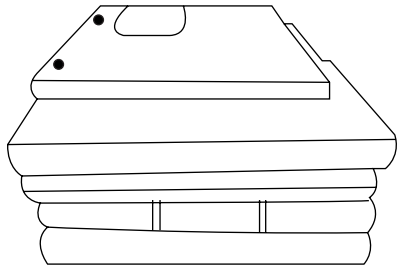

1. SOFA BODY
1X

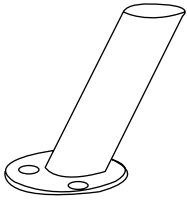

2. LEGS
4X

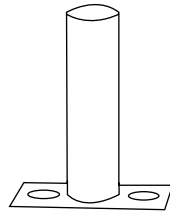

3. CENTER SUPPORT LEG
2X

HARDWARE

Please do not completely tighten any screws until the entire assembly is complete. Once assembly is complete, please be sure to tighten all hardware.



A1. SMALL BOLTS
12X



A2. LARGE BOLTS
4X



B. ALLEN KEY
1X

5 CONVERTING ARMS:

Lift armpads upward with each click sound until you reach the sofa position.

Note: Lift the armpads from the middle position to make sure both sides of ratchets are locked or unlocked at the same time.

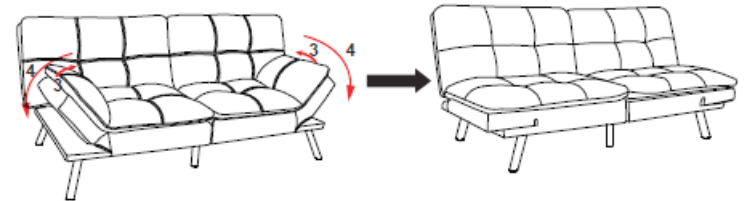
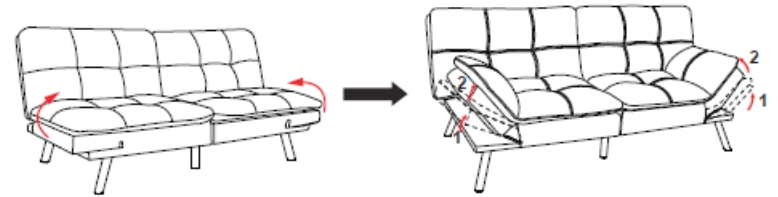

ASSEMBLY INSTRUCTIONS

4 CONVERTING TO SOFA:

In Bed (flat) position, simply lift backrest upwards with each click sound until you reach the sofa position.

Note: Lift the backrest from the middle position to make sure both sides of ratchets are locked or unlocked at the same time.

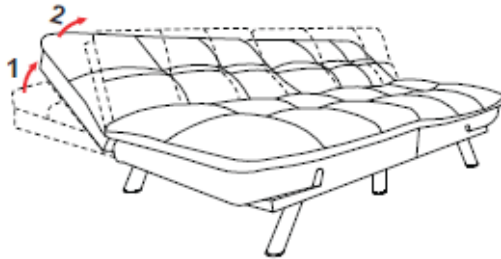
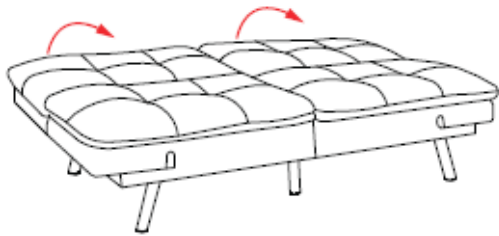

- 1 Remove all parts from the carton and place the Sofa Body (1) upside down on a protected surface or carpet.

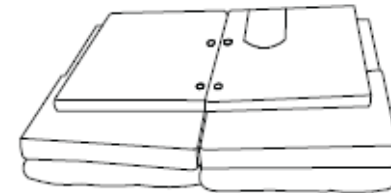
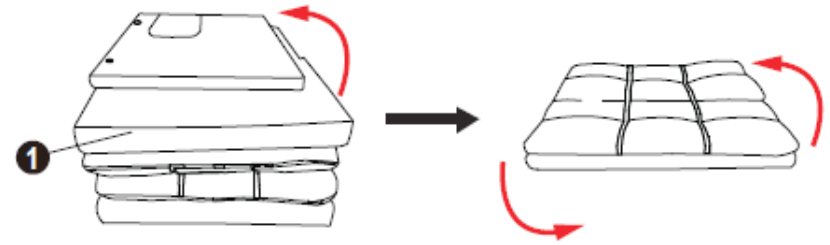

2 Open the flap on the bottom panel of Sofa Body (1) to find all Parts and Hardware.

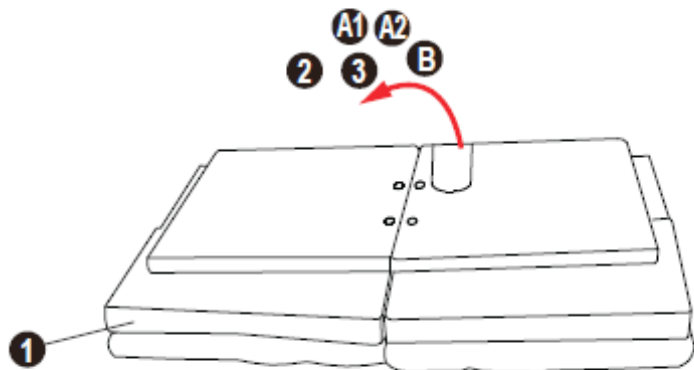

3 Attach Legs (2) to Sofa Body (1) using Small Bolts (A1). Tighten using provided Allen Key (B).

Then attach Center Support Legs (3) using Large Bolt (A2). Tighten using provided Allen Key (B).

