

Shoe Storage Cabinet

Armoire de rangement pour chaussures

Armario de almacenamiento para zapatos.

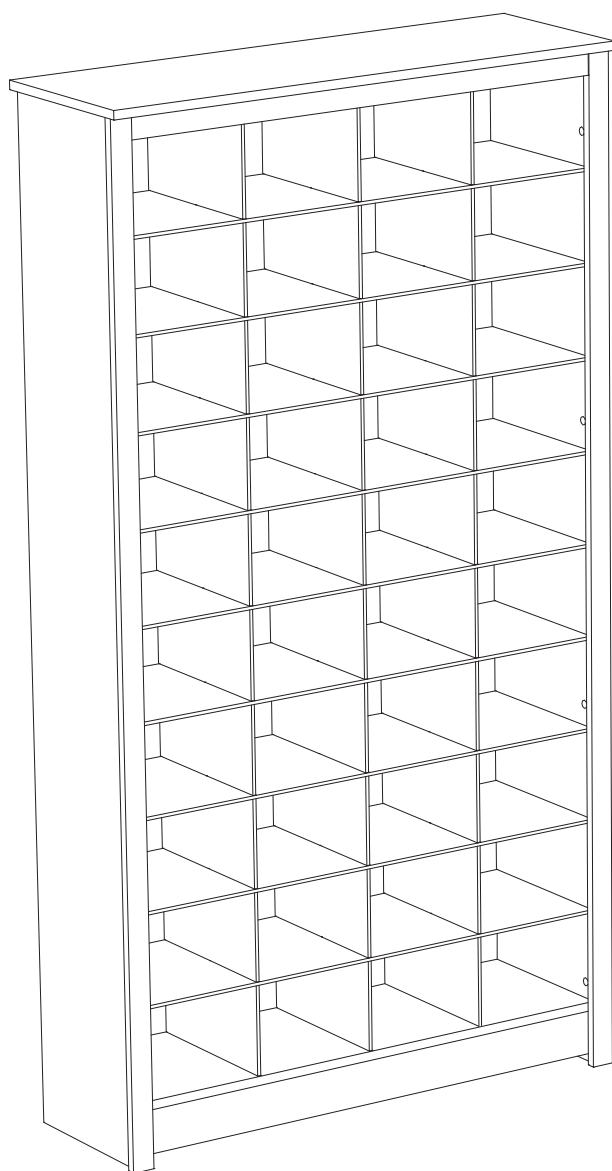

Tools

Vous aurez besoin / Necesitarás

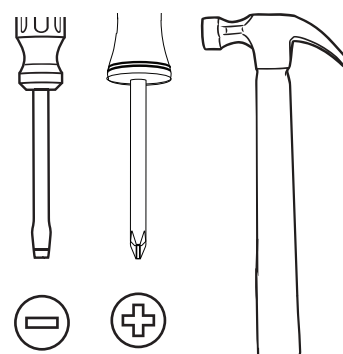

2 person recommended

2 personnes recommandées /
2 personas recomendadas

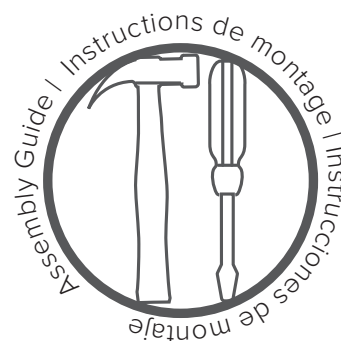

Parts

Pièces

Piezas



KR-10133



TR-10174

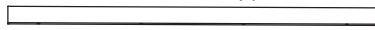

BT-10209



TP-10253

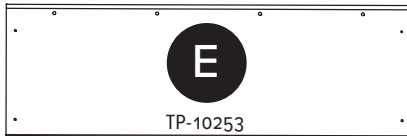

SL-10258

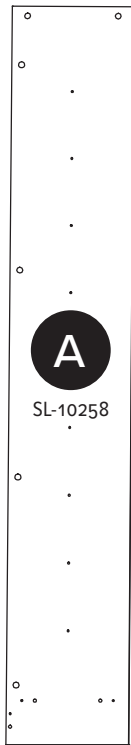

SR-10258

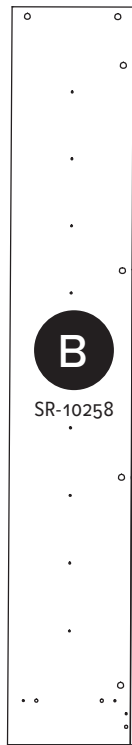

BB-10193

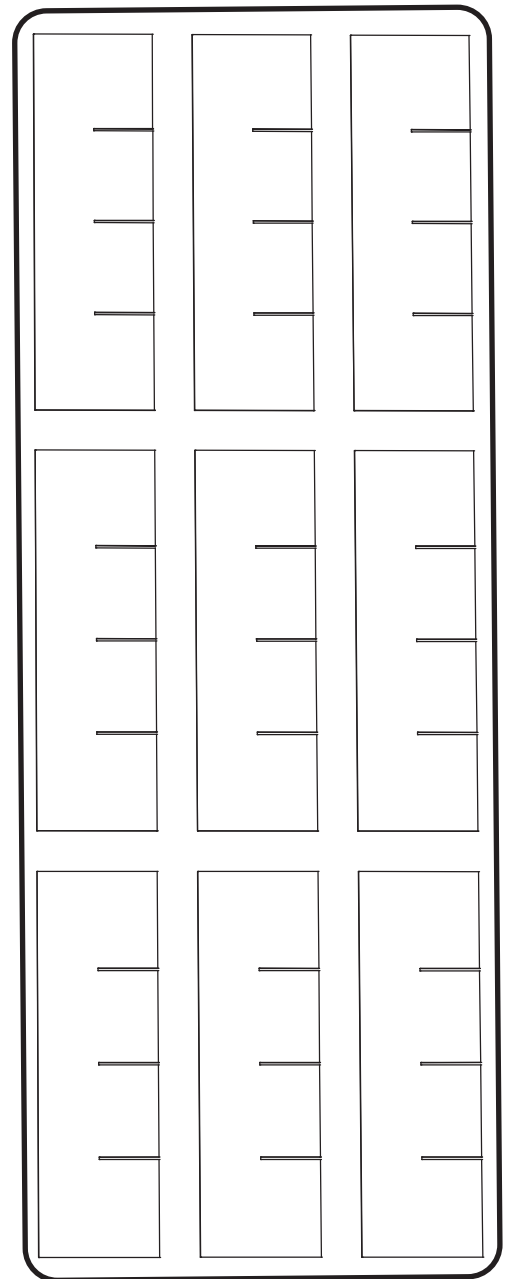
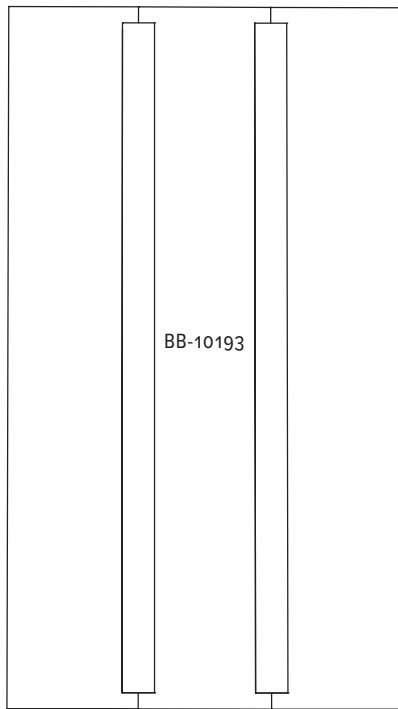

DV-10058 x9

TR-10046 x2

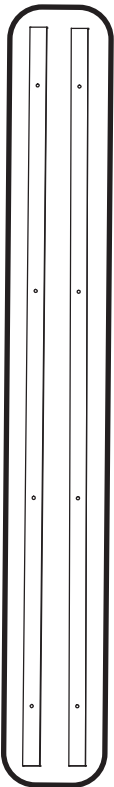

DV-10057 x3

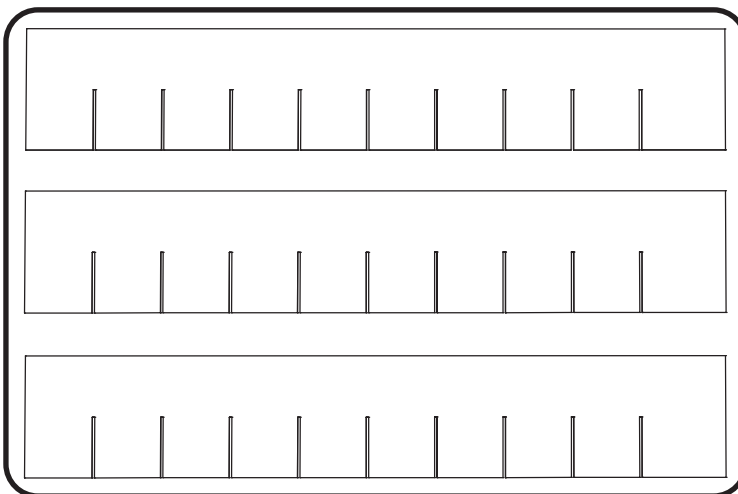

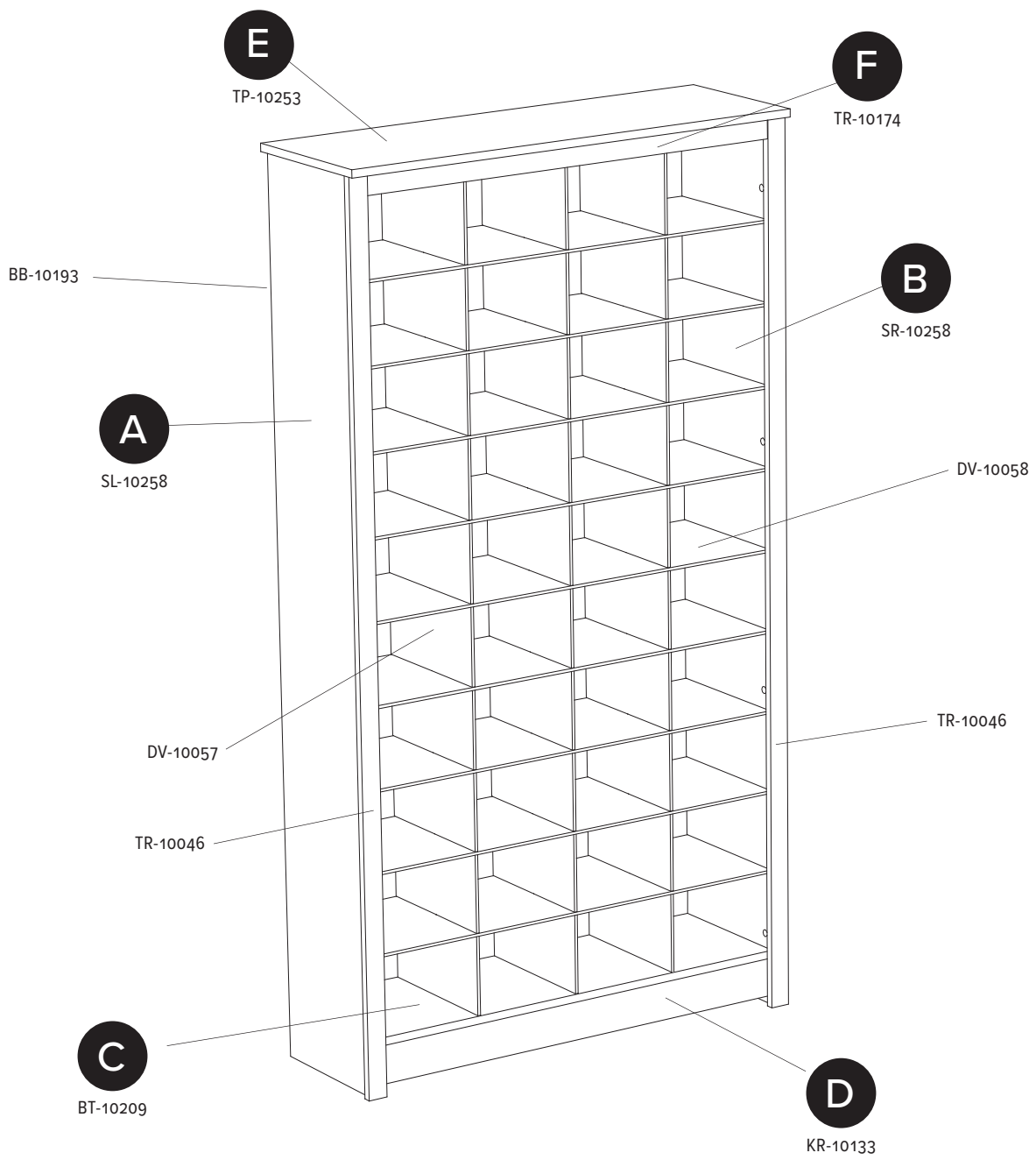

Hardware

Quincaillerie

Piezas de Conexión

18 X



RM-0103

8 X

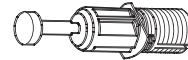

RM-0583
BLUE

10 X

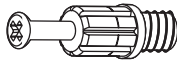

RM-0501

32 X



RM-0022

4 X

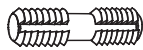

RM-0072

18 X



RM-0010-COLOR

6 X



RM-0069

12 X



RM-0802-COLOR

1 X

Tipover Restraint Kit

Kit anti-basculement

Kit de sujeción contra volcaduras

HP-1088

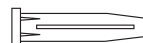

Assemble in 16 steps

Assemblage en 16 étapes

Montar en 16 pasos

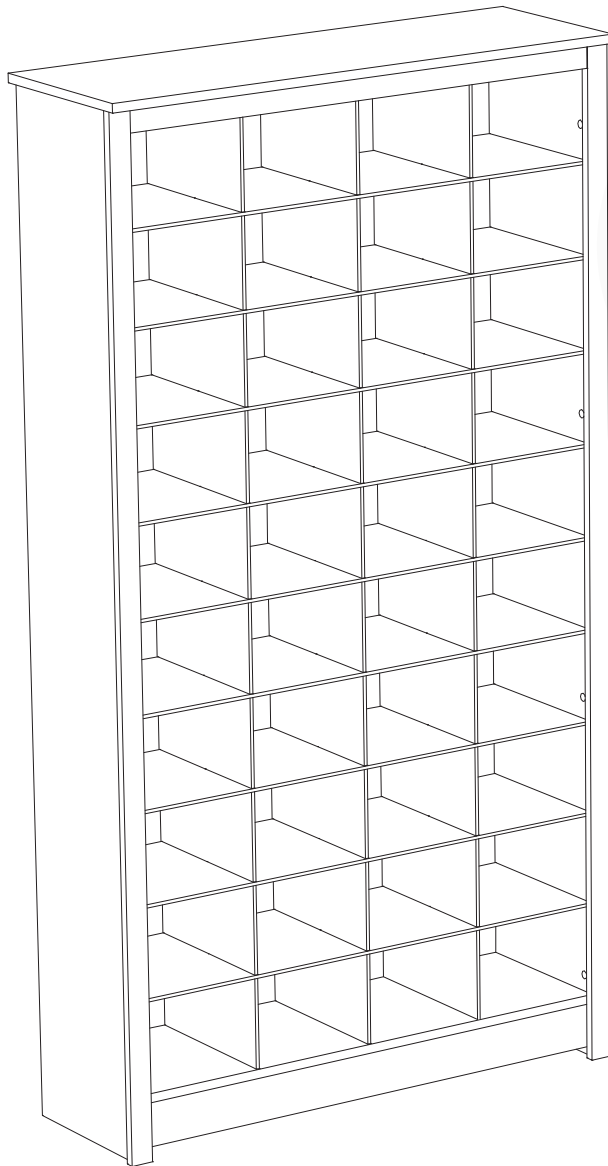

**Let's
start!**

Commençons!

¡Comencemos!

1

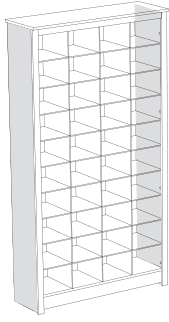

RM-0103



12X

RM-0501

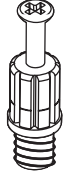

6X

RM-0069



6X

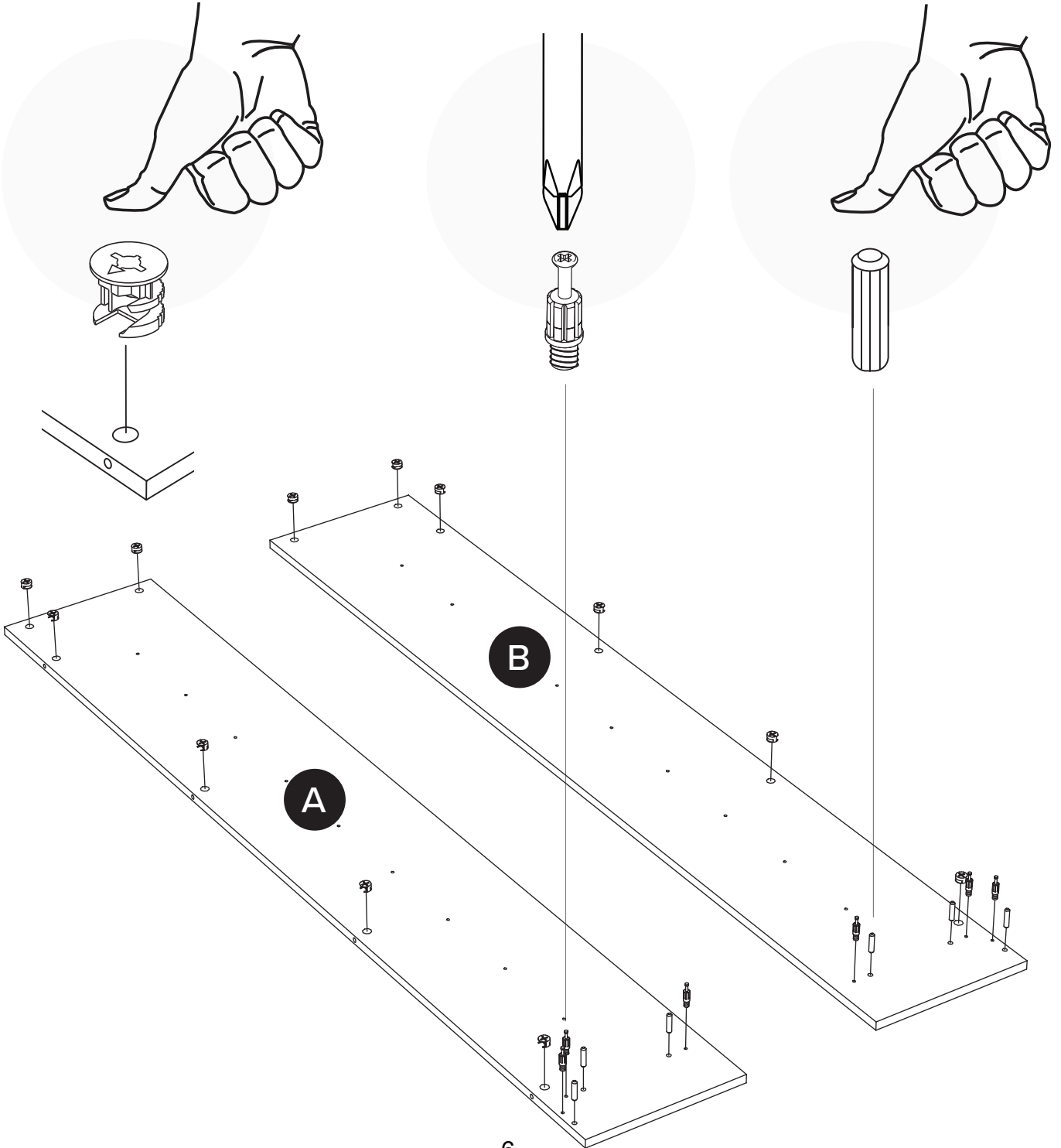

2

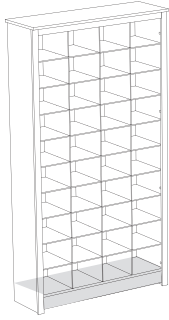

RM-0103



6X

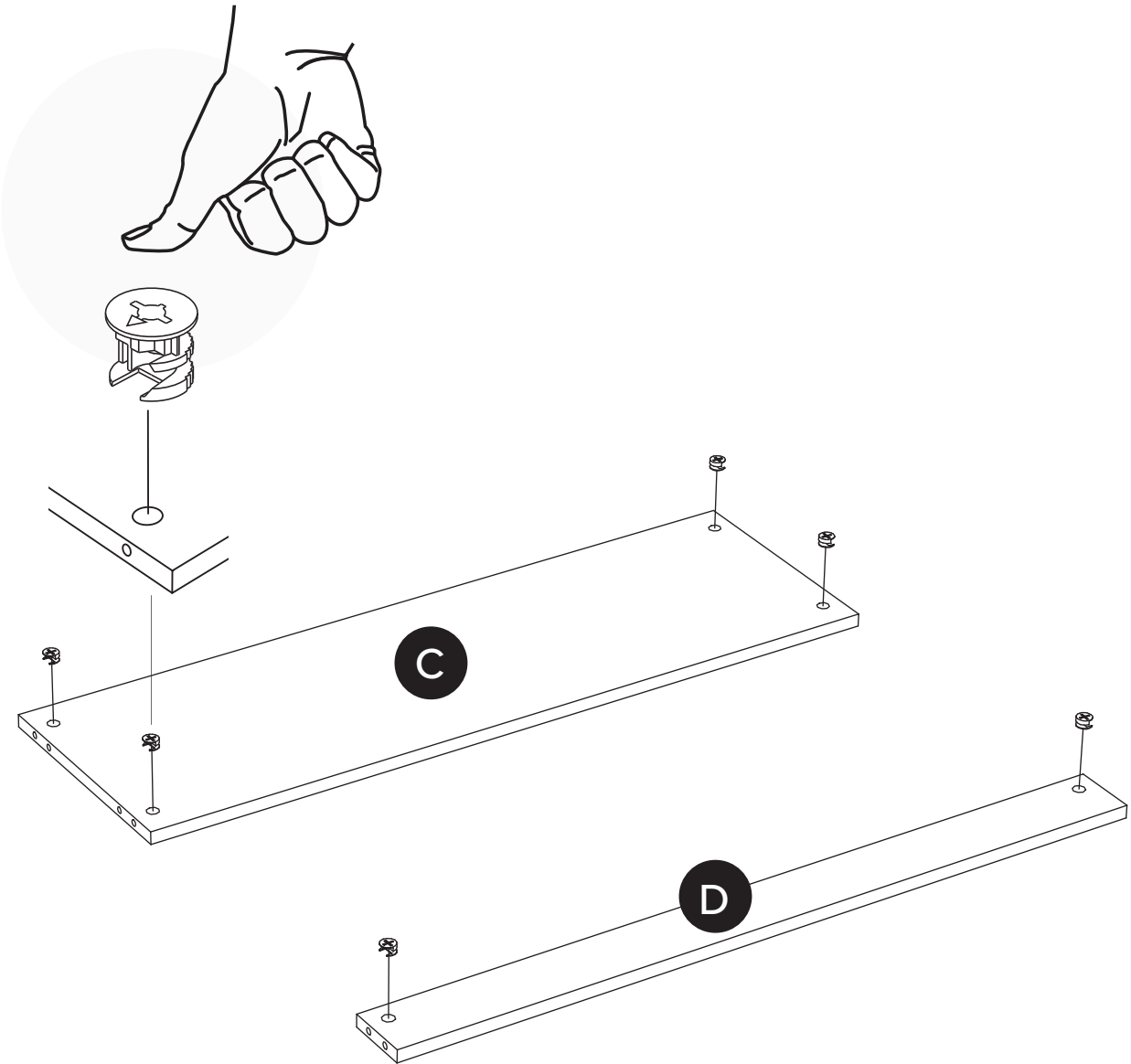

3

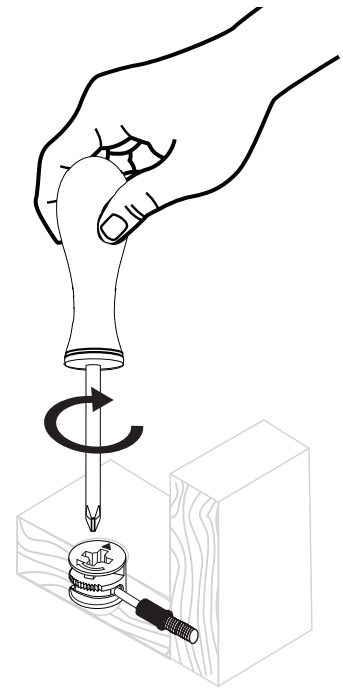
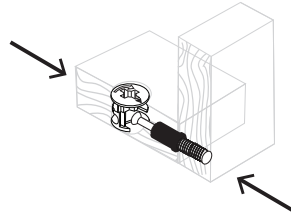
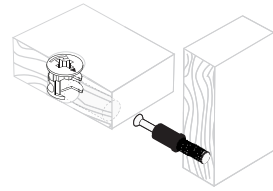
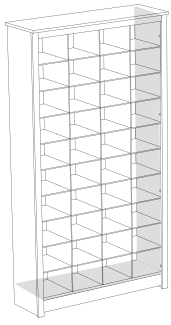

2X

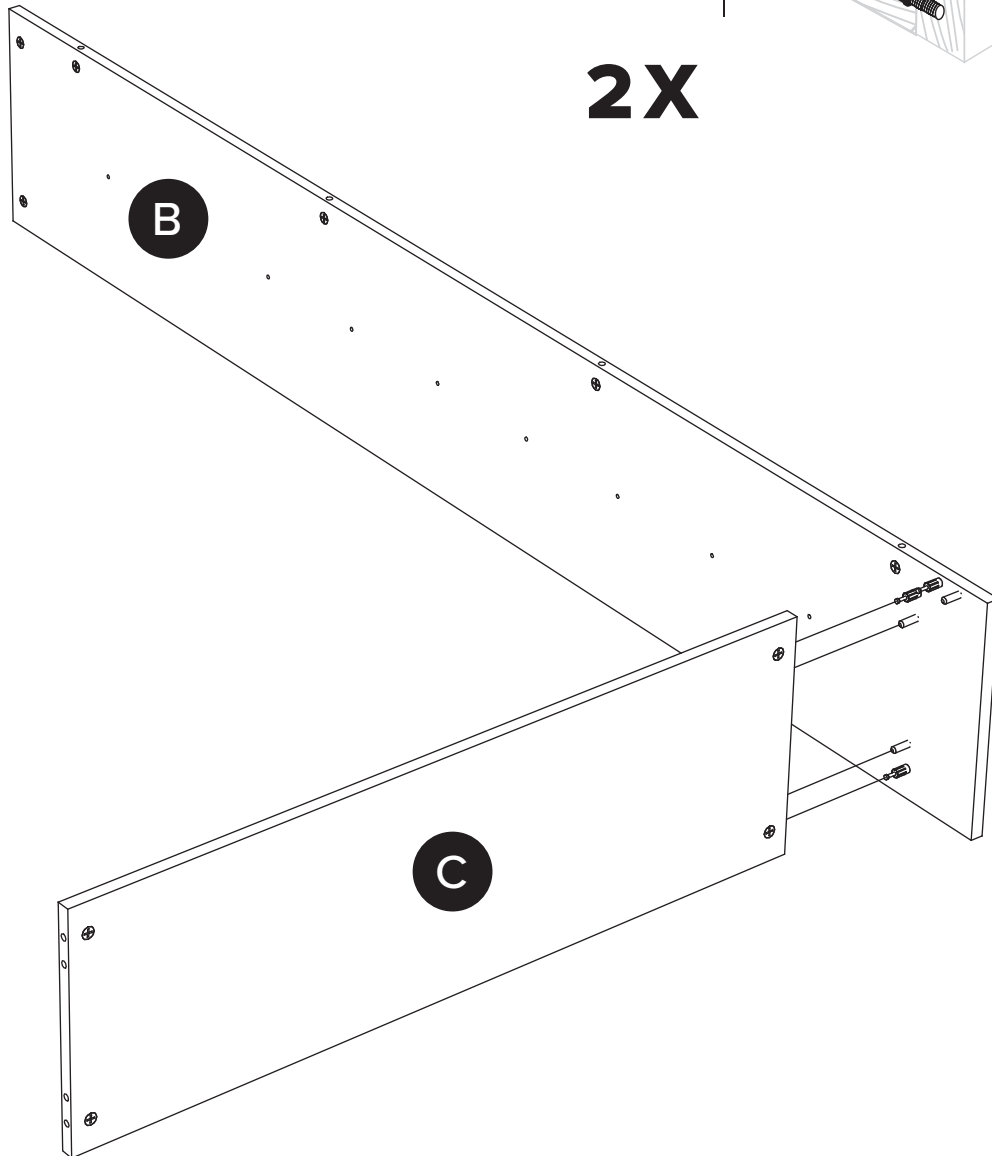

4

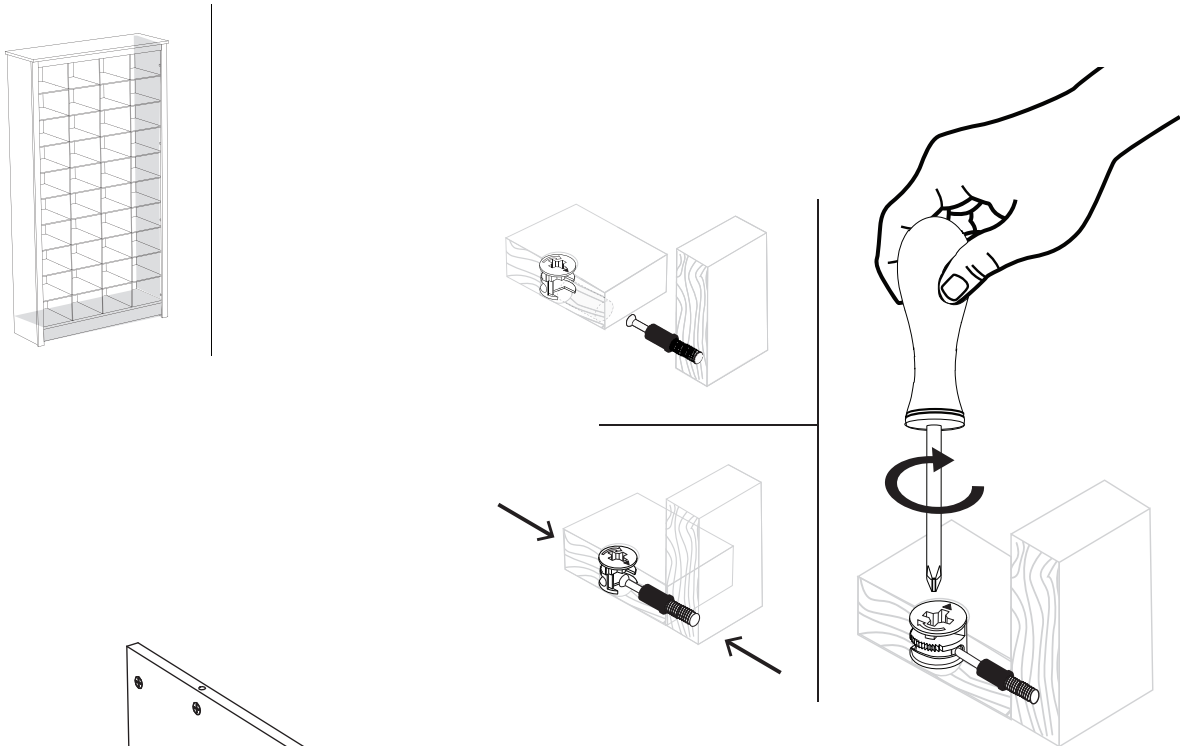

1X

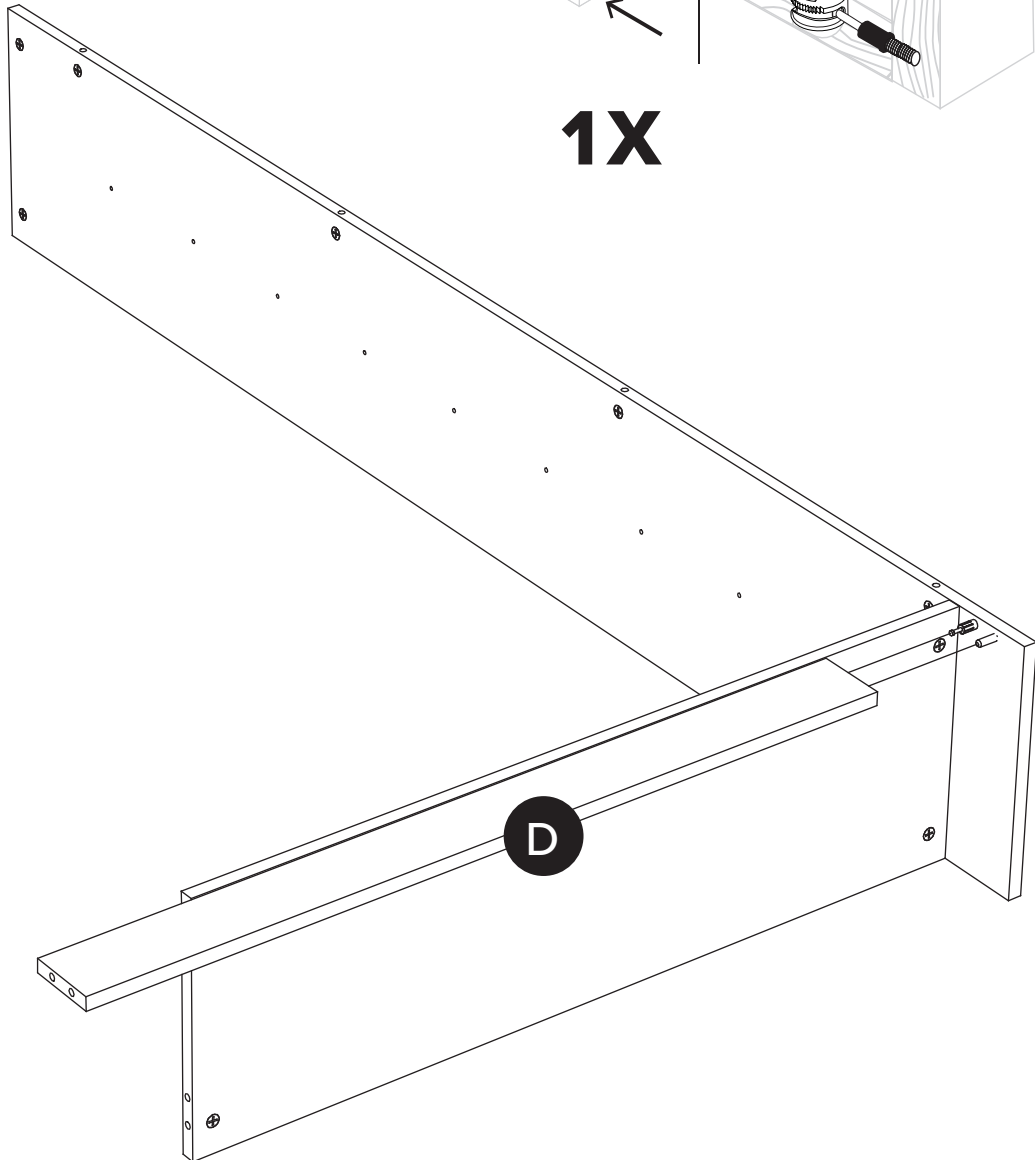

5

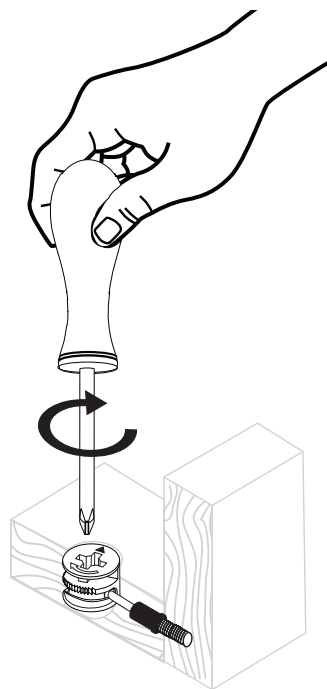
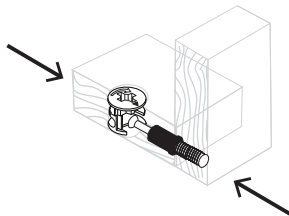
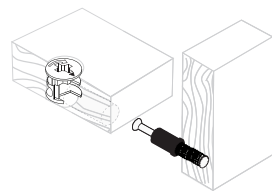
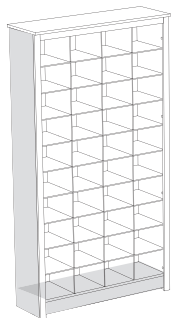

3X

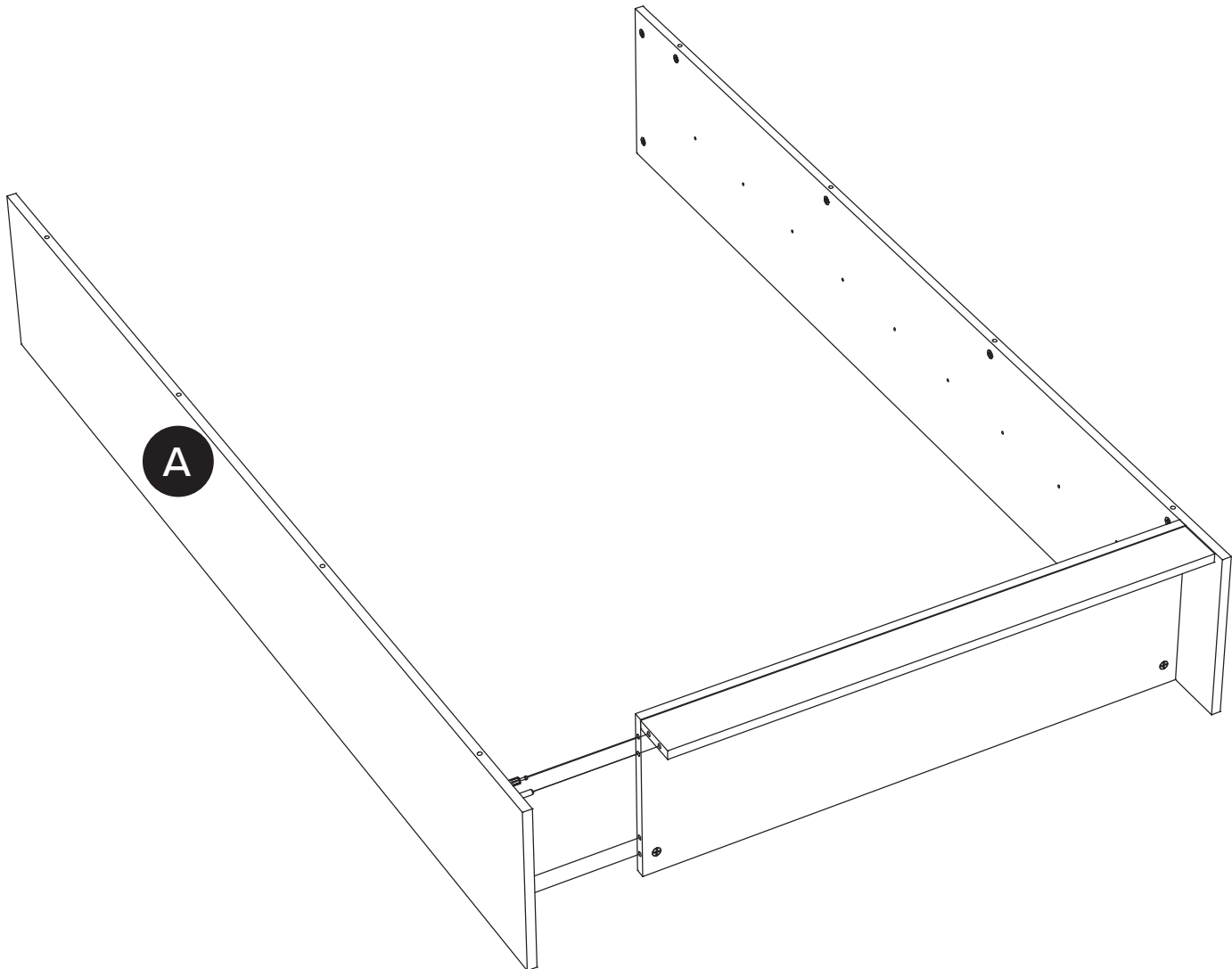

6

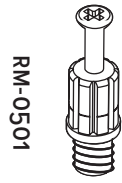
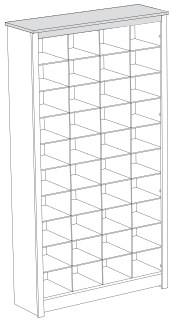

4X

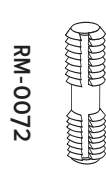

4X

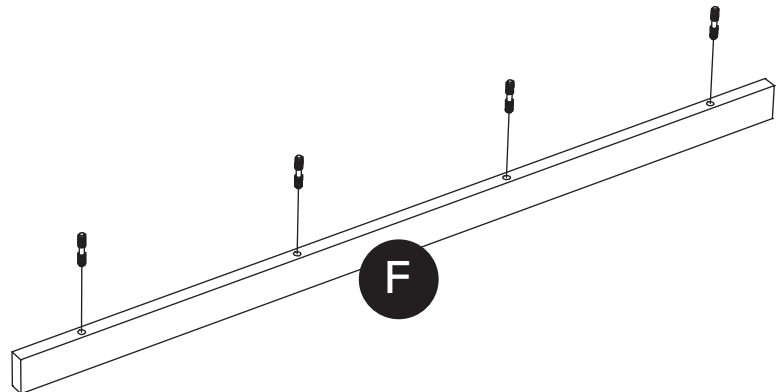
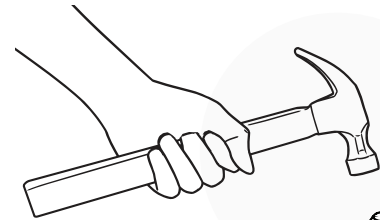
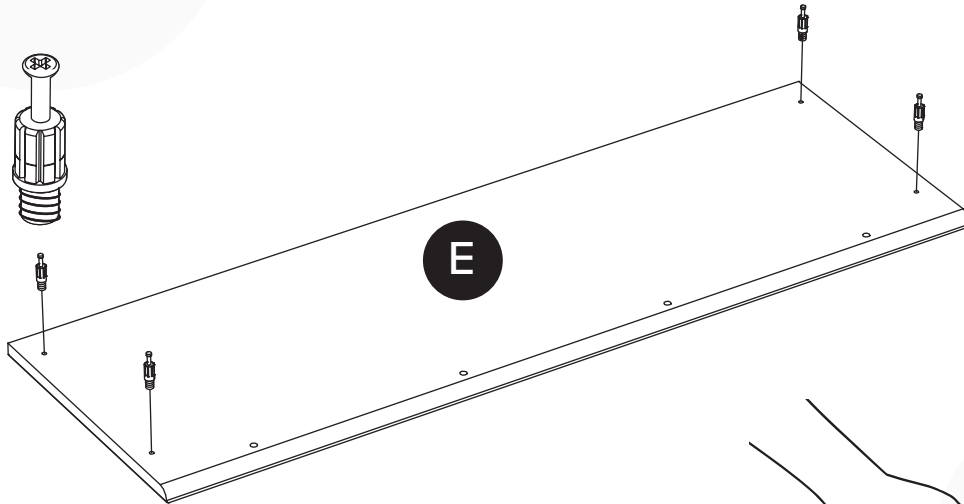
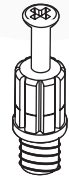
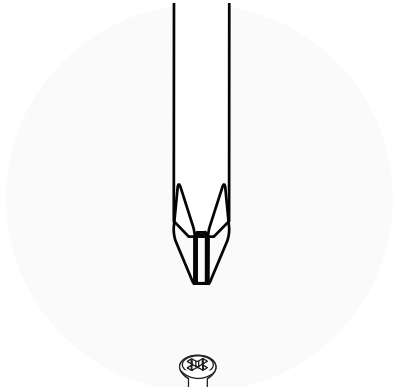

7

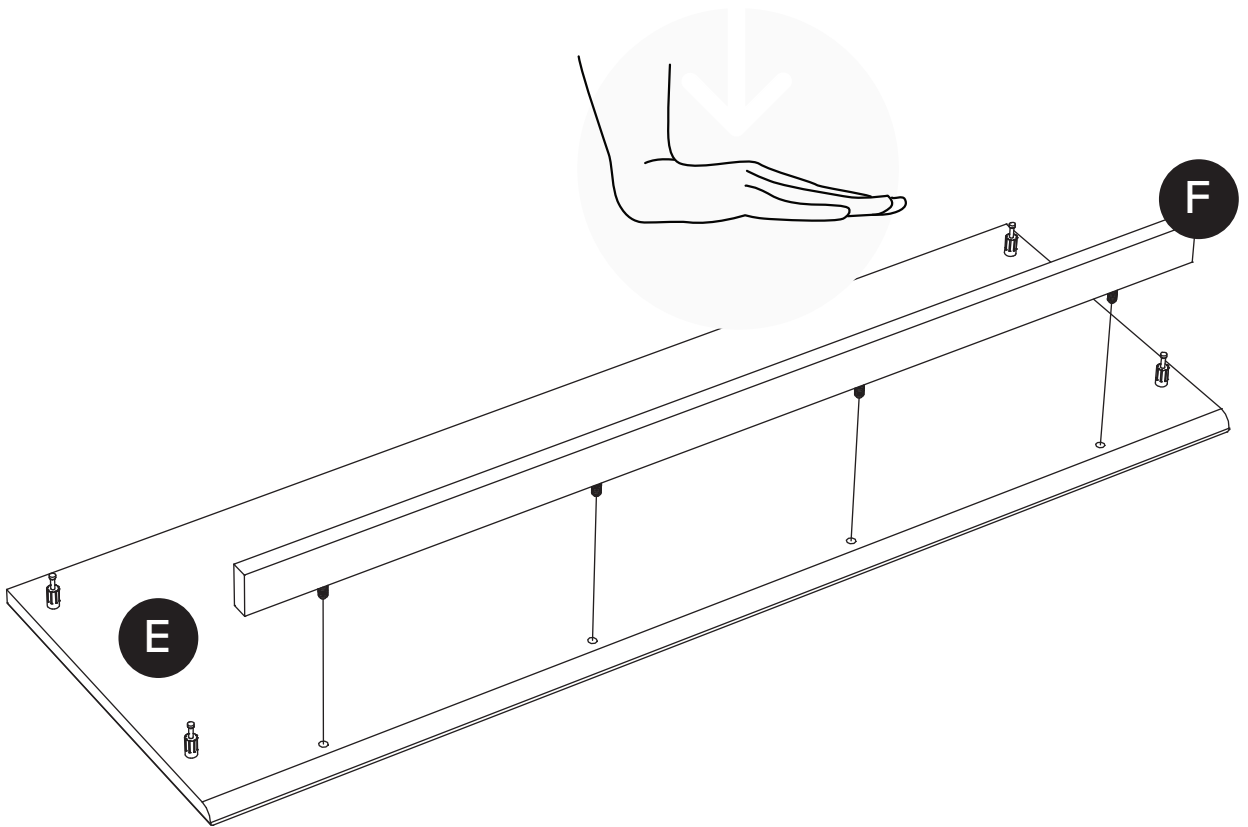
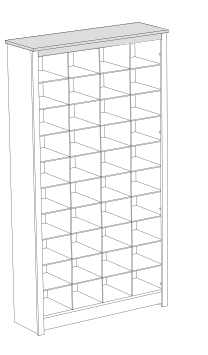

8

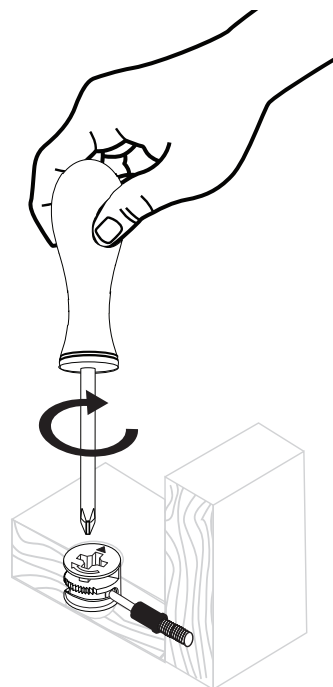
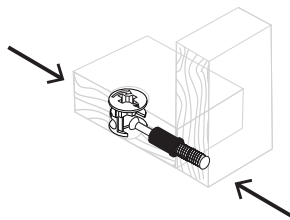
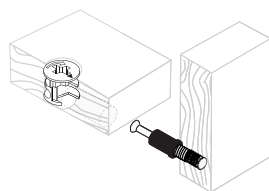
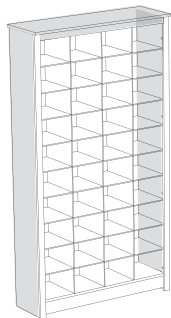

4X

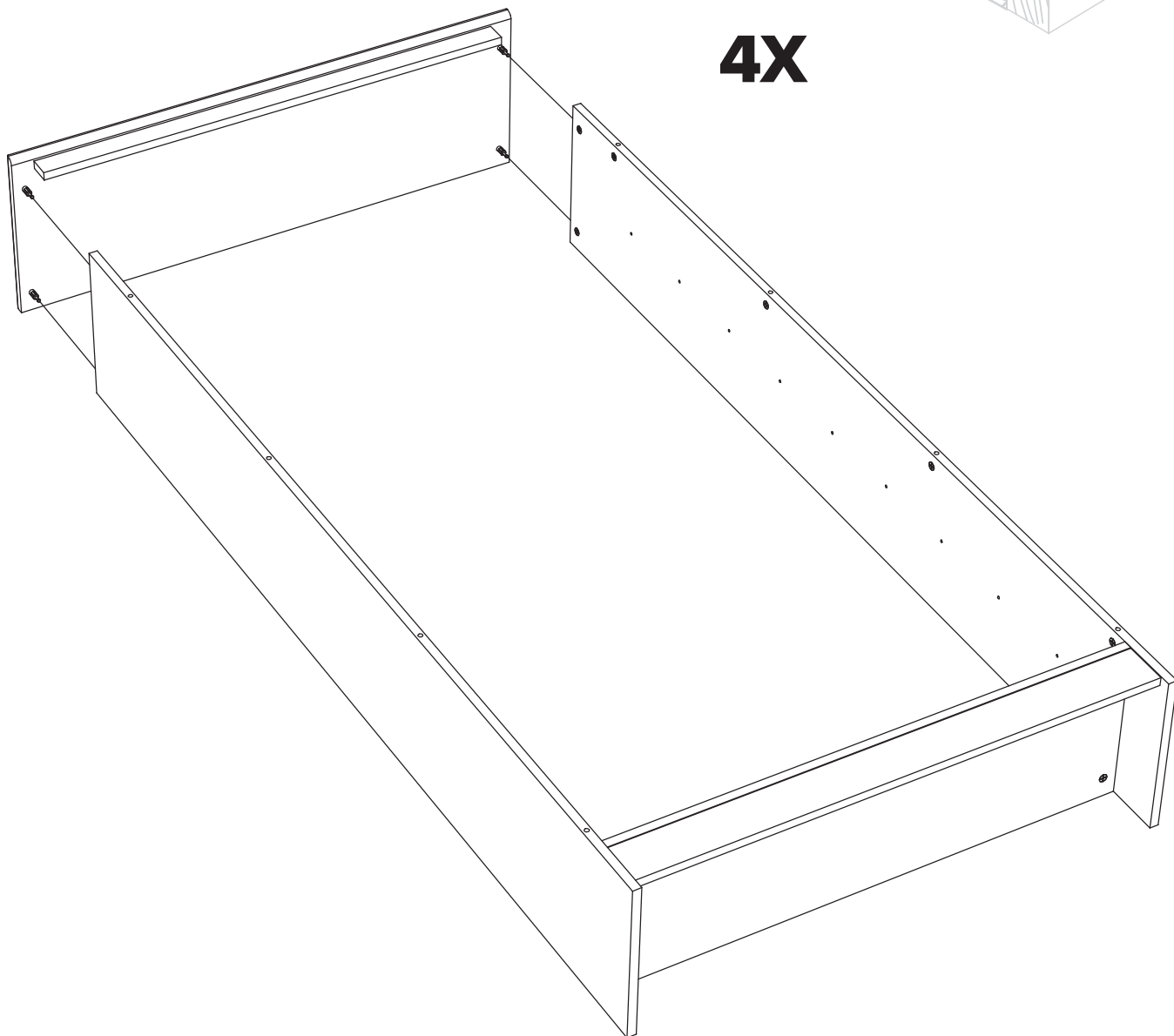

9

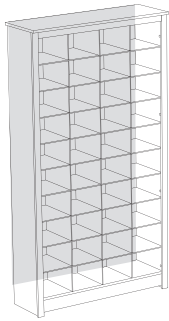

RM-0022



32X

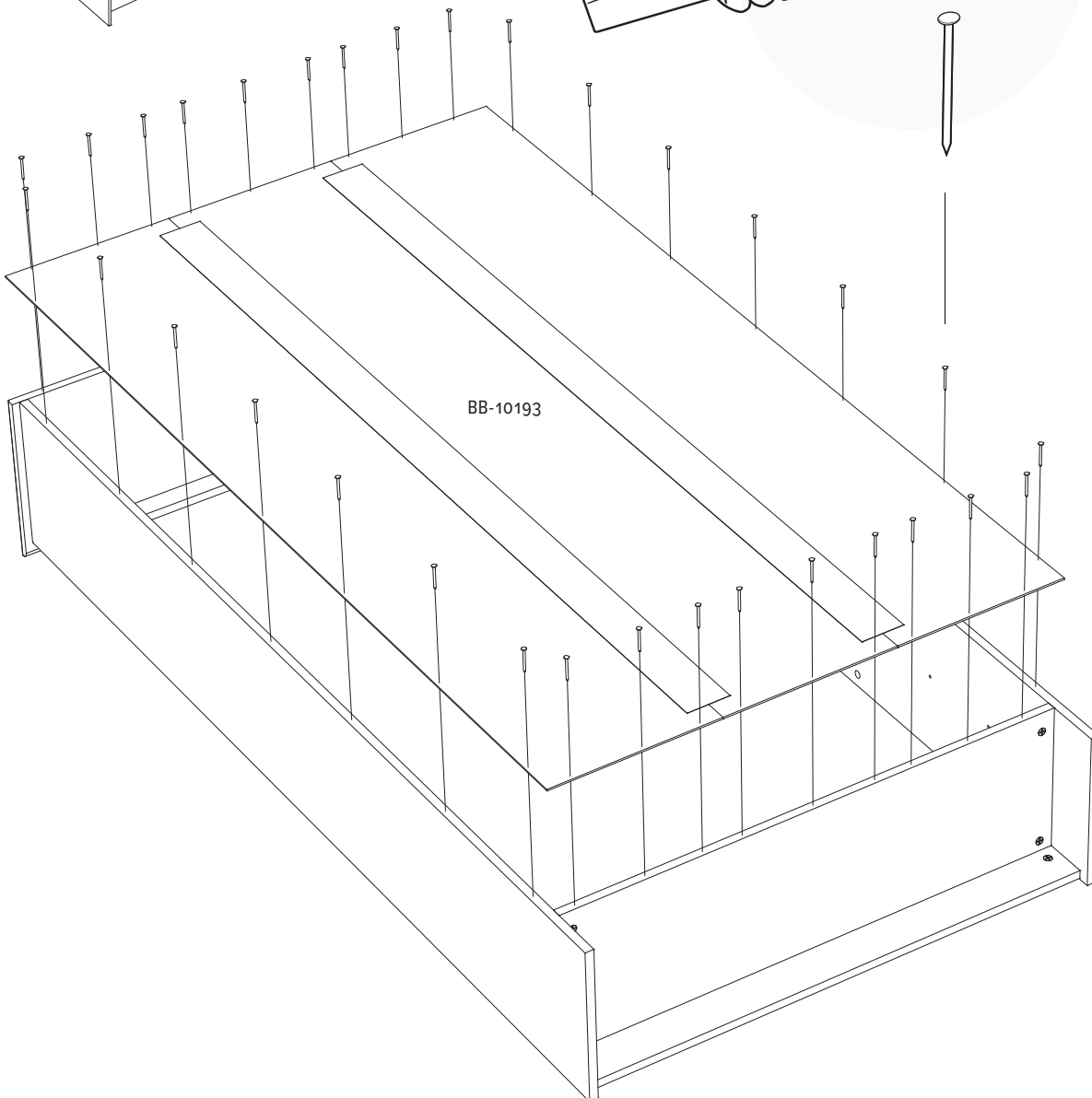
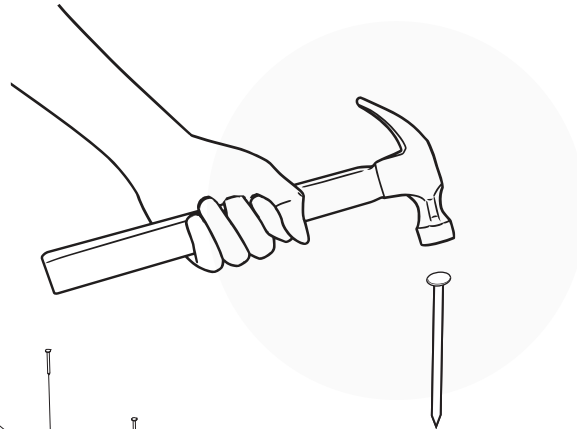
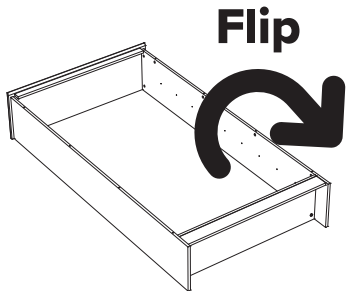

11

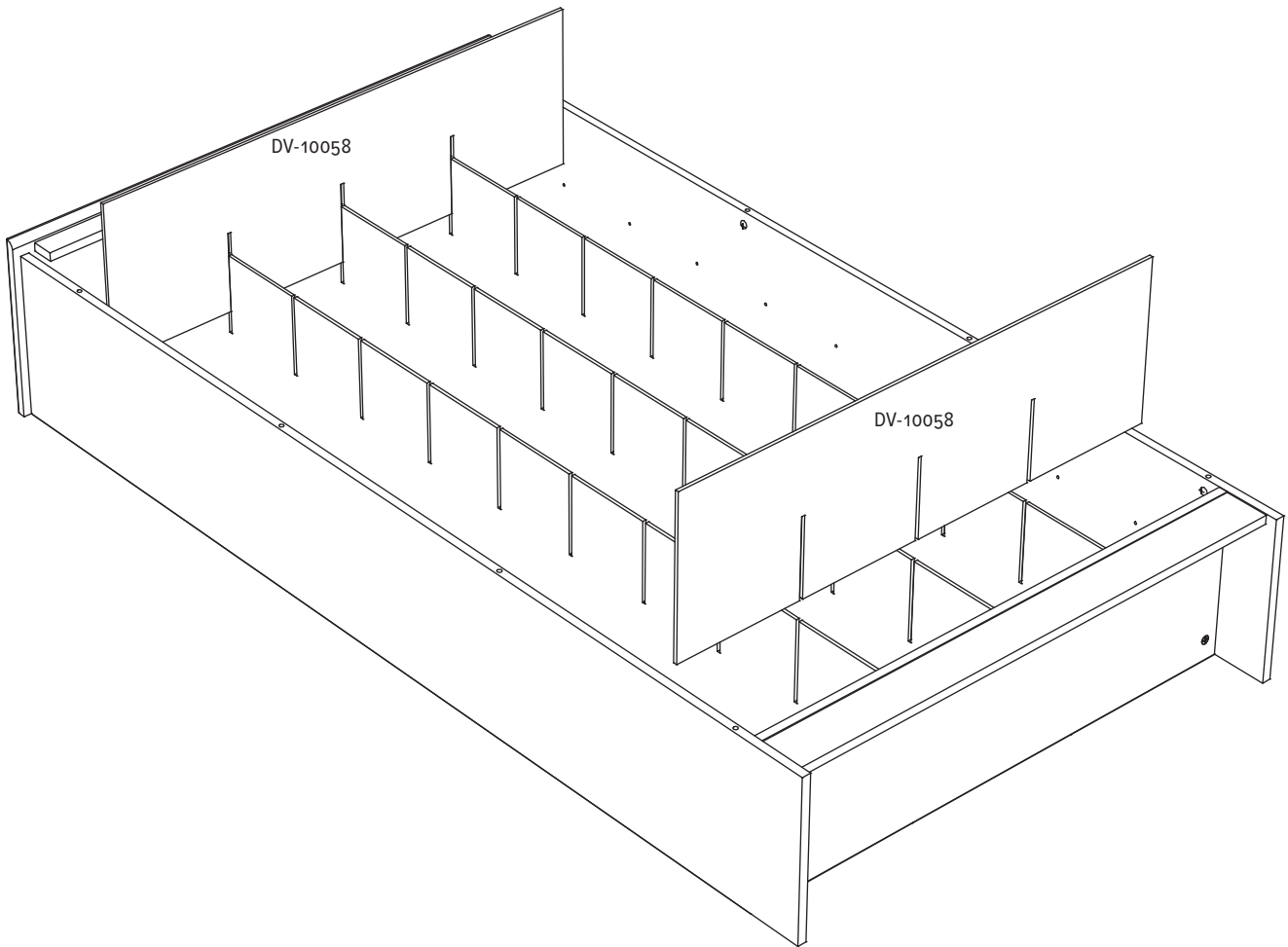
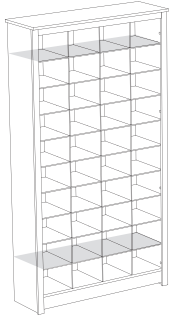

12

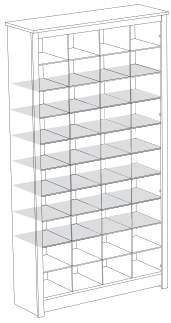

Flip

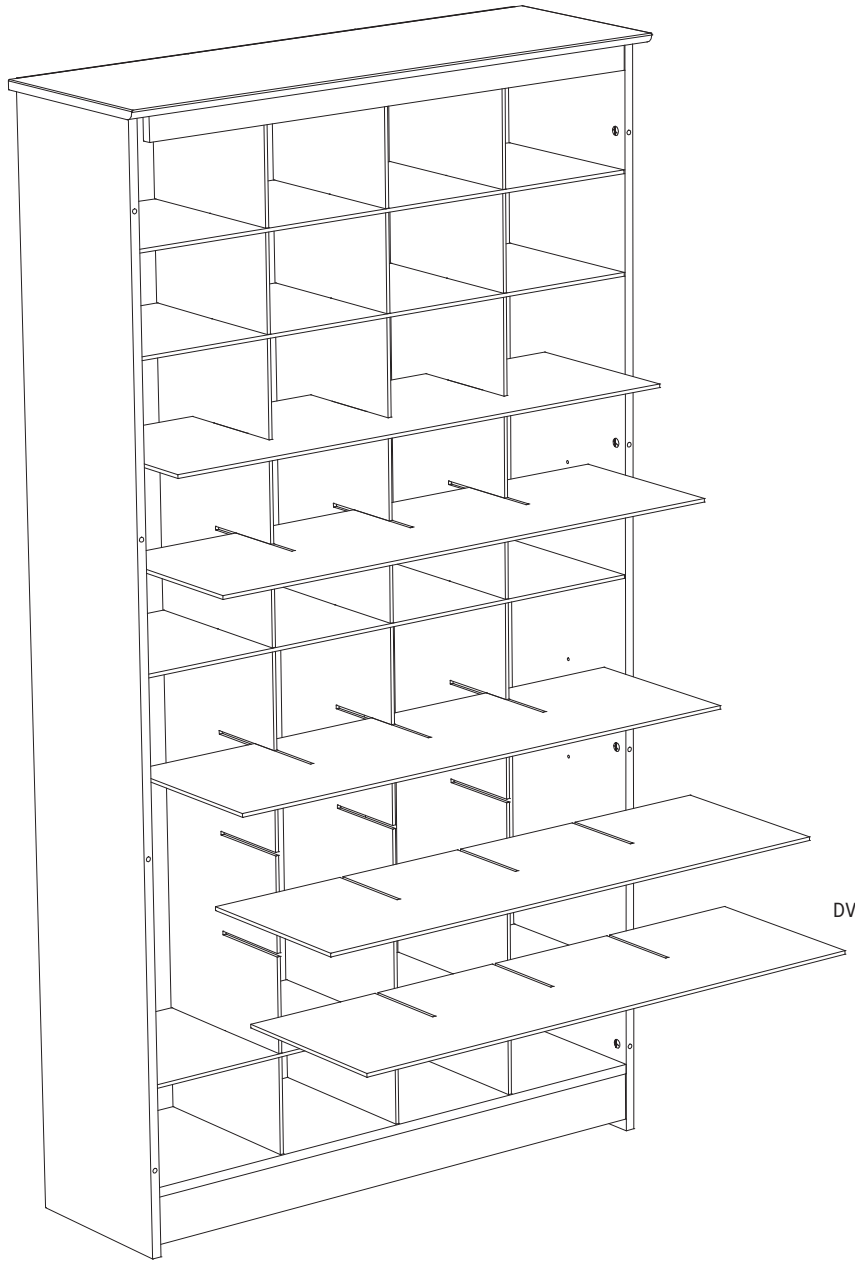
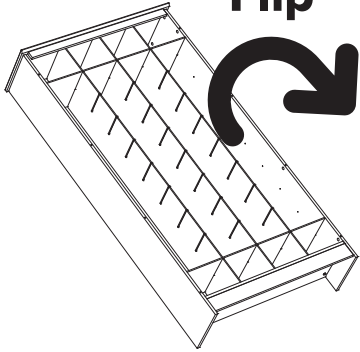

DV-10058

13

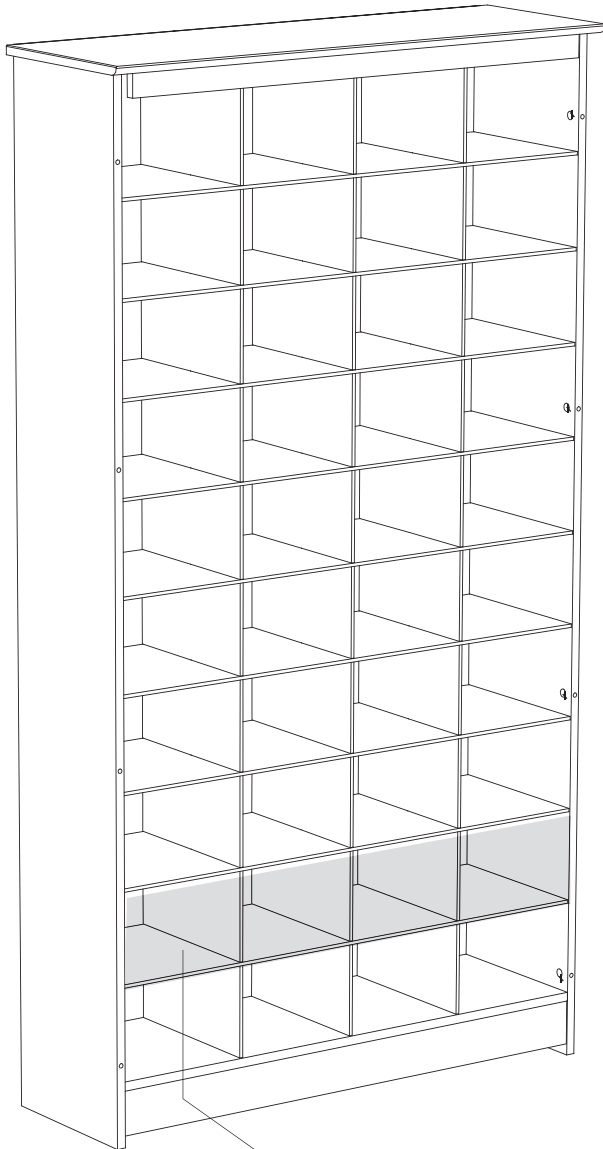
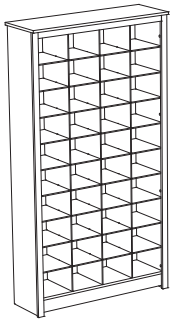

OR

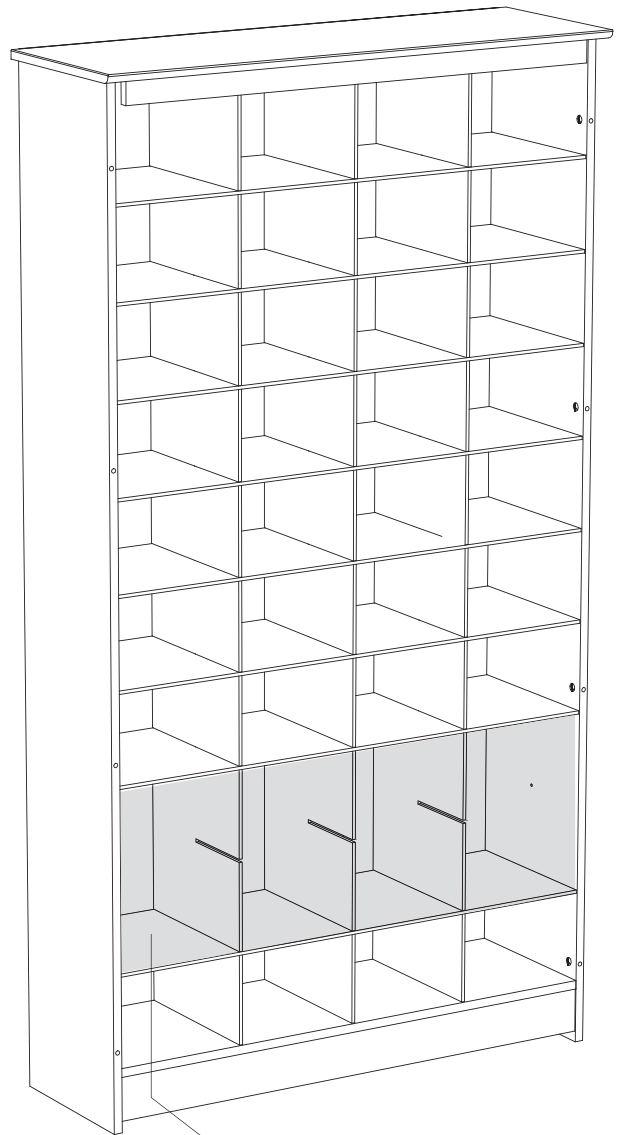

14

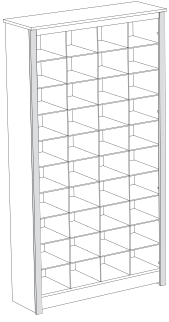

RM-0583



8X

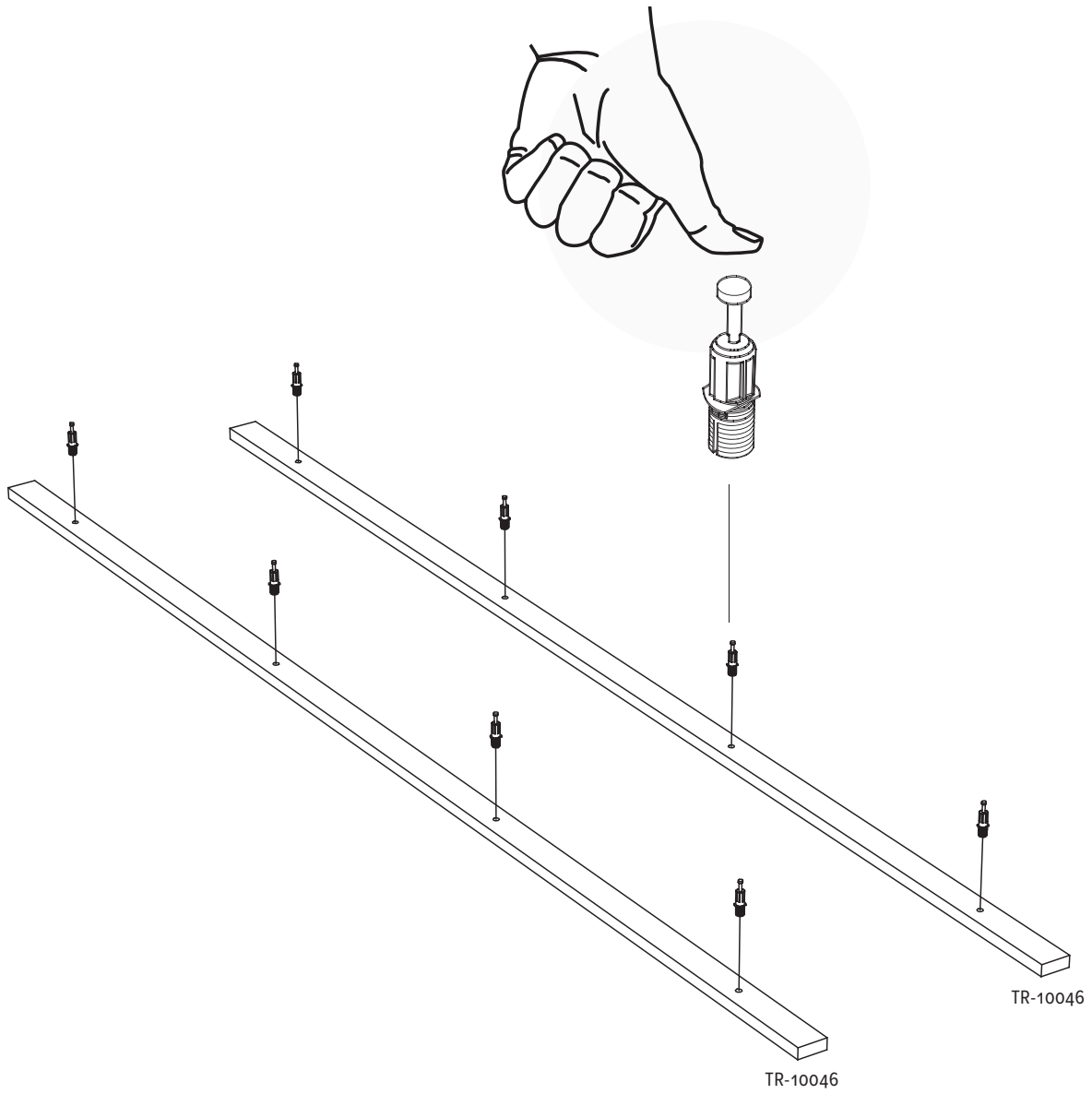

15

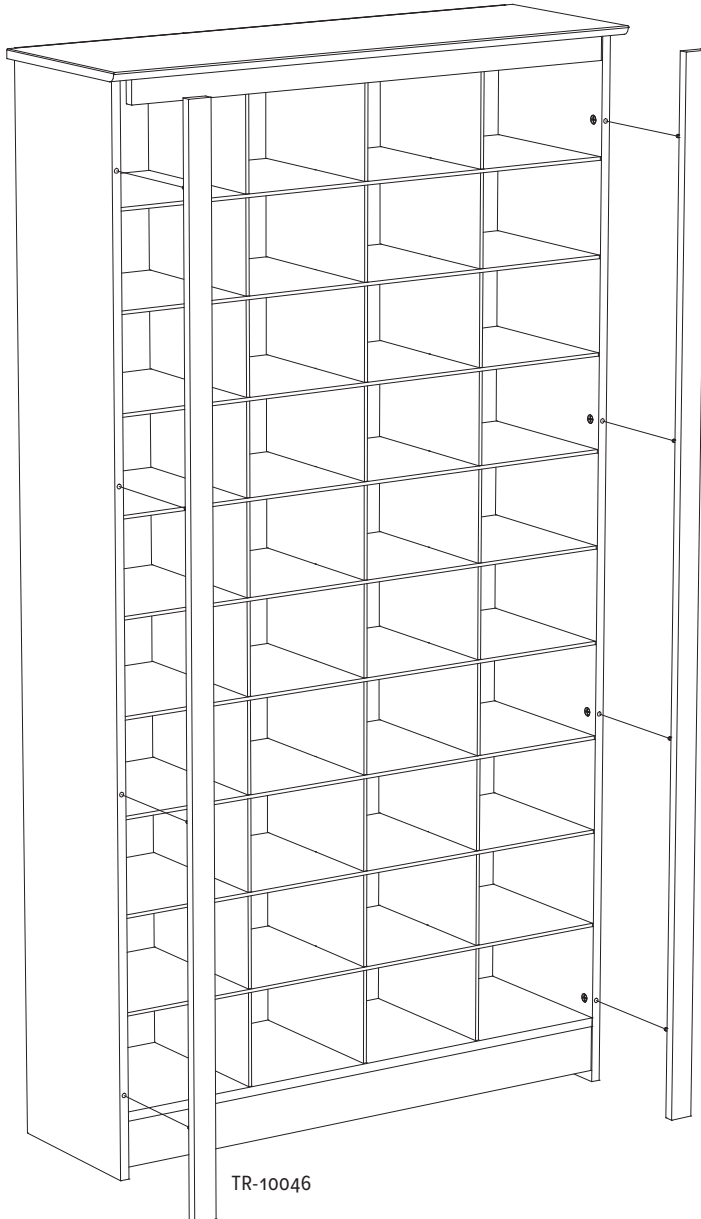
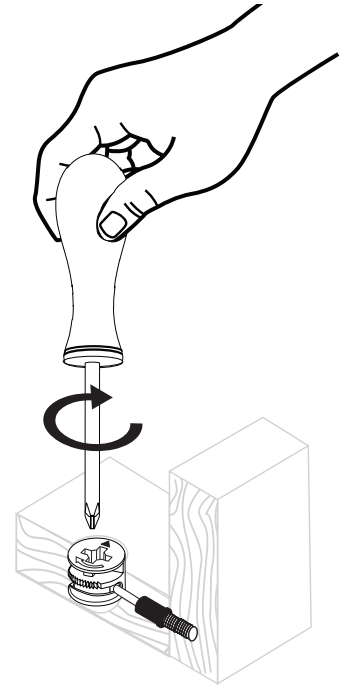
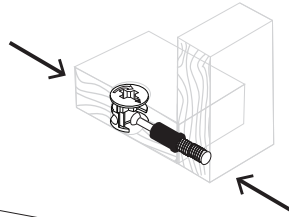
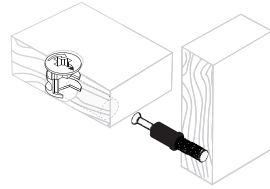
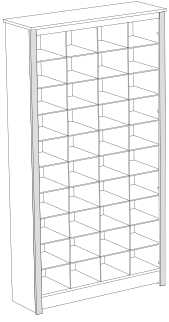

8X

TR-10046

TR-10046

16

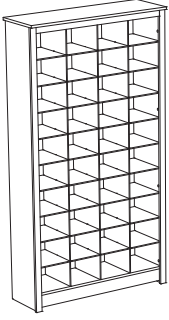

RM-0010-COLOR



RM-0802-COLOR



18 X 12 X

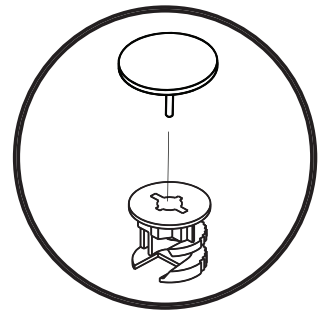
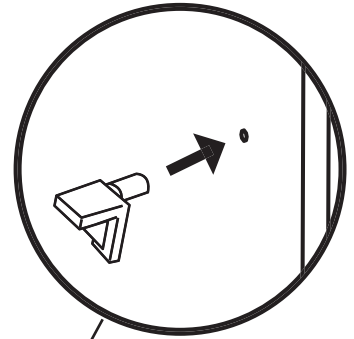
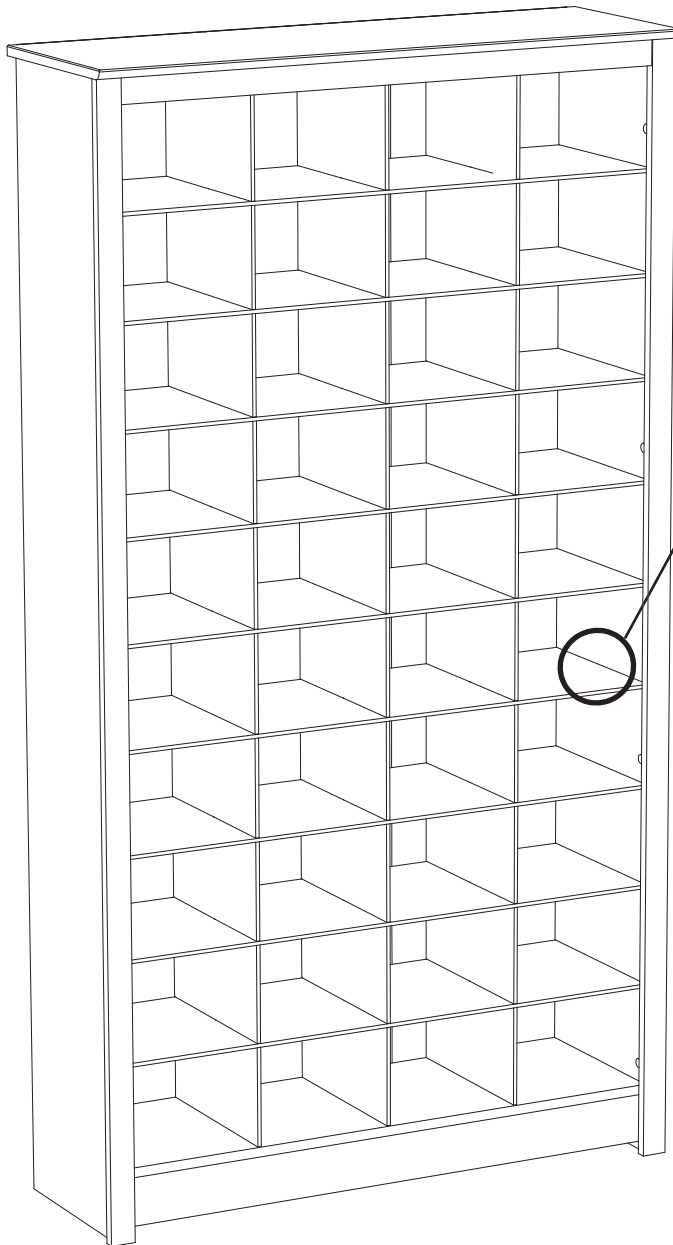

Tipover Restraint Device

Fixation du dispositif de retenue
Instalando la correa de seguridad

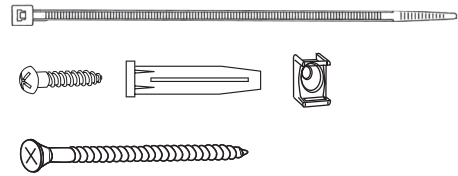

HP-1088

Safety Notice

We recommends anchoring furniture in homes where children live or visit and has included an easy to install safety device. Please make sure that it is installed according to the following instructions.

Noticia de seguridad

Recomendamos anclar los muebles en hogares donde viven niños o donde son visitantes. Hemos incluido un dispositivo de seguridad de fácil instalación. Por favor, asegúrese de que esté instalado de acuerdo con las siguientes instrucciones.

Avis de sécurité

Nous recommandons l'ancrage des meubles dans les domiciles où habitent ou visitent des enfants. C'est pourquoi nous avons inclus un dispositif de sécurité facile à installer. Veuillez vous assurer que ce dernier est installé conformément aux présentes instructions.

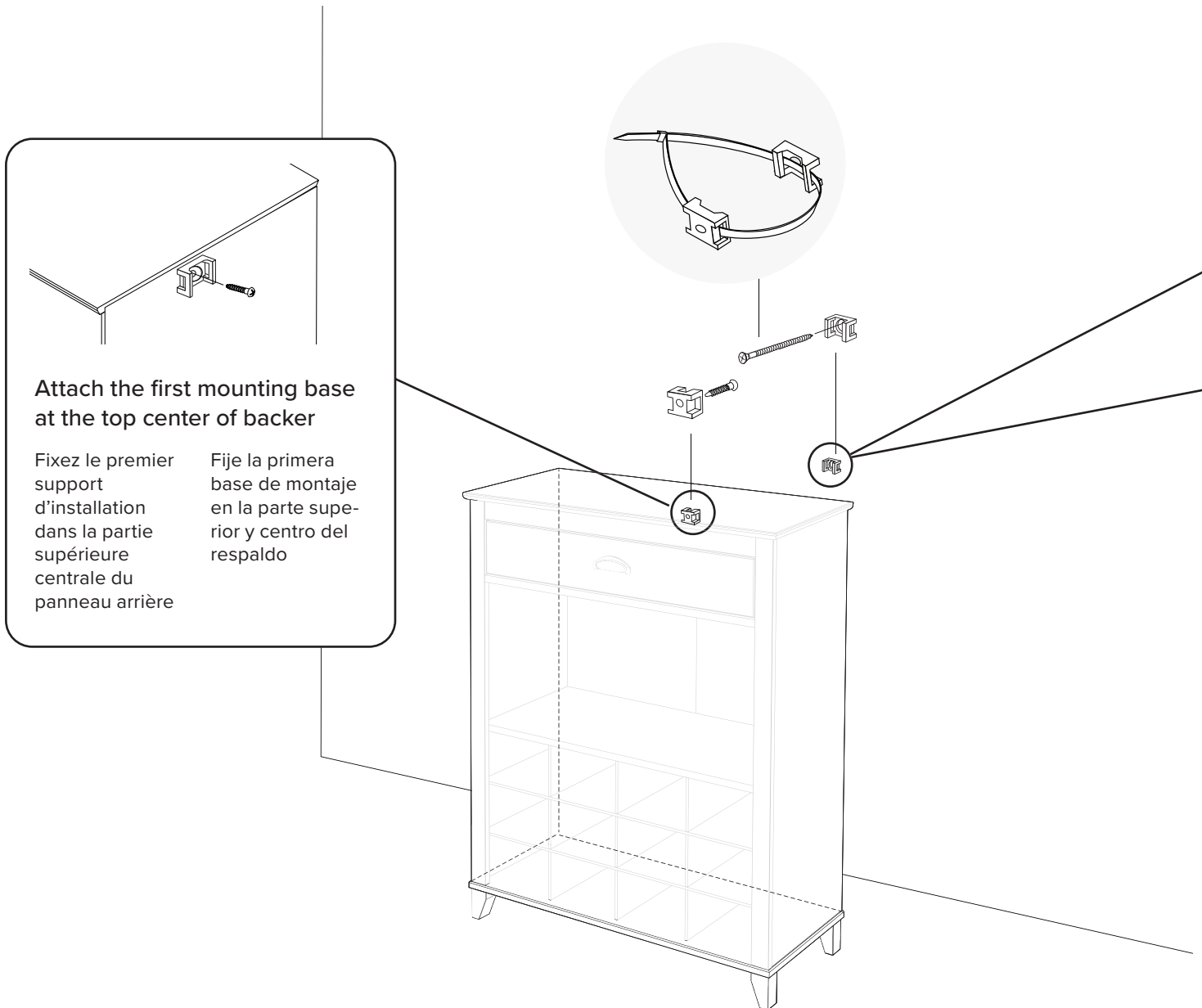

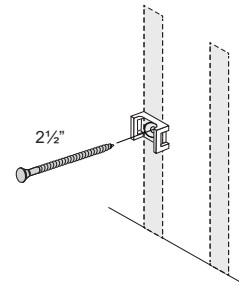
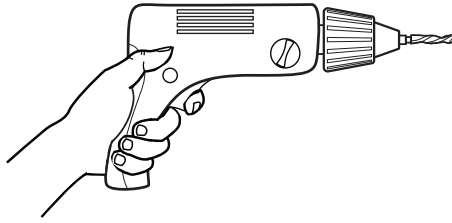
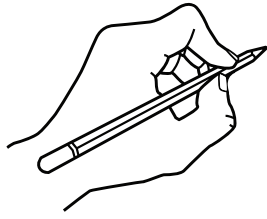

For walls constructed of wood with drywall

Pour les murs en cloison sèche avec montants en bois
Para paredes construidas de madera con paneles prefabricados

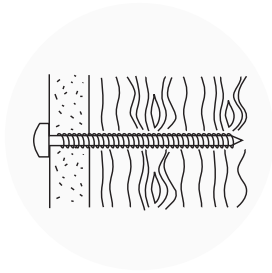

1. With a pencil mark location of second mounting base position
2. Drill pilot hole using an 1/8 inch drill bit 2 inches deep
3. Attach mounting base to wall using the 2 1/2 inch screw provided

1. À l'aide d'un crayon, marquez l'emplacement du deuxième support
2. Percez un avant-trou de 2 po de profondeur avec une mèche de 1/8 po
3. Vissez le support dans le mur à l'aide des vis de 2 1/2 po fournies

1. Con un lápiz marcar la ubicación de la segunda base de montaje
2. Perforar el agujero usando una broca de 1/8 pulgadas 2 pulgadas de profundidad
3. Montar el soporte a la pared utilizando los 2 tornillos de 2 1/2 pulgadas proporcionados

For walls constructed of drywall (unable to hit a stud)

Pour les murs en cloison sèche (où il est impossible de visser dans un montant en bois)
Para muros construidos de drywall (Sin travesaño)

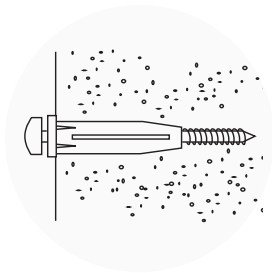

1. Drill pilot hole using a 5/16 inch drill bit only to the depth of drywall thickness
2. Using a rubber mallet or hammer insert wall anchor into drywall
3. Attach holder to wall anchor using 2 1/2 inch screw provided

1. Percez un avant-trou à l'aide d'une mèche de 5/16 po sans dépasser la profondeur de la cloison sèche
2. À l'aide d'un maillet en caoutchouc ou d'un marteau, insérez l'ancrage mural dans la cloison sèche
3. Vissez le support dans l'ancrage mural à l'aide des vis de 2 1/2 po fournies

1. Perforar el agujero utilizando una broca de 5/16 pulgadas solo a la profundidad del grosor del panel de yeso
2. Utilizando un martillo de goma o un martillo insertar el anclaje en pared de yeso
3. Fije el soporte de anclaje a la pared utilizando el tornillo de 2 1/2 pulgadas incluido

For walls constructed of concrete

Pour les murs en béton
Para muros construidos de hormigón

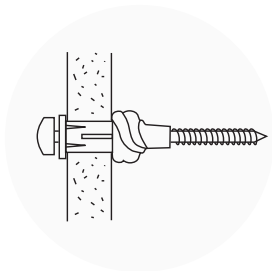

1. Drill pilot hole using a 5/16 inch drill bit 2 3/4 inches deep
2. Using a rubber mallet or hammer insert wall anchor into predrilled hole
3. Attach holder to wall anchor using 2 1/2 inch screw provided

1. Percez un avant-trou de 2 3/4 po de profondeur avec une mèche de 5/16 po
2. À l'aide d'un maillet en caoutchouc ou d'un marteau, insérez l'ancrage mural dans le trou
3. Vissez le support dans l'ancrage mural à l'aide des vis de 2 1/2 po fournies

1. Perforar un agujero de 2 3/4 de profundidad utilizando una broca de 5/16 pulgadas
2. Utilizando un martillo de goma o un martillo insertar el anclaje en el agujero preperforado
3. Fije el soporte de anclaje a la pared utilizando el tornillo de 2 1/2 pulgadas incluido

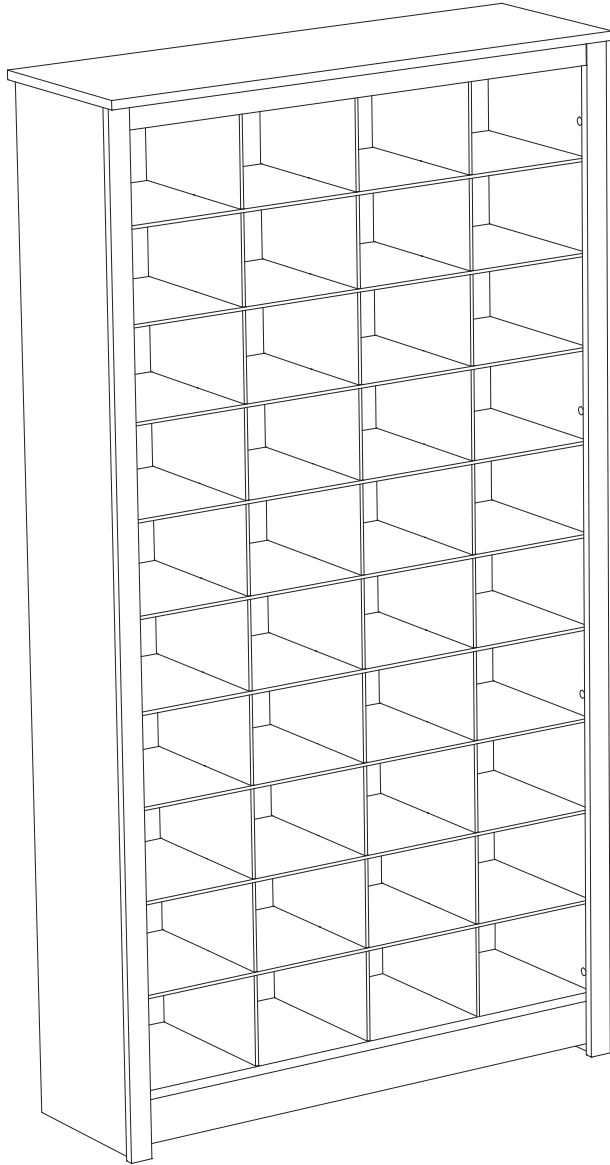

All done!
Good job!

Tout est fait! Bon travail!

¡Todo listo! ¡Buen trabajo!

Shoe Storage Cabinet

Armoire de rangement pour chaussures

Armario de almacenamiento para zapatos.

