

KD-TVS-001-V1

Kayden TV Stand Media Console

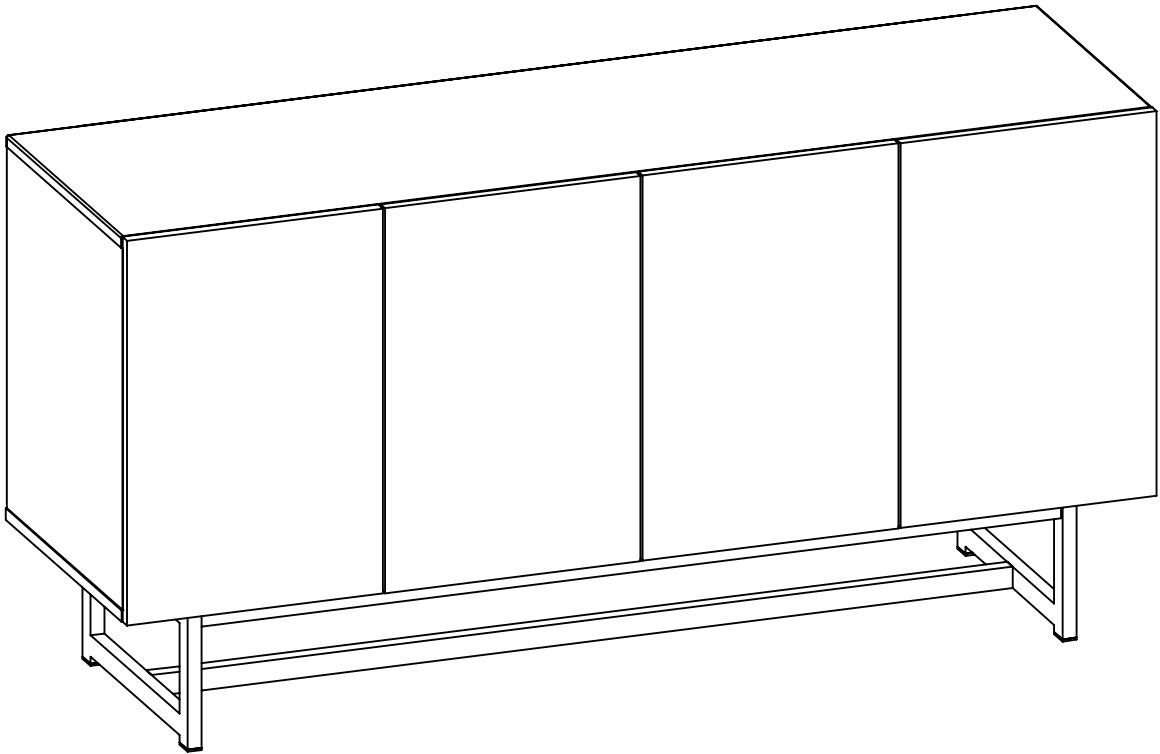

ASSEMBLY INSTRUCTION

ADULT ASSEMBLY REQUIRED

**THE PRODUCT MAY RECOMMENDED
ASSEMBLING BY MORE THAN ONE
PERSON.**

**PLEASE ASK FOR ASSISTANCE AT YOUR
CONVENIENCE BEFORE ASSEMBLING.**

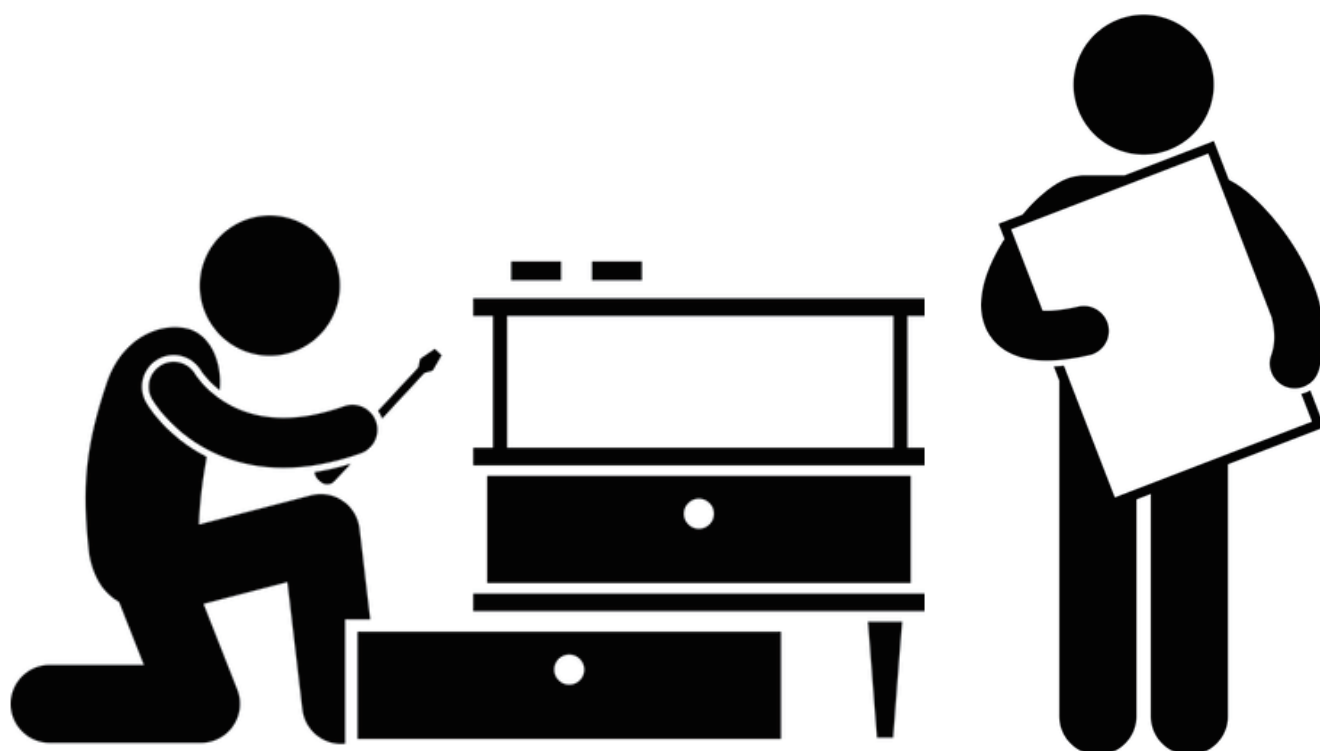

Before You Start

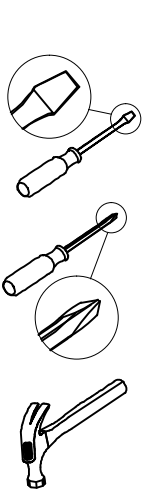

Read through each step carefully and follow the proper order

Separate and count all your parts and hardware

Give yourself enough room for the assembly process

Have the following tools: Flat Head Screwdriver, #2 Phillips Head Screwdriver and Hammer

Caution: If using a power drill or power screwdriver for screwing, please be aware to slow down and stop when screw is tight. Failure to do so may result in stripping the screw.

Cam Lock Fastening System

This Cam Lock Fastening System will be used throughout the assembly process.

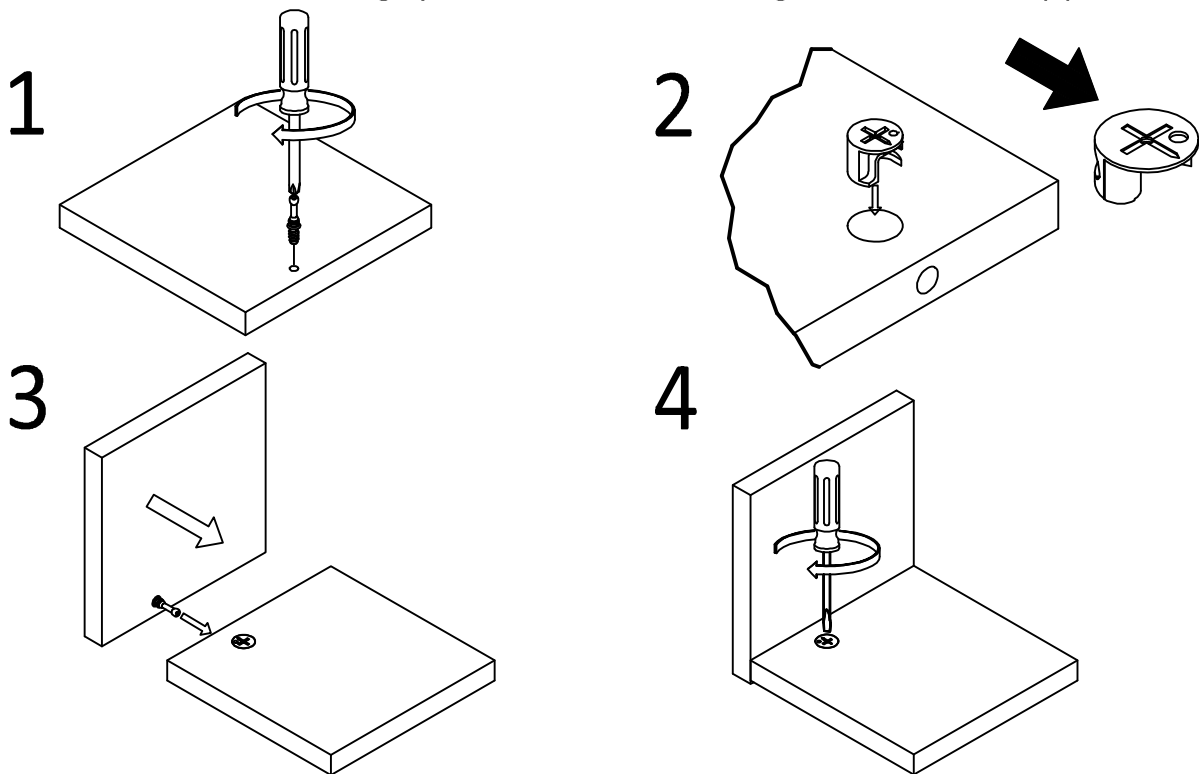

Parts Identification

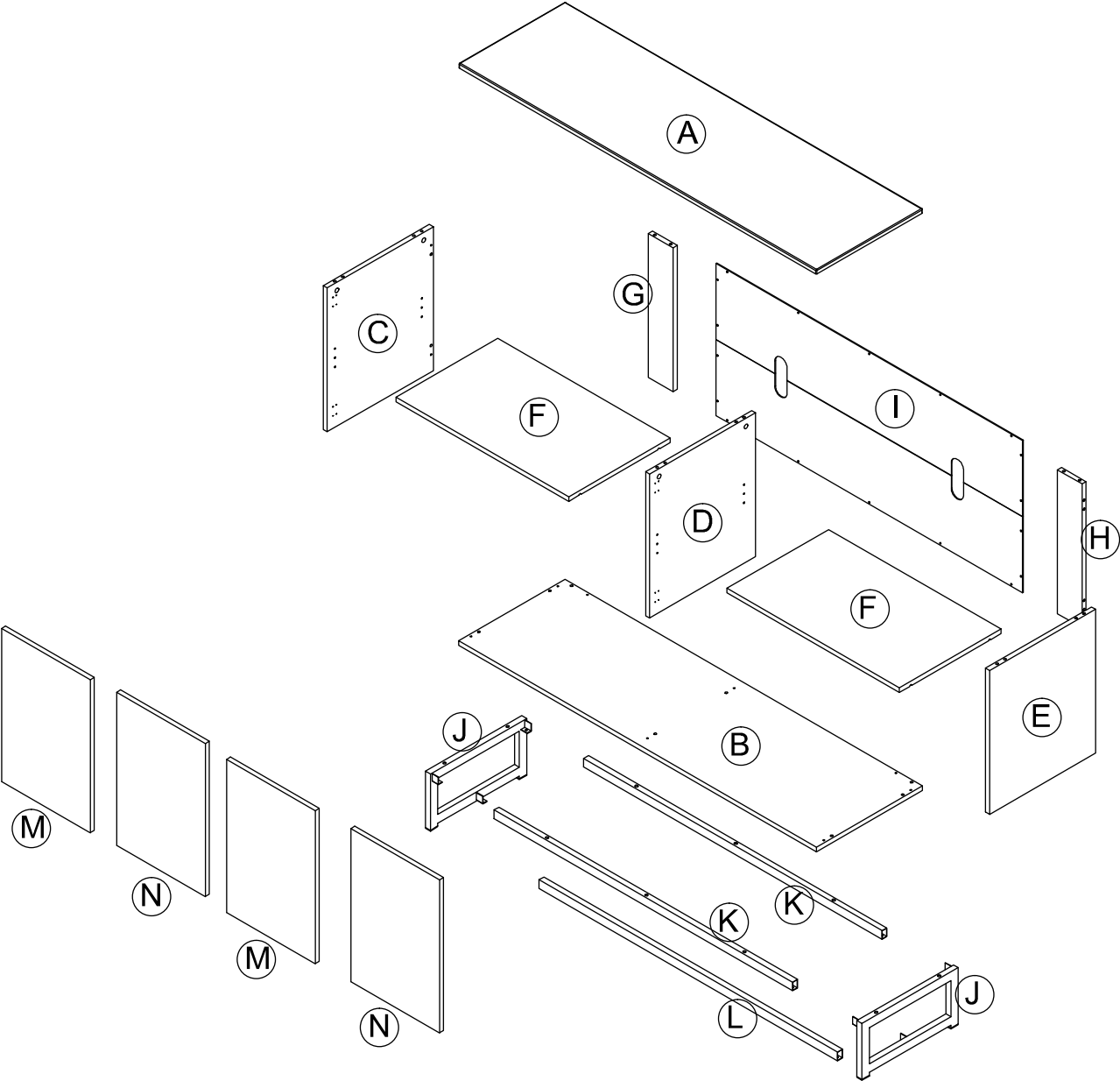

Parts Identification

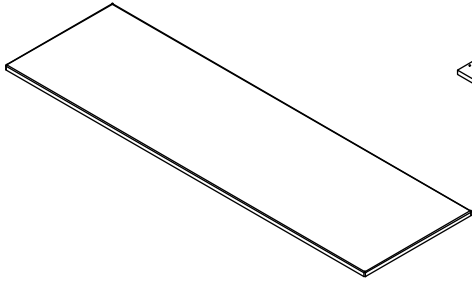

(A)

TOP

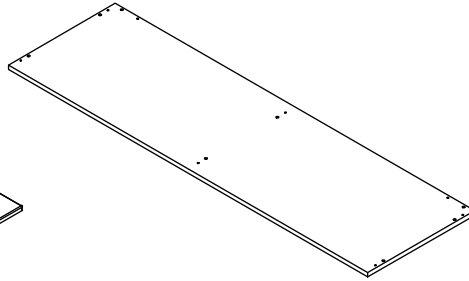

(B)

BOTTOM

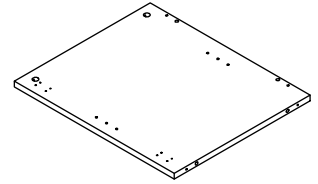

(C)

LEFT

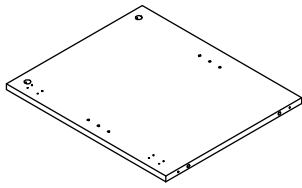

(D)

MIDDLE SHELF

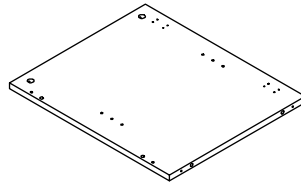

(E)

RIGHT

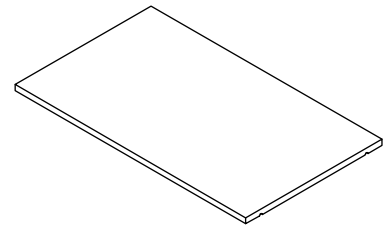

(F)

SHELF x2

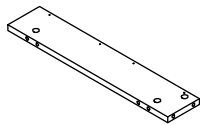

(G)

BACK LEFT DECOR

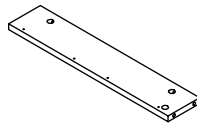

(H)

BACK RIGHT DECOR

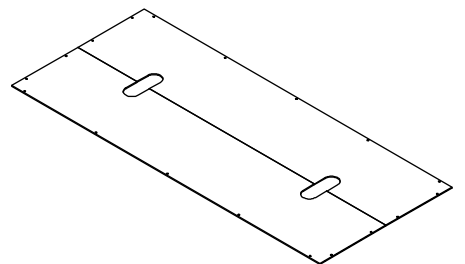

(I)

BACK PANEL

Parts Identification

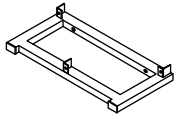

J

RIGHT AND LEFT END x 2

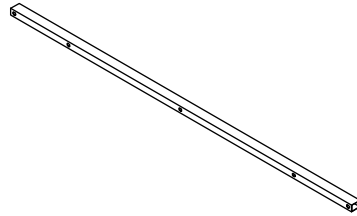

K

UPPER RAIL x 2

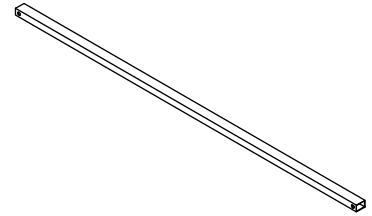

L

LOWER RAIL

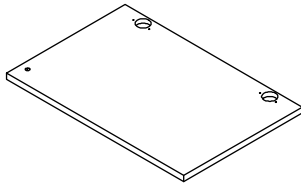

M

LEFT DOOR x2

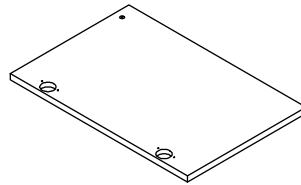

N

RIGHT DOOR x2

Hardware Identification

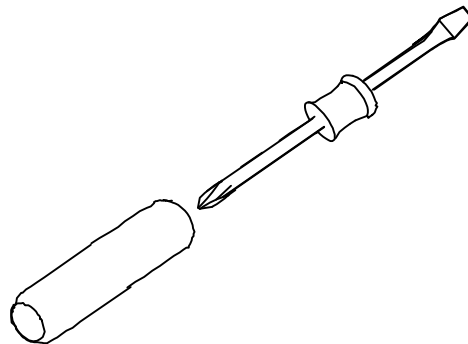

DOUBLE-HEADED SCREWDRIVER:
THIS TOOL ALLOWS YOU TO USE DIFFERENT HEAD FOR DIFFERENT
TYPE OF SCREWS BY SWITCH THE YELLOW HANDLE

Hardware Identification

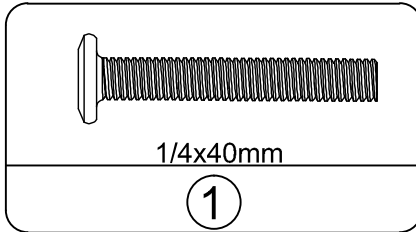

BOLT
QTY: 10+1 spare

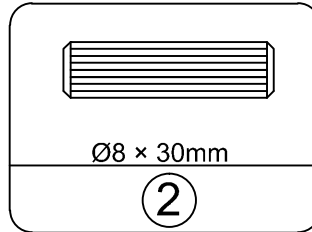

WOOD DOWEL
QTY: 20+1 spare

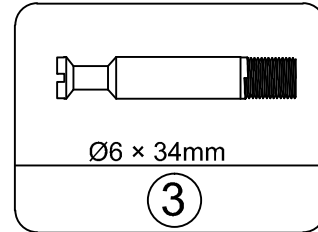

CAM BOLT
QTY: 12+1 spare

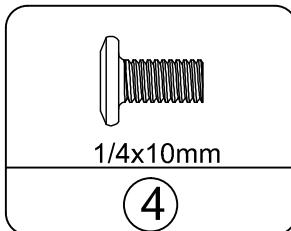

BOLT
QTY: 6+1 spare

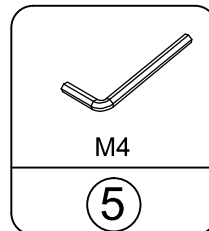

HEX KEY
QTY: 1

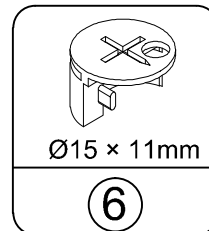

CAM LOCK
QTY: 12+1 spare

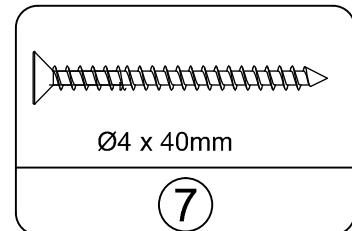

SCREW
QTY: 8+1 spare

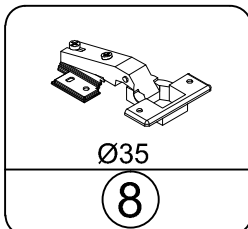

EUROPE HINGE
QTY: 4

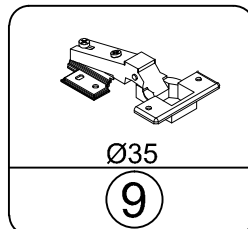

EUROPE HINGE
QTY: 4

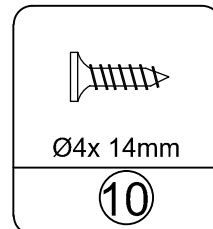

SCREW
QTY: 56+1 spare

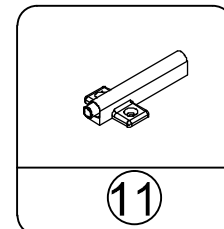

DOOR TOUCH
LATCH
QTY: 4

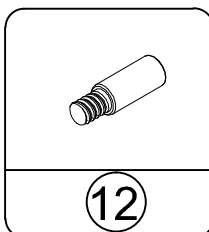

SHELF SUPPORT
QTY: 8+1 spare

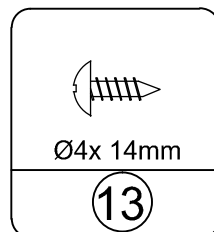

SCREW
QTY: 18+1 spare

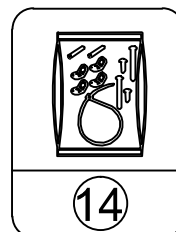

TIPPING RESTRAINT
HARDWARE KIT
QTY: 1

Step 1

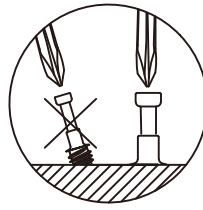

Assemble screws (part#3) vertically

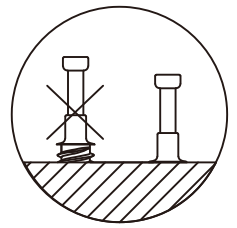

Make sure screws are lock up evenly on board

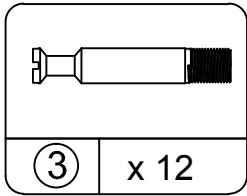
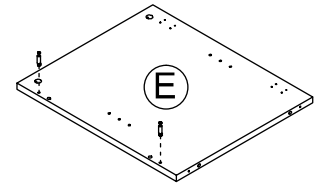
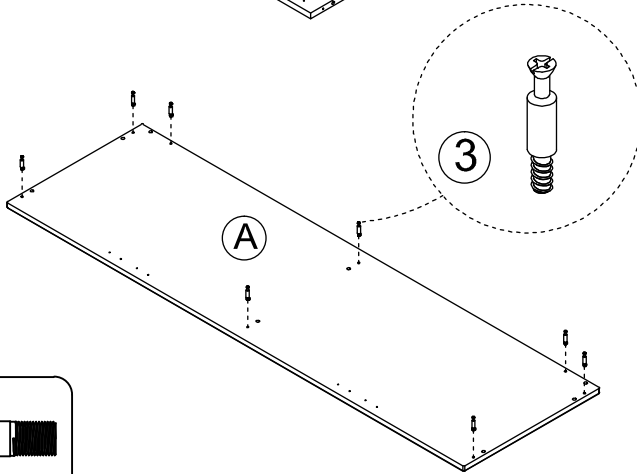
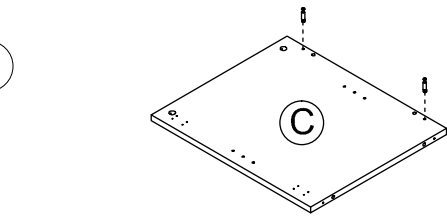
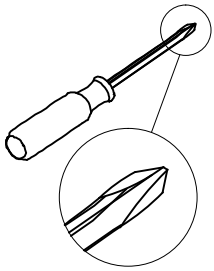

Step 2

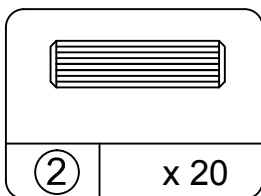
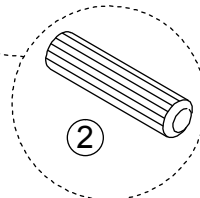
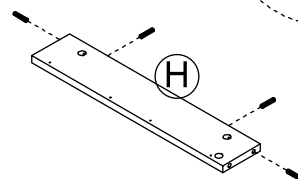
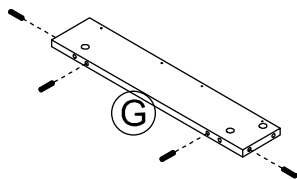
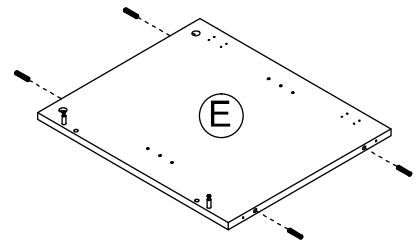
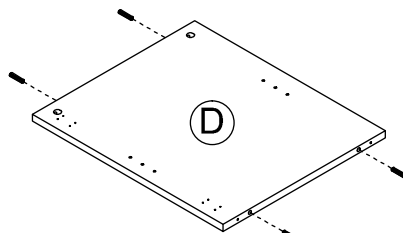
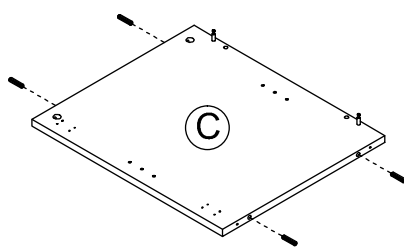

Parts 5

Step 3

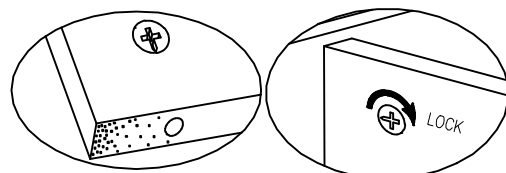

Proper orientation of CAM LOCK

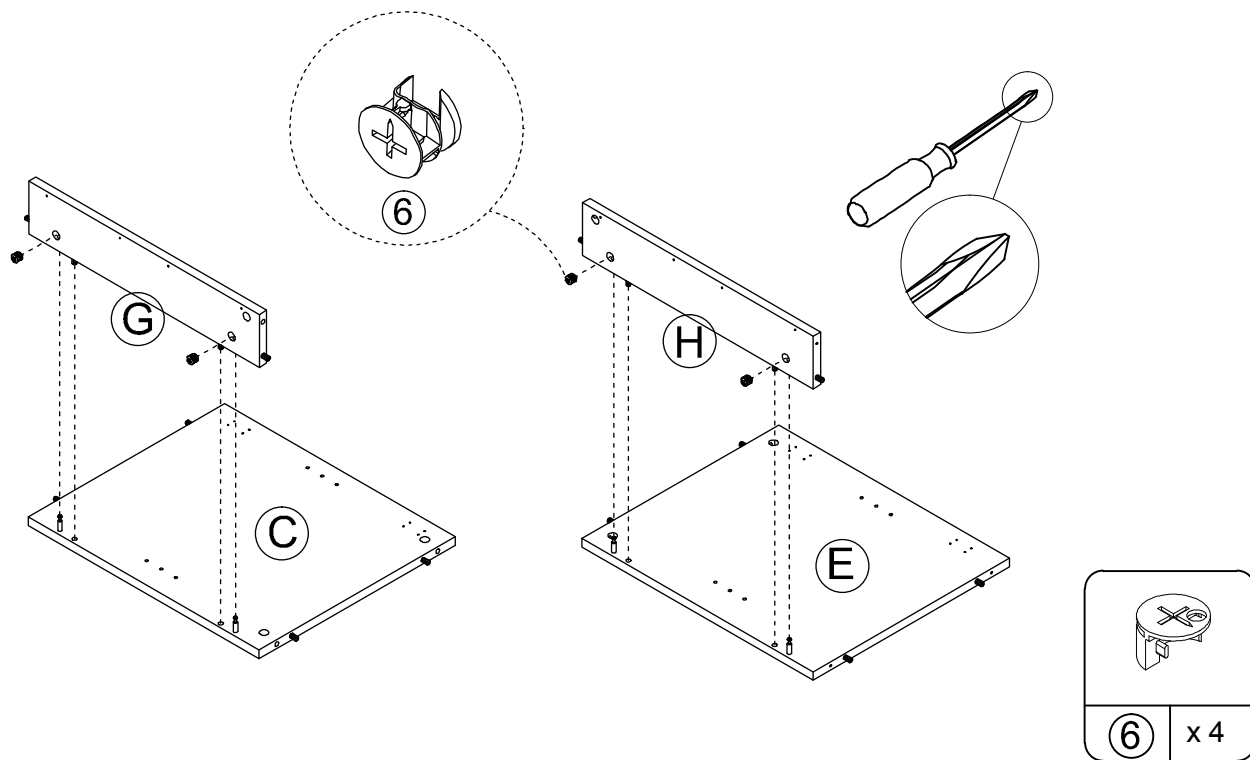

Step 4

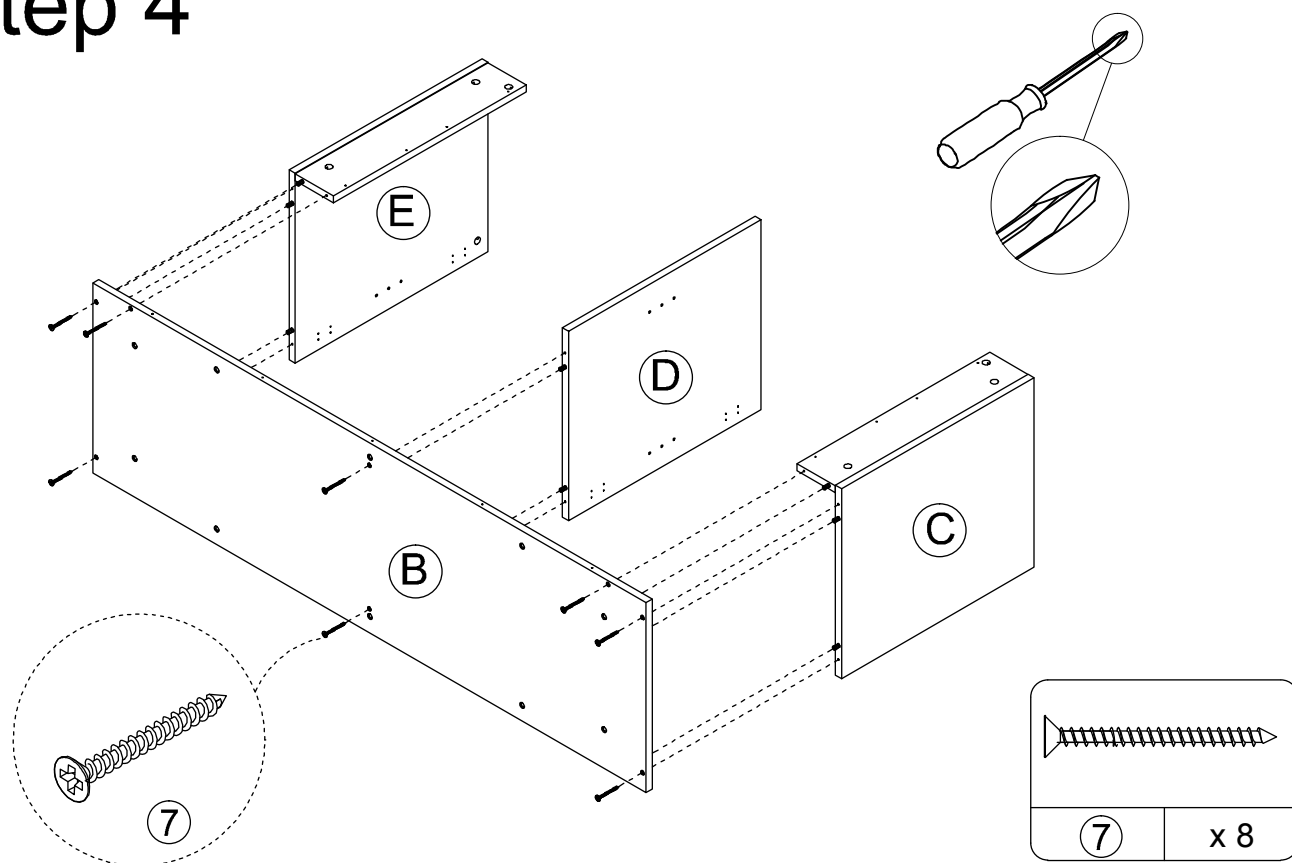

Parts 6

Step 5

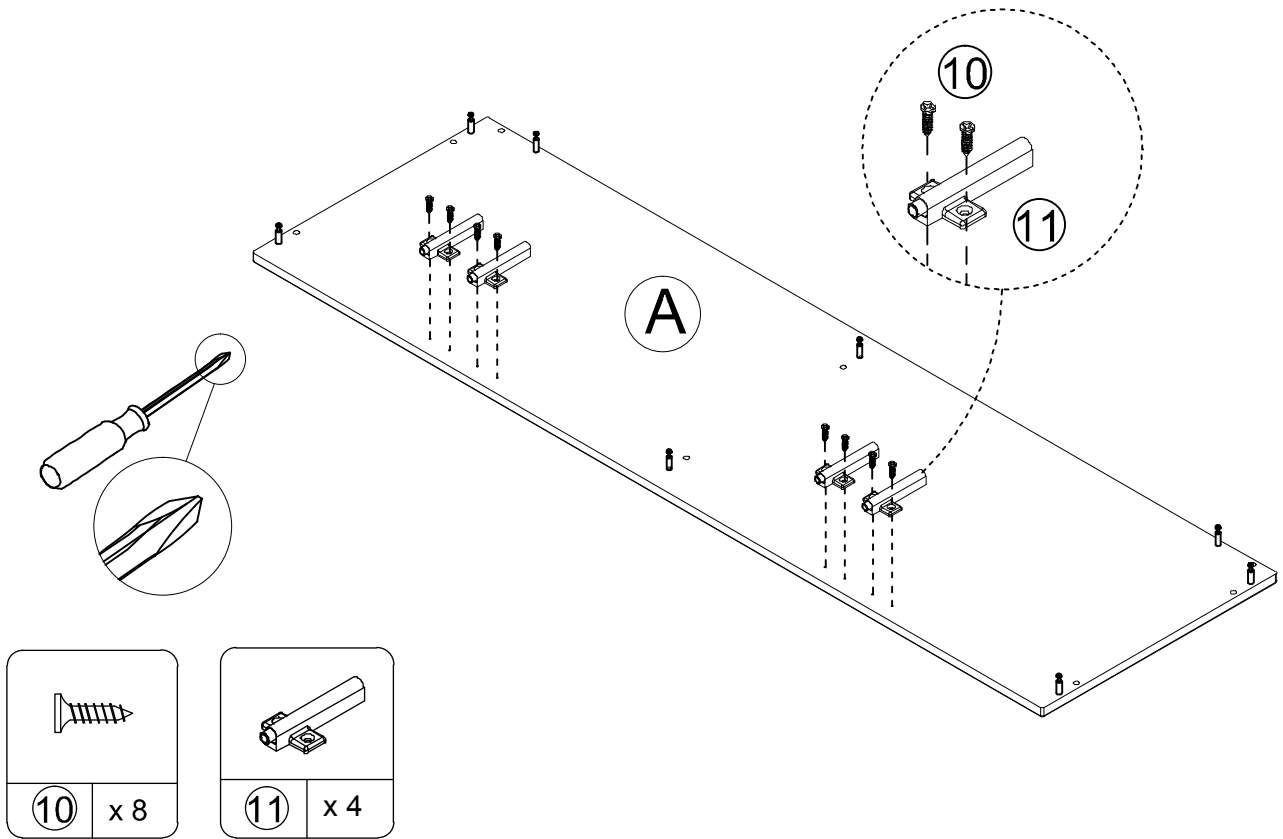

Step 6

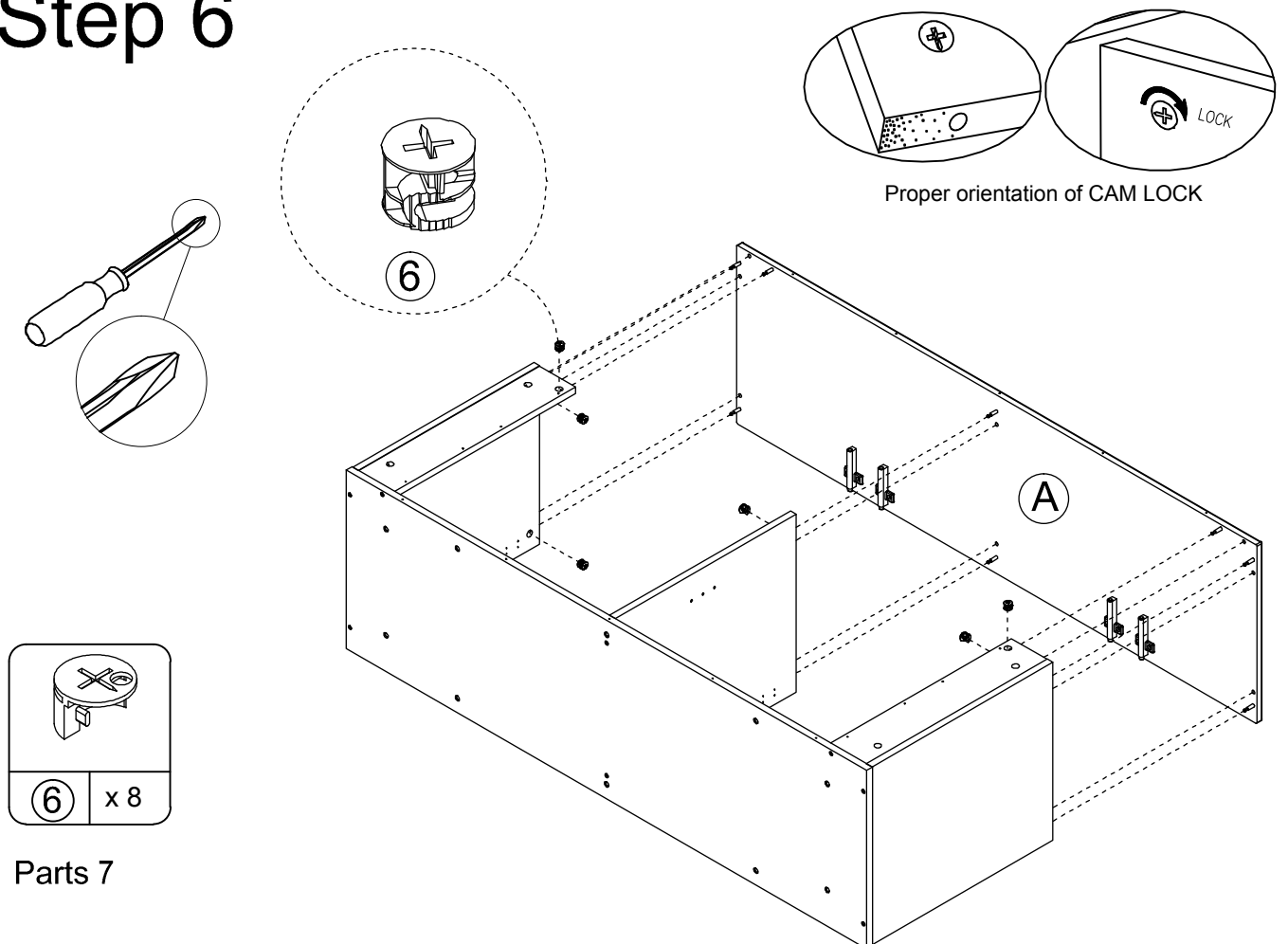

Step 7

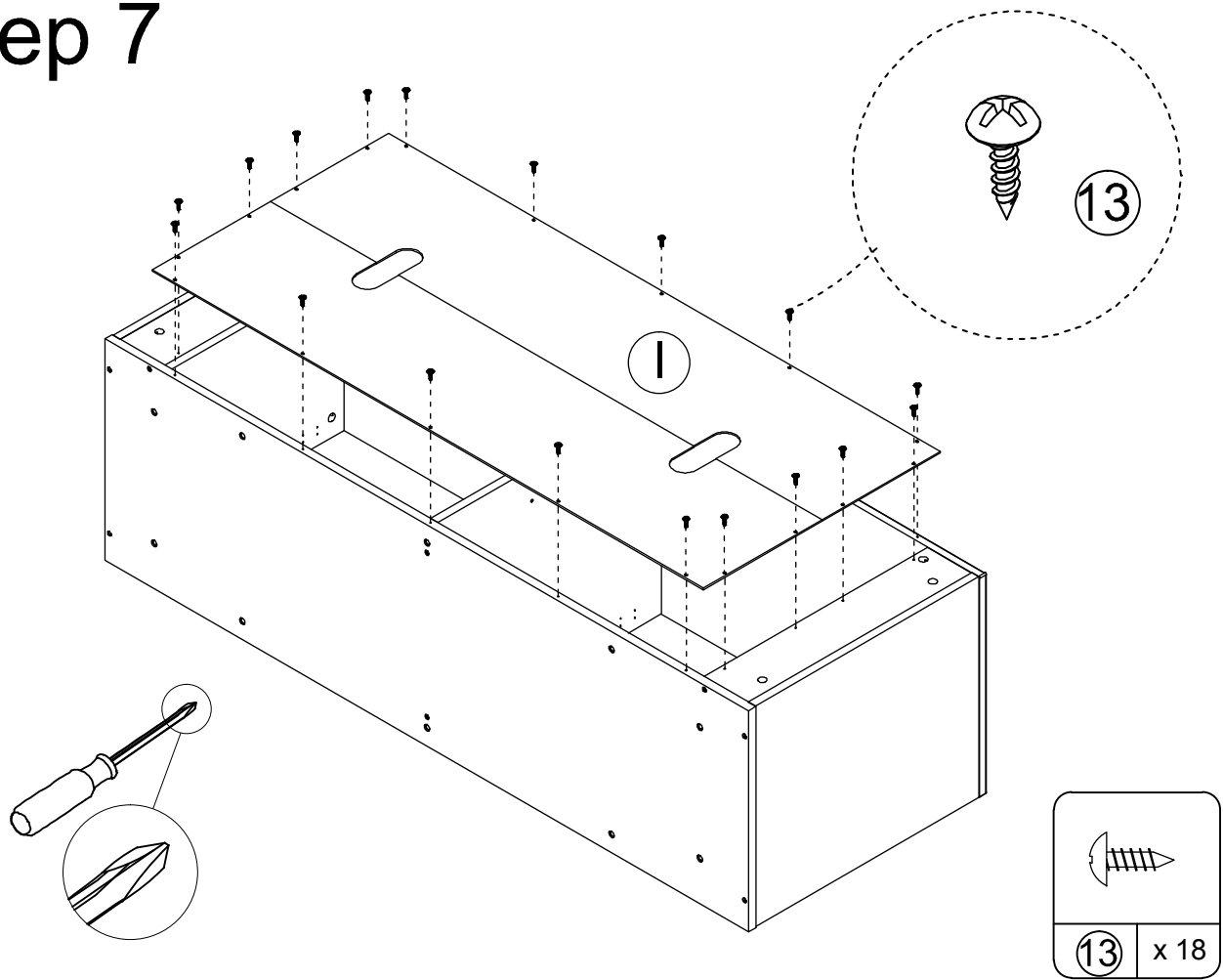

Step 8

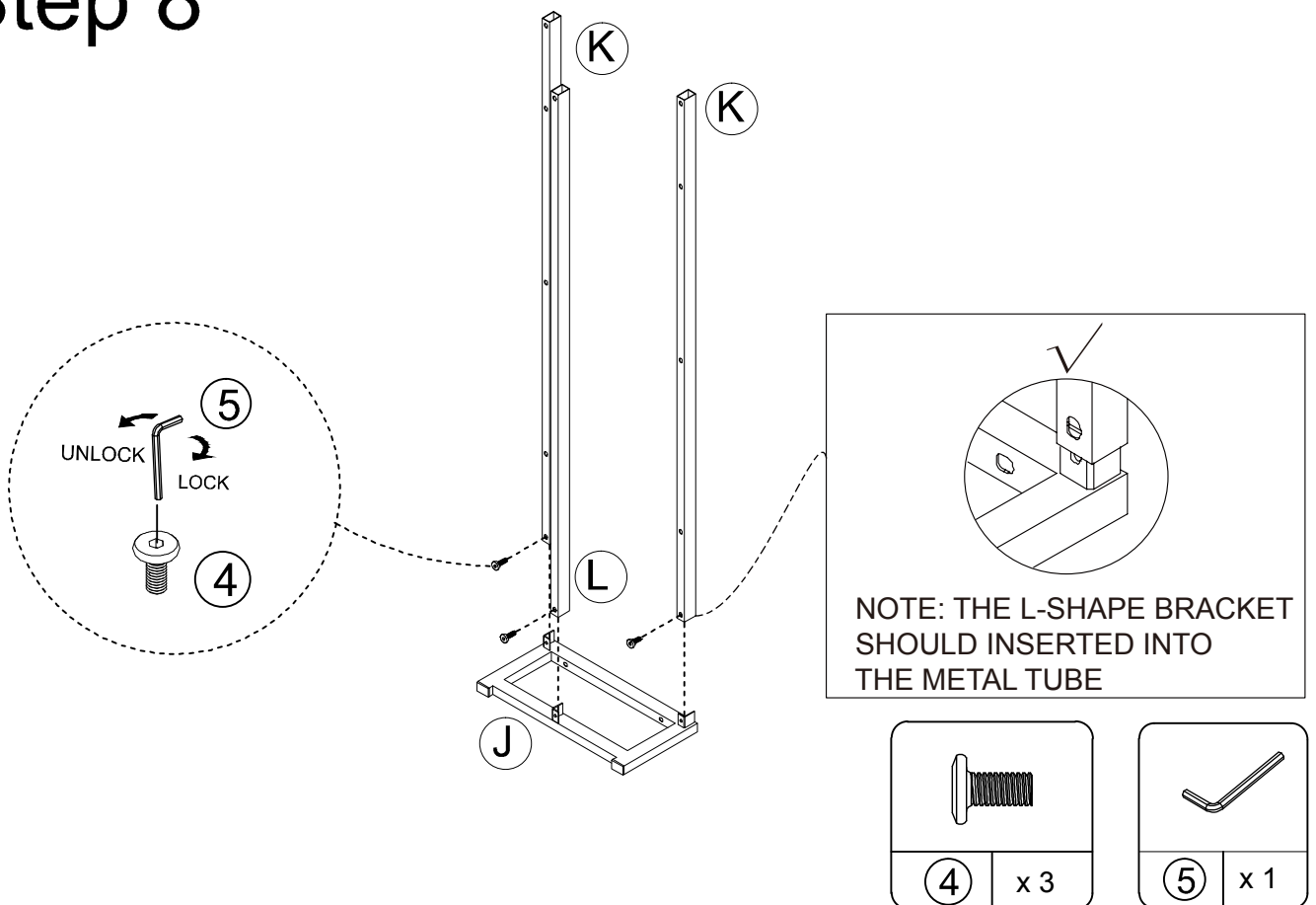

Step 9

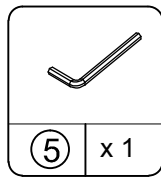
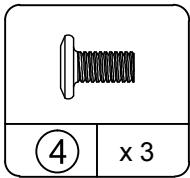
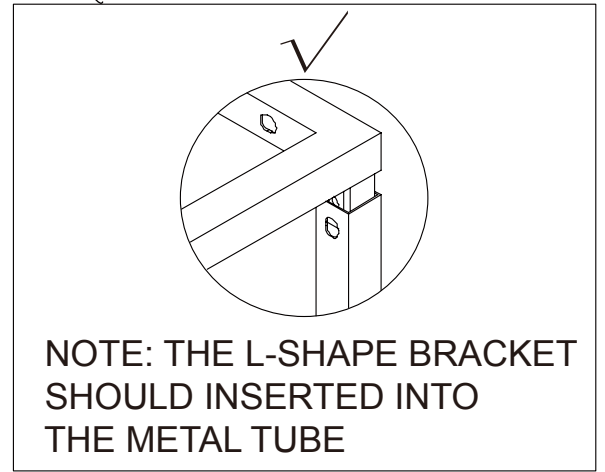
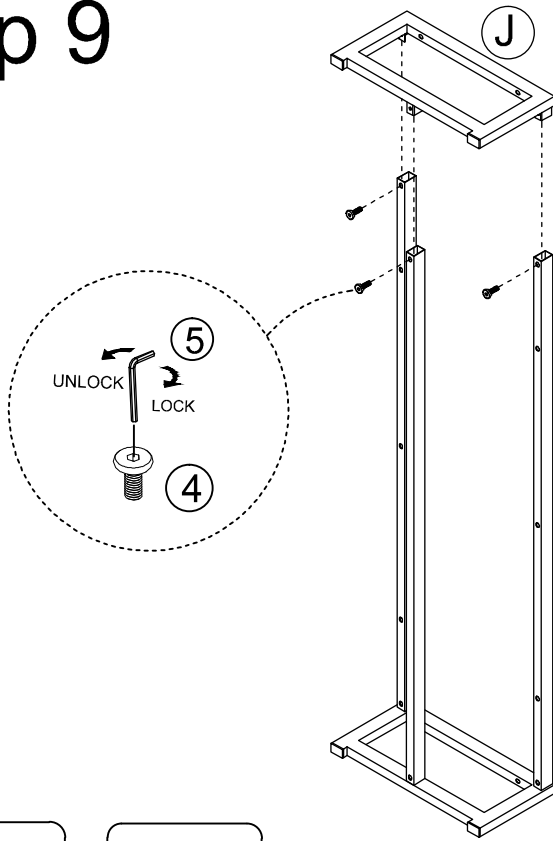

Step 10

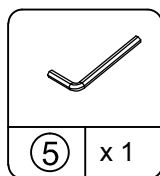
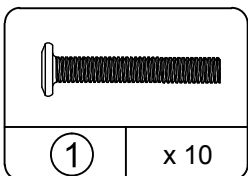
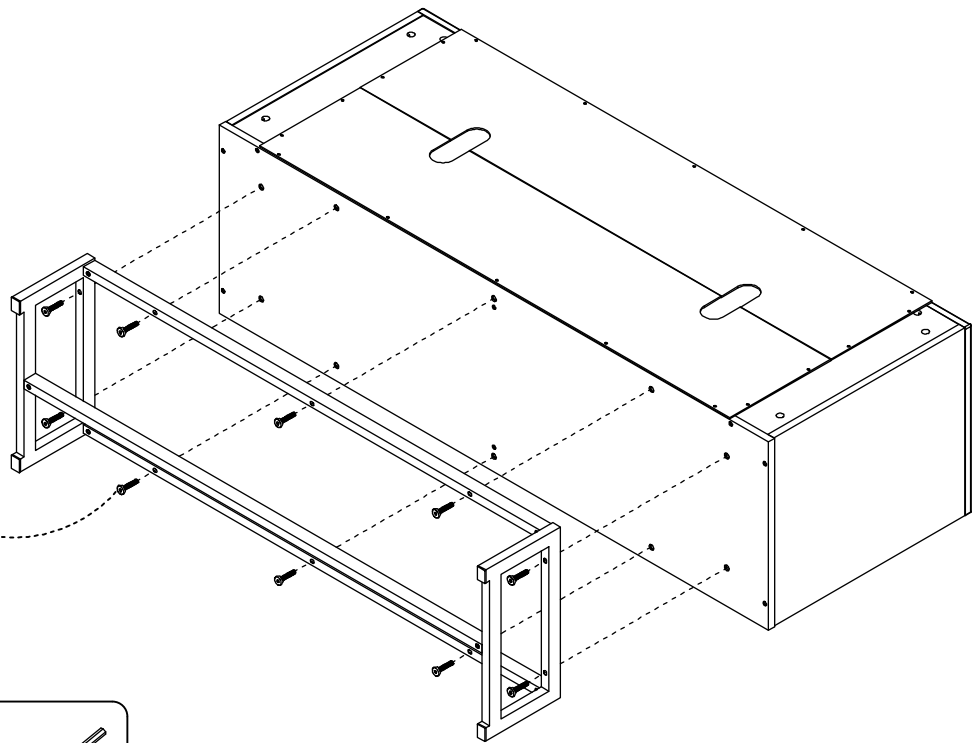
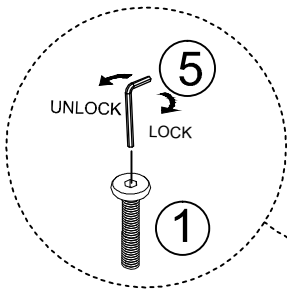

Parts 9

Step 11

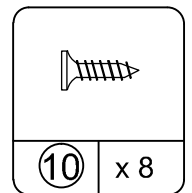
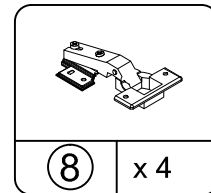
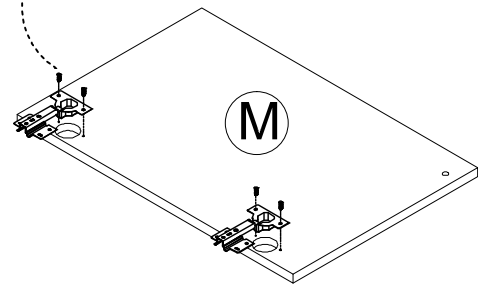
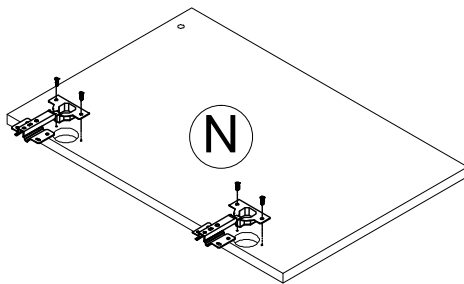
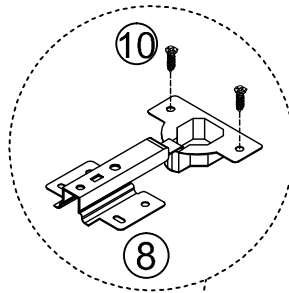
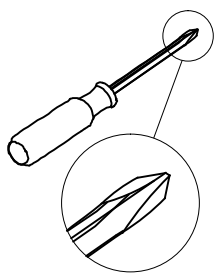

Step 12

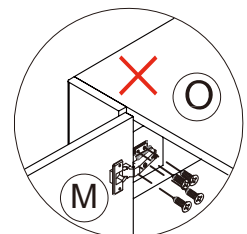
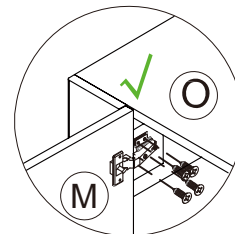

Make sure parts "M" and "O" are assembled aligning with parts "H" and "T"

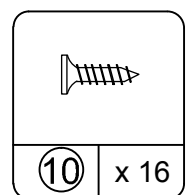
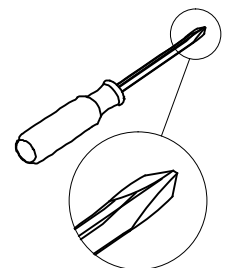
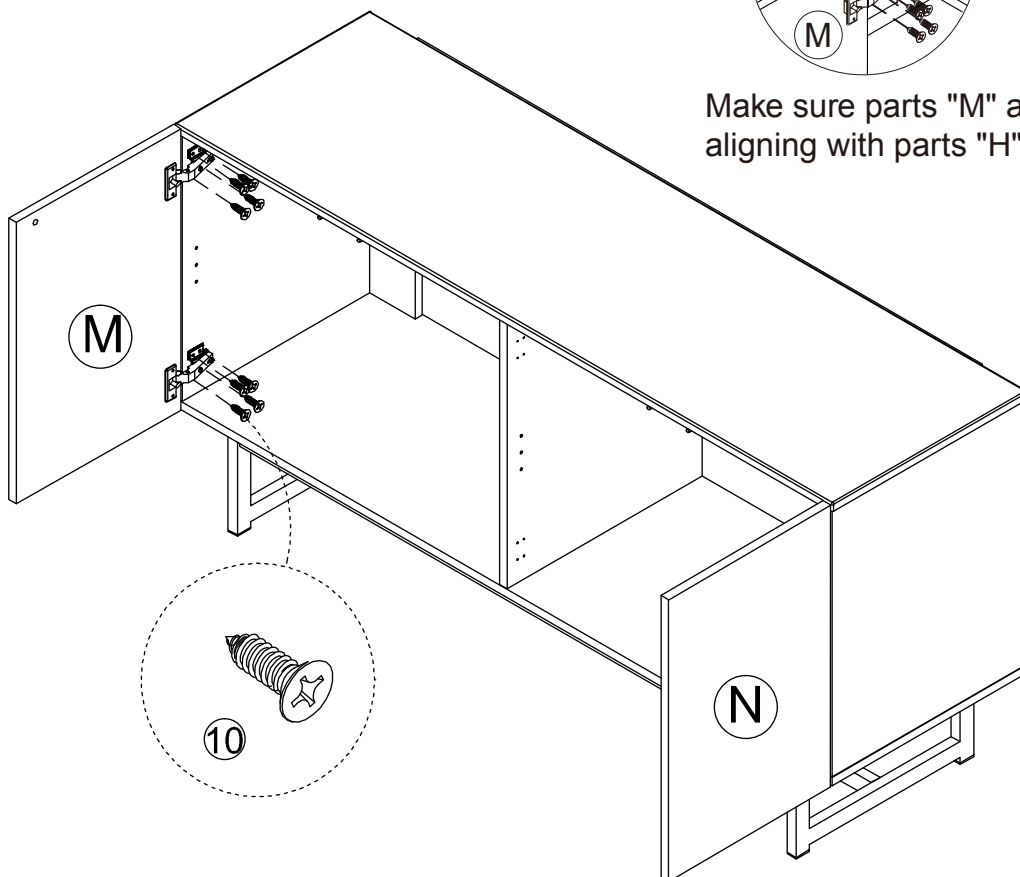

Parts 10

Step 13

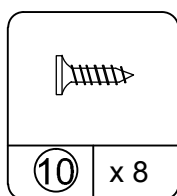
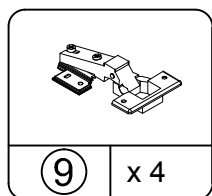
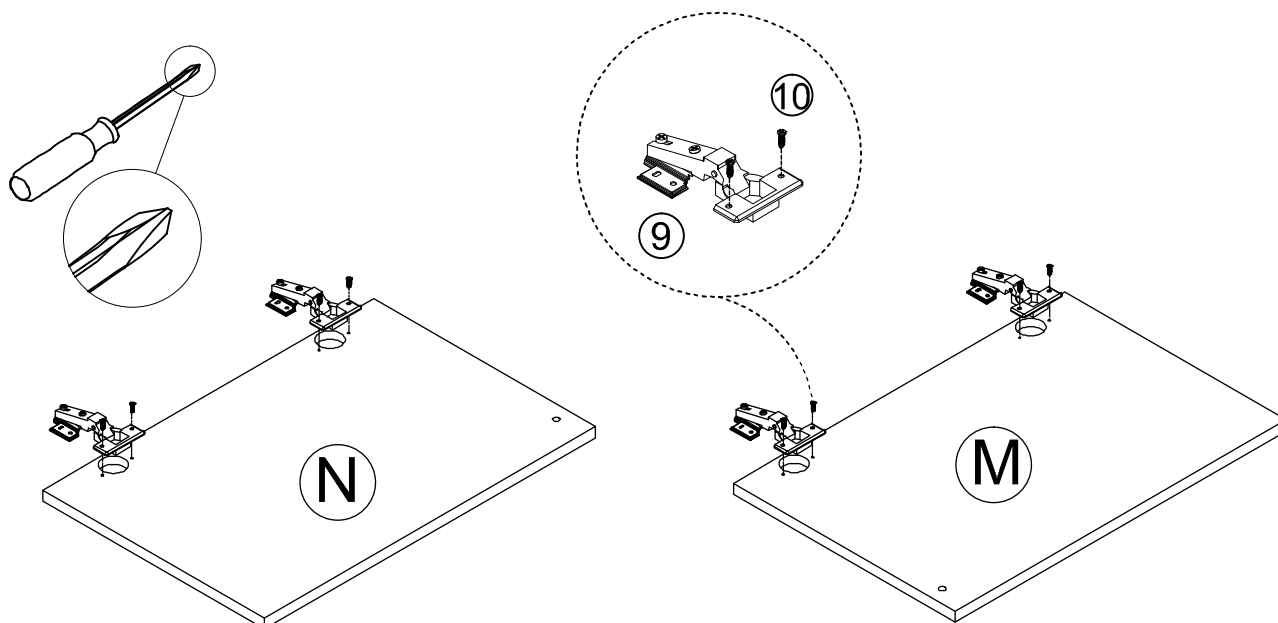

Step 14

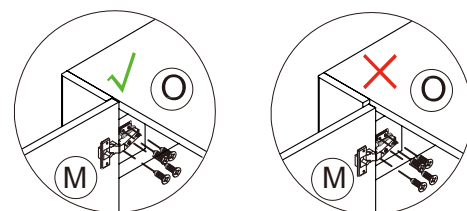

Make sure parts "M" and "O" are assembled aligning with parts "H" and "T"

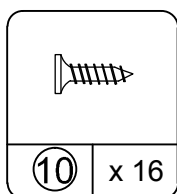
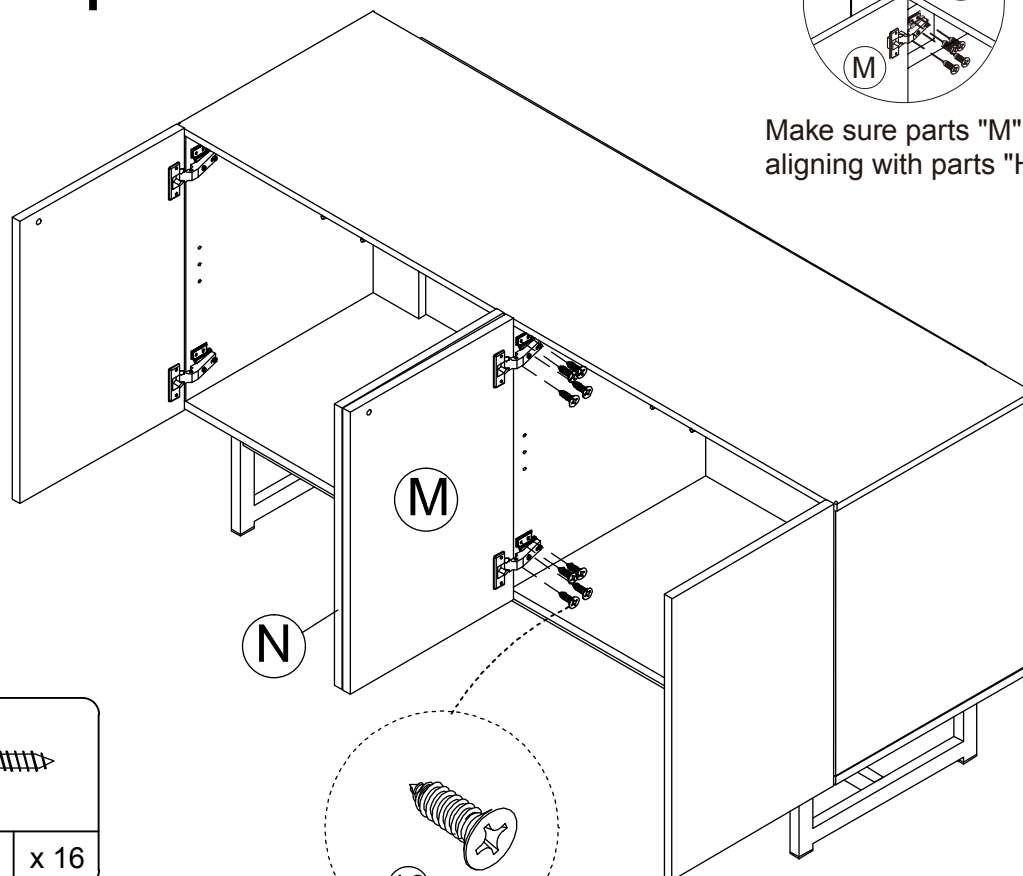

Parts 11

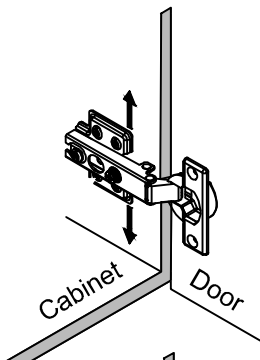
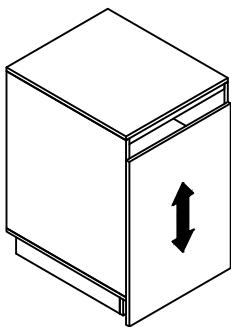
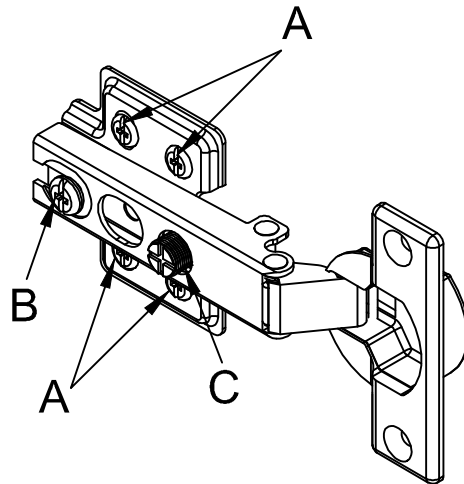

To adjust the vertical height.

Loosen the four screws "A" on both hinges. Two of them are usually in slotted holes which allows you to adjust up or down by a few mm. Then tighten back up.

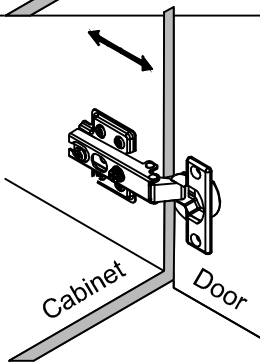
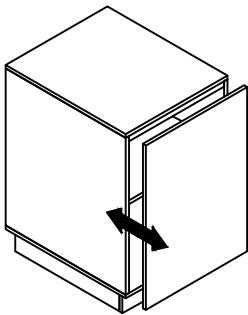

To adjust depth.

Loosen screw "B" and adjust door, if the door can not be adjusted, please loosen screw "C", then try again. Tighten screw "B" and "C".

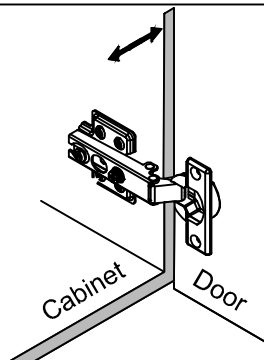
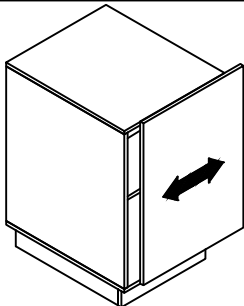

To adjust side ways.

Turning the screw "C" on BOTH hinges on each door.

Step 15

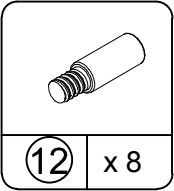
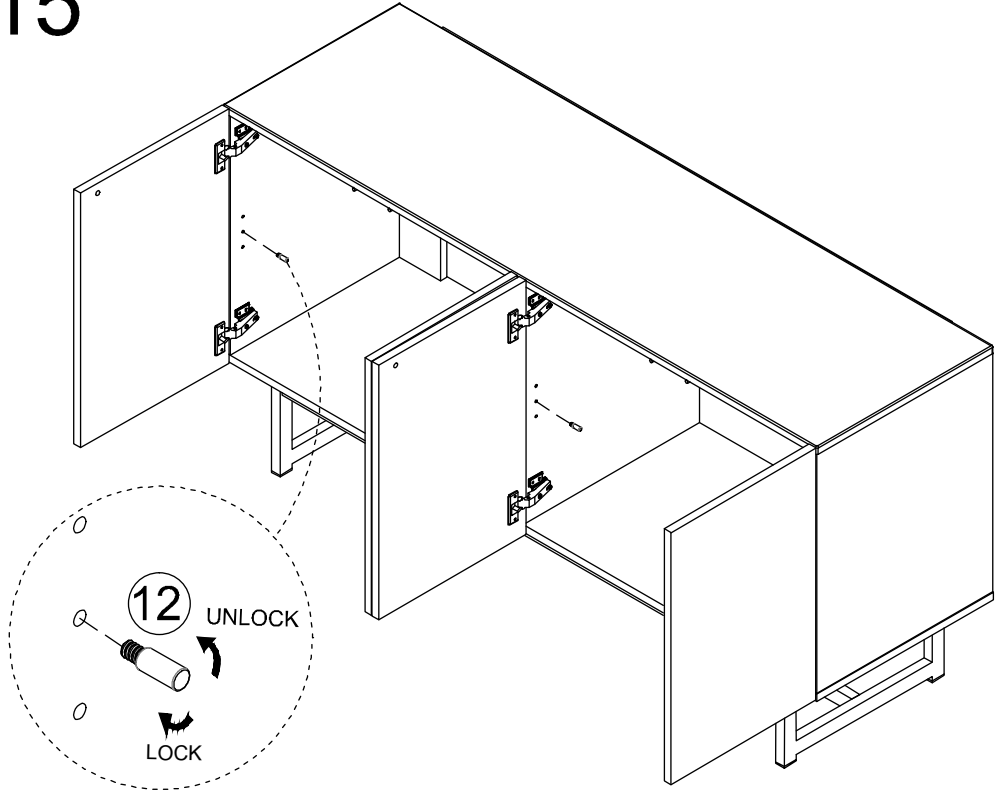

Step 16

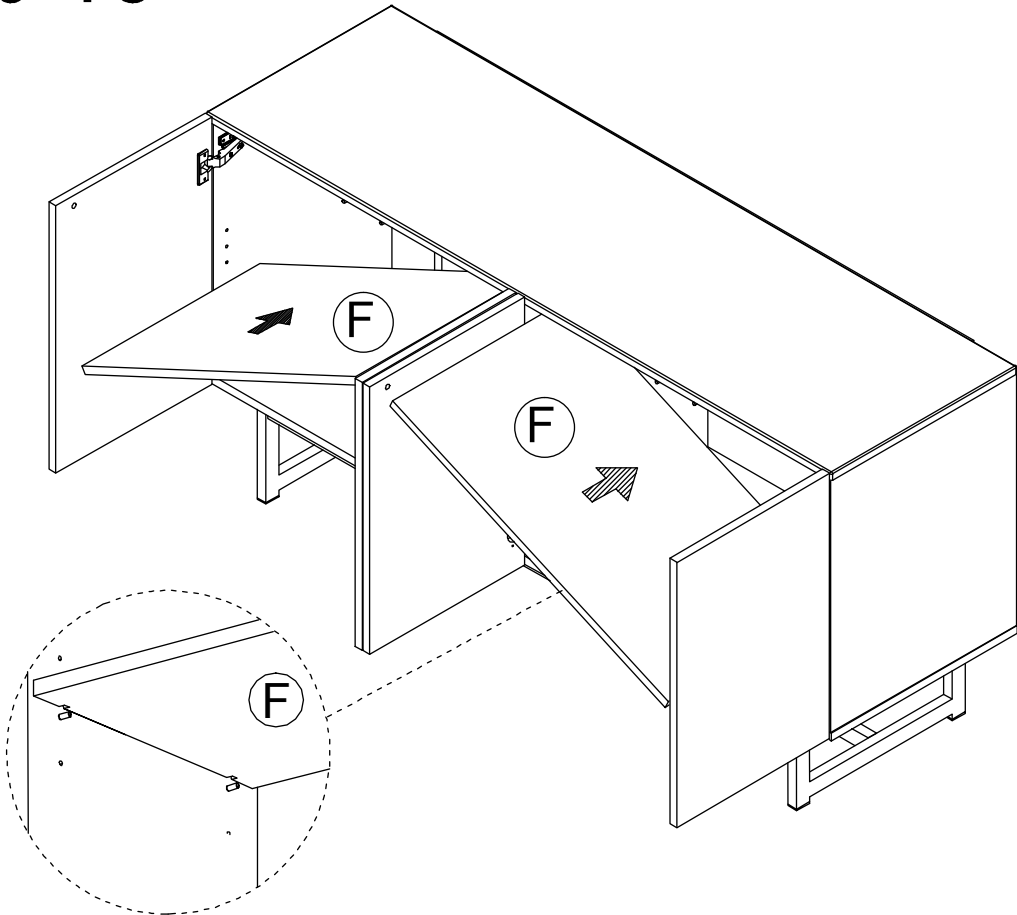

Parts 13

HOW-TO OPEN DOORS

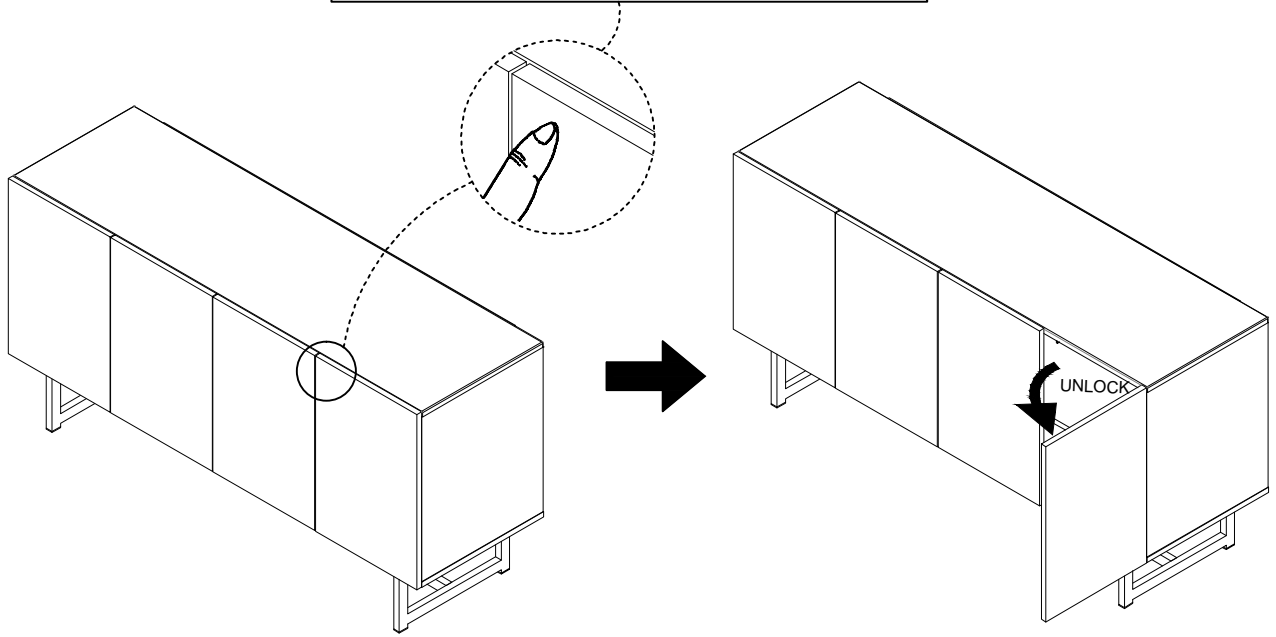

HOW-TO CLOSE DOORS

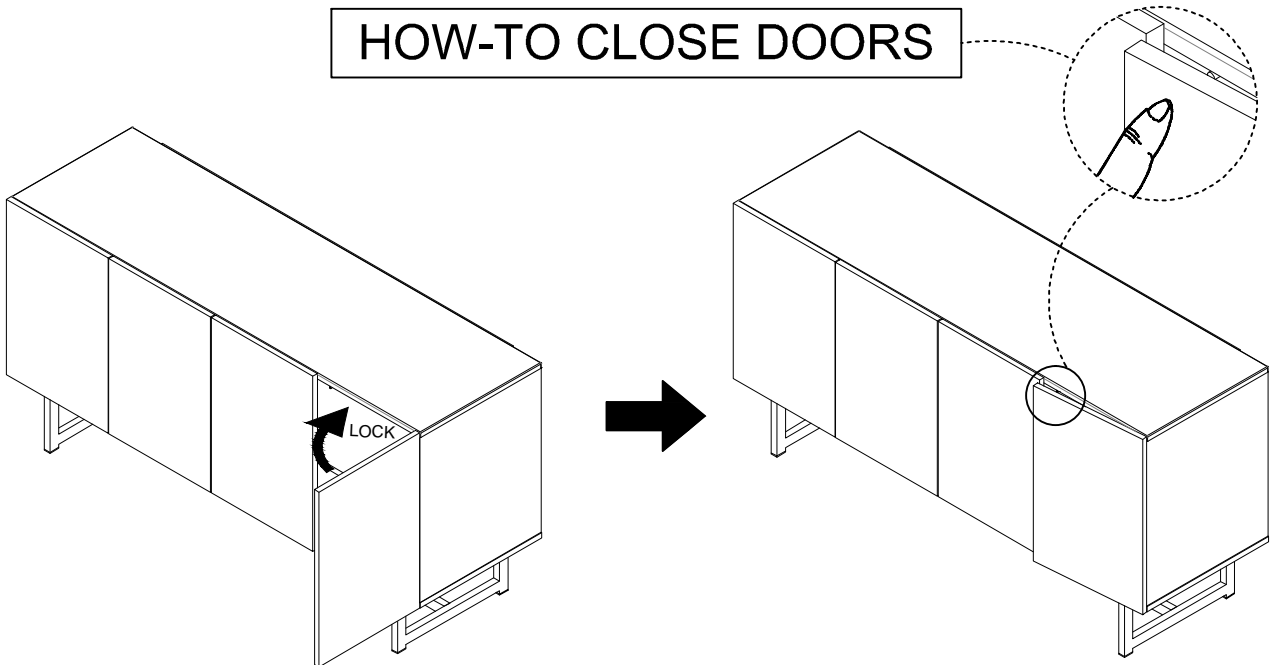

Step 17



PART LIST	FIGURE	QUANTITY	DESCRIPTION
14.1		2PC	LONG SCREW (Dia.4mmX38mmL)
14.2		2PC	SHORT SCREW (Dia.4mmX19mmL)
14.3		4PC	METAL "L" BRACKET
14.4		2PC	PLASTIC ANCHOR
14.5		2PC	CABLE

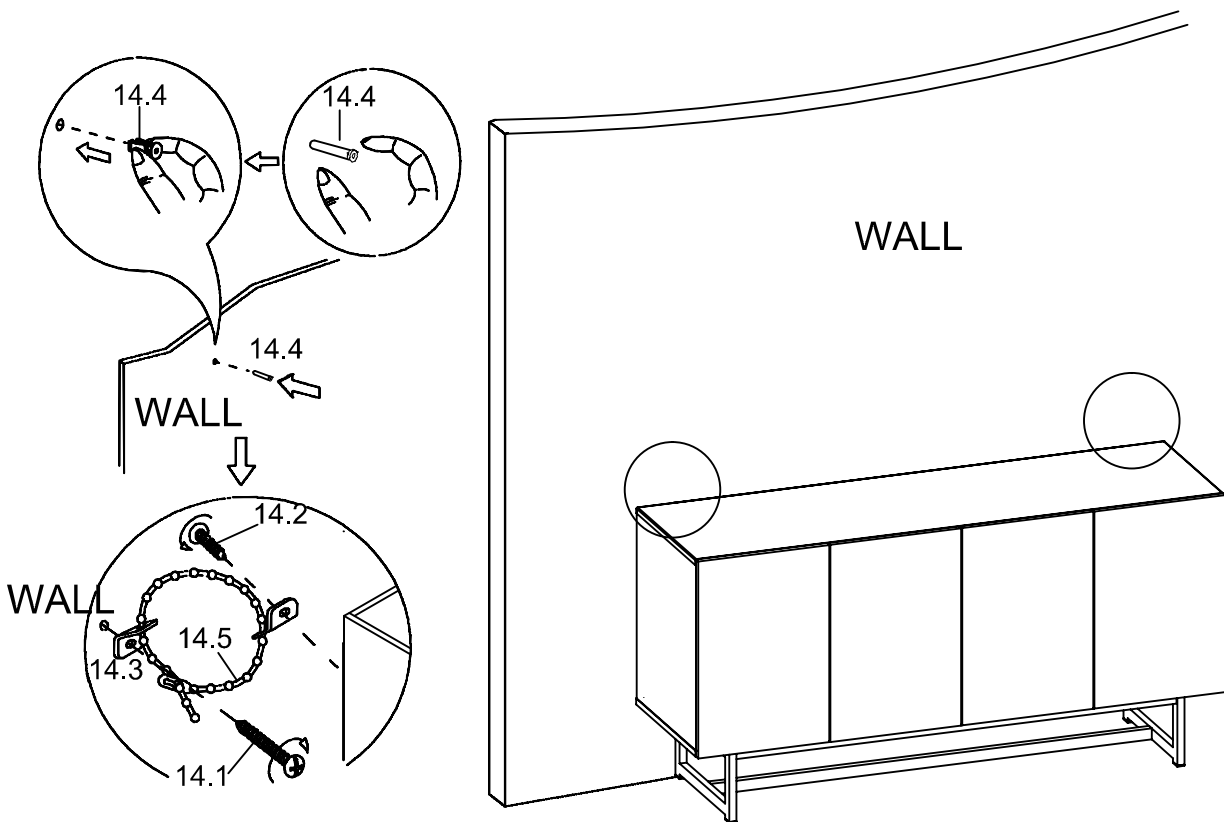
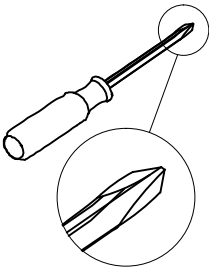

Follow the instructions printed on the plastic bag containing the tipping restraint hardware to attach the tip-over restraints to the unit and the wall.

NOTE: The tipping restraint hardware included is for drywall construction. It will be necessary to drill holes for the wall anchors. Depending upon your wall construction, different anchor hardware may be required. Please contact your local hardware store for assistance.

Safety Maximum Loads

This unit has been designed to support the maximum loads shown. Exceeding these load limits could cause sagging, instability, product collapse, and/or serious injury.

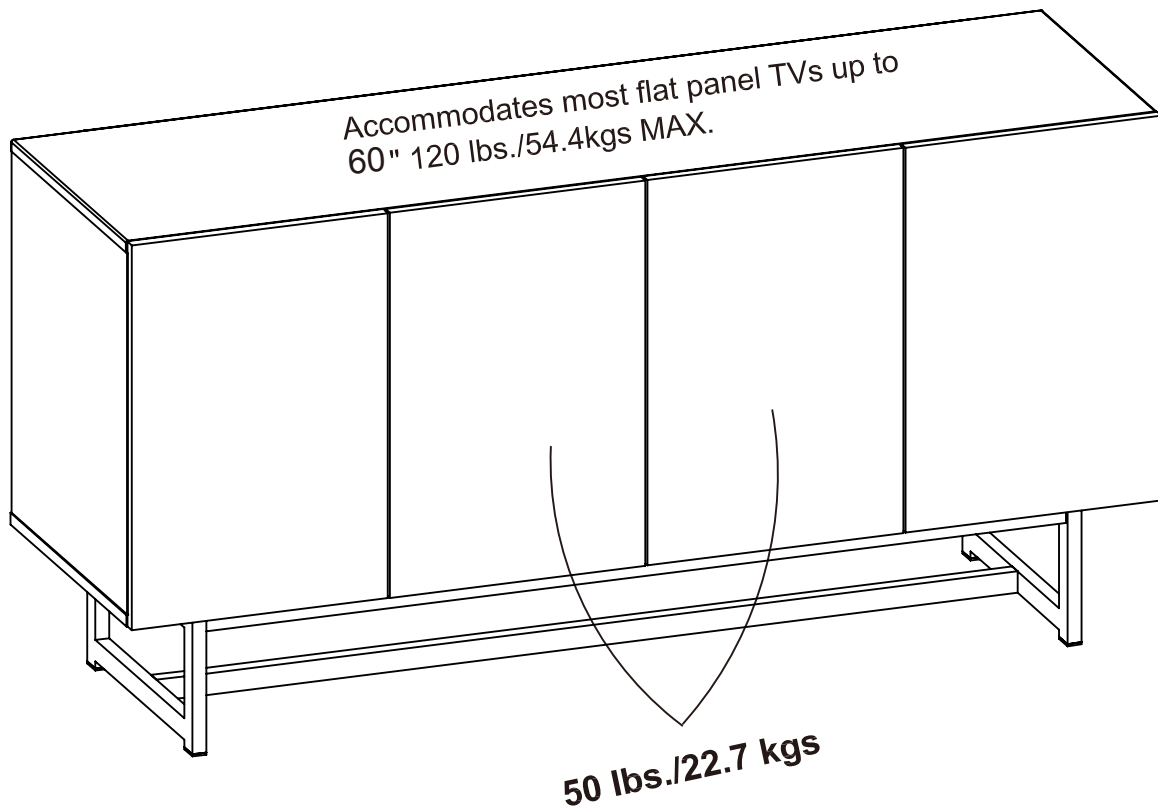

WARNING

Please make sure that all objects are removed before moving the assembled unit. The unit must be team lifted, not dragged or pushed. Failure to do so could cause instability, product collapse, and/or serious injury.