

ASSEMBLY INSTRUCTIONS

30" ROUND TABLE

LIST OF PARTS

NO.	Q.TY	DESCRIPTION
A	1 PC.	TABLE TOP
B	4 PCS.	LEG
C	8 PCS.	FLAT WASHER
D	8 PCS.	LOCK WASHER
E	8 PC.	NUT
F	1 PC.	KEY WRENCH

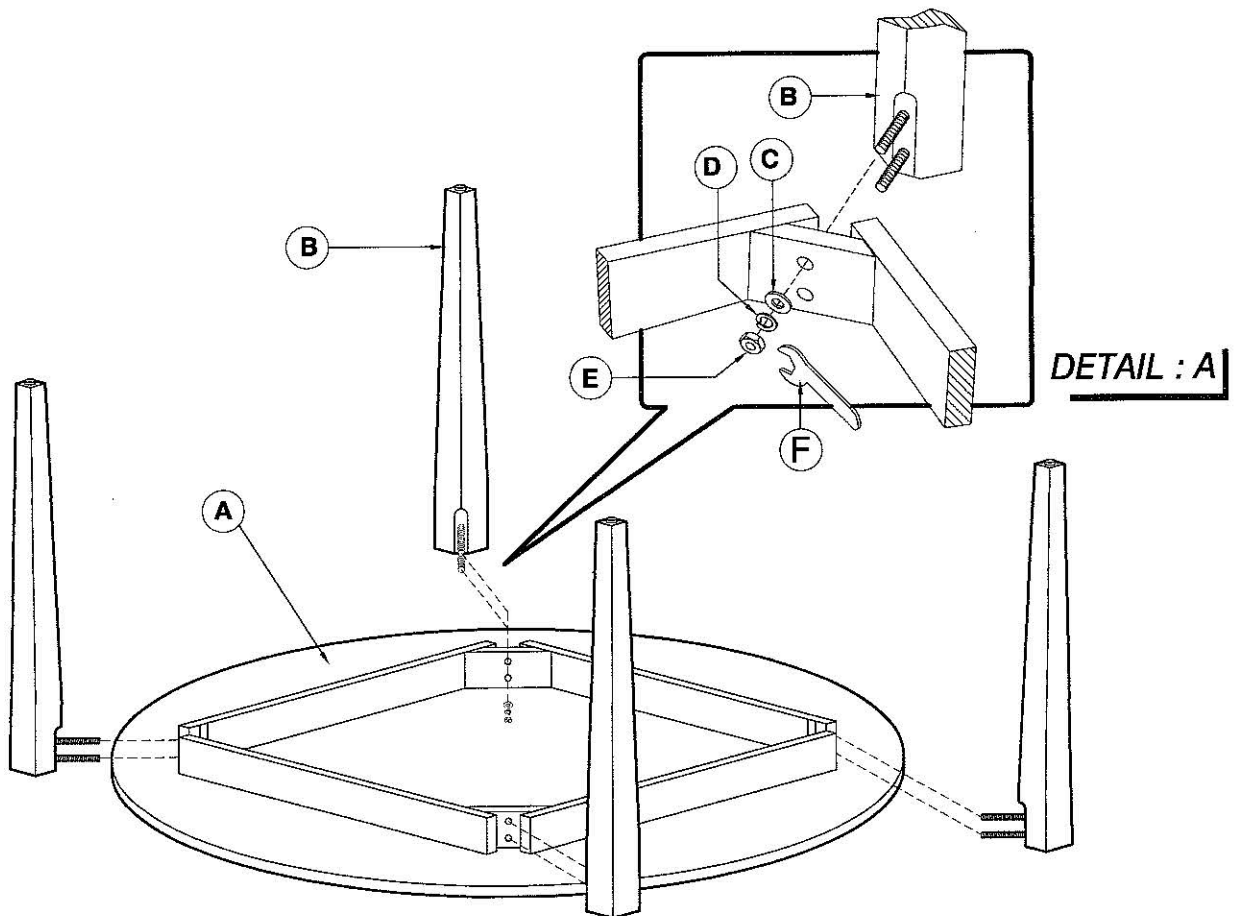
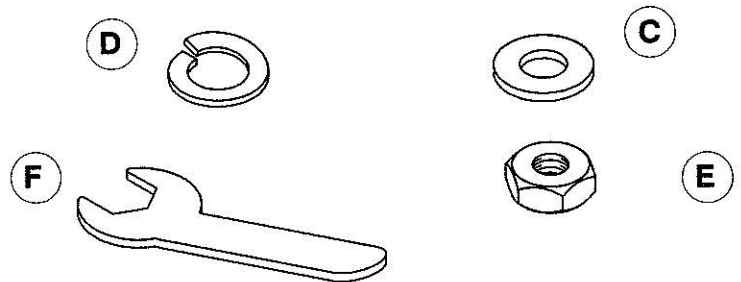

STEP : 1

- PLACE TABLE TOP (A) UP-SIDE-DOWN ON CARPETING OR CARTON FOR PROTECTION.
- ALIGN AND PLACE 4 LEGS (B) INTO EACH CORNER OF TABLE TOP (A) AS SHOWN IN ILLUSTRATION.
- PLACE FLAT WASHER (C), LOCK WASHER (D) AND NUT (E) INTO THE THREADED ON THE BOLT.
- FULLY TIGHTEN ALL NUTS (E) WITH THE PROVIDED KEY WRENCH (F) TURNING CLOCKWISE UNTIL SECURE. (SEE DETAIL : A)