

# TABLE INSTALLATION INSTRUCTION

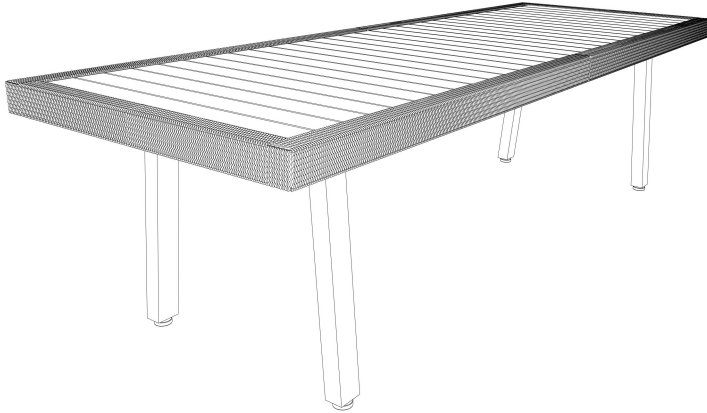

## Maintenance Notice

- The Outdoor Dining Table and Chairs are designed for all-weather use, but even the most durable furniture requires proper care.
- Please avoid using detergents, as they contain chemicals that may destroy or damage the fabric surface. If a spill occurs, please wipe it off immediately, then clean with a damp cloth and only use plain water.
- In case of severe weather, we recommend storing cushions and pillows in a terrace box or covering the entire outdoor furniture set. This will effectively extend the lifespan of the product and help keep it looking like new for longer.
- Our tabletops are made from PET slats, with a maximum heat resistance of 120°C (248°F). Please do not place open flames directly on the tabletop, such as portable outdoor pizza ovens or grills. If using high-temperature items, we recommend using a thick heat-resistant pad.

# Assembly accessories

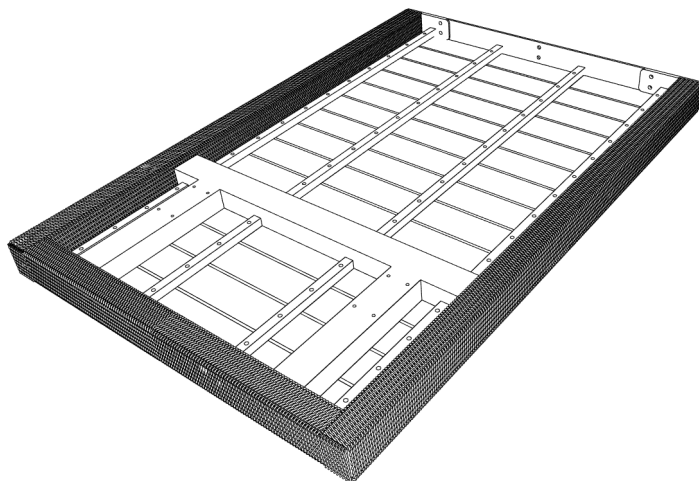

Ax2

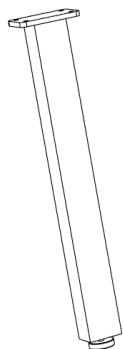

Bx4

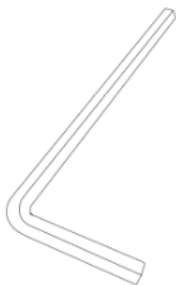

Cx1

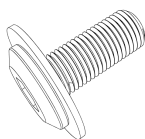

Dx17

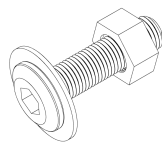

Ex7

Note: One spare screw and gasket are provided.

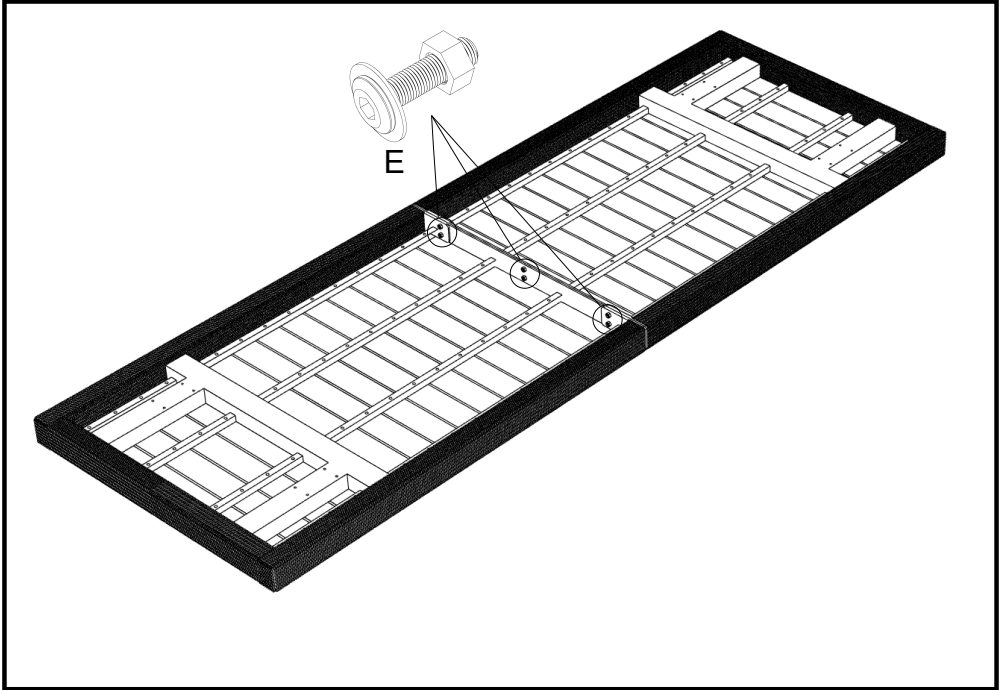
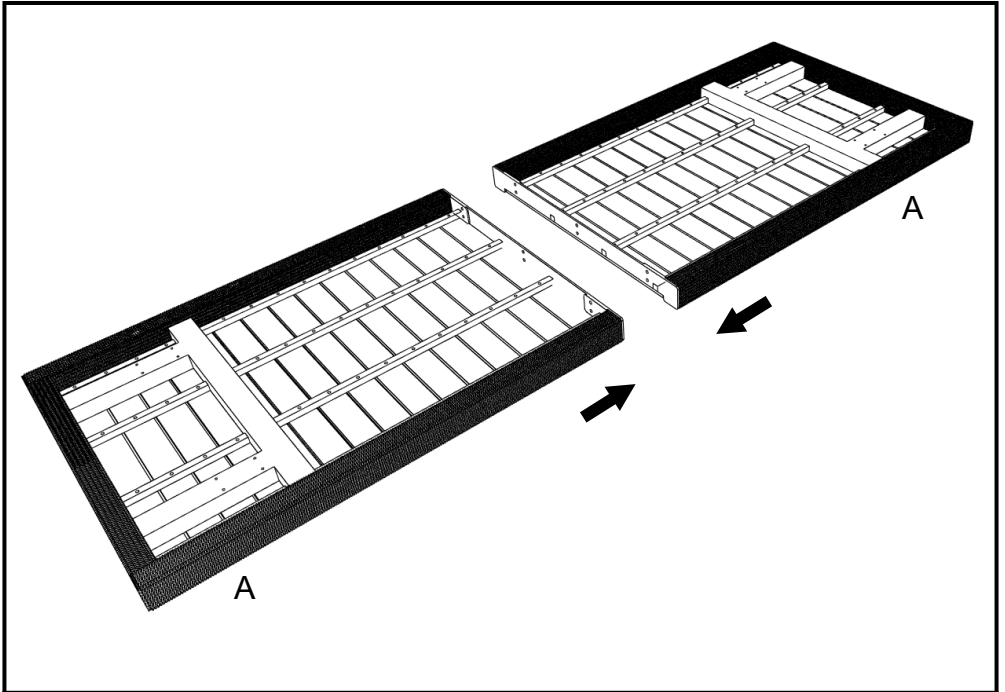

Note: It's suggested to screw all the screws in positions and then tighten them up.

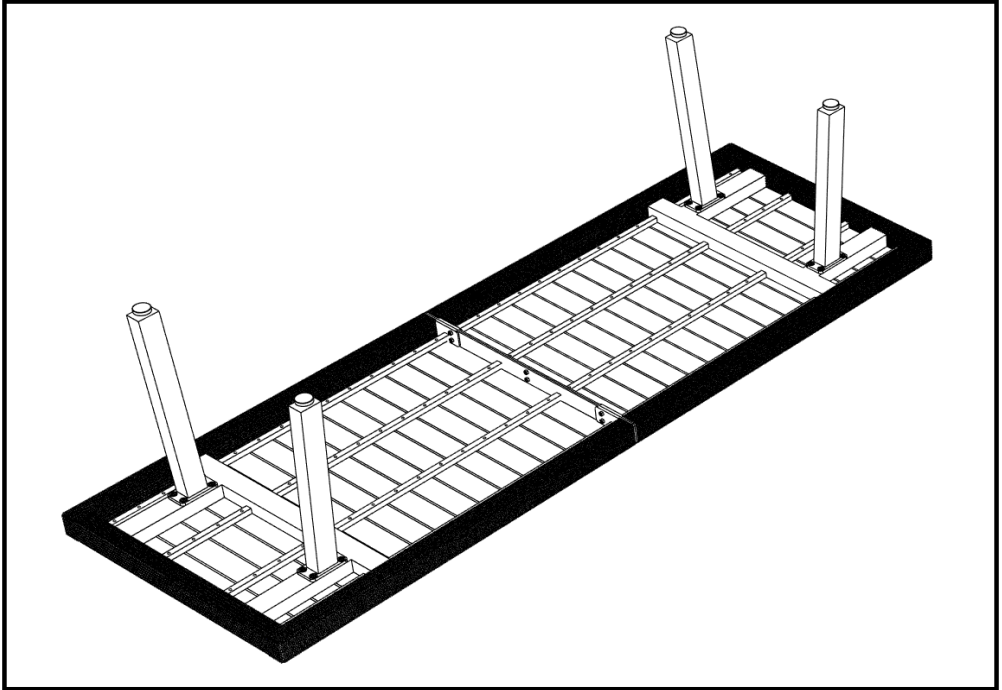
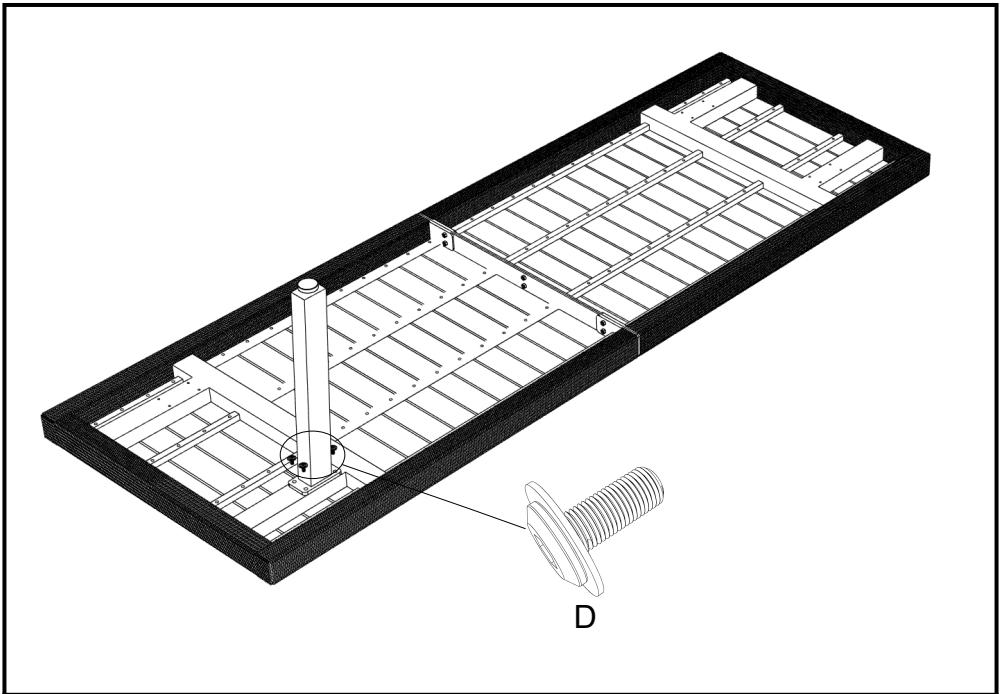

Note: It's suggested to screw all the screws in positions and then tighten them up.