

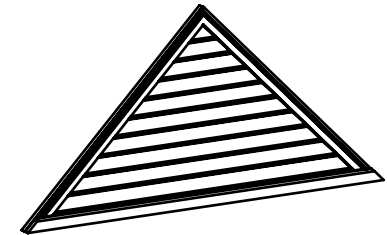

Technical drawing of a 6-sided pyramid (hexagonal pyramid) showing dimensions. The drawing includes a top view (a regular hexagon) and a side view (a triangle). The side view is labeled with a height of 32" and a base width of 64". The top view is labeled with a side length of 54 3/8". The drawing also shows a 6-sided pyramid with a height of 27 1/8" and a base width of 64". The drawing is labeled with dimensions: 32", 64", 54 3/8", 27 1/8", 2", 4 7/8", and 6-sided.

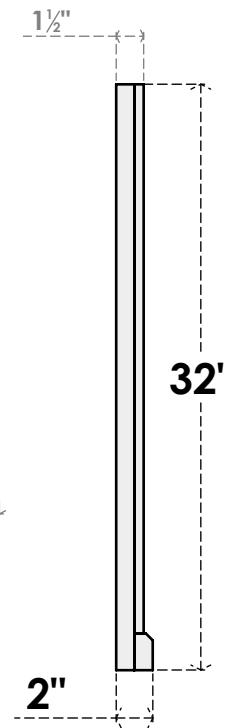

## SIDE

**EKENA MILLWORK**  
2300 WEST MAIN ST.  
CLARKSVILLE, TX 75426  
TOLL FREE: 866-607-0453  
[WWW.EKENAMILLWORK.COM](http://WWW.EKENAMILLWORK.COM)

1. INSTALLATION TO BE COMPLETED IN ACCORDANCE WITH MANUFACTURER'S SPECIFICATIONS.
2. DRAWING MAY NOT BE TO SCALE
3. THIS DRAWING IS INTENDED FOR DESIGN AND PLANNING PURPOSES ONLY.
4. ALL INFORMATION CONTAINED HEREIN WAS CURRENT AT THE TIME OF DEVELOPMENT BUT MU
- PRODUCT MANUFACTURER TO BE CONSIDERED ACCURATE.
5. ARCHITECTURAL GRADE PVC PRODUCTS ARE MADE FROM EXPANDED CELLULAR PVC AND CO

Generated Date : 08/23/2022