



XOU24WDZGOA
UNDERCOUNTER WINE COOLER
DUAL ZONE
GLASS OVERLAY



Height Adjusts
to Accommodate:
ADA Compliant Cabinetry
European Cabinetry
US Standard Cabinets
4" or 6" Toe Kick

Designed for use with a
framed glass overlay door.

24" UNDERCOUNTER WINE COOLER with OVERLAY FRAME DOOR

The ALL PURPOSE UNIT. With soft closing, reversible articulated hinges - the GOA units provide a perfectly integrated look whether you are installing under ADA or Standard height counters, using American or European style cabinetry, and can accommodate a 3, 4 or 6 inch toekick.

The XO GOA system is truly your all purpose undercounter solution.

WORLD CLASS SERVICE | COMPREHENSIVE WARRANTIES
OUR LASTING COMMITMENT TO YOU



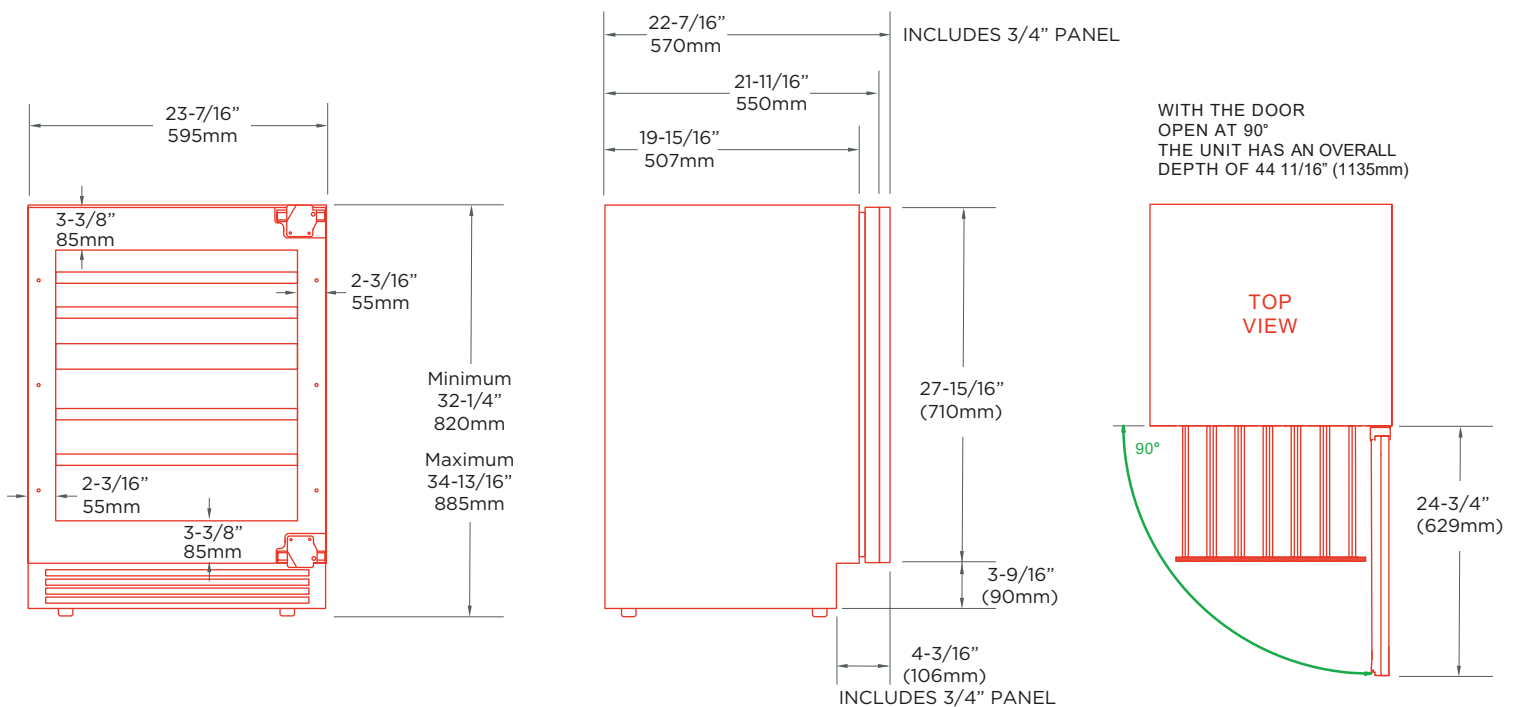

FEATURES

CAPACITY

Full extension smooth glide racks hold:
(12) 750ml bottles upper section at 41° to 50° F
(21) 750ml bottles lower section at 50° to 64° F

FEATURES

Articulated hinges for seamless integration
Soft closing, field reversible door
Library quiet 39 dBA operation
Elegant tri-color interior illumination
True seamless cabinet integration
Intuitive digital touch controls
6 1/2' power cord with low profile 90° flat plug
Low E Glass blocks harmful UV light
Alarm Functions
Energy Saver and Sabbath Mode

SPECIFICATIONS

ELECTRICAL 120V 60HZ 4.35 AMP*

DIMENSIONS H 32 1/4" min - 34 13/16" max
W 23 7/16"
D 21 11/16" (w/o finish panel)

ROUGH IN H 32 1/2" min
W 24"
D 24"

REFRIGERANT R600A

OPTIONAL ACCESSORIES SS Door Panel for ADA Installs
(includes 2 different style handles)
P/N: XOU24ADASG



Watch the
Video on
YouTube
CLICK ON
THE IMAGE

XO the next level
in luxury appliances

xoappliance.com | 800.966.8300



XO is exclusively distributed by
EASTERN MARKETING CORP.
24 Eisenhower Parkway
Roseland, NJ 07068

ROUGH IN DIMENSIONS

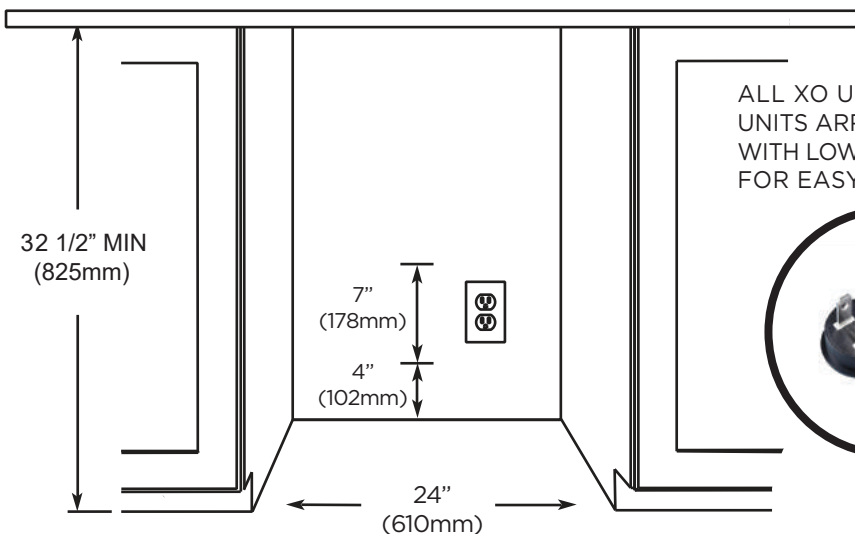

ALL XO UNDERCOUNTER
UNITS ARRIVE PRE-WIRED
WITH LOW PROFILE PLUGS
FOR EASY INSTALLATION



NEED MORE SPACE -
CUT INTO AN ADJOINING
CABINET TO REACH AN
OUTLET THERE

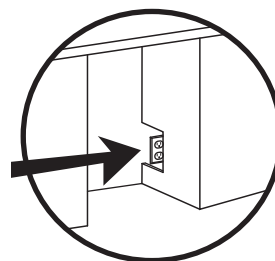

OVERLAY FRAME DIMENSIONS

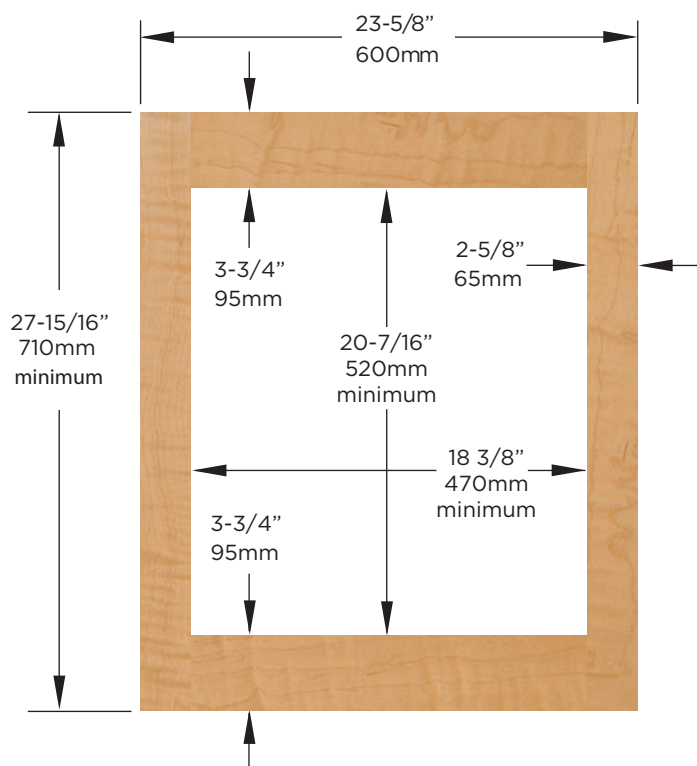

To conceal door completely observe
the frame dimensions as minimums.

You can extend panel height but the
gap between the bottom of the door
and the floor must be at least 3" for
ventilation.

To reduce possibility of warping -
overlay frame should be finished on
all sides.

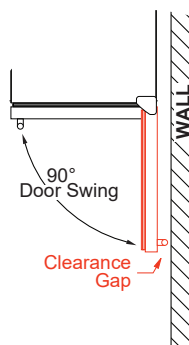

WHEN INSTALLING WITH
THE HINGE SIDE NEXT TO A WALL -
LEAVE ADEQUATE SPACE FOR
CABINET HANDLES

DOOR MUST BE ABLE TO OPEN
A MINIMUM OF 90°.

XO the next level
in luxury appliances

xoappliance.com | 800.966.8300

THE DOOR STOP IS SET AT 110°
BUT CAN BE RESET TO 90° OR 140°.

IF THE DOOR CANNOT OPEN FULLY
YOU CANNOT EXTEND THE RACKS.

ROUGH IN DIMENSIONS

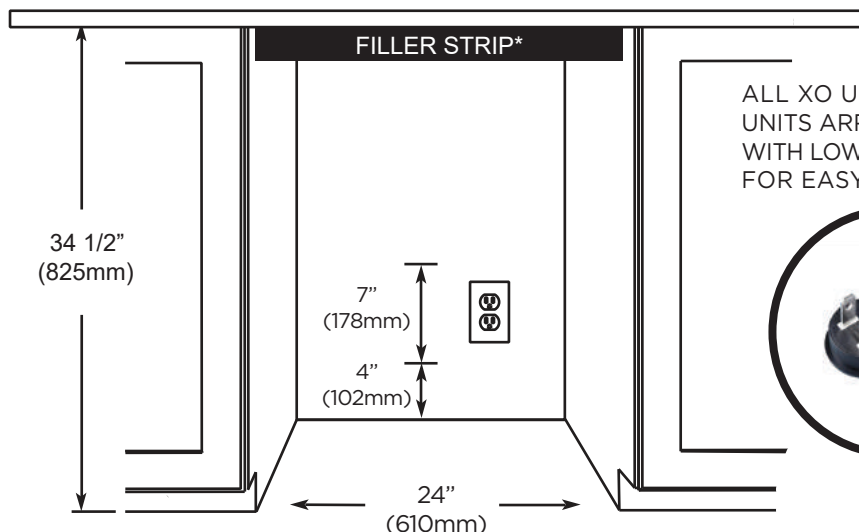

ALL XO UNDERCOUNTER
UNITS ARRIVE PRE-WIRED
WITH LOW PROFILE PLUGS
FOR EASY INSTALLATION



NEED MORE SPACE -
CUT INTO AN ADJOINING
CABINET TO REACH AN
OUTLET THERE

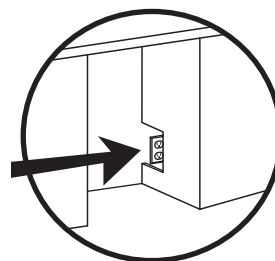

OVERLAY FRAME DIMENSIONS

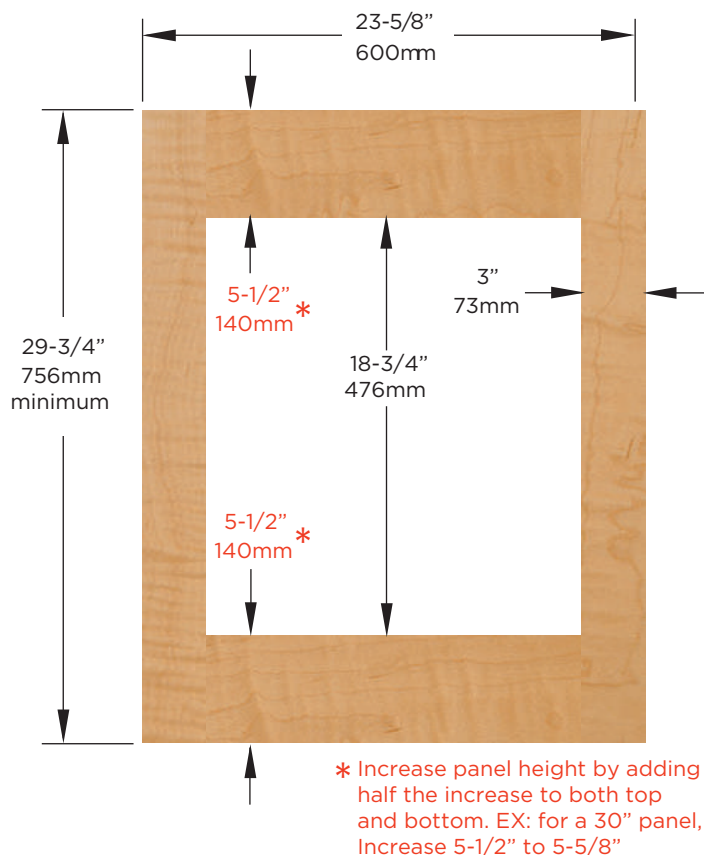

To conceal door completely observe
the frame dimensions as minimums.

You can change panel height but the
gap between the bottom of the door
and the floor must be at least 3" for
ventilation.

To reduce possibility of warping -
overlay frame should be finished on
all sides.

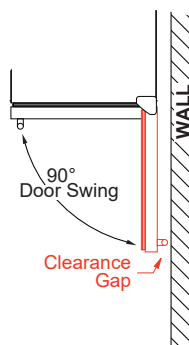

WHEN INSTALLING WITH
THE HINGE SIDE NEXT TO A WALL -
LEAVE ADEQUATE SPACE FOR
CABINET HANDLES

DOOR MUST BE ABLE TO OPEN
A MINIMUM OF 90°.

XO the next level
in luxury appliances

xoappliance.com | 800.966.8300

THE DOOR STOP IS SET AT 110°
BUT CAN BE RESET TO 90° OR 140°.

IF THE DOOR CANNOT OPEN FULLY
YOU CANNOT EXTEND THE RACKS.