

Model #512

Liberty basics™

Wall Mounted Hose Reel with Shelf Owner's Manual

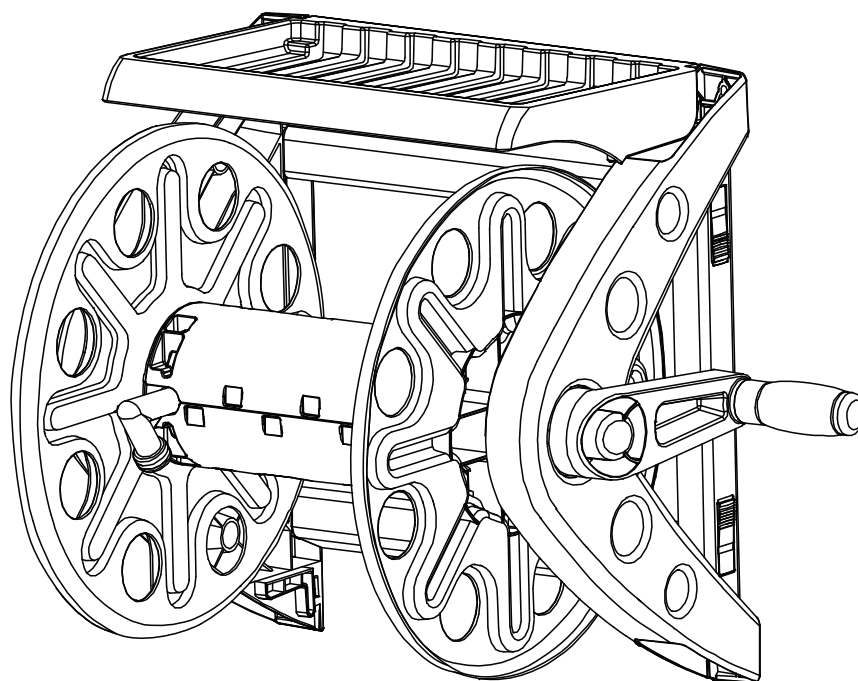

**VISIT OUR WEBSITE: WWW.LIBERTYGARDENPRODUCTS.COM
OR CALL US TOLL FREE AT 1-866-820-5805**

LIBERTY GARDEN PRODUCTS, INC.
1161 SOUTH PARK DRIVE, KERNERSVILLE NC 27284

IMPORTANT: READ THE OWNER'S MANUAL BEFORE ASSEMBLING

PRE-ASSEMBLY

Estimated Assembly Time : 10 minutes (not including mounting the hose reel)

TOOLS REQUIRED:

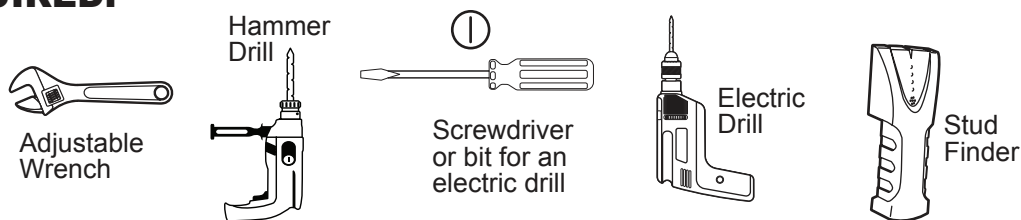

HARDWARE INCLUDED

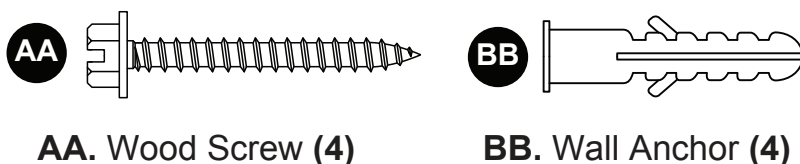

Note: Hardware not shown to actual size.

PARTS LIST

A. Cross Brace (2) B. Left Reel Side (1) C. Right Reel Side (1) D. Exit Tube (1) E. Side Frame (2)
F. Lower Frame Bar (1) G. Upper Frame Bar (1) H. Crank Handle (1) I. Supply Tube (1)
J. C-Shaped Lock (1) K. Lubricant Tube (1) L. Shelf (1) M. Leader Hose (1)
N. Cross Brace Screw (4)

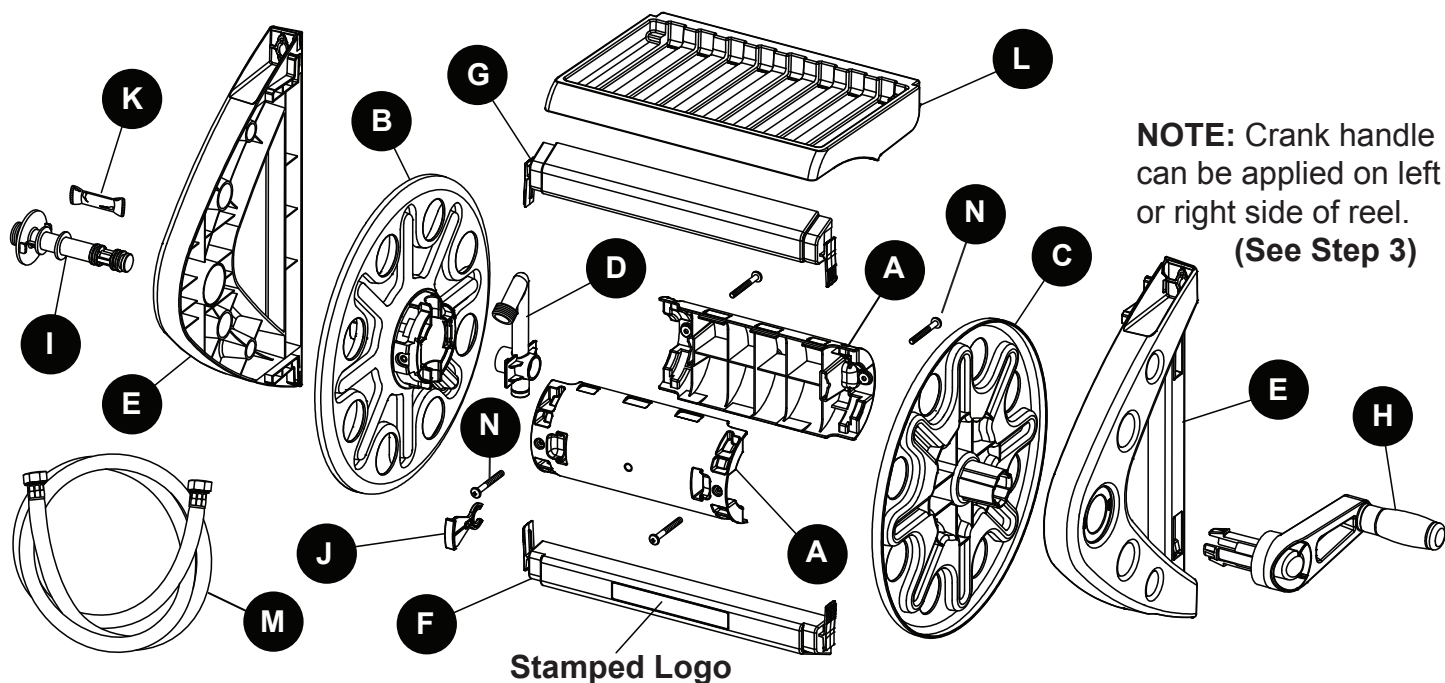

IMPORTANT: LAY OUT ALL PARTS AND FASTENERS. MAKE SURE ALL PARTS ARE ACCOUNTED FOR. IF ANY PART IS MISSING PLEASE CONTACT LIBERTY GARDEN PRODUCTS AT **1-866-820-5805**.
DO NOT CONTACT THE RETAILER. VISIT OUR WEBSITE, WWW.LIBERTYGARDENPRODUCTS.COM OR E-MAIL CUSTOMERSERVICE@LIBERTYGARDENPRODUCTS.COM FOR MORE INSTRUCTIONS.

INSTALLATION

This hose reel must be mounted to a solid masonry wall or to wall studs.

Tip: Remember to use the correct size and quantity of hardware to support the total weight of the unit. A standard 100' length of garden hose weighs approximately 15 lbs. Filled with water, the additional weight can exceed 20 lbs. The mounting hardware must be able to support the combined weight of the unit, garden hose, plus water.

1. WOOD SCREWS

The following hardware is included:

(4) 6 or 7 mm x 38 mm wood screws

(AA)(5/16" x 2 1/2").

- Using a stud finder, locate wood studs on your wall.
- Position and hold the hose reel assembly against the wall. Mark the positions of the suspension holes and remove the reel assembly.

NOTE: Ensure the leader hose (M) will reach the water supply reel.

- Using an electric drill, drill (4) 1/8" diameter pilot holes at the marked positions on the wall.

If applicable, drill (4) 1/4" diameter holes and insert (4) anchors (BB) into the drywall or masonite.

- Using a screwdriver, insert two wood screws (AA) half way into the top two pilot holes or optional wall anchors (BB).
- Mount the reel assembly on the top wood screws (AA), install the bottom screws (AA) and tighten all four screws. Do not overtighten the screws.

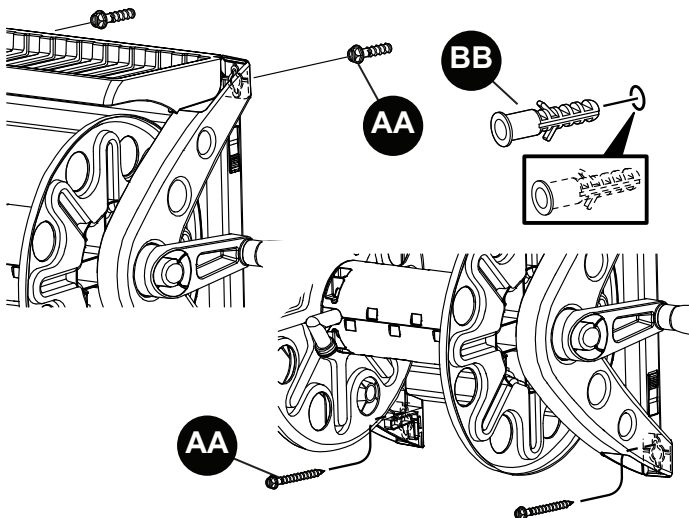

2. BRICK OR MASONRY SCREWS (Optional Mounting Method)

The following hardware is not included:

(4) 7 or 8 mm x 60 mm masonry screws (CC)(5/16" x 2 1/2").

- Position and hold the hose reel assembly against the brick wall. Mark the positions of the suspension holes and remove the reel assembly.

NOTE: Ensure the leader hose (M) will reach the water supply reel.

- Using a hammer drill, drill (4) 1/4" diameter pilot holes at the marked positions on the wall.
- Insert two masonry screws (CC) half way into the top two pilot holes.
- Mount the reel assembly on the top masonry screws (CC), install the bottom screws (CC) and tighten all four screws. Do not overtighten the screws.

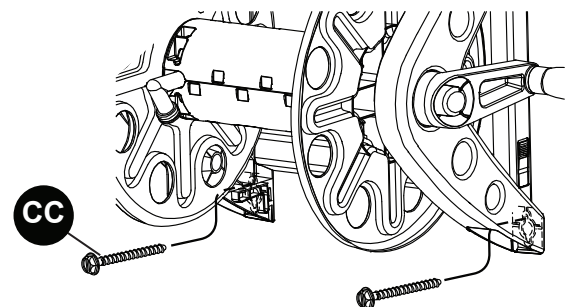
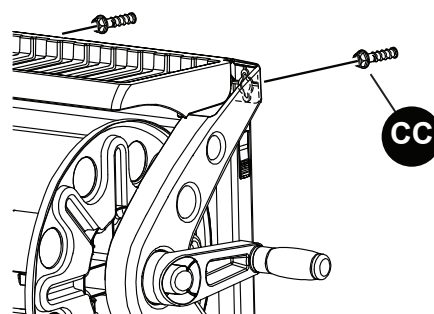

ASSEMBLY

NOTE: Most parts are assembled by locking tabs on the mating parts. The locking tab must slide down into the snap as shown in the figures below.

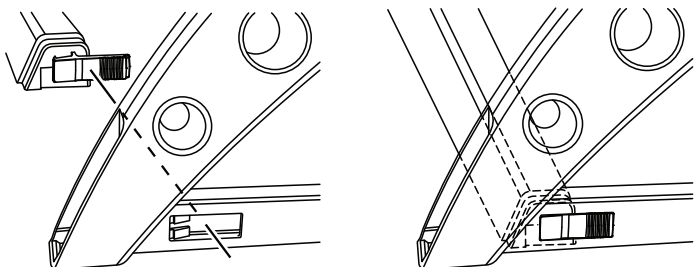

1. Align and slide the locking tab on lower frame bar (F) with the snap on side frame (E) until an audible click sound is heard.

NOTE: When the mating surfaces tab and snap are flush, the lower frame bar (F) and side frame (E) is locked together.

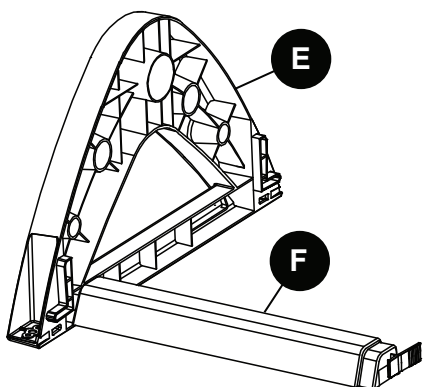

NOTE: To disassemble a lower frame bar from a side frame, use a flat head screwdriver to press the lock tab and slide the frame bar out of the snap.

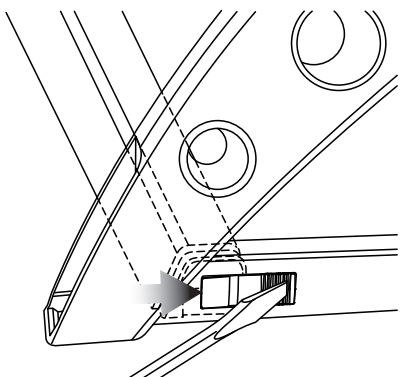

2. Align and slide the locking tab on upper frame bar (G) with the snap on side frame (E) until an audible click sound is heard. Store frame assembly for further assembly.

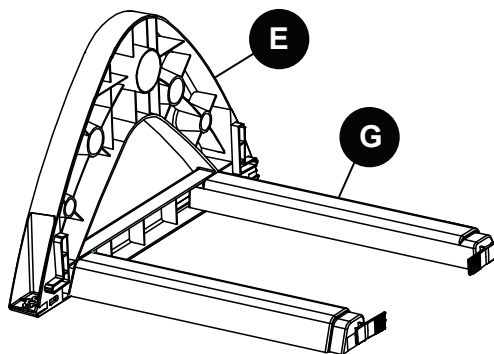

3. Press the exit tube (D) into the snaps on the right or left reel side (B) as shown in the figure below.

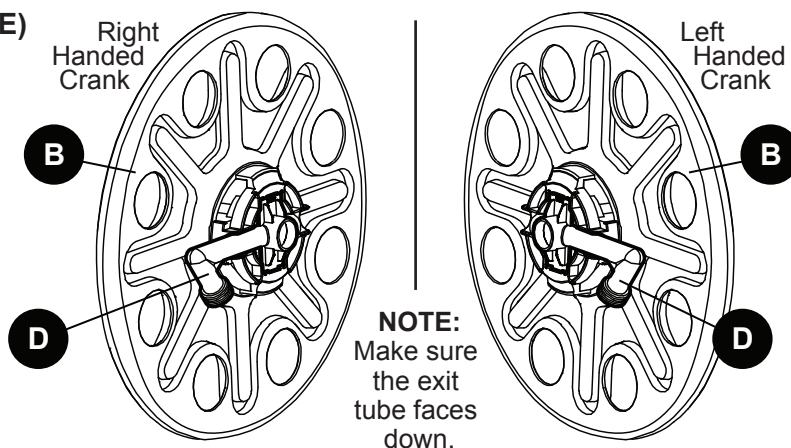

4. Align cross brace (A) tabs with the left reel side (B) and assemble as shown.

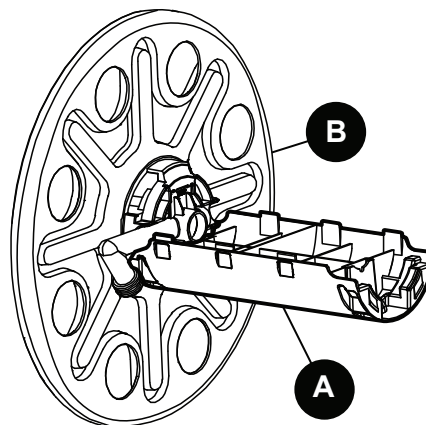

ASSEMBLY

5. Align cross brace (A) tabs with right reel side (C) and assemble as shown.

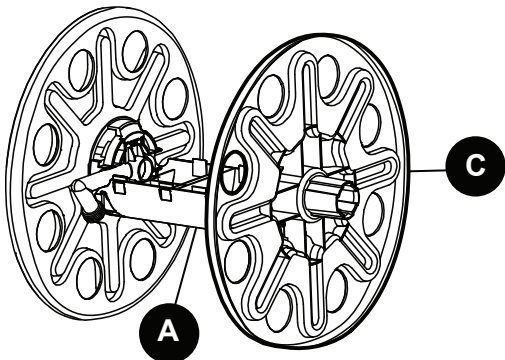

8. Ensure the cross brace screws (N) secure both cross braces (A) into the left and right reel sides (B) and (C). See figure below for reference.

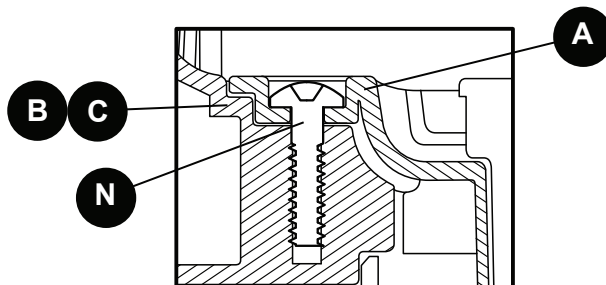

6. Align the second cross brace (A) tabs with the left and right reel sides (B) and (C) and assemble as shown.

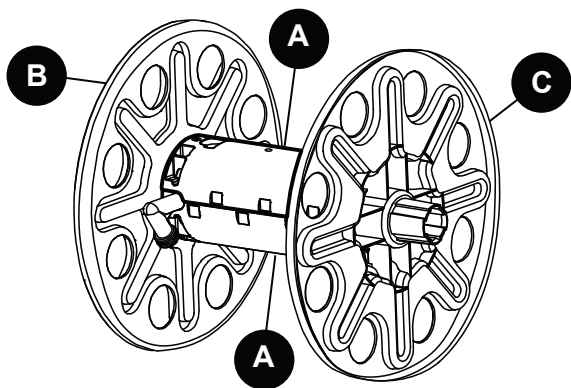

9. Place the frame on a sturdy surface and position the reel assembly on the frame as shown in the figure below.

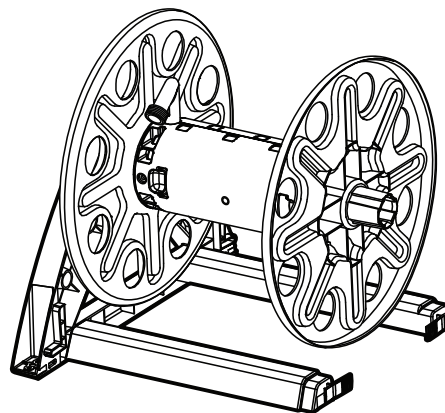

7. Using the supplied cross brace screws (N) secure cross braces (A) to the left and right reel sides (B) and (C).

10. Install the side frame (E) onto the right reel side (C) and the lower and upper frame bars (F) and (G) as shown.

NOTE: Do not over tighten the cross brace screws.

NOTE: Ensure the locking tabs and snaps engage and an audible snap is heard when the frame bars and side frame are assembled.

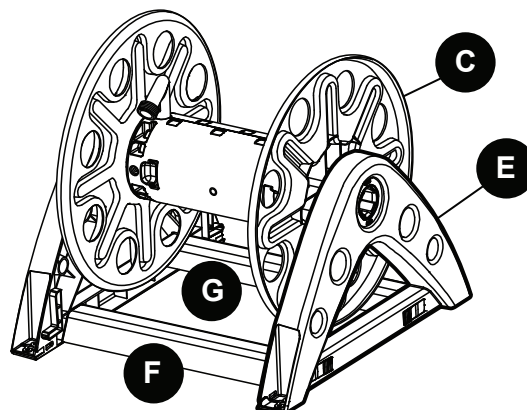
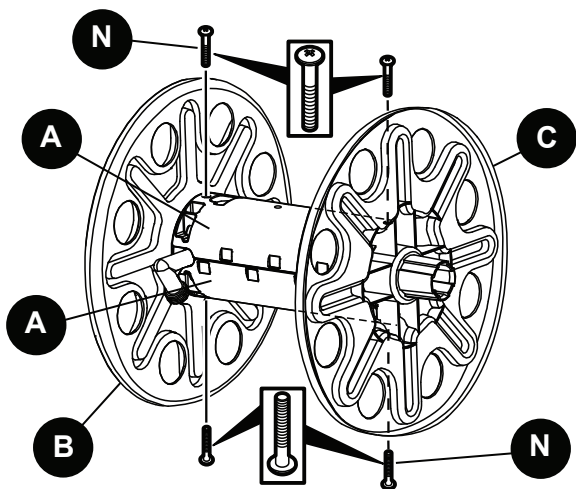

ASSEMBLY

11. Using lubricant tube (**K**), lubricate the o-rings on the supply tube (**I**).

12. Align the supply tube (**I**) tabs with the left side reel slots and press the supply tube and press until an audible snap is heard.

13. Align the c-shaped lock (**J**) with slot in the cross brace (**A**) and push until an audible snap is heard.

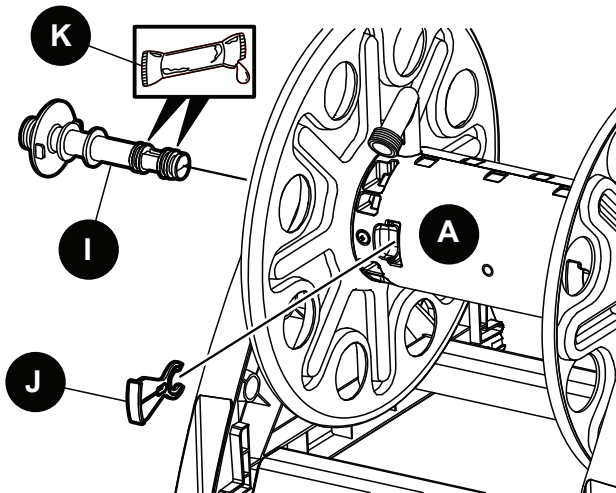

14. Place crank handle (**H**) into the reel hub and snap into place.

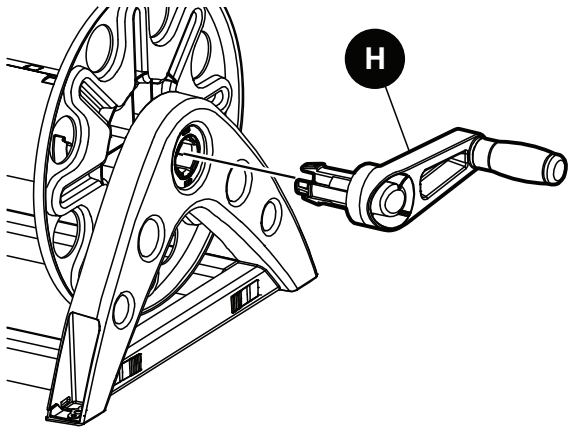

15. Align shelf (**L**) with the tabs on side frames (**E**) and snap into position as shown.

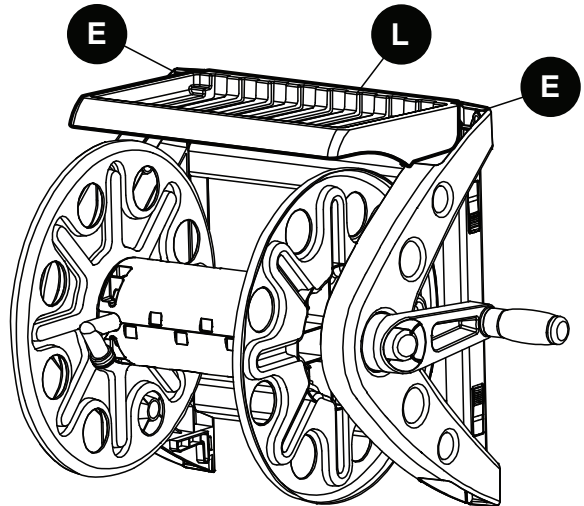

16. Mount hose reel assembly.

NOTE: See hose reel mounting instructions on page 3 (**Installation section**) of this owners manual.

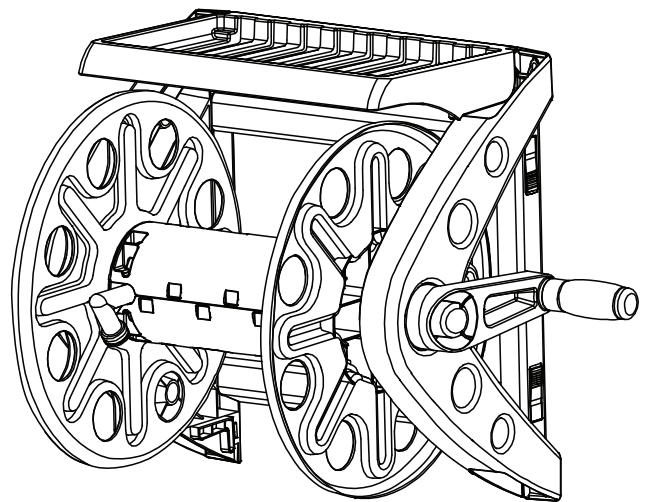

ASSEMBLY

17. Connect Leader hose (**M**) to supply tube (**I**).

NOTE: Do not overtighten the leader hose.

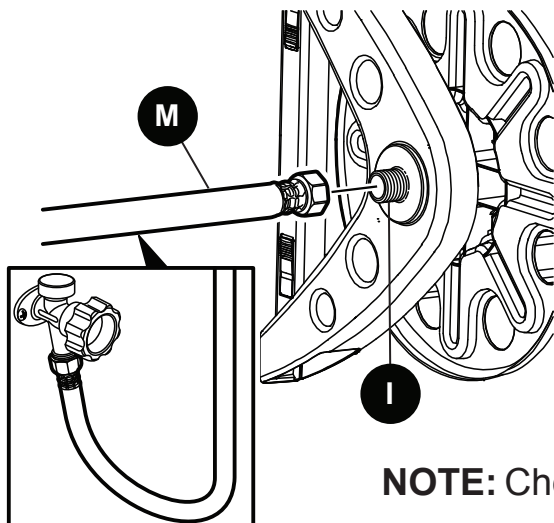

18. Connect garden hose to the exit tube (**D**).

NOTE: Do not overtighten the garden hose.

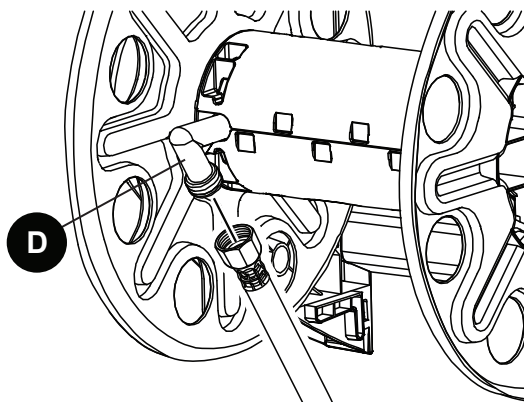

NOTE: Check for leaks prior to mounting.

CARE AND MAINTENANCE

WINTERIZING AND STORAGE

Drain the hose reel prior to the onset of freezing temperatures. If any trapped water freezes, it may cause damage to the hose reel, hose, and even your pipes.

Store the entire unit - including hose reel and hose - inside your garage or storage shed at above-freezing temperatures. Storing your hose reel inside during the winter is an excellent way of protecting your garden hose, leader hose and O-Rings.

When you install your hose reel, be sure the hose washers are in place and all fittings are secure. If you live in more temperate climates, be sure to drain the unit of any residual water before storing.

- **DO NOT EXPOSE UNIT TO FREEZING TEMPERATURES** while water remains in the plumbing system, this can damage the hose connections.
- **DO NOT** leave water running through the reel while not in use or unsupervised.

Your hose reel is manufactured with the finest quality components available. This product will give you many seasons of reliable and functional hose storage. All components in the product are manufactured to rigorous quality standards not common in other consumer grade hose reels available today. In the case of wall mounted reels, be sure to use stainless steel mounting hardware. We recommend that you periodically inspect your reel for any surface damage. **NOTE: Liberty Basic's plastic hose reels use ultraviolet light stabilizers in our plastic, but over time, the plastic color, depending on the amount of sunlight, can fade.**

WARNING: DO NOT consume water from garden hose; not fit for human consumption.



WARNING: Cancer and Reproductive Harm
- www.p65warnings.ca.gov

**CALL US AT 1-866-820-5805 IF YOU HAVE ANY QUESTIONS
REGARDING CARE AND MAINTENANCE**

LIBERTY GARDEN PRODUCTS LIMITED WARRANTY

(Effective November 14, 2018)

This limited warranty is applicable to each original end-customer (hereinafter "Customer") purchasing the model 512 wall mounted hose reel with shelf.

1. LIMITED WARRANTY; EXCLUSIVE REMEDIES:

1.1. LIMITED WARRANTY ON PRODUCTS: Company warrants solely to the original Customer that (a) the Structural Frame will be free from defects in materials and workmanship under normal use for a period of three (3) YEAR(S) from the date of original retail purchase, and (b) the Non-Frame Parts (which consist of the crank handle, water connections, leader hose and will be free from defects in materials and workmanship under normal use for a period of ONE (1) YEARS from the date of original retail purchase. Notwithstanding the foregoing, the colors and finishes of the Products may vary within a reasonable scope due to unavoidable color variations in different production batches, and such variations shall not constitute a material defect. This limited warranty is limited solely to the original Customer with proof of purchase and is not transferable.

1.2. THE WARRANTY: During a covered Product's limited warranty period, Company will, at Company's sole option and discretion, (1) repair the defective component or product without charge or (2) replace the defective component or product without charge.

1.3. The foregoing limited warranty is subject to the Customer's proper storage, transportation, handling and use of the Products as the same are defined within Company's then-current published guides and instructions for use and care. The limited warranty does not include defects due to normal wear and tear, abuse or misuse, mishandling, neglect, accident, fire, lightning, sunlight or other natural hazard, delivery or transportation damage, failure to follow applicable directions or instructions, or improper or inadequate cleaning, maintenance, care, repairs, modifications, or use beyond a Product's intended use. Please note that since the Structural Frame is made from plastic, fading may occur over time. As such, this limited warranty does not include color fading or defects due to the same.

1.4. LIMITED WARRANTY CLAIMS PROCEDURE: To obtain performance under this limited warranty, Customer shall notify Company in writing (to Liberty Garden Products, Inc., 1161 South Park Drive, Kernersville, NC 27284, Attn: Customer Service / Warranty Department), by email (to customerservice@libertygardenproducts.com), or by telephone (to (336) 992-3595) with a full description of the defect that is covered by warranty and a copy of the dated proof of purchase of the applicable product. Our warranty is limited to items purchased in new condition from authorized distributors.

- Company shall review each such claim and issue Customer a return merchandise authorization ("RMA") in the event that the described defect or condition merits warranty review as determined by Company. Customers who have been issued a RMA shall, at Company's election, return the covered item to the same physical address listed above for reporting initial claims. Company shall not accept any returned product without a RMA.

- Upon receipt, Company will evaluate the returned product(s) to determine if there is a warranty claim and, if so, how Company wishes to remedy the same. During a covered product's respective limited warranty period, Company will, at Company's sole and absolute option and discretion, (1) repair the defective component or product without charge or (2) replace the defective component or product without charge. Refunds are not available pursuant to this limited warranty.

- Customer is solely responsible for transportation of the covered product(s) to the Company for evaluation (if applicable and requested by Company). In the event that Company determines that a claim under this limited warranty is justified, Company shall be responsible for transportation of the repaired, corrected, replaced or exchanged product back to Customer. Customer shall be solely responsible for the transportation of any product back to Customer if Company determines that a claim under this warranty is not justified.

- Any repaired, corrected, replaced or exchanged Products shall be subject to the Limited Warranty set forth to the duration of the original limited warranty period as set forth in Section 1.1. and not for any extended duration, following their repair, correction, replacement or exchange.

1.5. IF A COMPANY PRODUCT DOES NOT CONFORM TO THESE LIMITED WARRANTIES, THE PURCHASER'S SOLE AND EXCLUSIVE REMEDY IS, AT COMPANY'S SOLE AND EXCLUSIVE OPTION, THE (1) REPAIR OF ANY DEFECTIVE PRODUCT OR COMPONENT PART OR (2) REPLACEMENT OF ANY DEFECTIVE PRODUCT OR COMPONENT PART. THE LIMITED WARRANTY AND REMEDIES SET FORTH ABOVE ARE EXCLUSIVE AND MADE IN LIEU OF ALL OTHER WARRANTIES, REMEDIES, RIGHTS OR CONDITIONS, WHETHER ORAL OR WRITTEN, EXPRESS OR IMPLIED, EITHER IN FACT OR BY OPERATION OF LAW, STATUTORY OR OTHERWISE, INCLUDING THE IMPLIED WARRANTIES OF MERCHANTABILITY AND FITNESS FOR A PARTICULAR PURPOSE. COMPANY SPECIFICALLY DISCLAIMS, WITHOUT LIMITATION, ANY AND ALL OTHER WARRANTIES, EXPRESS OR IMPLIED, OF ANY KIND. IF COMPANY CANNOT LAWFULLY DISCLAIM IMPLIED WARRANTIES UNDER THIS LIMITED WARRANTY, ALL SUCH WARRANTIES, INCLUDING THE IMPLIED WARRANTIES OF MERCHANTABILITY AND FITNESS FOR A PARTICULAR PURPOSE, ARE LIMITED IN DURATION TO THE DURATION OF THIS LIMITED WARRANTY. The Company does not assume or authorize any person to assume for them any other liability in connection with the Products.

LIBERTY GARDEN PRODUCTS LIMITED WARRANTY CONTINUED

2. EXCLUSION AND LIMITATION OF LIABILITY:

IN NO EVENT, WHETHER BASED ON CONTRACT OR TORT OR OTHER LEGAL THEORY, SHALL COMPANY BE LIABLE FOR ANY INDIRECT, INCIDENTAL, PUNITIVE, SPECIAL OR CONSEQUENTIAL DAMAGES, INCLUDING BUT NOT LIMITED TO, DAMAGES TO OTHER PROPERTY, INCONVENIENCE, DAMAGES FOR LOSS OF PROFITS, REVENUE, GOODWILL OR USE, INCURRED BY CUSTOMER OR ANY THIRD PARTY, WHETHER IN AN ACTION IN CONTRACT, TORT, STRICT LIABILITY, OR IMPOSED BY STATUTE, OR OTHERWISE, EVEN IF ADVISED OF THE POSSIBILITY OF SUCH DAMAGES. Some states do not allow the exclusion or limitation of incidental or consequential damages or exclusions or limitations on the duration of implied warranties or conditions, so the above limitations or exclusions may not apply to Customer. In jurisdictions that limit the scope of or preclude limitations or exclusion of remedies or damages, or of liability, such as liability for gross negligence or willful misconduct or do not allow implied warranties to be excluded, the limitation or exclusion of warranties, remedies, damages or liability set forth above are intended to apply to the maximum extent permitted by applicable law. This limited warranty gives the Customer specific legal rights, and the Customer may also have other rights that vary by state, country or other jurisdiction.

3. SEVERABILITY:

If any provision of this limited warranty is held to be illegal, invalid or otherwise unenforceable, such provision will be enforced to the extent possible consistent with its stated intention, or, if incapable of such enforcement, will be deemed to be severed and deleted from this limited warranty, while the remainder of the terms of this limited warranty will continue in full force and effect.

4. DISPUTE RESOLUTION:

This Liberty Garden Products, Inc. Limited Warranty shall be governed by and construed in accordance with the laws of the State of North Carolina, without regard to its principles of conflicts of law. The parties acknowledge the exclusive jurisdiction of the federal and state courts of the State of North Carolina. Any claims or disputes under this Liberty Garden Products, Inc. Limited Warranty shall be heard exclusively in any state or federal courts sitting in Guilford County, North Carolina, and both parties expressly consent to the personal jurisdiction and venue of the North Carolina state and federal courts for such actions.



"Liberty" is a registered trademark of Liberty Garden Products, Inc. Kernersville, NC. All Rights Reserved 2018

Updated 11/14/2018