

ASSEMBLY INSTRUCTIONS

EEI-6638

V2.01.23.25

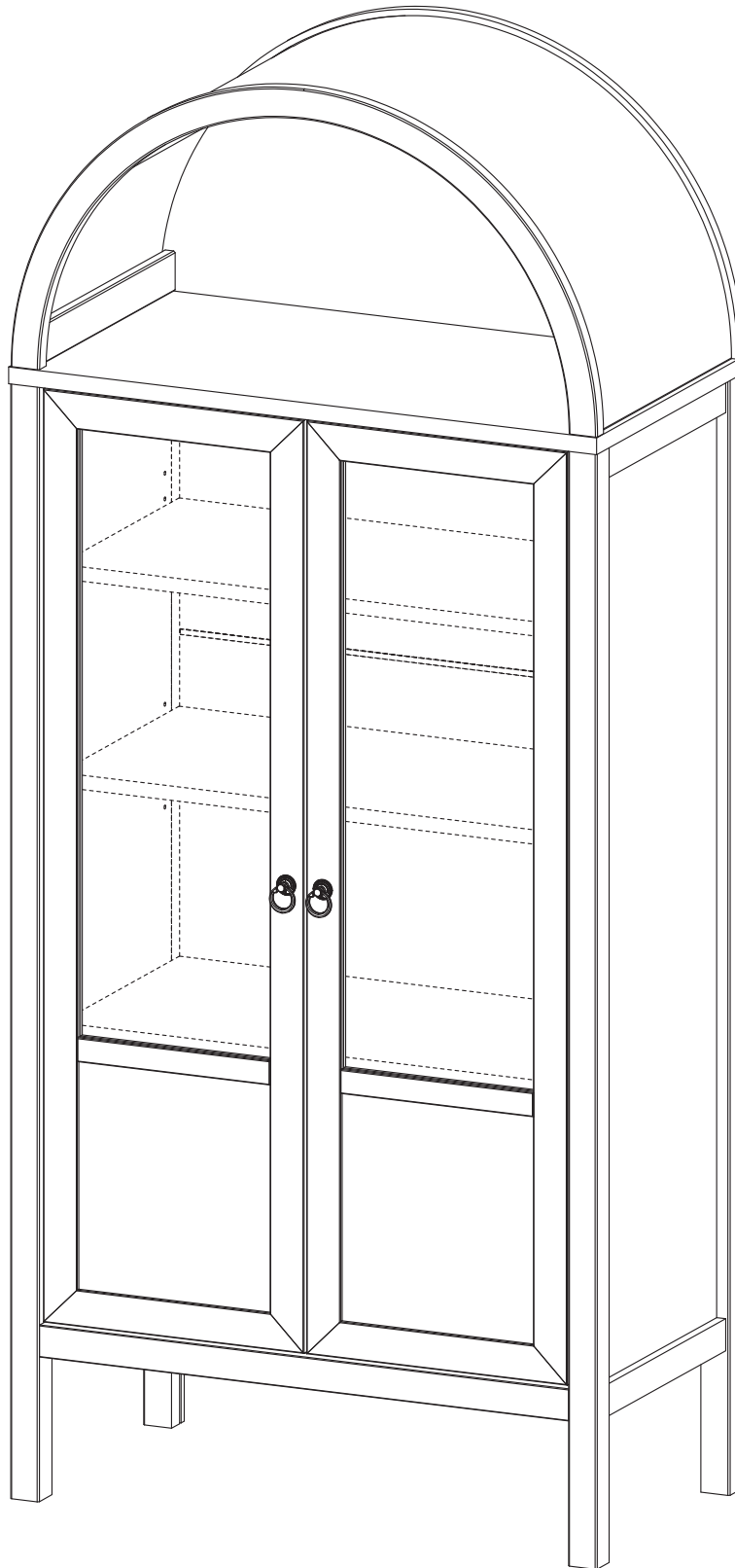

Questions? Contact us!

609.256.9000 • cs@modway.com
www.modway.com

***modway**



Read through all of the instructions before starting



Care instructions are listed in the last step of this manual



Approx. 60 minutes assembly time



Make sure you have all parts and components before discarding any packing materials



2 people recommended for assembly

Only use hand tools to assemble this item. Do not use power tools. Do not tighten bolts or screws completely until all hardware is lined up and inserted into the holes.

Do not over-tighten screws and bolts to avoid stripping the hardware or cracking the item.

Assemble your item on a flat, carpeted area, with plenty of space to work. This will prevent damage and scratches to your floors or the item while you're assembling the product.

Keep all components and packaging out of reach of children or animals to avoid risk of choking or suffocation.

Furniture components:

1	Top Board	x1
2	Bottom Board	x1
3	Side Board Left	x1
4	Side Board Right	x1
5	Adjustable Shelf	x2
6	Fixed Shelf	x1
7	Bottom Skirt	x1
8	Door Left	x1
9	Door Right	x1

10	Support Board 1 Hutch	x2
11	Support Board 2 Hutch	x3
12	Front Board Hutch	x1
13	Back Board Hutch	x1
14	PVC Board	x1
15	Back Board 1	x2
16	Back Board 2	x1

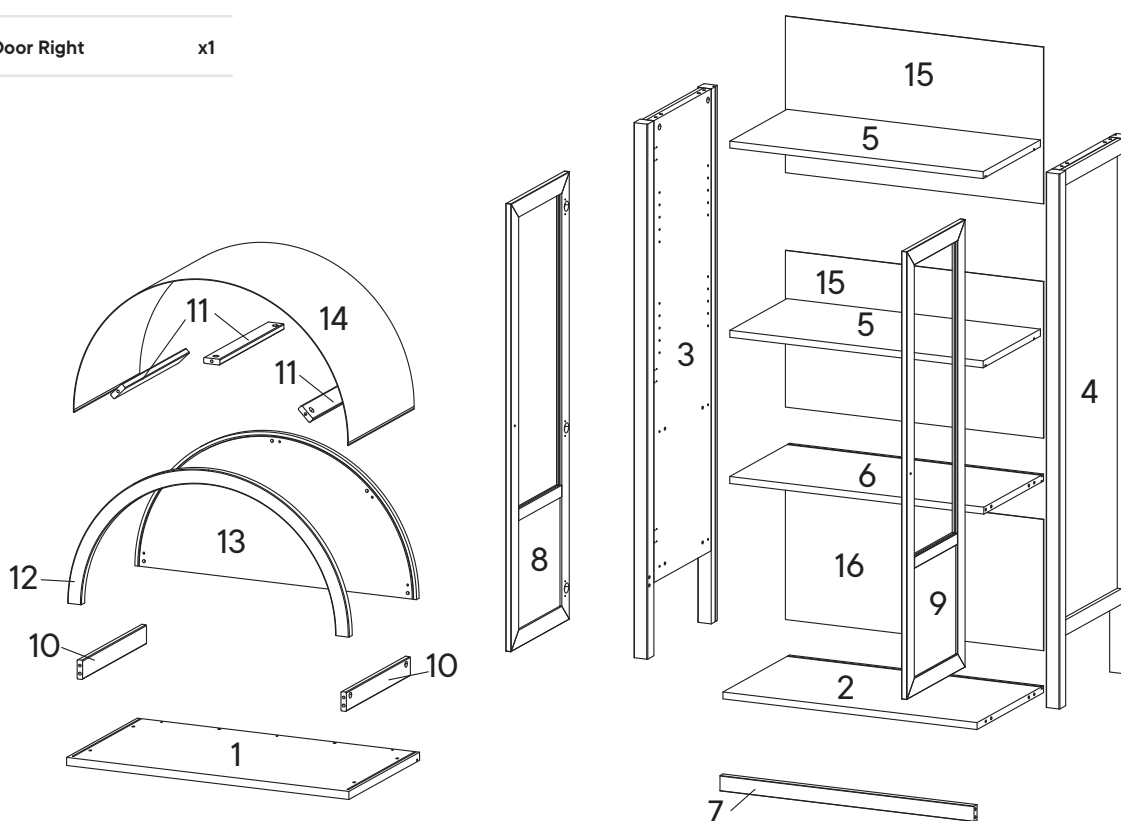

Wait!

Missing parts or hardware? Need assistance?
Contact us before returning your item. We're here to help!
609.256.9000 • cs@modway.com

Provided hardware:

A		Cam Bolt Ø6 x 35 mm	x25
B		Cam Lock Ø15 mm	x25
C		Wood Dowel Ø8 x 30 mm	x25
D		Screw M 6.4 x 14 mm	x1
E		Screw M 7 x 50 mm	x4
F		Shelf Pin	x8
G		Screw Cap Ø15 mm	x4
H		Stopper	x2
I		Handle	x2
J		Screw M 4 x 20 mm	x2
K		Floor Protector	x4
L		Screw M 4.5 x 12.5 mm	x37
M		Wedge	x16
N		Screw M 3.5 x 15.5 mm	x16
O		Allen Key	x2
P		Joining Strip	x1
Q		Plate	x1
R		List	x2
HS26C		Hinge	x6

What you need:



Components Carton Placement

Carton 1 of 2

Label	Description	Qty
3	Side Board Left	x1
4	Side Board Right	x1
8	Door Left	x1
9	Door Right	x1
14	PVC Board	x1
15	Back Board 1	x2
16	Back Board 2	x1
	Hardware Pack	x1

Carton 2 of 2

Label	Description	Qty
1	Top Board	x1
2	Bottom Board	x1
5	Adjustable Shelf	x2
6	Fixed Shelf	x1
7	Bottom Skirt	x1
10	Support Board 1 Hutch	x2
11	Support Board 2 Hutch	x3
12	Front Board Hutch	x1
13	Back Board Hutch	x1

Wait!

Missing parts or hardware? Need assistance?
Contact us before returning your item. We're here to help!
609.256.9000 • cs@modway.com

Step 1

HARDWARE

- A** Cam Bolt Ø6 x 35 mm x8
- C** Wood Dowel Ø8 x 30 mm x4
- K** Floor Protector x4

COMPONENTS

- 3** Side Board Left x1
- 4** Side Board Right x1

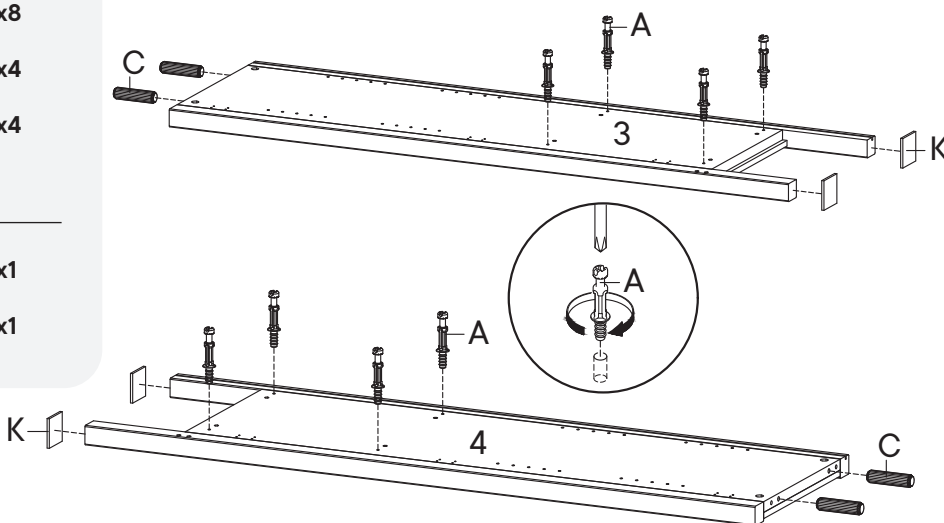
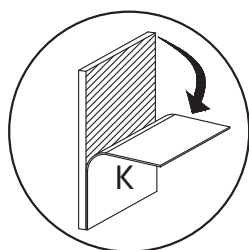

Step 2

HARDWARE

- C** Wood Dowel Ø8 x 30 mm x4
- L** Screw M 4.5 x 12.5 mm x1
- Q** Plate x1

COMPONENTS

- 2** Bottom Board x1

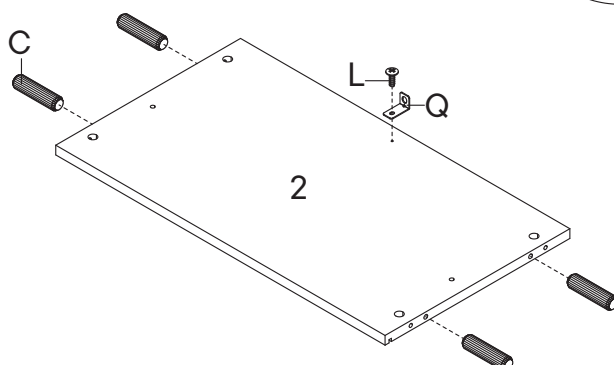
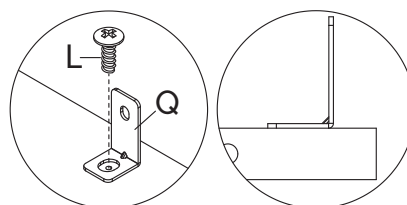
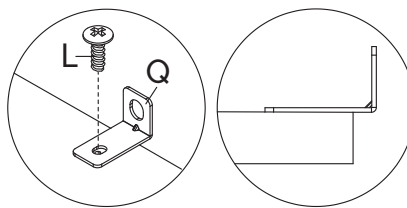
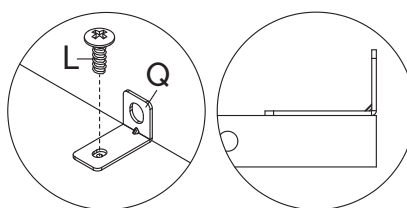

Step 3

HARDWARE

- A** Cam Bolt Ø6 x 35 mm x3
- C** Wood Dowel Ø8 x 30 mm x8

COMPONENTS

- 1** Top Board x1
- 6** Fixed Shelf x1
- 7** Bottom Skirt x1

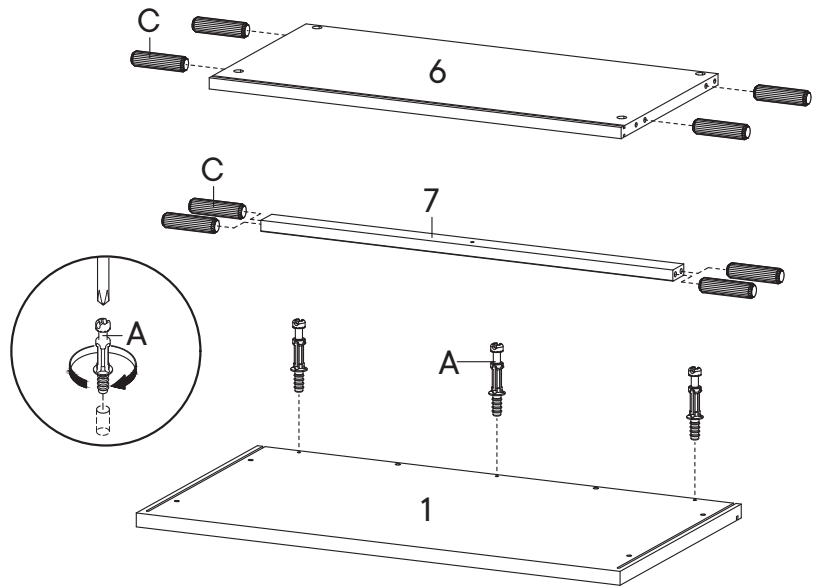

Step 4

HARDWARE

- B** Cam Lock Ø15 mm x4

COMPONENTS

- 2** Bottom Board x1
- 4** Side Board Right x1
- 6** Fixed Shelf x1

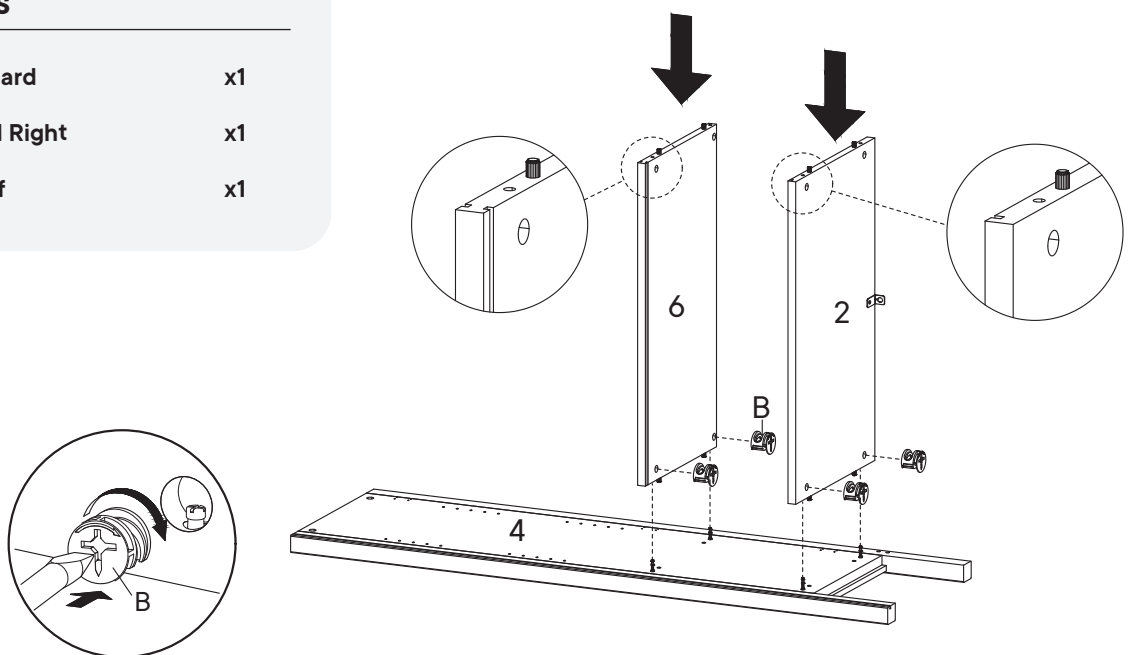

Step 5

COMPONENTS

- | | | |
|----------|--------------|----|
| 7 | Bottom Skirt | x1 |
|----------|--------------|----|

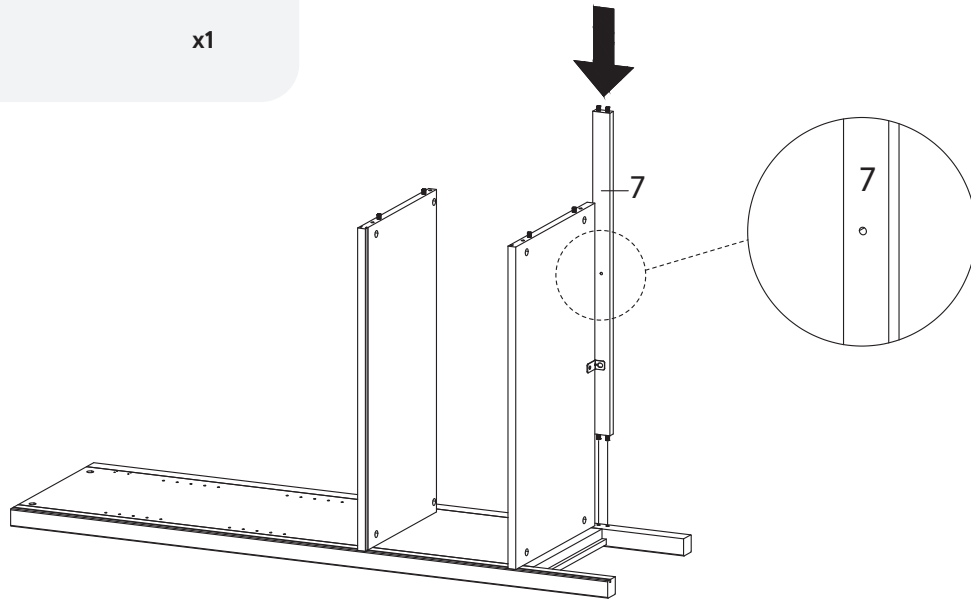

Step 6

HARDWARE

- | | | |
|----------|-----------------|----|
| B | Cam Lock Ø15 mm | x4 |
|----------|-----------------|----|

COMPONENTS

- | | | |
|-----------|-----------------|----|
| 3 | Side Board Left | x1 |
| 16 | Back Board 2 | x1 |

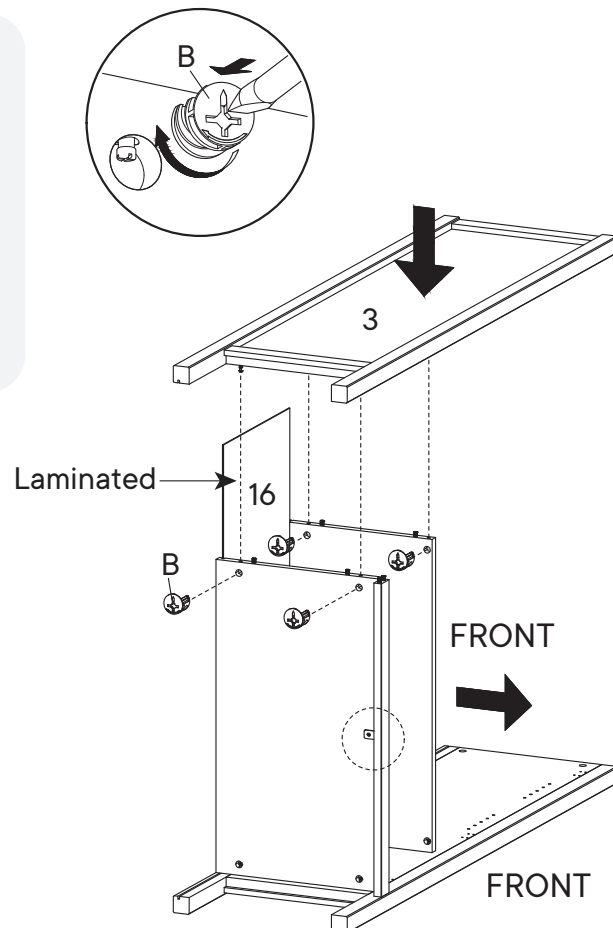

Step 7

HARDWARE

- D** Screw M 6.4 x 14 mm x1
- O** Allen Key x1

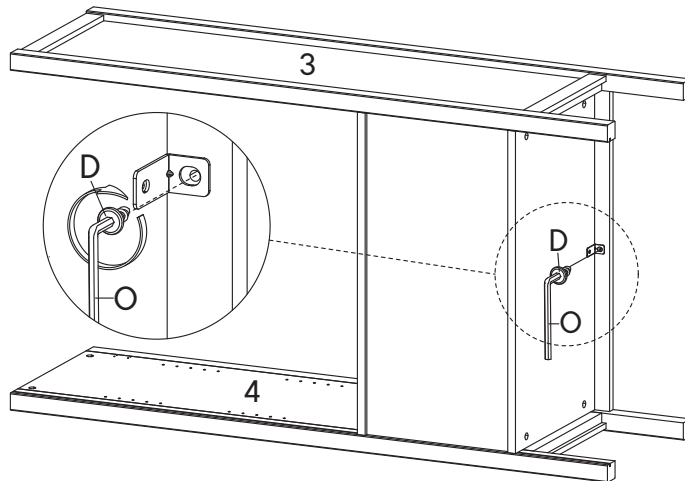

Step 8

HARDWARE

- P** Joining Strip x1

COMPONENTS

- 15** Back Board 1 x2

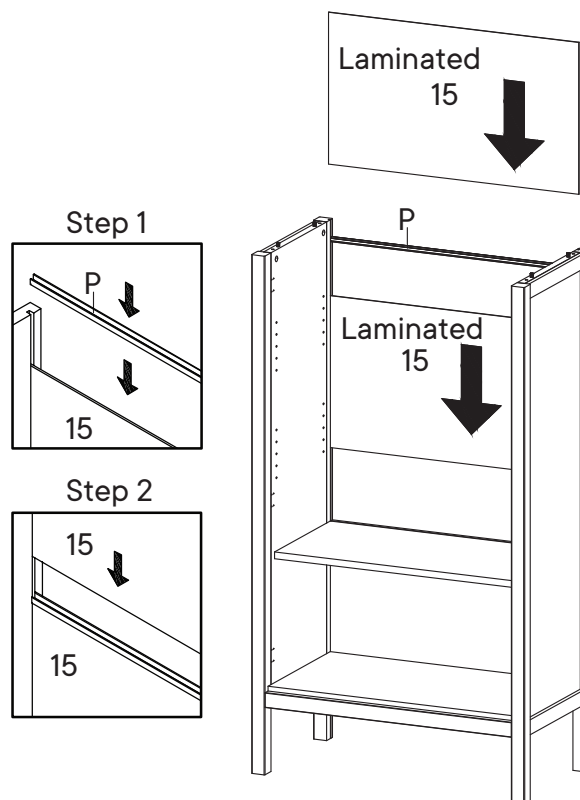

Step 9

HARDWARE

- A** Cam Bolt Ø6 x 35 mm x10
- C** Wood Dowel Ø8 x 30 mm x9

COMPONENTS

- 10** Support Board 1 Hutch x2
- 11** Support Board 2 Hutch x3
- 12** Front Board Hutch x1
- 13** Back Board Hutch x1

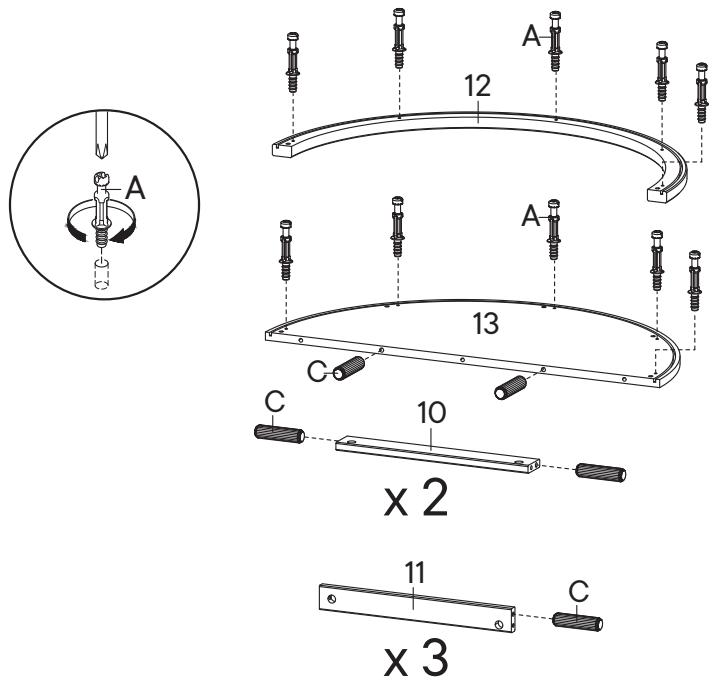

Step 10

HARDWARE

- B** Cam Lock Ø15 mm x5

COMPONENTS

- 10** Support Board 1 Hutch x2
- 11** Support Board 2 Hutch x3
- 13** Back Board Hutch x1

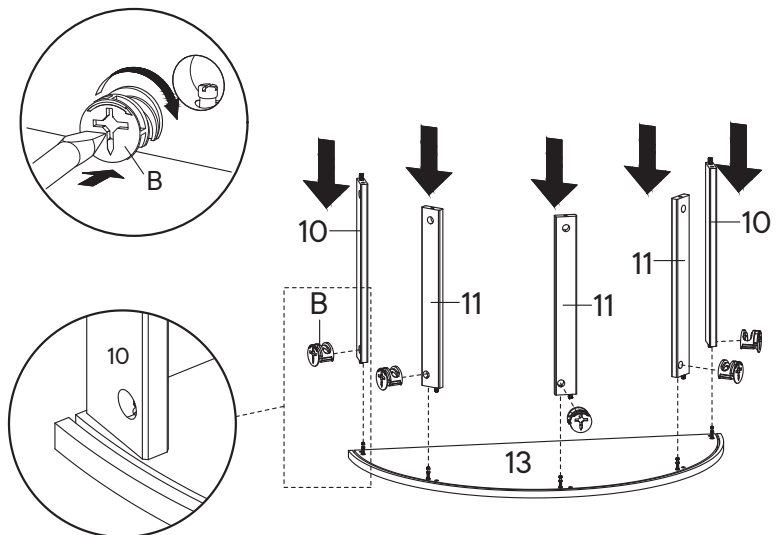

Step 11

HARDWARE

- B** Cam Lock Ø15 mm x5

COMPONENTS

- 12** Front Board Hutch x1

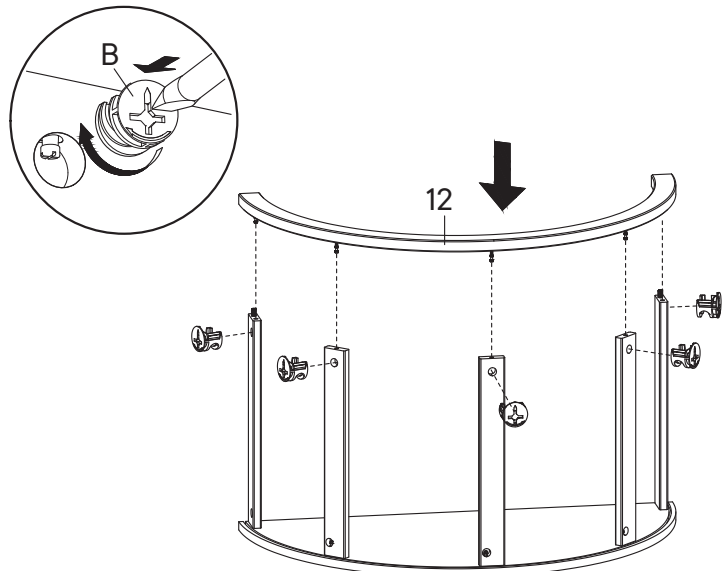

Step 12

COMPONENTS

- | | | |
|-----------|-----------|----|
| 14 | PVC Board | x1 |
|-----------|-----------|----|

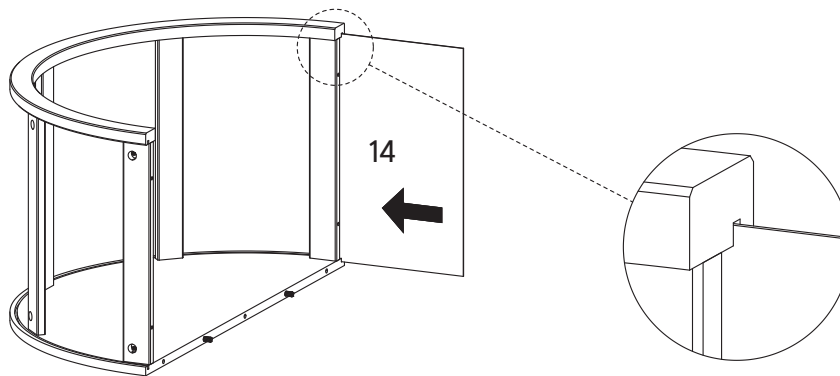

Step 13

HARDWARE

- | | | |
|----------|---------------------|----|
| A | Cam Bolt Ø6 x 35 mm | x4 |
| B | Cam Lock Ø15 mm | x3 |
| E | Screw M 7 x 50 mm | x4 |
| H | Stopper | x2 |
| O | Allen Key | x1 |

COMPONENTS

- | | | |
|----------|-----------|----|
| 1 | Top Board | x1 |
|----------|-----------|----|

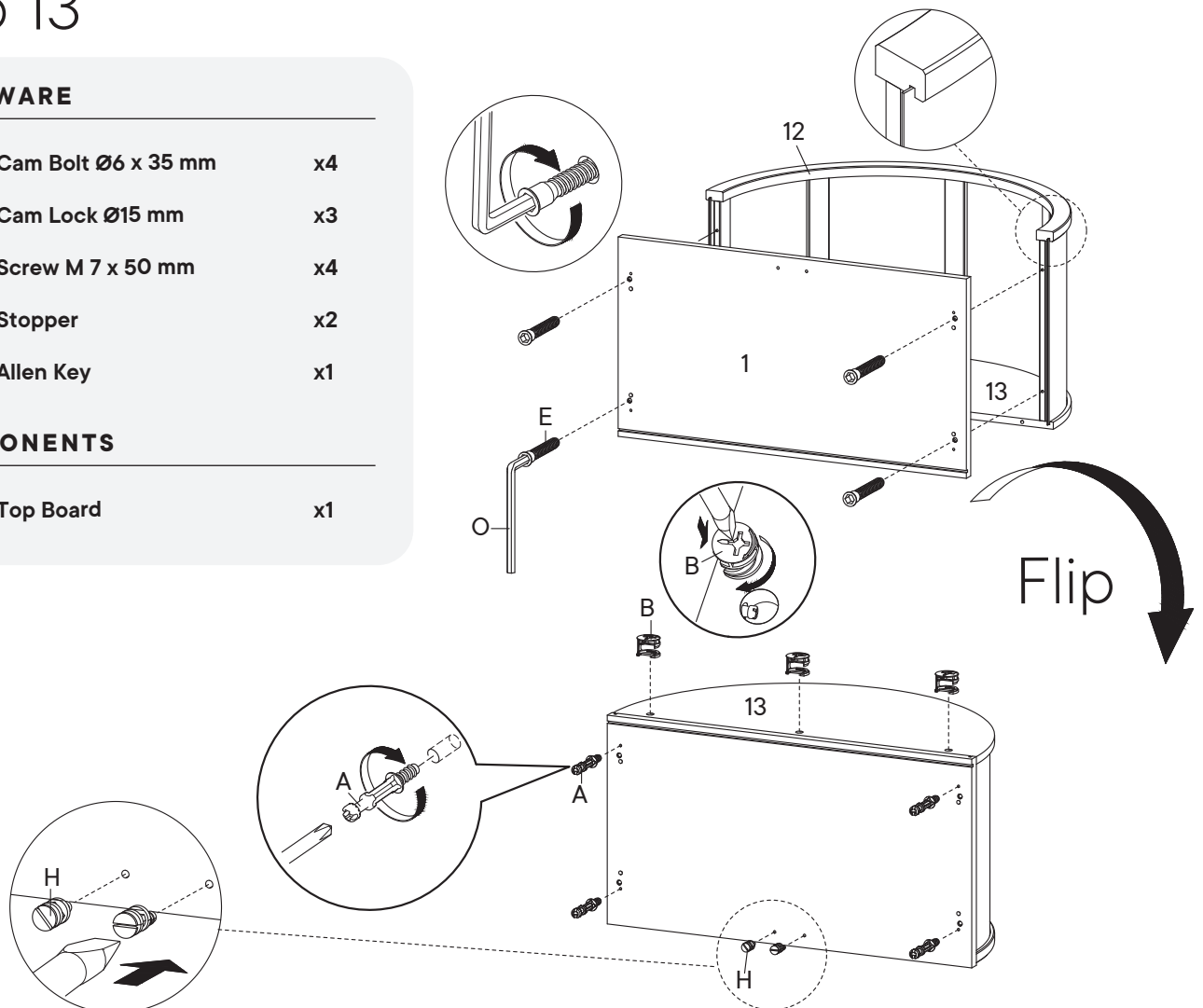

Step 14

HARDWARE

- B** Cam Lock Ø15 mm x4
- G** Screw Cap Ø15 mm x4

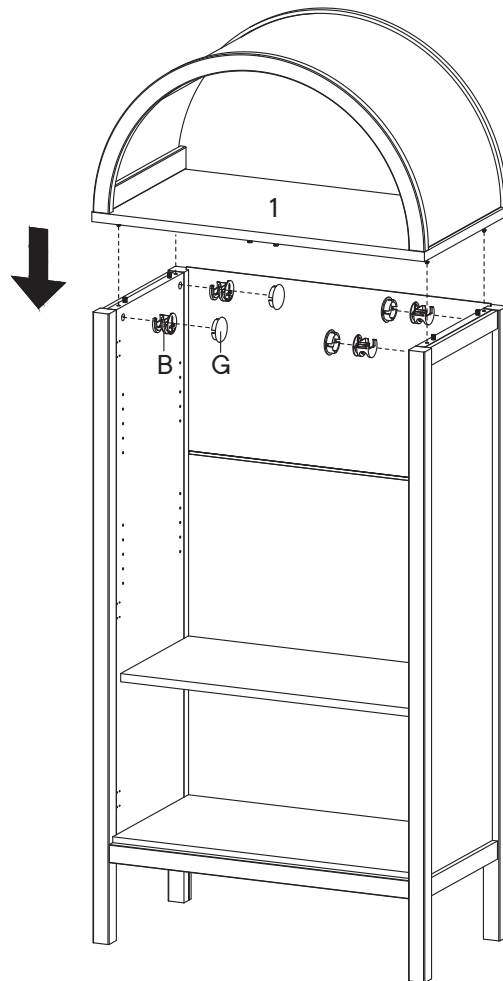
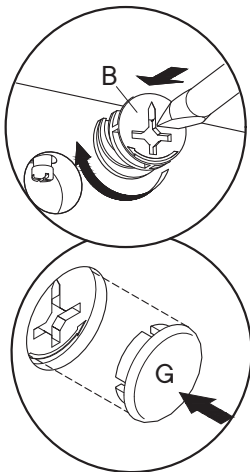

Step 15

HARDWARE

- F** Shelf Pin x8

COMPONENTS

- 5** Adjustable Shelf x2

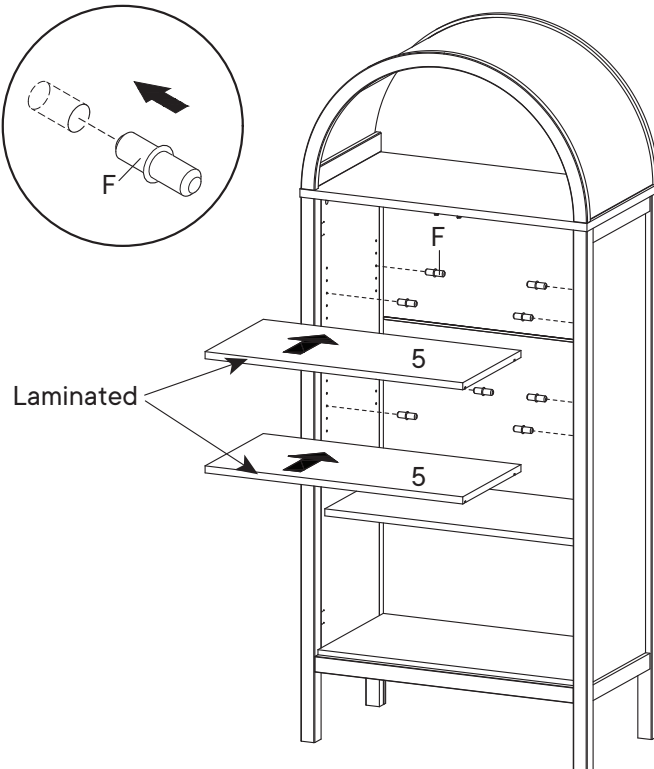
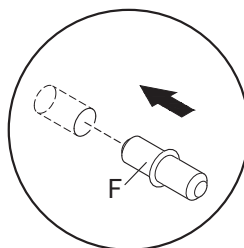

Step 16

HARDWARE

L	Screw M 4.5 x 12.5 mm	x12
HS26C	Hinge	x6

COMPONENTS

8	Door Left	x1
9	Door Right	x1

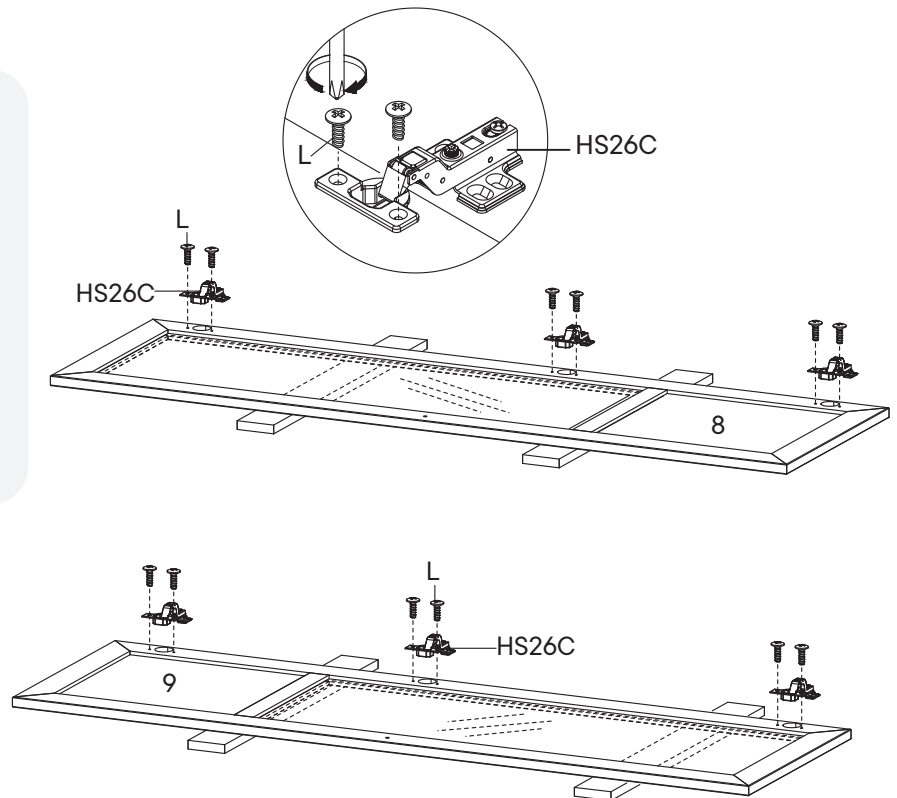

Step 17

HARDWARE

I	Handle	x2
J	Screw M 4 x 20 mm	x2
L	Screw M 4.5 x 12.5 mm	x24

COMPONENTS

8	Door Left	x1
9	Door Right	x1

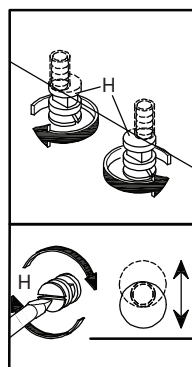
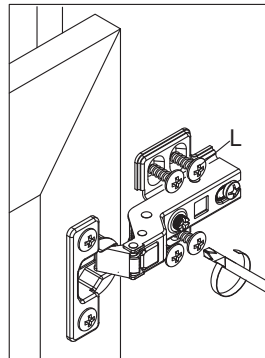

The door stopper position is adjustable (H). Please use screwdriver to adjust it as needed, so the doors are aligned when closed

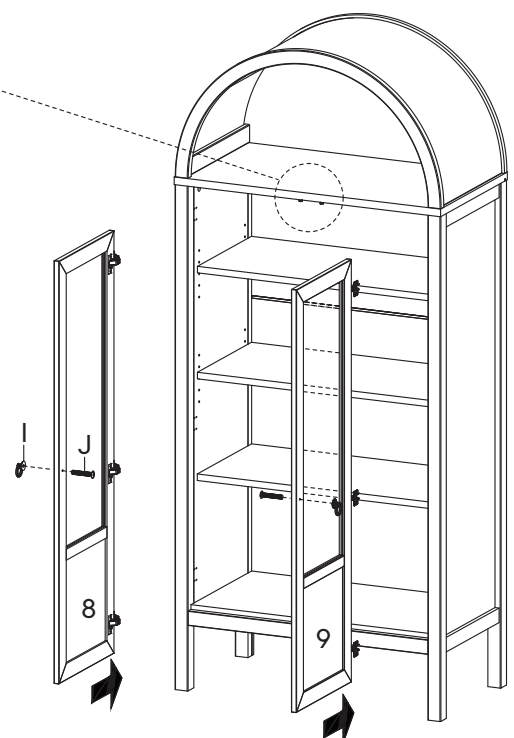

Note:

Door alignment can be adjusted after all cabinet parts are secured. Refer page 14 OF 14

Step 18

HARDWARE

- | | | |
|----------|-----------------------|-----|
| M | Wedge | x16 |
| N | Screw M 3.5 x 15.5 mm | x16 |

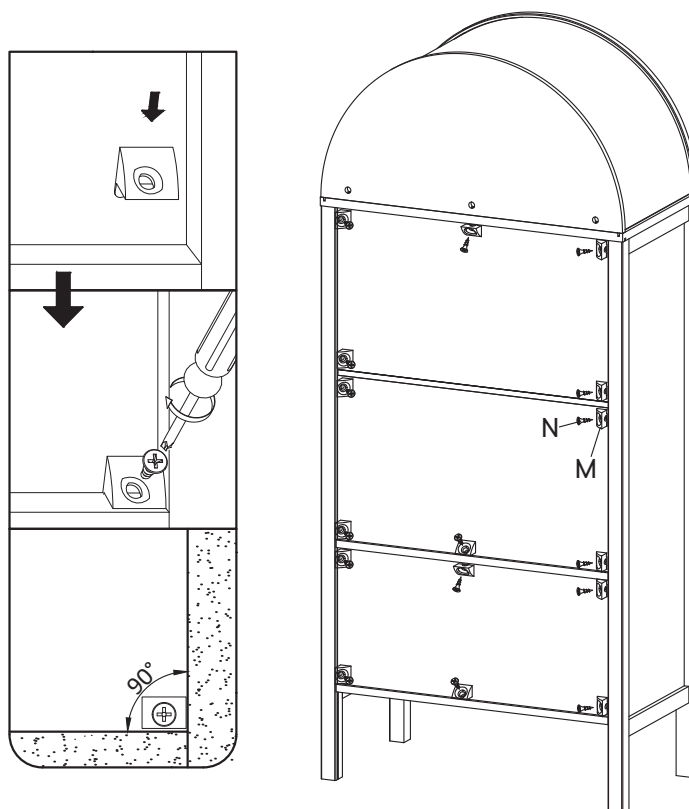

Step 19

HARDWARE

- | | | |
|----------|------|----|
| R | List | x2 |
|----------|------|----|

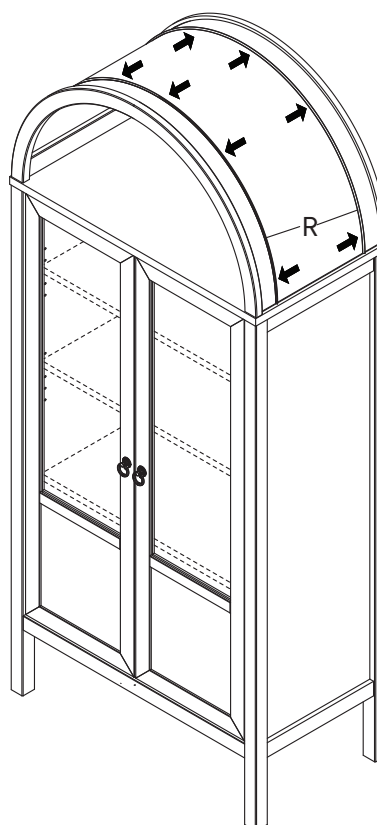
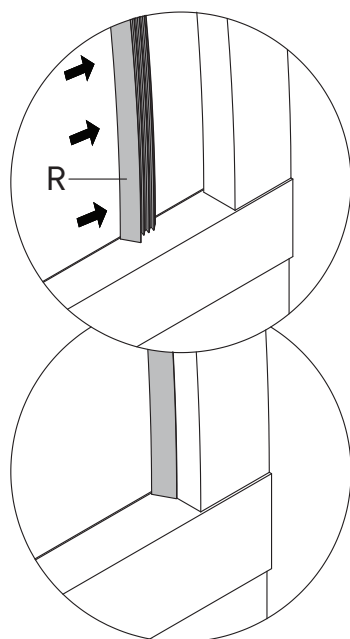

Great job!

Bookcase assembly is complete.

♥ CARING FOR YOUR ITEM

Indoor use only.

Not contract grade.

Clean using a non-abrasive cloth
and a mild cleaner.

Never use harsh chemicals,
as they could damage the finish
or integrity of the item.

CONNECT WITH US!



Tag us **@modway_furniture** and **#modway**
for a chance to be featured.

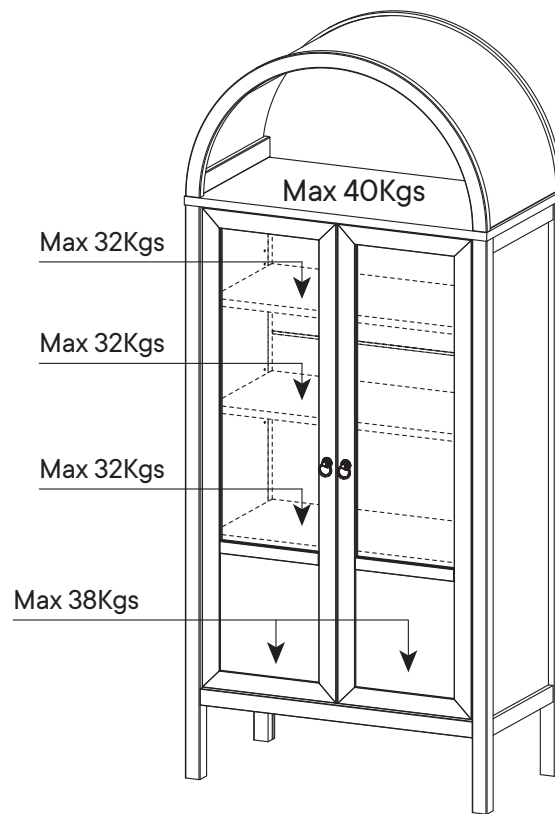

Cabinet Door Alignment

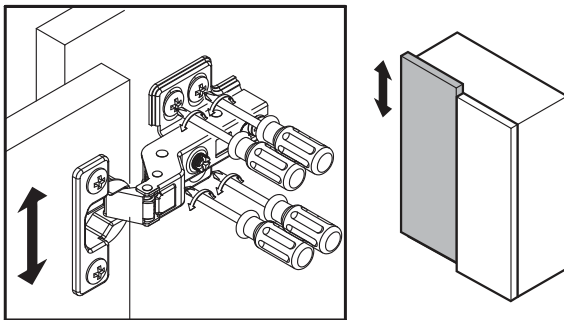
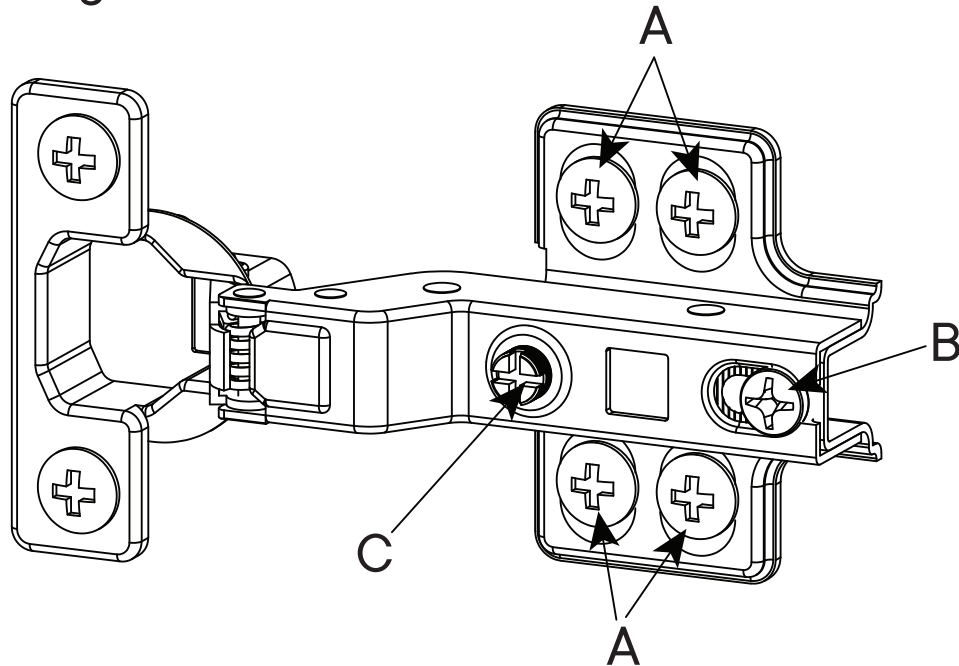

To adjust the vertical height.

Loosen the four screws "A" on both hinges. Two of them are usually in slotted holes which allows you to adjust up or down by few mm. Then tighten back up.

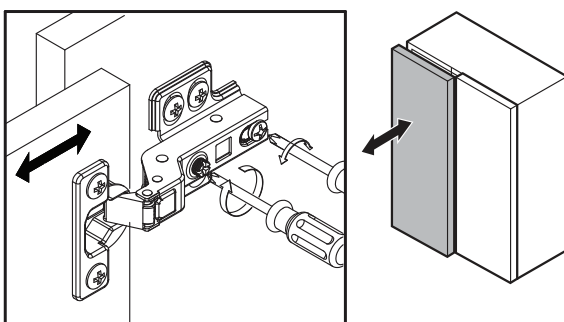

To adjust depth.

Loosen screw "B" and adjust door, if the door can not be adjusted, please loosen screw "C", then try again. Tighten screw "B" and "C".

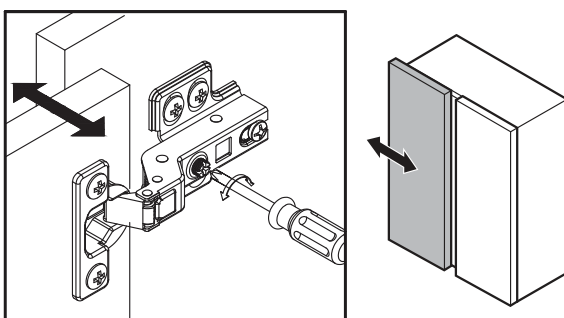

To adjust side ways.

Turn screw "C" on BOTH hinges on each door.

TIPPING RESTRAINTS KIT INSTALLATION GUIDANCE

Different wall materials require unique wall fasteners.

The wall plugs (AA2) and screws (AA3) are designed for fixing to concrete walls only.

Please consult your local hardware store to ensure you are using the correct hardware for you wall type.

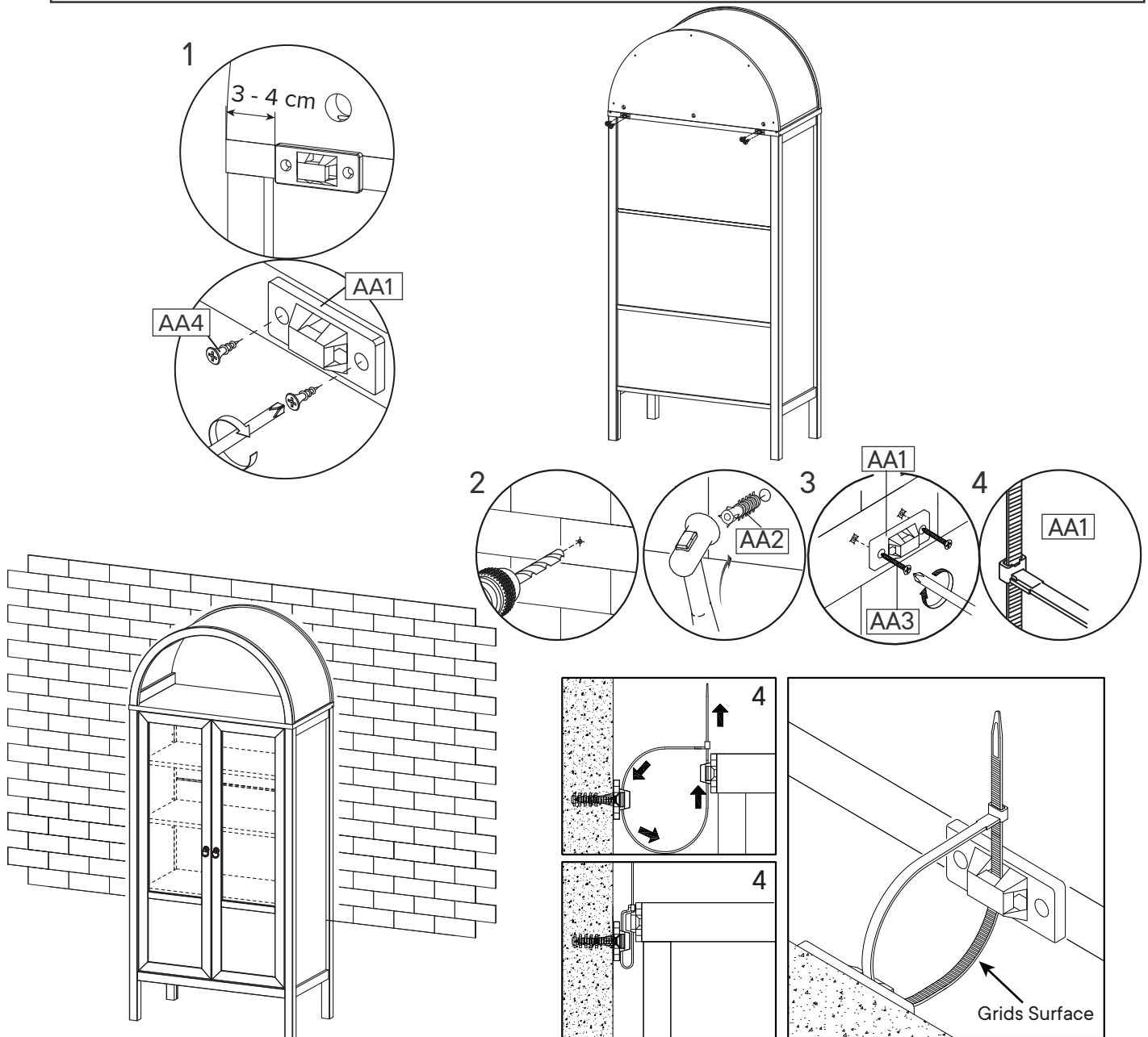
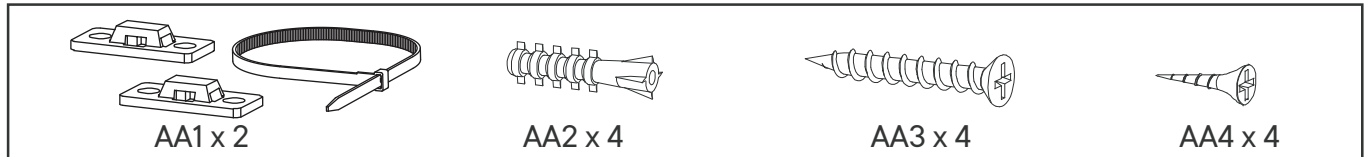

Installation Instructions :

1. Attach bracket (AA1) securely to the back top of the furniture using screw (AA4) provided. Allow 3 - 4 cm from each side.
2. Please make a hole for wall plugs position on the wall and minimum 15 mm below bracket secured to the back of unit attach the wall plugs (AA2).
3. Locate the other bracket (AA1) on the wall over wall plugs (AA2). Place furniture into position so both brackets (AA1) are vertically in the line.
4. Lace the end of the restrains strap through the larger hole in each bracket. Ensure the restrains strap with grids surface facing the inner loops. Bring both ends together and slide the flat end through the locking end and draw it through until all slack is removed.
5. Make sure that the strap is securely laced & locked.