

# LIFETIME 60-INCH ROUND NESTING TABLE (COMMERCIAL)

## 280301 / SPECIFICATIONS



|                     |   |
|---------------------|---|
| Table Top Color     | White Granite                             |
| Frame Color         | Gray                                      |
| Grade               | Commercial                                |
| Dimensions (Open)   | 60 in. D x 29 in. H (152,4 cm x 73,7 cm)  |
| Dimensions (Closed) | 60 in. D x 2.15 in. H (152,4 cm x 5,7 cm) |
| Table Top Material  | High-Density Polyethylene (HDPE)          |
| Table Top Thickness | 2.17 in. (55,2 mm)                        |
| Frame Material      | Powder-Coated Steel                       |

- UV-Protected High-Density Polyethylene (HDPE) Top
- Tables Nest Together Saving Storage and Transportation Space
- Superior Strength and Durability
- Lightweight Design

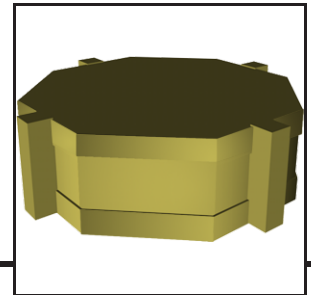

| Dimensions |                    | Pallet Dimensions |                     | Shipping Quantity |     |
|------------|--------------------|-------------------|---------------------|-------------------|-----|
| Quantity   | 1                  | Quantity          | 12                  | 20' Container     | 132 |
| Weight     | 40.0000 (18.1406)  | Weight            | 535.0000 (242.6304) | 40' Container     | 287 |
| Length     | 64.0000 (162.5600) | Length            | 64.0000 (162.5600)  | 40' H Container   | 315 |
| Width      | 64.0000 (162.5600) | Width             | 64.0000 (162.5600)  | 48' Container     | 192 |
| Height     | 2.8750 (7.3025)    | Height            | 39.5000 (100.3300)  | 53' Container     | 216 |
| Cubic Feet | 6.8148 (0.1930)    | Cubic Feet        | 93.6296 (2.6513)    |                   |     |
| Ship       | LTL                | Ship              | Ltl                 |                   |     |

UPC: 081483803548



\* Packaging may vary by model. Speak with your sales representative about individual model packaging.