

INSTALLATION INSTRUCTIONS

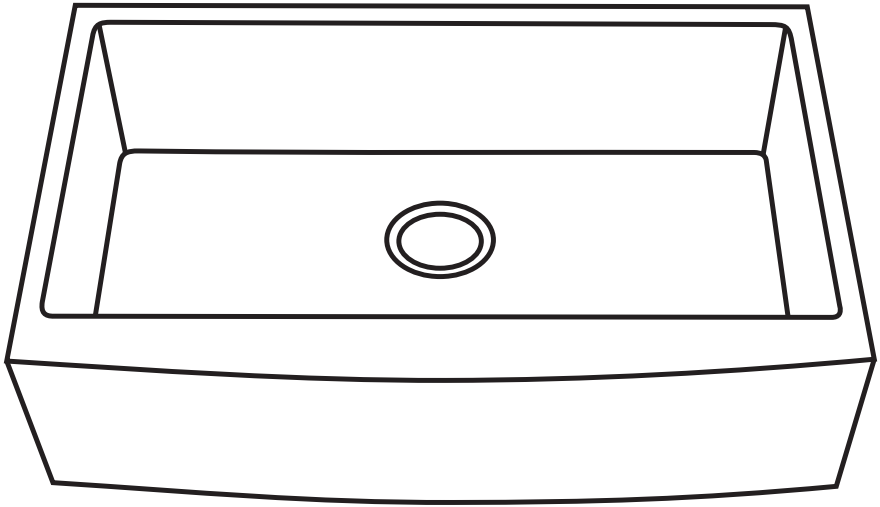

Farmhouse Kitchen Sink

IMPORTANT:

1. We strongly recommend that the product be installed by A licensed plumber.
2. We recommend at least two people to lift or mount the sink .

TOOLS

Safety glasses / marker / silicone adhesive sealant / tape / Jigsaw / rags / wood braces / leveling device / screws / bladed screwdriver

(Take 33"x22"x10" for example and check the picture below)

Step 1: Put the cutout template and mark the size on the countertop. Measure the height and depth of the apron sink to double-check the size and then cut the cabinet front and countertop accordingly.

Step 2: Make proper frames under the countertop to support the farmhouse sink. Prepare two supporting frames and fix them on right and left sides of the base. Before that, please mark the location of the frames to ensure that the rim of the sink will sit at frames and slightly below the top edge of the cabinet.

Step 3: Make sure proper space for the sink before gluing and inserting screws into the frames and cabinet.

Step 4: Position and fix the supports with screws.

Step 5: Put the sink into the cabinet. Check if the sink is resting on the supports.

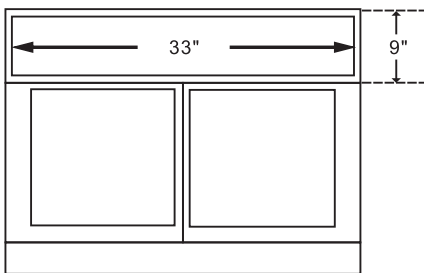

Step 1

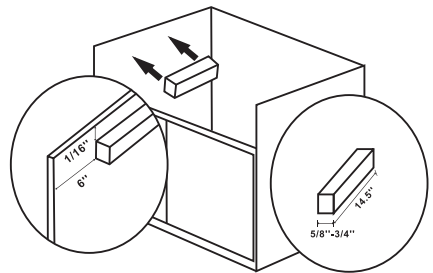

Step 2

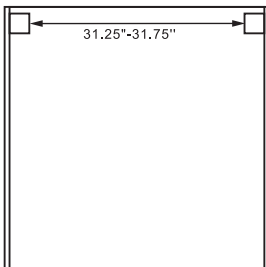

Step 3

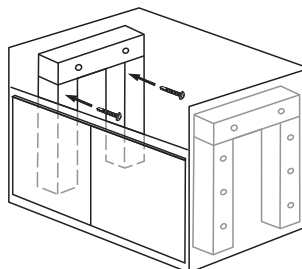

Step 4

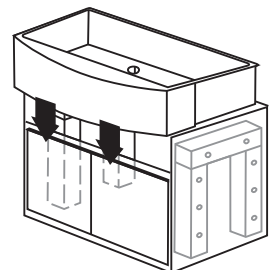

Step 5

Step 6: Remove the sink.

Step 7: Apply the silicone sealant to the top of each support.

Step 8: Place the sink onto the supports and adjust it to the proper position. There should be at least 4" space reserved between the back of the cabinet and the sink to allow faucet installation.

Step 9: Then cover the countertop on the sink. Add some calking for sealing if necessary.

Step 10: Install the secure clips to the countertop, make sure all clips are installed on the rim of the sink (At least 4 clips in back and 2 clips per side). Tighten each clip evenly. (optional)

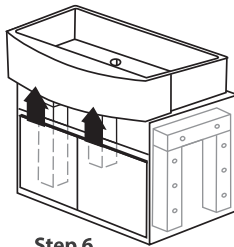

Step 6

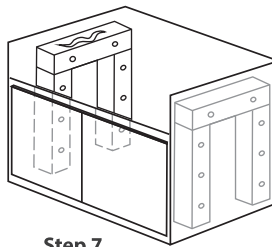

Step 7

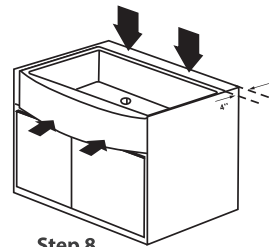

Step 8

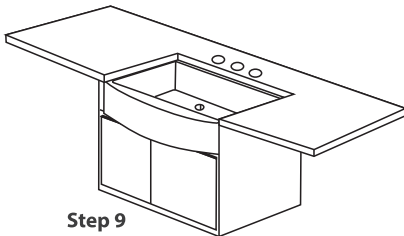

Step 9

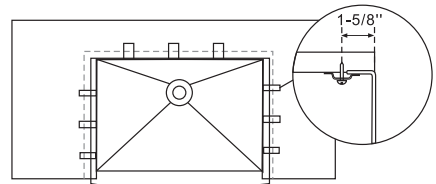

Step 10

Step 11: Complete countertop installation and wipe away any excess caulk from the sink rim.

- Connect drain to sink. Connect trap to drain. Connect water supply connections to faucet according to manufacturer's instructions.
- Run water into sink and check for leaks.

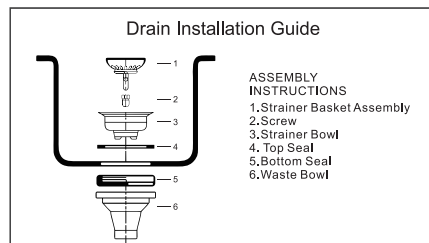
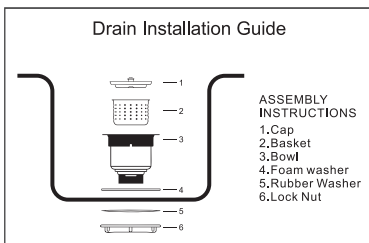

MAINTENANCE INSTRUCTIONS

MAINTENANCE INSTRUCTIONS

DO:

1. Clean Daily with soft towel to wipe the sink with warm water, Mixing in some wash-er-fluid is advisable. Remember to wipe it dry.
2. If any mineral substance is built up on the sink, clean it up as soon as possible.
3. Properly remove the rust, molds, or scratches with a scouring pad. Rubbing the sink in the direction of the brush.
4. Rub it slightly with a soft towel in the direction of brushed lines

DO NOT

1. Leave water spots, utensils, or steel cool-ware in the sink for a long time, which could become rust spots on your sink surface.
2. Leave cleaning agents or bleach sitting in your sink for a long time which may cause the sink to discolor or damage the surface.
3. Use steel wool or a scouring pad to rub.
4. Leave rubber mats, cleaning pads, or sponges in the sink for a long time as this may ruin the finish of your sink.
5. Cut food in the sink.
6. The hard water may also cause rust stains.

FAQs

1. Why are there rusts in my new kitchen sink?

Reasons: Rusts and stains on a stainless steel sink can be caused by a variety of factors, including:

- 1.1 Air on pan or other metal pans are left in the sink for days.
- 1.2 Utensils or flatware are left in the sink for days.
- 1.3 Metal cans (pet food cans, vegetables cans, etc.) are left in the sink for days.
- 1.4 The water contains iron (suggestion: get an iron filter to help alleviate this issue).
- 1.5 Certain dish soaps contained by metal bottle or built-in soap dispenser.
- 1.6 Wet sponges or colored towels are left in the sink for days.

Prevention and Treatments:

- 1.1 Install the sink after all innovation project is done and clean your sink right after installation.
- 1.2 Clean your sink after each use.
- 1.3 Properly remove the rusts and molds using a scouring pad.

2. What will scratch or harm the sink?

- 2.1 Improper packaging and accessories can lead to scratch marks during transit.
- 2.2 The sink can be easily scratched by sharp objects, please use soft cloth to clean the sink.

Prevention and Treatments:

- 1.1 Minor scratch: Use a sponge with toothpaste to polish it repeatedly.
- 1.2 Moderate scratch: Use a scouring pad to polish small areas.
- 1.3 Serious scratch: Purchase stainless steel polisher.