

## NOTICE

- \* Please make sure that you have all parts indicated and they are in good condition before you begin assembly of this item. Refer to part list and hardware list below for guidance.
- \* This item should be assembled on soft surface to prevent scratching the finish during assembly.
- \* This item may require periodic tightening.
- \* If you are having difficulty, our friendly Customer Care team is always here to help.

## PREPARATION

- \* Before beginning assembly of product, make sure all parts are present. Compare parts with package contents list and hardware content list.
- \* If any part is missing or damaged, do not attempt to assemble the product.
- \* Estimated Assembly Time : 10 minutes
- \* Tools Required for Assembly (included) : Allen Key

## CARE AND MAINTENANCE

- Spot clean using a mild water-free solvent. Only a professional cleaner should undertake a complete overall cleaning.
- The use of steam or water-based cleaners may cause excessive shrinking or staining.

## FURNITURE

Product Dimensions : 18" x 17" x 22"



### Part List and Hardware List

PIECE	DESCRIPTION	PICTURE	QUANTITY
A	NIGHTSTAND		1X
B	NATURAL HANDLE		2X
C	Nuts Dia 1.25" x 1"		2X
D	L Key		1X



Weight Capacity : 110 lbs

WARNING : DO NOT STAND ON NIGHT STAND TABLE

WARNING : DO NOT OVER TORQUE BOLTS

## PREPARATION

- \* Before beginning assembly of product, make sure all parts are present. Compare parts with part contents list and hardware content list.
- \* If any part is missing or damaged, do not attempt to assemble the product.
- \* Estimated Assembly Time : 10 minutes
- \* Tools Required for Assembly (included) : Allen Key
- \* If you are having difficulty, our friendly Customer Care team is always here to help.

Hardware is located inside the box. You can find them placed near the sign "HARDWARE INCLUDED"

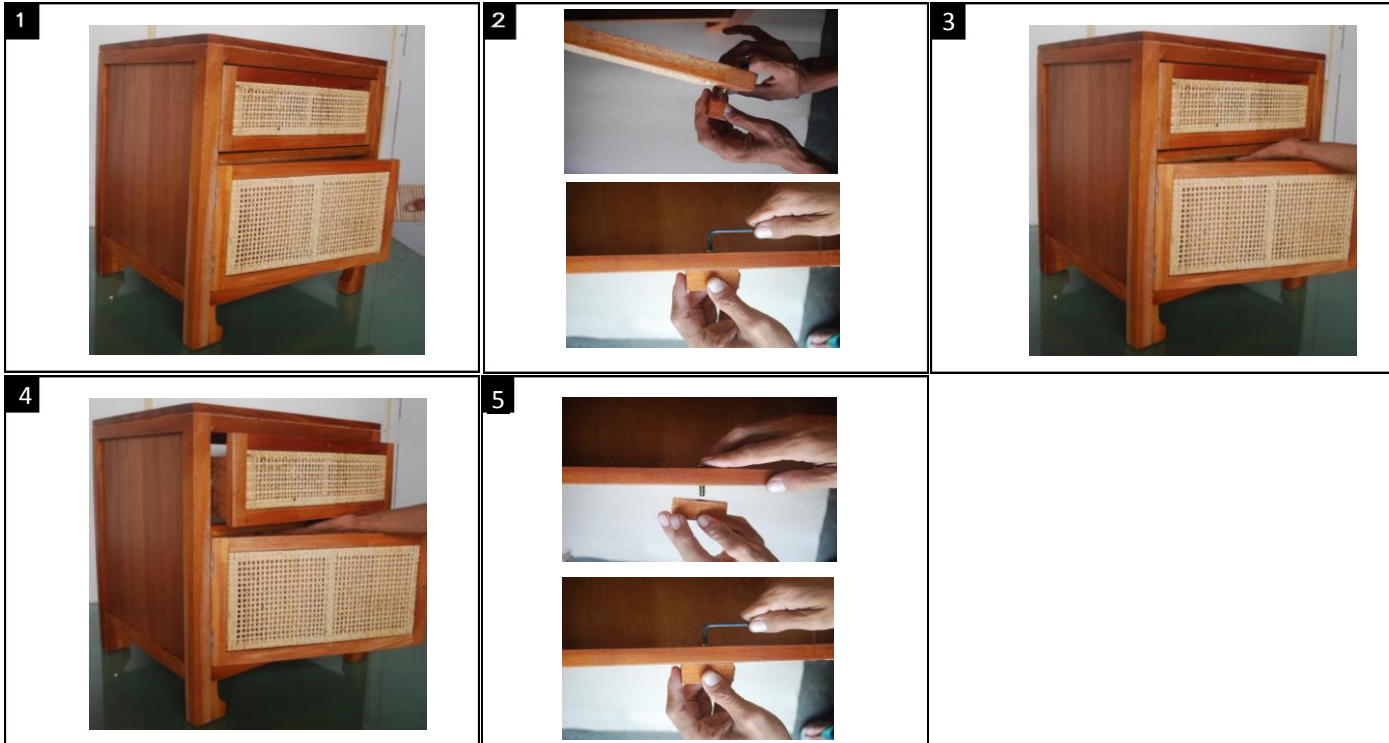

Step 1 : Pull the paper on door

Step 2 : Insert the bolt from back of door, then handle from the front. Spin the bolt and tighten with L key.

Step 3 : Place the hand on the bottom of drawer, then pull out the drawer with hand.

Step 4 : Pull out the drawer with hand.

Step 5 : Insert the bolt from back of drawer, handle from front. Spin the bolt and tighten with L Key